

Organisation/ Individual	Contact Name	Phone Number	Email Address/ Fax	Postal Address	LGA's	Additional information	
					Woollahra Waverly Wollondilly		
Gulaga	Wendy Smith	Not Provided	<a href="mailto:gulagachts@gmail.com">gulagachts@gmail.com</a>	Not Provided	Hawkesbury Blacktown Penrith Fairfield Holroyd Camden Campbelltown Liverpool Parramatta Sutherland Sydney Kogarah Hurstville Rockdale Canterbury Marrickville Bankstown Strathfield Randwick Woollahra	Ashfield Auburn Canada Bay Leichhardt Manly Mosman North Sydney Lane Cove Hunters Hill Hornsby Ku-Ring-Gai Pittwater Botany Bay Ryde Warringah Willoughby Blue Mountains Burwood The Hills Waverly Wollondilly	This group states that their boundaries (Murrin Peoples) extend from the Hawkesbury River to the Snowy River
Biamanga	Seli Storer	Not Provided	<a href="mailto:biamangachts@gmail.com">biamangachts@gmail.com</a>	Not Provided	Hawkesbury Blacktown Penrith Fairfield Holroyd Camden Campbelltown Liverpool Parramatta Sutherland Sydney Kogarah Hurstville Rockdale Canterbury Marrickville Bankstown Strathfield Randwick Woollahra	Ashfield Auburn Canada Bay Leichhardt Manly Mosman North Sydney Lane Cove Hunters Hill Hornsby Ku-Ring-Gai Pittwater Botany Bay Ryde Warringah Willoughby Blue Mountains Burwood The Hills Waverly Wollondilly	This group states that their boundaries (Murrin Peoples) extend from the Hawkesbury River to the Snowy River
Callendulla	Corey Smith	Not Provided	<a href="mailto:cullendullachts@gmail.com">cullendullachts@gmail.com</a>	Not Provided	Hawkesbury Blacktown Penrith Fairfield Holroyd Camden Campbelltown Liverpool Parramatta Sutherland	Ashfield Auburn Canada Bay Leichhardt Manly Mosman North Sydney Lane Cove Hunters Hill Hornsby	This group states that their boundaries (Murrin Peoples) extend from the Hawkesbury River to the Snowy River

Organisation/ Individual	Contact Name	Phone Number	Email Address/ Fax	Postal Address	LGA's	Additional information	
					Sydney Kogarah Hurstville Rockdale Canterbury Marrickville Bankstown Strathfield Randwick Woollahra	Ku-Ring-Gai Pittwater Botany Bay Ryde Warringah Willoughby Blue Mountains Burwood The Hills Waverly Wollondilly	
Murramarang	Roxanne Smith	Not Provided	<a href="mailto:murramarangchts@gmail.com">murramarangchts@gmail.com</a>	Not Provided	Hawkesbury Blacktown Penrith Fairfield Holroyd Camden Campbelltown Liverpool Parramatta Sutherland Sydney Kogarah Hurstville Rockdale Canterbury Marrickville Bankstown Strathfield Randwick Woollahra	Ashfield Auburn Canada Bay Leichhardt Manly Mosman North Sydney Lane Cove Hunters Hill Hornsby Ku-Ring-Gai Pittwater Botany Bay Ryde Warringah Willoughby Blue Mountains Burwood The Hills Waverly Wollondilly	This group states that their boundaries (Murrin Peoples) extend from the Hawkesbury River to the Snowy River
DJMD Consultancy	Darren Duncan	0410 510 397	<a href="mailto:darrenjohnduncan@gmail.com">darrenjohnduncan@gmail.com</a>	Not Provided	Hawkesbury Blacktown Penrith Parramatta Sydney Marrickville Strathfield Warringah Willoughby Blue Mountains Burwood The Hills Ryde	Ashfield Auburn Canada Bay Leichhardt Manly Mosman North Sydney Lane Cove Hunters Hill Hornsby Ku-Ring-Gai Pittwater	Darren is associated with Metro and Deerubbin LALCs
Butucarbin Aboriginal Corporation	Jennifer Beale	(02)9832 7167	<a href="mailto:koori@ozemail.com.au">koori@ozemail.com.au</a>	PO Box E18, Emerton, NSW 2770	Hawkesbury Blacktown Penrith Fairfield Holroyd Camden Campbelltown	Ashfield Auburn Canada Bay Leichhardt Manly Mosman North Sydney	

Organisation/ Individual	Contact Name	Phone Number	Email Address/ Fax	Postal Address	LGA's	Additional information
					Liverpool Parramatta Sutherland Sydney Kogarah Hurstville Rockdale Canterbury Marrickville Bankstown Strathfield Randwick Woollahra	Lane Cove Hunters Hill Hornsby Ku-Ring-Gai Pittwater Botany Bay Ryde Warringah Willoughby Blue Mountains Burwood The Hills Waverly Wollondilly
Didge Ngunawal Clan	Lillylea Carroll Paul Boyd	0426823944	didgegunawal@yahoo.com	7 Siskin St, Quakers Hill NSW 2763	Hawkesbury Blacktown Penrith Fairfield Holroyd Camden Campbelltown Liverpool Parramatta Sutherland Sydney Kogarah Hurstville Rockdale Canterbury Marrickville Bankstown Strathfield Randwick Woollahra	Ashfield Auburn Canada Bay Leichhardt Manly Mosman North Sydney Lane Cove Hunters Hill Hornsby Ku-Ring-Gai Pittwater Botany Bay Ryde Warringah Willoughby Blue Mountains Burwood The Hills Waverly Wollondilly
Ginninderra Aboriginal Corporation	Steven Johnson and Krystle Carroll	0406991221	Ginninderra.corp@gmail.com	1 Smallwood Road, McGraths Hill NSW 2756	Hawkesbury Blacktown Penrith Fairfield Holroyd Camden Campbelltown Liverpool Parramatta Sutherland Sydney Kogarah Hurstville Rockdale Canterbury Marrickville Bankstown Strathfield Randwick	Ashfield Auburn Canada Bay Leichhardt Manly Mosman North Sydney Lane Cove Hunters Hill Hornsby Ku-Ring-Gai Pittwater Botany Bay Ryde Warringah Willoughby Blue Mountains Burwood The Hills

Organisation/ Individual	Contact Name	Phone Number	Email Address/ Fax	Postal Address	LGA's	Additional information
					Woollahra      Waverly Wollondilly	
Garrara Aboriginal Corporation	Raymond Ingrey		<a href="mailto:raymond@bariyu.org.au">raymond@bariyu.org.au</a>		Sutherland Liverpool Camden Campbelltown Wollondilly	



**DARUG LAND  
OBSERVATIONS PTY LTD  
ABN 27 602 765 453**

---

EMAIL: [DARUGLANDOBSERVATIONS@GMAIL.COM](mailto:DARUGLANDOBSERVATIONS@GMAIL.COM)  
PO BOX 571 PLUMPTON NSW 2761  
MOBILE: 0420 591 138 / 0413 687 279

1<sup>st</sup> February 2017

Tamika Goward  
Mary Dallas Consulting Archaeologists  
PO BOX A281  
ARNCLIFF ACT 2205

**Notification and Registration of ALL Aboriginal Interests**

RE: Proposed Redevelopment of the University of NSW, Cliffbrock Campus,  
Coogee

Aboriginal Archaeological & Cultural Heritage Assessment

Dear Tamika,

Please be advised that Darug Land Observations Pty Ltd is seeking to be involved in any and all consultation meetings and fieldwork.

This office specialises in Aboriginal and community consultations, and has a membership that comprises of Traditional owners from the area in question. Those retain strong story, song lines, oral history and continued contact.

We would also like to state that we do not accept or support any person or organisation that are NOT from the DARUG Nation that comments regarding the said area.

Please also be advised that this Aboriginal organisation does not do volunteer work or attend unpaid meetings. I hope that you advise your client of this so that, 'This Group', will not be discriminated against and refused paid fieldwork. DLO's rate is \$440 half day (less than 4 hours) and \$880 per day (flat rate), including GST.

All correspondence should be emailed to: [daruglandobservations@gmail.com](mailto:daruglandobservations@gmail.com) and any further consultation during this project can be directed to Anna or Jamie Workman.

Yours sincerely,

Jamie Workman  
Darug Land Observations Pty Ltd

Uncle Gordon Workman  
Darug Elder

3rd February 2017

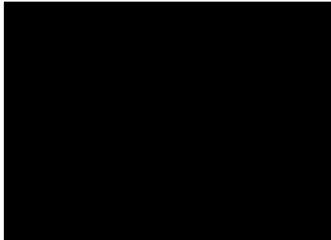

**RE: NOTIFICATION OF ABORIGINAL PEOPLE IN RELATION TO  
THE ABORIGINAL HERITAGE ASSESSMENT OF THE PROPOSED REDEVELOPMENT OF THE  
UNIVERSITY OF NEW SOUTH WALES CLIFFBROOK CAMPUS, COOGEE NSW**

Proponent: UNSW Australia [UNSW Sydney NSW 2052]

UNSW Australia are proposing the redevelopment of the Cliffbrook Campus (Lot 1 DP8162, Lot 1 DP109530 and Lot 8 DP8162) at 45-51 Beach Street, Coogee NSW. The proposal is to be assessed as a State Significant Development under Division 4.1 of the *Environmental Planning & Assessment Act 1979* and requires Aboriginal community consultation to be undertaken in accordance with the Office of Environment & Heritage 2010 *Aboriginal cultural heritage consultation requirements for proponents*. The proponent has engaged MDCA (Mary Dallas Consulting Archaeologists) to complete an Aboriginal Heritage Assessment and to coordinate the Aboriginal community consultation in accordance with these requirements.

Accordingly we have received your details from the Office of Environment & Heritage as someone who may potentially hold cultural knowledge relevant to determining the significance of Aboriginal objects at this location. If this is the case, you are invited to register your interest in the current project to ensure that you are consulted as per the 2010 OEH consultation requirements.

Please note that details of Registered Aboriginal Parties will be forwarded to The Office of Environment & Heritage and the La Perouse Local Aboriginal Land Council as per the above requirements. If you do not wish this to occur, please contact us in writing prior to **February 22, 2017** at one of the addresses listed below.

**IF YOU WISH TO BE REGISTERED** as a Registered Aboriginal Party, please notify MDCA in writing by Wednesday **February 22, 2017** at one of the following addresses:

POST	FAX	EMAIL
c/- PO Box A281 Arncliffe NSW 2205	(02) 8520 2006	admin@mdca.com.au



Please ensure that you provide us with current postal addresses and contact names. Any enquiries should be directed to Tamika Goward on 0488 999 452.

Yours sincerely,

Tamika Goward

**Mary Dallas Consulting Archaeologists**



Tamika Goward <tamika.goward@gmail.com>

---

**Notification in relation to the Aboriginal heritage assessment of the proposed redevelopment of the University of New South Wales Cliffbrook Campus, Coogee NSW**

---

**Biamanga** <biamangachts@gmail.com>  
To: Tamika Goward <tamika@mdca.com.au>

Sun, Feb 19, 2017 at 6:22 PM

Hi Tamika,

Biamanga wish to register their interest in the above project, and be kept informed of any further developments.

[Quoted text hidden]

--

**Kind Regards**  
**Seli Storer**  
**Chief Executive Officer**  
**Biamanga**

This email may contain privileged information. Privilege is not waived if it has been sent to you in error, or if you are not the intended recipient. Please immediately notify me and delete the email if you have received this in error.

## Admin

---

**From:** Jennifer Beale <koori@ozemail.com.au>  
**Sent:** Monday, 6 February 2017 5:00 PM  
**To:** admin@mdca.com.au  
**Subject:** EoI

Tamika

Butucarbin Aboriginal Corporation is registering its expression of interest the proposed redevelopment of the UNSW Cliffbrook campus. The postal address is:

P.O Box E18  
Emerton NSW 2770m

Regards

Jennifer Beale.  
Executive Officer.



Tamika Goward <tamika.goward@gmail.com>

---

**Notification in relation to the Aboriginal heritage assessment of the proposed redevelopment of the University of New South Wales Cliffbrook Campus, Coogee NSW**

---

**Cullendulla** <cullendullachts@gmail.com>  
To: Tamika Goward <tamika@mdca.com.au>

Sun, Feb 19, 2017 at 6:21 PM

Hi Tamika,

Please register Cullendullas expression of interest in the above project. We wish to be kept informed of any further developments thankyou.

[Quoted text hidden]

--

**Kind Regards**  
**Corey Smith**  
**Cultural Heritage Officer**  
**Cullendulla**

This email may contain privileged information. Privilege is not waived if it has been sent to you in error, or if you are not the intended recipient. Please immediately notify me and delete the email if you have received this in error.



Tamika Goward &lt;tamika.goward@gmail.com&gt;

---

## Registration

---

**lilly carroll** <didgengunawalclan@yahoo.com.au>  
To: Tamika Goward <tamika@mdca.com.au>

Sat, Feb 4, 2017 at 5:36 PM

Hi Tamika

Didge Ngunawal Clan would like to register an interest into Re: The Cliffbrook Campus Lot1 Dp8162,lot1 Dp109530 lot8 Dp8162 At 45-51 Beach Street Coogee NSW Didge Ngunawal Clan has lots of knowledge with Sydney surrounds, from La Perouse, Maroubra, Bondi, Rozelle etc.

DNC has plenty of exp. in sieving, digging and surveying. We can recognise stone artefacts, and will work in and under any condition. DNC also has its own tools and insurance.

Kind Regards  
Paul Boyd & Lilly Carroll  
Directors DNC

[Sent from Yahoo Mail for iPhone](#)

On Saturday, February 4, 2017, 5:02 PM, Tamika Goward <tamika@mdca.com.au> wrote:

Dear Ms Carroll,

The attached letter is a notification in relation to the Aboriginal heritage assessment of the proposed redevelopment of the University of New South Wales Cliffbrook Campus, Coogee NSW.

If you wish to be listed as a Registered Aboriginal Party for this project, please contact MDCA in writing by **Wednesday 22nd February 2017**.

Regards,

Tamika Goward

--

Tamika Goward BA(Hons)  
Archaeologist  
**Mary Dallas Consulting Archaeologists**

PO Box A281  
Arncliffe NSW 2205  
T: + 61 2 4465 2546  
F: + 61 2 8520 2006  
M: 0488 999 452  
E: tamika@mdca.com.au  
W: [www.mdca.com.au](http://www.mdca.com.au)



Tamika Goward <tamika.goward@gmail.com>

---

## Notification in relation to the Aboriginal heritage assessment of the proposed redevelopment of the University of New South Wales Cliffbrook Campus, Coogee NSW

---

**Ginninderra Aboriginal Corporation** <ginninderra.corp@gmail.com>  
To: Tamika Goward <tamika@mdca.com.au>

Thu, Feb 9, 2017 at 12:42 PM

Hi Tamika,

Could you please register us for this project on all levels of consultation. Which may include meetings, surveys and or fieldwork.

I apologise for the delay in sending our expression of interest, we are having technical problems with our internet in the office.

Kind regards,

Steve Johnson  
Ginninderra Aboriginal Corporation  
M: [0406991221](tel:0406991221)

[Quoted text hidden]

<Ginninderra.pdf>



Tamika Goward <tamika.goward@gmail.com>

---

**Notification in relation to the Aboriginal heritage assessment of the proposed redevelopment of the University of New South Wales Cliffbrook Campus, Coogee NSW**

---

**Goobah** <goobahchts@gmail.com>  
To: tamika@mdca.com.au

Sun, Feb 12, 2017 at 1:52 PM

Hi Tamika this is confirmation of our expression of interest with the above project and we wish to be kept informed of any further developments please.

--

**Regards Basil Smith**  
**Chief Executive Officer**  
**Goobah PH 0405995725**

This email may contain privileged information. Privilege is not waived if it has been sent to you in error, or if you are not the intended recipient. Please immediately notify me and delete the email if you have received this in error.



Tamika Goward <tamika.goward@gmail.com>

---

**Notification in relation to the Aboriginal heritage assessment of the proposed redevelopment of the University of New South Wales Cliffbrook Campus, Coogee NSW**

---

**Gulaga** <gulagachts@gmail.com>  
To: Tamika Goward <tamika@mdca.com.au>

Tue, Feb 14, 2017 at 11:33 AM

Dear Tamika

Gulaga wishes to be listed as a Registered Aboriginal Party for this project

I have sent an email to admin as requested

Many thanks

[Quoted text hidden]

--

**Kind Regards**  
**Wendy Smith**  
**Cultural Heritage Officer**  
**Gulaga**

This email may contain privileged information. Privilege is not waived if it has been sent to you in error, or if you are not the intended recipient. Please immediately notify me and delete the email if you have received this in error.



Tamika Goward <tamika.goward@gmail.com>

---

**Notification in relation to the Aboriginal heritage assessment of the proposed redevelopment of the University of New South Wales Cliffbrook Campus, Coogee NSW**

---

**Murramarang** <murramarangchts@gmail.com>  
To: Tamika Goward <tamika@mdca.com.au>

Sun, Feb 19, 2017 at 6:23 PM

Hi Tamika,

This is Murramarangs expression of interest to register for the above project.

[Quoted text hidden]

--

**Kind Regards**  
**Roxanne Smith**  
**Cultural Heritage Officer**  
**Murramarang**

This email may contain privileged information. Privilege is not waived if it has been sent to you in error, or if you are not the intended recipient. Please immediately notify me and delete the email if you have received this in error.



**APPENDIX A2 : Information and Methodology Document provided to all  
Registered Aboriginal Parties**

13 April 2017

Dear ,

**RE: ABORIGINAL CULTURAL HERITAGE ASSESSMENT OF THE  
UNIVERSITY OF NEW SOUTH WALES CLIFFBROOK CAMPUS, COOGEE NSW**

Thank you for your interest in the above project. You have been listed as a 'Registered Aboriginal Party' as per the *National Parks and Wildlife Regulation 2009* [Clause 80C (5)(a)] in relation to the current Aboriginal heritage assessment of the above property. Accordingly, your details have been forwarded to the Office of Environment and Heritage (OEH) and the La Perouse Local Aboriginal Land Council.

As per Clauses 80C (5) & (6) of the *National Parks and Wildlife Regulation 2009* we are now contacting you to provide you with information about the proposed assessment. You are also afforded an opportunity to make submissions on the proposed methodology or provide information on any Aboriginal objects or places of cultural value of which you are aware that are relevant to the proposed investigations. Specifically this document contains the following information:

- A description of the proposed activities and the background to the current assessment.
- A description of the timing of the current assessment and opportunities for Aboriginal comment and involvement.
- The proposed cultural and archaeological assessment methodology for your review and comment.
- Options for the management of any Aboriginal objects that may be located during possible subsurface Aboriginal archaeological investigations.

Please note that as per current OEH guidelines,<sup>1</sup> comment and consultation on the current project is separate to any engagement in archaeological fieldwork that may be undertaken during the current project.

If you wish to make comments on the proposed assessment methodology and/or Aboriginal cultural values within the study area, we would prefer that you provide these in writing. Any submission must however be received by 12 May 2017. Submissions can be sent to MDCA via:

---

<sup>1</sup> As outlined in Section 3.4 (page 9) of the 2010 *Aboriginal cultural heritage consultation requirements for proponents 2010. Part 6 National Parks & Wildlife Act 1974* (Department of Environment, Climate Change and Water).



**POST**

PO Box A281  
Arncliffe NSW 2205

**FAX**

(02) 8520 2006

**EMAIL**

admin@mdca.com.au

**1. Project Information**

The subject land is approximately 1.15ha in size and is situated on Gordon's Bay, approximately 6km southeast of the Sydney CBD and 10km north of Botany Bay (**Figure 1**). It is located within the Randwick Local Government Area, Parish of Alexandria and lies within the Office of Environment and Heritage Metropolitan South West Region. It is bounded to the south by Gordon's Bay, to the west by Beach Street, to the north by Battery Street and to the east by Tower Street (Error! Reference source not found.). The subject land currently contains the UNSW Cliffbrook Campus which comprises four main buildings (CC1 - CC4) with thoroughfares and car parking areas, landscaped gardens and lawns, as well as steeply sloping vegetated land above the bay. The centrepiece is the landmark, state heritage-listed 1920s mansion - Cliffbrook House (CC1). Most of the buildings are currently tenanted as offices, with the majority (including the offices of UNSW Press) located in Building CC4. In addition, Lot 8 DP8162 (10 Battery St) is an adjoining residential allotment which is also under consideration as part of the current assessment



Figure 1. The subject land in its local context.



Figure 2. Aerial view of the subject land.

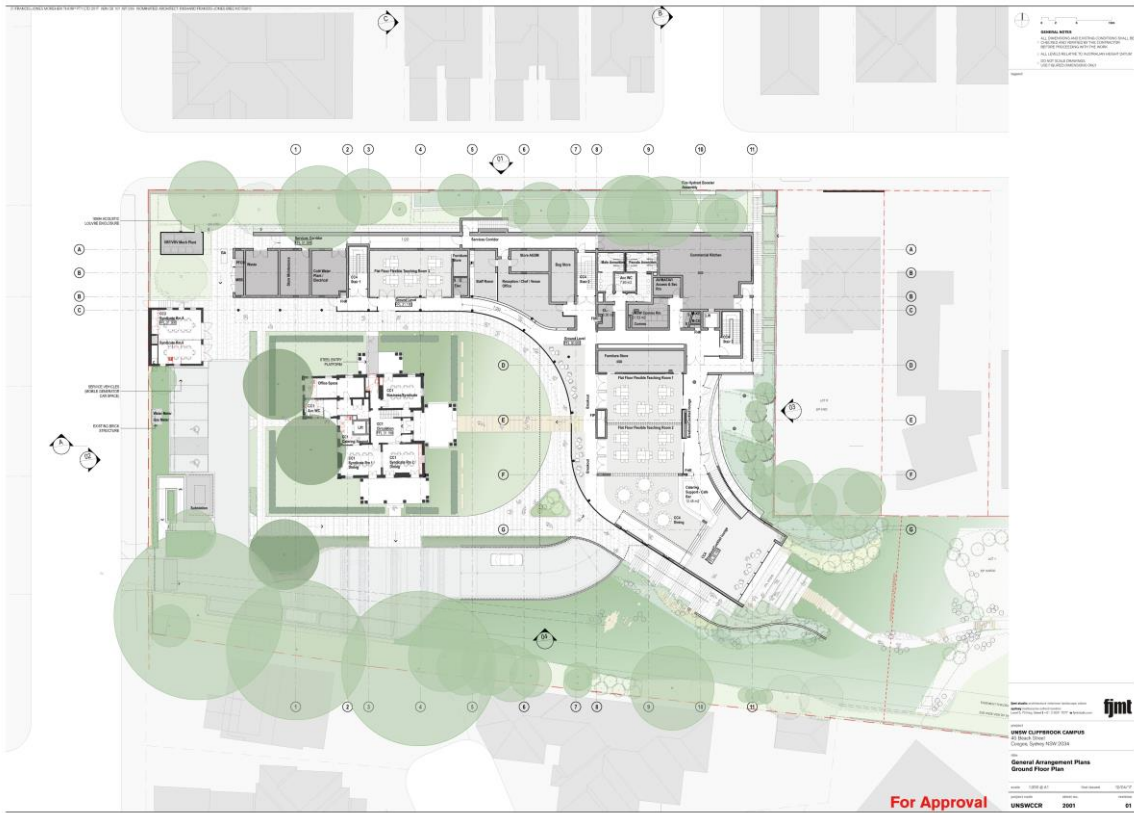

Figure 3. Indicative concept – site plan (Source: FJMT Architects).





The current proposal is to construct a purpose-built facility primarily to accommodate the UNSW Australian Graduate School of Management (AGSM) residential program, which will provide accommodation and learning facilities. The proposal involves (and see **Figure 3**):

- Demolition of the L-shaped, multipurpose/multilevel buildings (CC4) and single level CC2 building that dominate the northern portion of the subject land.
- Conservation of heritage buildings and structures including Cliffbrook mansion (CC1), the sandstone garage/office (CC3) and the sandstone perimeter wall and retention and conservation of significant plantings and landscapes. Cliffbrook House (CC1) will be adaptively reused as a combination of seminar rooms and a manager's residence. The garage (building CC3) will be adaptively reused as seminar rooms.
- Construction of a new residential and educational retreat, largely within the footprint of the building that is to be demolished. The building includes four levels and a basement car parking level, as well as an entrance, reception spaces, student support facilities, kitchen & dining facilities, flexible teaching rooms, up to 52 bedrooms, bathrooms, storage facilities, cleaning rooms, services plant rooms and infrastructure.
- In addition to the above, there will also be services upgrades (including installation of an electrical substation) as well as general landscaping improvements aimed at improving amenity and synthesising heritage, environment and architectural form within the unique coastal setting of the place.
- Leading from the new facilities to the eastern boundary of the subject land will be a gravel pathway (with some stone paving), including sections of wooden staircase and up to two areas of timber decking (**Figures 4 & 5**), together with associated new plantings.

The proposal is to be assessed as a State Significant Development under Section 89D of the *Environmental Planning & Assessment Act* 1979. Secretary's Environmental Assessment Requirements (SEARs) have been released by Department of Planning and Environment, which require an Aboriginal Cultural Heritage Assessment report to be prepared for the project, including documentation of Aboriginal community consultation in accordance with the OEH 2010 *Aboriginal cultural heritage consultation requirements for proponents*. The current assessment is being undertaken in accordance with the SEARs, and will inform an Environmental Impact Assessment report for the proposal. The proposal is to be submitted shortly, and the full documentation of Aboriginal community consultation will be appended as an addendum to that report on completion.

## 2. Contextual Information

The property is underlain by Hawkesbury Sandstone which outcrops along the eastern and southern extents. The outcrop is limited in extent and has possibly been quarried for footings and property boundaries of the adjacent residential properties. Much of the sandstone is covered with heath vegetation, but it does not appear to be of an expanse or quality that is likely to contain sites such as engravings or axe grinding grooves. No overhangs appear to be present within outcropping sandstone across the site.

Across the western two-thirds of the property, including in the western portion of the site where the proposed redevelopment is to occur, the sandstone is overlain by the edge of a Quaternary dune