

PRELIMINARY
1.12.2011

NOTE:
1. LOT BOUNDARIES AND AREAS ARE SUBJECT TO FINAL SURVEY
2. EXISTING EASEMENTS SHOWN ARE AS NOTED ON TITLE.

ROADS ARE ALLOWED TO BE WITHIN AZP

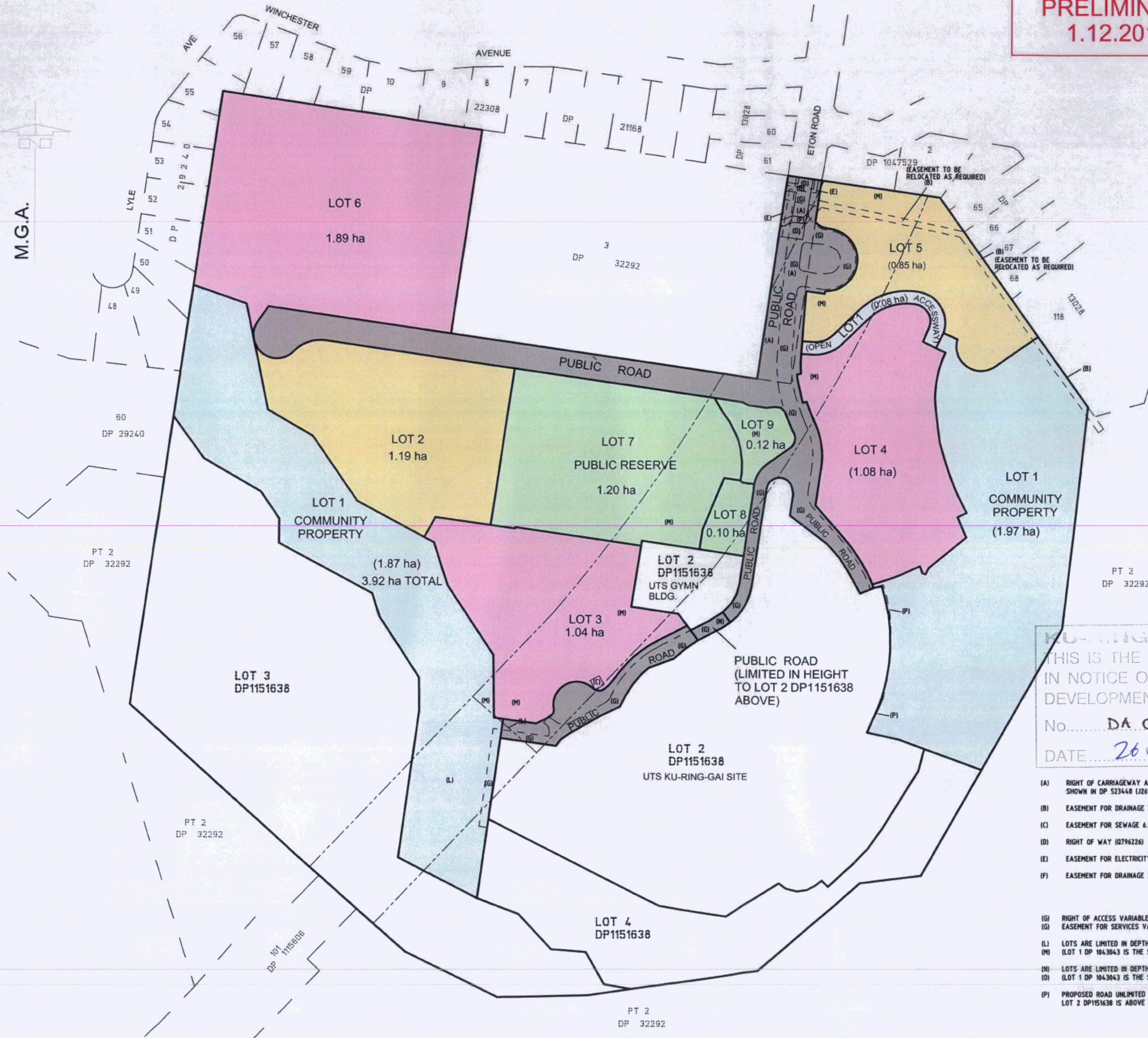

KU-RING-GAI COUNCIL
THIS IS THE PLAN/S REFERRED TO
IN NOTICE OF DETERMINATION OF
DEVELOPMENT APPLICATION

No. DA 06 17/11
DATE 26 June 2012

- (A) RIGHT OF CARRIAGEWAY AFFECTING THE PIECE OF LAND 20.115 WIDE SHOWN IN DP 523448 (J269400)
- (B) EASEMENT FOR DRAINAGE 3.66 & VAR. WIDTH (J744469)
- (C) EASEMENT FOR SEWAGE 6.96 WIDE SHOWN IN DP 221099 (K84524)
- (D) RIGHT OF WAY (Q796226)
- (E) EASEMENT FOR ELECTRICITY PURPOSES 2 WIDE (Q796226)
- (F) EASEMENT FOR DRAINAGE 3.66 WIDE (J745595)

- (G) RIGHT OF ACCESS VARIABLE WIDTH (DP1151638)
- (H) EASEMENT FOR SERVICES VARIABLE WIDTH (DP1151638)
- (I) LOTS ARE LIMITED IN DEPTH TO RL 20 AND ARE UNLIMITED IN HEIGHT, (LOT 1 DP 1043043 IS THE STRATUM BELOW)
- (J) LOTS ARE LIMITED IN DEPTH TO RL 30 AND ARE UNLIMITED IN HEIGHT, (LOT 1 DP 1043043 IS THE STRATUM BELOW)
- (K) PROPOSED ROAD UNLIMITED IN DEPTH AND LIMITED IN HEIGHT TO RL 65.0 LOT 2 DP1151638 IS ABOVE

No.	DATE	REVISION DETAILS
F	1.12.2011	ROAD CHANGE & BOY ADJUSTMENT
E	18.10.2011	BOY ADJUSTMENT PRECINCT 1,4,5
D	10.8.2011	NEW BOUNDARIES + AREAS
C	2.8.2011	CHANGE PT LOT 1 TO PUBLIC RD
B	29.7.2011	NEW BOUNDARIES + AREAS
A	28.7.2011	NEW BOUNDARIES

COPYRIGHT © INSITES PTY LTD. INFORMATION CONTAINED IN THIS DRAWING IS THE PROPERTY OF INSITES PTY LTD. THE INFORMATION MAY ONLY BE USED FOR THE PURPOSE FOR WHICH IT WAS COMMISSIONED AND IN ACCORDANCE WITH THE TERMS OF ENGAGEMENT FOR THE COMMISSION. UNAUTHORIZED USE OF THE INFORMATION IS PROHIBITED AND PENALIZED.

PREPARED BY

WHELAN'S INSITES

Whelans Insites Pty Ltd
ACN: 688 148 743

Level 12, 80 Clarence Street
Sydney, NSW 2000
DX 288 Sydney
T: 02 8234 8000
F: 02 9282 6511

insites.com.au

PREPARED FOR

DHA
Defence Housing Australia

"EDGELEA"
PROPOSED COMMUNITY TITLE
SUBDIVISION OF
LOT 1 DP 1151638
ETON ROAD, LINDFIELD

ORIGINAL SIZE		A1	
SCALE	HOR: 1:1200	VERT:	N/A
CO-ORDS	MGA	DATUM	N/A
DATE OF SURVEY	9/5/11	DATE OF PLAN	9/5/11
SURVEY	ANR	DRAWN	ANR
CHECKED	ANR	DATE	9/5/11
APPROVED	ANR	DATE	9/5/11
JOB REF	G243		
CAD REF	G243-018f.dwg		
		SHEET	1 OF 2 SHEETS