

- LEGEND:
- PHASE 1:
  - PHASE 1: ADMINISTRATIVE
  - 100M APZ
  - 2HR FIRE RATED WALL

DRAWING TO BE PRINTED IN COLOUR



**Copyright DesignInc Sydney Pty Limited**  
This drawing is protected by copyright. All rights are reserved. Unless permitted under the Copyright Act 1968, no part of this drawing may in any form or by any means be reproduced, published, broadcast or transmitted without the prior written permission of the copyright owner.

**Please note**  
If the Status of this drawing is not signed off For Construction it may be subject to change, alteration or amendment at the discretion of DesignInc Sydney Pty Limited. If so, DesignInc Sydney Pty Limited is not liable for any loss, damage, harm or injury whether special, consequential, direct or indirect, suffered by you or any other person as a result of your use of this drawing for construction purposes.

Figured dimensions take preference to scale readings. Verify all dimensions on site. Report any discrepancies to the Architect for decision before proceeding with the work.

**Nominated Architects**  
Anthony Quan 5421 | Sandeep Amin 7337 | Ian Armstrong 7260 | Richard Does 8126

No	DATE	REVISIONS	BY
A	04/05/2018	ISSUED FOR DEVELOPMENT APPROVAL	TG
B	07/05/2018	ISSUED FOR DEVELOPMENT APPROVAL	TG

ARCHITECT

**DesignInc | Lacoste + Stevenson | bmc2**  
architects in association

**DesignInc Sydney** PTY LIMITED ACN 003008820  
L12 / 77 PACIFIC HWY NORTH SYDNEY NSW 2060 AUSTRALIA  
PO BOX 651 NORTH SYDNEY NSW 2059 AUSTRALIA  
T +612 8905 7100 F +612 8905 7199  
E sydney@sydney.designinc.com.au www.designinc.com.au

**Architecture Urban Design Interiors**

CLIENT

**SCHOOL INFRASTRUCTURE NSW**

PROJECT

**Lindfield Learning Village -**

Eton Road,  
Lindfield NSW 2070

TITLE

**PHASE 1 PROPOSED FLOOR PLAN ROOF LEVEL**

	DRAWN BY	TG, CS, HC, RK		
	SCALES	1 : 1000 @A3		
	PLOT DATE	26/04/2022		
PROJECT N°		P18-023	REVISION	
DRAWING N°		DA-118	B	
DRAWING STATUS FOR APPROVAL		REVIEWED BY RG	SIGNATURE	DATE
QUALITY CERTIFIED ISO 9001 Completion of the Drawing Status is evidence the design has been verified as conforming to the requirements of the Project M.S. Plan. Initiating the 'Drawn By' box confirms that this drawing has been prepared in conformity with DesignInc Sydney M.S. procedures.				

**DEVELOPMENT APPLICATION**

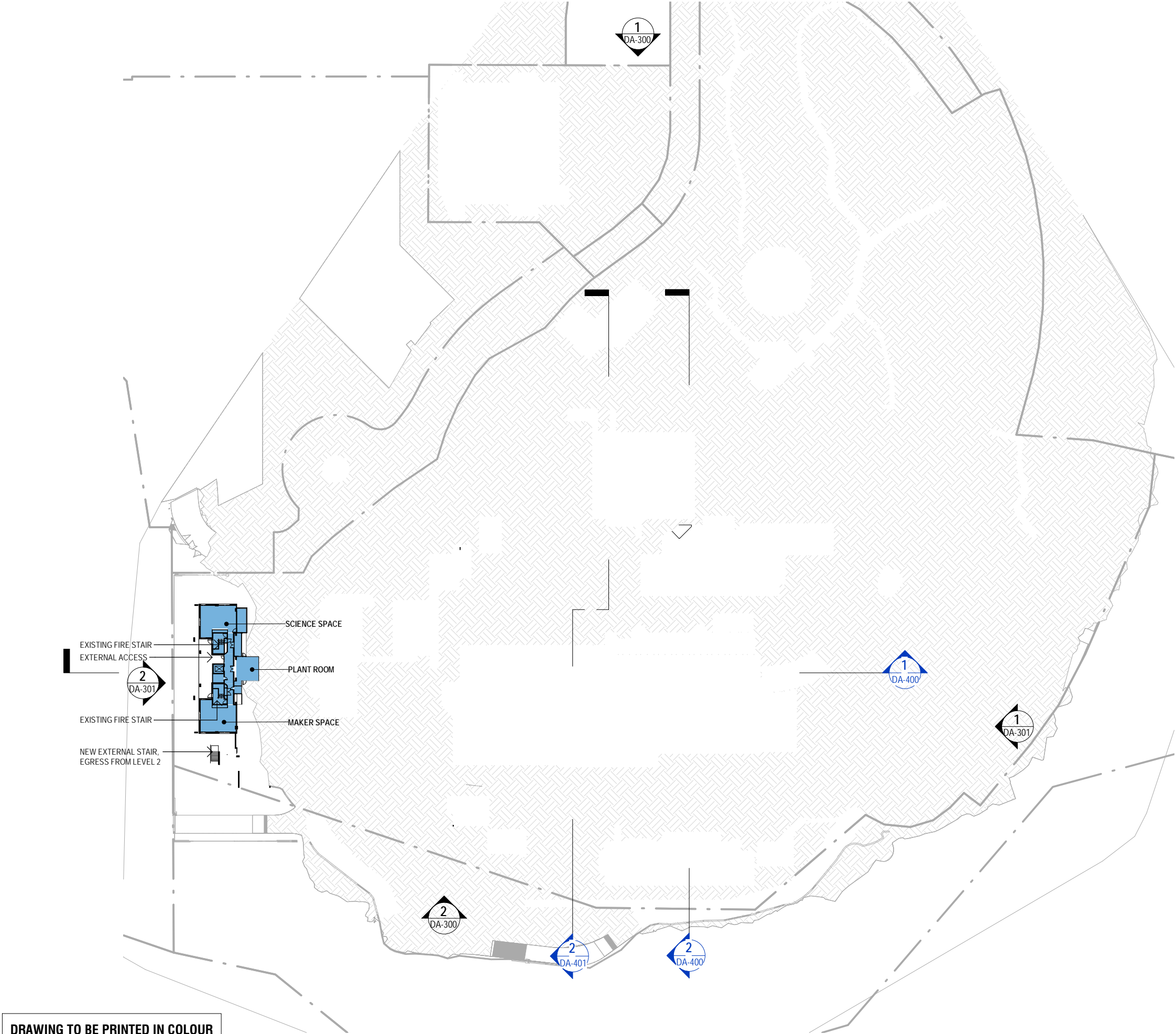

- STAGING LEGEND**
- STAGE 1 - PHASE 1
  - STAGE 1 - PHASE 2A
  - STAGE 1 - PHASE 2B
  - STAGE 2 - PHASE 3

© Copyright DesignInc Sydney Pty Limited

This drawing is protected by copyright. All rights are reserved. Unless permitted under the Copyright Act 1968, no part of this drawing may in any form or by any means be reproduced, published, broadcast or transmitted without the prior written permission of the copyright owner.

**Please note**

If the Status of this drawing is not signed off For Construction it may be subject to change, alteration or amendment at the discretion of DesignInc Sydney Pty Limited. If so, DesignInc Sydney Pty Limited is not liable for any loss, damage, harm or injury whether special, consequential, direct or indirect, suffered by you or any other person as a result of your use of this drawing for construction purposes.

Figured dimensions take preference to scale readings. Verify all dimensions on site. Report any discrepancies to the Architect for decision before proceeding with the work.

**Nominated Architects**

Anthony Guan 5421 | Sandeep Amin 7337 | Ian Armstrong 7260 | Richard Does 8126

No	DATE	REVISIONS	BY
A	04/05/2018	ISSUED FOR DEVELOPMENT APPROVAL	TG
B	07/05/2018	ISSUED FOR DEVELOPMENT APPROVAL	TG

ARCHITECT

**DesignInc | Lacoste + Stevenson | bmc2**

architects in association

**DesignInc Sydney** PTY LIMITED ACN 003008820  
L12 / 77 PACIFIC HWY NORTH SYDNEY NSW 2060 AUSTRALIA  
PO BOX 651 NORTH SYDNEY NSW 2059 AUSTRALIA  
T +612 8905 7100 F +612 8905 7199  
E sydney@sydney.designinc.com.au www.designinc.com.au

**Architecture Urban Design Interiors**

CLIENT

**SCHOOL INFRASTRUCTURE NSW**

PROJECT

**LINDFIELD LEARNING VILLAGE**  
Eton Road,  
Lindfield NSW 2070

TITLE

**CONSTRUCTION STAGING PLAN - LEVEL 0**

**N**

0 5 10 15 20 25  
SCALE BAR - 1:1000  
m

DRAWN BY	TG, CS, HC, RK
SCALES	1 : 1000 @A3
PLOT DATE	26/04/2018

PROJECT Nº.	S151441	REVISION
DRAWING Nº.	DA-120	B
DRAWING STATUS FOR APPROVAL	REVIEWED BY RG	SIGNATURE
		DATE

QUALITY CERTIFIED ISO 9001

Completion of the Drawing Status is evidence the design has been verified as conforming to the requirements of the Project M.S. Plan. Initiating the 'Drawn By' box confirms that this drawing has been prepared in conformity with DesignInc Sydney M.S. procedures.

**DEVELOPMENT APPLICATION**

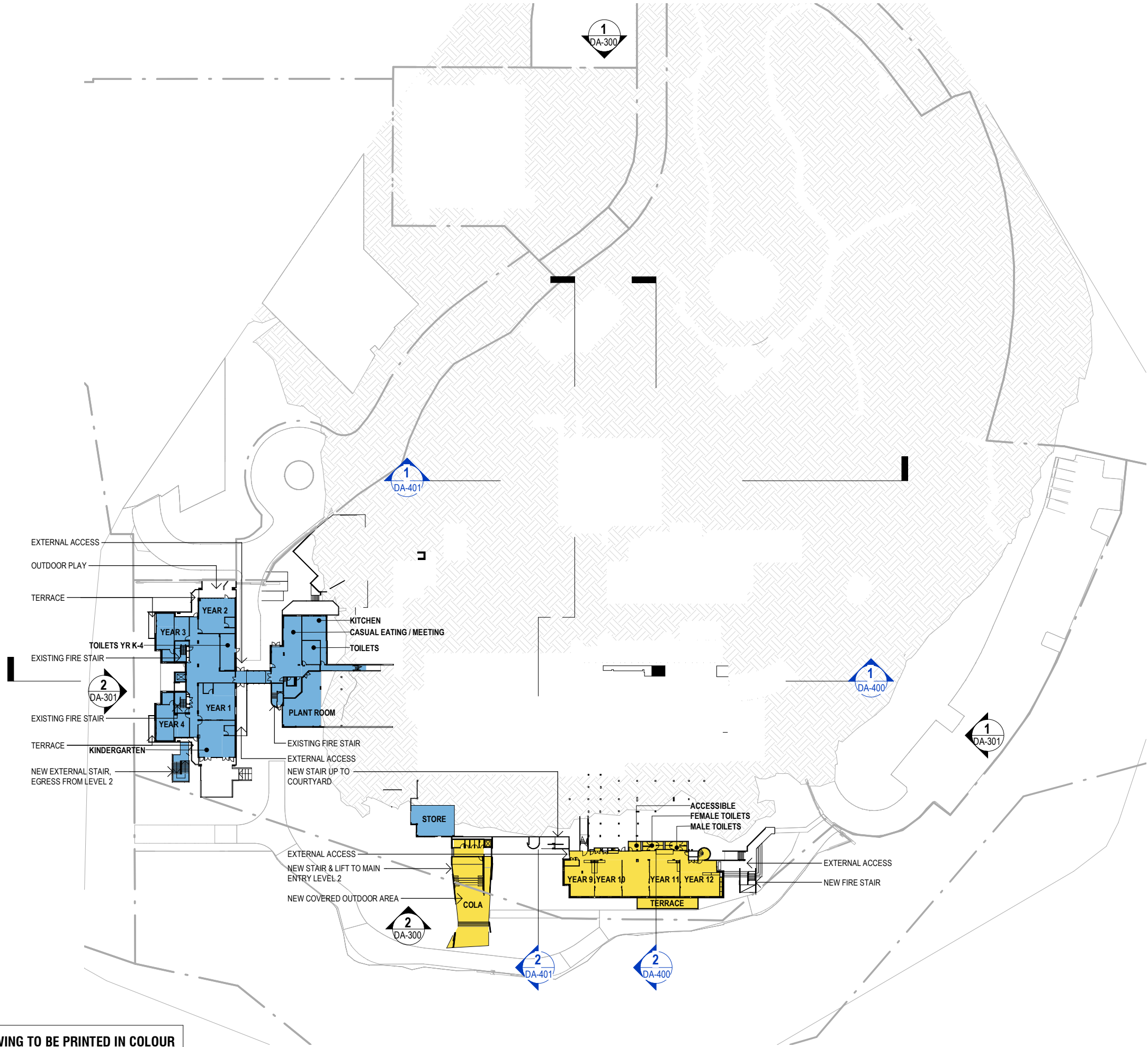

- STAGING LEGEND**
- STAGE 1 - PHASE 1
  - STAGE 1 - PHASE 2A
  - STAGE 1 - PHASE 2B
  - STAGE 2 - PHASE 3

© Copyright DesignInc Sydney Pty Limited  
This drawing is protected by copyright. All rights are reserved. Unless permitted under the Copyright Act 1968, no part of this drawing may in any form or by any means be reproduced, published, broadcast or transmitted without the prior written permission of the copyright owner.

**Please note**  
If the Status of this drawing is not signed off For Construction it may be subject to change, alteration or amendment at the discretion of DesignInc Sydney Pty Limited. If so, DesignInc Sydney Pty Limited is not liable for any loss, damage, harm or injury whether special, consequential, direct or indirect, suffered by you or any other person as a result of your use of this drawing for construction purposes.  
Figured dimensions take preference to scale readings. Verify all dimensions on site.  
Report any discrepancies to the Architect for decision before proceeding with the work.

**Nominated Architects**  
Anthony Quan 5421 | Sandeep Amin 7337 | Ian Armstrong 7260 | Richard Does 8126

No	DATE	REVISIONS	BY
A	04/05/2018	ISSUED FOR DEVELOPMENT APPROVAL	TG
B	07/05/2018	ISSUED FOR DEVELOPMENT APPROVAL	TG

ARCHITECT  
**DesignInc | Lacoste + Stevenson | bmc2**  
architects in association  
DesignInc Sydney PTY LIMITED ACN 003008820  
L12 / 77 PACIFIC HWY NORTH SYDNEY NSW 2060 AUSTRALIA  
PO BOX 651 NORTH SYDNEY NSW 2059 AUSTRALIA  
T +612 8905 7100 F +612 8905 7199  
E sydney@sydneydesigninc.com.au www.designinc.com.au  
Architecture Urban Design Interiors

CLIENT  
**SCHOOL INFRASTRUCTURE NSW**

PROJECT  
**LINDFIELD LEARNING VILLAGE**  
Eton Road,  
Lindfield NSW 2070

TITLE  
**CONSTRUCTION STAGING PLAN - LEVEL 1**

DRAWN BY	TG, CS, HC, RK		
SCALES	1 : 1000 @A3		
PLOT DATE	26/04/2018		
PROJECT N°	S151441	REVISION	B
DRAWING N°	DA-121		
DRAWING STATUS FOR APPROVAL	REVIEWED BY RG	SIGNATURE	DATE

QUALITY CERTIFIED ISO 9001  
Completion of the Drawing Status is evidence the design has been verified as conforming to the requirements of the Project M.S. Plans. Initiating the 'Drawn By' box confirms that this drawing has been prepared in conformity with DesignInc Sydney M.S. procedures.

**DEVELOPMENT APPLICATION**

DRAWING TO BE PRINTED IN COLOUR



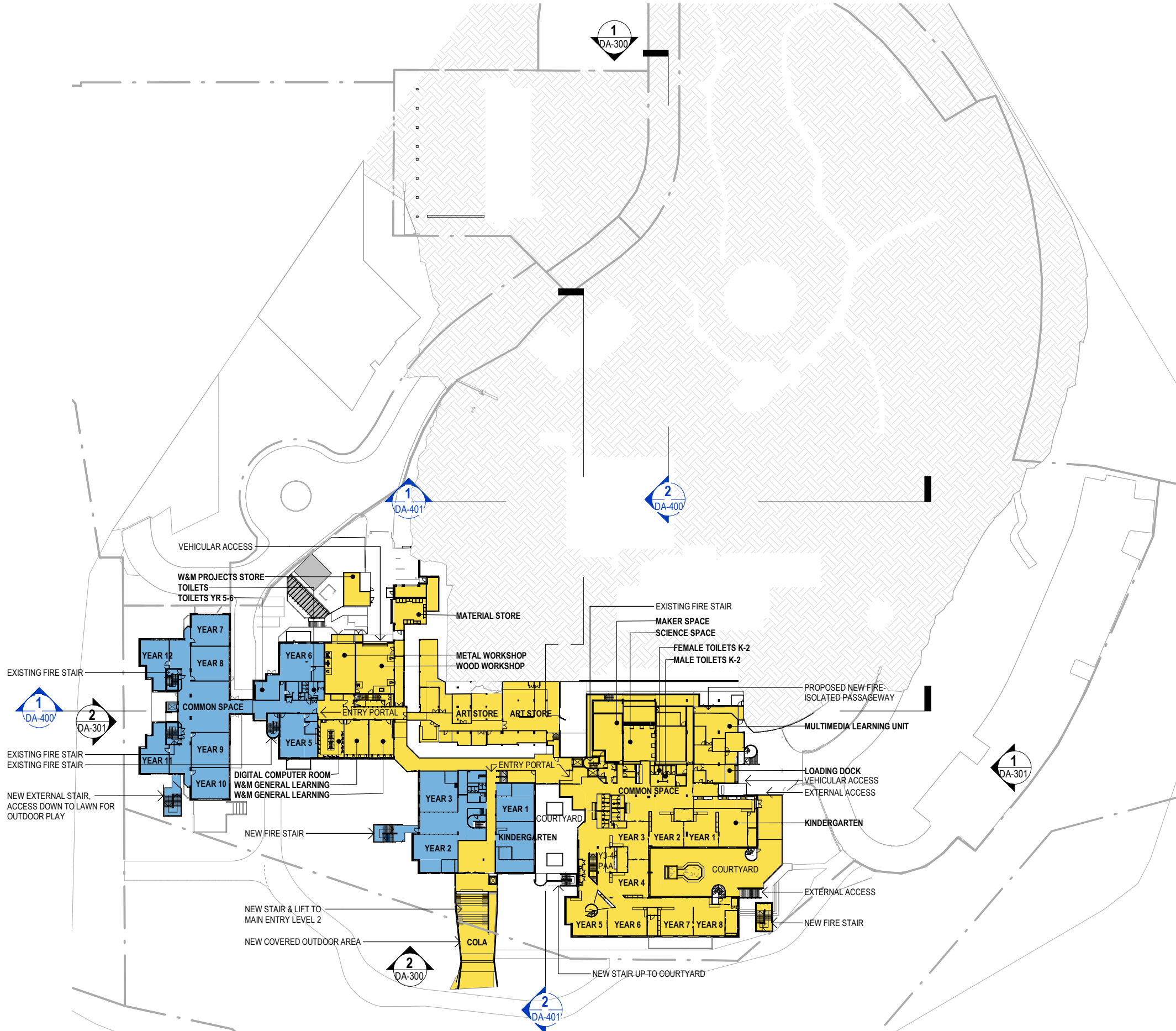

**STAGING LEGEND**

- STAGE 1 - PHASE 1
- STAGE 1 - PHASE 2A
- STAGE 1 - PHASE 2B
- STAGE 2 - PHASE 3

© Copyright DesignInc Sydney Pty Limited

This drawing is protected by copyright. All rights are reserved. Unless permitted under the Copyright Act 1968, no part of this drawing may in any form or by any means be reproduced, published, broadcast or transmitted without the prior written permission of the copyright owner.

**Please note**

If the Status of this drawing is not signed off For Construction it may be subject to change, alteration or amendment at the discretion of DesignInc Sydney Pty Limited. If so, DesignInc Sydney Pty Limited is not liable for any loss, damage, harm or injury whether special, consequential, direct or indirect, suffered by you or any other person as a result of your use of this drawing for construction purposes.

Figured dimensions take preference to scale readings. Verify all dimensions on site. Report any discrepancies to the Architect for decision before proceeding with the work.

**Nominated Architects**

Anthony Quan 5421 | Sandeep Amin 7337 | Ian Armstrong 7260 | Richard Does 8126

No	DATE	REVISIONS	BY
A	04/05/2018	ISSUED FOR DEVELOPMENT APPROVAL	TG
B	07/05/2018	ISSUED FOR DEVELOPMENT APPROVAL	TG

ARCHITECT

**DesignInc | Lacoste + Stevenson | bmc2**

architects in association

**DesignInc Sydney** PTY LIMITED ACN 003008820  
L12 / 77 PACIFIC HWY NORTH SYDNEY NSW 2060 AUSTRALIA  
PO BOX 651 NORTH SYDNEY NSW 2059 AUSTRALIA  
T +612 8905 7100 F +612 8905 7199  
E sydney@sydney.designinc.com.au www.designinc.com.au

Architecture Urban Design Interiors

CLIENT

**SCHOOL INFRASTRUCTURE NSW**

PROJECT

**LINDFIELD LEARNING VILLAGE**  
Eton Road,  
Lindfield NSW 2070

TITLE

**CONSTRUCTION STAGING PLAN - LEVEL 2**

<b>N</b>	DRAWN BY	TG, CS, HC, RK	
	SCALES	1 : 1000 @A3	
	PLOT DATE	26/04/2018	
<b>PROJECT N°.</b>	S151441	<b>REVISION</b>	
<b>DRAWING N°.</b>	DA-122	<b>B</b>	
<b>DRAWING STATUS FOR APPROVAL</b>	<b>REVIEWED BY</b>	<b>SIGNATURE</b>	<b>DATE</b>
	RG		
<b>QUALITY CERTIFIED ISO 9001</b>			
Completion of the Drawing Status is evidence the design has been verified as conforming to the requirements of the Project M.S. Plans. Initiating the 'Drawn By' box confirms that this drawing has been prepared in conformity with DesignInc Sydney M.S. procedures.			
<b>DEVELOPMENT APPLICATION</b>			

DRAWING TO BE PRINTED IN COLOUR



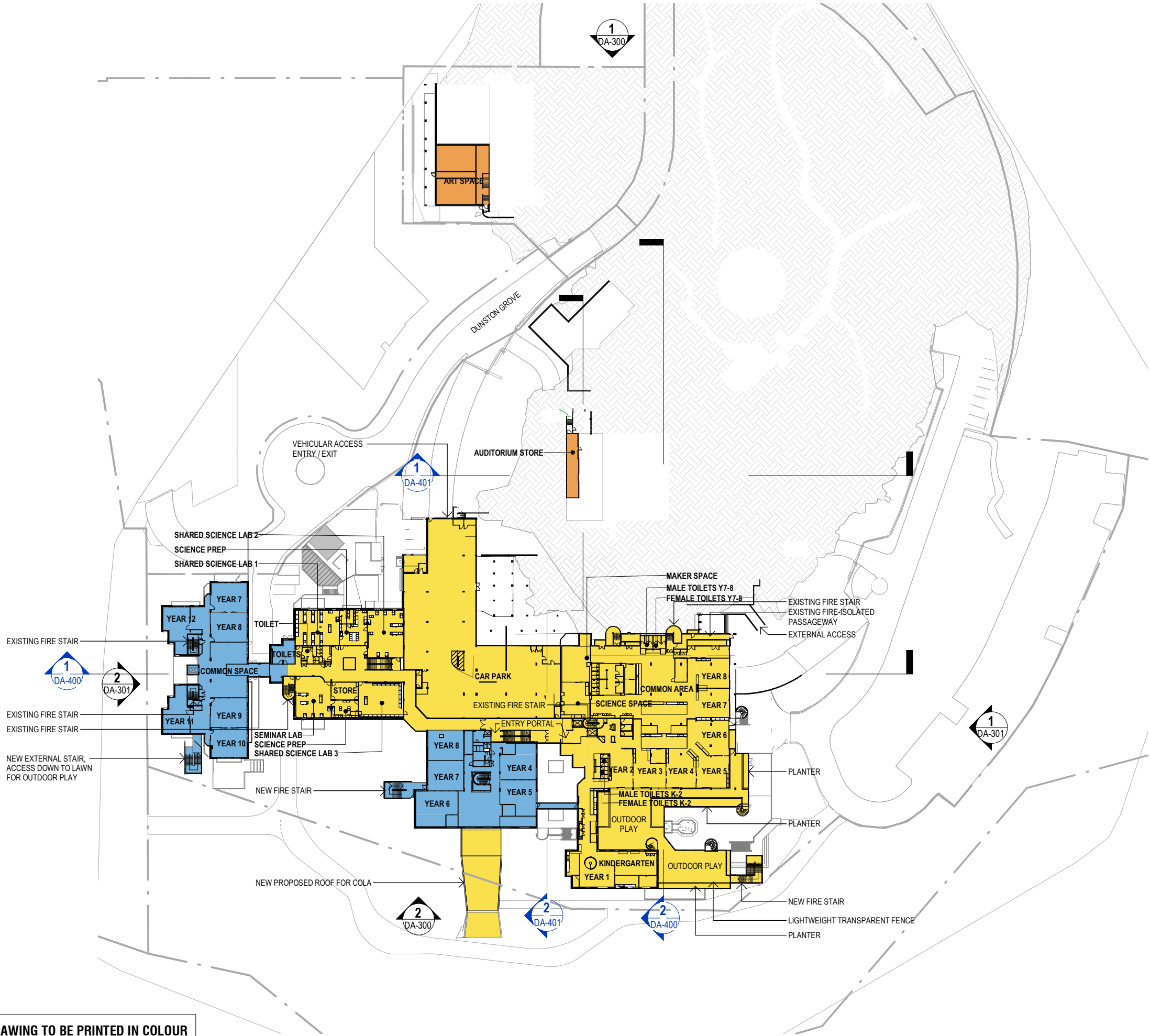

**STAGING LEGEND**

- STAGE 1 - PHASE 1
- STAGE 1 - PHASE 2A
- STAGE 1 - PHASE 2B
- STAGE 2 - PHASE 3

Copyright DesignInc Sydney Pty Limited

This drawing is protected by copyright. All rights are reserved. Unless permitted under the Copyright Act 1968, no part of this drawing may in any form or by any means be reproduced, published, broadcast or transmitted without the prior written permission of the copyright owner.

**Please note**

If the Status of this drawing is not signed off For Construction it may be subject to change, alteration or amendment at the discretion of DesignInc Sydney Pty Limited. If so, DesignInc Sydney Pty Limited is not liable for any loss, damage, harm or injury whether special, consequential, direct or indirect, suffered by you or any other person as a result of your use of this drawing for construction purposes.

Figured dimensions take preference to scale readings. Verify all dimensions on site. Report any discrepancies to the Architect for decision before proceeding with the work.

**Nominated Architects**

Anthony Quan 5421 | Sandeep Amin 7337 | Ian Armstrong 7260 | Richard Does 8126

No	DATE	REVISIONS	BY
A	04/05/2018	ISSUED FOR DEVELOPMENT APPROVAL	TG
B	07/05/2018	ISSUED FOR DEVELOPMENT APPROVAL	TG

ARCHITECT

**DesignInc | Lacoste + Stevenson | bmc2**

architects in association

**DesignInc Sydney** PTY LIMITED ACN 003008820  
L12 / 77 PACIFIC HWY NORTH SYDNEY NSW 2060 AUSTRALIA  
PO BOX 651 NORTH SYDNEY NSW 2059 AUSTRALIA  
T +612 8905 7100 F +612 8905 7199  
E sydney@sydneydesigninc.com.au www.designinc.com.au

**Architecture Urban Design Interiors**

CLIENT

**SCHOOL INFRASTRUCTURE NSW**

PROJECT

**LINDFIELD LEARNING VILLAGE**  
Eton Road,  
Lindfield NSW 2070

TITLE

**CONSTRUCTION STAGING PLAN - LEVEL 3**

**N**

**DRAWN BY**

TG, CS, HC, RK

**SCALES**

1 : 1000 @A3

**PLOT DATE**

26/04/2018

PROJECT N°	S151441	REVISION
DRAWING N°	DA-123	B
DRAWING STATUS FOR APPROVAL	REVIEWED BY RG	SIGNATURE
		DATE

**QUALITY CERTIFIED ISO 9001**

Completion of the Drawing Status is evidence the design has been verified as conforming to the requirements of the Project M.S. Plans. Initiating the "Drawn By" box confirms that this drawing has been prepared in conformity with DesignInc Sydney M.S. procedures.

**DEVELOPMENT APPLICATION**

DRAWING TO BE PRINTED IN COLOUR

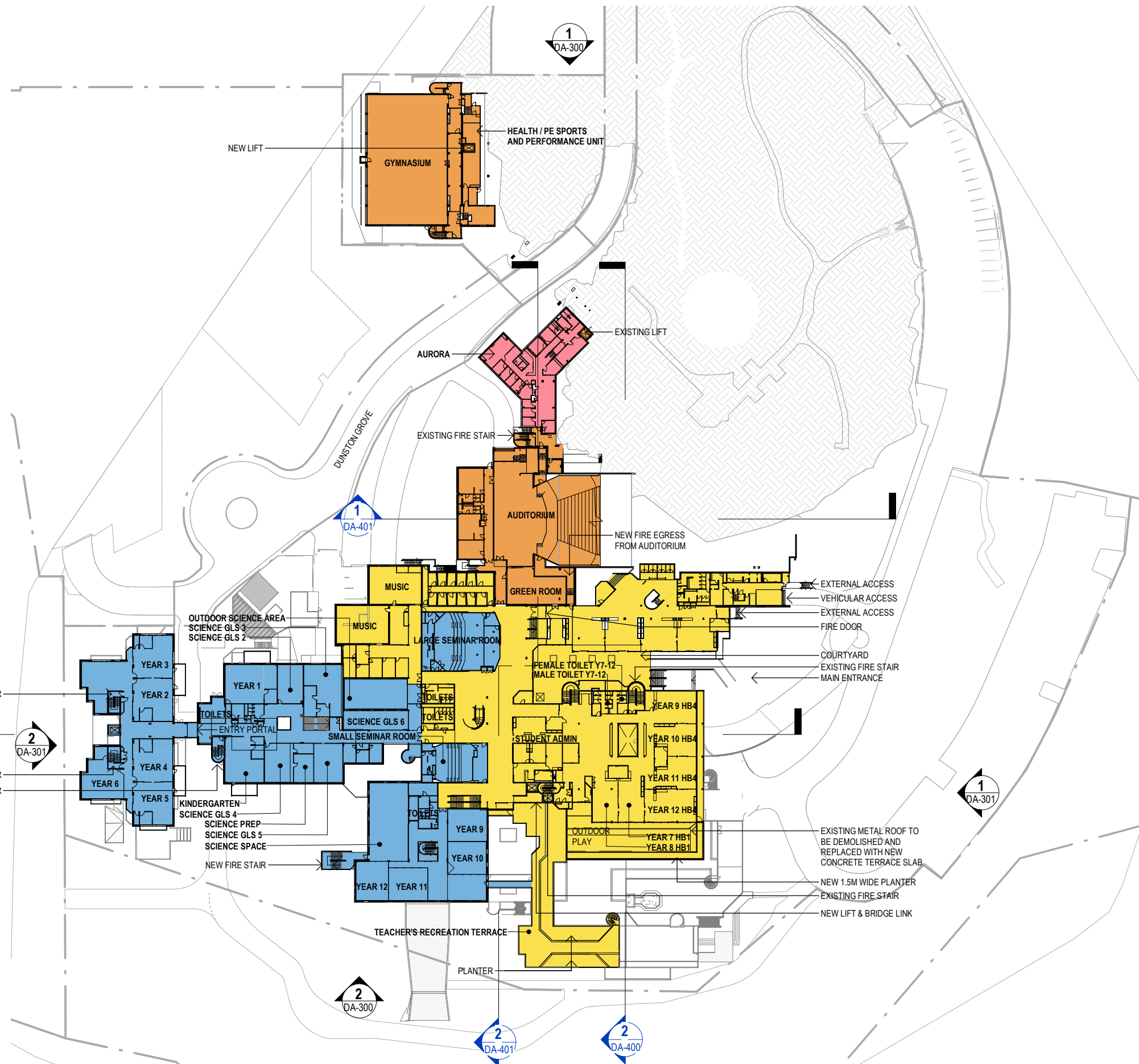

**STAGING LEGEND**

- STAGE 1 - PHASE 1
- STAGE 1 - PHASE 2A
- STAGE 1 - PHASE 2B
- STAGE 2 - PHASE 3

Copyright DesignInc Sydney Pty Limited

This drawing is protected by copyright. All rights are reserved. Unless permitted under the Copyright Act 1968, no part of this drawing may in any form or by any means be reproduced, published, broadcast or transmitted without the prior written permission of the copyright owner.

**Please note**

If the Status of this drawing is not signed off For Construction it may be subject to change, alteration or amendment at the discretion of DesignInc Sydney Pty Limited. If so, DesignInc Sydney Pty Limited is not liable for any loss, damage, harm or injury whether special, consequential, direct or indirect, suffered by you or any other person as a result of your use of this drawing for construction purposes.

Figured dimensions take preference to scale readings. Verify all dimensions on site. Report any discrepancies to the Architect for decision before proceeding with the work.

**Nominated Architects**

Anthony Quan 5421 | Sandeep Amin 7337 | Ian Armstrong 7260 | Richard Does 8126

No	DATE	REVISIONS	BY
A	04/05/2018	ISSUED FOR DEVELOPMENT APPROVAL	TG
B	07/05/2018	ISSUED FOR DEVELOPMENT APPROVAL	TG

ARCHITECT

**DesignInc | Lacoste + Stevenson | bmc2**

architects in association

**DesignInc Sydney** PTY LIMITED ACN 003008820  
L12 / 77 PACIFIC HWY NORTH SYDNEY NSW 2060 AUSTRALIA  
PO BOX 651 NORTH SYDNEY NSW 2059 AUSTRALIA  
T +612 8905 7100 F +612 8905 7199  
E sydney@sydney.designinc.com.au www.designinc.com.au

Architecture Urban Design Interiors

CLIENT

**SCHOOL INFRASTRUCTURE NSW**

PROJECT

**LINDFIELD LEARNING VILLAGE**  
Eton Road,  
Lindfield NSW 2070

TITLE

**CONSTRUCTION STAGING PLAN - LEVEL 4**

**N**

**DRAWN BY** TG, CS, HC, RK

**SCALES** 1 : 1000 @A3

**PLOT DATE** 26/04/2018

PROJECT N°	S151441	REVISION
DRAWING N°	DA-124	B

DRAWING STATUS	REVIEWED BY	SIGNATURE	DATE
FOR APPROVAL	RG		

**QUALITY CERTIFIED ISO 9001**

Completion of the Drawing Status is evidence the design has been verified as conforming to the requirements of the Project M.S. Plan. Initiating the 'Drawn By' box confirms that this drawing has been prepared in conformity with DesignInc Sydney M.S. procedures.

**DEVELOPMENT APPLICATION**

DRAWING TO BE PRINTED IN COLOUR



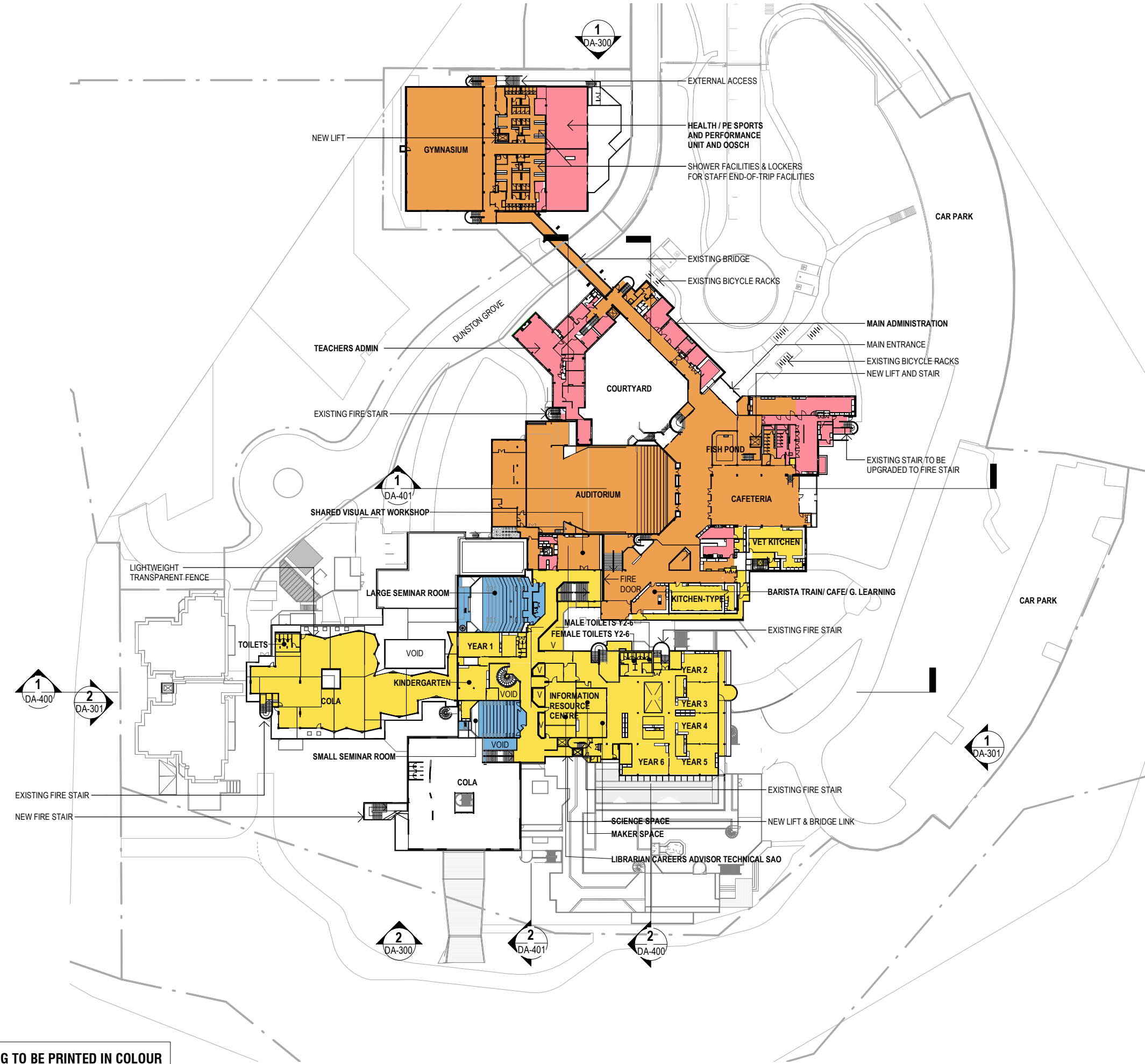

**STAGING LEGEND**

- STAGE 1 - PHASE 1
- STAGE 1 - PHASE 2A
- STAGE 1 - PHASE 2B
- STAGE 2 - PHASE 3

**Copyright DesignInc Sydney Pty Limited**  
This drawing is protected by copyright. All rights are reserved. Unless permitted under the Copyright Act 1968, no part of this drawing may in any form or by any means be reproduced, published, broadcast or transmitted without the prior written permission of the copyright owner.

**Please note**  
If the Status of this drawing is not signed off For Construction it may be subject to change, alteration or amendment at the discretion of DesignInc Sydney Pty Limited. If so, DesignInc Sydney Pty Limited is not liable for any loss, damage, harm or injury whether special, consequential, direct or indirect, suffered by you or any other person as a result of your use of this drawing for construction purposes.

Figured dimensions take preference to scale readings. Verify all dimensions on site. Report any discrepancies to the Architect for decision before proceeding with the work.

**Nominated Architects**  
Anthony Quan 5421 | Sandeep Amin 7337 | Ian Armstrong 7260 | Richard Does 8126

No	DATE	REVISIONS	BY
A	04/05/2018	ISSUED FOR DEVELOPMENT APPROVAL	TG
B	07/05/2018	ISSUED FOR DEVELOPMENT APPROVAL	TG
C	26/05/2018	ISSUED FOR INFORMATION	RK

ARCHITECT

**DesignInc | Lacoste + Stevenson | bmc2**  
architects in association

**DesignInc Sydney** PTY LIMITED ACN 003008820  
L12 / 77 PACIFIC HWY NORTH SYDNEY NSW 2060 AUSTRALIA  
PO BOX 651 NORTH SYDNEY NSW 2059 AUSTRALIA  
T +612 8905 7100 F +612 8905 7199  
E sydney@sydney.designinc.com.au www.designinc.com.au  
Architecture Urban Design Interiors

CLIENT

**SCHOOL INFRASTRUCTURE NSW**

PROJECT

**Lindfield Learning Village -**

Eton Road,  
Lindfield NSW 2070

TITLE

**CONSTRUCTION STAGING PLAN - LEVEL 5**

**N**

**DRAWN BY** TG, CS, HC, RK

**SCALES** 1 : 1000 @A3

**PLOT DATE** 26/04/2018

PROJECT N°	P18-023	REVISION
DRAWING N°	DA-125	C

DRAWING STATUS	REVIEWED BY	SIGNATURE	DATE
FOR APPROVAL	RG		

**QUALITY CERTIFIED ISO 9001**

Completion of the Drawing Status is evidence the design has been verified as conforming to the requirements of the Project M.S. Plan. Initiating the 'Drawn By' box confirms that this drawing has been prepared in conformity with DesignInc Sydney M.S. procedures.

**DEVELOPMENT APPLICATION**

DRAWING TO BE PRINTED IN COLOUR





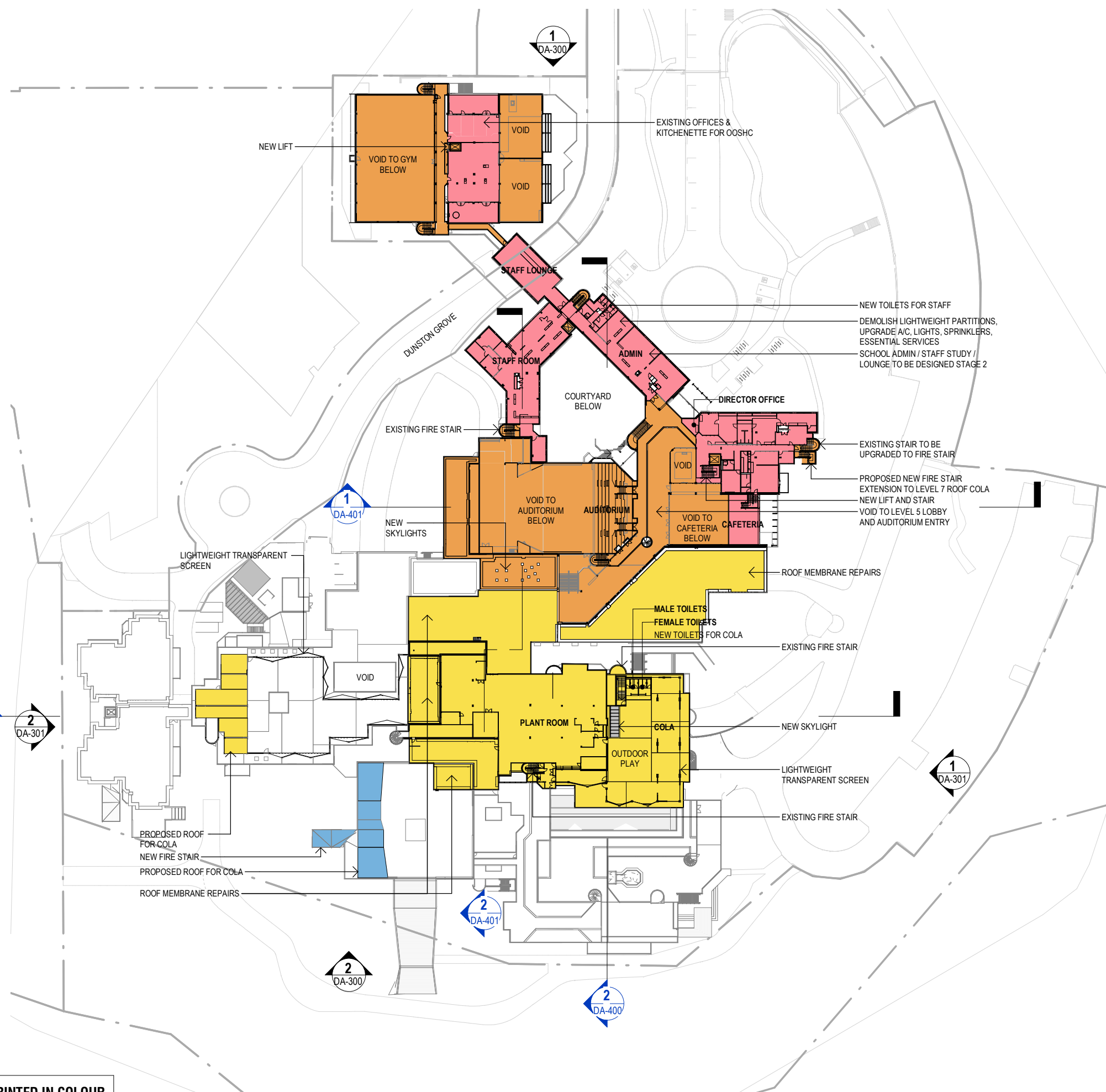

**STAGING LEGEND**

- STAGE 1 - PHASE 1
- STAGE 1 - PHASE 2A
- STAGE 1 - PHASE 2B
- STAGE 2 - PHASE 3

© Copyright DesignInc Sydney Pty Limited

This drawing is protected by copyright. All rights are reserved. Unless permitted under the Copyright Act 1968, no part of this drawing may in any form or by any means be reproduced, published, broadcast or transmitted without the prior written permission of the copyright owner.

**Please note**

If the Status of this drawing is not signed off For Construction it may be subject to change, alteration or amendment at the discretion of DesignInc Sydney Pty Limited. If so, DesignInc Sydney Pty Limited is not liable for any loss, damage, harm or injury whether special, consequential, direct or indirect, suffered by you or any other person as a result of your use of this drawing for construction purposes.

Figured dimensions take preference to scale readings. Verify all dimensions on site. Report any discrepancies to the Architect for decision before proceeding with the work.

**Nominated Architects**

Anthony Quan 5421 | Sandeep Amin 7337 | Ian Armstrong 7260 | Richard Does 8126

No	DATE	REVISIONS	BY
A	04/05/2018	ISSUED FOR DEVELOPMENT APPROVAL	TG
B	07/05/2018	ISSUED FOR DEVELOPMENT APPROVAL	TG

ARCHITECT

**DesignInc | Lacoste + Stevenson | bmc2**

architects in association

**DesignInc Sydney** PTY LIMITED ACN 003008820  
L12 / 77 PACIFIC HWY NORTH SYDNEY NSW 2060 AUSTRALIA  
PO BOX 651 NORTH SYDNEY NSW 2059 AUSTRALIA  
T +612 8905 7100 F +612 8905 7199  
E sydney@sydneydesigninc.com.au www.designinc.com.au

**Architecture Urban Design Interiors**

CLIENT

**SCHOOL INFRASTRUCTURE NSW**

PROJECT

**LINDFIELD LEARNING VILLAGE**  
Eton Road,  
Lindfield NSW 2070

TITLE

**CONSTRUCTION STAGING PLAN - LEVEL 6**

**N**

**DRAWN BY**

TG, CS, HC, RK

**SCALES**

1 : 1000 @A3

**PLOT DATE**

26/04/2018

PROJECT N°	S151441	REVISION
DRAWING N°	DA-126	B

DRAWING STATUS	REVIEWED BY	SIGNATURE	DATE
FOR APPROVAL	RG		

**QUALITY CERTIFIED ISO 9001**

Completion of the Drawing Status is evidence the design has been verified as conforming to the requirements of the Project M.S. Plan. Initiating the 'Drawn By' box confirms that this drawing has been prepared in conformity with DesignInc Sydney M.S. procedures.

**DEVELOPMENT APPLICATION**

DRAWING TO BE PRINTED IN COLOUR



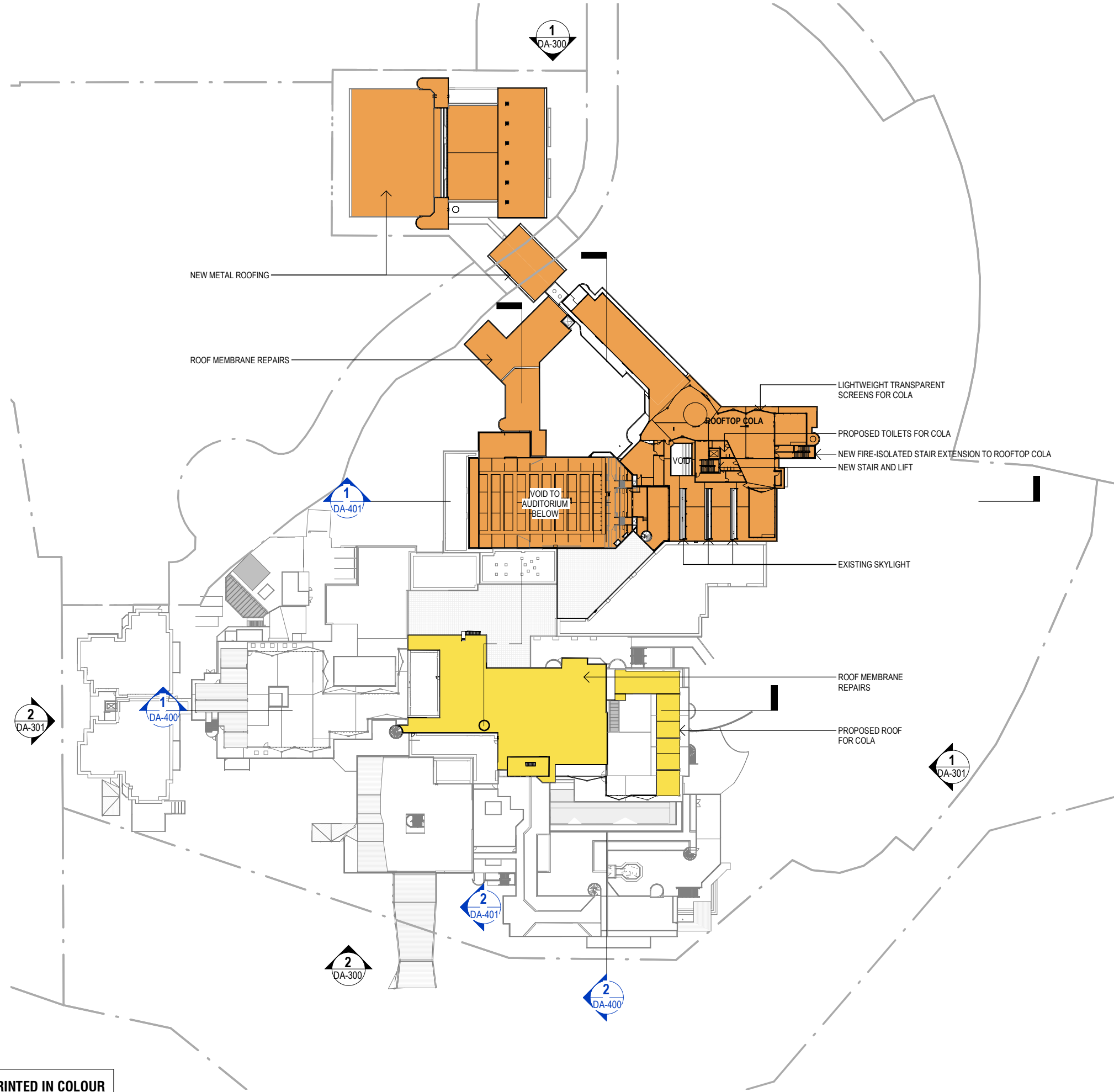

**STAGING LEGEND**

- STAGE 1 - PHASE 1
- STAGE 1 - PHASE 2A
- STAGE 1 - PHASE 2B
- STAGE 2 - PHASE 3

DRAWING TO BE PRINTED IN COLOUR

Copyright DesignInc Sydney Pty Limited

This drawing is protected by copyright. All rights are reserved. Unless permitted under the Copyright Act 1968, no part of this drawing may in any form or by any means be reproduced, published, broadcast or transmitted without the prior written permission of the copyright owner.

**Please note**

If the Status of this drawing is not signed off For Construction it may be subject to change, alteration or amendment at the discretion of DesignInc Sydney Pty Limited. If so, DesignInc Sydney Pty Limited is not liable for any loss, damage, harm or injury whether special, consequential, direct or indirect, suffered by you or any other person as a result of your use of this drawing for construction purposes.

Figured dimensions take preference to scale readings. Verify all dimensions on site. Report any discrepancies to the Architect for decision before proceeding with the work.

**Nominated Architects**

Anthony Quan 5421 | Sandeep Amin 7337 | Ian Armstrong 7260 | Richard Does 8126

No	DATE	REVISIONS	BY
A	04/05/2018	ISSUED FOR DEVELOPMENT APPROVAL	TG
B	07/05/2018	ISSUED FOR DEVELOPMENT APPROVAL	TG

ARCHITECT

**DesignInc | Lacoste + Stevenson | bmc2**

architects in association

**DesignInc Sydney** PTY LIMITED ACN 003008820  
L12 / 77 PACIFIC HWY NORTH SYDNEY NSW 2060 AUSTRALIA  
PO BOX 651 NORTH SYDNEY NSW 2059 AUSTRALIA  
T +612 8905 7100 F +612 8905 7199  
E sydney@sydney.designinc.com.au www.designinc.com.au

**Architecture Urban Design Interiors**

CLIENT

**SCHOOL INFRASTRUCTURE NSW**

PROJECT

**LINDFIELD LEARNING VILLAGE**  
Eton Road,  
Lindfield NSW 2070

TITLE

**CONSTRUCTION STAGING PLAN - LEVEL 7**

**N**

**DRAWN BY**

TG, CS, HC, RK

**SCALES**

1 : 1000 @A3

**PLOT DATE**

26/04/2019

PROJECT N°.	S151441	REVISION
DRAWING N°.	DA-127	B

DRAWING STATUS	REVIEWED BY	SIGNATURE	DATE
FOR APPROVAL	RG		

**QUALITY CERTIFIED ISO 9001**

Completion of the Drawing Status is evidence the design has been verified as conforming to the requirements of the Project M.S. Plan. Initiating the 'Drawn By' box confirms that this drawing has been prepared in conformity with DesignInc Sydney M.S. procedures.

**DEVELOPMENT APPLICATION**

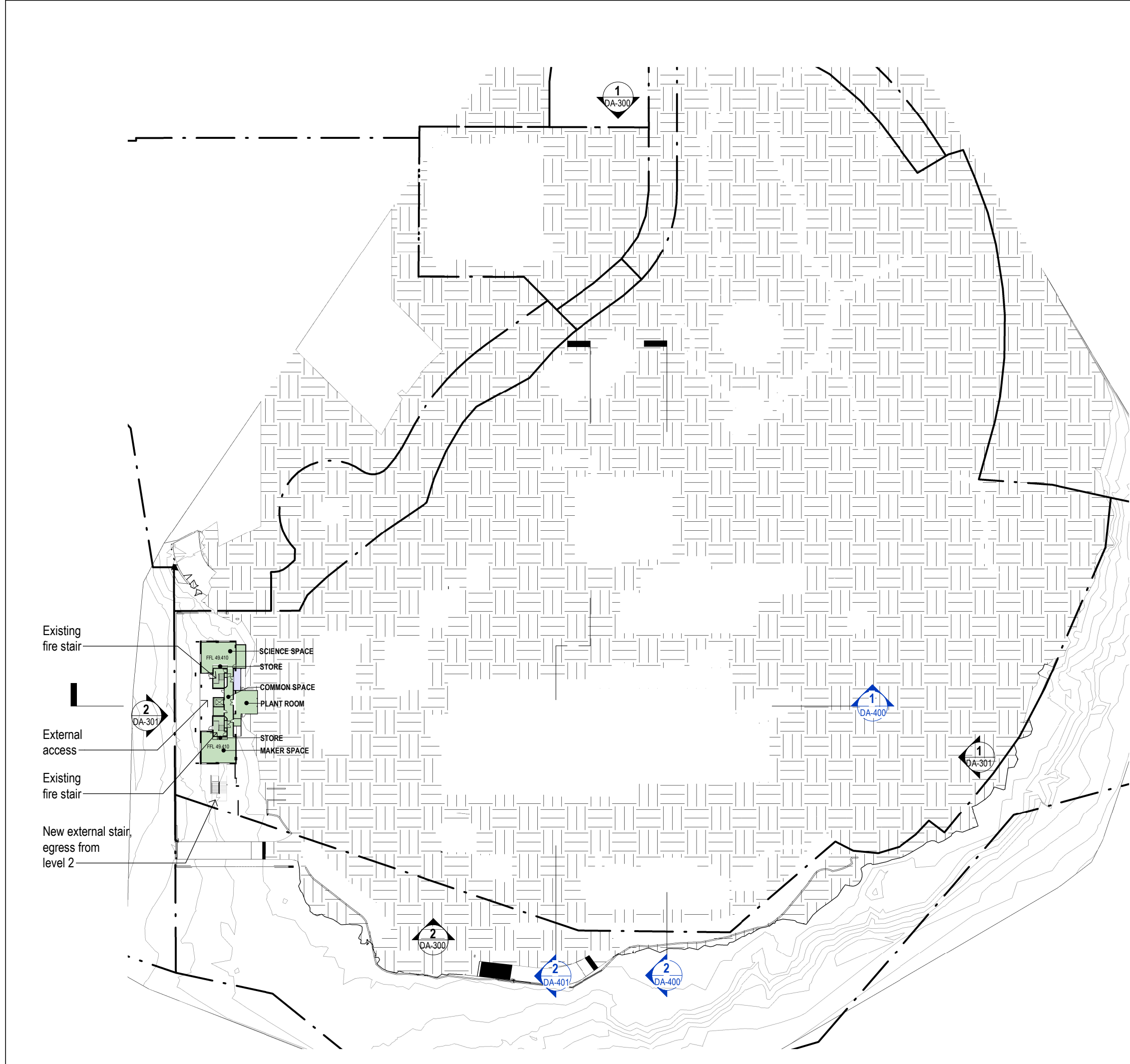

ABBREVIATIONS LEGEND

AS	APARATUS STORE
IR	INTERVIEW ROOM
K	KINDERGARTEN
PAA	PRACTICAL ACTIVITIES AREA
PES	PERSONAL EFFECTS STORE
SGL	SCIENCE GENERAL LEARNING
STR	STORE/STORAGE
V	VOID
Y	YEAR
YR	YEAR
WDRL	WITHDRAWAL

DEPARTMENT AREAS

ADMINISTRATION
AUDITORIUM
AURORA
CARPARK
CHILD CARE
CIRCULATION
COMMON COLA
DINING
FISH POND
FOOD TEXTILE
FUTURE LEARNING
GYMNASIUM
HOME BASE 1
HOME BASE 2
HOME BASE 3
HOME BASE 4
HOME BASE 5
HOME BASE 6
HOSPITALITY
INTERIM HOMEBASE
MUSIC
OTHER
OUTDOOR PLAY
SCIENCE
SERVICES
STUDENT ADMINISTRATION
VISUAL ARTS
WOOD AND METAL

© Copyright DesignInc Sydney Pty Limited

This drawing is protected by copyright. All rights are reserved. Unless permitted under the Copyright Act 1968, no part of this drawing may in any form or by any means be reproduced, published, broadcast or transmitted without the prior written permission of the copyright owner.

**Please note**

If the Status of this drawing is not signed off For Construction it may be subject to change, alteration or amendment at the discretion of DesignInc Sydney Pty Limited. If so, DesignInc Sydney Pty Limited is not liable for any loss, damage, harm or injury whether special, consequential, direct or indirect, suffered by you or any other person as a result of your use of this drawing for construction purposes.

Figured dimensions take preference to scale readings. Verify all dimensions on site. Report any discrepancies to the Architect for decision before proceeding with the work.

**Nominated Architects**

Anthony Quan 5421 | Sandeep Amin 7337 | Ian Armstrong 7260 | Richard Does 8126

No	DATE	REVISIONS	BY
A	27/03/2017	PRELIMINARY ISSUE FOR REVIEW	HC
B	28/03/2017	PRELIMINARY ISSUE	HC
C	31/03/2017	ISSUED FOR APPROVAL	HC
D	07/04/2017	ISSUED FOR DEVELOPMENT APPLICATION	HC
E	29/05/2017	ISSUED FOR APPROVAL	CS
F	27/10/2017	SSD RESUBMISSION	TG
G	30/04/2018	ISSUED FOR REVIEW	HC
H	04/05/2018	ISSUED FOR DEVELOPMENT APPROVAL	TG

ARCHITECT	<b>DesignInc   Lacoste + Stevenson   bmc2</b> architects in association
	<b>DesignInc Sydney</b> PTY LIMITED ACN 003008820 L12 / 77 PACIFIC HWY NORTH SYDNEY NSW 2060 AUSTRALIA PO BOX 651 NORTH SYDNEY NSW 2059 AUSTRALIA T +612 8905 7100 F +612 8905 7199 E sydney@sydney.designinc.com.au www.designinc.com.au Architecture Urban Design Interiors

CLIENT	<b>SCHOOL INFRASTRUCTURE NSW</b>
--------	----------------------------------

PROJECT	<b>LINDFIELD LEARNING VILLAGE</b> Eton Road, Lindfield NSW 2070
---------	---

TITLE	<b>PHASE 2 &amp; 3 - PROPOSED FLOOR PLAN LEVEL 0</b>
-------	--

<b>N</b> 	DRAWN BY	TG, CS, HC, RK		
	SCALES	1:1000 @A3		
	PLOT DATE	21/03/2017		
	PROJECT N°	S151441	REVISION	H
	DRAWING N°	DA-200		
	DRAWING STATUS FOR APPROVAL	REVIEWED BY RG	SIGNATURE	DATE
	QUALITY CERTIFIED ISO 9001 Completion of the Drawing Status is evidence the design has been verified as conforming to the requirements of the Project M.S. Plans. Initiating the 'Drawn By' box confirms that this drawing has been prepared in conformity with DesignInc Sydney M.S. procedures.			
	<b>DEVELOPMENT APPLICATION</b>			



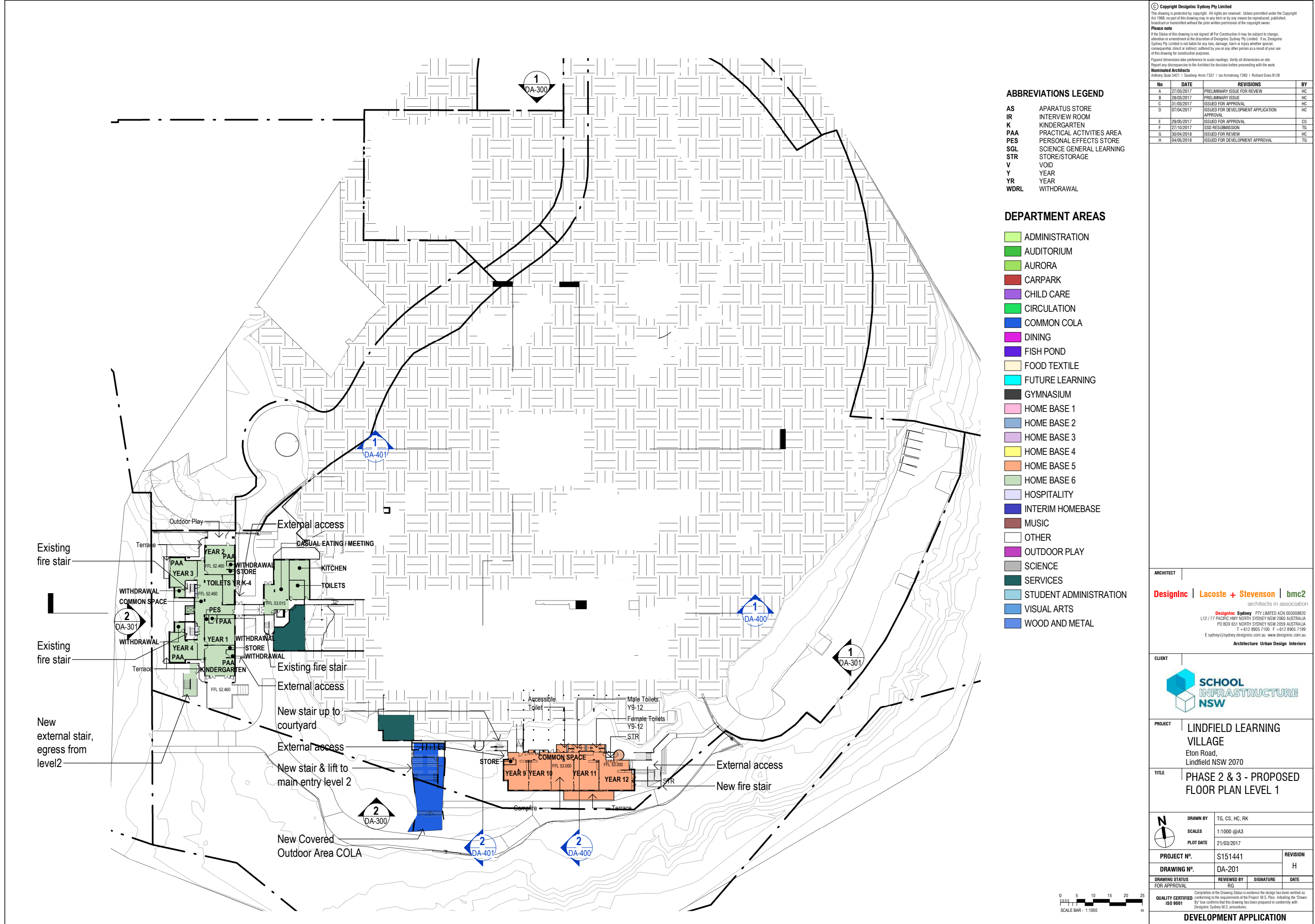

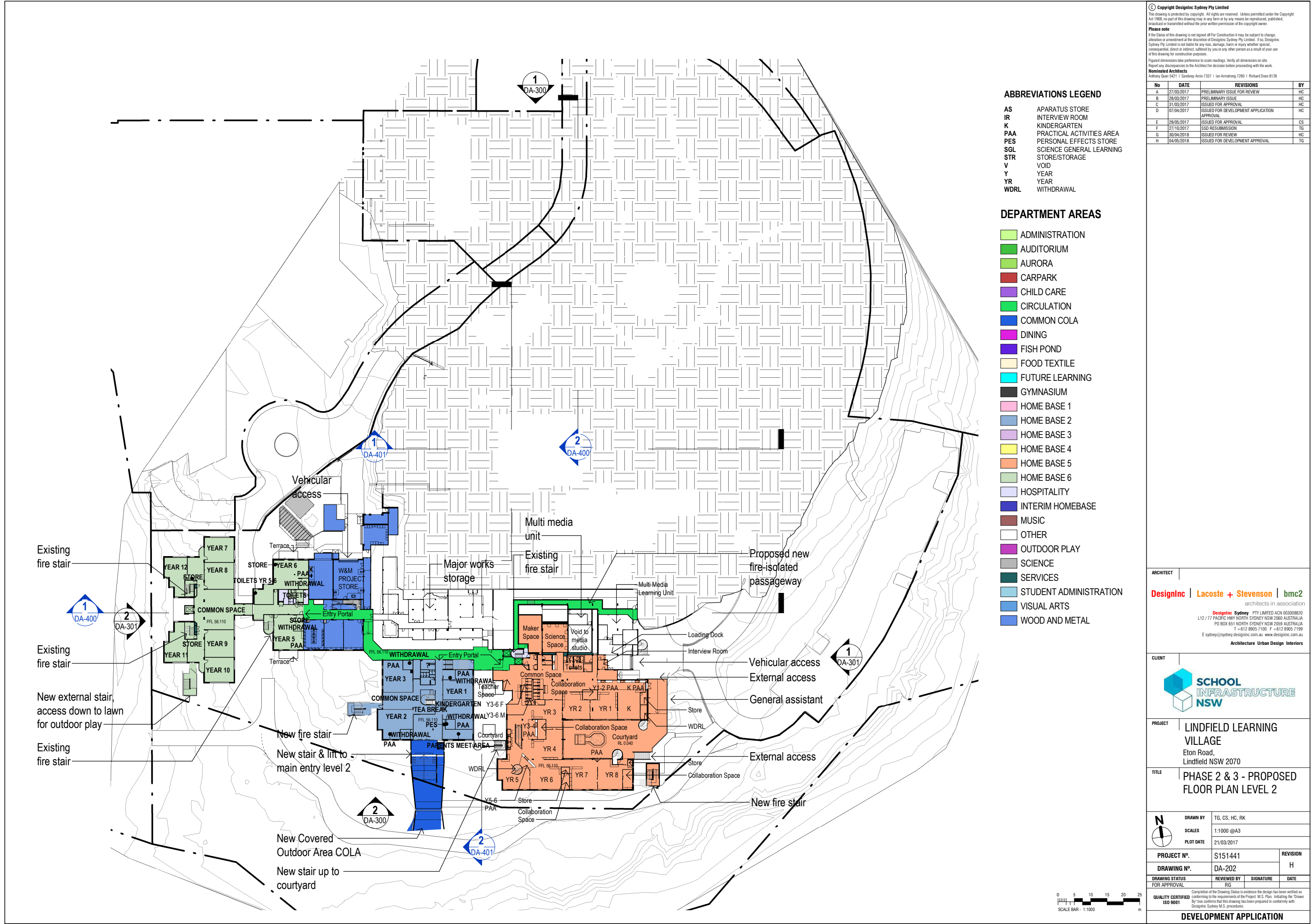

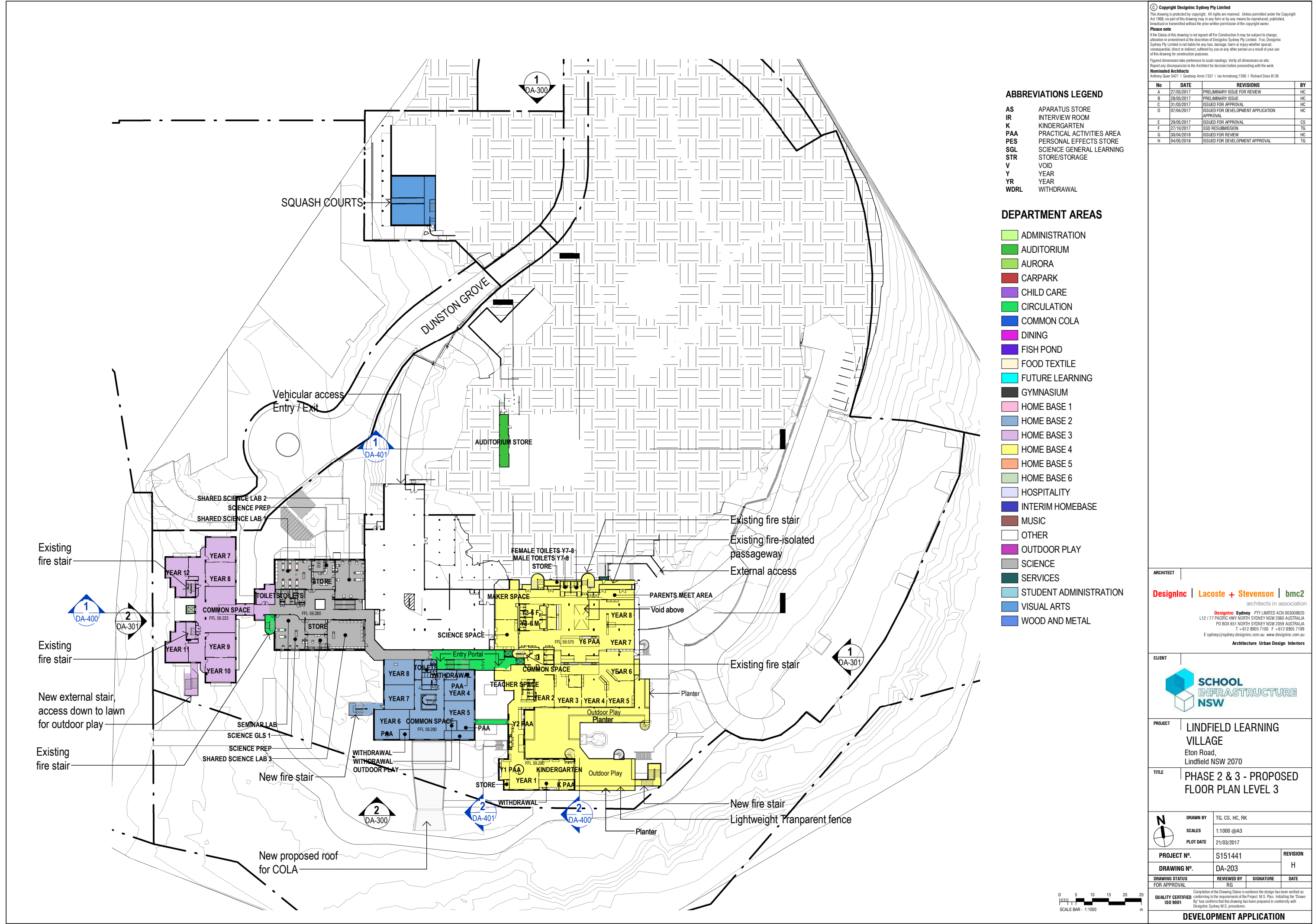

ABBREVIATIONS LEGEND

AS	APARATUS STORE
IR	INTERVIEW ROOM
K	KINDERGARTEN
PAA	PRACTICAL ACTIVITIES AREA
PES	PERSONAL EFFECTS STORE
SGL	SCIENCE GENERAL LEARNING
STR	STORE/STORAGE
V	VOID
Y	YEAR
YR	YEAR
WDRL	WITHDRAWAL

DEPARTMENT AREAS

	ADMINISTRATION
	AUDITORIUM
	AURORA
	CARPARK
	CHILD CARE
	CIRCULATION
	COMMON COLA
	DINING
	FISH POND
	FOOD TEXTILE
	FUTURE LEARNING
	GYMNASIUM
	HOME BASE 1
	HOME BASE 2
	HOME BASE 3
	HOME BASE 4
	HOME BASE 5
	HOME BASE 6
	HOSPITALITY
	INTERIM HOMEBASE
	MUSIC
	OTHER
	OUTDOOR PLAY
	SCIENCE
	SERVICES
	STUDENT ADMINISTRATION
	VISUAL ARTS
	WOOD AND METAL

© Copyright Designinc Sydney Pty Limited

This drawing is protected by copyright. All rights are reserved. Unless permitted under the Copyright Act 1968, no part of this drawing may in any form or by any means be reproduced, published, broadcast or transmitted without the prior written permission of the copyright owner.

**Please note**

If the Status of this drawing is not signed off For Construction it may be subject to change, alteration or amendment at the discretion of Designinc Sydney Pty Limited. If so, Designinc Sydney Pty Limited is not liable for any loss, damage, harm or injury whether special, consequential, direct or indirect, suffered by you or any other person as a result of your use of this drawing for construction purposes.

Figured dimensions take preference to scale readings. Verify all dimensions on site. Report any discrepancies to the Architect for decision before proceeding with the work.

**Nominated Architects**  
Anthony Quan 5421 | Sandeep Amin 7337 | Ian Armstrong 7260 | Richard Does 8126

No	DATE	REVISIONS	BY
A	27/03/2017	PRELIMINARY ISSUE FOR REVIEW	HC
B	28/03/2017	PRELIMINARY ISSUE	HC
C	31/03/2017	ISSUED FOR APPROVAL	HC
D	07/04/2017	ISSUED FOR DEVELOPMENT APPLICATION	HC
E	29/05/2017	ISSUED FOR APPROVAL	CS
F	27/10/2017	SSD RESUBMISSION	TG
G	30/04/2018	ISSUED FOR REVIEW	HC
H	04/05/2018	ISSUED FOR DEVELOPMENT APPROVAL	TG

ARCHITECT	<b>DesignInc   Lacoste + Stevenson   bmc2</b> architects in association <small>Designinc Sydney PTY LIMITED ACN 003008820 L12 / 77 PACIFIC HWY NORTH SYDNEY NSW 2060 AUSTRALIA PO BOX 651 NORTH SYDNEY NSW 2059 AUSTRALIA T +612 8905 7100 F +612 8905 7199 E sydney@sydneydesigninc.com.au www.designinc.com.au Architecture Urban Design Interiors</small>
-----------	--

CLIENT	<b>SCHOOL INFRASTRUCTURE NSW</b>
--------	----------------------------------

PROJECT	<b>LINDFIELD LEARNING VILLAGE</b> Eton Road, Lindfield NSW 2070
---------	---

TITLE	<b>PHASE 2 &amp; 3 - PROPOSED FLOOR PLAN LEVEL 3</b>
-------	--

<b>N</b> 	DRAWN BY	TG, CS, HC, RK	
	SCALES	1:1000 @A3	
	PLOT DATE	21/03/2017	
	PROJECT N°	S151441	REVISION
	DRAWING N°	DA-203	H
	DRAWING STATUS	FOR APPROVAL	
	REVIEWED BY	RG	SIGNATURE
			DATE
QUALITY CERTIFIED ISO 9001	Completion of the Drawing Status is evidence the design has been verified as conforming to the requirements of the Project M.S. Plan. Initiating the 'Drawn By' box confirms that this drawing has been prepared in conformity with Designinc Sydney M.S. procedures.		
<b>DEVELOPMENT APPLICATION</b>			



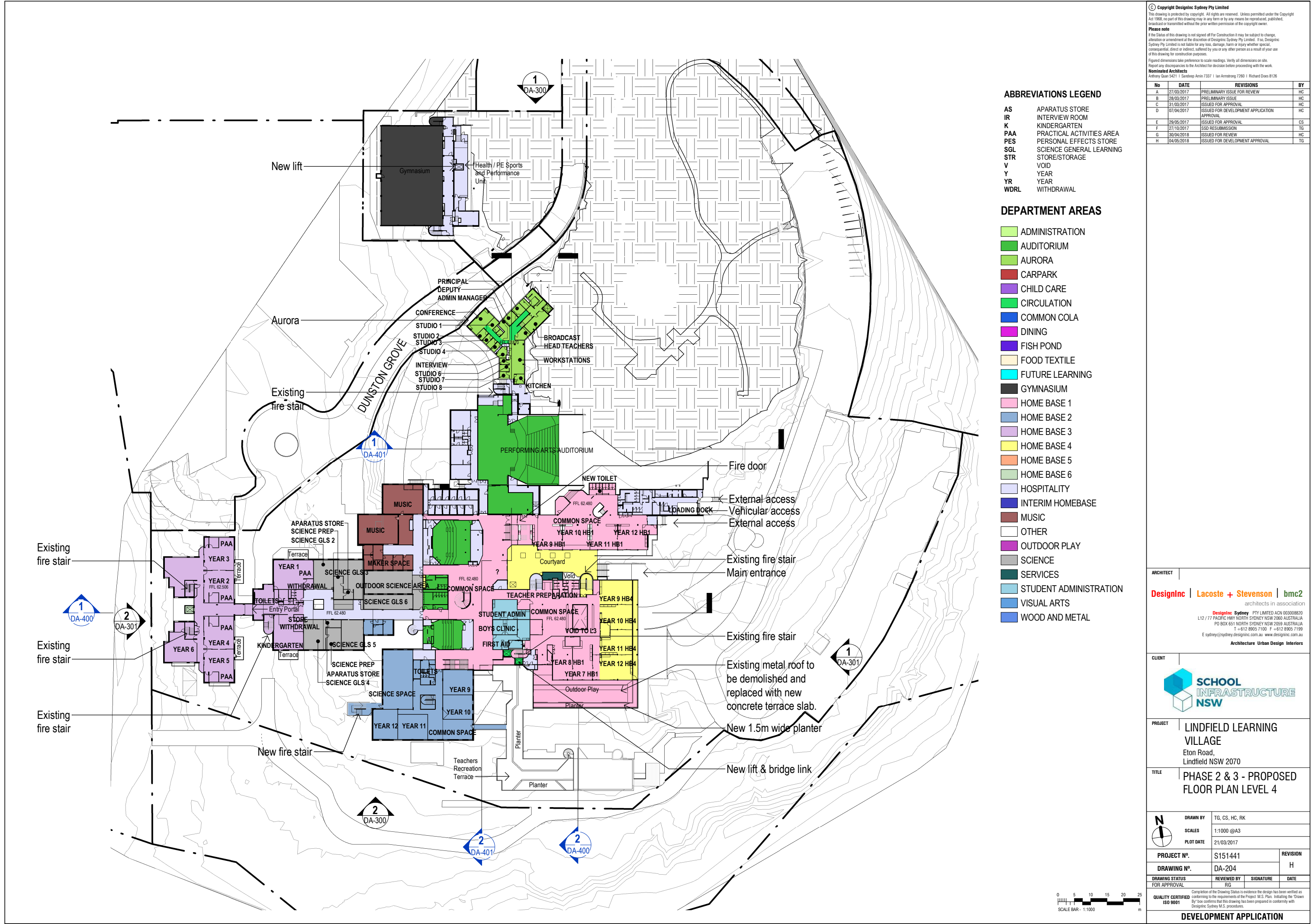

**ABBREVIATIONS LEGEND**

AS	APARATUS STORE
IR	INTERVIEW ROOM
K	KINDERGARTEN
PAA	PRACTICAL ACTIVITIES AREA
PES	PERSONAL EFFECTS STORE
SGL	SCIENCE GENERAL LEARNING
STR	STORE/STORAGE
V	VOID
Y	YEAR
YR	YEAR
WDRL	WITHDRAWAL

**DEPARTMENT AREAS**

ADMINISTRATION
AUDITORIUM
AURORA
CARPARK
CHILD CARE
CIRCULATION
COMMON COLA
DINING
FISH POND
FOOD TEXTILE
FUTURE LEARNING
GYMNASIUM
HOME BASE 1
HOME BASE 2
HOME BASE 3
HOME BASE 4
HOME BASE 5
HOME BASE 6
HOSPITALITY
INTERIM HOMEBASE
MUSIC
OTHER
OUTDOOR PLAY
SCIENCE
SERVICES
STUDENT ADMINISTRATION
VISUAL ARTS
WOOD AND METAL

**Copyright DesignInc Sydney Pty Limited**  
This drawing is protected by copyright. All rights are reserved. Unless permitted under the Copyright Act 1968, no part of this drawing may in any form or by any means be reproduced, published, broadcast or transmitted without the prior written permission of the copyright owner.  
**Please note**  
If the Status of this drawing is not signed off For Construction it may be subject to change, alteration or amendment at the discretion of DesignInc Sydney Pty Limited. If so, DesignInc Sydney Pty Limited is not liable for any loss, damage, harm or injury whether special, consequential, direct or indirect, suffered by you or any other person as a result of your use of this drawing for construction purposes.  
Figured dimensions take preference to scale readings. Verify all dimensions on site.  
Report any discrepancies to the Architect for decision before proceeding with the work.  
**Nominated Architects**  
Anthony Quan 5421 | Sandeep Amin 7337 | Ian Armstrong 7260 | Richard Does 8126

No	DATE	REVISIONS	BY
A	27/03/2017	PRELIMINARY ISSUE FOR REVIEW	HC
B	28/03/2017	PRELIMINARY ISSUE	HC
C	31/03/2017	ISSUED FOR APPROVAL	HC
D	07/04/2017	ISSUED FOR DEVELOPMENT APPLICATION	HC
E	29/05/2017	ISSUED FOR APPROVAL	CS
F	27/10/2017	SSD RESUBMISSION	TG
G	30/04/2018	ISSUED FOR REVIEW	HC
H	04/05/2018	ISSUED FOR DEVELOPMENT APPROVAL	TG

**ARCHITECT**  
**DesignInc | Lacoste + Stevenson | bmc2**  
architects in association  
**DesignInc Sydney** PTY LIMITED ACN 003008820  
L12 / 77 PACIFIC HWY NORTH SYDNEY NSW 2060 AUSTRALIA  
PO BOX 651 NORTH SYDNEY NSW 2059 AUSTRALIA  
T +612 8905 7100 F +612 8905 7199  
E sydney@sydney.designinc.com.au www.designinc.com.au  
Architecture Urban Design Interiors

**CLIENT**  
**SCHOOL INFRASTRUCTURE NSW**

**PROJECT**  
**LINDFIELD LEARNING VILLAGE**  
Eton Road,  
Lindfield NSW 2070

**TITLE**  
**PHASE 2 & 3 - PROPOSED FLOOR PLAN LEVEL 4**

<b>DRAWN BY</b> TG, CS, HC, RK	<b>REVISION</b> H
<b>SCALES</b> 1:1000 @A3	
<b>PLOT DATE</b> 21/03/2017	
<b>PROJECT N°</b> S151441	
<b>DRAWING N°</b> DA-204	
<b>DRAWING STATUS</b> FOR APPROVAL	<b>REVIEWED BY</b> RG
<b>SIGNATURE</b>	<b>DATE</b>

**QUALITY CERTIFIED ISO 9001**  
Completion of the Drawing Status is evidence the design has been verified as conforming to the requirements of the Project M.S. Plan. Initiating the 'Drawn By' box confirms that this drawing has been prepared in conformity with DesignInc Sydney M.S. procedures.

**DEVELOPMENT APPLICATION**

PLOTTED 8/05/2018 9:39:38 AM C:\Users\kwok\Documents\S151441-AR-LLV-SHEETS\_CENTRAL\_R18\_rkwok.rvt

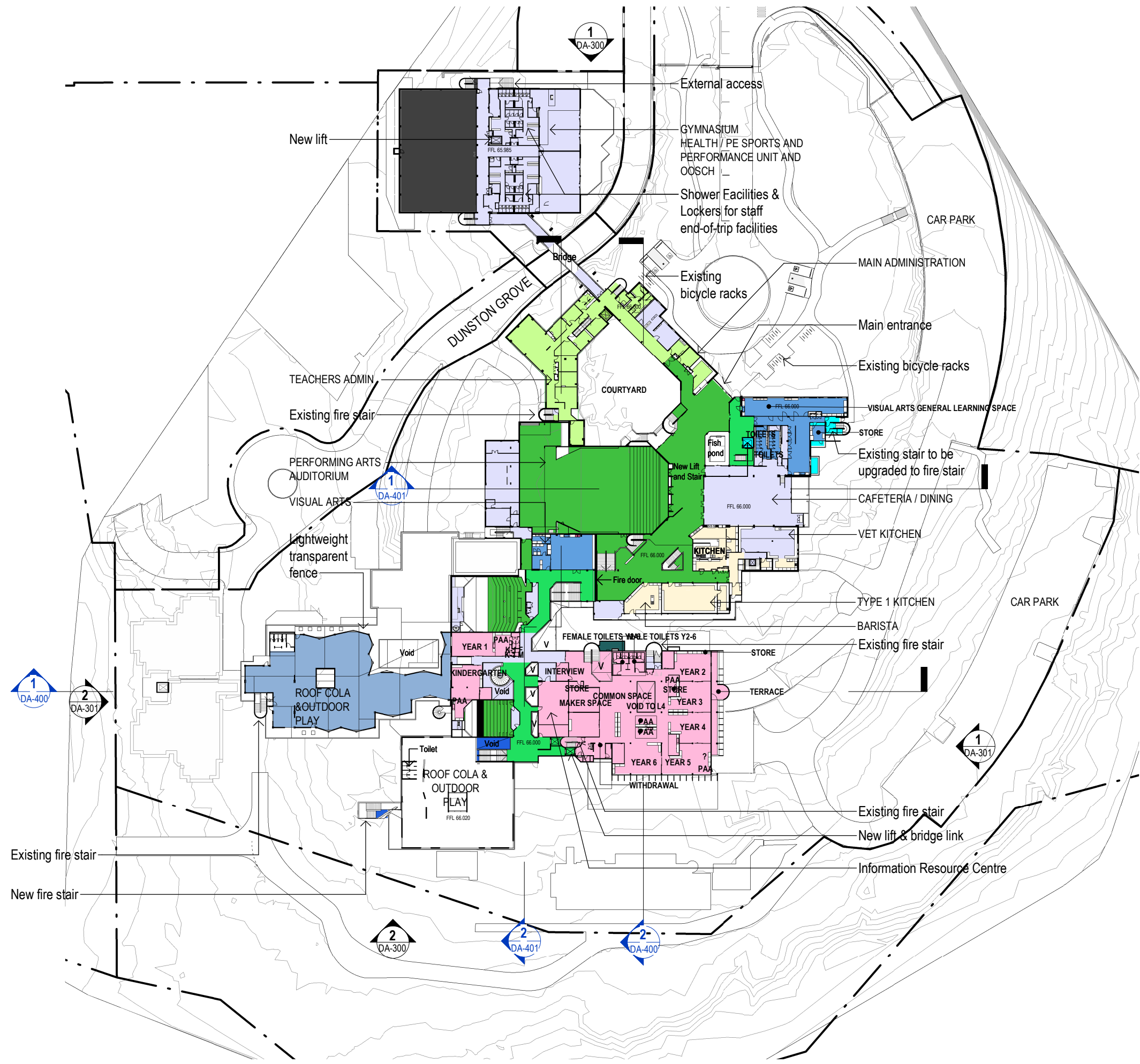

- ABBREVIATIONS LEGEND**
- AS APARATUS STORE
  - IR INTERVIEW ROOM
  - K KINDERGARTEN
  - PAA PRACTICAL ACTIVITIES AREA
  - PES PERSONAL EFFECTS STORE
  - SGL SCIENCE GENERAL LEARNING
  - STR STORE/STORAGE
  - V VOID
  - Y YEAR
  - YR YEAR
  - WDRL WITHDRAWAL
- DEPARTMENT AREAS**
- ADMINISTRATION
  - AUDITORIUM
  - AURORA
  - CARPARK
  - CHILD CARE
  - CIRCULATION
  - COMMON COLA
  - DINING
  - FISH POND
  - FOOD TEXTILE
  - FUTURE LEARNING
  - GYMNASIUM
  - HOME BASE 1
  - HOME BASE 2
  - HOME BASE 3
  - HOME BASE 4
  - HOME BASE 5
  - HOME BASE 6
  - HOSPITALITY
  - INTERIM HOMEBASE
  - MUSIC
  - OTHER
  - OUTDOOR PLAY
  - SCIENCE
  - SERVICES
  - STUDENT ADMINISTRATION
  - VISUAL ARTS
  - WOOD AND METAL

© Copyright Designinc Sydney Pty Limited  
This drawing is protected by copyright. All rights are reserved. Unless permitted under the Copyright Act 1968, no part of this drawing may in any form or by any means be reproduced, published, broadcast or transmitted without the prior written permission of the copyright owner.

**Please note**  
If the Status of this drawing is not signed off For Construction it may be subject to change, alteration or amendment at the discretion of Designinc Sydney Pty Limited. If so, Designinc Sydney Pty Limited is not liable for any loss, damage, harm or injury whether special, consequential, direct or indirect, suffered by you or any other person as a result of your use of this drawing for construction purposes.  
Figured dimensions take preference to scale readings. Verify all dimensions on site.  
Report any discrepancies to the Architect for decision before proceeding with the work.

**Nominated Architects**  
Anthony Quan 5421 | Sandeep Amin 7337 | Ian Armstrong 7260 | Richard Does 8126

No	DATE	REVISIONS	BY
A	27/03/2017	PRELIMINARY ISSUE FOR REVIEW	HC
B	28/03/2017	PRELIMINARY ISSUE	HC
C	31/03/2017	ISSUED FOR APPROVAL	HC
D	07/04/2017	ISSUED FOR DEVELOPMENT APPLICATION APPROVAL	HC
E	29/05/2017	ISSUED FOR APPROVAL	CS
F	27/10/2017	SSD RESUBMISSION	TG
G	30/04/2018	ISSUED FOR REVIEW	HC
H	04/05/2018	ISSUED FOR DEVELOPMENT APPROVAL	TG

**ARCHITECT**  
**DesignInc | Lacoste + Stevenson | bmc2**  
architects in association  
Designinc Sydney PTY LIMITED ACN 003008820  
L12 / 77 PACIFIC HWY NORTH SYDNEY NSW 2060 AUSTRALIA  
PO BOX 651 NORTH SYDNEY NSW 2059 AUSTRALIA  
T +612 8905 7100 F +612 8905 7199  
E sydney@sydney.designinc.com.au www.designinc.com.au  
Architecture Urban Design Interiors

**CLIENT**  
**SCHOOL INFRASTRUCTURE NSW**

**PROJECT**  
**LINDFIELD LEARNING VILLAGE**  
Eton Road,  
Lindfield NSW 2070

**TITLE**  
**PHASE 2 & 3 - PROPOSED FLOOR PLAN LEVEL 5**

DRAWN BY	TG, CS, HC, RK		
SCALES	1:1000 @A3		
PLOT DATE	21/03/2017		
PROJECT N°	S151441	REVISION	H
DRAWING N°	DA-205		
DRAWING STATUS FOR APPROVAL	REVIEWED BY RG	SIGNATURE	DATE
QUALITY CERTIFIED ISO 9001 Completion of the Drawing Status is evidence the design has been verified as conforming to the requirements of the Project M.S. Plan. Initiating the 'Drawn By' box confirms that this drawing has been prepared in conformity with Designinc Sydney M.S. procedures.			

**DEVELOPMENT APPLICATION**