

Western Precinct Envelope

PROPOSED DEMOLITION

- 1 Demolition of B-Block, three storey existing brick building. Site excavation to the existing Gymnasium floor level.
- 2 Partial demolition of external stairs, landings, walkways and planters in between the Gymnasium, Centenary Hall and the Junior School.
- 3 Demolition of the existing Gymnasium facade

----- PROPOSED DEMOLITION

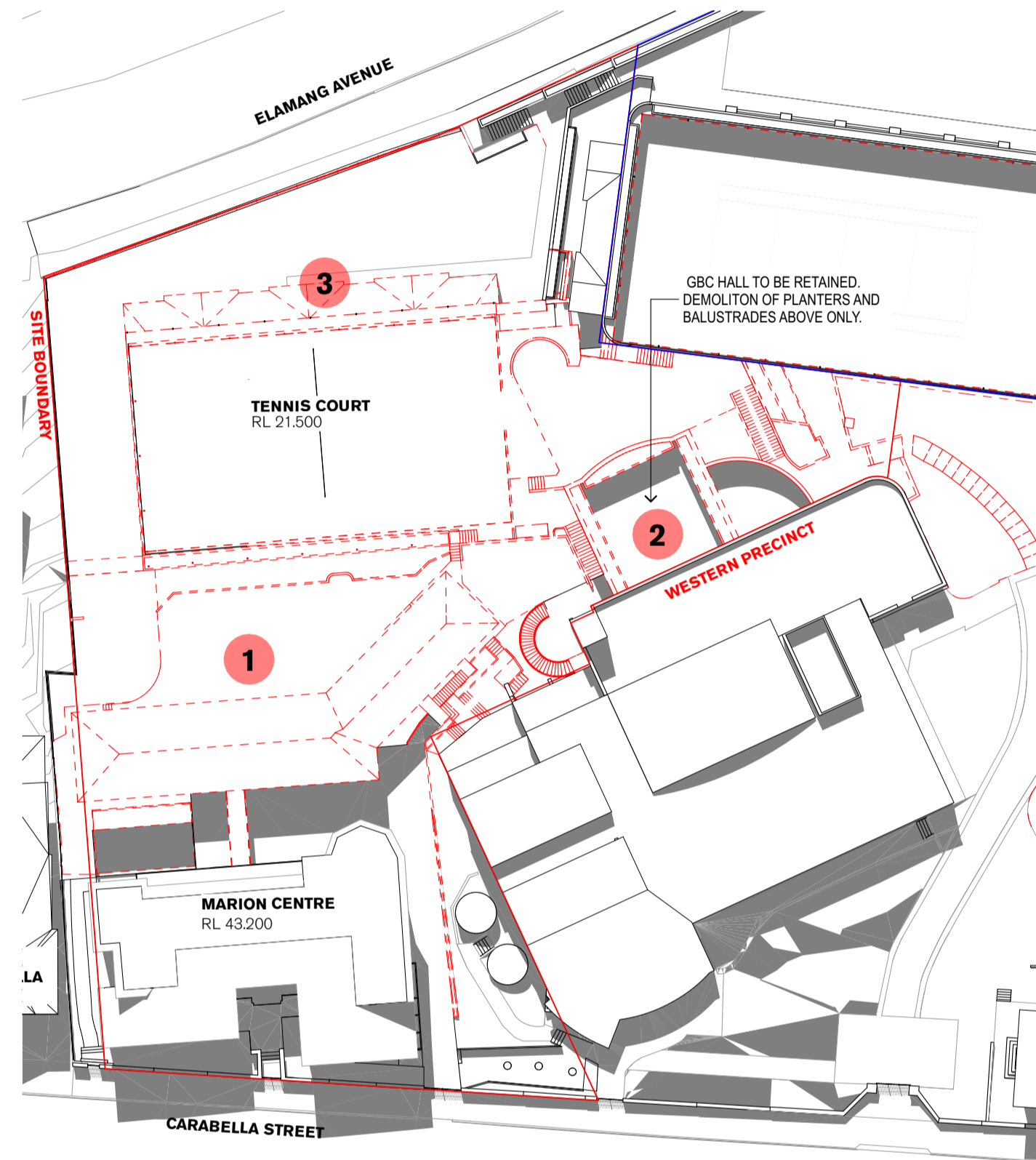

PROPOSED DEVELOPMENT

- 1 Proposed Development Envelope - New Learning Hub. Seven storey building (3 storeys above ground - Carabella Street) including external roof terrace. Includes a vertical connector providing accessible access to the Marian Centre, Junior School, Gymnasium and the Centenary Hall.
- 2 Proposed Development Envelope - Two level extension to the existing Gymnasium
- 3 Proposed Landscaped terrace
- 4 Proposed external landscaped walkways, providing an accessible path of travel to the New Learning Hub. Including an extension to the Junior School play terrace.

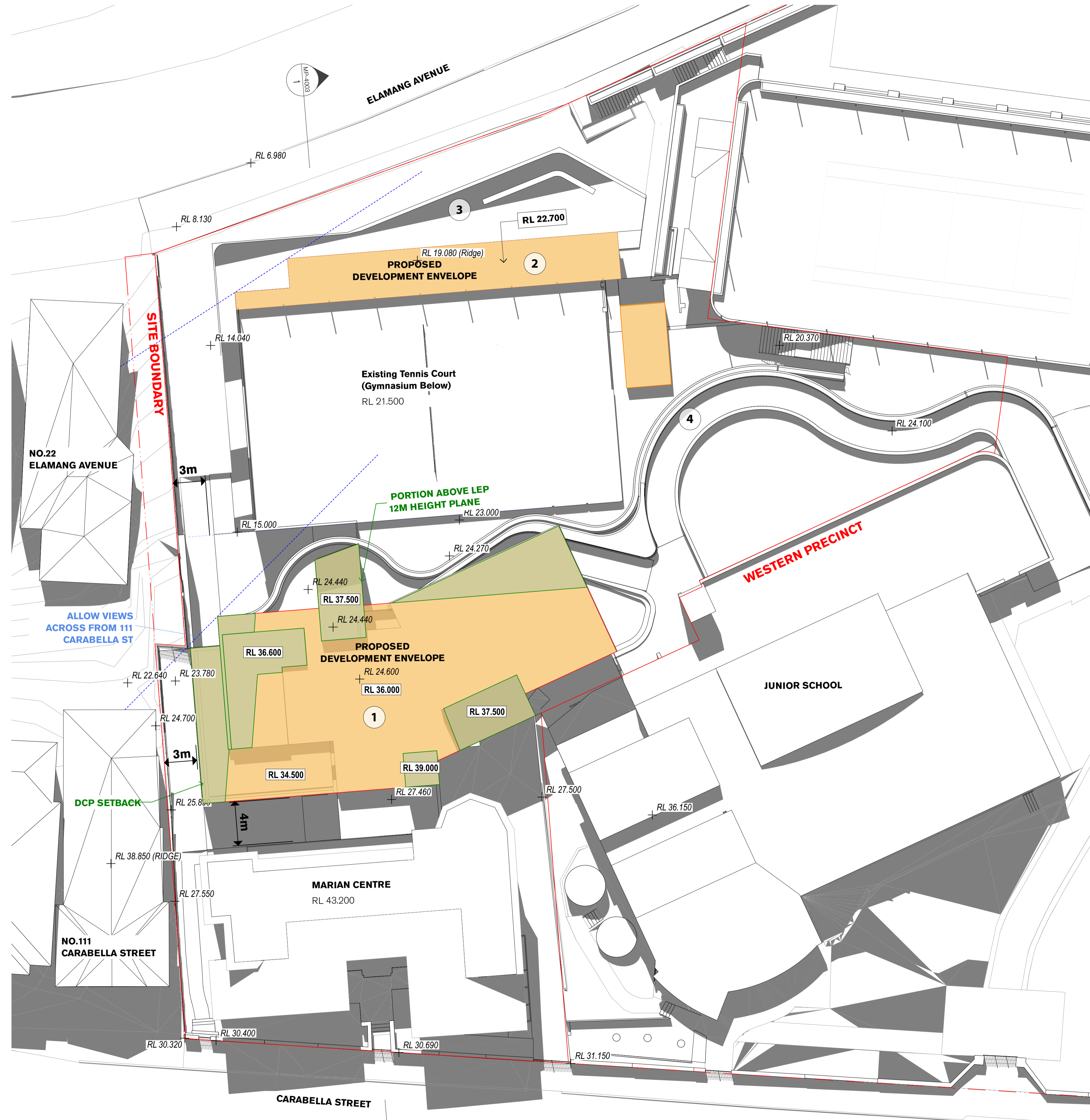

GENERAL NOTES
 ALL DIMENSIONS AND EXISTING CONDITIONS SHALL BE CHECKED AND VERIFIED BY THE CONTRACTOR BEFORE PROCEEDING WITH THE WORK
 ALL LEVELS RELATIVE TO AUSTRALIAN HEIGHT DATUM
 DO NOT SCALE DRAWINGS
 USE FIGURED DIMENSIONS ONLY

Legend

- DEVELOPMENT ENVELOPE
- PORTION ABOVE LEP HEIGHT PLANE AND DCP SIDE BOUNDARY SETBACK
- EXISTING LEVELS (REFER SURVEY)

REV	DATE	DESCRIPTION	BY	CHK
02	21/7/17	SSD Submission	AWY	
01	7/7/17	SSD Submission	KT	

fjmt studio architecture interiors landscape urban community
 sydney melbourne uk
 Level 5, 70 King Street +61 2 9251 7077 www.fjmtstudio.com

project
Master plan
 85 Carabella Street, Kirribilli
 Sydney NSW 2061

title
Envelopes
Western Precinct Envelope

scale	1:200 @ A1	first issued	7/7/17
project code	sheet no.	revision	
LKMP	MP-1106	02	