

Eastern Precinct Plan

PROPOSED DEMOLITION

- 1 Partial demolition of external stairs, landings, walkways and planters in between Science, Elating, Performing Arts and Mary Ward.
- 2 Demolition of Music & Performing Arts and Mary Ward. Excavation to the area at the rear of Araluan House to the carpark on Elating Avenue.

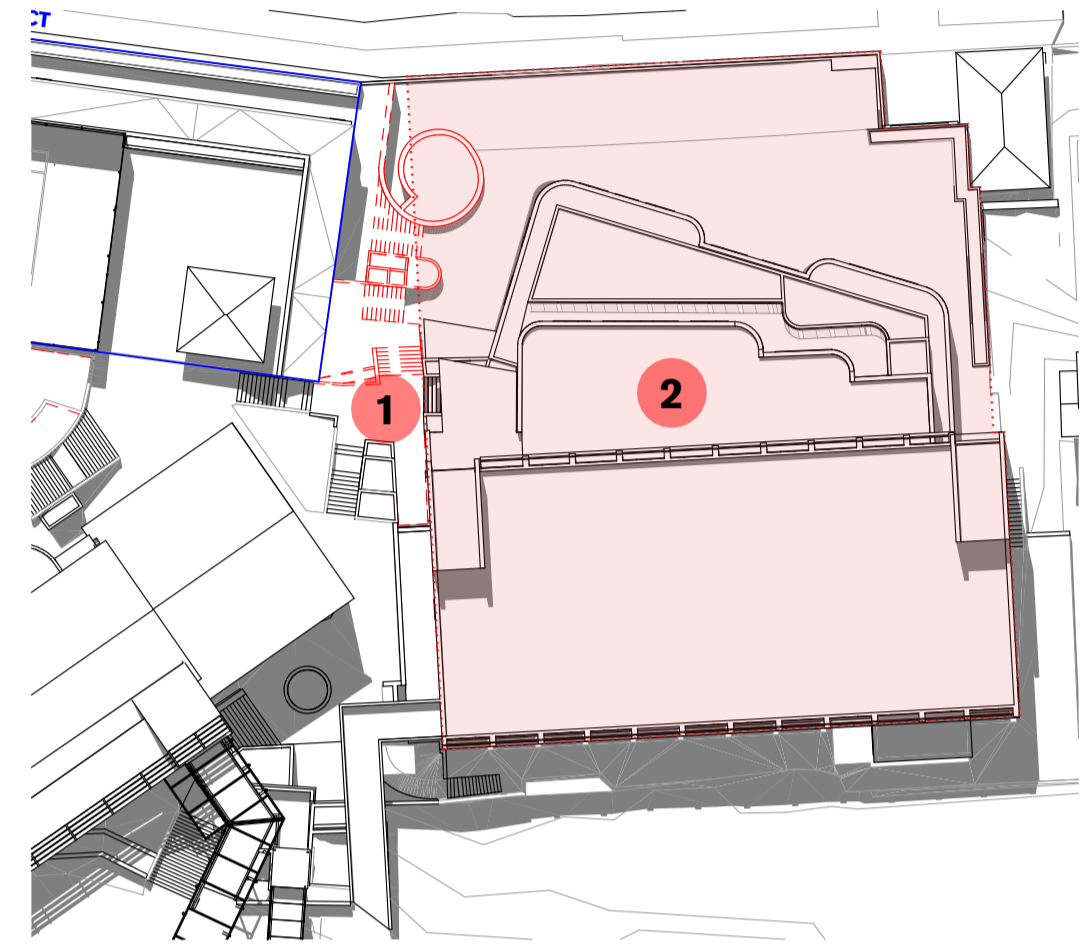

PROPOSED DEMOLITION

PROPOSED DEVELOPMENT

- 1 Proposed envelope for an interim ramp connector, providing an accessible path of travel between Science and Performing Arts.
- 2 Proposed development envelope for a six story building. (Height consistent with the existing building)

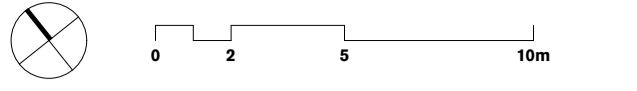
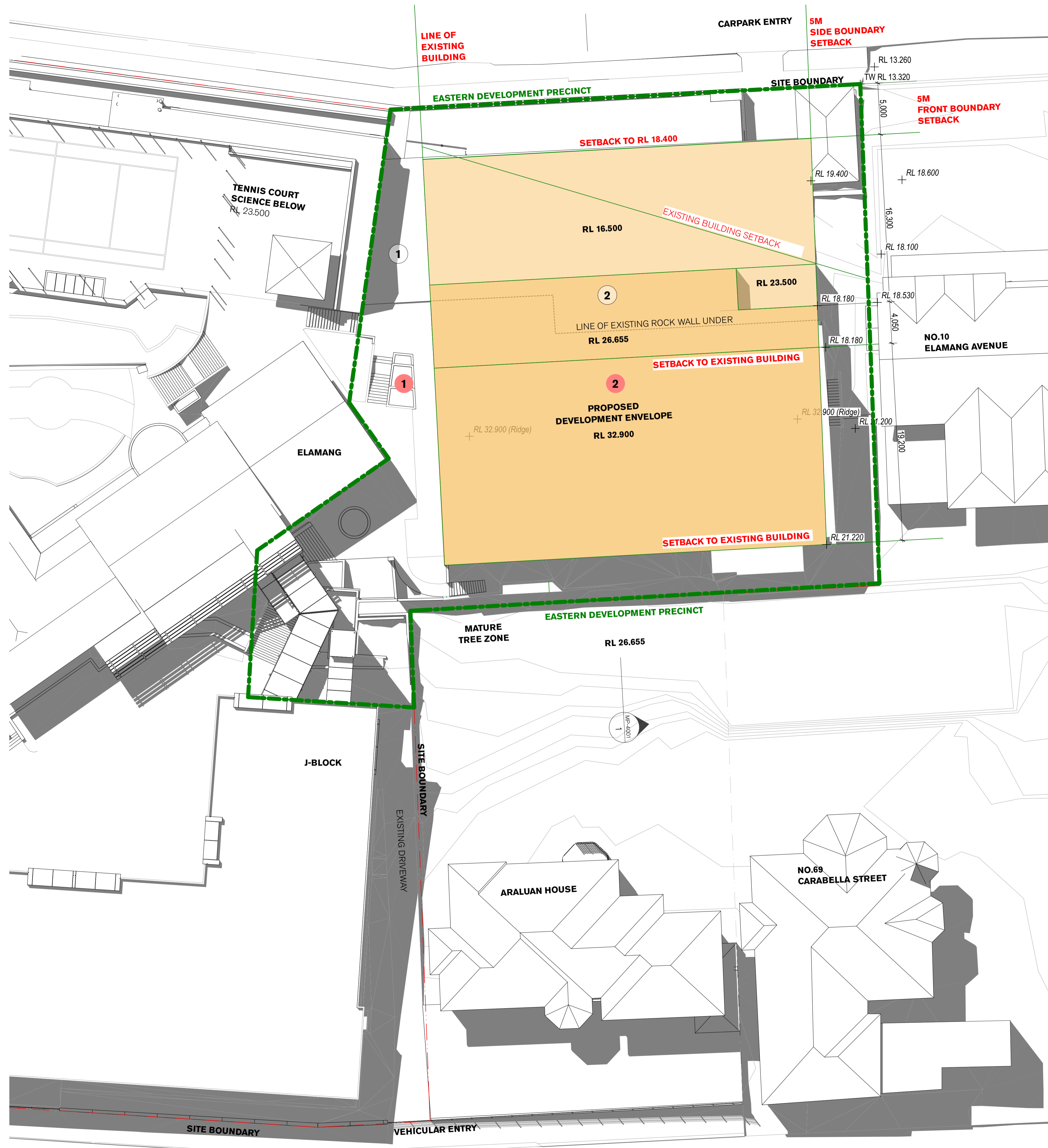

GENERAL NOTES
 ALL DIMENSIONS AND EXISTING CONDITIONS SHALL BE CHECKED AND VERIFIED BY THE CONTRACTOR BEFORE PROCEEDING WITH THE WORK.
 ALL LEVELS RELATIVE TO AUSTRALIAN HEIGHT DATUM.
 DO NOT SCALE DRAWINGS.
 USE FIGURED DIMENSIONS ONLY.

legend

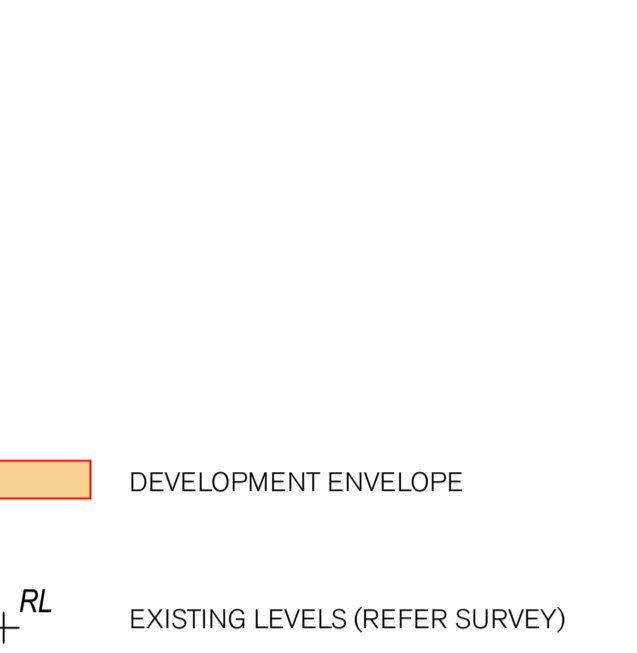

REV	DATE	DESCRIPTION	BY	CHK
02	21/7/17	SSO Submission	AWY	
01	7/7/17	SSO Submission	KT	

fjmt studio architecture interiors landscape urban community
 sydney melbourne uk
 Level 5, 70 King Street +61 2 9251 7077 www.fjmtstudio.com

project
Master plan
 85 Carabella Street, Kirribilli
 Sydney NSW 2061

title
Envelopes
Eastern Precinct Envelope

scale	1:200 @ A1	first issued	7/7/17
project code	sheet no.	revision	
LKMP	MP-1110	02	