

5.0 Figure 4 Bicycle Parking

Government Architect NSW

Comment :
No bicycle parking is provided. The transport and traffic survey showed that no students or staff arrive at school by bicycle, and that the school is very well serviced by public transport. However due to the density of the surrounding residential area street parking is in high demand and therefore all car trips and parking to the school should be discouraged. Bicycle parking and end of trip facilities should be provided.

Response:
Approximately 20 bicycle parking spaces are able to be provided in the existing sports storage area on the lower ground level of Centenary Hall with the end of trip facilities within the adjacent Lower Ground level of the New Learning Hub. Access is able to be provided directly off Elamang Avenue via a stair ramp on the existing stairs.



Figure 2 - Existing access stair from Elamang Avenue



Figure 1 - Proposed access path from Elamang Avenue to School entry point.

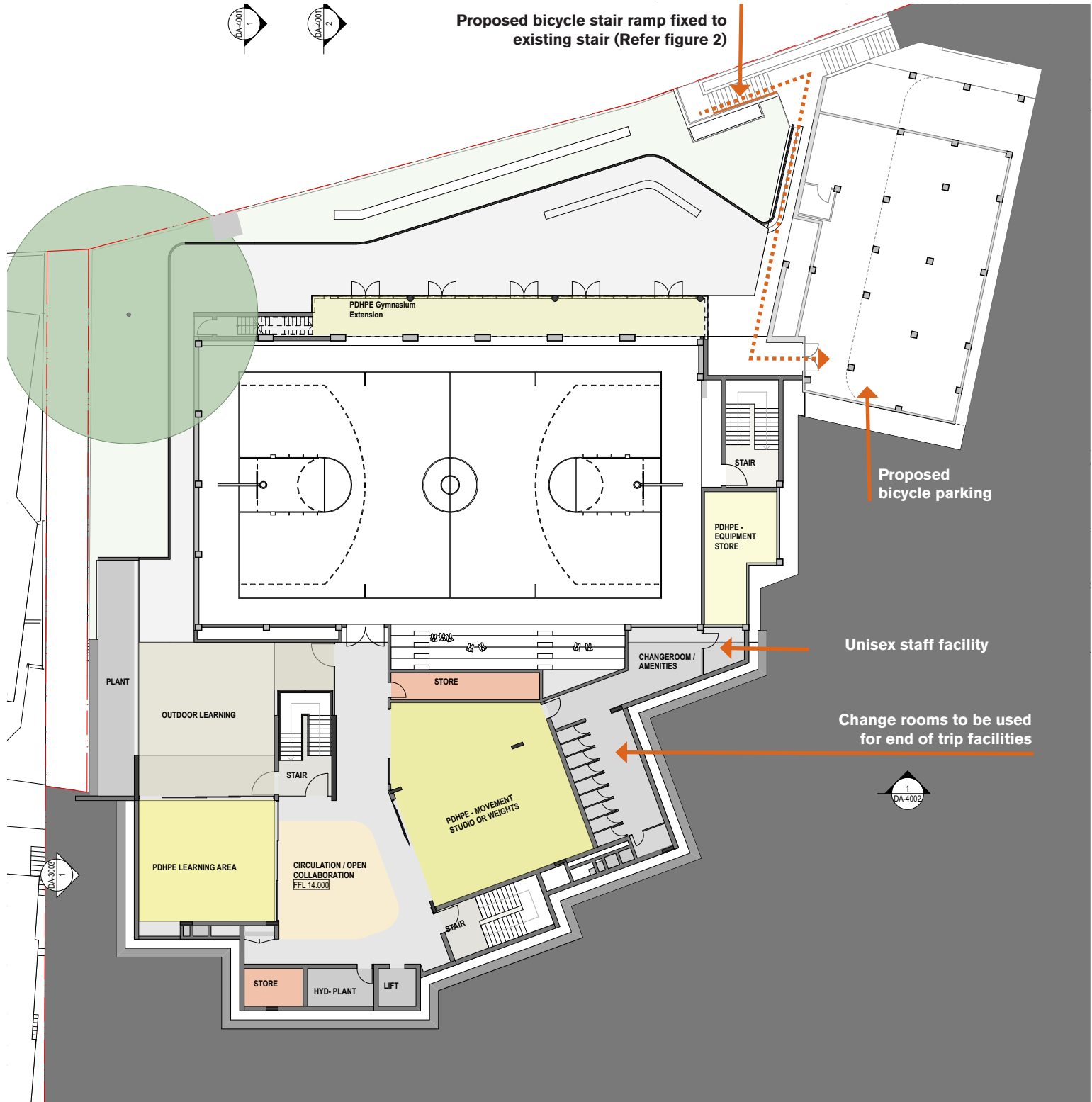

Figure 3 - Proposed Lower Ground Level 4 Plan