



## Report Document Control

**Project:** New Ballina High School  
**Project Ref:** NL150200  
**Document:** NL150200.E04  
**File Location:** NL150200\_E04\_Civil\_Preliminary\_Design\_Report [B].EA

**Client:** Department of Education and Communities (DEC) c/- EJE Architecture  
**Client Contact:** Grant Shultz  
**Client Reference:**

**Title:** Civil Engineering Design (SEARS Report)  
**Author:** Ben Clark

## Revision History

Revision Number	Issue Date	Checked	Issued
A	17/08/2015	B Clark	E Avery
B	06/09/2016	C Smith	B Clark

## Distribution

Recipient	Revision	
	A	B
EJE Architecture	PDF	PDF

## Limitation Statement

Northrop Consulting Engineers Pty Ltd (Northrop) has been retained to prepare this report based on specific instructions, scope of work and purpose pursuant to a contract with its client. It has been prepared in accordance with the usual care and thoroughness of the consulting profession for the use by EJE Architecture. The report is based on generally accepted practices and standards applicable to the scope of work at the time it was prepared. No other warranty, express or implied, is made as to the professional advice included in this report.

Except where expressly permitted in writing or required by law, no third party may use or rely on this report unless otherwise agreed in writing by Northrop.

Where this report indicates that information has been provided to Northrop by third parties, Northrop has made no independent verification of this information except as expressly stated in the report. Northrop is not liable for any inaccuracies in or omissions to that information.

The report was prepared on the dates shown and is based on the conditions and information received at the time of preparation.

This report should be read in full, with reference made to all sources. No responsibility is accepted for use of any part of this report in any other context or for any other purpose. Northrop does not purport to give legal advice or financial advice. Appropriate specialist advice should be obtained where required.

To the extent permitted by law, Northrop expressly excludes any liability for any loss, damage, cost or expenses suffered by any third party relating to or resulting from the use of, or reliance on, any information contained in this report.





















# A NEW HIGH SCHOOL FOR BALLINA 37- 49 SWIFT STREET BALLINA NSW 2478



## DRAWING SCHEDULE

DRG No.	DRAWING TITLE
C01	COVERSHEET AND DRAWING SCHEDULE
C03	CONCEPT SITE LAYOUT PLAN
C10	CONCEPT EROSION AND SEDIMENT CONTROL PLAN - SHEET 1
C11	CONCEPT EROSION AND SEDIMENT CONTROL PLAN - SHEET 2
C12	CONCEPT EROSION AND SEDIMENT CONTROL DETAILS
C20	CONCEPT STORMWATER MANAGEMENT AND LEVELS PLAN - SHEET 1
C21	CONCEPT STORMWATER MANAGEMENT AND LEVELS PLAN - SHEET 2
C30	CIVIL DETAILS

DRAWN: W. SUTERS  
DESIGNED: E. AVERY  
JOB MANAGER: B. CLARK  
VERIFIER: B. CLARK

**NOT FOR CONSTRUCTION**

REVISION	DESCRIPTION	ISSUED	VER'D	APP'D	DATE	CLIENT	ARCHITECT	PROJECT	DRAWING TITLE	JOB NUMBER	
1	ISSUED FOR INFORMATION	WS	BC	EA	09.09.16			<p>Newcastle Suite 4, 215 Pacific Hwy, Charlestown NSW 2290 P.O. Box 180, Charlestown NSW 2290 Ph (02) 4943 1777 Fax (02) 4943 1577 Email newcastle@northrop.com.au ABN 81 094 433 100</p>	<p>A NEW HIGH SCHOOL FOR BALLINA 37- 49 SWIFT STREET BALLINA NSW 2478</p>	<p>COVERSHEET AND DRAWING SCHEDULE</p>	<p>NL150200</p>
A	ISSUED FOR APPROVAL	WC	BC	EA	31.10.16						
DRAWING NOT TO BE USED FOR CONSTRUCTION UNLESS VERIFICATION SIGNATURE HAS BEEN ADDED						THE COPYRIGHT OF THIS DRAWING REMAINS WITH NORTHROP CONSULTING ENGINEERS PTY LTD.					

DRAWING SHEET SIZE ± A1

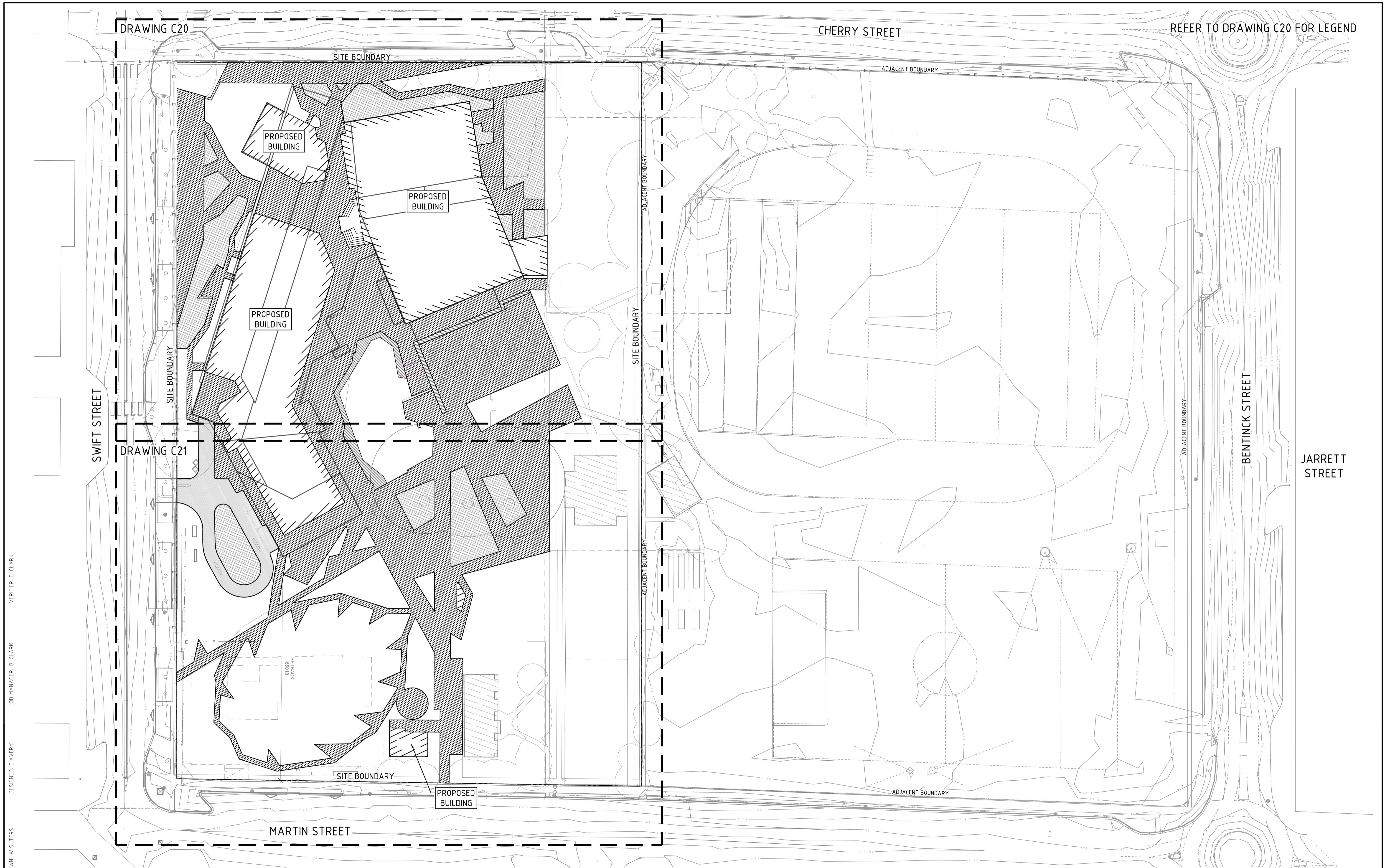

**NOT FOR CONSTRUCTION**

REVISION	DESCRIPTION	ISSUED	VER'D	APP'D	DATE
1	ISSUED FOR INFORMATION	WS	BC	EA	09.09.16
A	ISSUED FOR APPROVAL	WC	BC	EA	31.10.16

CLIENT

DRAWING NOT TO BE USED FOR CONSTRUCTION UNLESS VERIFICATION SIGNATURE HAS BEEN ADDED

ARCHITECT

THE COPYRIGHT OF THIS DRAWING REMAINS WITH NORTHROP CONSULTING ENGINEERS PTY LTD.

PLANS 1:500

ALL SETOUT TO ARCHITECT'S DRAWINGS. DIMENSIONS TO BE VERIFIED WITH THE ARCHITECT AND ON SITE BEFORE MAKING SHOP DRAWINGS OR COMMENCING WORK. NORTHROP ACCEPTS NO RESPONSIBILITY FOR THE USABILITY, COMPLETENESS OR SCALE OF DRAWINGS TRANSFERRED ELECTRONICALLY.

Suite 4, 215 Pacific Hwy, Charlestown NSW 2290  
 P.O. Box 180, Charlestown NSW 2290  
 Ph (02) 4943 1777 Fax (02) 4943 1577  
 Email newcastle@northrop.com.au ABN 81 094 433 100

PROJECT

**A NEW HIGH SCHOOL FOR BALLINA**  
**37- 49 SWIFT STREET**  
**BALLINA NSW 2478**

DRAWING TITLE

**CONCEPT SITE LAYOUT PLAN**

JOB NUMBER

**NL150200**

DRAWING NUMBER	REVISION
<b>C03</b>	<b>A</b>

DRAWING SHEET SIZE ± A1

DRAWN: W. SUTERS  
 DESIGNED: E. AVERY  
 JOB MANAGER: B. CLARK  
 VERIFIER: B. CLARK





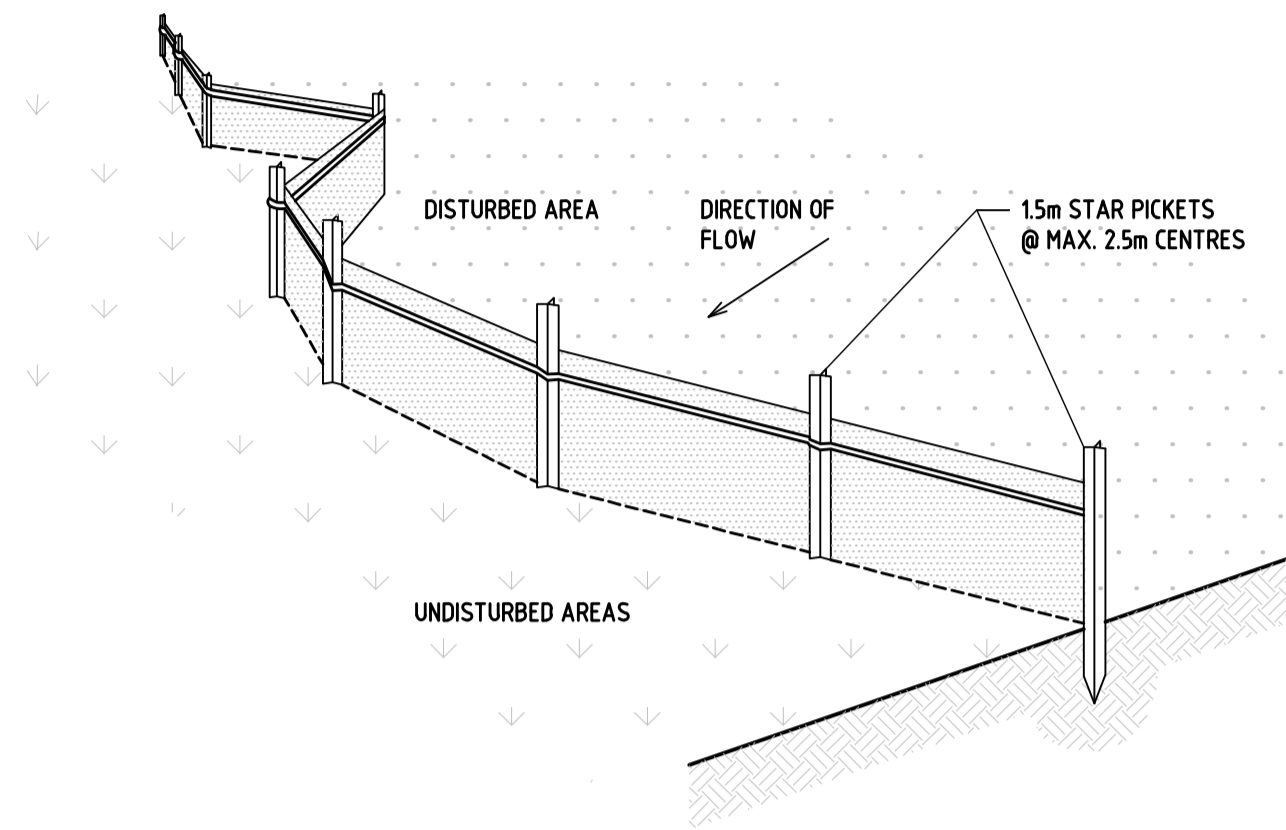
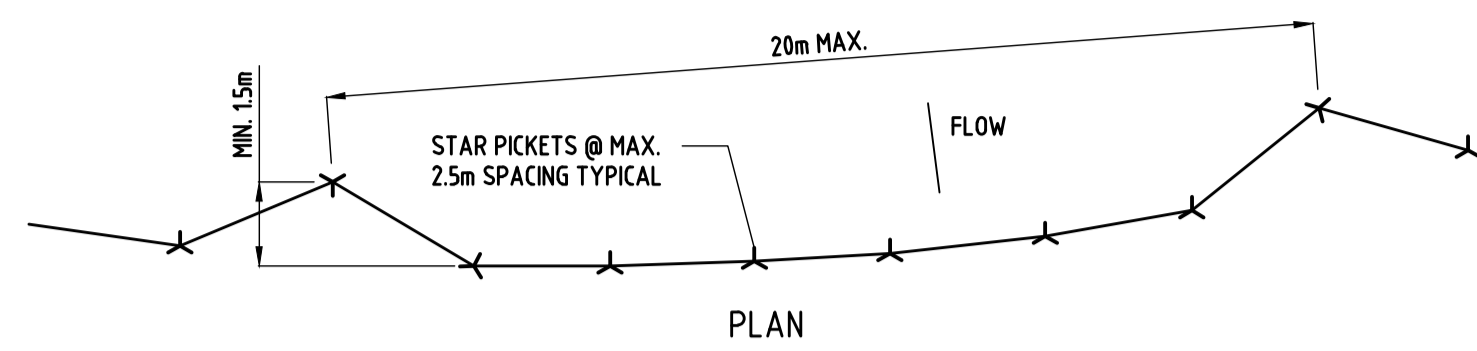

**SEDIMENT FENCE**  
SCALE N.T.S.

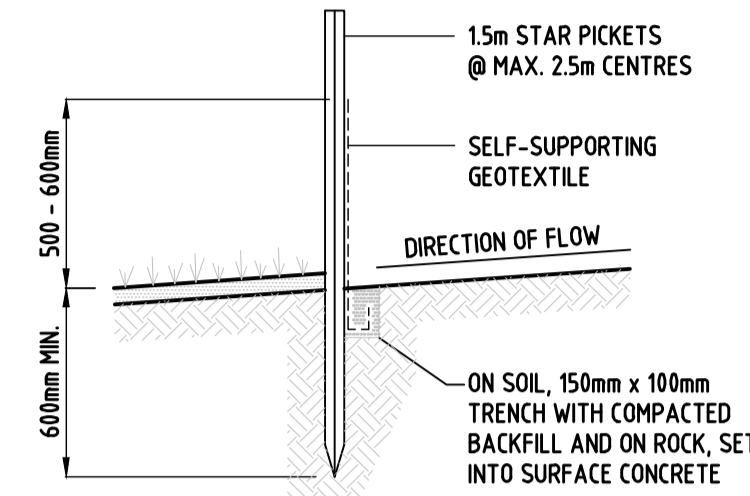

**SECTION DETAIL**

**SEDIMENT BASIN SIZING CALCULATION**

THE SITE IS LOCATED WITHIN THE BURNS POINT SOIL LANDSCAPE AND PRIMARILY CONSISTS OF SILTY SAND (AS PER THE SITE SPECIFIC GEOTECHNICAL INVESTIGATION), WHICH HAS THE FOLLOWING PROPERTIES (IN ACCORDANCE WITH TABLE 2 OF THE "BLUE BOOK"):

SITE PARAMETERS	
CONSTRAINT	VALUE
SEDIMENT TYPE	F (DISPERSIBLE SOILS)
SOIL HYDROLOGY GROUP	D
K = SOIL ERODIBILITY (K-FACTOR)	0.013
R = RAINFALL ERODIVITY (R-FACTOR)	4640
S = 2 YEAR, 6 HOUR STORM INTENSITY	14.5 mm/hr (BALLINA)
LS = SLOPE LENGTH/GRADIENT	0.18 (60m SLOPE @ 1% GRADE)
P = EROSION CONTROL PRACTICE (P-FACTOR)	1.3 (TYPICAL)
C = GROUND COVER (C-FACTOR)	1.0 (TYPICAL FOR STRIPPED SITE)
SOIL LOSS (RUSLE METHOD) (tonnes/ha/yr)	14
EROSION HAZARD (TABLE 4.2 BLUE BOOK)	VERY LOW

SEDIMENT BASIN SIZING		
CONSTRAINT	VALUE	UNITS
CV = VOLUMETRIC RUNOFF COEFFICIENT	0.56	
R = 5 DAY, 80 <sup>th</sup> PERCENTILE RAINFALL	35.300	mm
A = CATCHMENT AREA	2.230	ha
SETTLING ZONE VOLUME (10xCVxRxX)	504	m <sup>3</sup>
SOIL LOSS (CALC ABOVE)	11	m <sup>3</sup> /ha/yr
A2 = DISTURBED CATCHMENT AREA	2.230	ha
SEDIMENT STORAGE VOLUME (0.17xSOIL LOSSxA2)	4	m <sup>3</sup>
TOTAL BASIN VOLUME REQUIRED	508	m <sup>3</sup>

GIVEN THE VERY LOW EROSION HAZARD CLASSIFICATION DETERMINED FOR THIS SITE A SEDIMENT BASIN IS NOT REQUIRED UNDER THE "BLUE BOOK" GUIDELINES. AS SUCH ALTERNATIVE SITE APPROPRIATE MEASURES HAVE BEEN PROPOSED TO MANAGE THE SEDIMENT LADEN RUN-OFF PRIOR TO DISCHARGE FROM SITE.

**SEDIMENT FENCE CONSTRUCTION NOTES:**

- CONSTRUCT SEDIMENT FENCES AS CLOSE AS POSSIBLE TO BEING PARALLEL TO THE CONTOURS OF THE SITE, BUT WITH SMALL RETURNS AS SHOWN IN THE DRAWING TO LIMIT THE CATCHMENT AREA OF ANY ONE SECTION. THE CATCHMENT AREA SHOULD BE SMALL ENOUGH TO LIMIT WATER FLOW IF CONCENTRATED AT ONE POINT TO 50 LITRES PER SECOND IN THE DESIGN STORM EVENT, USUALLY THE 10-YEAR EVENT.
- CUT A 150mm DEEP TRENCH ALONG THE UPSLOPE LINE OF THE FENCE FOR THE BOTTOM OF THE FABRIC TO BE ENTRENCHED.
- DRIVE 1.5m LONG STAR PICKETS INTO GROUND @ 2.5m INTERVALS (MAX.) AT THE DOWNSLOPE EDGE OF THE TRENCH. ENSURE ANY STAR PICKETS ARE FITTED WITH SAFETY CAPS.
- FIX SELF-SUPPORTING GEOTEXTILE TO THE UPSLOPE SIDE OF THE POSTS ENSURING IT GOES TO THE BASE OF THE TRENCH. FIX THE GEOTEXTILE WITH WIRE TIES OR AS RECOMMENDED BY THE MANUFACTURER. ONLY USE GEOTEXTILE SPECIFICALLY PRODUCED FOR SEDIMENT FENCING. THE USE OF SHADE CLOTH FOR THIS PURPOSE IS NOT SATISFACTORY.
- JOIN SECTIONS OF FABRIC AT A SUPPORT POST WITH A 150mm OVERLAP.
- BACKFILL THE TRENCH OVER THE BASE OF THE FABRIC AND COMPACT IT THOROUGHLY OVER THE GEOTEXTILE.

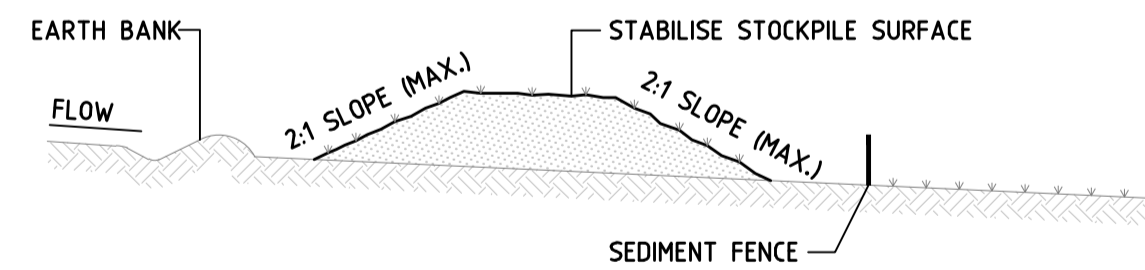

**STOCKPILE CONSTRUCTION NOTES:**

- PLACE STOCKPILES MORE THAN 2 (PREFERABLY 5) METRES FROM EXISTING VEGETATION, CONCENTRATED WATER FLOW, ROADS AND HAZARD AREAS.
- CONSTRUCT ON THE CONTOUR AS LOW, FLAT, ELONGATED MOUNDS.
- WHERE THERE IS SUFFICIENT AREA, TOPSOIL STOCKPILES SHALL BE LESS THAN 2 METRES IN HEIGHT. WHERE THEY ARE TO BE PLACED FOR MORE THAN 10 DAYS, STABILISE FOLLOWING THE APPROVED E.S.C.P. OR S.W.M.P. TO REDUCE THE C-FACTOR TO LESS THAN 0.10.
- CONSTRUCT EARTH BANKS ON THE UPSLOPE SIDE TO DIVERT WATER AROUND STOCKPILES AND SEDIMENT FENCES 1 TO 2 METRES DOWNSLOPE.

**STOCKPILES**  
SCALE N.T.S.

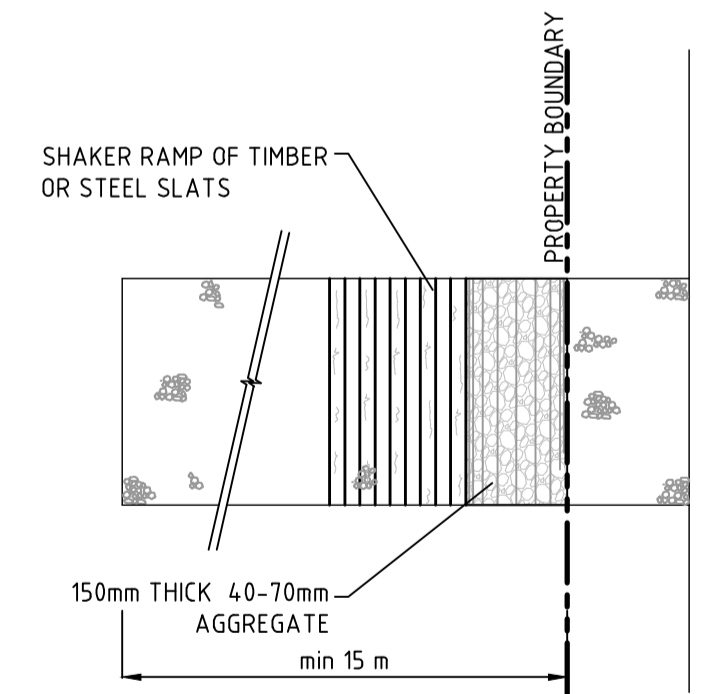

**STABILISED SITE ACCESS WITH SHAKER RAMP**  
N.T.S.

**CONSTRUCTION SITE**

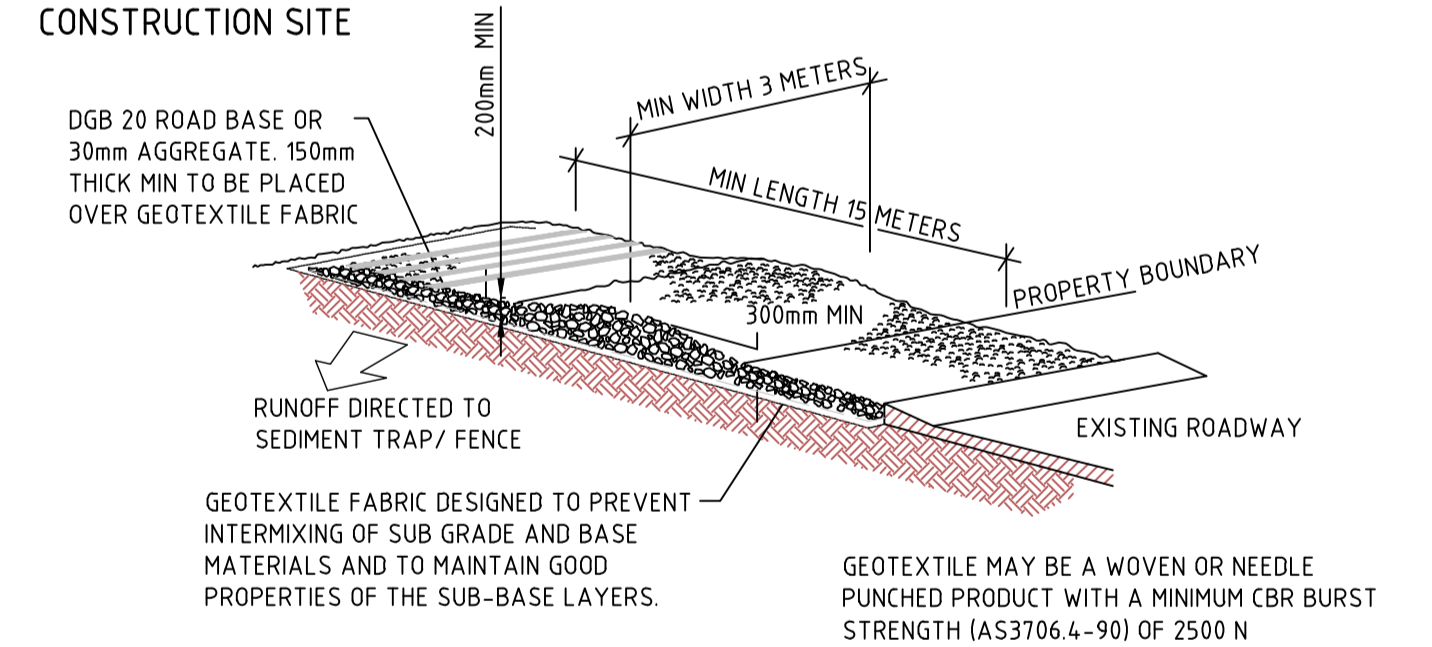

**STABILISED SITE ACCESS WITH SHAKER RAMP**  
N.T.S.

**STABILISED SITE ACCESS WITH SHAKER RAMP CONSTRUCTION NOTES:**

- THIS DEVICE IS TO BE LOCATED AT ALL EXITS FROM CONSTRUCTION SITE.
- THIS DEVICE IS TO BE REGULARLY CLEANED OF DEPOSITED MATERIAL SO AS TO MAINTAIN A 50mm DEEP SPACE BETWEEN PLANKS.
- ANY UNSEALED ROAD BETWEEN THIS DEVICE AND NEAREST ROADWAY IS TO BE TOPPED WITH 100mm THICK 4.0-70mm SIZE AGGREGATE.
- ALTERNATIVELY, PRECAST CONCRETE CATTLE GRIDS MAY BE USED. 1, 2 & 3 ABOVE ALSO APPLY.

**NOT FOR CONSTRUCTION**

DRAWN: W SUTERS  
DESIGNED: E AVERY  
JOB MANAGER: B CLARK  
VERIFIER: B CLARK

REVISION	DESCRIPTION	ISSUED	VER'D	APP'D	DATE
1	ISSUED FOR INFORMATION	WS	BC	EA	09.09.16
A	ISSUED FOR APPROVAL	WC	BC	EA	31.10.16

CLIENT  
**NSW Education Public Schools**

ARCHITECT  
**EJE architecture**

ALL SETOUT TO ARCHITECT'S DRAWINGS. DIMENSIONS TO BE VERIFIED WITH THE ARCHITECT AND ON SITE BEFORE MAKING SHOP DRAWINGS OR COMMENCING WORK. NORTHROP ACCEPTS NO RESPONSIBILITY FOR THE USABILITY, COMPLETENESS OR SCALE OF DRAWINGS TRANSFERRED ELECTRONICALLY.

DETAILS 1:10  
0 100 200 300 400 500

**NORTHROP**  
Newcastle  
Suite 4, 215 Pacific Hwy, Charlestown NSW 2290  
P.O. Box 180, Charlestown NSW 2290  
Ph (02) 4943 1777 Fax (02) 4943 1577  
Email newcastle@northrop.com.au ABN 81 094 433 100

PROJECT  
**A NEW HIGH SCHOOL FOR BALLINA**  
37- 49 SWIFT STREET  
BALLINA NSW 2478

DRAWING TITLE  
**EROSION AND SEDIMENT CONTROL DETAILS**

JOB NUMBER  
**NL150200**

DRAWING NUMBER <b>C12</b>	REVISION <b>A</b>
------------------------------	----------------------

DRAWING SHEET SIZE ± A1

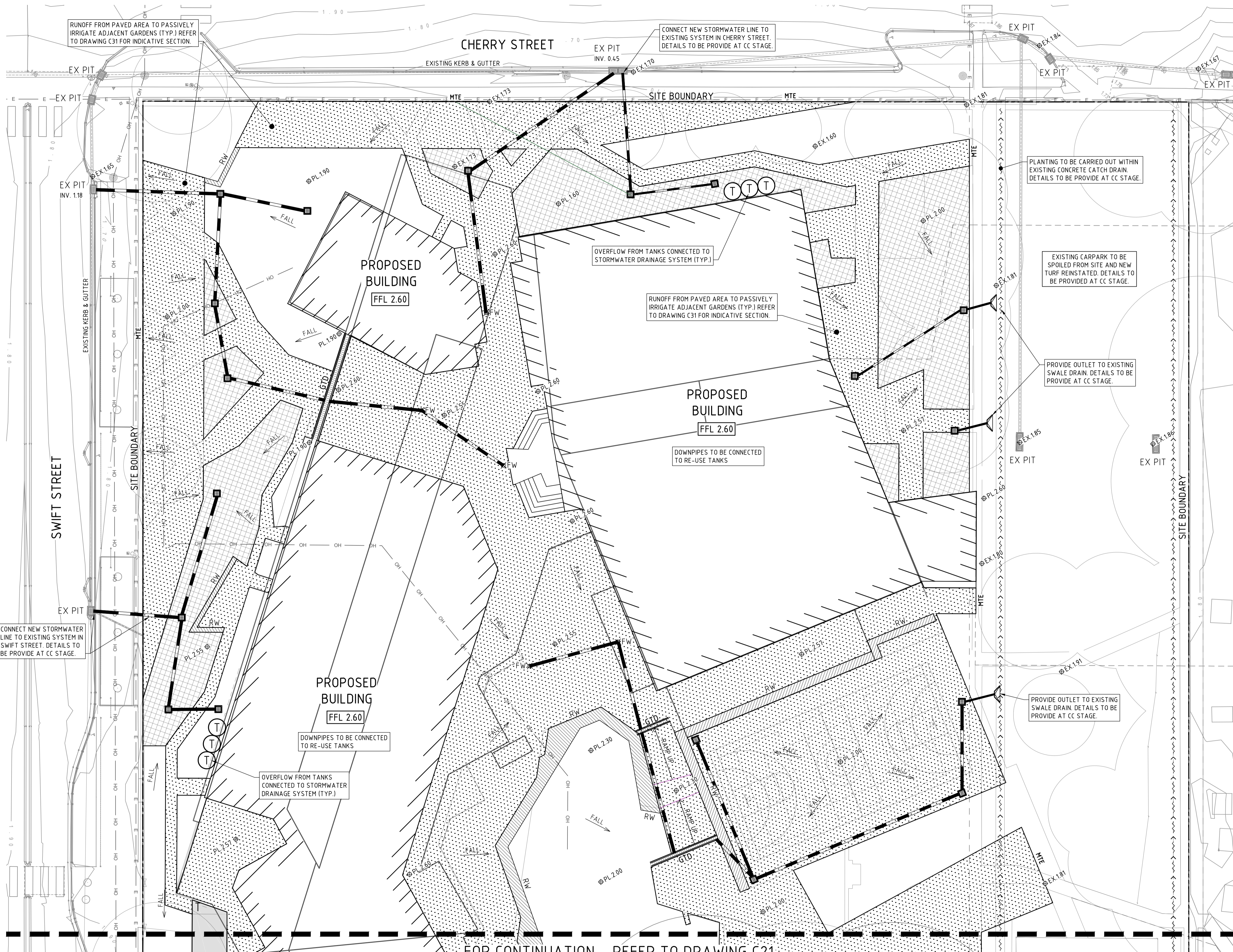

- LEGEND**
- DENOTES SITE FENCE.
  - DENOTES PROPOSED STORMWATER PIT. DETAILS & PIT SCHEDULE TO BE PROVIDED AT CC STAGE.
  - DENOTES PROPOSED STORMWATER DRAINAGE PIPE.
  - EX PIT --- DENOTES EXISTING STORMWATER PIT.
  - DENOTES EXISTING STORMWATER DRAINAGE PIPE.
  - FFL 2.60 DENOTES PROPOSED FINISHED FLOOR LEVEL.
  - PL 2.57 DENOTES PROPOSED FINISHED SURFACE LEVEL.
  - EX 1.85 DENOTES EXISTING FINISHED SURFACE LEVEL.
  - MTE DENOTES MATCH TO EXISTING LEVELS.
  - FALL DENOTES PROPOSED DIRECTION OF FALL IN FINISHED SURFACE.
  - GTD DENOTES PROPOSED PROPRIETARY OR CAST INSITU GRATED TRENCH DRAIN. DETAILS TO BE PROVIDED AT CC STAGE.
  - RW DENOTES PROPOSED RETAINING WALL. DETAILS TO BE PROVIDED AT CC STAGE.
  - DENOTES EXISTING CONCRETE CATCH DRAIN. DETAILS TO BE PROVIDED AT CC STAGE.
  - (T) DENOTES ABOVE GROUND REUSE TANK. DETAILS & SIZES WILL BE PROVIDED AT CC.
  - [Dotted Pattern] DENOTES EXTENT OF PROPOSED IMPERVIOUS PAVEMENT. REFER TO LANDSCAPE ARCHITECTS PLANS FOR FINISH AND TYPE.
  - [Hatched Pattern] DENOTES EXTENT OF PROPOSED IMPERVIOUS DRIVEWAY/LOADING ZONE PAVEMENT. DETAILS TO BE PROVIDED AT CC STAGE.
  - [Cross-hatched Pattern] DENOTES EXTENT OF PROPOSED PASSIVE IRRIGATION AREA. DETAILS TO BE PROVIDED AT CC STAGE.

FOR CONTINUATION - REFER TO DRAWING C21

**NOT FOR CONSTRUCTION**

REVISION	DESCRIPTION	ISSUED	VER'D	APP'D	DATE	CLIENT
1	ISSUED FOR INFORMATION	WS	BC	EA	09.09.16	NSW Education Public Schools
A	ISSUED FOR APPROVAL	WC	BC	EA	31.10.16	

NSW Education Public Schools

ARCHITECT: EJE

CLIENT: Education Public Schools

ALL SETOUT TO ARCHITECT'S DRAWINGS. DIMENSIONS TO BE VERIFIED WITH THE ARCHITECT AND ON SITE BEFORE MAKING SHOP DRAWINGS OR COMMENCING WORK. NORTHROP ACCEPTS NO RESPONSIBILITY FOR THE USABILITY, COMPLETENESS OR SCALE OF DRAWINGS TRANSFERRED ELECTRONICALLY.

PLANS 1:250

**NORTHROP**

Newcastle

Suite 4, 215 Pacific Hwy, Charlestown NSW 2290  
 P.O. Box 180, Charlestown NSW 2290  
 Ph (02) 4943 1777 Fax (02) 4943 1577  
 Email newcastle@northrop.com.au ABN 81 094 433 100

PROJECT: A NEW HIGH SCHOOL FOR BALLINA FOR BALLINA 37- 49 SWIFT STREET BALLINA NSW 2478

DRAWING TITLE: CONCEPT STORMWATER MANAGEMENT AND LEVELS PLAN - SHEET 1

JOB NUMBER: NL150200

DRAWING NUMBER: C20 REVISION: A

DRAWING SHEET SIZE ± A1

DRAWN: W SUITERS  
 DESIGNED: E AVERY  
 JOB MANAGER: B CLARK  
 VERIFIER: B CLARK

FOR CONTINUATION - REFER TO DRAWING C20

REFER TO DRAWING C20 FOR LEGEND

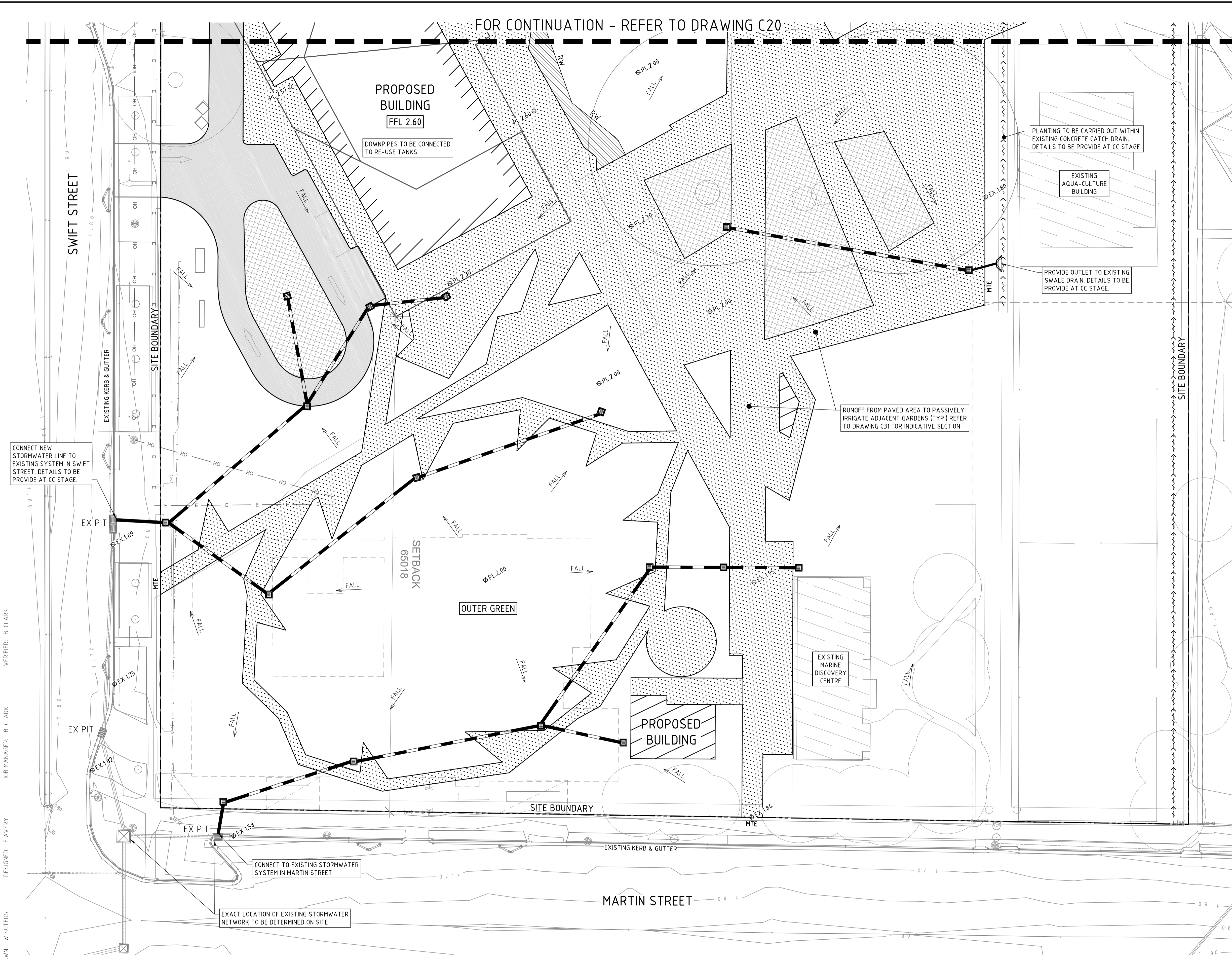

DRAWN: W. SUTERS  
 DESIGNED: E. AVERY  
 JOB MANAGER: B. CLARK  
 VERIFIER: B. CLARK

**NOT FOR CONSTRUCTION**

REVISION	DESCRIPTION	ISSUED	VER'D	APP'D	DATE
1	ISSUED FOR INFORMATION	WS	BC	EA	09.09.16
A	ISSUED FOR APPROVAL	WC	BC	EA	31.10.16

CLIENT

NSW Education Public Schools

ARCHITECT

EJE architecture

THE COPYRIGHT OF THIS DRAWING REMAINS WITH NORTHROP CONSULTING ENGINEERS PTY LTD.

ALL SETOUT TO ARCHITECT'S DRAWINGS. DIMENSIONS TO BE VERIFIED WITH THE ARCHITECT AND ON SITE BEFORE MAKING SHOP DRAWINGS OR COMMENCING WORK. NORTHROP ACCEPTS NO RESPONSIBILITY FOR THE USABILITY, COMPLETENESS OR SCALE OF DRAWINGS TRANSFERRED ELECTRONICALLY.

PLANS 1:250

**NORTHROP**  
Newcastle

Suite 4, 215 Pacific Hwy, Charlestown NSW 2290  
 P.O. Box 180, Charlestown NSW 2290  
 Ph (02) 4943 1777 Fax (02) 4943 1577  
 Email newcastle@northrop.com.au ABN 81 094 433 100

PROJECT

**A NEW HIGH SCHOOL FOR BALLINA**  
 37-49 SWIFT STREET  
 BALLINA NSW 2478

DRAWING TITLE

**CONCEPT STORMWATER MANAGEMENT AND LEVELS**  
 PLAN - SHEET 2

JOB NUMBER	
<b>NL150200</b>	
DRAWING NUMBER	REVISION
<b>C21</b>	<b>A</b>
DRAWING SHEET SIZE ± A1	

DRAWN: W. SUTERS  
DESIGNED: E. AVERY  
JOB MANAGER: B. CLARK  
VERIFIER: B. CLARK

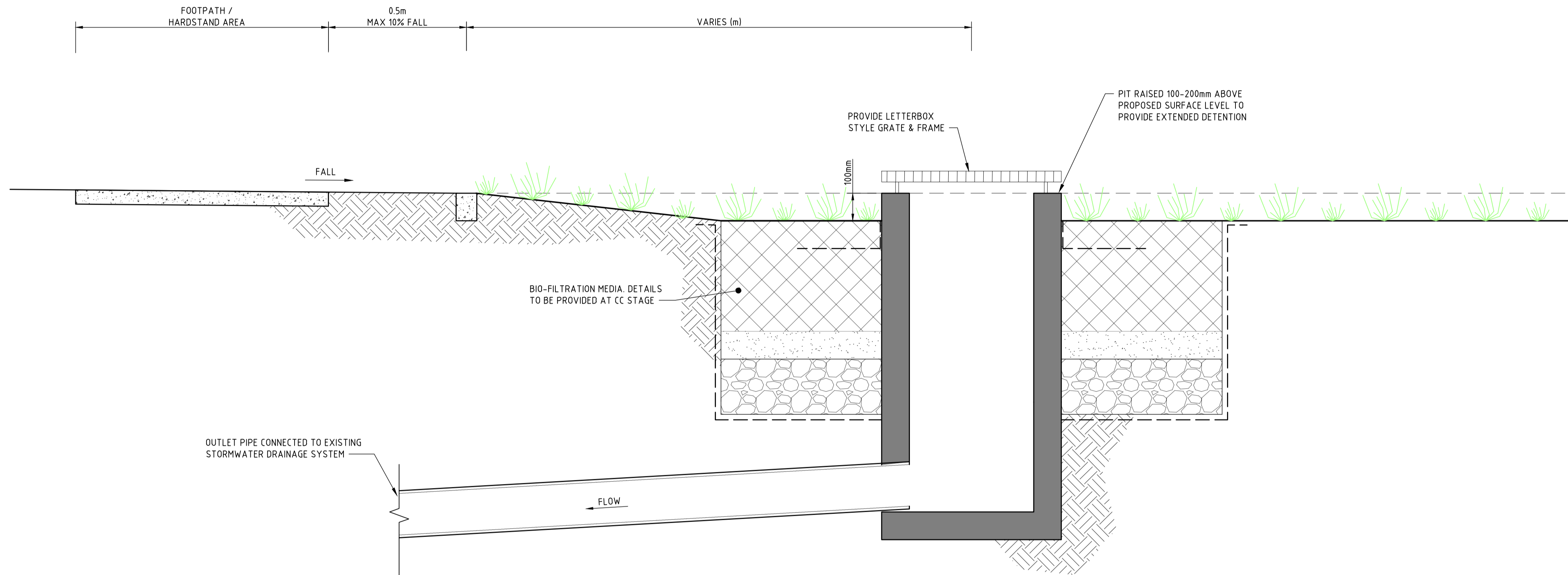

TYPICAL PASSIVE IRRIGATION DETAIL  
FOOTPATH TO GARDEN EDGE  
SCALE 1:10

**NOT FOR CONSTRUCTION**

REVISION	DESCRIPTION	ISSUED	VER'D	APP'D	DATE
1	ISSUED FOR INFORMATION	WS	BC	EA	09.09.16
A	ISSUED FOR APPROVAL	WC	BC	EA	31.10.16

CLIENT

DRAWING NOT TO BE USED FOR CONSTRUCTION UNLESS VERIFICATION SIGNATURE HAS BEEN ADDED

ARCHITECT

THE COPYRIGHT OF THIS DRAWING REMAINS WITH NORTHROP CONSULTING ENGINEERS PTY LTD.

ALL SETOUT TO ARCHITECT'S DRAWINGS. DIMENSIONS TO BE VERIFIED WITH THE ARCHITECT AND ON SITE BEFORE MAKING SHOP DRAWINGS OR COMMENCING WORK. NORTHROP ACCEPTS NO RESPONSIBILITY FOR THE USABILITY, COMPLETENESS OR SCALE OF DRAWINGS TRANSFERRED ELECTRONICALLY.

DETAILS 1:10

Suite 4, 215 Pacific Hwy, Charlestown NSW 2290  
P.O. Box 180, Charlestown NSW 2290  
Ph (02) 4943 1777 Fax (02) 4943 1577  
Email newcastle@northrop.com.au ABN 81 094 433 100

PROJECT

**A NEW HIGH SCHOOL FOR BALLINA**  
37-49 SWIFT STREET  
BALLINA NSW 2478

DRAWING TITLE

**CIVIL DETAILS**

JOB NUMBER

**NL150200**

DRAWING NUMBER	REVISION
<b>C30</b>	<b>A</b>

DRAWING SHEET SIZE ± A1