

7 April 2020

Supriya Mukherji
Sydney Trains
Ground Floor (East), 36 – 46 George Street
Burwood NSW 2134

Dear Supriya

**2 FIGTREE DRIVE, SYDNEY OLYMPIC PARK (SSD 7662)
CONSENT CONDITION E22**

Mirvac is intending to obtain their third and fourth interim occupational certificates for Building 2 and 5 at 2B & 2D Figtree Drive, Sydney Olympic Park. In order to satisfy consent condition E22, summarised below, please see attached as-built drawings prepared by a Registered Surveyor confirming the location of the pile walls in the basement and the location of Building 2 and Building 5, in proximity to the rail corridor. Please review and provide written confirmation that the condition below has been satisfied.

E22 - Railway Corridor - Sydney Trains

Prior to the issue of each Occupation Certificate the Applicant is to submit the as-built drawings to Sydney Trains and Consent Authority. The as-built drawings are to be endorsed by a Registered Surveyor confirming that there has been no encroachment into Sydney Trains property or easement. The Principle Certifying Authority is not to issue the Occupation certificate until written confirmation has been received from Sydney Trains confirming that this condition has been satisfied.

Yours sincerely



Steven De Pasquale
Senior Development Manager
Residential NSW

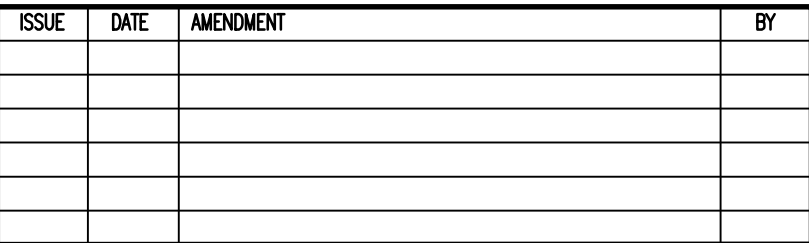

1. ORIGIN OF LEVELS SSM 0000, R.L.00.000 (A.H.D.)
2. BEARINGS ARE ON MGA NORTH
3. NO BOUNDARY SURVEY HAS BEEN UNDERTAKEN.
4. BEARINGS & DISTANCES HAVE BEEN COMPILED FROM TITLE AND/OR DEED INFORMATION SUPPLIED BY DEPARTMENT OF LANDS NSW.
5. RELATIONSHIP OF IMPROVEMENTS AND DETAIL TO BOUNDARIES IS DIAGRAMMATIC ONLY AND SPECIFIC DETAILS, IF CRITICAL, WILL REQUIRE FURTHER SURVEY.
6. SERVICES SHOWN ARE BASED ON VISIBLE SURFACE INDICATORS EVIDENT AT THE DATE OF SURVEY AND THE RELEVANT SERVICE DIAGRAMS OF THE VARIOUS AUTHORITIES. ALL SERVICE MUST BE VERIFIED ON SITE PRIOR TO ANY WORK BEING UNDERTAKEN. VERIS AUSTRALIA PTY LTD BEAR NO RESPONSIBILITY FOR THE ACCURACY OR COMPLETENESS OF THE SERVICES SHOWN HEREON.
7. RIDGE, EAVE & GUTTER HEIGHTS HAVE BEEN OBTAINED BY AN INDIRECT METHOD AND ARE ACCURATE FOR PLANNING PURPOSES ONLY.
8. ADJOINING BUILDINGS AND DWELLINGS HAVE BEEN PLOTTED FOR DIAGRAMMATIC PURPOSES ONLY AND SPECIFIC DETAILS, IF CRITICAL, WILL REQUIRE FURTHER SURVEY.
9. THE DIAMETER (ϕ), SPREAD (S) & HEIGHT (H) OF EACH TREE IS INDICATIVE ONLY AND SPECIFIC DETAILS, IF CRITICAL, WILL REQUIRE FURTHER SURVEY.
10. CONTOURS ARE AN INDICATION OF THE TOPOGRAPHY ONLY. SPOT LEVELS SHOULD BE USED IF DETAILED DESIGN IS TO BE UNDERTAKEN.
11. CONTOUR INTERVAL XXXXMETRE.

AE	ARCHITECTURAL EMBELLISHMENT	EG	EAGE OF GARDEN	SSM	STATE SURVEY MARK
AP	ALIGNMENT PIN	ELEC	ELECTRICITY PIT	ST	STAY STALVE
APN	APPROACH	ED	EDGE OF PATH	STW	STORM WATER
BALC	BALCONY	ER	EDGE OF ROAD	TARCH	TOP OF ARCH
BANW	BOTTOM OF AWNING	FCE	FENCE	TAWN	TOP OF AWNING
BCH	BOTTOM OF CHIMNEY	FL	FLOOR LEVEL	TBN	TOP OF BANK
BO	BOTTOM OF CHIMNEY	FFL	FINISHED FLOOR LEVEL	TBL	TELSTRA BOX
BD	BOTTOM OF DOOR	FP	FENCE POST	TCH	TOP OF CHIMNEY
BDY	BOTTOM OF DOOR	GD	GLASS DOOR	TDD	TOP OF DOOR
BF	BOTTOM OF FENCE	GL	GROUND LEVEL	TEL	TELSTRA
BHR	BOTTOM OF HANDRAIL	GM	GAS METER	TELP	TELSTRA PILLAR
BHS	BOTTOM OF HANDRAIL	HPS	HIGH POWERED GAS	TF	TOP OF FENCE
BK	BOTTOM OF KERB	HR	HANDRAIL	TG	TOP OF GUTTER
BLD	BUILDING	HYD	HYDRANT	TI	TRAFFIC ISLAND
BM	BENCH MARK	IL	INVERT LEVEL	TH	TOP OF HANDRAIL
BOL	BOLTER	K	KERB	TK	TOP OF KERB
BOR	BOTTOM OF ROOF	LIN	LINE	TL	TRAFFIC LIGHT
BRK	BRIER	LP	LAMP POST	TP	TOP OF PARAPET
BS	BOTTOM OF RETAINING WALL	M	MANHOLE	TR	TREE
BSW	BOTTOM OF STEPS	MUD	MUD LID	TRF	TOP OF ROOF
BSW	BOTTOM OF STEPS	NCL	NATURAL SURFACE	TRF	TOP OF ROCK
BWN	BOTTOM OF WINDOW	NSC	STRUCTURE	TRW	TOP RETAINING WALL
CHM	CHIMNEY	OPT <td>OPTUS</td> <td>TS</td> <td>TOP OF STEPS</td>	OPTUS	TS	TOP OF STEPS
CL	CENTRELINE	PC	PEW CROSSING	TW	TOP OF WALL
CLD	CONCRETE LID	PERG	PEDESTRIAN CROSSING	TWN	TOP OF WINDOW
COL	COLUMN	PERG	PERGOLA	US	UNDERSIDE
COM	COMMUNICATIONS PIT	PM	PERMANENT MARK	UNW	UNDERSIDE OF AWNING
COW	COW	POWER	POWER LINE	UNW	UNDERSIDE SERVICE
CP	CARPOT	POK	POCK	USB	UNDERSIDE OF BEAM
D	DOOR	POK	POCK	USC	UNDERSIDE OF CEILING
DH	DRILL HOLE	R	RAILWAY	USC	UNDERSIDE FLY
DH	DRILL HOLE	RR	RROR OF PATH	USC	UNDERSIDE OF GUTTER
DHW	DRILL HOLE & WINGS	RSN	REINFORCED CONCRETE	V	VENT
DRI	DRIVWAY	SEW	SEWER	VER	VERANDAH
EB	EDGE OF BITUMEN	SHR	SHRUB	VO	VENT DOWRY
EDX	ELECTRICITY BOX	SLH	SEWER LAMP LID	W	WATER
EC	EDGE OF CONCRETE	SMH	SEWER MANHOLE	WM	WINDOW METER
ED	EDGE OF DOOR	SG	SEIGN POST		

C	COMMUNICATIONS CABLE	RM	RECYCLED WATER
CSWP	CERAMIC STORMWATER PIPE	RM	RISING MAIN
E	UNDERGROUND ELECTRICITY CABLES	RMS	ROADS & MARITIME SERVICES
AE	UNDERGROUND ELECTRICITY & OPTUS CABLES	S	SEWER
FS	FIRE SERVICE	SO	SEWER OUTFALL
G	GAS LINE	ST	SHARED TRENCH
GE	GAS LINE & ELECTRICITY CABLES	SW	STORM WATER
NGN	NATIONAL BROAD BAND CABLES	SW CK	STORMWATER CREEK
NB	NATURAL GAS LINE	T	TELSTRA CABLES
OH	OVERHEAD CABLES	TC	TELSTRA & GAS CABLES
OPT	OPTUS CABLE	U	UNKNOWN SERVICE
PE	PRIVATE ELECTRICITY	V	VOCUS CABLES
PS	PRIVATE SEWER	VR	VERIZON CABLES
PW	PRIVATE WATER	W	WATER SUPPLY
		WM	WATER MAIN

1. ALL UNDERGROUND SERVICE INFORMATION INCLUSIVE OF GENERAL POSITION AND SURFACE COVER DEPTHS NOTED ON THE PLAN ARE APPROXIMATELY ONLY.
2. ALL UNDERGROUND SERVICE INFORMATION HAS BEEN COMPILED FROM SERVICE AUTHORITY PLANS PROVIDED BY THE AUTHORITIES.
3. THE LOCATION OF SERVICES BETWEEN SURVEYED POINTS (AS INDICATED) HAVE BEEN SHOWN DIAGRAMMATICALLY ONLY USING THE SERVICE DIAGRAMS AS PROVIDED. THE EXACT LOCATION OF THESE SERVICES BETWEEN THE SURVEYED POINTS MUST BE DETERMINED PRIOR TO EXCAVATION. NO WARRANTY OR GUARANTEE IS GIVEN AGAINST THE POSSIBILITY OF THE EXISTENCE OF FURTHER UNCHARTERED SERVICES.
4. ALL CONTRACTORS, TRADESMEN, BUILDING & PROJECT CONSULTANTS MUST CONTACT THE VARIOUS AUTHORITIES IN ACCORDANCE WITH THE STANDARD PRACTICES OF THE INDUSTRY PRIOR TO UNDERTAKING ANY WORKS WITHIN THE VICINITY OF THE SERVICE LINES TO VERIFY THE POSITION OF THE SERVICE LINES.



TITLE No: 1/DP1252952	REF: 140632
DATUM: A.H.D.	ISSUE: 1
DATE OF SURVEY: 16.01.20	ISSUE DATE: 06.04.20
SURVEYOR: AR	SHEET SIZE:
DRAFTER: CC	SHEET 1 OF 2 SHEETS



Veris Australia Pty Ltd
Suite 301, Level 3, 55 Holt Street
Surry Hills NSW 2012
PO Box 1807
Strawberry Hills NSW 2012
t: (02) 92124655
email: surryhills@veris.com.au
web site: www.veris.com.au

BASEMENT LEVEL 1

PLAN SHOWING WORK AS EXECUTED PILE LOCATION IN RELATION TO DP1252952 BOUNDARIES.
No. 2 FIGTREE DRIVE, SYDNEY OLYMPIC PARK

W..... - DENOTES WORK AS EXECUTED PILE LOCATION VIDE WARD CIVIL DRAWING: 679 WAE PILES 200116.dxf

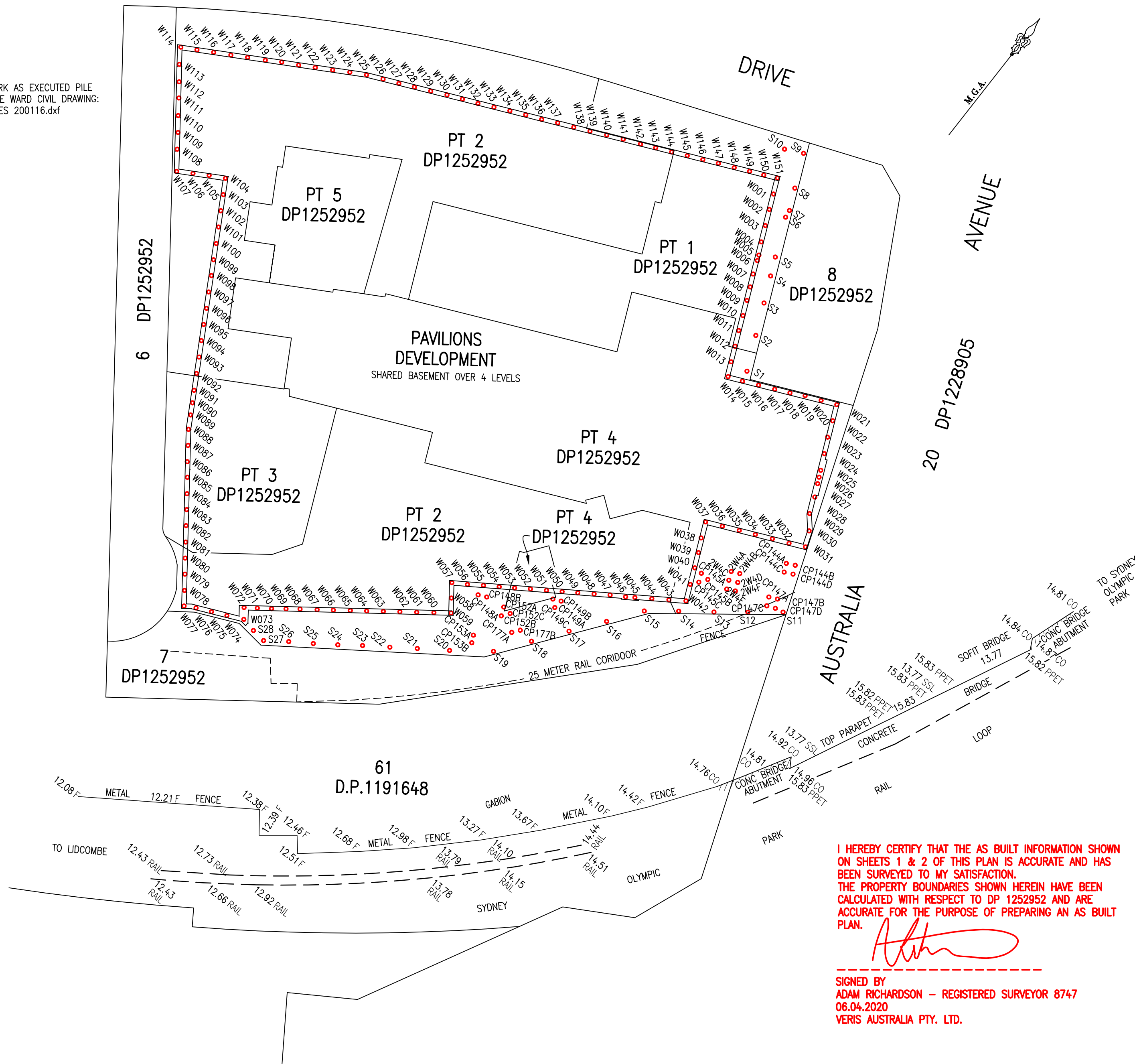

ISSUE	DATE	AMENDMENT	BY

TYPICAL NOTES:

- ORIGIN OF LEVELS SSM 0000, R.L.00.000 (A.H.D.)
- BEARINGS ARE ON MGA NORTH
- NO BOUNDARY SURVEY HAS BEEN UNDERTAKEN
- BEARINGS & DISTANCES HAVE BEEN COMPILED FROM TITLE AND/OR DEED INFORMATION SUPPLIED BY DEPARTMENT OF LANDS NSW.
- RELATIONSHIP OF IMPROVEMENTS AND DETAIL TO BOUNDARIES IS DIAGRAMMATIC ONLY AND SPECIFIC DETAILS, IF CRITICAL, WILL REQUIRE FURTHER SURVEY.
- SERVICES SHOWN ARE BASED ON VISIBLE SURFACE INDICATORS EVIDENT AT THE DATE OF SURVEY AND THE RELEVANT SERVICE DIAGRAMS OF THE VARIOUS AUTHORITIES. ALL SERVICE MUST BE VERIFIED ON SITE PRIOR TO ANY WORK BEING UNDERTAKEN. VERIS AUSTRALIA PTY LTD BEAR NO RESPONSIBILITY FOR THE ACCURACY OR COMPLETENESS OF THE SERVICES SHOWN HEREON.
- RIDGE, EAVE & GUTTER HEIGHTS HAVE BEEN OBTAINED BY AN INDIRECT METHOD AND ARE ACCURATE FOR PLANNING PURPOSES ONLY.
- ADJOINING BUILDINGS AND DWELLINGS HAVE BEEN PLOTTED FOR DIAGRAMMATIC PURPOSES ONLY AND SPECIFIC DETAILS, IF CRITICAL, WILL REQUIRE FURTHER SURVEY.
- THE DIAMETER (Ø), SPREAD (S) & HEIGHT (H) OF EACH TREE IS INDICATIVE ONLY AND SPECIFIC DETAILS, IF CRITICAL, WILL REQUIRE FURTHER SURVEY.
- CONTOURS ARE AN INDICATION OF THE TOPOGRAPHY ONLY. SPOT LEVELS SHOULD BE USED IF DETAILED DESIGN IS TO BE UNDERTAKEN.
- CONTOUR INTERVAL XXX METRE.

LEGEND OF TYPICAL CODES		
AE - ARCHITECTURAL EMBELLISHMENT	EG - EDGE OF GARDEN	SSM - STATE SURVEY MARK
AP - ALIGNMENT PIN	ELEC - ELECTRICITY PIT	SV - STOP VALVE
AWN - AWNING	EP - EDGE OF PATH	SW - STORM WATER
BALC - BALCONY	ER - EDGE OF ROAD	TARCH - TOP OF ARCH
BAWN - BOTTOM OF AWNING	FCE - FENCE	TAWN - TOP OF AWNING
BB - BOTTOM OF BANK	FL - FLOOR LEVEL	TB - TOP OF BANK
BCH - BOTTOM OF CHIMNEY	FPL - FINISHED FLOOR LEVEL	TBX - TELSTRA BOX
BD - BOTTOM OF DOOR	FP - FENCE POST	TCH - TOP OF CHIMNEY
BDY - BOUNDARY	GD - GLASS DOOR	TD - TOP OF DOOR
BL - BOTTOM OF LEVEL	GL - GROUND LEVEL	TEL - TELSTRA
BHR - BOTTOM OF HANDRAIL	GM - GAS METER	TLP - TELSTRA PILLAR
BIT - BITUMEN	HPS - HIGH POWERED GAS	TP - TOP OF FENCE
BK - BUILDING	HR - HANDRAIL	TG - TOP OF GUTTER
BLD - BUILDING	HYD - HYDRANT	TI - TRAFFIC ISLAND
BM - BENCH MARK	IL - INVERT LEVEL	THR - TOP OF HANDRAIL
BOX - BOX	K - KERB	TK - TOP OF KERB
BR - BOTTOM OF ROCK	LIN - LINTEL	TL - TRAFFIC LIGHT
BRK - BRICK	LP - LAMP POST	TR - TOP OF PARAPET
BRW - BOTTOM OF RETAINING WALL	MH - MANHOLE	TRF - TOP OF ROOF
BS - BOTTOM OF STEPS	MUD - METAL UD	TRK - TOP OF ROCK
BW - BOTTOM OF WALL	NS - NATURAL SURFACE	TRM - TOP OF RETAINING WALL
BWN - BOTTOM OF WINDOW	OCC - OCCUPATION	TS - TOP OF STEPS
CHIM - CHIMNEY	OPT - OPTUS	TW - TOP OF WALL
CL - CENTRELINE	PC - PRAM CROSSING	TWN - TOP OF WINDOW
CLO - CONCRETE LID	PERG - PERGOLA	US - UNDERSIDE
COL - COLUMN	PM - PERMANENT MARK	UAWN - UNDERSIDE OF AWNING
COM - COMMUNICATIONS PIT	PP - POWER POLE	UKS - UNKNOWN SERVICE
CONC - CONCRETE	RCK - ROCK	USB - UNDERSIDE OF BEAM
CPT - CURB CUT	RCK - ROCK	USC - UNDERSIDE OF CEILING
D - DOOR	RLWY - RAILWAY	USE - UNDERSIDE OF EAVE
DD - DISH DRAIN	RM - REFERENCE MARK	USC - UNDERSIDE OF GUTTER
DH - DRILL HOLE	RSN - CONCRETE NAIL	V - VENT
DHW - DRILL HOLE & WINGS	SEW - SEWER	VER - VERANDAH
DWY - DRIVEWAY	SHR - SHED	VC - VEHICLE CROSSING
EB - EDGE OF BITUMEN	SLH - SEWER LAMP HOLE	W - WINDOW
EBOX - ELECTRICITY BOX	SMH - SEWER MANHOLE	WM - WATER METER
EC - EDGE OF CONCRETE	SP - SIGN POST	
ED - EDGE OF DOOR		

LEGEND OF TYPICAL SERVICES		
C - COMMUNICATIONS CABLE	RW - RECYCLED WATER	
CSWP - CERAMIC STORMWATER PIPE	RM - RISING MAIN	
E - UNDERGROUND ELECTRICITY	RMS - ROADS & MARITIME SERVICES	
AE - UNDERGROUND ELECTRICITY & OPTUS CABLES	S - SEWER	
FS - FIRE SERVICE	SO - SEWER OUTFALL	
G - GAS LINE	ST - SHARED TRENCH	
GE - GAS LINE & ELECTRICITY CABLES	SW - STORM WATER	
NBN - NATIONAL BROAD BAND CABLES	SW-CK - STORMWATER CREEK	
NG - NATURAL GAS LINE	T - TELSTRA CABLES	
OH - OVERHEAD CABLES	TG - TELSTRA & GAS CABLES	
OPT - OPTUS CABLE	U - UNKNOWN SERVICE	
PE - PRIVATE ELECTRICITY	VO - VOCUS CABLES	
PS - PRIVATE SEWER	VR - VERIZON CABLES	
PW - PRIVATE WATER	W - WATER SUPPLY	
	WM - WATER MAIN	

- ALL UNDERGROUND SERVICE INFORMATION INCLUSIVE OF GENERAL POSITION AND SURFACE COVER DEPTHS NOTED ON THE PLAN ARE APPROXIMATELY ONLY.
- ALL UNDERGROUND SERVICE INFORMATION HAS BEEN COMPILED FROM SERVICE AUTHORITY PLANS PROVIDED BY THE AUTHORITIES.
- THE LOCATION OF SERVICES BETWEEN SURVEYED POINTS (AS INDICATED) HAVE BEEN SHOWN DIAGRAMMATICALLY ONLY USING THE SERVICE DIAGRAMS AS PROVIDED. THE EXACT LOCATION OF THESE SERVICES BETWEEN THE SURVEYED POINTS MUST BE VERIFIED PRIOR TO ANY EXCAVATION OR PILING. NO WARRANTY IS GIVEN AGAINST THE POSSIBILITY OF THE EXISTENCE OF FURTHER UNCHARTED SERVICES.
- ALL CONTRACTORS, TRADESMEN, BUILDING & PROJECT CONSULTANTS MUST CONTACT THE VARIOUS AUTHORITIES, IN ACCORDANCE WITH STANDARD "DIAL BEFORE YOU DIG" PROCEDURES PRIOR TO UNDERTAKING ANY WORKS WITHIN THE VICINITY OF THE SERVICE LINES TO VERIFY THE POSITION OF THE SERVICE LINES.

Liability limited by a scheme approved under Professional Standards Legislation

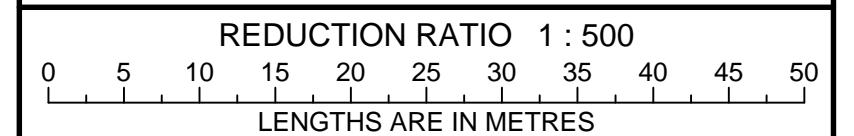

CLIENT: MIRVAC

TITLE No: 1/DP1252952	REF: 140632
DATUM: A.H.D.	ISSUE: 1
DATE OF SURVEY: 16.01.20	ISSUE DATE: 06.04.20
SURVEYOR: AR	SHEET SIZE:
DRAFTER: CC	SHEET 2 OF 2 SHEETS

PLAN SHOWING 'PAVILIONS' BUILDING 2 & 5 IN PROXIMITY TO THE SYDNEY OLYMPIC PARK RAIL LOOP CORRIDOR

Veris Australia Pty Ltd
Suite 301, Level 3, 55 Holt Street
Surry Hills NSW 2012
PO Box 1807
Strawberry Hills NSW 2012
t: (02) 92124655
email: surryhills@veris.com.au
web site: www.veris.com.au

I HEREBY CERTIFY THAT THE AS BUILT INFORMATION SHOWN ON SHEETS 1 & 2 OF THIS PLAN IS ACCURATE AND HAS BEEN SURVEYED TO MY SATISFACTION. THE PROPERTY BOUNDARIES SHOWN HEREIN HAVE BEEN CALCULATED WITH RESPECT TO DP 1252952 AND ARE ACCURATE FOR THE PURPOSE OF PREPARING AN AS BUILT PLAN.

SIGNED BY
ADAM RICHARDSON - REGISTERED SURVEYOR 8747
06.04.2020
VERIS AUSTRALIA PTY. LTD.

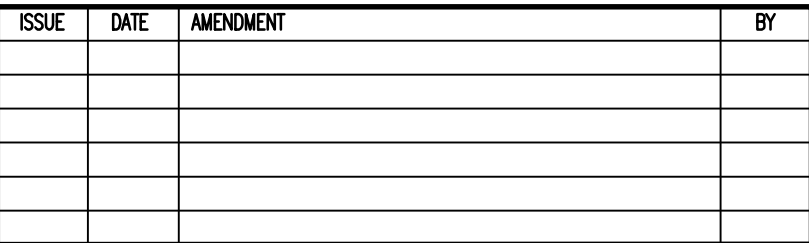

1. ORIGIN OF LEVELS SSM 0000, R.L.00.000 (A.H.D.)
2. BEARINGS ARE ON MGA NORTH
3. NO BOUNDARY SURVEY HAS BEEN UNDERTAKEN.
4. BEARINGS & DISTANCES HAVE BEEN COMPILED FROM TITLE AND/OR DEED INFORMATION SUPPLIED BY DEPARTMENT OF LANDS NSW.
5. RELATIONSHIP OF IMPROVEMENTS AND DETAIL TO BOUNDARIES IS DIAGRAMMATIC ONLY AND SPECIFIC DETAILS, IF CRITICAL, WILL REQUIRE FURTHER SURVEY.
6. SERVICES SHOWN ARE BASED ON VISIBLE SURFACE INDICATORS EVIDENT AT THE DATE OF SURVEY AND THE RELEVANT SERVICE DIAGRAMS OF THE VARIOUS AUTHORITIES. ALL SERVICE MUST BE VERIFIED ON SITE PRIOR TO ANY WORK BEING UNDERTAKEN. VERIS AUSTRALIA PTY LTD BEAR NO RESPONSIBILITY FOR THE ACCURACY OR COMPLETENESS OF THE SERVICES SHOWN HEREON.
7. RIDGE, EAVE & GUTTER HEIGHTS HAVE BEEN OBTAINED BY AN INDIRECT METHOD AND ARE ACCURATE FOR PLANNING PURPOSES ONLY.
8. ADJOINING BUILDINGS AND DWELLINGS HAVE BEEN PLOTTED FOR DIAGRAMMATIC PURPOSES ONLY AND SPECIFIC DETAILS, IF CRITICAL, WILL REQUIRE FURTHER SURVEY.
9. THE DIAMETER (ϕ), SPREAD (S) & HEIGHT (H) OF EACH TREE IS INDICATIVE ONLY AND SPECIFIC DETAILS, IF CRITICAL, WILL REQUIRE FURTHER SURVEY.
10. CONTOURS ARE AN INDICATION OF THE TOPOGRAPHY ONLY. SPOT LEVELS SHOULD BE USED IF DETAILED DESIGN IS TO BE UNDERTAKEN.
11. CONTOUR INTERVAL XXXXMETRE.

AE	ARCHITECTURAL EMBELLISHMENT	EG	EAGE OF GARDEN	SSM	STATE SURVEY MARK
AP	ALIGNMENT PIN	ELEC	ELECTRICITY PIT	ST	STAY VALVE
APN	APPROACH	ED	EDGE OF PATH	STM	STORM WATER
BALC	BALCONY	ER	EDGE OF ROAD	TARCH	TOP OF ARCH
BANW	BOTTOM OF AWNING	FCE	FENCE	TAWN	TOP OF AWNING
BO	BOTTOM OF BANK	FL	FLOOR LEVEL	TBN	TOP OF BANK
BOCH	BOTTOM OF CHIMNEY	FFL	FINISHED FLOOR LEVEL	TBL	TELSTRA BOX
BOB	BOTTOM OF DOOR	FP	FENCE POST	TCH	TOP OF CHIMNEY
BOV	BOTTOM OF VALVE	GD	GLASS DOOR	TDD	TOP OF DOOR
BF	BOTTOM OF FENCE	GL	GROUND LEVEL	TEL	TELSTRA
BHR	BOTTOM OF HANDRAIL	GM	GAS METER	TELP	TELSTRA PILLAR
BHS	BOTTOM OF HOUSE	HPS	HIGH POWERED GAS	TF	TOP OF FENCE
BK	BOTTOM OF KERB	HR	HANDRAIL	TG	TOP OF GUTTER
BLD	BUILDING	HYD	HYDRANT	TI	TRAFFIC ISLAND
BM	BENCH MARK	IL	INVERT LEVEL	TH	TOP OF HANDRAIL
BOL	BOLTER	K	KERB	TK	TOP OF KERB
BOR	BOTTOM OF ROCK	LIN	LINEN	TL	TRAFFIC LIGHT
BRK	BRIER	LP	LAMP POST	TFP	TOP OF PARAPET
BSW	BOTTOM OF RETAINING WALL	MH	MANHOLE	TR	TREE
BW	BOTTOM OF STEPS	MUD	MUD LID	TRF	TOP OF ROOF
BW	BOTTOM OF WINDOW	NCL	NATURAL SURFACE	TR	TOP OF ROCK
BWN	BOTTOM OF WINDOW	NSC	STRUCTURE	TRW	TOP RETAINING WALL
CHM	CHIMNEY	OPT <td>OPTICAL</td> <td>TS</td> <td>TOP OF STEPS</td>	OPTICAL	TS	TOP OF STEPS
CL	CENTRELINE	PC	PEW CROSSING	TW	TOP OF WALL
CLD	CONCRETE LID	PERG	PEDESTRIAN CROSSING	TWN	TOP OF WINDOW
COL	COLUMN	PERG	PERGOLA	US	UNDERSIDE
COM	COMMUNICATIONS PIT	PM	PERMANENT MARK	UNW	UNDERSIDE OF AWNING
CNC	CORNER	PO	POWER POLE	USN	UNDERSIDE SERVICE
CP	CARPOT	POK	POCK	USB	UNDERSIDE OF BEAM
D	DOOR	POK	POCK	USC	UNDERSIDE OF CEILING
DD	DRILL HOLE	PRF	REFERENCE MARK	USF	UNDERSIDE OF FLY
DH	DRILL HOLE & WINGS	RR	ROOF RIDGE	USG	UNDERSIDE OF GUTTER
DW	DRIVEWAY	RSN	REINFORCED CONCRETE	V	VENT
EB	EDGE OF BUTTEND	SEW	SEWER	VER	VERANDAH
EDX	ELECTRICITY BOX	SHR	SHRUB	VOD	VEHICLE DRIVING
EG	EDGE OF CONCRETE	SLH	SIGNER LAMP LAMP	W	WATER
EDG	EDGE OF DOOR	SMH	SEWER MANHOLE	WM	WIND METER
		SG	SIGN POST		

C	COMMUNICATIONS CABLE	RM	RECYCLED WATER
CSWP	CERAMIC STORMWATER PIPE	RM	RISING MAIN
E	UNDERGROUND ELECTRICITY CABLES	RMS	ROADS & MARITIME SERVICES
AE	UNDERGROUND ELECTRICITY & OPTUS CABLES	S	SEWER
FS	FIRE SERVICE	SO	SEWER OUTFALL
G	GAS LINE	ST	SHARED TRENCH
GE	GAS LINE & ELECTRICITY CABLES	SW	STORM WATER
NGN	NATIONAL BROAD BAND CABLES	SW CK	STORMWATER CREEK
NB	NATURAL GAS LINE	T	TELSTRA CABLES
OH	OVERHEAD CABLES	TG	TELSTRA & GAS CABLES
OPT	OPTUS CABLE	U	UNKNOWN SERVICE
PE	PRIVATE ELECTRICITY	V	VOCUS CABLES
PS	PRIVATE SEWER	VR	VERIZON CABLES
PW	PRIVATE WATER	W	WATER SUPPLY
		WM	WATER MAIN

1. ALL UNDERGROUND SERVICE INFORMATION INCLUSIVE OF GENERAL POSITION AND SURFACE COVER DEPTHS NOTED ON THE PLAN ARE APPROXIMATELY ONLY.
2. ALL UNDERGROUND SERVICE INFORMATION HAS BEEN COMPILED FROM SERVICE AUTHORITY PLANS PROVIDED BY THE AUTHORITIES.
3. THE LOCATION OF SERVICES BETWEEN SURVEYED POINTS (AS INDICATED) HAVE BEEN SHOWN DIAGRAMMATICALLY ONLY USING THE SERVICE DIAGRAMS AS PROVIDED. THE EXACT LOCATION OF THESE SERVICES BETWEEN THE SURVEYED POINTS MUST BE DETERMINED PRIOR TO EXCAVATION. NO WARRANTY OR GUARANTEE IS GIVEN AGAINST THE POSSIBILITY OF THE EXISTENCE OF FURTHER UNCHARTERED SERVICES.
4. ALL CONTRACTORS, TRADESMEN, BUILDING & PROJECT CONSULTANTS MUST CONTACT THE VARIOUS AUTHORITIES IN ACCORDANCE WITH THE STANDARD PRACTICES OF THE INDUSTRY PRIOR TO UNDERTAKING ANY WORKS WITHIN THE VICINITY OF THE SERVICE LINES TO VERIFY THE POSITION OF THE SERVICE LINES.



0 5 10 15 20 25 30 35 40 45 50

LENGTHS ARE IN METRES

TITLE No: 1/DP1252952
DATUM: A.H.D.
DATE OF SURVEY: 16.0
SURVEYOR: AR
DRAFTER: CC

REF:140632
ISSUE:1
ISSUE DATE:06.04.20
SHEET SIZE:
SHEET 1 OF 2 SHEETS

PLAN SHOWING 'PAVILIONS'
BUILDING 2 & 5 IN PROXIMITY
TO THE SYDNEY OLYMPIC
PARK RAIL LOOP CORRIDOR



PLAN SHOWING WORK AS EXECUTED PILE LOCATION
IN RELATION TO DP1252952 BOUNDARIES.
No. 2 FIGTREE DRIVE, SYDNEY OLYMPIC PARK

• W..... - DENOTES WORK AS EXECUTED PILE
LOCATION VIDE WARD CIVIL DRAWING:
679 WAE PILES 200116.dxf

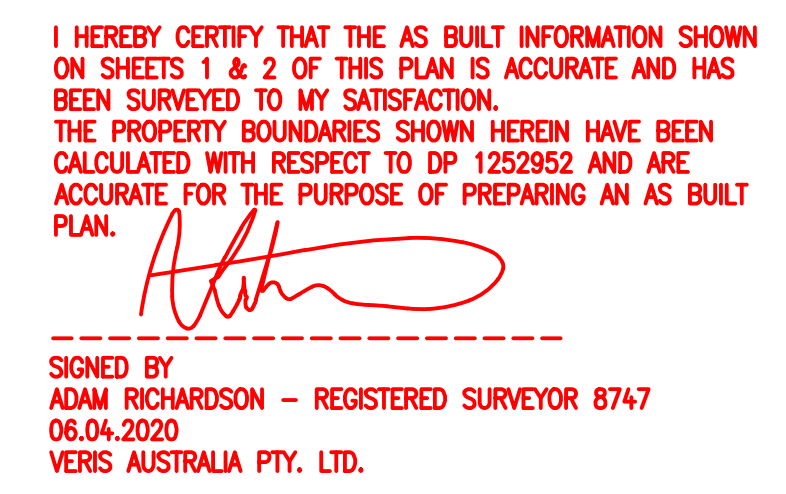

TYPICAL NOTES:

1. ORIGIN OF LEVELS SSM 0000, R.L.00.000 (A.H.D.)
2. BEARINGS ARE ON MGA NORTH
3. NO BOUNDARY SURVEY HAS BEEN UNDERTAKEN.
4. BEARINGS & DISTANCES HAVE BEEN COMPILED FROM TITLE AND/OR DEED INFORMATION SUPPLIED BY DEPARTMENT OF LANDS NSW.
5. RELATIONSHIP OF IMPROVEMENTS AND DETAIL TO BOUNDARIES IS DIAGRAMMATIC ONLY AND SPECIFIC DETAILS, IF CRITICAL, WILL REQUIRE FURTHER SURVEY.
6. SERVICES SHOWN ARE BASED ON VISIBLE SURVEY INDICATORS EVIDENT AT THE DATE OF SURVEY AND THE RELEVANT SERVICE DATA FROM THE VARIOUS AUTHORITIES. ALL SERVICE MUST BE VERIFIED ON SITE PRIOR TO ANY WORK BEING UNDERTAKEN. WEST AUSTRALIA PTY LTD BEAR NO RESPONSIBILITY FOR THE ACCURACY OR COMPLETENESS OF THE SERVICES SHOWN HEREON.
7. RIDGE, CAVE & GUTTER HEIGHTS HAVE BEEN OBTAINED BY AN INDIRECT METHOD AND ARE ACCURATE FOR PLANNING PURPOSES ONLY.
8. ADJOINING BUILDINGS AND DWELLINGS HAVE BEEN PLOTTED FOR DIAGRAMMATIC PURPOSES ONLY AND SPECIFIC DETAILS, IF CRITICAL, WILL REQUIRE FURTHER SURVEY.
9. THE DIAMETER (ϕ), SPREAD (S) & HEIGHT (H) OF EACH TREE IS INDICATIVE ONLY AND SPECIFIC DETAILS, IF CRITICAL, WILL REQUIRE FURTHER SURVEY.
10. CONTOURS ARE AN INDICATION OF THE TOPOGRAPHY ONLY. SPOT LEVELS SHOULD BE USED IF DETAILED DETAIL IS TO BE UNDERTAKEN.
11. CONTOUR INTERVAL XXX METRE.

LEGEND OF TYPICAL SERVICES			
— C —	COMMUNICATIONS CABLE	— RW —	RECYCLED WATER
— CSWP —	CERAMIC STORMWATER PIPE	— RM —	RISING MAIN
— E —	UNDERGROUND ELECTRICITY CABLES	— RMS —	ROADS & MARITIME SERVICES
— AE — AO —	UNDERGROUND ELECTRICITY & OPTUS CABLES	— S —	SEWER
— FS —	FIRE SERVICE	— SO —	SEWER OUTFALL
— G —	GAS LINE	— ST —	SHARED TRENCH
— GE —	GAS LINE & ELECTRICITY CABLES	— SW —	STORM WATER
— NBN —	NATIONAL BROAD BAND CABLES	— SW — CK —	STORMWATER CREEK
— NG —	NATURAL GAS LINE	— T —	TELESTRA CABLES
— OH —	OVERHEAD CABLES	— TG —	TELESTRA & GAS CABLES
— OPT —	OPTUS CABLE	— U —	UNKNOWN SERVICE
— PE —	PRIVATE ELECTRICITY	— VO —	VOCUS CABLES
— PS —	PRIVATE SEWER	— VR —	VERIZON CABLES
— PW —	PRIVATE WATER	— W —	WATER SUPPLY
		— WM —	WATER MAIN

1. ALL UNDERGROUND SERVICE INFORMATION INCLUSIVE OF GENERAL POSITION AND SURFACE COVER DEPTHS NOTED ON THE PLAN ARE APPROXIMATELY ONLY.
2. ALL UNDERGROUND SERVICE INFORMATION HAS BEEN COMPILED FROM SERVICE AUTHORITY PLANS PROVIDED BY THE AUTHORITIES.
3. THE LOCATION OF SERVICES BETWEEN SURVEYED POINTS (AS INDICATED) HAVE BEEN SHOWN DIAGRAMMATICALLY ONLY USING THE SERVICE DIAGRAMS AS PROVIDED. THE EXACT LOCATION OF THESE SERVICES BETWEEN THE SURVEYED POINTS MUST BE VERIFIED PRIOR TO ANY EXCAVATION OR PILING. NO WARRANTY IS GIVEN AGAINST THE POSSIBILITY OF THE EXISTENCE OF FURTHER UNCHARTED SERVICES.
4. ALL CONTRACTORS, TRADESMEN, BUILDING & PROJECT CONSULTANTS MUST CONTACT THE VARIOUS AUTHORITIES, IN ACCORDANCE WITH STANDARD "DIAL BEFORE YOU DIG" PROCEDURES PRIOR TO UNDERTAKING ANY WORKS WITHIN THE VICINITY OF THE SERVICE LINES TO VERIFY THE POSITION OF THE SERVICE LINES.

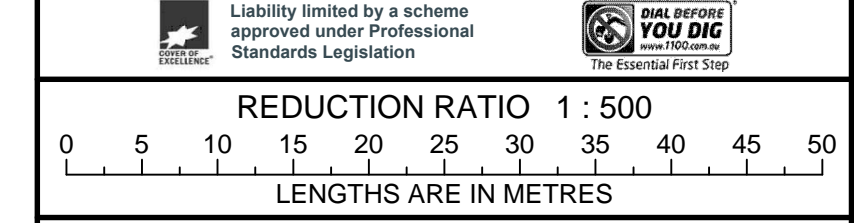

CLIENT: MIRVAC	
TITLE No: 1/DP1252952	REF: 140632
DATUM: A.H.D.	ISSUE:1
DATE OF SURVEY: 16.01.20	ISSUE DATE:06.04.20
SURVEYOR: AR	SHEET SIZE:
DRAFTER: CC	SHEET 2 OF 2 SHEETS

<p>PLAN SHOWING 'PAVILIONS' BUILDING 2 & 5 IN PROXIMITY TO THE SYDNEY OLYMPIC PARK RAIL LOOP CORRIDOR</p>	
	<p>Veris Australia Pty Ltd Suite 301, Level 3, 55 Holt Street Surry Hills NSW 2012 PO Box 1807 Strawberry Hills NSW 2012 t: (02) 92124655 email: surryhills@veris.com.au web site: www.veris.com.au</p>