

- GENERAL NOTES:**
- THIS DRAWING IS TO BE READ IN CONJUNCTION WITH ENDEAVOUR ENERGY'S RELEVANT TERMS AND CONDITIONS AND THE FOLLOWING ENDEAVOUR ENERGY DOCUMENTS:
 MCI0006 - UNDERGROUND CONSTRUCTION STANDARDS
 MCI0005 - OVERHEAD CONSTRUCTION STANDARDS
 - ENDEAVOUR ENERGY CONTACT PHONE: 131 081
 - DESIGN CERTIFICATION SHALL LAPSE WHERE:
 (i) NOTICE OF INTENT HAS NOT BEEN RECEIVED WITHIN SIX (6) MONTHS OF THIS CERTIFICATION; OR
 (ii) CONSTRUCTION HAS BEEN INTERRUPTED FOR MORE THAN SIX (6) MONTHS.
 WHERE DESIGN CERTIFICATION HAS LAPSED, THE DESIGN MUST BE RESUBMITTED FOR CERTIFICATION BY THE LEVEL 3 ACCREDITED SERVICE PROVIDER (ASP).
 - ATTENTION:
 PERMANENT SURVEY MARKS MAY EXIST IN THIS AREA. THESE ARE TO BE LOCATED BY A SURVEYOR PRIOR TO COMMENCEMENT OF WORK.
 - ATTENTION:
 ALL SERVICES SEARCHES MUST BE CHECKED BEFORE CONSTRUCTION.
 - WARNING:
 LIVE ENDEAVOUR ENERGY CABLES & OTHER SERVICES IN THIS AREA. PLEASE CONTACT DIAL BEFORE YOU DIG ON TELEPHONE: 1100 FOR SEARCHES TWO DAYS PRIOR TO EXCAVATION.
 - ATTENTION:
 LEVEL 1 ASP TO NOTIFY ENDEAVOUR ENERGY'S ASSET DATA CUSTOMER DEPARTMENT DAILY, WHEN CABLE WORKS ARE IN PROGRESS. TELEPHONE: 131 081
 - OPERATIONAL LIMITS
 UNLESS APPROVED OTHERWISE, INTERRUPTION TO ANY CUSTOMER'S SUPPLY MUST BE AVOIDED. THE FOLLOWING ALTERNATIVES SHOULD BE CONSIDERED:
 8.1. MOBILE GENERATORS AND SUBSTATIONS
 8.2. LIVE LINE WORK
 8.3. DESIGN ALTERNATIVES
 8.4. LOW VOLTAGE PARALLELS
 8.5. WORK PRACTICES/STANDARDS
 THE COST IS TO BE FUNDED BY THE CUSTOMER/DEVELOPER.
 - EASEMENT NOTES:
 9.1. PROPOSED EASEMENT TO BE CREATED:
 9.1.1. EASEMENT FOR PADMOUNT SUBSTATIONS TBD IS TO BE CREATED, IN FAVOUR OF ENDEAVOUR ENERGY, WITHIN PROPOSED DEVELOPMENT SITE ON LOT 7 / DP1160947. RESTRICTION ON THE USE OF LAND IN RELATION TO THE FIRE RATING OF BUILDINGS, MEASURED 3 METRES FROM THE SUBSTATION PLINTH, IS TO BE CREATED, IN FAVOUR OF ENDEAVOUR ENERGY
 9.1.2. AN EASEMENT FOR UNDERGROUND CABLES MINIMUM 3m WIDE IS TO BE CREATED IN FAVOUR OF ENDEAVOUR ENERGY WITHIN PROPOSED DEVELOPMENT SITE. THE CABLES ARE TO BE CENTRALLY LOCATED WITHIN THE EASEMENT (REFER TO SHEET 2)
 - HAVE ALL EXISTING ASSETS HAVE BEEN FIELD CHECKED AND ARE ACCURATE AT THE TIME OF DESIGN? YES/NO
 - ENVIRONMENTAL MANAGEMENT PLAN: FAT 0038, IS PART OF THIS DESIGN.
 - TELECOMMUNICATION ASSETS ARE NOT AFFECTED BY PROPOSED WORKS UNDER THIS PROJECT.
 - 24 HOURS 7 DAYS UNRESTRICTED ACCESS IS REQUIRED TO THE PROPOSED PADMOUNT SUBSTATION. REFER TO MCI0006 SECTION 7.1.5
 - ALL SERVICE WORKS TO BE INSTALLED AS PER AS/NZS 3000 AND THE NSW SERVICES & INSTALLATION RULES.
 - CUSTOMER TO ARRANGE FOR INSTALLATION & CONNECTION OF SERVICE MAINS AND ANY WORK ON THE CUSTOMERS INSTALLATION BY A LEVEL 2 ASP AND ELECTRICAL CONTRACTOR.
 EXISTING PM SUB 25539 ON THE SAME LOT WILL BE REMOVED UNDER A SEPARATE PROJECT ONCE LV

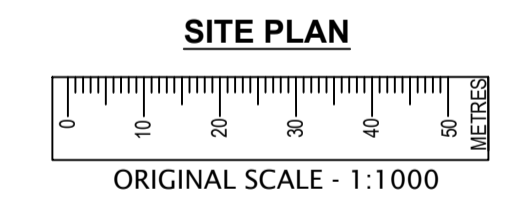
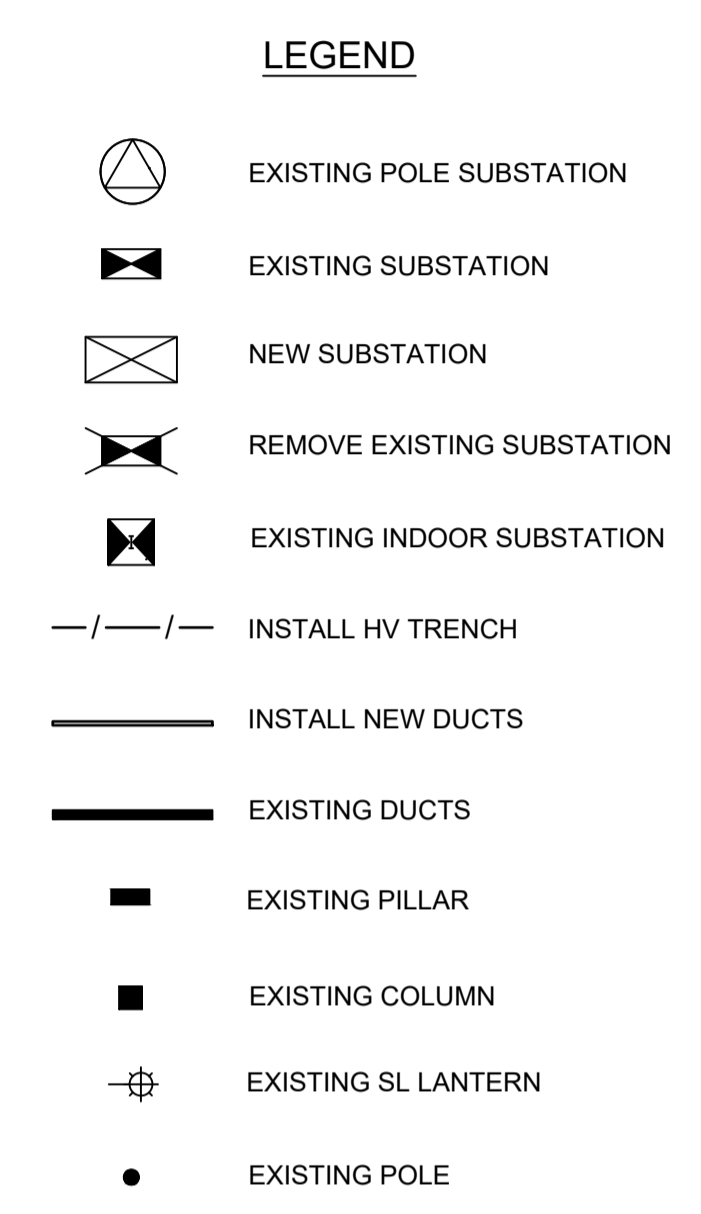

THIS DRAWING SUPPLIES ONE LOT						
C.A.P. No	FILE No	LOT No's	No. of LOTS	DEVELOPER	DEVELOPERS REP	PHONE No
UML11059	TBA	LOT 71, DP1160947	1	KEVIN PILLAY	IRT GROUP	TBA

PIONEER COST SHARE REIMBURSEMENT SCHEME NOT APPLICABLE

KEY DOCUMENTS TABLE
 THE CERTIFICATION OF THIS PROJECT IS SUPPORTED BY THE FOLLOWING KEY DOCUMENTS

DOCUMENT NAME	NOTATION DATE
SUMMARY ENVIRONMENTAL REPORT (SER) - FAT0038 part of EMS0001	TBC
PROJECT DEFINITION	TBC
EQUIPMENT TO BE RETURNED TO ENDEAVOUR ENERGY - FP4252	TBC
LIST ANY OTHER DOCUMENTS SUPPORTING THE CERTIFICATION	TBC
1) DESIGNER SAFETY REPORT	TBC

CERTIFIED BY ENDEAVOUR ENERGY
 Amendment: _____
 Date Approved: _____
 Examiner's Signature: _____
 Print Name: _____
 This Certification is issued subject to Endeavour Energy's Standard Certification Terms

AUTHORISATION OF ESTIMATE VALUE OF ENDEAVOUR ENERGY FUNDED ASSETS
 Signed: _____
 Print Name: _____
 Service Number: _____
 Funding Amount: \$ _____
 Date: _____

WORKS COMPLETED/FIELD BOOK

CONSTRUCTED BY: _____
 WORKS COMPLETED: _____
 SIGNATURE: _____ DATE: _____
 INSPECTED BY: _____
 SIGNATURE: _____ DATE: _____

ASSET RECORDING

I: _____
 OF: _____
 CONTACT No.: _____
 HEREBY CERTIFY THAT ASSETS MARKED AS-BUILT ON THIS DRAWING HAVE BEEN RECORDED AS PER ENDEAVOUR ENERGY STANDARD SAD 0004.
 SIGNATURE: _____
 DATE: _____

DESIGN COMPLIANCE AND INDEMNITY

This design complies with Endeavour Energy's relevant standards as current at this time and as listed on the Endeavour Energy Accredited Service Provider's Internet site. These standards include, but are not limited to:

CP: Connection Policy
 EMS: Environmental Management Standard
 MCI: Mains Construction Instruction
 MDI: Mains Design Instruction
 PDI: Protection Design Instruction
 SDI: Substation Design Instruction
 SAD 0001: Design Drawing Standard
 MMI: Mains Maintenance Instruction
 SMI: Substation Maintenance Instruction
 LDI 0001: Public Lighting Electrical Design Element

Additionally, where relevant, the design complies with AS/NZS 7000 "Overhead Line Design - Detailed Procedures" published by The Australian Standards.

LCI Consultants Pty Ltd. indemnifies Endeavour Energy for any loss or damage resulting from non-compliance of the design with the above standards.
 Signed: _____
 Name: _____
 Service Provider Number: _____ Date: XX/02/2025

FUNDING ARRANGEMENTS FOR SCOPE OF WORKS

ASP LEVEL 1 ELECTRICAL WORKS	CUSTOMER FUNDED NON-CONTESTABLE WORKS	CUSTOMER FUNDED
ENDEAVOUR ENERGY SUPPLIED MATERIALS	Includes but not limited to: -- Monopoly fees -- Network switching -- Substation commissioning -- Contract inspection As per fee advice issued by Endeavour Energy	Includes but not limited to: -- Pegging of easements, property boundaries & infrastructure locations -- Registering of easements, where applicable -- Providing site access -- Confirm finished ground levels
NIL		EXISTING DUCT USAGE CHARGES (exc GST)
ENDEAVOUR ENERGY FUNDED AND CONSTRUCTED	Works Required Prior to Completion of Customer Contestable Project	NIL
NIL	Works Required in Association of Customer Contestable Project	CO-ORDINATION SUPPLY REQUIRED DATE
ENDEAVOUR ENERGY FUNDED & ASP L1 CONSTRUCTED - REIMBURSEMENT (exc GST)		(TO BE CONFIRMED BY THE CUSTOMER) TBC
TBC	CUSTOMER FUNDED CONTESTABLE WORKS	ASSETS TO BE RETURNED TO NEAREST ENDEAVOUR ENERGY DEPOT BY L1 ASP
	All other works and materials including but not limited to: -- Trenching -- Duct installation -- Cable laying and/or installation -- Joining -- Installation of a pole -- Removing and Relocating OH mains	LBS F9697 AND SCADA EQUIPMENT

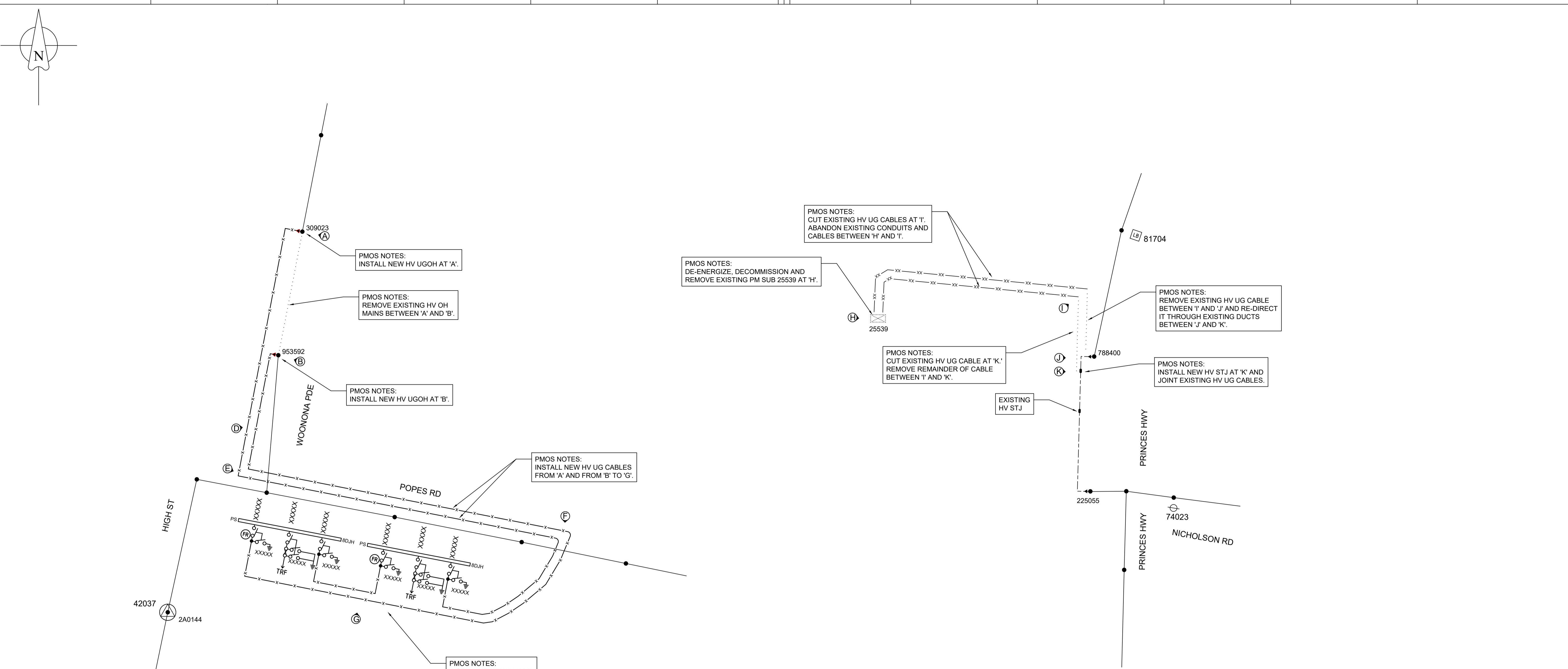

FINAL H.V. CIRCUIT
NOT TO SCALE

- EXISTING HV UG MAINS
- EXISTING HV OH MAINS
- REMOVE CABLE
- xx-xx- ABANDON CABLE
- x-x- INSTALL 240mm² CU, 3C 11KV XLPE/PVC/HDPE CABLE
R.L. = ##m C.L. = ##m
- x-x- INSTALL NEW HV STJ
- EXISTING/NEW HV STJ
- ▲ EXISTING/NEW HV UGOH
- EXISTING POLE
- LB EXISTING HV LBS (CLOSED)
- ⊖ EXISTING HV ABS (CLOSED)
- ⊕ EXISTING POLE SUBSTATION
- ⊗ REMOVE PM SUBSTATION

WORKS COMPLETED/FIELD BOOK

CONSTRUCTED BY: _____

WORKS COMPLETED: _____

SIGNATURE: _____ DATE: _____

INSPECTED BY: _____

SIGNATURE: _____ DATE: _____

ASSET RECORDING

I: _____

OF: _____

CONTACT No.: _____

HEREBY CERTIFY THAT ASSETS MARKED AS-BUILT ON THIS DRAWING HAVE BEEN RECORDED AS PER ENDEAVOUR ENERGY STANDARD SAD 0004.

SIGNATURE: _____

DATE: _____

CERTIFIED BY ENDEAVOUR ENERGY

Amendment: _____

Date Approved: _____

Examiner's Signature: _____

Print Name: _____

This Certification is issued subject to Endeavour Energy's Standard Certification Terms

AMENDMENTS ORIGINAL ISSUE DRAFT No. 01	PROJECT: 230816	 Level 5, 73 Miller St North Sydney NSW 2060 Australia Phone: 02 9157 0570 E-mail: info@lciconsultants.com.au ASP3: 5000	TEMPLATE VERSION No. 5.20 THIS DRAWING AND THE COPYRIGHT THEREIN IS THE PROPERTY OF ENDEAVOUR ENERGY AND MAY NOT BE COPIED, REPRODUCED, DISTRIBUTED, LOANED OR USED WITHOUT THE WRITTEN CONSENT OF ENDEAVOUR ENERGY.	REFERENCE DRAWING'S	WORK ORDERS	CAMS File No.	UML11059	 ORIGINAL SCALE AS SHOWN	DO NOT SCALE DIMENSIONS IN METRES GDA2020/MGAS6 COORDINATE SYSTEM	POPES ROAD WOONONA UML11059 CONNECTION OF LOAD IRT WOONONA PMOS	 535656 SHEET No. 2 OF 2 SHEETS
				GENERAL	OVERHEAD	UNDERGROUND	SUBSTATIONS				