

# THE RIBBON

## REDEVELOPMENT OF 31 WHEAT ROAD, SYDNEY

### DRAWING LIST - ARCHITECTURE

Sheet No.	Sheet Name	Revision
1000	T1	E

#### 00 - TITLE SHEETS

1000	T1	E
------	----	---

#### 01 - AREA PLANS

1052	GFA AREA SCHEDULE	G
1060	DRAFT LEASE PLAN	F
1070	GROUND FLOOR PROPOSED CLEARANCES TO RMS ROADWAY STRUCTURES	E
1071	PODIUM LEVEL PROPOSED CLEARANCES TO RMS ROADWAY STRUCTURES	C
1072	HOTEL LEVEL PROPOSED CLEARANCES TO RMS ROADWAY STRUCTURES	C
1073	PROPOSED CLEARANCES TO RMS ROADWAY STRUCTURES	C
1074	TEMPORARY CONSTRUCTION SCREEN CLEARANCES TO RMS ROADWAY STRUCTURES	C
1075	TEMPORARY CONSTRUCTION SCREEN CLEARANCES TO RMS ROADWAY STRUCTURES	C
1076	UPPER LEVELS CANTILEVER OVER RMS ROADWAY	C
1077	PROPOSED CANTILEVER OVER RMS ROADWAY	C

#### 01 - SITE SETOUT

1078	LEASE LINE RELATIONSHIP PLANS - SHEET 1	C
1079	LEASE LINE RELATIONSHIP PLANS - SHEET 2	C
1079.1	LEASE LINE RELATIONSHIP PLANS - SHEET 3	B
1080	DEMOLITION PLAN	G
1090	LOWER SITE PLAN	H
1091	UPPER SITE PLAN	E

### DRAWING LIST - ARCHITECTURE

Sheet No.	Sheet Name	Revision
1100	GA PLANS - GROUND FLOOR	H
1101	GA PLANS - PODIUM L01	H
1102	GA PLANS - PODIUM L02	D
1103	GA PLANS - PODIUM L03	D
1104	GA PLANS - PODIUM L04	D
1105	GA PLANS - HOTEL AND SERVICED APARTMENTS L05 AND L06	E
1106	GA PLANS - HOTEL AND SERVICED APARTMENTS L07 AND L08	D
1107	GA PLANS - HOTEL AND SERVICED APARTMENTS L09 AND L10	D
1108	GA PLANS - HOTEL AND SERVICED APARTMENTS L11 AND L12	D
1109	GA PLANS - HOTEL AND SERVICED APARTMENTS L13 AND L14	D
1110	GA PLANS - HOTEL AND SERVICED APARTMENTS L15 AND L16	D
1111	GA PLANS - HOTEL AND SERVICED APARTMENTS L17 AND L18	D
1112	GA PLANS - HOTEL L19 AND L20	D
1112.1	GA PLANS - HOTEL L21 AND L22	A
1112.2	GA PLANS - HOTEL L23 AND L24	-
1113	GA PLANS - ROOF	D

#### 02 - GA PLANS

1100	GA PLANS - GROUND FLOOR	H
1101	GA PLANS - PODIUM L01	H
1102	GA PLANS - PODIUM L02	D
1103	GA PLANS - PODIUM L03	D
1104	GA PLANS - PODIUM L04	D
1105	GA PLANS - HOTEL AND SERVICED APARTMENTS L05 AND L06	E
1106	GA PLANS - HOTEL AND SERVICED APARTMENTS L07 AND L08	D
1107	GA PLANS - HOTEL AND SERVICED APARTMENTS L09 AND L10	D
1108	GA PLANS - HOTEL AND SERVICED APARTMENTS L11 AND L12	D
1109	GA PLANS - HOTEL AND SERVICED APARTMENTS L13 AND L14	D
1110	GA PLANS - HOTEL AND SERVICED APARTMENTS L15 AND L16	D
1111	GA PLANS - HOTEL AND SERVICED APARTMENTS L17 AND L18	D
1112	GA PLANS - HOTEL L19 AND L20	D
1112.1	GA PLANS - HOTEL L21 AND L22	A
1112.2	GA PLANS - HOTEL L23 AND L24	-
1113	GA PLANS - ROOF	D

### DRAWING LIST - ARCHITECTURE

Sheet No.	Sheet Name	Revision
1150	GA ELEVATIONS - SHEET 1	E
1151	GA ELEVATIONS - SHEET 2	E
1152	GA ELEVATIONS - SHEET 3	E
1153	GA ELEVATIONS - SHEET 4	E
1154	GA ELEVATIONS - BUILDING 2	D

#### 05 - GA ELEVATIONS

1150	GA ELEVATIONS - SHEET 1	E
1151	GA ELEVATIONS - SHEET 2	E
1152	GA ELEVATIONS - SHEET 3	E
1153	GA ELEVATIONS - SHEET 4	E
1154	GA ELEVATIONS - BUILDING 2	D

#### 06 - GA SECTIONS

1200	GA SECTIONS - SHEET 1	D
1201	GA SECTIONS - SHEET 2	D
1202	GA SECTIONS - SHEET 3	D
1203	GA SECTIONS - SHEET 4	D
1204	GA SECTIONS - SHEET 5	D

### DRAWING LIST - ARCHITECTURE

Sheet No.	Sheet Name	Revision
1350	SECTION DETAILS	C

#### 10 - INTERFACE DETAILS

1350	SECTION DETAILS	C
------	-----------------	---

#### 27 - MISCELLANEOUS

1930	MATERIALS AND FINISHES PALETTE	D
1950	ARTIST'S IMPRESSION 1	D
1951	ARTIST'S IMPRESSION 2	D
1952	ARTIST'S IMPRESSION 3	D

#### REFERENCE MAP

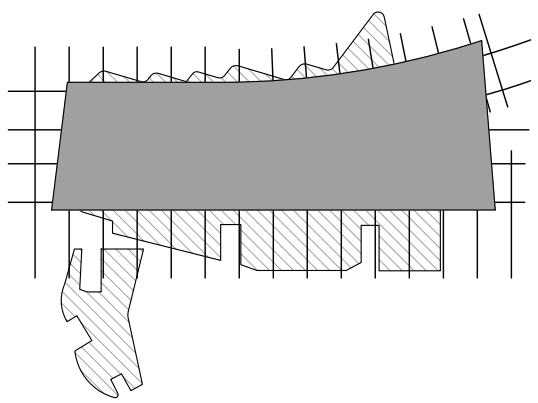

#### NOTES

- DO NOT SCALE DRAWINGS. WRITTEN DIMENSIONS GOVERN.
- ALL DIMENSIONS ARE IN MILLIMETRES UNLESS NOTED OTHERWISE.
- ALL DIMENSIONS SHALL BE VERIFIED ON SITE BEFORE PROCEEDING WITH THE WORK. HASSELL SHALL BE NOTIFIED IN WRITING OF ANY DISCREPANCIES.
- THIS DRAWING MUST BE READ IN CONJUNCTION WITH ALL RELEVANT CONTRACTS, SPECIFICATIONS AND DRAWINGS.

© COPYRIGHT OF THIS DRAWING IS VESTED IN HASSELL LTD.  
2015 HASSELL LTD.

THIS DRAWING IS AN UNCONTROLLED COPY, UNLESS NOTED OTHERWISE.

REV	DESCRIPTION	DATE
E	AMENDED DEVELOPMENT APPLICATION	21.03.16
D	AMENDED DEVELOPMENT APPLICATION	15.12.15
C	AMENDED DEVELOPMENT APPLICATION	23.10.15
B	DEVELOPMENT APPLICATION	20.08.13
A	FINAL DRAFT	23.07.13
-	ISSUED FOR INFORMATION	19.07.13

REV	DESCRIPTION	DATE
E	AMENDED DEVELOPMENT APPLICATION	21.03.16
D	AMENDED DEVELOPMENT APPLICATION	15.12.15
C	AMENDED DEVELOPMENT APPLICATION	23.10.15
B	DEVELOPMENT APPLICATION	20.08.13
A	FINAL DRAFT	23.07.13
-	ISSUED FOR INFORMATION	19.07.13

#### ARCHITECT

HASSELL Limited ABN 007 711 435  
LEVEL 2, PIER 6/9,  
23 HICKSON ROAD  
SYDNEY NSW 2000 AUSTRALIA  
SYDNEY@HASSELLSTUDIO.COM  
T +61 2 9101 2000 F +61 2 9101 2100

**HASSELL**

**RUSSELL & GEORGE**

**pmdl**

#### CLIENT

**Grocon**

#### PROJECT

THE RIBBON HOTEL,  
SERVICED APARTMENTS AND RETAIL

31 WHEAT ROAD, SYDNEY

#### DRAWING TITLE

T1

#### STATUS

FOR APPROVAL

SCALE @ B1	DRAWN	CO-ORD	REVIEWED	APPROVED
RT	JO	JO	CW	

PROJECT NUMBER	DRAWING NUMBER	REV
A004409	ARC-HSL-DD-1000	E



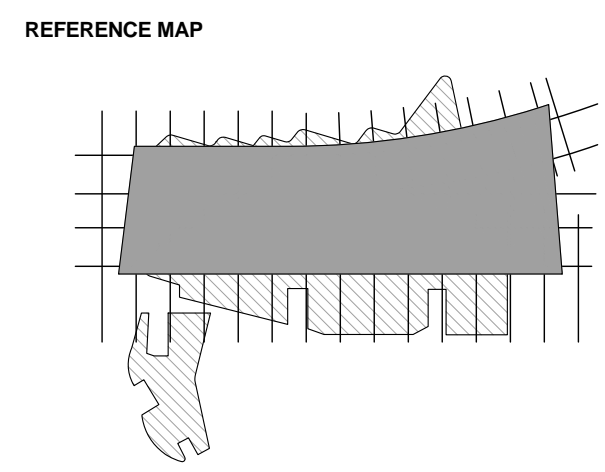
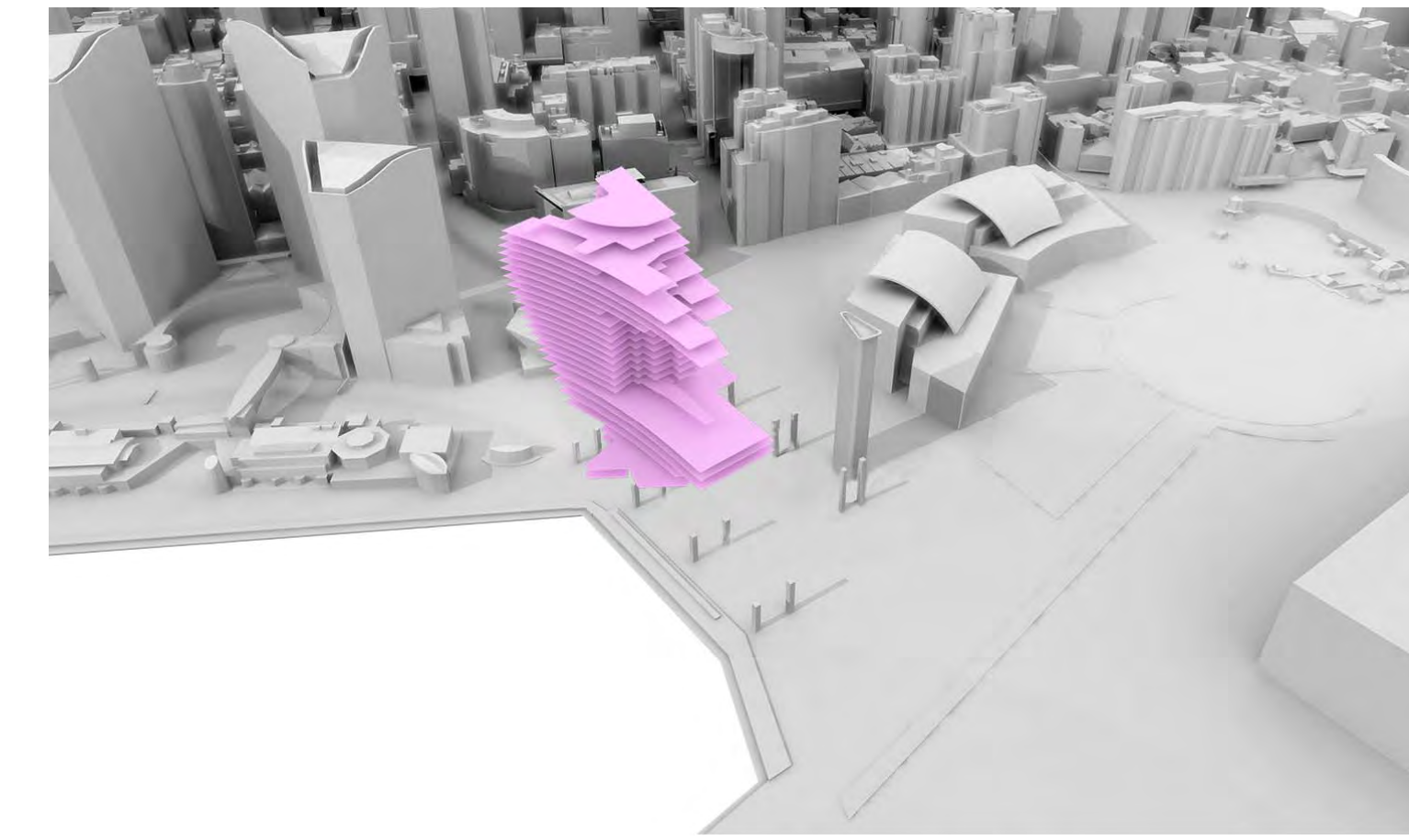
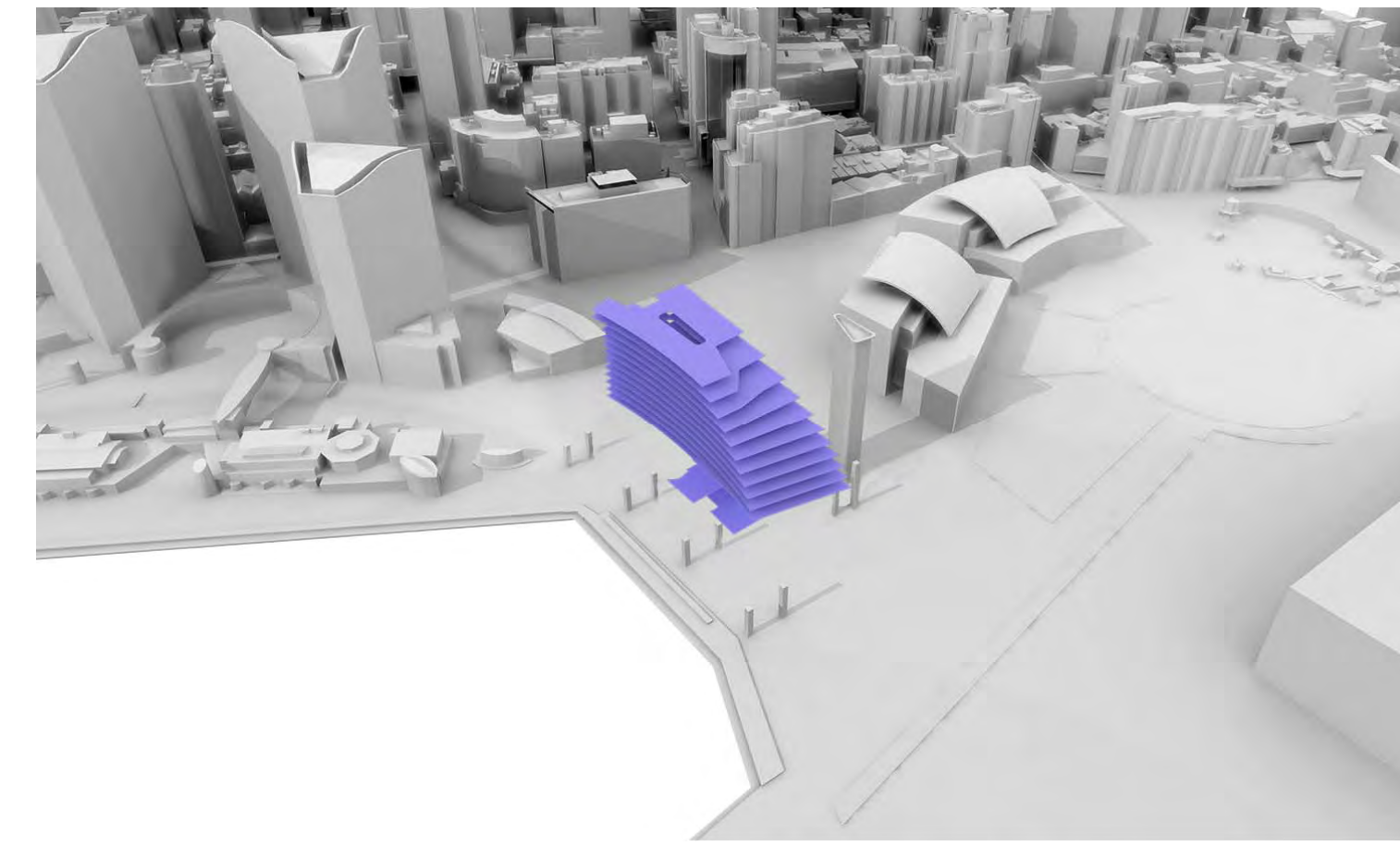
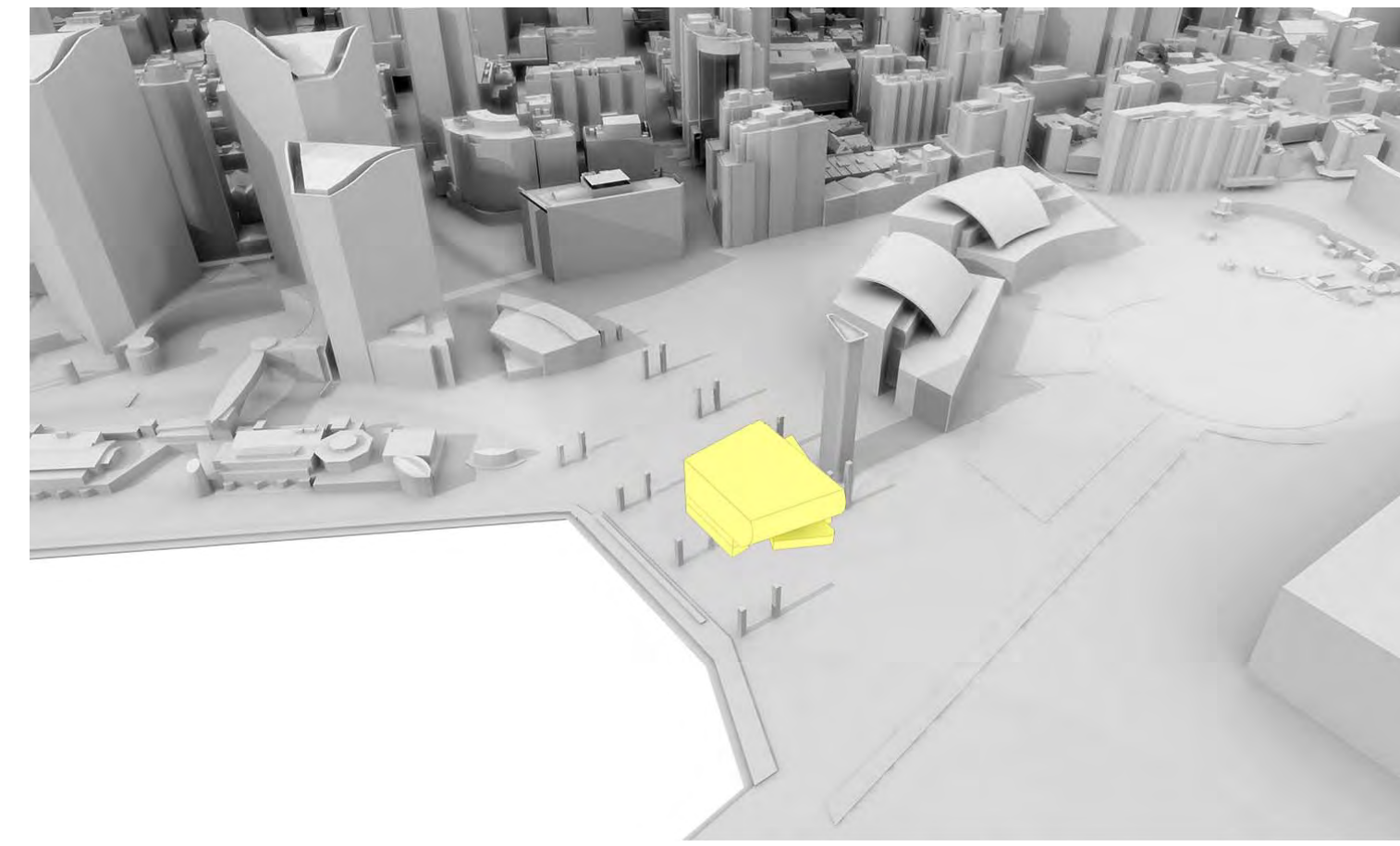
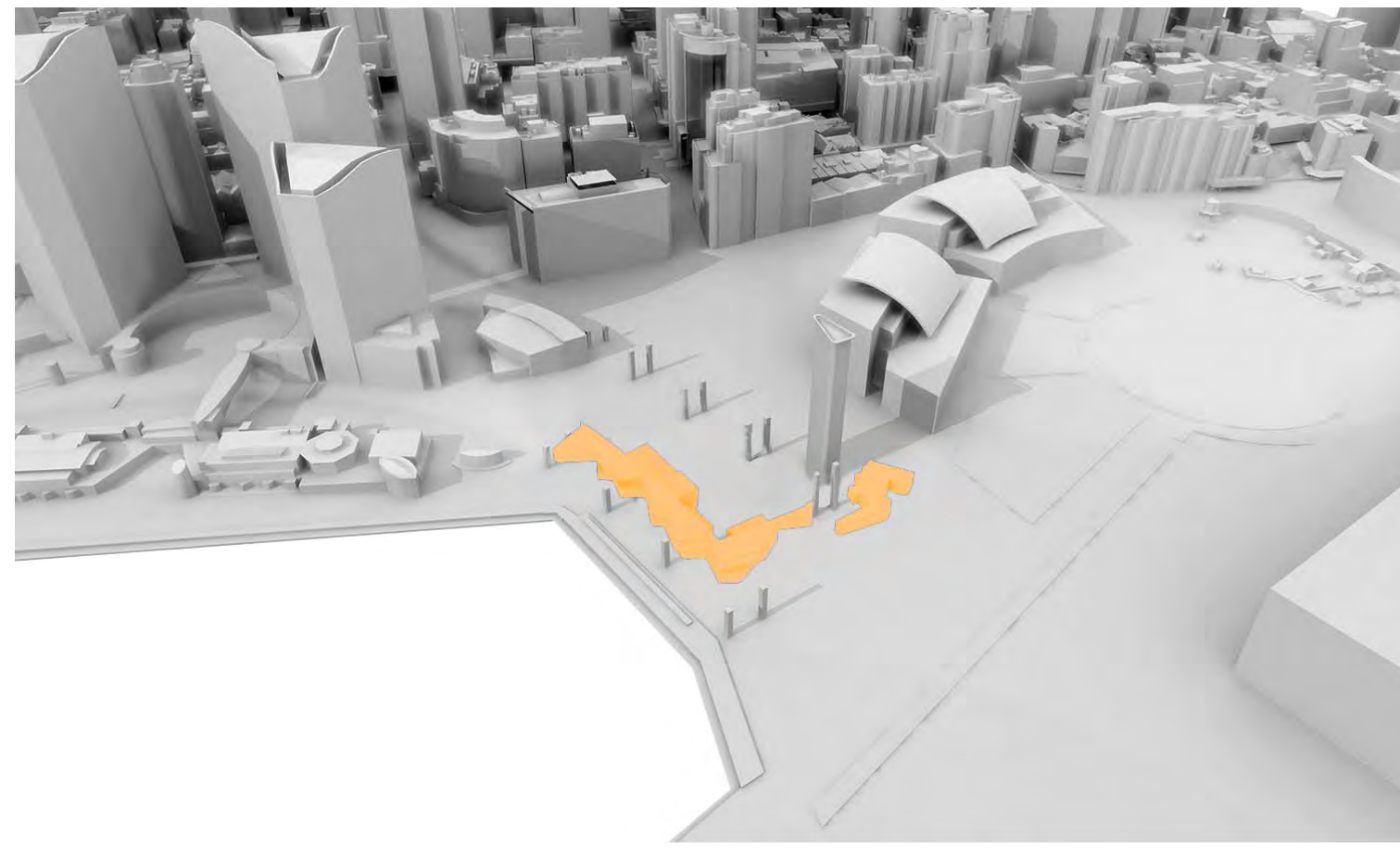

- NOTES**
- DO NOT SCALE DRAWINGS. WRITTEN DIMENSIONS GOVERN.
  - ALL DIMENSIONS ARE IN MILLIMETRES UNLESS NOTED OTHERWISE.
  - ALL DIMENSIONS SHALL BE VERIFIED ON SITE BEFORE PROCEEDING WITH THE WORK. HASSELL SHALL BE NOTIFIED IN WRITING OF ANY DISCREPANCIES.
  - THIS DRAWING MUST BE READ IN CONJUNCTION WITH ALL RELEVANT CONTRACTS, SPECIFICATIONS AND DRAWINGS.

© COPYRIGHT OF THIS DRAWING IS VESTED IN HASSELL, LTD.  
2015 HASSELL, LTD.

THIS DRAWING IS AN UNCONTROLLED COPY, UNLESS NOTED OTHERWISE.

LEVEL	RETAIL	CINEMA	SHFA	SERVICED APARTMENTS	HOTEL	CAR PARKS	TOTAL
H L24					208m <sup>2</sup>		208m <sup>2</sup>
H L23					618m <sup>2</sup>		618m <sup>2</sup>
H L22					1134m <sup>2</sup>		1134m <sup>2</sup>
H L21					876m <sup>2</sup>		876m <sup>2</sup>
H L20					1743m <sup>2</sup>		1743m <sup>2</sup>
H L19					1858m <sup>2</sup>		1858m <sup>2</sup>
H/SA L18				251m <sup>2</sup>	1830m <sup>2</sup>		2081m <sup>2</sup>
H/SA L17				371m <sup>2</sup>	1338m <sup>2</sup>		1709m <sup>2</sup>
H/SA L16				1019m <sup>2</sup>	1374m <sup>2</sup>		2393m <sup>2</sup>
H/SA L15				1183m <sup>2</sup>	1391m <sup>2</sup>		2574m <sup>2</sup>
H/SA L14				1283m <sup>2</sup>	1376m <sup>2</sup>		2659m <sup>2</sup>
H/SA L13				1378m <sup>2</sup>	1354m <sup>2</sup>		2732m <sup>2</sup>
H/SA L12				1461m <sup>2</sup>	1328m <sup>2</sup>		2789m <sup>2</sup>
H/SA L11				1628m <sup>2</sup>	1284m <sup>2</sup>		2912m <sup>2</sup>
H/SA L10				1704m <sup>2</sup>	1349m <sup>2</sup>		3053m <sup>2</sup>
H/SA L09				1864m <sup>2</sup>	1229m <sup>2</sup>		3093m <sup>2</sup>
H/SA L08				1848m <sup>2</sup>	1271m <sup>2</sup>		3119m <sup>2</sup>
H/SA L07				2124m <sup>2</sup>	1107m <sup>2</sup>		3231m <sup>2</sup>
H/SA L06		81m <sup>2</sup>		945m <sup>2</sup>	1196m <sup>2</sup>		2222m <sup>2</sup>
H L05		192m <sup>2</sup>		30m <sup>2</sup>	1143m <sup>2</sup>		1365m <sup>2</sup>
P L04		213m <sup>2</sup>		31m <sup>2</sup>	2254m <sup>2</sup>		2498m <sup>2</sup>
P L03		214m <sup>2</sup>		32m <sup>2</sup>	1895m <sup>2</sup>		2141m <sup>2</sup>
P L02		715m <sup>2</sup>		145m <sup>2</sup>	1087m <sup>2</sup>		1927m <sup>2</sup>
P L01	550m <sup>2</sup>	1049m <sup>2</sup>	301m <sup>2</sup>	31m <sup>2</sup>	971m <sup>2</sup>		2902m <sup>2</sup>
GF	1249m <sup>2</sup>	753m <sup>2</sup>	66m <sup>2</sup>	31m <sup>2</sup>	789m <sup>2</sup>		2888m <sup>2</sup>
<b>TOTAL</b>	<b>1799m<sup>2</sup></b>	<b>3217m<sup>2</sup></b>	<b>367m<sup>2</sup></b>	<b>17352m<sup>2</sup></b>	<b>31990m<sup>2</sup></b>	<b>170</b>	<b>54725m<sup>2</sup></b>

REV	DESCRIPTION	DATE
G	AMENDED DEVELOPMENT APPLICATION	21.03.16
F	AMENDED DEVELOPMENT APPLICATION	15.12.15
E	AMENDED DEVELOPMENT APPLICATION	23.10.15
D	DEVELOPMENT APPLICATION	14.01.14
C	DEVELOPMENT APPLICATION	05.09.13
B	DEVELOPMENT APPLICATION	20.08.13
A	FINAL DRAFT	23.07.13
-	ISSUED FOR INFORMATION	19.07.13

REV	DESCRIPTION	DATE
G	AMENDED DEVELOPMENT APPLICATION	21.03.16
F	AMENDED DEVELOPMENT APPLICATION	15.12.15
E	AMENDED DEVELOPMENT APPLICATION	23.10.15
D	DEVELOPMENT APPLICATION	14.01.14
C	DEVELOPMENT APPLICATION	05.09.13
B	DEVELOPMENT APPLICATION	20.08.13
A	FINAL DRAFT	23.07.13
-	ISSUED FOR INFORMATION	19.07.13

**ARCHITECT**  
HASSELL Limited ABN 007 711 435  
LEVEL 2, PIER 6/9,  
23 HICKSON ROAD  
SYDNEY NSW 2000 AUSTRALIA  
SYDNEY@HASSELLSTUDIO.COM  
T +61 2 9101 2000 F +61 2 9101 2100

**HASSELL**

**RUSSELL & GEORGE** **pmdl**

**Grocon**

**PROJECT**  
THE RIBBON HOTEL,  
SERVICED APARTMENTS AND RETAIL  
31 WHEAT ROAD, SYDNEY

**DRAWING TITLE**  
GFA AREA SCHEDULE

**STATUS**  
FOR APPROVAL

SCALE @ B1	DRAWN	CO-ORD	REVIEWED	APPROVED
	RT	JO	JO	CW
PROJECT NUMBER	DRAWING NUMBER	REV		
A004409	ARC-HSL-DD-1052	G		

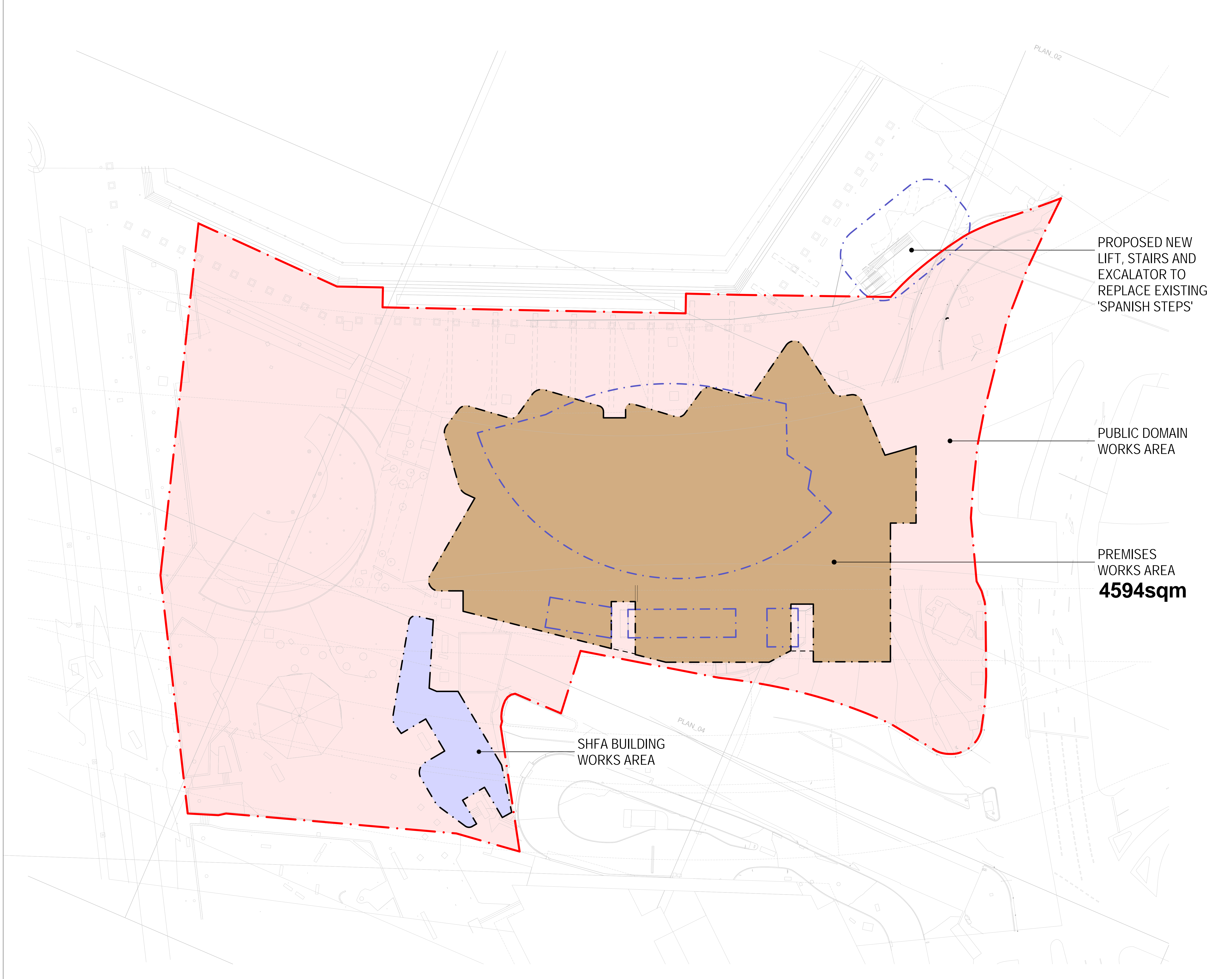

REFERENCE MAP

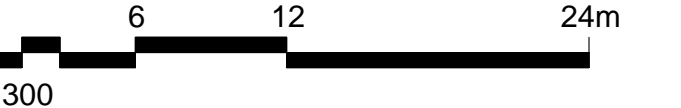
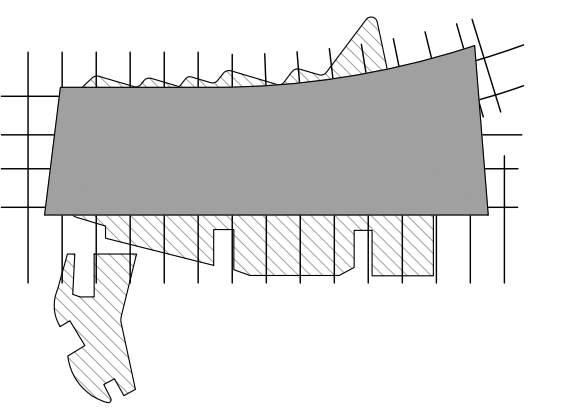

NOTES

1. DO NOT SCALE DRAWINGS. WRITTEN DIMENSIONS GOVERN.
2. ALL DIMENSIONS ARE IN MILLIMETRES UNLESS NOTED OTHERWISE.
3. ALL DIMENSIONS SHALL BE VERIFIED ON SITE BEFORE PROCEEDING WITH THE WORK. HASSELL SHALL BE NOTIFIED IN WRITING OF ANY DISCREPANCIES.
4. THIS DRAWING MUST BE READ IN CONJUNCTION WITH ALL RELEVANT CONTRACTS, SPECIFICATIONS AND DRAWINGS.

© COPYRIGHT OF THIS DRAWING IS VESTED IN HASSELL. LTD.  
2015 HASSELL. LTD.

THIS DRAWING IS AN UNCONTROLLED COPY, UNLESS NOTED OTHERWISE.

REV	DESCRIPTION	DATE
F	AMENDED DEVELOPMENT APPLICATION	21.03.16
E	AMENDED DEVELOPMENT APPLICATION	15.12.15
D	AMENDED DEVELOPMENT APPLICATION	23.10.15
C	DEVELOPMENT APPLICATION	20.12.13
B	DEVELOPMENT APPLICATION	19.12.13
A	FINAL DRAFT	20.08.13
-	ISSUED FOR INFORMATION	23.07.13

**ARCHITECT**  
HASSELL Limited ABN 007 711 435  
LEVEL 2, PIER 8/9,  
23 HICKSON ROAD,  
SYDNEY NSW 2000 AUSTRALIA  
SYDNEY@HASSELLSTUDIO.COM  
T +61 2 9101 2000 F +61 2 9101 2100

**HASSELL**

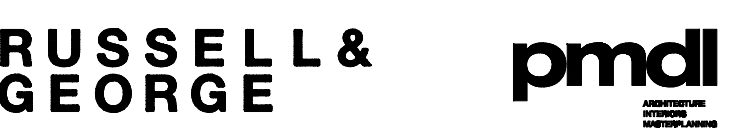

PROJECT  
**THE RIBBON HOTEL,  
SERVICED APARTMENTS AND RETAIL**  
31 WHEAT ROAD, SYDNEY

DRAWING TITLE  
**DRAFT LEASE PLAN**

STATUS  
**FOR APPROVAL**

SCALE @ B1	DRAWN	CO-ORD	REVIEWED	APPROVED
1:300	RT	JO	JO	CW
PROJECT NUMBER	DRAWING NUMBER	REV		
A004409	ARC-HSL-DD-1060			F

3/30/2016 7:57:57 AM \\server\hsl\2016\10\31\A-Plan\Working\ribhes\_working\PT004409\_TheRibbon\_DA\_Drawing\SM004409\_TheRibbon\_Hesse-DA\_160300\_0716.dwg

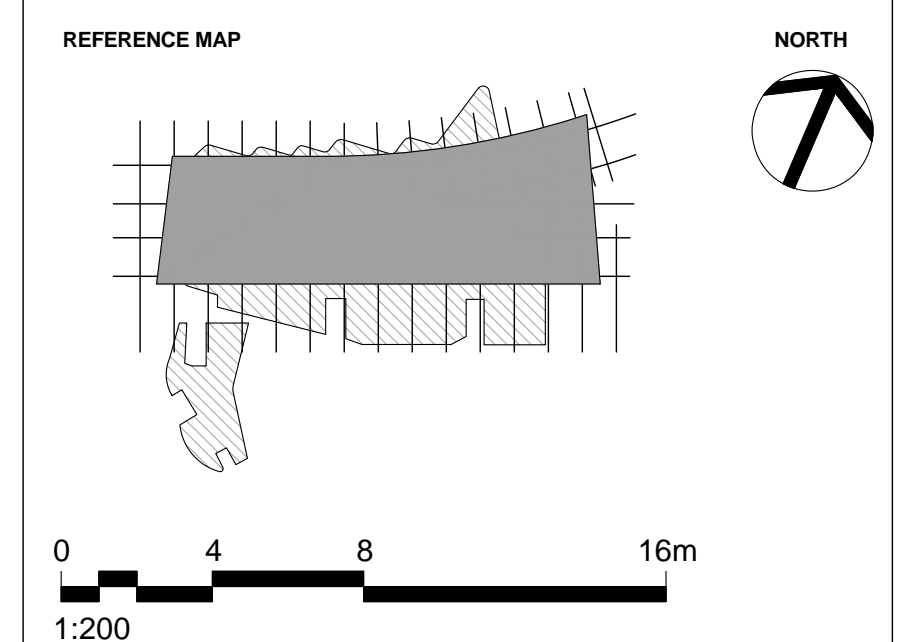
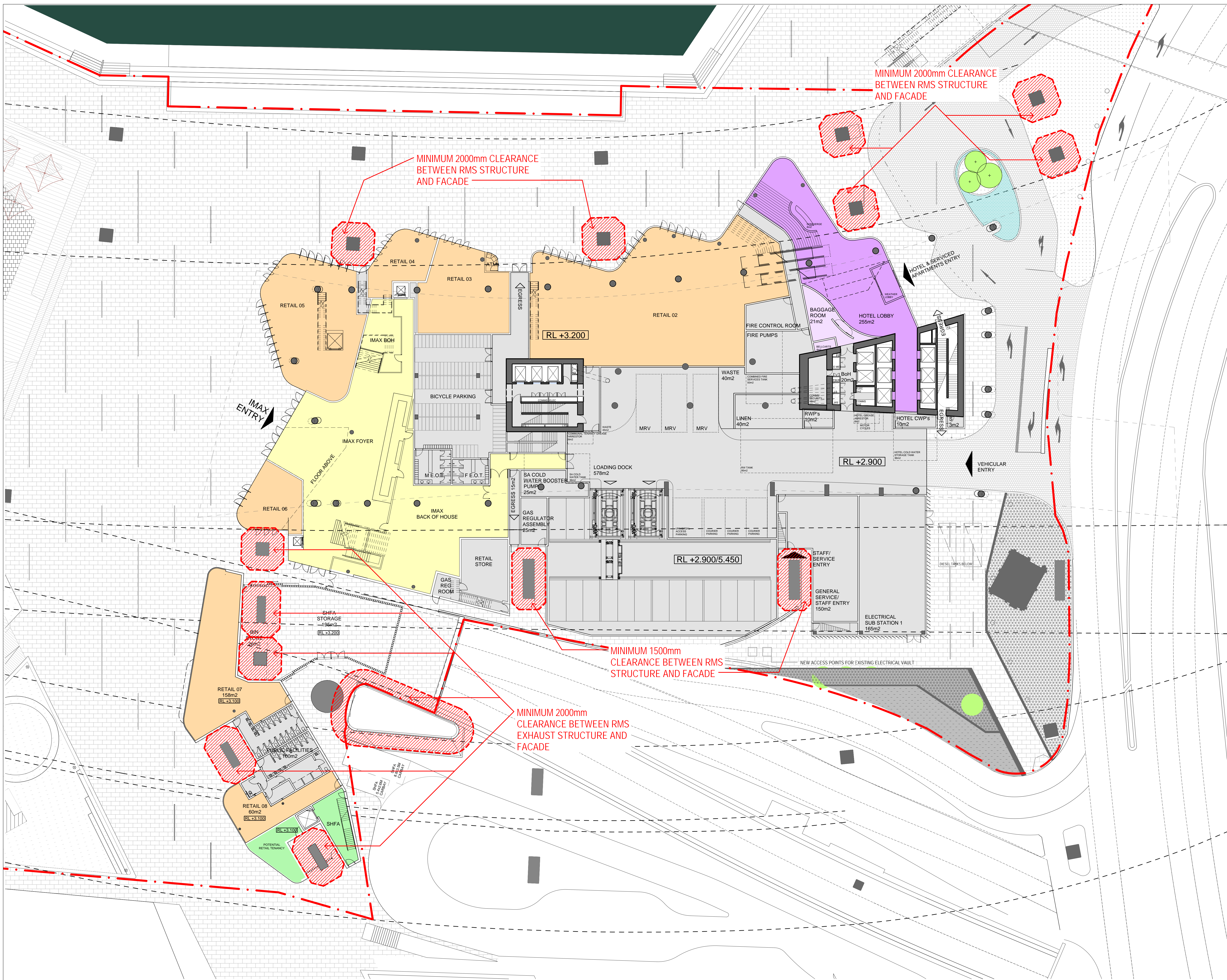

1:200

**NOTES**

- DO NOT SCALE DRAWINGS. WRITTEN DIMENSIONS GOVERN.
- ALL DIMENSIONS ARE IN MILLIMETRES UNLESS NOTED OTHERWISE.
- ALL DIMENSIONS SHALL BE VERIFIED ON SITE BEFORE PROCEEDING WITH THE WORK. HASSELL SHALL BE NOTIFIED IN WRITING OF ANY DISCREPANCIES.
- THIS DRAWING MUST BE READ IN CONJUNCTION WITH ALL RELEVANT CONTRACTS, SPECIFICATIONS AND DRAWINGS.

© COPYRIGHT OF THIS DRAWING IS VESTED IN HASSELL LTD.  
2015 HASSELL LTD.

THIS DRAWING IS AN UNCONTROLLED COPY, UNLESS NOTED OTHERWISE.

REV	DESCRIPTION	DATE
E	AMENDED DEVELOPMENT APPLICATION	30.03.16
D	AMENDED DEVELOPMENT APPLICATION	16.12.13
C	AMENDED DEVELOPMENT APPLICATION	15.12.15
B	AMENDED DEVELOPMENT APPLICATION	23.10.15
A	DEVELOPMENT APPLICATION	20.08.13
-	ISSUED FOR INFORMATION	23.07.13

**ARCHITECT**

HASSELL Limited ABN 007 711 435  
LEVEL 2, PIER 6/9,  
23 HICKSON ROAD  
SYDNEY NSW 2000 AUSTRALIA  
SYDNEY@HASSELLSTUDIO.COM  
T +61 2 9101 2000 F +61 2 9101 2100

**HASSELL**

**RUSSELL & GEORGE**

**pmdl**

**CLIENT**

**Grocon**

**PROJECT**

THE RIBBON HOTEL,  
SERVICED APARTMENTS AND RETAIL  
31 WHEAT ROAD, SYDNEY

**DRAWING TITLE**

GROUND FLOOR PROPOSED  
CLEARANCES TO RMS ROADWAY  
STRUCTURES

**STATUS**

FOR APPROVAL

SCALE @ B1	DRAWN	CO-ORD	REVIEWED	APPROVED
1:200	RT	JO	JO	CW
PROJECT NUMBER	DRAWING NUMBER	REV		
A004409	ARC-HSL-DD-1070	E		

3/30/2016 7:57:57 AM \\pmp\proj\2016\10324-61\A-P\Working\Rhines\_working\RT1004409\_TheRibbon\_DD\_Drawing\50004409\_TheRibbon\_Hesse.DA\_160300\_0706.dwg

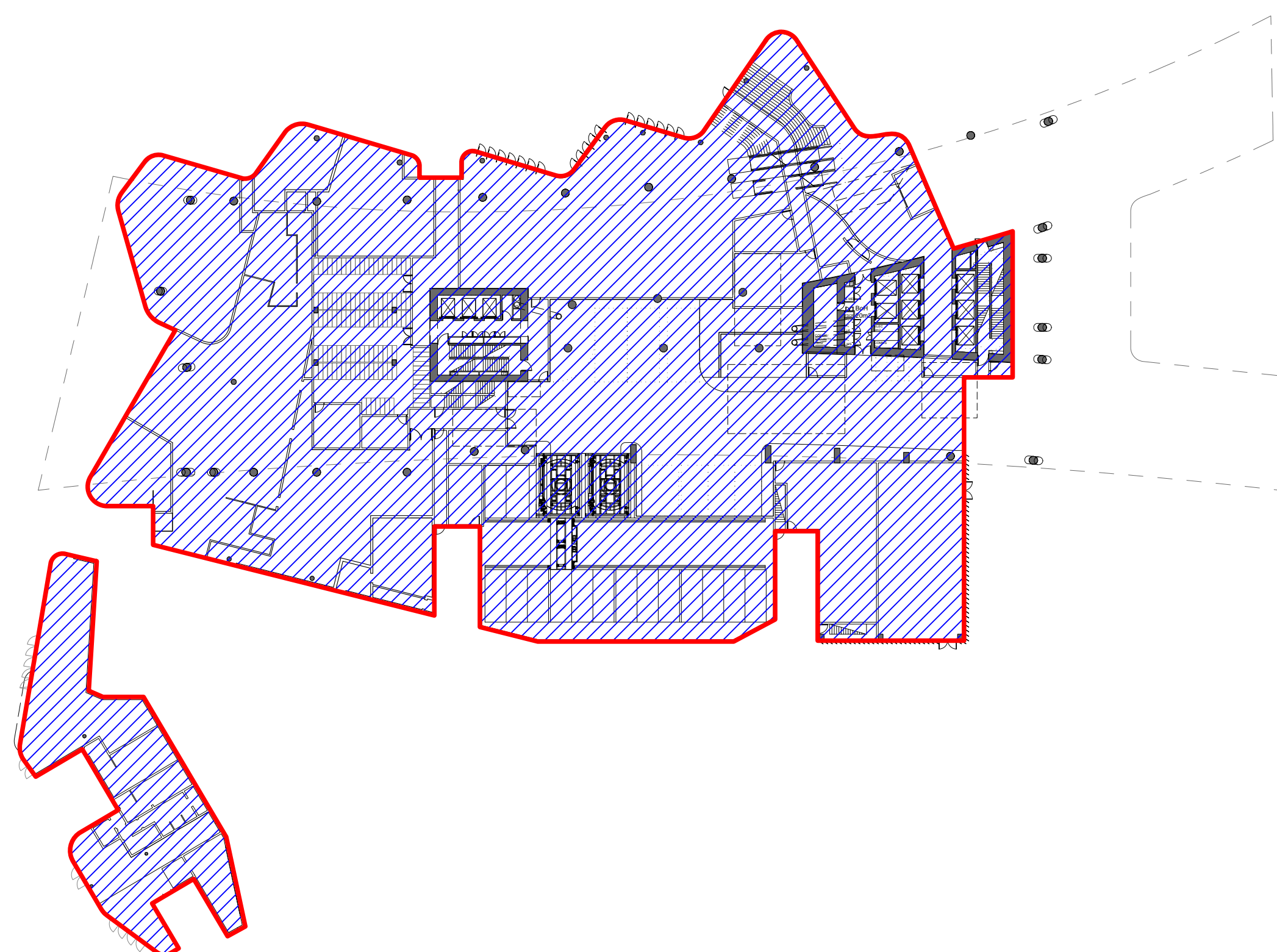

**1** GF LEASE LINE RELATIONSHIP  
1:500

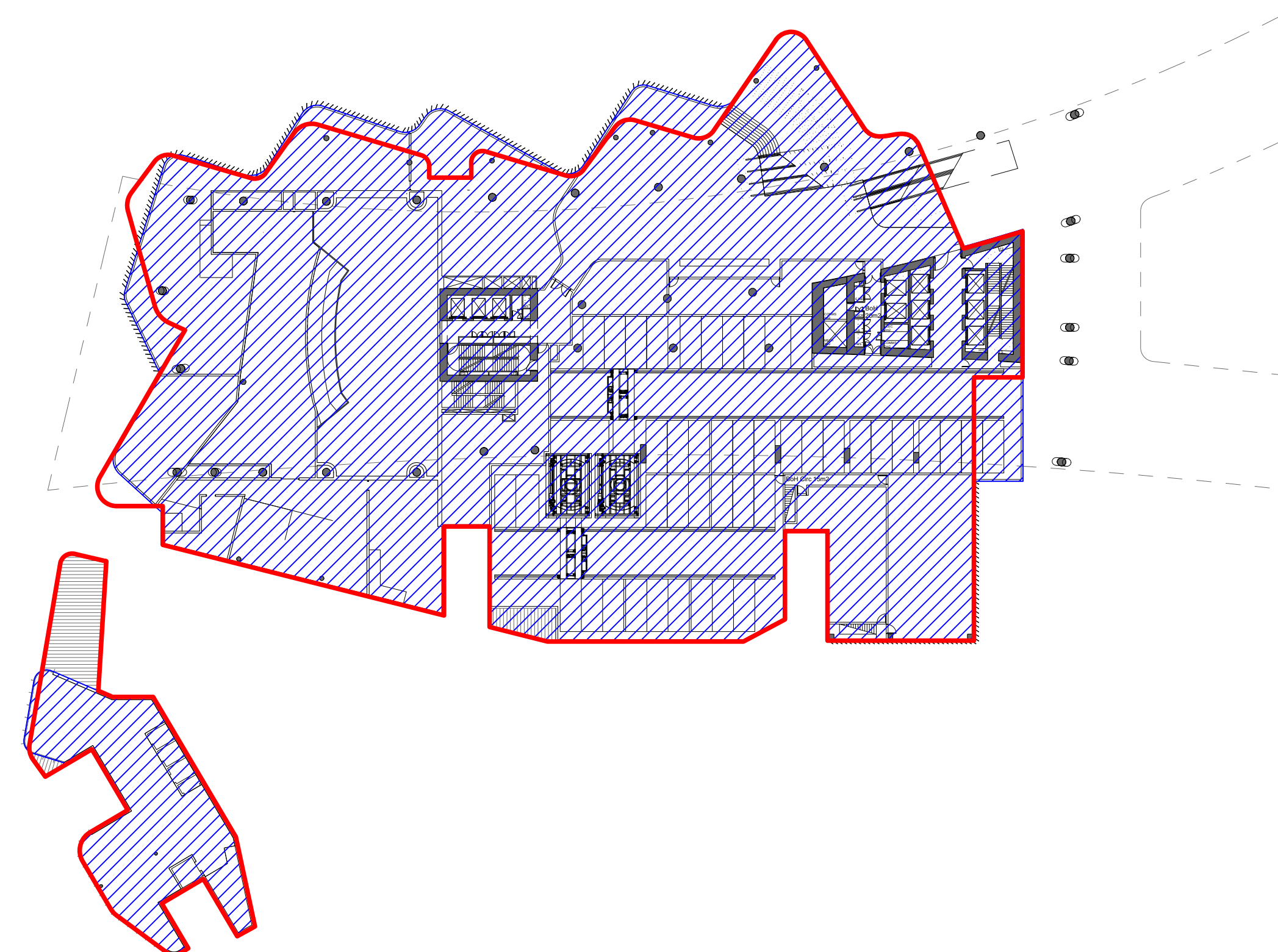

**2** PODIUM L01 LEASE LINE RELATIONSHIP  
1:500

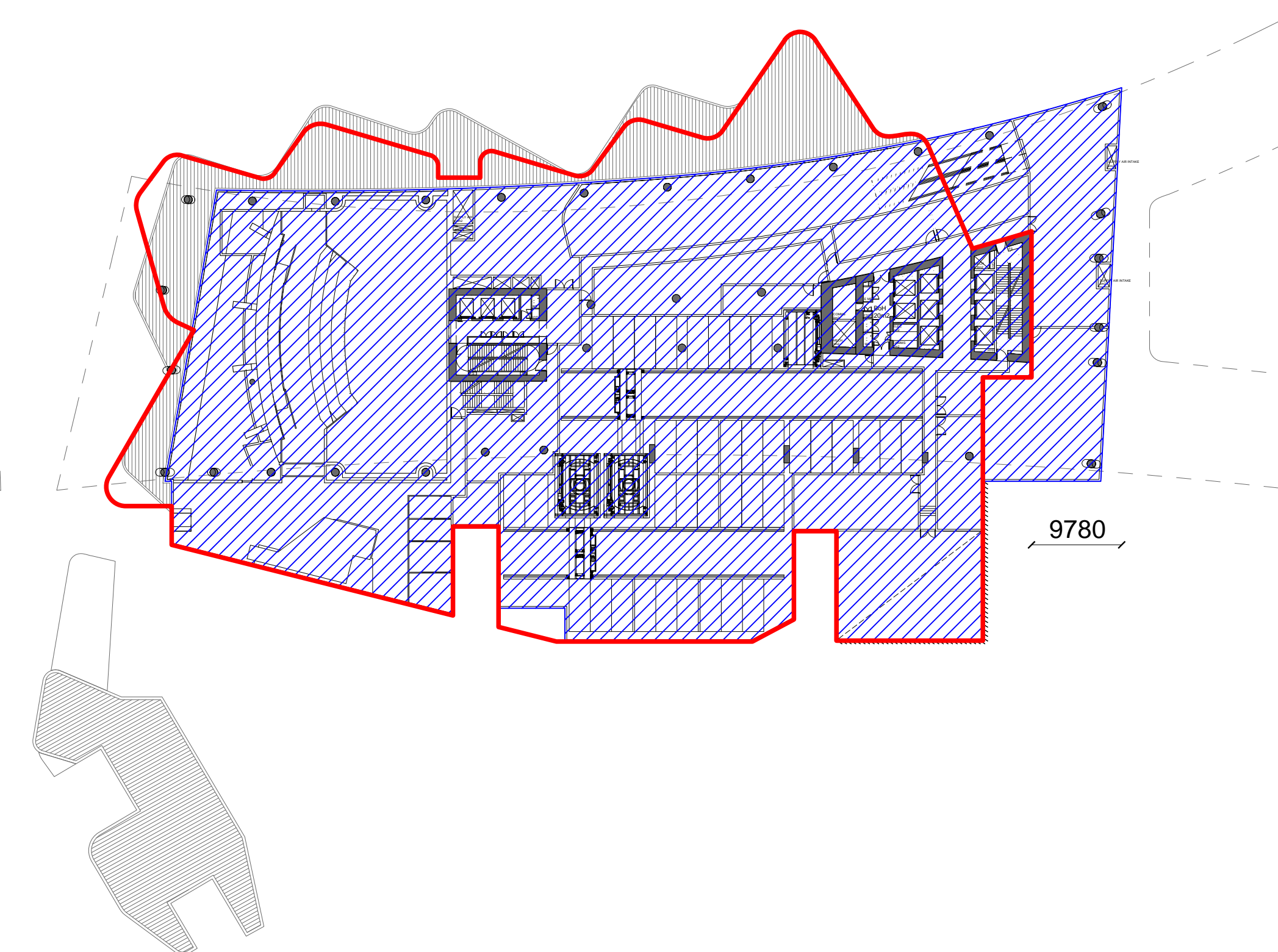

**3** PODIUM L02 LEASE LINE RELATIONSHIP  
1:500

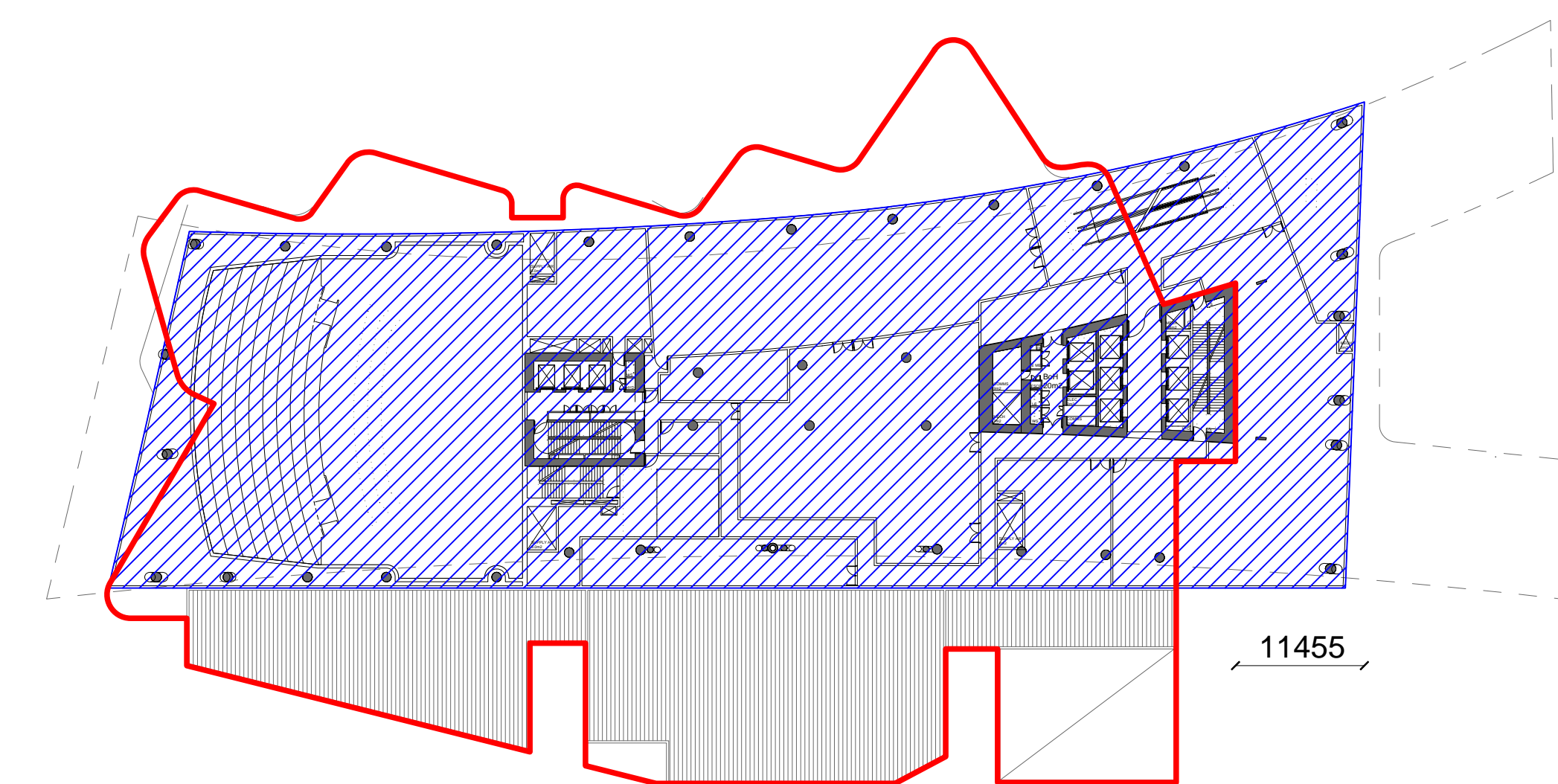

**4** PODIUM L03 LEASE LINE RELATIONSHIP  
1:500

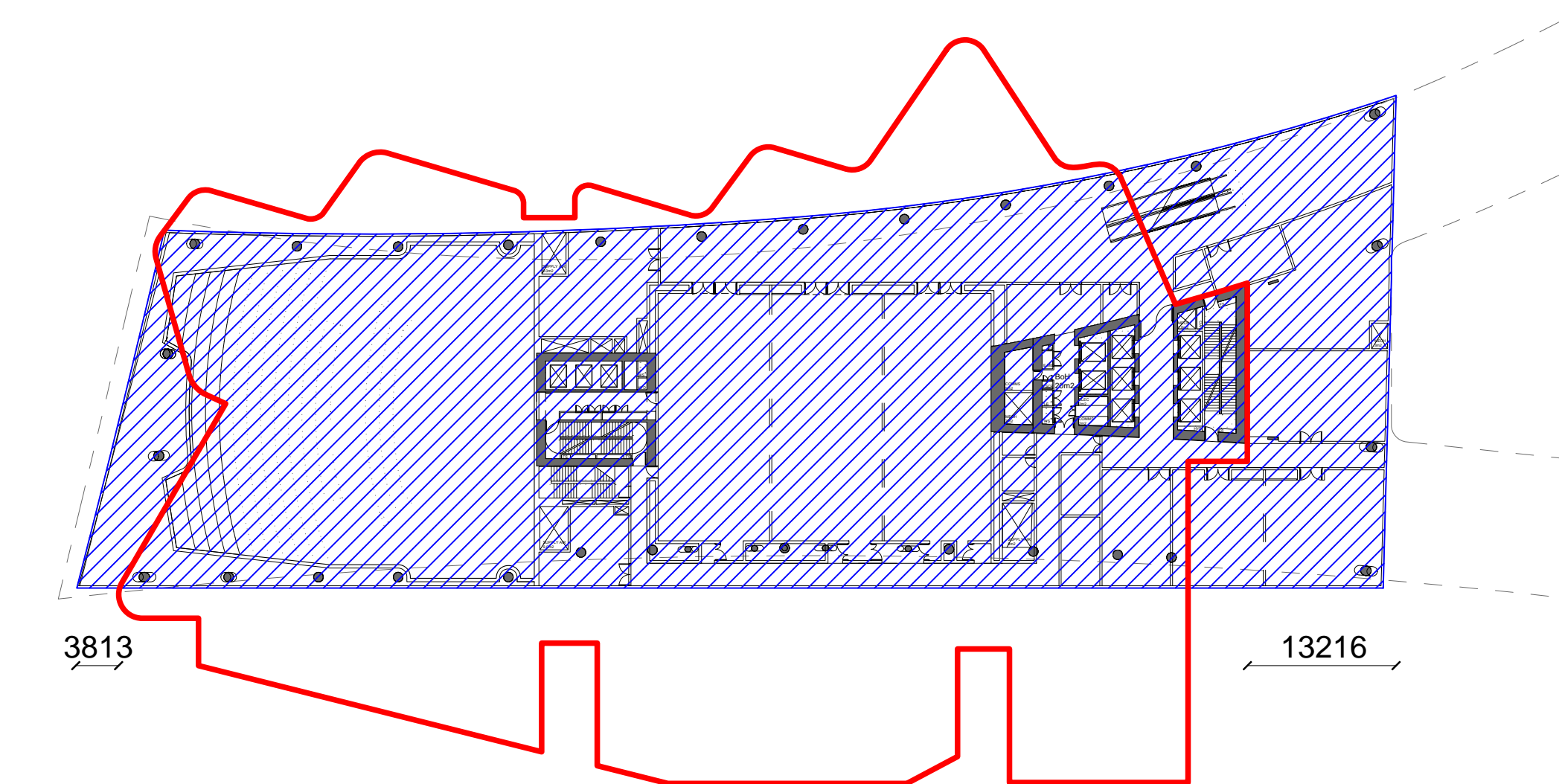

**5** PODIUM L04 LEASE LINE RELATIONSHIP  
1:500

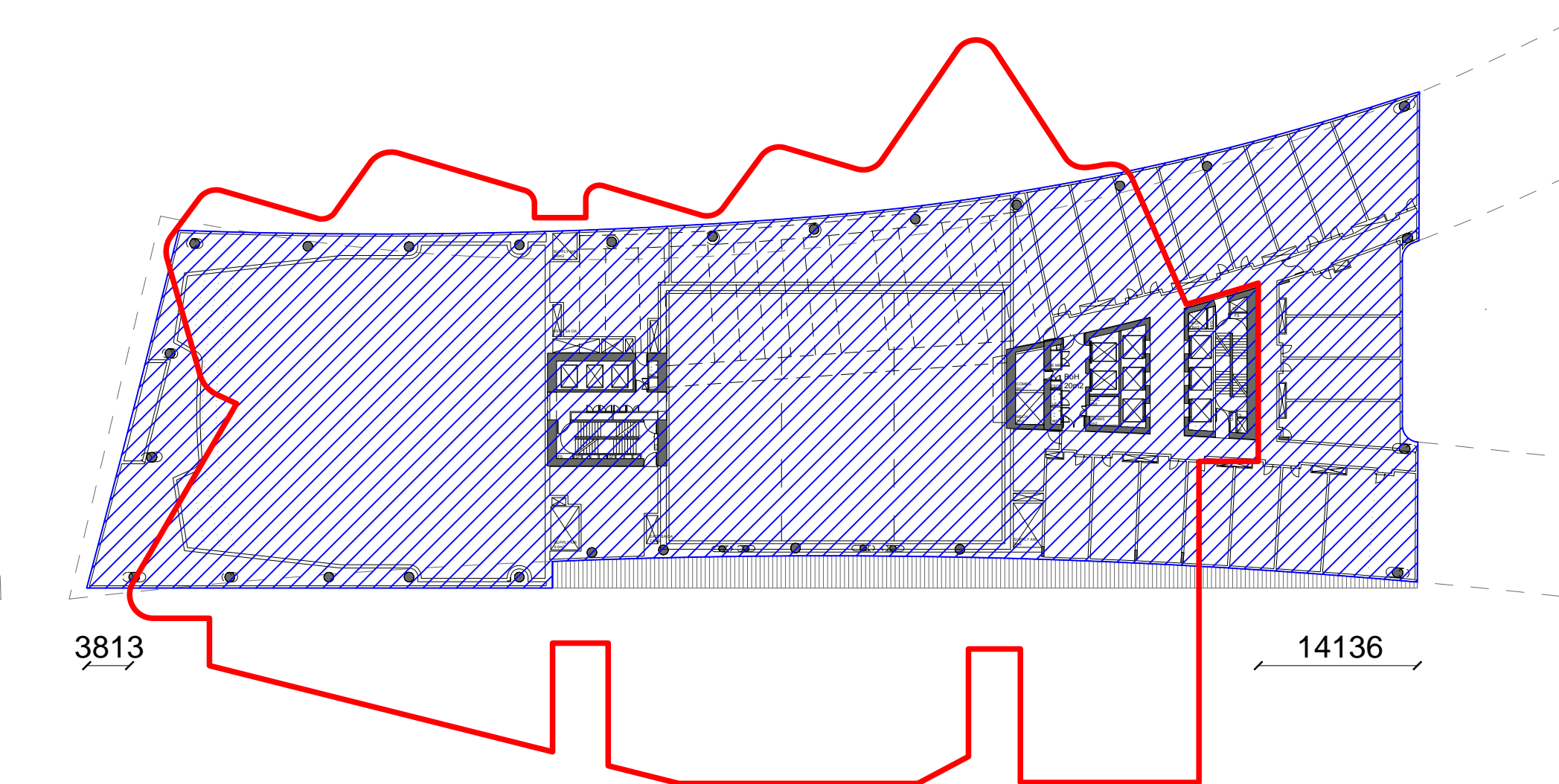

**6** HOTEL L05 LEASE LINE RELATIONSHIP  
1:500

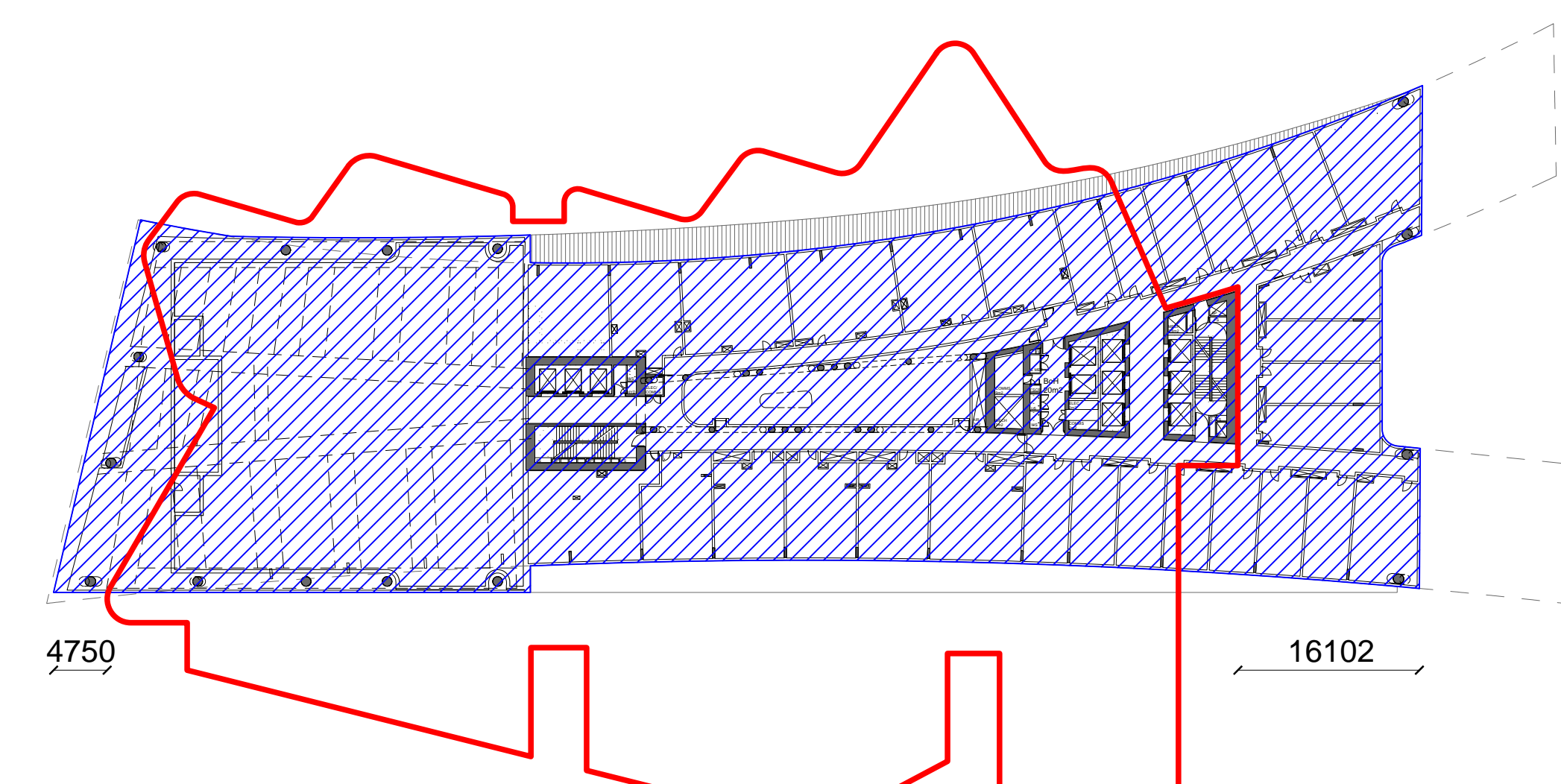

**7** HOTEL/SERVICED APARTMENTS L06 LEASE LINE RELATIONSHIP  
1:500

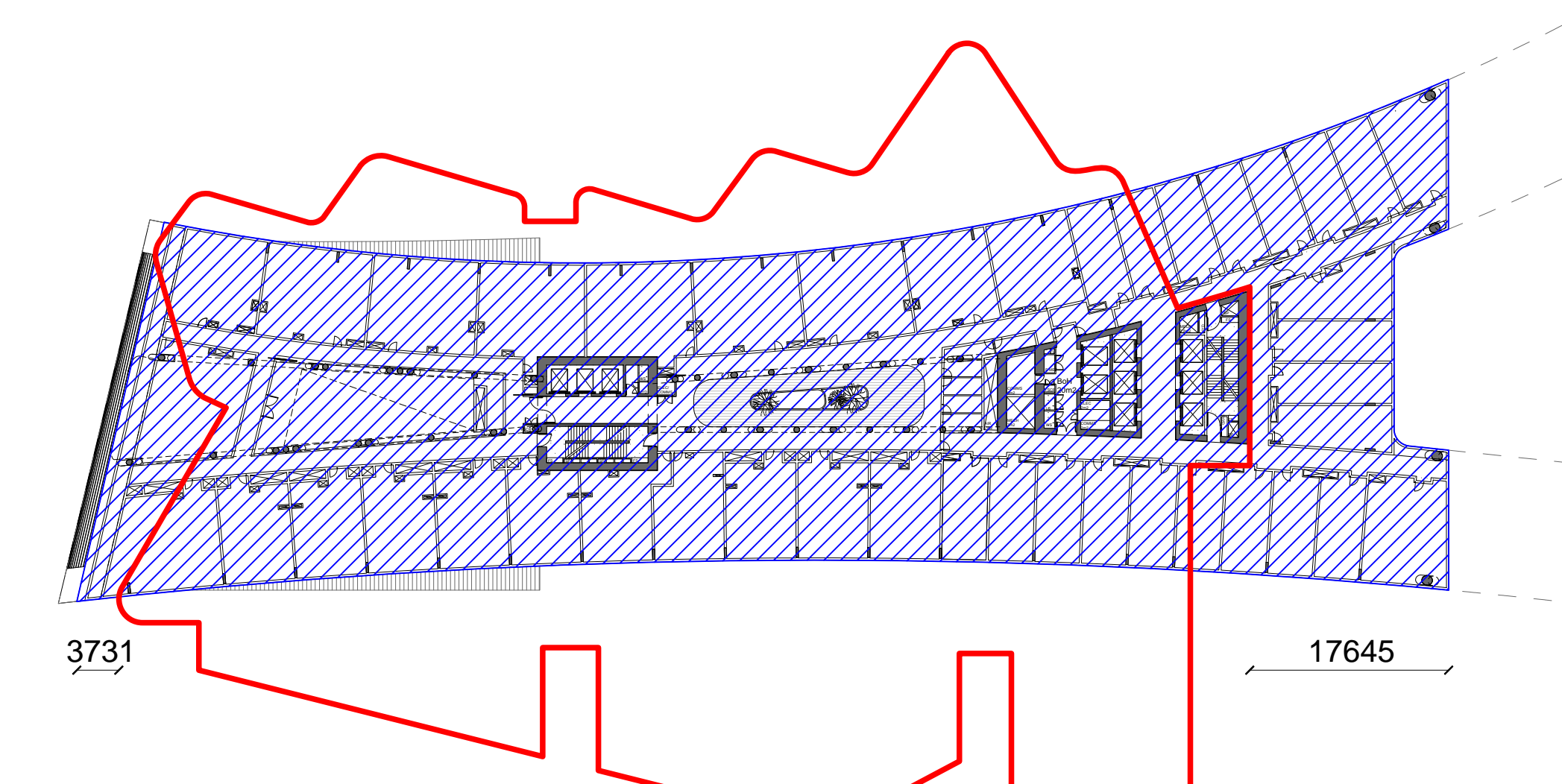

**8** HOTEL/SERVICED APARTMENTS L07 LEASE LINE RELATIONSHIP  
1:500

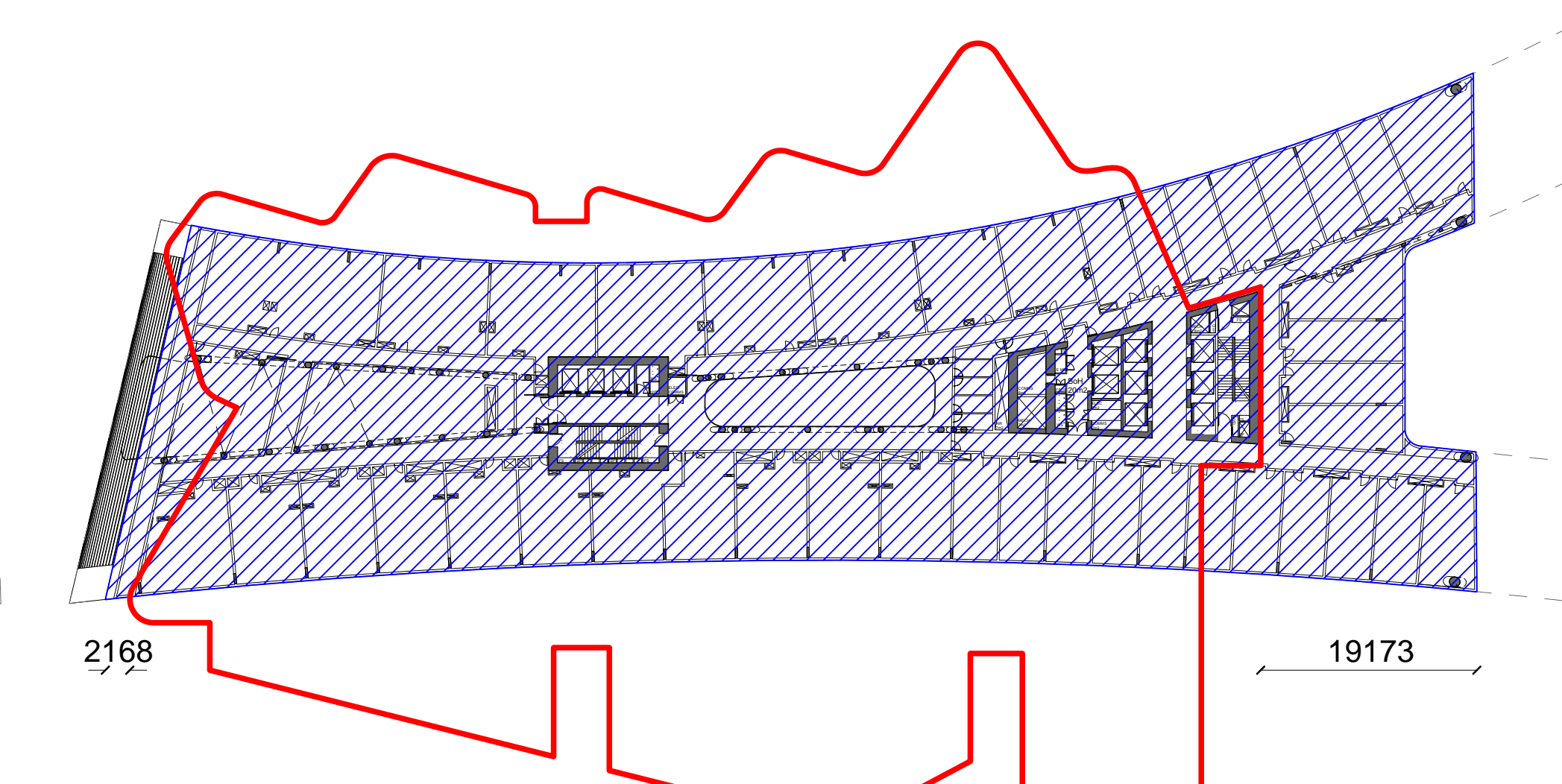

**9** HOTEL/SERVICED APARTMENTS L08 LEASE LINE RELATIONSHIP  
1:500

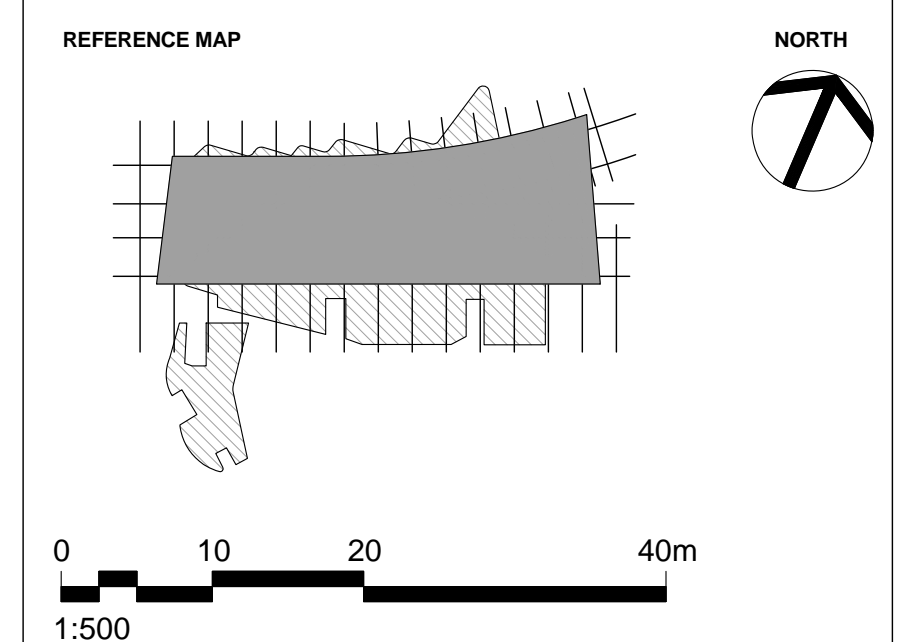

0 10 20 40m  
1:500

**NOTES**

- DO NOT SCALE DRAWINGS. WRITTEN DIMENSIONS GOVERN.
- ALL DIMENSIONS ARE IN MILLIMETRES UNLESS NOTED OTHERWISE.
- ALL DIMENSIONS SHALL BE VERIFIED ON SITE BEFORE PROCEEDING WITH THE WORK. HASSELL SHALL BE NOTIFIED IN WRITING OF ANY DISCREPANCIES.
- THIS DRAWING MUST BE READ IN CONJUNCTION WITH ALL RELEVANT CONTRACTS, SPECIFICATIONS AND DRAWINGS.

© COPYRIGHT OF THIS DRAWING IS VESTED IN HASSELL, LTD. 2015 HASSELL, LTD.

THIS DRAWING IS AN UNCONTROLLED COPY, UNLESS NOTED OTHERWISE.

REV	DESCRIPTION	DATE
C	AMENDED DEVELOPMENT APPLICATION	30.03.16
B	AMENDED DEVELOPMENT APPLICATION	15.12.15
A	AMENDED DEVELOPMENT APPLICATION	23.10.15
-	DEVELOPMENT APPLICATION	20.12.13

**ARCHITECT**  
HASSELL Limited ABN 007 711 435  
LEVEL 2, PIER 6/8,  
23 HICKSON ROAD  
SYDNEY NSW 2000 AUSTRALIA  
SYDNEY@HASSELLSTUDIO.COM  
T +61 2 9101 2000 F +61 2 9101 2100

**HASSELL**

**RUSSELL & GEORGE** **pmdl**

**CLIENT**  
**Grocon**

**PROJECT**  
THE RIBBON HOTEL,  
SERVICED APARTMENTS AND RETAIL  
31 WHEAT ROAD, SYDNEY

**DRAWING TITLE**  
LEASE LINE RELATIONSHIP PLANS -  
SHEET 1

**STATUS**  
FOR APPROVAL

SCALE @ B1 1:500	DRAWN RT	CO-ORD JO	REVIEWED JO	APPROVED CW
PROJECT NUMBER A004409	DRAWING NUMBER ARC-HSL-DD-1078	REV C		

3/30/2016 7:56:10 AM \\pmp\proj\2016\10324-614-P\Working\Ribon\_Leasing\RT\004409\_TheRibbon\_DA\_DrawingSheet004409\_TheRibbon\_DA\_DrawingSheet004409\_TheRibbon\_Hess.DA\_160300\_0756.3am

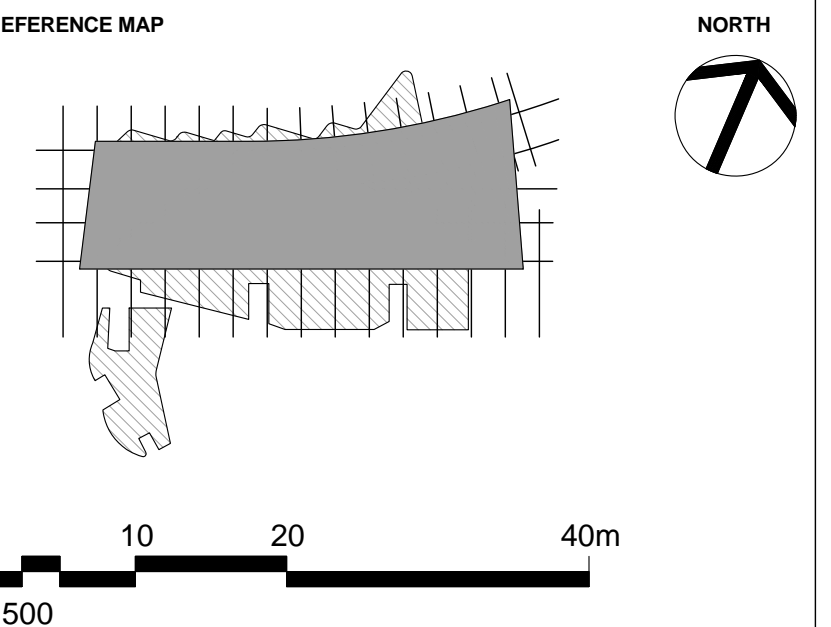

- NOTES**
- DO NOT SCALE DRAWINGS. WRITTEN DIMENSIONS GOVERN.
  - ALL DIMENSIONS ARE IN MILLIMETRES UNLESS NOTED OTHERWISE.
  - ALL DIMENSIONS SHALL BE VERIFIED ON SITE BEFORE PROCEEDING WITH THE WORK. HASSELL SHALL BE NOTIFIED IN WRITING OF ANY DISCREPANCIES.
  - THIS DRAWING MUST BE READ IN CONJUNCTION WITH ALL RELEVANT CONTRACTS, SPECIFICATIONS AND DRAWINGS.

© COPYRIGHT OF THIS DRAWING IS VESTED IN HASSELL, LTD. 2015 HASSELL, LTD.  
THIS DRAWING IS AN UNCONTROLLED COPY, UNLESS NOTED OTHERWISE.

REV	DESCRIPTION	DATE
C	AMENDED DEVELOPMENT APPLICATION	30.03.16
B	AMENDED DEVELOPMENT APPLICATION	15.12.15
A	AMENDED DEVELOPMENT APPLICATION	23.10.15
-	DEVELOPMENT APPLICATION	20.12.13

**ARCHITECT**  
HASSELL Limited ABN 007 711 435  
LEVEL 2, PIER 6/8,  
23 HICKSON ROAD  
SYDNEY NSW 2000 AUSTRALIA  
SYDNEY@HASSELLSTUDIO.COM  
T +61 2 9101 2000 F +61 2 9101 2100

**HASSELL**

**RUSSELL & GEORGE** **pmdl**

**CLIENT**  
**Grocon**

**PROJECT**  
THE RIBBON HOTEL,  
SERVICED APARTMENTS AND RETAIL  
31 WHEAT ROAD, SYDNEY

**DRAWING TITLE**  
LEASE LINE RELATIONSHIP PLANS -  
SHEET 2

**STATUS**  
FOR APPROVAL

SCALE @ B1	DRAWN	CO-ORD	REVIEWED	APPROVED
1:500	RT	JO	JO	CW
PROJECT NUMBER	DRAWING NUMBER	REV		
A004409	ARC-HSL-DD-1079	C		

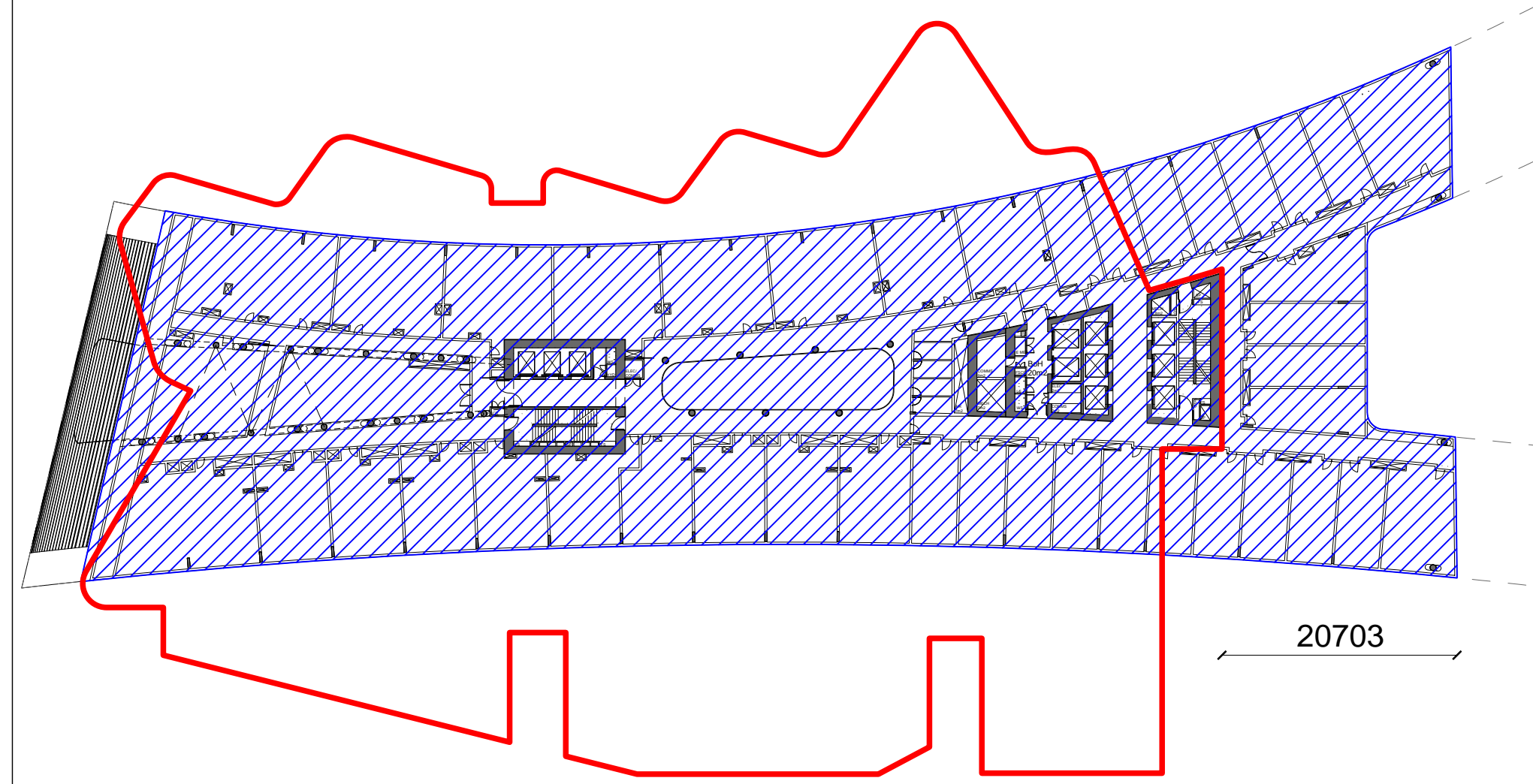

**1** HOTEL/SERVICED APARTMENTS L09 LEASE LINE RELATIONSHIP  
1:500

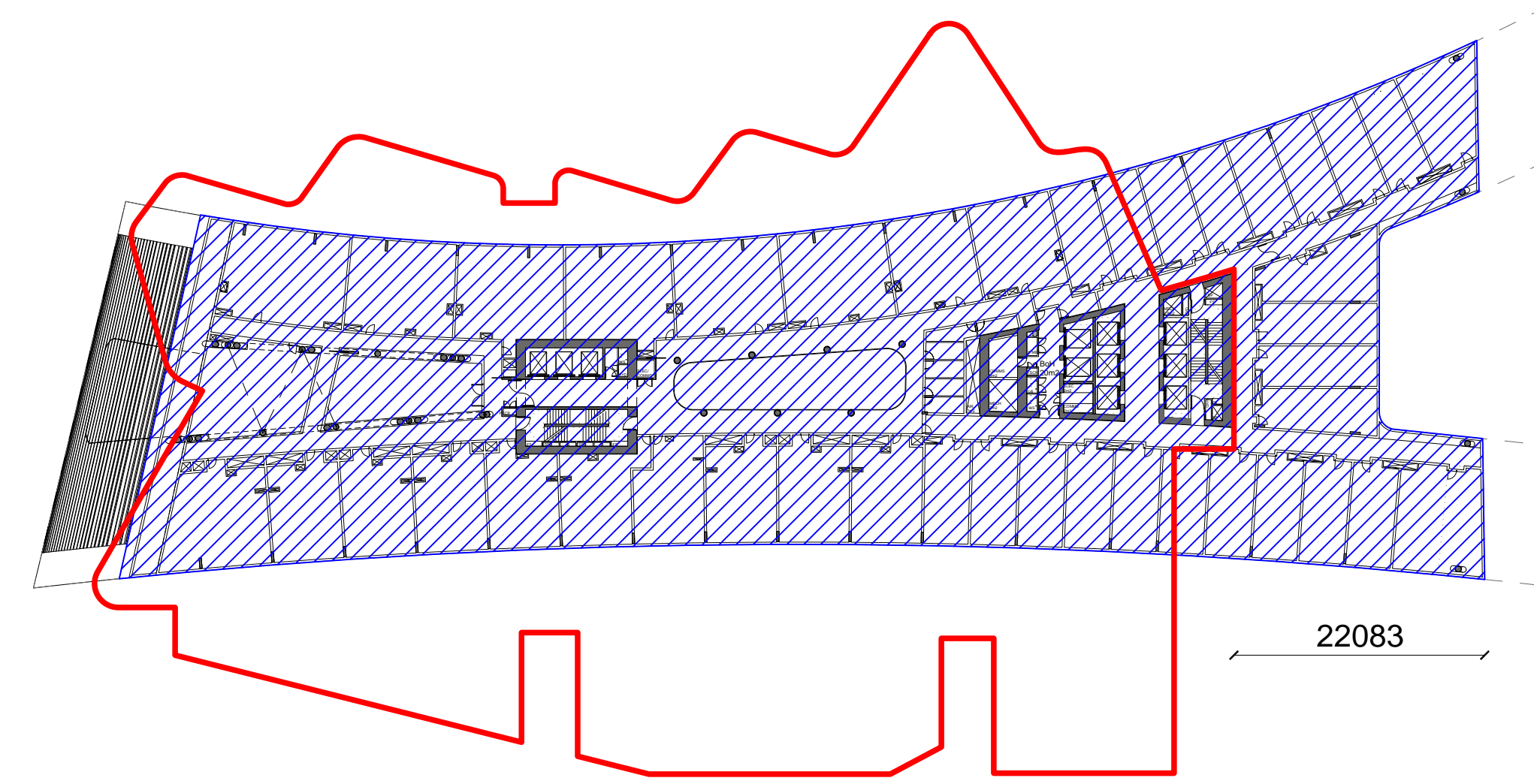

**2** HOTEL/SERVICED APARTMENTS L10 LEASE LINE RELATIONSHIP  
1:500

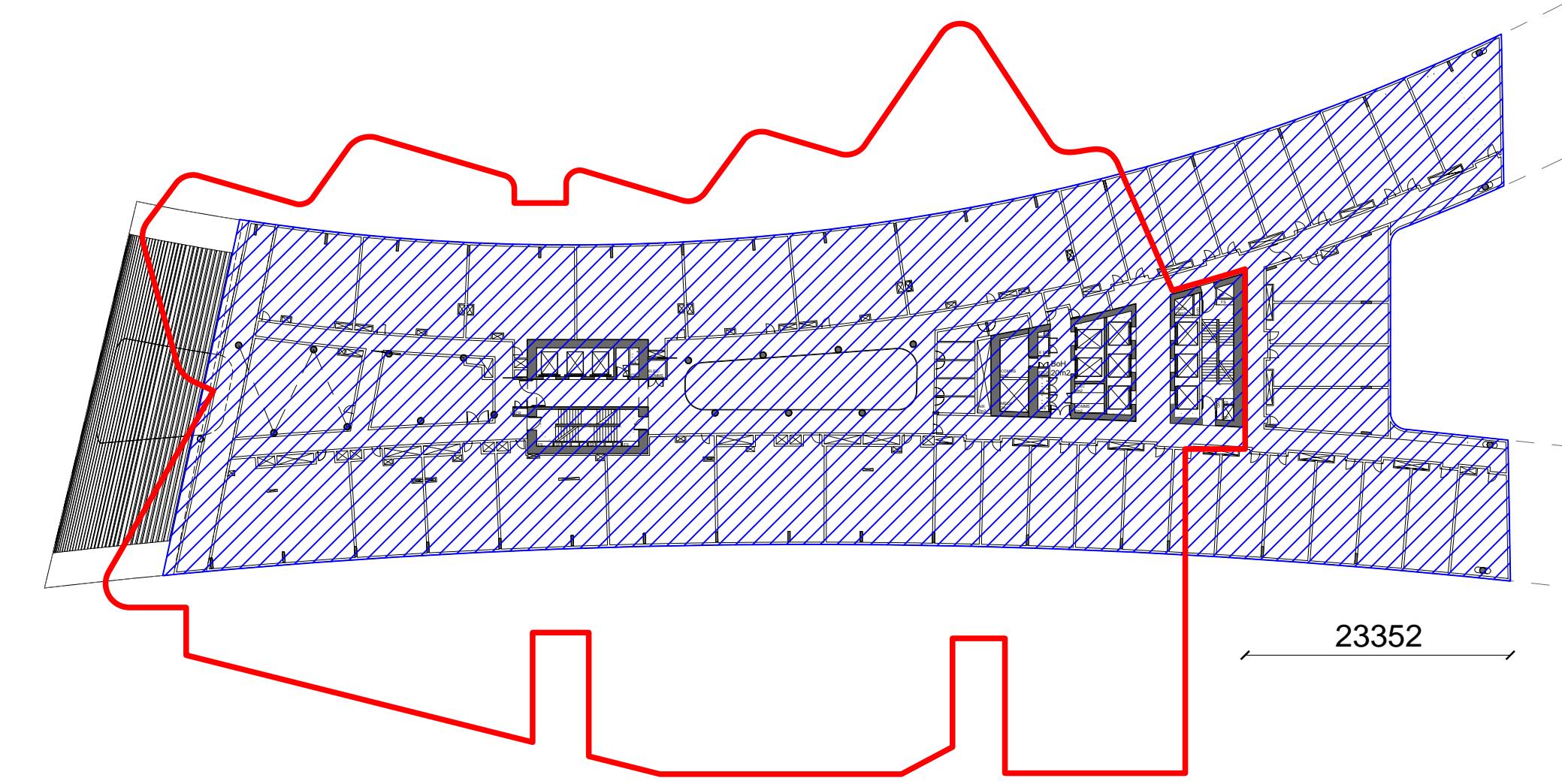

**3** HOTEL/SERVICED APARTMENTS L11 LEASE LINE RELATIONSHIP  
1:500

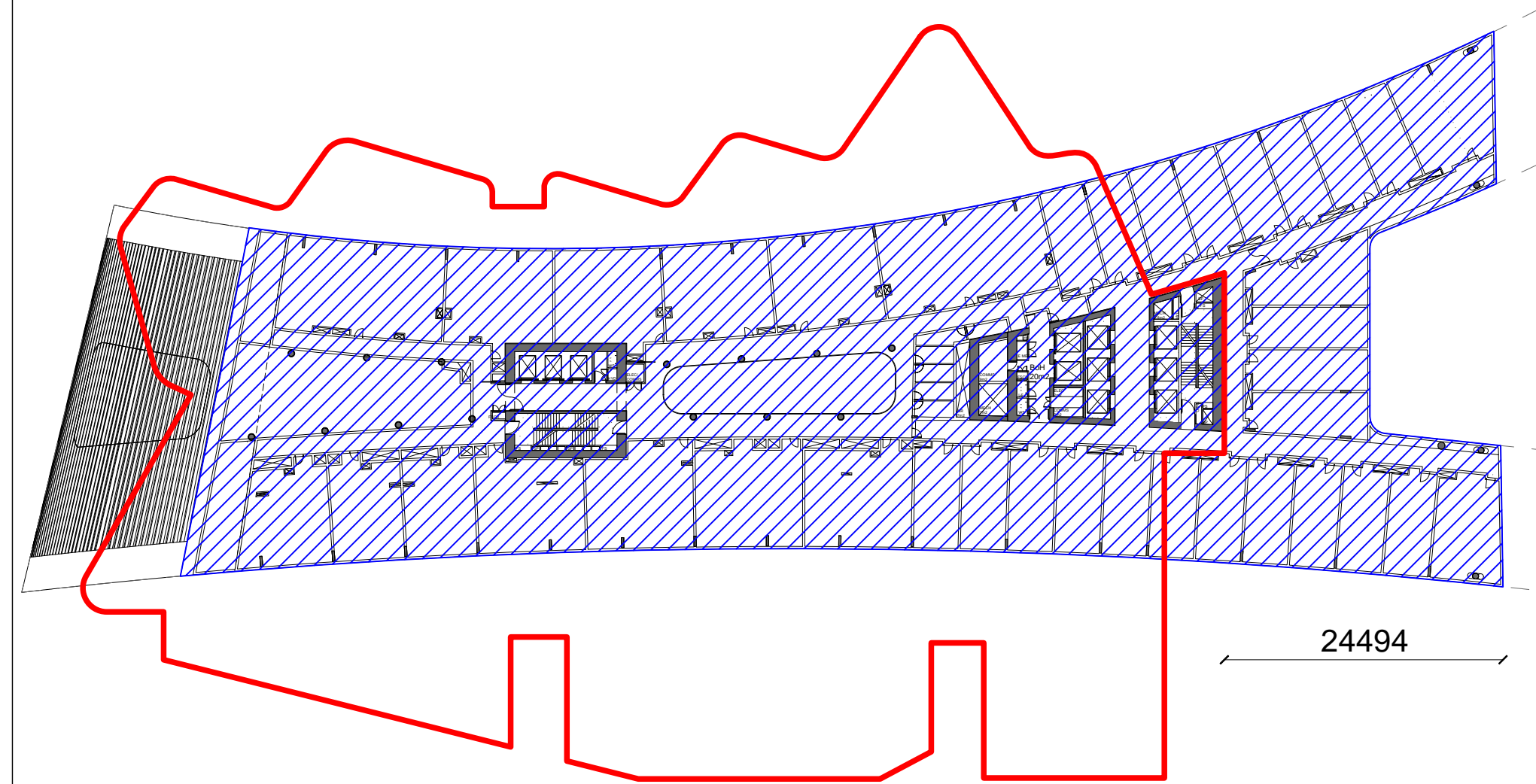

**4** HOTEL/SERVICED APARTMENTS L12 LEASE LINE RELATIONSHIP  
1:500

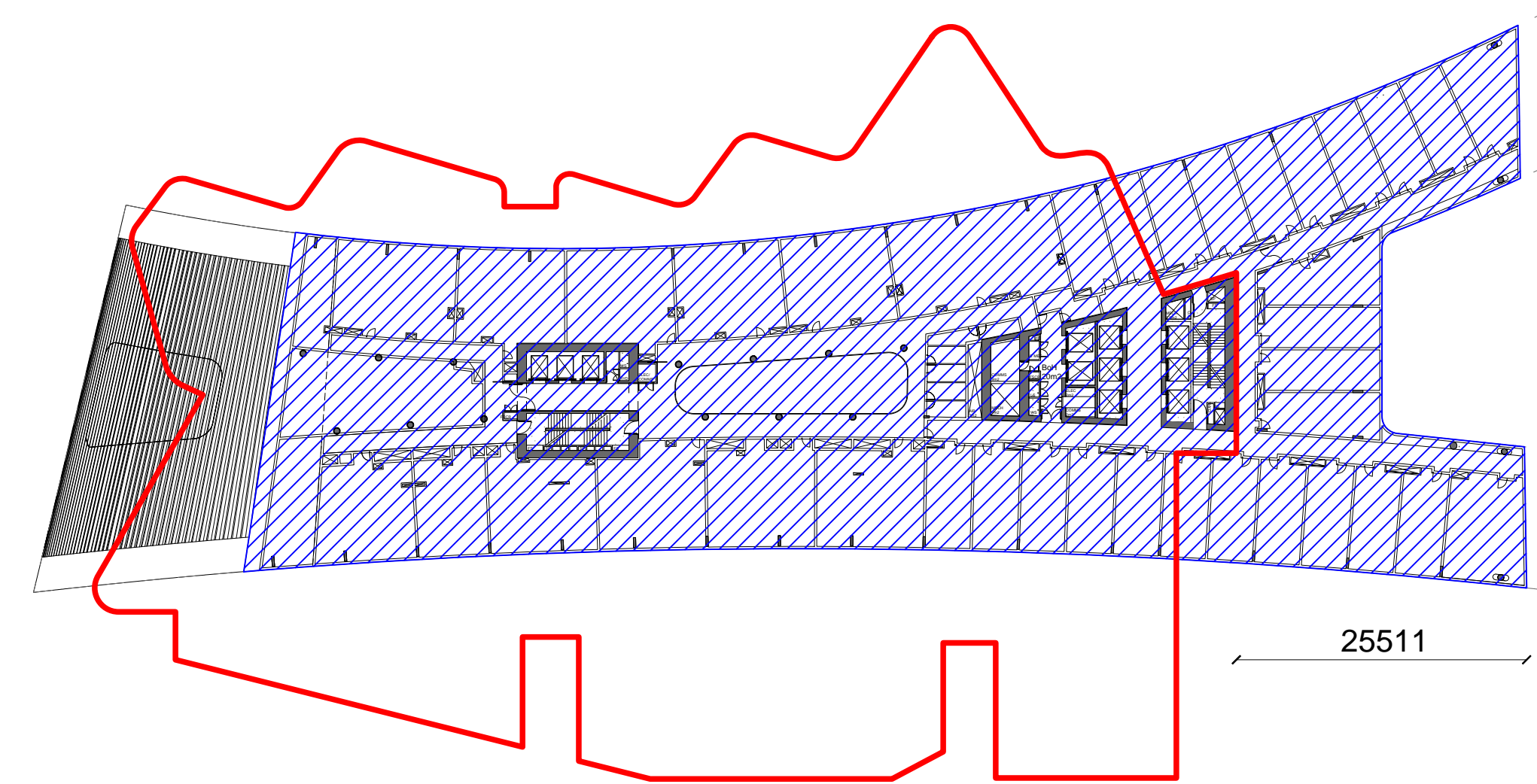

**5** HOTEL/SERVICED APARTMENTS L13 LEASE LINE RELATIONSHIP  
1:500

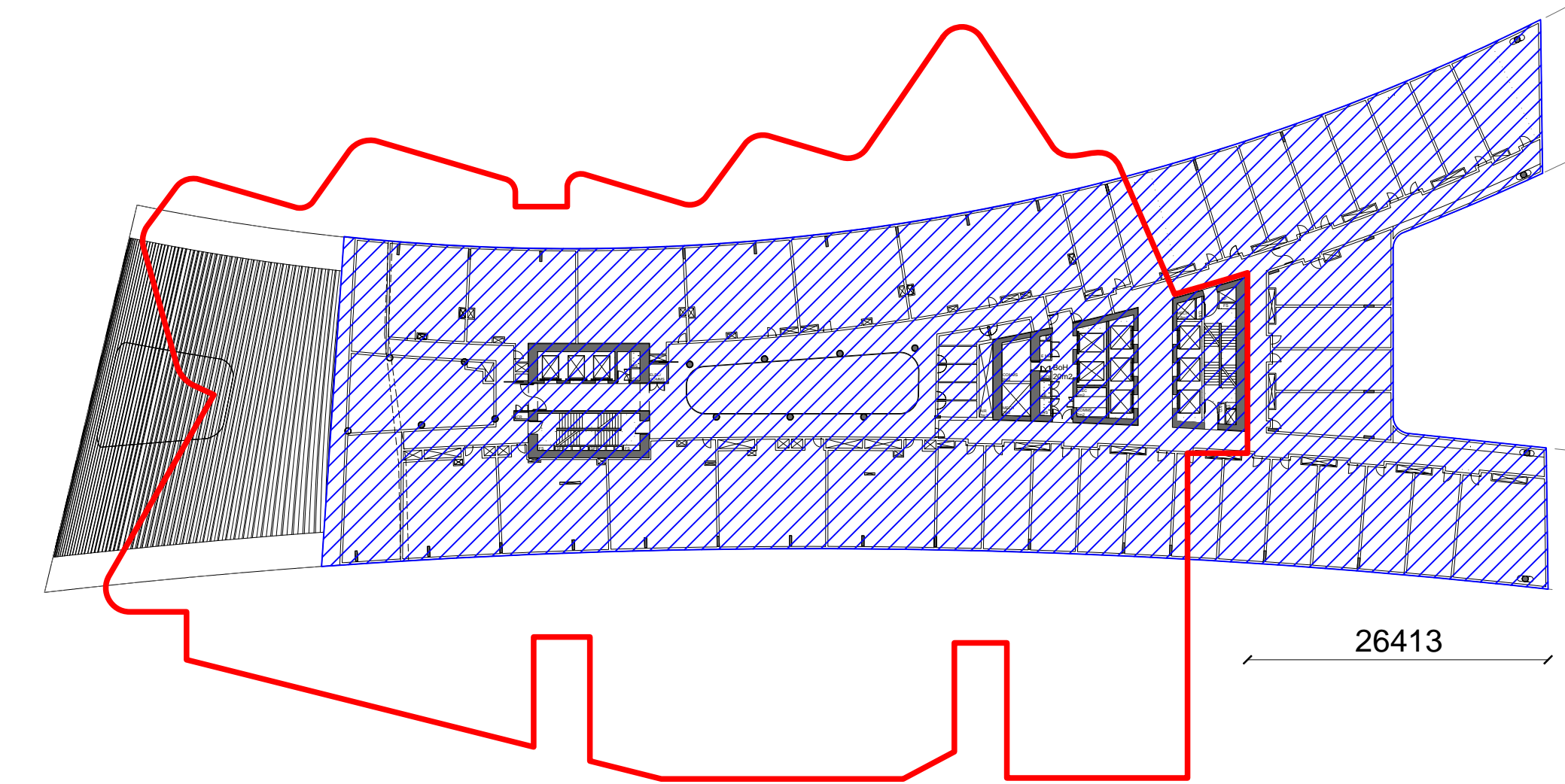

**6** HOTEL/SERVICED APARTMENTS L14 LEASE LINE RELATIONSHIP  
1:500

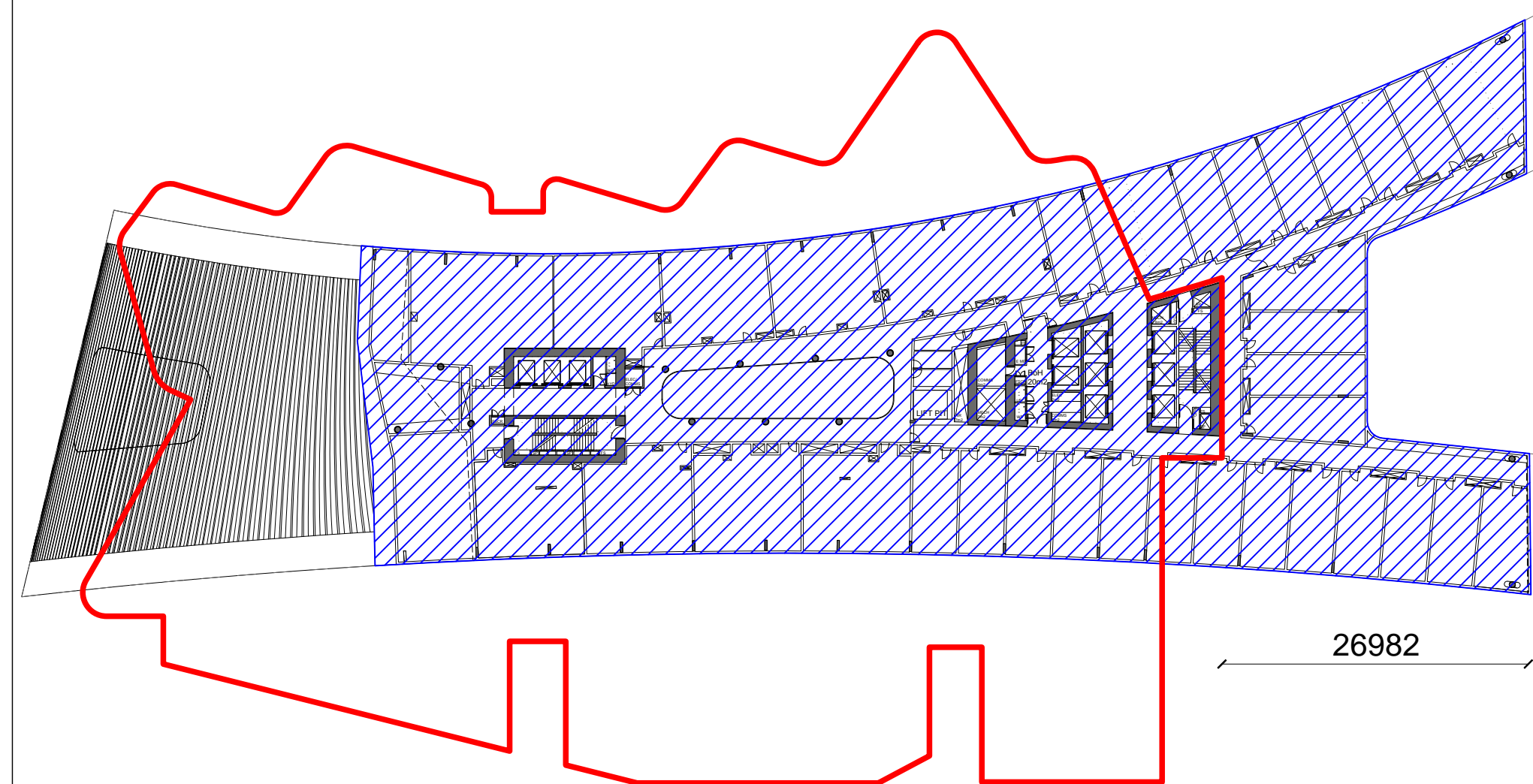

**7** HOTEL/SERVICED APARTMENTS L15 LEASE LINE RELATIONSHIP  
1:500

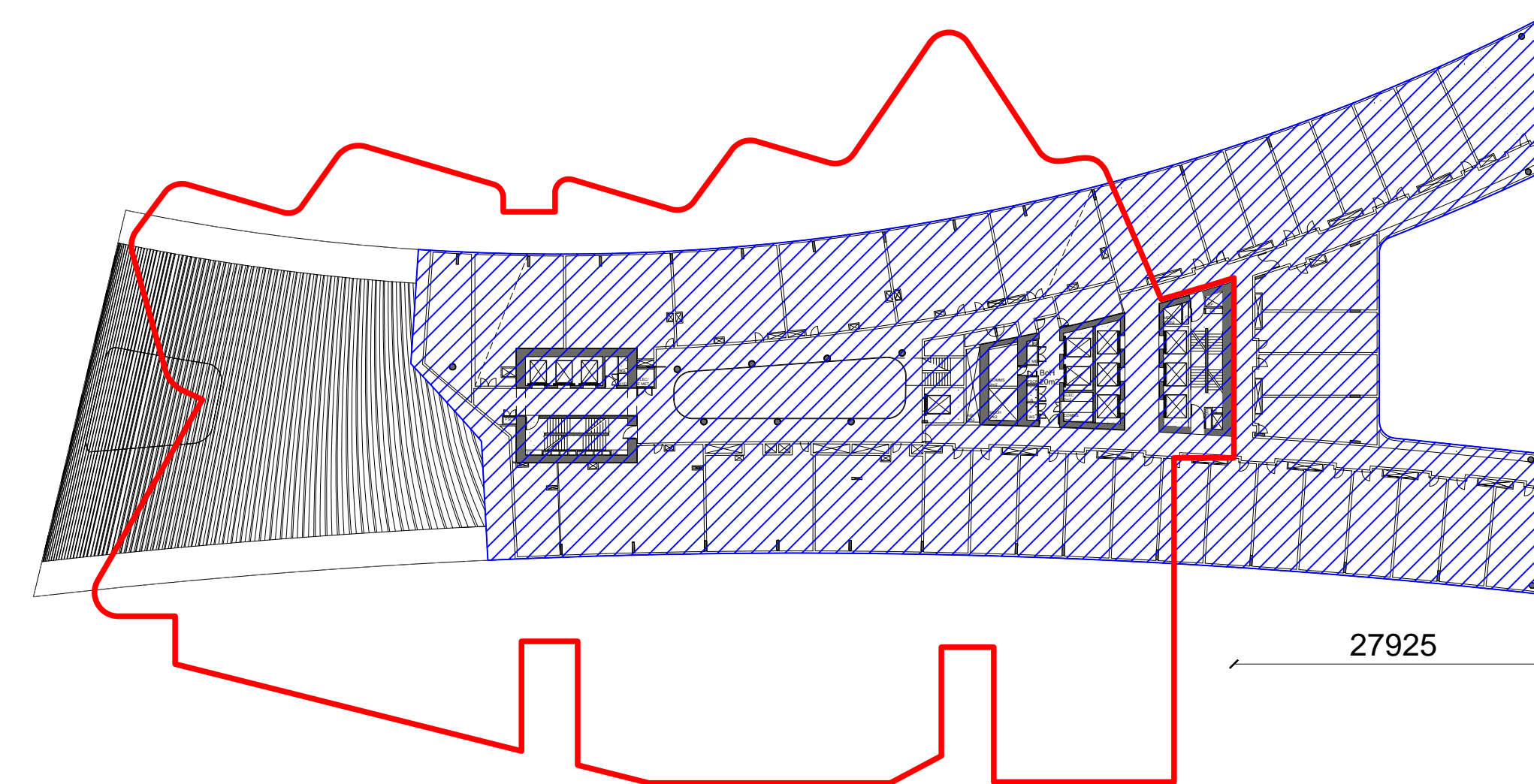

**8** HOTEL/SERVICED APARTMENTS L16 LEASE LINE RELATIONSHIP  
1:500

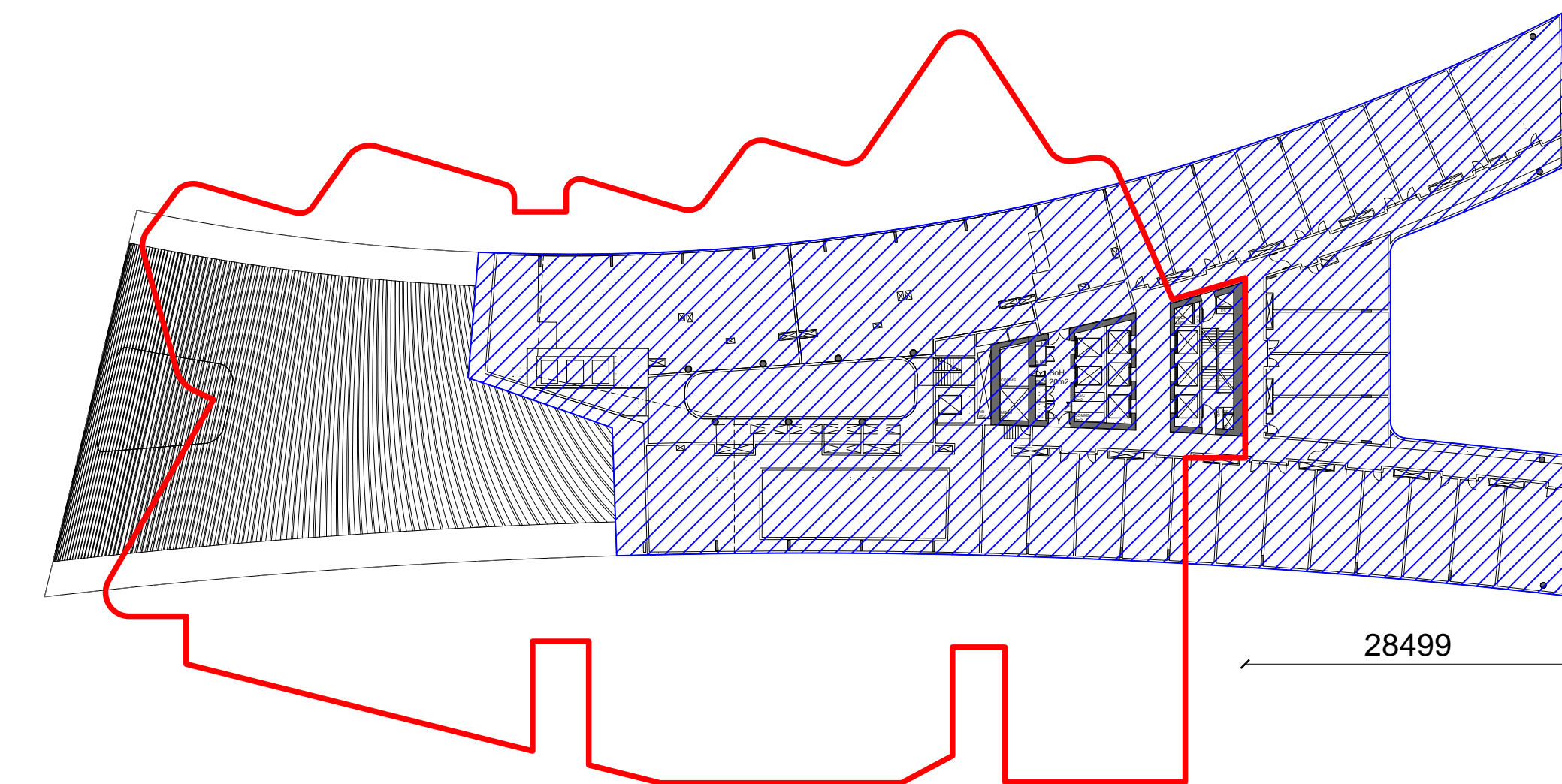

**9** HOTEL/SERVICED APARTMENTS L17 LEASE LINE RELATIONSHIP  
1:500

\\pmp01\h0201092044\A-P\Working\Ribon\_Leasing\RT004409\_TheRibbon\_DA\_Drawing\Ribon\_DA\_Drawing\Ribon\_DD-Drawing\RT004409\_TheRibbon\_Hotel-DA\_160300\_0716.dwg