

OSPS SITE

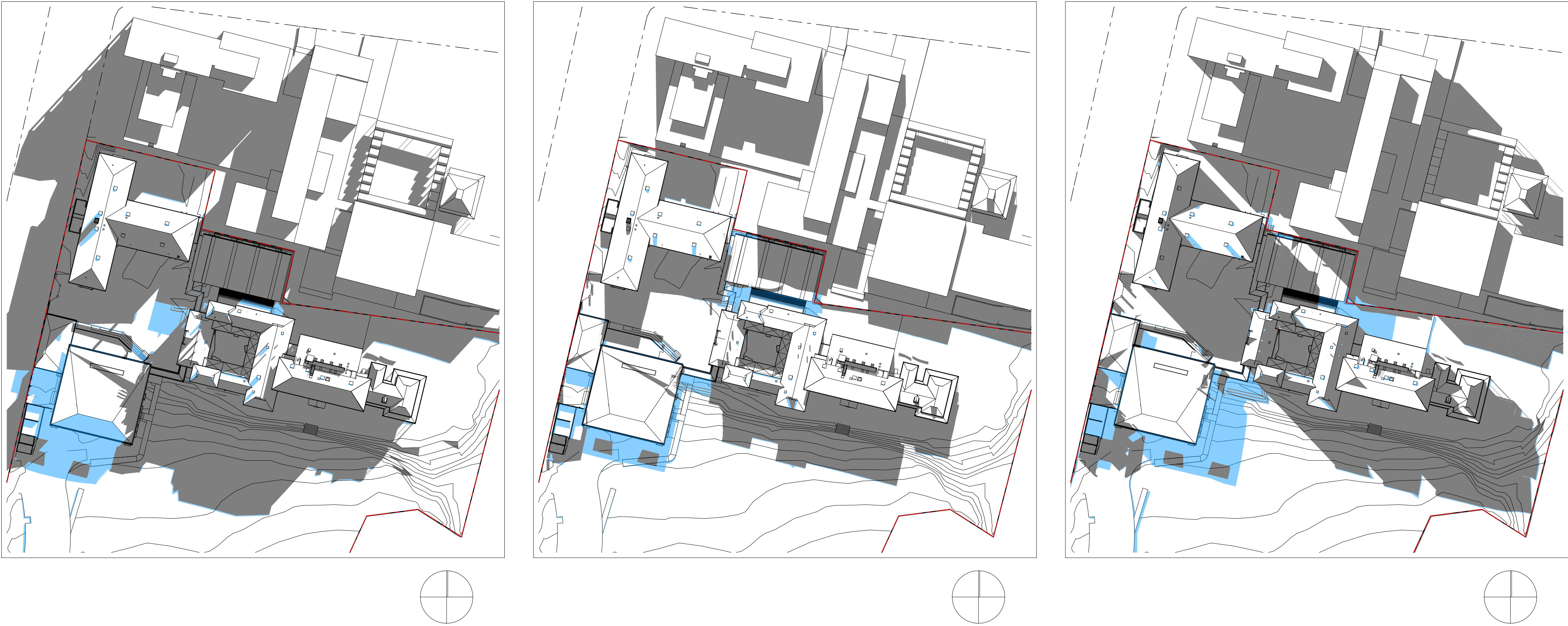

OSPS SITE + CONTEXT



REVISION NAME:
06/05/2016 ISSUE FOR SSD - REV A
31/05/2016 ISSUE FOR SSD - REV B

NOTES:
Do not scale off drawings. Use figured dimensions only. Report any discrepancies to the architect. These designs, plans, specifications and the copyright therein are the property of Tonkin Zulaikha Greer Architects Pty Ltd, and must not be reproduced or copied wholly or in part without written permission of Tonkin Zulaikha Greer Architects Pty Ltd.
DRAWINGS TO BE PRINTED IN COLOUR

ACCESS CONSULTANT
FUNKION
Phone: (02) 9011 8128
Email: jen@funktion-makinglifeit.com
FIRE ENGINEERING
CORE Engineering Group
Phone: 0412 389 484
Email: sandro@coreengineering.com.au
TOWN PLANNER
JBA Urban Development Services
Phone: 0411 818 359
Email: kludehope@jaurban.com.au

ACOUSTIC ENGINEER
Acoustic Studio
Phone: 0417 427 270
Email: jason.cameron@acousticstudio.com.au
HYDRAULIC ENGINEER
WOOD & GRIEVE
Phone: 0413 388 202
Email: david.stebina@wge.com.au
QUANTITY SURVEYOR
Slattery
Phone: 0427 658 513
Email: gillian.cottle@slattery.com.au

BCA CONSULTANT
BMG
Phone: 0400 300 126
Email: tony@bmplusg.com.au
LANDSCAPE ARCHITECT
SMM
Phone: (02) 9361 4549
Email: ms@sm2group.com.au
ARCHAEOLOGY
AHMS
Phone: 0425 215 012
Email: smcnyre-tamwoy@ahms.com.au

CIVIL ENGINEER
SDA Structures
Phone: 0425 173 151
Email: andrew@sdasttructures.com.au
MECHANICAL ENGINEER
WOOD & GRIEVE
Phone: #iMechanical Phone Number
Email: stephen.melady@wge.com.au
TRAFFIC ENGINEER
Thompson Stanbury
Phone: 0418 262 125
Email: david@thompsonstanbury.com.au

ELECTRICAL ENGINEER
WOOD & GRIEVE
Phone: 0425 173 151
Email: steven.lysar@wge.com.au
STRUCTURAL ENGINEER
SDA
Phone: 0408 900 855
Email: andrew@sdasttructures.com.au
WASTE MANAGEMENT
SMEC
Phone: (02) 8484 7000
Email: Daniel.Cramer@smec.com

ESD CONSULTANT
WOOD & GRIEVE
Phone: #ESD Phone Number
Email: alexander.kobler@wge.com.au
ARBORIST
TCL Tree solutions
Phone: 0412 292 777
Email: tcltreesolutions1@gmail.com
SOIL CONTAMINATION / HAZMAT
SMEC
Phone: 0418 262 125
Email: Daniel.Cramer@smec.com

CLIENT:
DEPARTMENT OF EDUCATION
Phone: 02 9561 1141
Email: roland.marshall@det.nsw.edu.au

PROJECT :
**O'CONNELL STREET
PRIMARY SCHOOL**

PROJECT NO : 15030

ARCHITECT
TONKIN ZULAIKHA GREER ARCHITECTS
117 Reservoir Street
ABN: 4600272349
P: (02) 9215 4900
F: (02) 9215 4901
EMAIL: info@tzig.com.au
WEB: www.tzig.com.au

tonkin
zulaikha
greer
architects

DRAWING TITLE
**SUN DIAGRAMS - JUNE 21 -
EXISTING AND NEW**

SCALES
1:1000

PHASE
PRELIMINARY

DRAWING NO
PA-601

REV
B

DRAWN BY
KL, JH, BS, JB, KP,
JH, ML, CS, JM
CHECKED
PT