

THIS DOCUMENT IS THE COPYRIGHT OF THE HDR GROUP (NSW) PTY LTD
 ALL THE INFORMATION ILLUSTRATED ON THIS DOCUMENT IS TO BE CHECKED AND VERIFIED ON SITE
 IN THE EVENT OF DISCREPANCIES REFER TO ARCHITECT PRIOR TO COMMENCEMENT OF THE WORK.
 DO NOT SCALE DRAWINGS ELECTRONICALLY OR MANUALLY

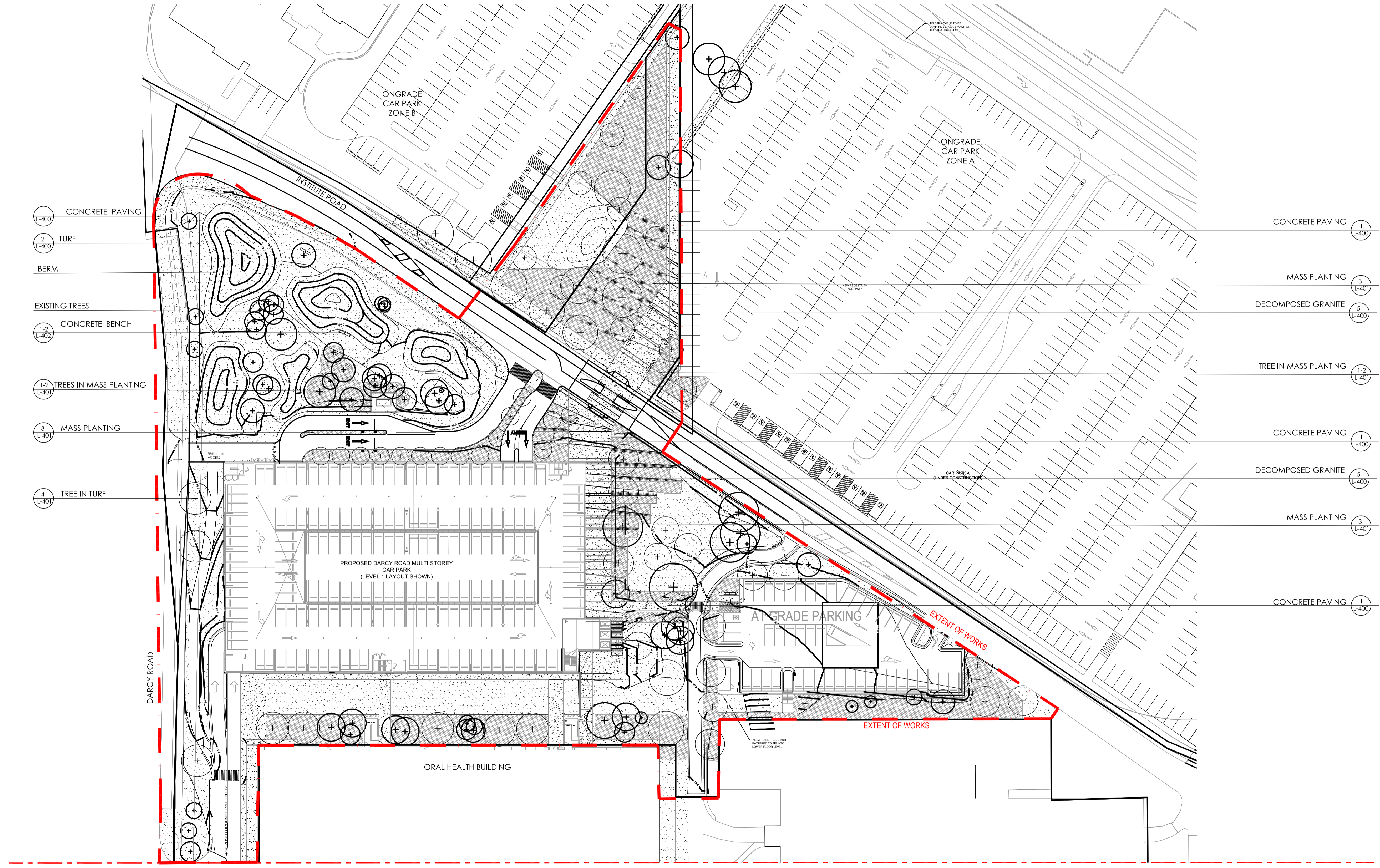

- 1 CONCRETE PAVING (L-400)
- 2 TURF (L-400)
- BERM
- EXISTING TREES
- 1-2 CONCRETE BENCH (L-402)
- 1-2 TREES IN MASS PLANTING (L-401)
- 3 MASS PLANTING (L-401)
- 4 TREE IN TURF (L-401)

- 1 CONCRETE PAVING (L-400)
- 3 MASS PLANTING (L-401)
- 5 DECOMPOSED GRANITE (L-400)
- 1-2 TREE IN MASS PLANTING (L-401)
- 1 CONCRETE PAVING (L-400)
- 5 DECOMPOSED GRANITE (L-400)
- 3 MASS PLANTING (L-401)
- 1 CONCRETE PAVING (L-400)

REV	DESCRIPTION	DRAWN	CHECK	DATE
1	PRELIMINARY ISSUE	LV	AL	18/11/2015
2	ISSUED FOR RECORD	LV	AL	27/11/2015
3	ISSUED FOR TENDER	LV	AL	14/12/2015
4	ISSUED FOR TENDER	LV	AL	01/02/2016
5	ISSUED FOR TENDER	LV	AL	02/02/2016
6	ISSUED FOR TENDER	LV	AL	11/02/2016
7	ISSUED FOR TENDER	LV	AL	24/05/2016

FOR TENDER
 NOT FOR CONSTRUCTION

CLIENT:
NSW HEALTH INFRASTRUCTURE

 Level 6, 77 Pacific Highway
 North Sydney NSW 2060
 P: (02) 9978 5427
 F: (02) 8964 1277
 www.hinfra.health.nsw.gov.au

PROJECT MANAGER:
PRICE WATERHOUSE COOPERS

 Darling Park Tower 2
 201 Sussex St
 Sydney NSW 2000
 P: (02) 8266 0000
 F: (02) 8266 9999
 www.pwc.com.au

LEAD ARCHITECT:
HDR | RD + MSJ
 Lvl 1, 110 Walker Street
 North Sydney NSW 2060
 P: (02) 9557 5533
 F: (02) 9559 3015
 askhdr@hdr-foad.com.au

LANDSCAPE ARCHITECT:
OCULUS

 Lvl 1, 5 Wilson Street
 Newtown NSW 2042
 P: (02) 9557 5533
 F: (02) 9519 8322
 www.ocular.info

WESTMEAD EARLY ENABLING WORKS
 Cnr Hawkesbury Road and Darcy Road
 Westmead NSW 2145

WESTMEAD HOSPITAL REDEVELOPMENT
 Building health. Transforming lives.

DRAWING TITLE:
SURFACE MATERIALS, FINISHES AND LEVELS PLAN
 SCALE: 1:500
 DOHS NUMBER: **5335**
 CHECKED: AL
 PROJECT NUMBER: **S14-038 MSC-OCU-LS-DG-201**
 DRAWING NUMBER:
 ISSUE: **7**

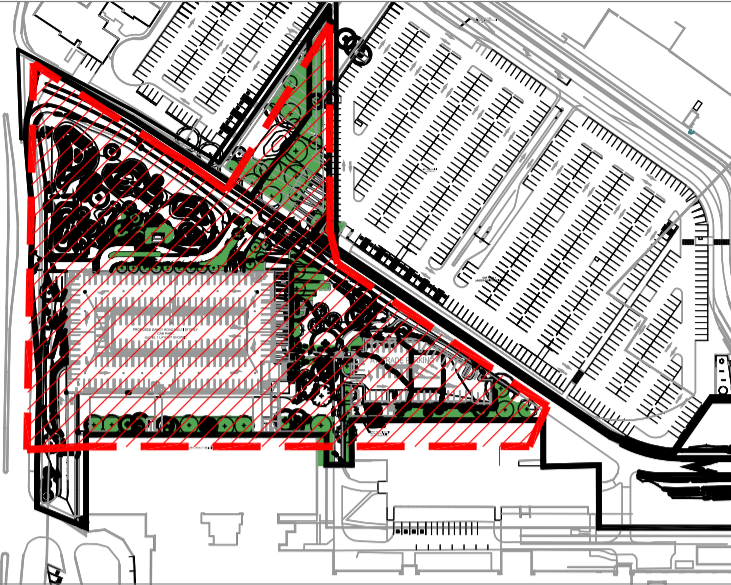
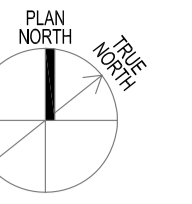

THIS DOCUMENT IS THE COPYRIGHT OF THE HDR GROUP (NSW) PTY LTD
 ALL THE INFORMATION ILLUSTRATED ON THIS DOCUMENT IS TO BE CHECKED AND VERIFIED ON SITE
 IN THE EVENT OF DISCREPANCIES REFER TO ARCHITECT PRIOR TO COMMENCEMENT OF THE WORK.
 DO NOT SCALE DRAWINGS ELECTRONICALLY OR MANUALLY

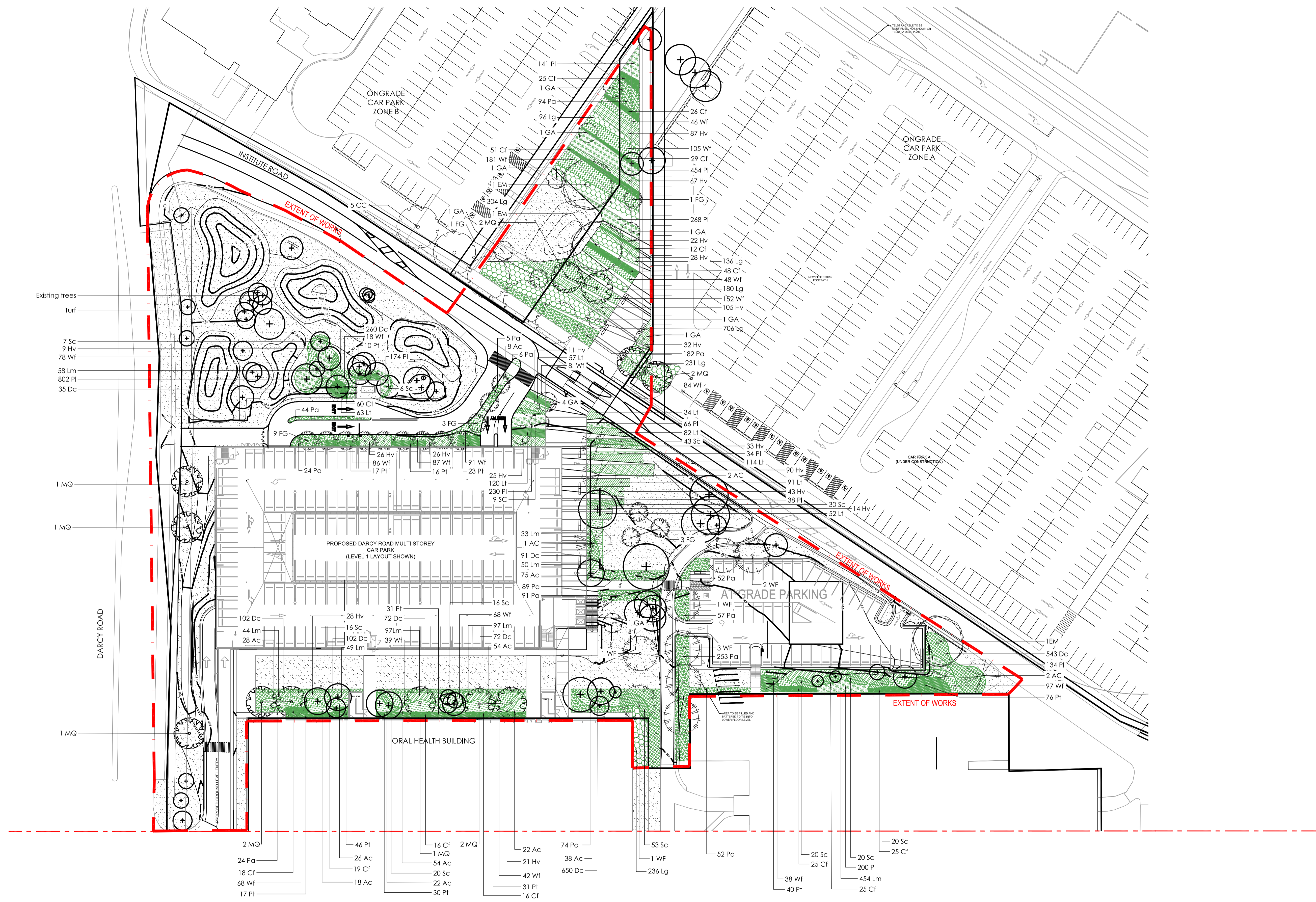

REV	DESCRIPTION	DRAWN	CHECK	DATE
1	PRELIMINARY ISSUE	LV	AL	18/11/2015
2	ISSUED FOR RECORD	LV	AL	27/11/2015
3	ISSUED FOR TENDER	LV	AL	14/12/2015
4	ISSUED FOR TENDER	LV	AL	01/02/2016
5	ISSUED FOR TENDER	LV	AL	02/02/2016
6	ISSUED FOR TENDER	LV	AL	11/02/2016
7	ISSUED FOR TENDER	LV	AL	24/05/2016

FOR TENDER
 NOT FOR CONSTRUCTION

CLIENT:
NSW HEALTH INFRASTRUCTURE

 Level 6, 77 Pacific Highway
 North Sydney NSW 2060
 P: (02) 9978 5427
 F: (02) 8964 1277
 www.hinfra.health.nsw.gov.au

PROJECT MANAGER:
PRICE WATERHOUSE COOPERS

 Darling Park Tower 2
 291 Sussex St
 Sydney NSW 2000
 P: (02) 8266 0000
 F: (02) 8266 9999
 www.pwc.com.au

LEAD ARCHITECT:
HDR | RD + MSJ
 Lvl 1, 110 Walker Street
 North Sydney NSW 2060
 P: (02) 9556 2666
 F: (02) 9559 3015
 askhdr@hdr-foolabnsw.com

LANDSCAPE ARCHITECT:
OCULUS

 Lvl 1, 5 Wilson Street
 Newtown NSW 2042
 P: (02) 9557 5533
 F: (02) 9519 8323
 www.ocular.info

WESTMEAD EARLY ENABLING WORKS
 Cnr Hawkesbury Road and Darcy Road
 Westmead NSW 2145

WESTMEAD HOSPITAL REDEVELOPMENT
 Building health. Transforming lives.

DRAWING TITLE			
PLANTING PLAN			
SCALE: 1:500	DOHS NUMBER: 5335	CHECKED: AL	
PROJECT NUMBER: S14-038 MSC-OCU-LS-DG-202	DRAWING NUMBER: 7	ISSUE:	