

CATHERINE
MCAULEY HIGH
SCHOOL

C:\m\232186_MULTI DECK CARPARK_STAND ALONE_10.dwg
11/11/2015 4:05:30 PM

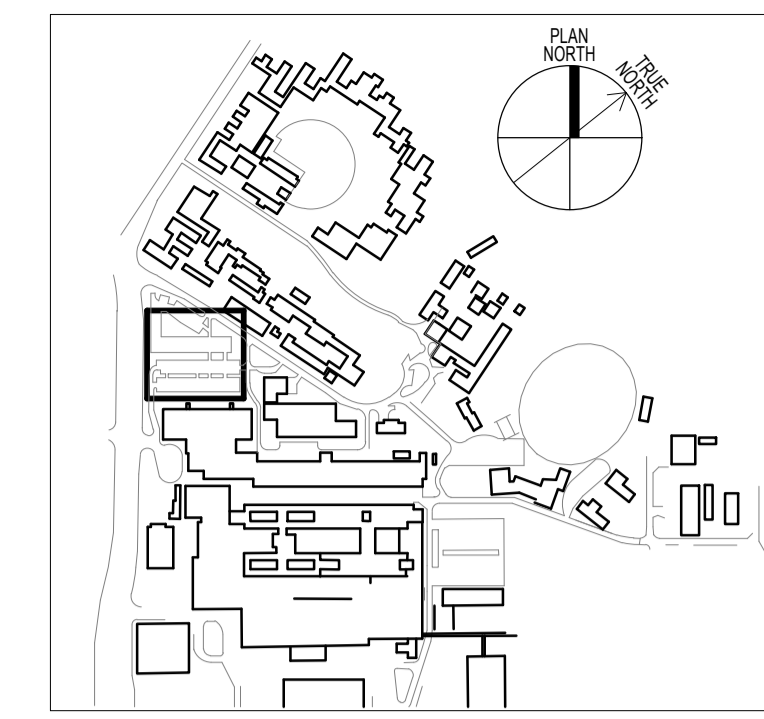
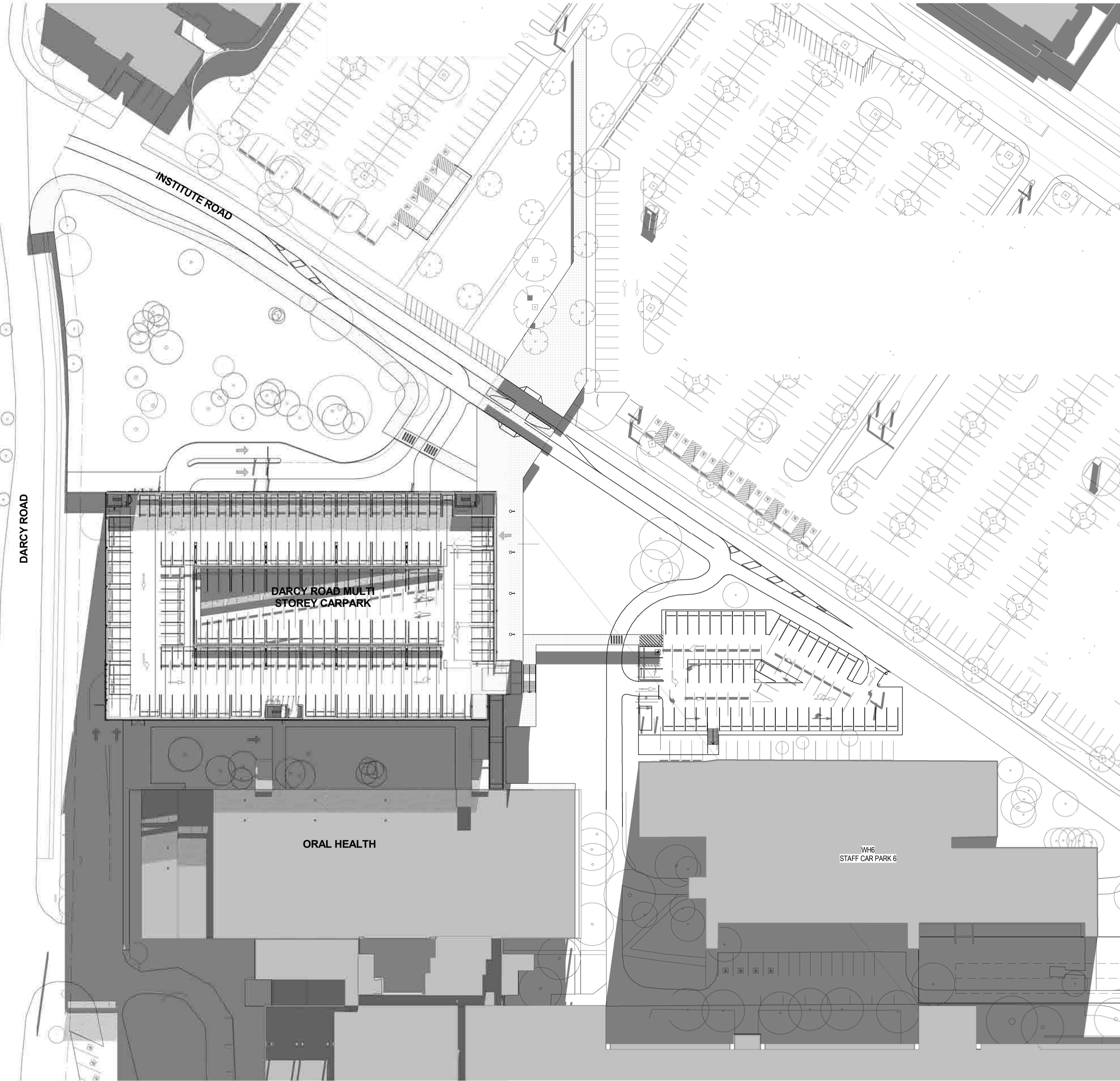

THIS DOCUMENT IS THE COPYRIGHT OF THE HOBBS GROUP (NSW) PTY LTD
ALL THE INFORMATION ILLUSTRATED ON THIS DOCUMENT IS TO BE CHECKED AND VERIFIED ON SITE
IN THE EVENT OF DISCREPANCIES REFER TO ARCHITECT PRIOR TO COMMENCEMENT OF THE WORK.
DO NOT SCALE DRAWINGS ELECTRONICALLY OR MANUALLY.

REV	DESCRIPTION	DRAWN	CHECK	DATE
1	SSD APPROVAL	RT	EG	29/10/2015

DISCLAIMER:
Survey topography, building heights and fence heights used to produce these shadow diagrams have been produced by others. Shadow diagrams have been calculated and drawn to the best of our ability with all due care taken to ensure their accuracy within the limits of the available data. The area represented by the aerial photograph was not part of the topographical survey and as such no data was available within this zone. This information is an approximate representation to provide context.

STATE SIGNIFICANT DEVELOPMENT
APPROVAL
NOT FOR CONSTRUCTION

CLIENT:
NSW HEALTH
INFRASTRUCTURE



Level 6, 77 Pacific Highway
North Sydney NSW 2060

P: (02) 9979 5427
F: (02) 8904 1377
www.hinfra.health.nsw.gov.au

PROJECT MANAGER:
PRICE WATERHOUSE
COOPERS

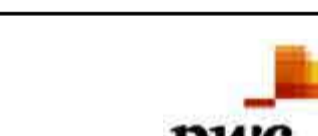

Darling Park
201 Sussex Street
Sydney NSW 2000

P: (02) 8266 2750
F: (02) 8266 2780
www.pwc.com.au

LEAD ARCHITECT:
HDR | RD + MSJ

Lvl 1, 110 Walker Street
North Sydney NSW 2060

P: (02) 9956 2666
F: (02) 9959 3015
askhldr@hobbsgroup.com.au

WESTMEAD MULTI STOREY CARPARK
Cnr Institute Road and Darcy Road
Westmead NSW 2145
Westmead Redevelopment
Building health. Transforming lives.

DRAWING TITLE:
SHADOW DIAGRAMS WINTER
SOLSTICE 3pm

SCALE:	DOHS NUMBER:	CHECKED:
1:500	5335	EG
PROJECT NUMBER:	DRAWING NUMBER:	ISSUE:
232186	MSC-HDR-AR-DG-0703	1

WINTER SOLSTICE 3PM 21 JUNE (EST)

1:500

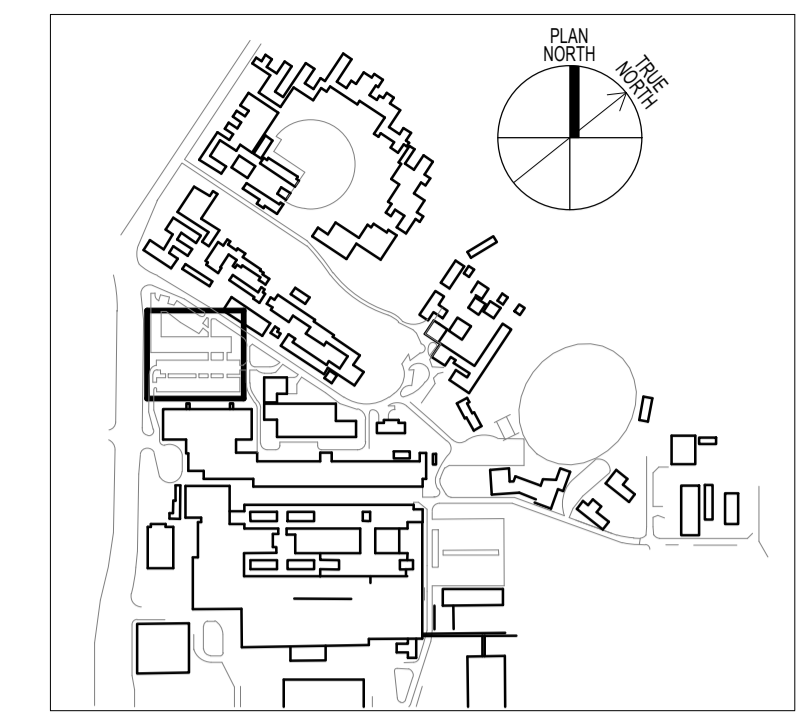
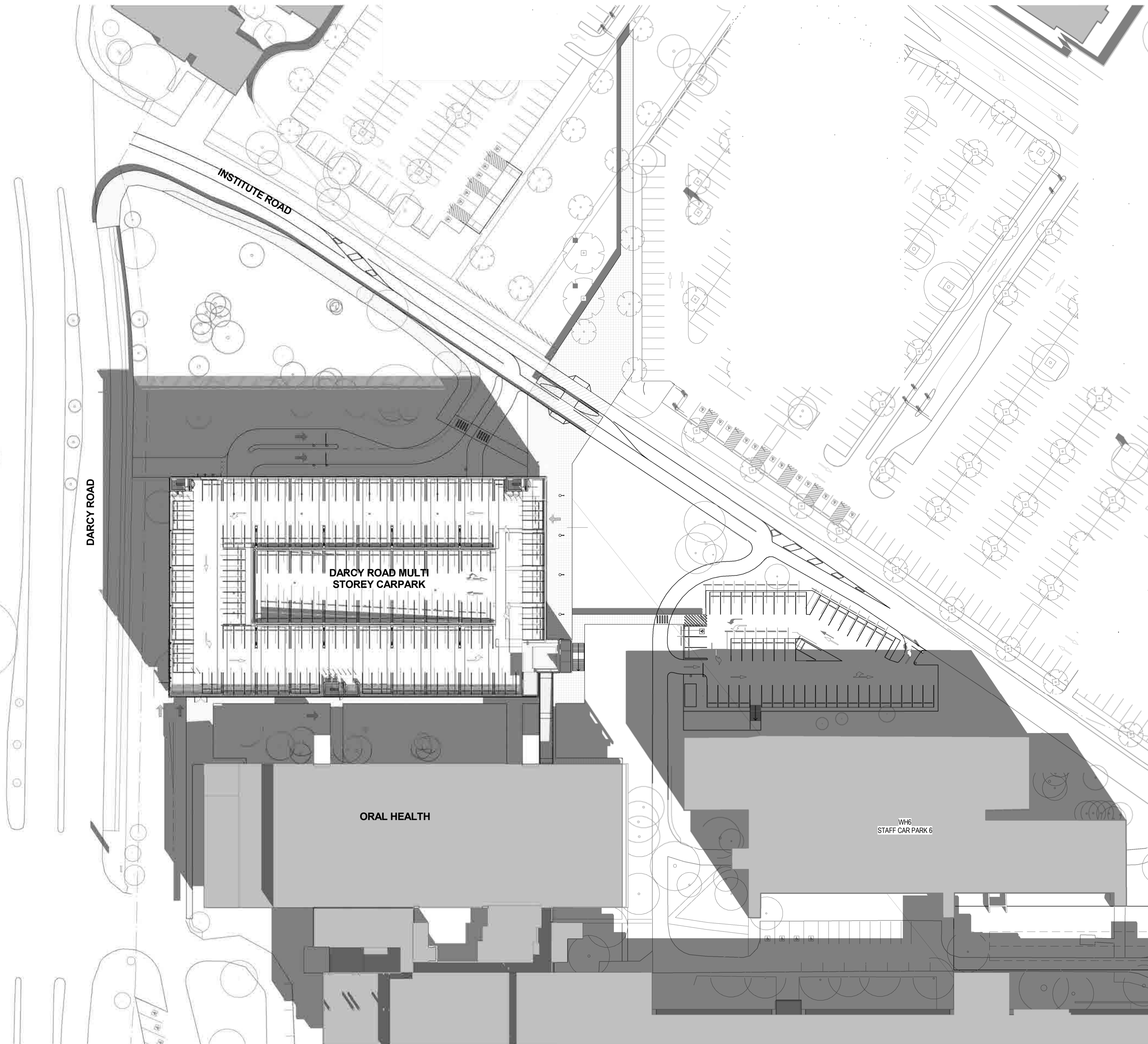

THIS DOCUMENT IS THE COPYRIGHT OF THE HOBBS GROUP (NSW) PTY LTD
 ALL THE INFORMATION ILLUSTRATED ON THIS DOCUMENT IS TO BE CHECKED AND VERIFIED ON SITE
 IN THE EVENT OF DISCREPANCIES REFER TO ARCHITECT PRIOR TO COMMENCEMENT OF THE WORK.
 DO NOT SCALE DRAWINGS ELECTRONICALLY OR MANUALLY.

REV	DESCRIPTION	DRAWN	CHECK	DATE
1	SSD APPROVAL	RT	EG	29/10/2015

DISCLAIMER:
 Survey topography, building heights and fence heights used to produce these shadow diagrams have been produced by others. Shadow diagrams have been calculated and drawn to the best of our ability with all due care taken to ensure their accuracy within the limits of the available data. The area represented by the aerial photograph was not part of the topographical survey and as such no data was available within this zone. This information is an approximate representation to provide context.

STATE SIGNIFICANT DEVELOPMENT
 APPROVAL
 NOT FOR CONSTRUCTION

CLIENT:
NSW HEALTH INFRASTRUCTURE
 Level 6, 77 Pacific Highway
 North Sydney NSW 2060
 P: (02) 9979 5427
 F: (02) 8904 1377
 www.hinfra.health.nsw.gov.au

PROJECT MANAGER:
PRICE WATERHOUSE COOPERS
 Darling Park
 201 Sussex Street
 Sydney NSW 2000
 P: (02) 8266 2750
 F: (02) 8266 2780
 www.pwc.com.au

LEAD ARCHITECT:
HDR | RD + MSJ
 Lvl 1, 110 Walker Street
 North Sydney NSW 2060
 P: (02) 9556 2666
 F: (02) 9559 3015
 askhldr@hpricecoopers.com

WESTMEAD MULTI STOREY CARPARK
 Cnr Institute Road and Darcy Road
 Westmead NSW 2145
Westmead Redevelopment
 Building health. Transforming lives.

DRAWING TITLE:
 SHADOW DIAGRAMS SUMMER
 SOLSTICE 9am

SCALE	DOHS NUMBER	CHECKED
1:500	5335	EG
PROJECT NUMBER	DRAWING NUMBER	ISSUE
232186	MSC-HDR-AR-DG-0704	1

C:\m\232186\MULTI DECK CARPARK STAND ALONE.rvt
 11/11/2015 4:12:10 PM

SUMMER SOLSTICE 9AM 22 DECEMBER (EDST)

1:500

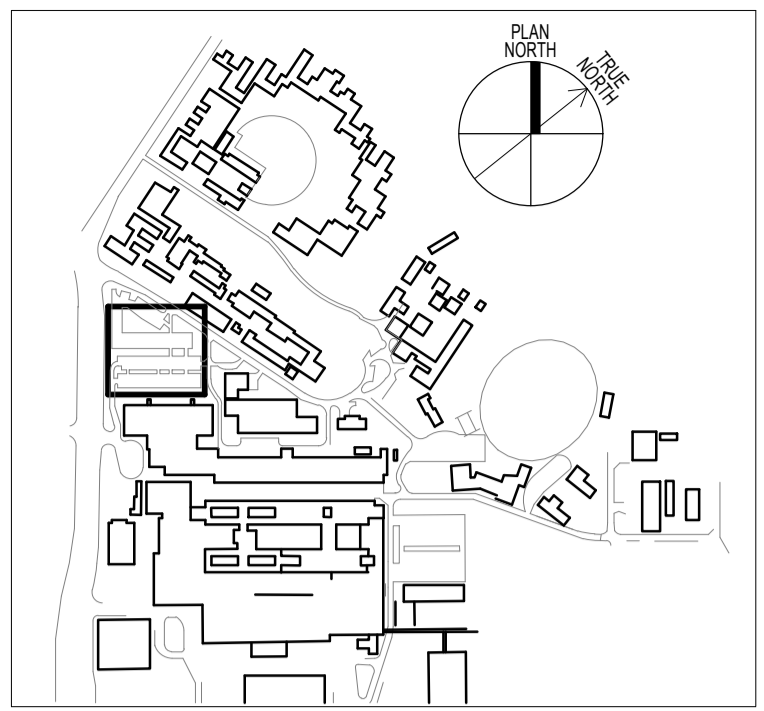
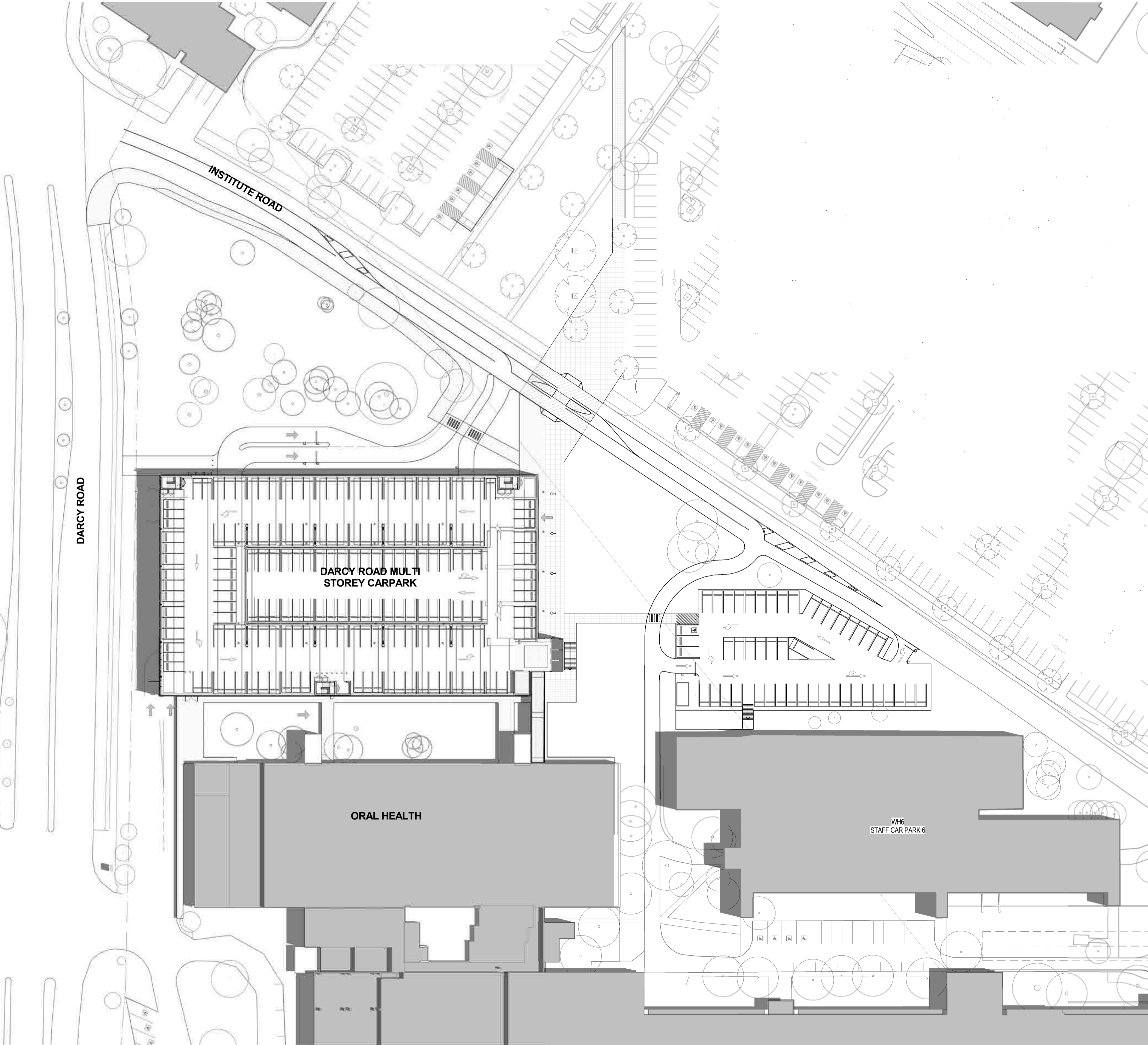

THIS DOCUMENT IS THE COPYRIGHT OF THE HOBBS GROUP (NSW) PTY LTD
 ALL THE INFORMATION ILLUSTRATED ON THIS DOCUMENT IS TO BE CHECKED AND VERIFIED ON SITE
 IN THE EVENT OF DISCREPANCIES REFER TO ARCHITECT PRIOR TO COMMENCEMENT OF THE WORK.
 DO NOT SCALE DRAWINGS ELECTRONICALLY OR MANUALLY.

REV	DESCRIPTION	DRAWN	CHECK	DATE
1	SSD APPROVAL	RT	EG	29/10/2015

DISCLAIMER:

Survey topography, building heights and fence heights used to produce these shadow diagrams have been produced by others. Shadow diagrams have been calculated and drawn to the best of our ability with all due care taken to ensure their accuracy within the limits of the available data. The area represented by the aerial photograph was not part of the topographical survey and as such no data was available within this zone. This information is an approximate representation to provide context.

STATE SIGNIFICANT DEVELOPMENT
 APPROVAL
 NOT FOR CONSTRUCTION

CLIENT:
NSW HEALTH INFRASTRUCTURE



Level 6, 77 Pacific Highway
 North Sydney NSW 2060

P: (02) 9979 5427
 F: (02) 8904 1377
 www.hinfra.health.nsw.gov.au

PROJECT MANAGER:
PRICE WATERHOUSE COOPERS



Darling Park
 201 Sussex Street
 Sydney NSW 2000

P: (02) 8266 2750
 F: (02) 8266 2780
 www.pwc.com.au

LEAD ARCHITECT:
HDR | RD + MSJ

Lvl 1, 110 Walker Street
 North Sydney NSW 2060

P: (02) 9956 2666
 F: (02) 9959 3015
 aashdr@hdrpriceadvisory.com

WESTMEAD MULTI STOREY CARPARK
 Cnr Institute Road and Darcy Road
 Westmead NSW 2145

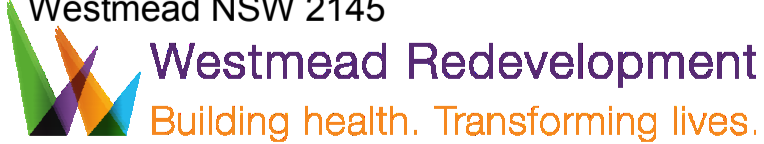

DRAWING TITLE:
SHADOW DIAGRAMS SUMMER SOLSTICE 12pm

SCALE:	DOHS NUMBER:	CHECKED:
1: 500	5335	EG
PROJECT NUMBER:	DRAWING NUMBER:	ISSUE:
232186	MSC-HDR-AR-DG-0705 1	

SUMMER SOLSTICE 12PM 22 DECEMBER (EDST)

1: 500



CATHERINE
McAULEY HIGH
SCHOOL

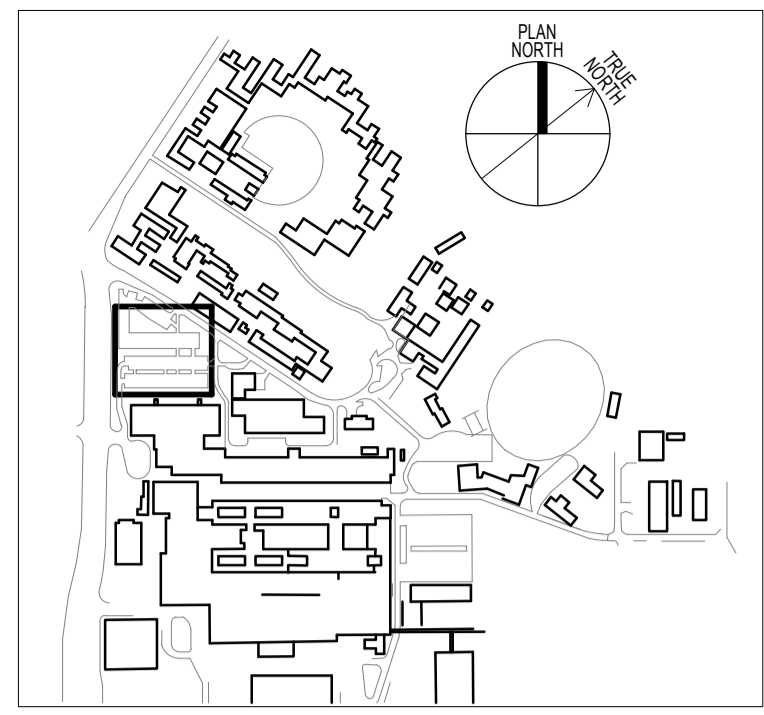
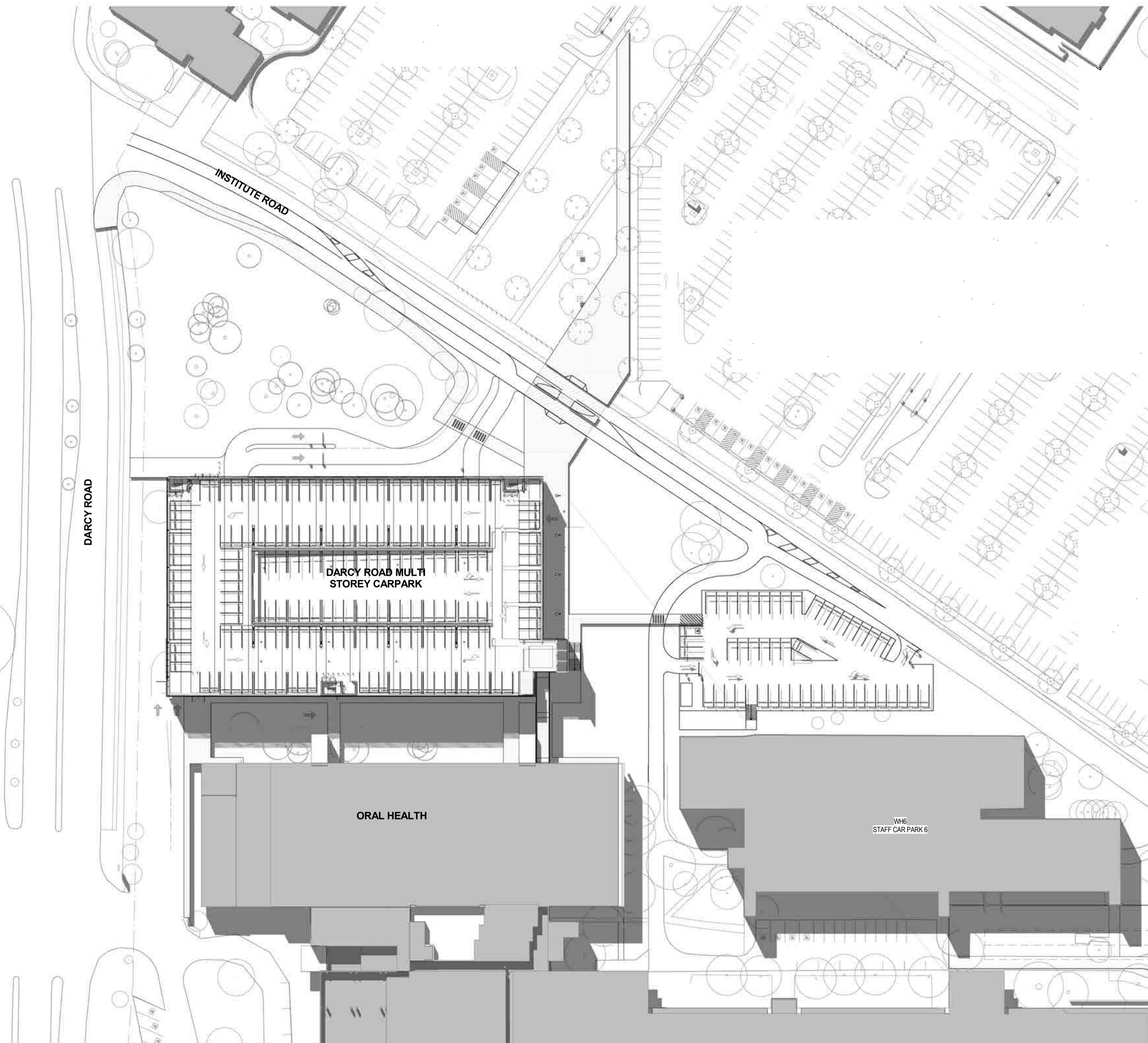

THIS DOCUMENT IS THE COPYRIGHT OF THE HOBBS GROUP (NSW) PTY LTD
ALL THE INFORMATION ILLUSTRATED ON THIS DOCUMENT IS TO BE CHECKED AND VERIFIED ON SITE
IN THE EVENT OF DISCREPANCIES REFER TO ARCHITECT PRIOR TO COMMENCEMENT OF THE WORK.
DO NOT SCALE DRAWINGS ELECTRONICALLY OR MANUALLY.

REV	DESCRIPTION	DRAWN	CHECK	DATE
1	SSD APPROVAL	RT	EG	29/10/2015

DISCLAIMER:
Survey topography, building heights and fence heights used to produce these shadow diagrams have been produced by others. Shadow diagrams have been calculated and drawn to the best of our ability with all due care taken to ensure their accuracy within the limits of the available data. The area represented by the aerial photograph was not part of the topographical survey and as such no data was available within this zone. This information is an approximate representation to provide context.

STATE SIGNIFICANT DEVELOPMENT
APPROVAL
NOT FOR CONSTRUCTION

CLIENT:
NSW HEALTH
INFRASTRUCTURE



Level 6, 77 Pacific Highway
North Sydney NSW 2060

P: (02) 9979 5427
F: (02) 8904 1377
www.hinfra.health.nsw.gov.au

PROJECT MANAGER:
PRICE WATERHOUSE
COOPERS



Darling Park
201 Darling Street
Sydney NSW 2000

P: (02) 8266 2750
F: (02) 8266 2780
www.pwc.com.au

LEAD ARCHITECT:
HDR | RD + MSJ

Lvl 1, 110 Walker Street
North Sydney NSW 2060

P: (02) 9956 2666
F: (02) 9959 3015
askhdro@hdr.com.au

WESTMEAD MULTI STOREY CARPARK
Cnr Institute Road and Darcy Road
Westmead NSW 2145



DRAWING TITLE:
SHADOW DIAGRAMS SUMMER
SOLSTICE 3pm

SCALE	DOHS NUMBER	CHECKED
1:500	5335	EG
PROJECT NUMBER	DRAWING NUMBER	ISSUE
232186	MSC-HDR-AR-DG-0706	1

SUMMER SOLSTICE 3PM 22 DECEMBER (EDST)

1:500

C:\m\232186\MULTI DECK CARPARK STAND ALONE.dwg
11/11/2015 4:17:30 PM

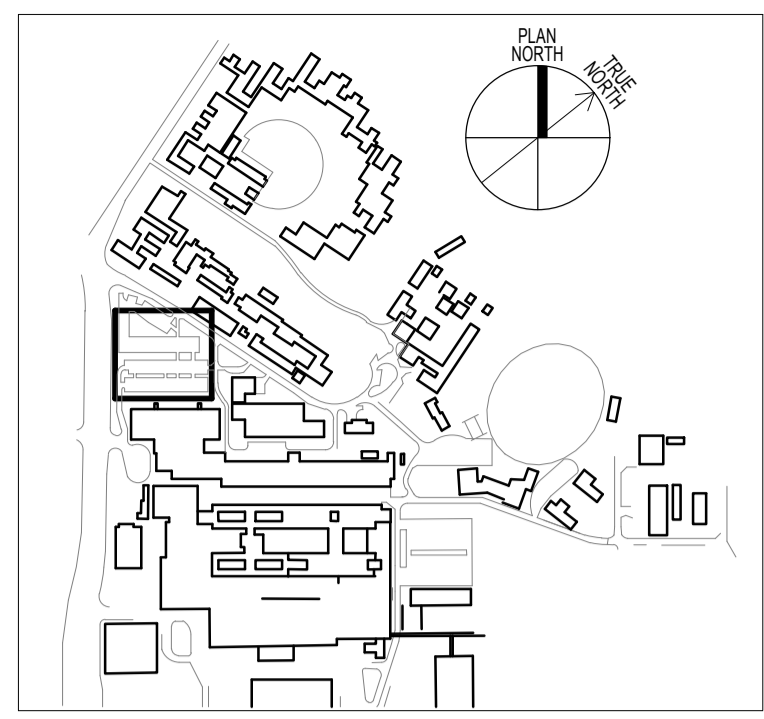

THIS DOCUMENT IS THE COPYRIGHT OF THE HOBBS GROUP (NSW) PTY LTD
 ALL THE INFORMATION ILLUSTRATED ON THIS DOCUMENT IS TO BE CHECKED AND VERIFIED ON SITE
 IN THE EVENT OF DISCREPANCIES REFER TO ARCHITECT PRIOR TO COMMENCEMENT OF THE WORK.
 DO NOT SCALE DRAWINGS ELECTRONICALLY OR MANUALLY.

REV	DESCRIPTION	DRAWN	CHECK	DATE
1	SSD DRAFT	RT	AF	9/10/2015
2	SSD APPROVAL	RT	EG	29/10/2015

GREEN AREA
 DENOTES
 APPROVED
 WORKS

FOR CONTINUATION REFER SHEET DG-0102

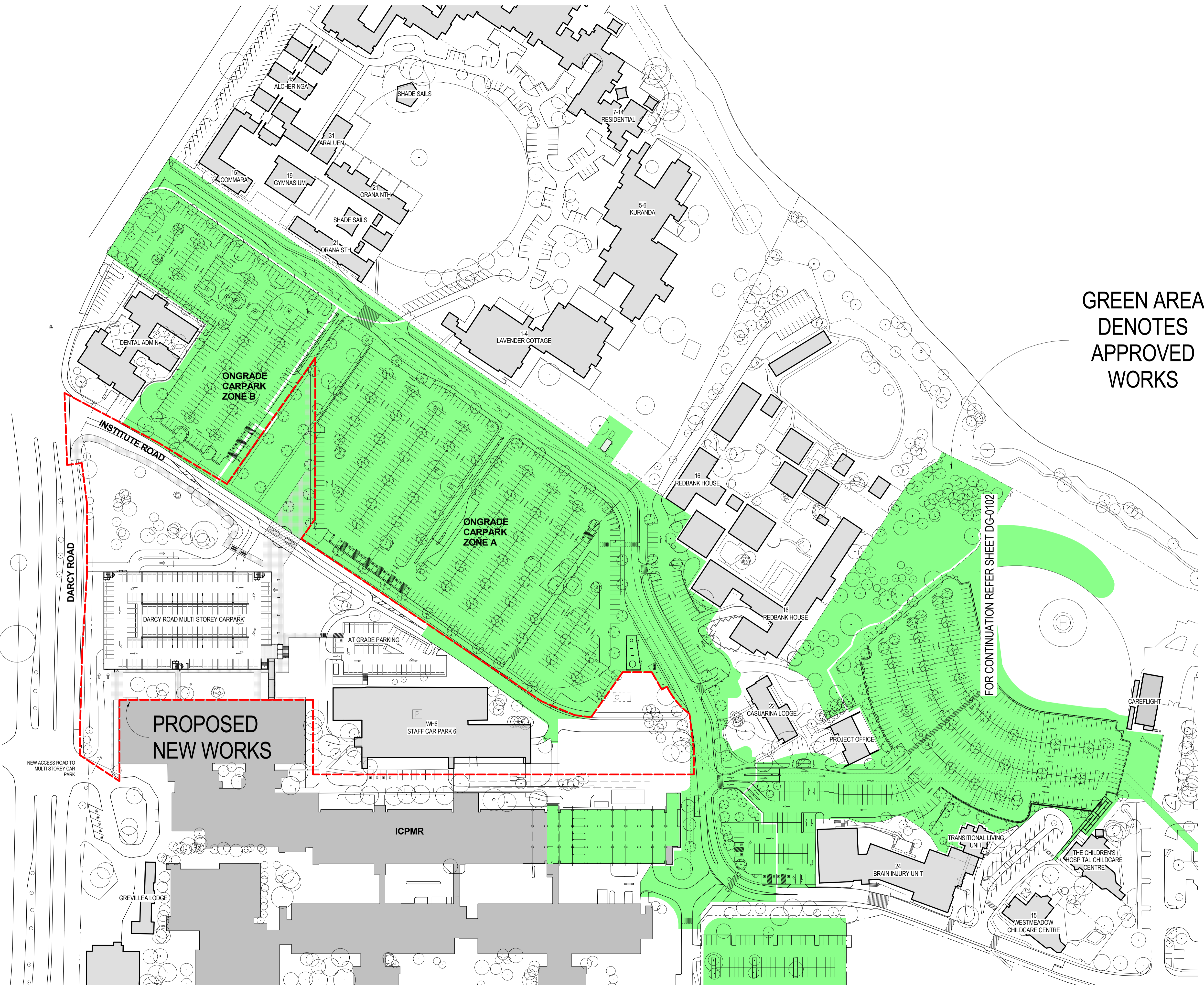

C:\m\232186_MULTI DECK CARPARK_STAND ALONE_10.dwg
 10/11/2015 10:42:50 PM

STATE SIGNIFICANT DEVELOPMENT
 APPROVAL
 NOT FOR CONSTRUCTION

CLIENT:
**NSW HEALTH
 INFRASTRUCTURE**

Level 6, 77 Pacific Highway
 North Sydney NSW 2060

P: (02) 9978 5427
 F: (02) 8904 1377
 www.health.nsw.gov.au

PROJECT MANAGER:
**PRICE WATERHOUSE
 COOPERS**

Darling Park
 201 Sussex Street
 Sydney NSW 2000

P: (02) 8266 2750
 F: (02) 8266 2780
 www.pwc.com.au

LEAD ARCHITECT:
HDR | RD + MSJ

Level 1, 110 Walker Street
 North Sydney NSW 2060

P: (02) 9556 2666
 F: (02) 9559 3015
 aashdr@hdrinc.com.au

WESTMEAD MULTI STOREY CARPARK
 Cnr Institute Road and Darcy Road
 Westmead NSW 2145

Building health. Transforming lives.

DRAWING TITLE:
CAR PARK SITE LOCATION PLAN

SCALE:	DOWNS NUMBER:	CHECKED:
1:1000	5335	EG
PROJECT NUMBER:	DRAWING NUMBER:	ISSUE:
232186	MSC-HDR-AR-DG-1000 2	