

KEY

- Sydney Zoo Scope Boundary
- · - South Plot Boundary (Not In Scope)
- Main Service Vehicle Route
- - - Zoo Internal Back of House Service Road
- Zoo Internal Trafficable Pathway
- Car Parking Route
- Bus Drop Off
- Bus Layover

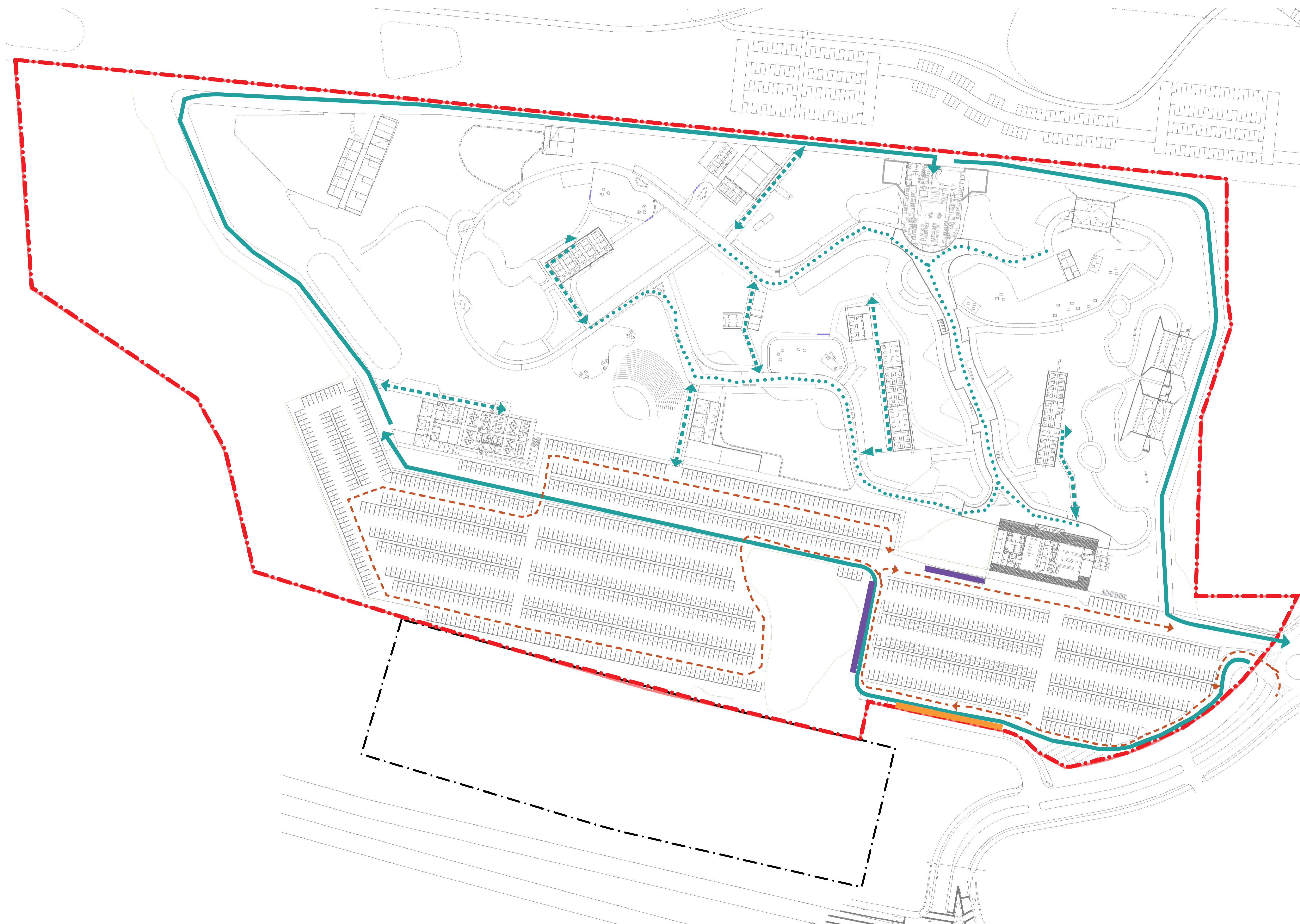

KEY

— Sydney Zoo Scope Boundary

— South Plot Boundary (Not In Scope)

**High Risk**  
The High Flood Risk Precinct is the land subject to a high hydraulic hazard (in accordance with the provisional criteria outlined in the N.S.W. Government Floodplain Development Manual 2005) in a 100 year flood event and/or subject to potential evacuation difficulties during a flood.

**Medium (1:100 year)**  
The Medium Flood Risk Precinct is the land below the 100 year flood level subject to a low hydraulic hazard (in accordance with the provisional criteria outlined in the N.S.W. Government Floodplain Development Manual 2005).

**Low (Possible Maximum Flood)**  
The Low Flood Risk Precinct is all land within the floodplain, ie within the extent of the Probable Maximum Flood (PMF) but not identified as either a high flood risk or medium flood risk precinct. Therefore the Low Flood Risk Precinct is all the land between the 100 year and the PMF flood extents.

