

Mandalong Investments Pty Ltd

ABN 21 000223 754
RICK PISATURO AM JP#128788

“Mandalong Park”
579 MAMRE ROAD
ORCHARD HILLS NSW 2748

OFFICE: 02 9834 5092
Email: mandalongstuds@bigpond.com

13 June 2018

Endeavour Energy
PO Box 811
SEVEN HILLS NSW 1730

Dear Sir/Madam

Folio Identifier 2/1233392, being part of the land in Lot 2 in Deposited Plan 1233392 situated at Mamre Road, Erskine Park, NSW and Folio Identifier 214/1013539, being the land in Lot 214 in Deposited Plan 1013539 ("Property") as shown in Annexure 1

I am the sole director and secretary of the registered proprietor of the Property, Mandalong Investments Pty Ltd.

On behalf of Mandalong Investments Pty Ltd, I hereby:

1. authorise you to liaise with The Trust Company (Australia) Limited, Altis Bulky Retail Pty Ltd, Altis Property Partners Ltd and any authorised agents or contractors of those parties in relation to any proposed planning, rezoning, subdivision and development of the property; and
2. authorise The Trust Company (Australia) Limited, Altis Bulky Retail Pty Ltd, Altis Property Partners Pty Ltd and any authorised agents or contractors of those parties to lodge any applications or submissions in relation to any potential planning, rezoning, subdivision application, easement applications, supply agreements, development of the Property, including any applications to facilitate any access road connections to Lot 2 DP 1233392 and Lot 214 DP 1013539;
3. give consent to The Trust Company (Australia) Limited and Altis Bulky Retail Pty Ltd to enter into a Voluntary Planning Agreement with the Department of Planning and Environment (DPE) and The Roads and Maritime Service in relation to the Property.

Yours faithfully
MANDALONG INVESTMENTS PTY LTD by its
Attorney, James Arthur Creech, pursuant to
Power of Attorney Registered Book 4742 No 964

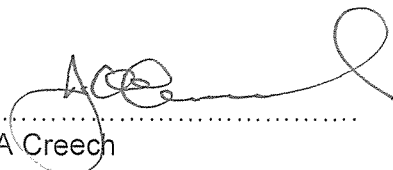
.....
J A Creech

Mandalong Investments Pty Ltd

ABN 21 000223 754
RICK PISATURO AM JP#128788

“Mandalong Park”
579 MAMRE ROAD
ORCHARD HILLS NSW 2748

OFFICE: 02 9834 5092
Email: mandalongstuds@bigpond.com

13 June 2018

Department of Planning & Environment
GPO Box 39
SYDNEY NSW 2001

Dear Sir/Madam

Folio Identifier 2/1233392, being part of the land in Lot 2 in Deposited Plan 1233392 situated at Mamre Road, Erskine Park, NSW and Folio Identifier 214/1013539, being the land in Lot 214 in Deposited Plan 1013539 ("Property") as shown in Annexure 1

I am the sole director and secretary of the registered proprietor of the Property, Mandalong Investments Pty Ltd.

On behalf of Mandalong Investments Pty Ltd, I hereby:

1. authorise you to liaise with The Trust Company (Australia) Limited, Altis Bulky Retail Pty Ltd, Altis Property Partners Ltd and any authorised agents or contractors of those parties in relation to any proposed planning, rezoning, subdivision and development of the property; and
2. authorise The Trust Company (Australia) Limited, Altis Bulky Retail Pty Ltd, Altis Property Partners Pty Ltd and any authorised agents or contractors of those parties to lodge any applications or submissions in relation to any potential planning, rezoning, subdivision application, easement applications, development of the Property, including any applications to facilitate any access road connections to Lot 2 DP 1233392 and Lot 214 DP 1013539;
3. give consent to The Trust Company (Australia) Limited and Altis Bulky Retail Pty Ltd to enter into a Voluntary Planning Agreement with the Department of Planning and Environment (DPE) and The Roads and Maritime Service in relation to the Property.

Yours faithfully
MANDALONG INVESTMENTS PTY LTD by its
Attorney, James Arthur Creech, pursuant to
Power of Attorney Registered Book 4742 No 964

.....
J A Creech

Annexure 1 – Property Plan

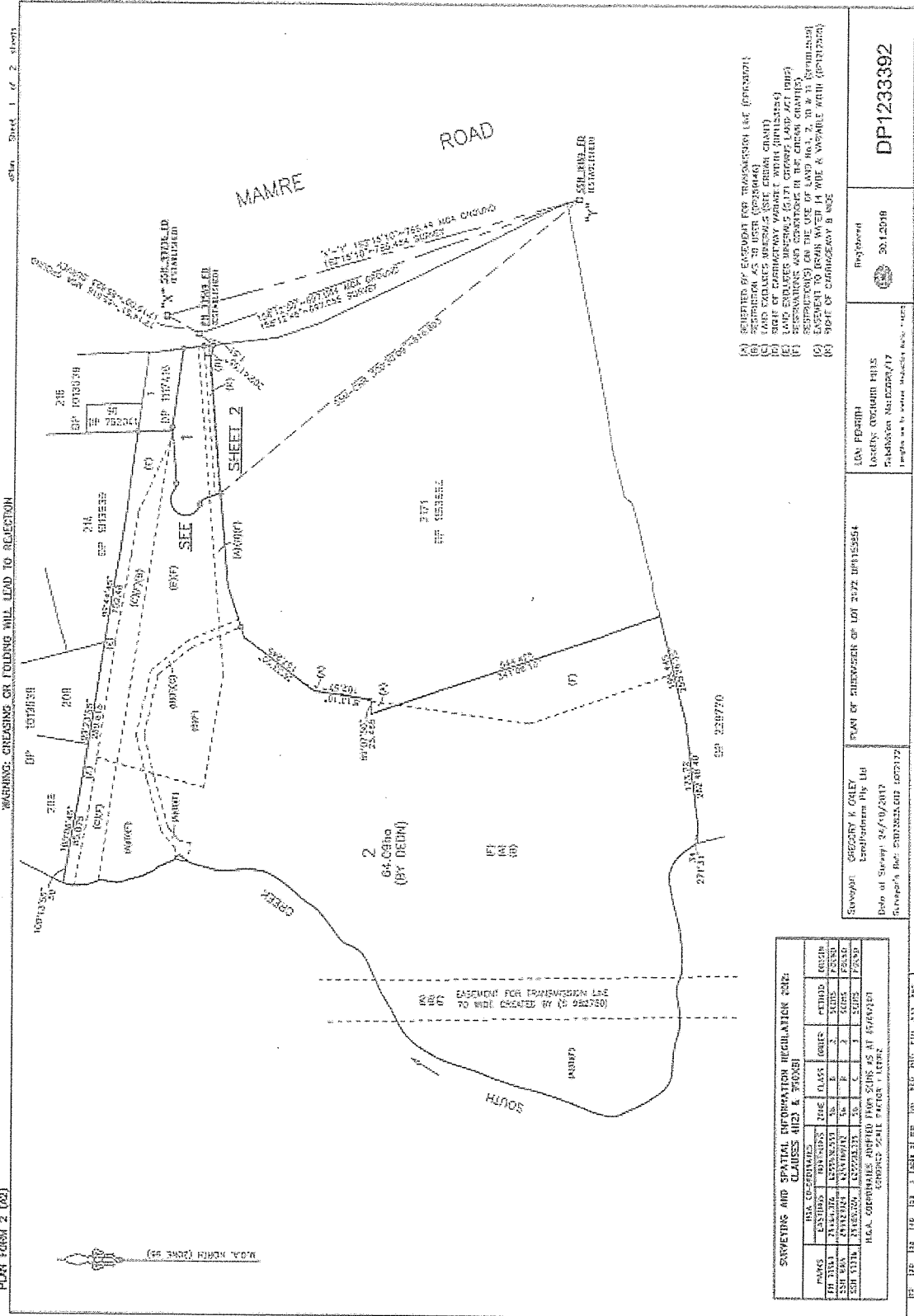

- (A) BELIEFERS OF EASEMENT FOR TRANSMISSION LINE (2017/150)
- (B) BELIEFERS OF EASEMENT FOR TRANSMISSION LINE (2017/150)
- (C) BELIEFERS OF EASEMENT FOR TRANSMISSION LINE (2017/150)
- (D) BELIEFERS OF EASEMENT FOR TRANSMISSION LINE (2017/150)
- (E) BELIEFERS OF EASEMENT FOR TRANSMISSION LINE (2017/150)
- (F) BELIEFERS OF EASEMENT FOR TRANSMISSION LINE (2017/150)
- (G) BELIEFERS OF EASEMENT FOR TRANSMISSION LINE (2017/150)

PLAN OF SUBDIVISION OF LOT 2072 DP1152554

Surveyor: GREGORY K O'LEARY
 Registration No: 17

Date of Survey: 05/10/2017

Project No: 201.0509

DP1233392

SURVEYING AND SPATIAL INFORMATION REGULATION 2012
 CLAUSES 41(2) & 36(2)(b)

PARCEL	AREA (SQ METRES)	CLASS	CLASS	CLASS	METHOD
200	100.00	1	1	1	1
201	100.00	1	1	1	1
202	100.00	1	1	1	1
203	100.00	1	1	1	1
204	100.00	1	1	1	1
205	100.00	1	1	1	1
206	100.00	1	1	1	1
207	100.00	1	1	1	1
208	100.00	1	1	1	1
209	100.00	1	1	1	1
210	100.00	1	1	1	1
211	100.00	1	1	1	1
212	100.00	1	1	1	1
213	100.00	1	1	1	1
214	100.00	1	1	1	1
215	100.00	1	1	1	1
216	100.00	1	1	1	1
217	100.00	1	1	1	1
218	100.00	1	1	1	1
219	100.00	1	1	1	1
220	100.00	1	1	1	1
221	100.00	1	1	1	1
222	100.00	1	1	1	1
223	100.00	1	1	1	1
224	100.00	1	1	1	1
225	100.00	1	1	1	1
226	100.00	1	1	1	1
227	100.00	1	1	1	1
228	100.00	1	1	1	1
229	100.00	1	1	1	1
230	100.00	1	1	1	1
231	100.00	1	1	1	1
232	100.00	1	1	1	1
233	100.00	1	1	1	1
234	100.00	1	1	1	1
235	100.00	1	1	1	1
236	100.00	1	1	1	1
237	100.00	1	1	1	1
238	100.00	1	1	1	1
239	100.00	1	1	1	1
240	100.00	1	1	1	1
241	100.00	1	1	1	1
242	100.00	1	1	1	1
243	100.00	1	1	1	1
244	100.00	1	1	1	1
245	100.00	1	1	1	1
246	100.00	1	1	1	1
247	100.00	1	1	1	1
248	100.00	1	1	1	1
249	100.00	1	1	1	1
250	100.00	1	1	1	1
251	100.00	1	1	1	1
252	100.00	1	1	1	1
253	100.00	1	1	1	1
254	100.00	1	1	1	1
255	100.00	1	1	1	1
256	100.00	1	1	1	1
257	100.00	1	1	1	1
258	100.00	1	1	1	1
259	100.00	1	1	1	1
260	100.00	1	1	1	1
261	100.00	1	1	1	1
262	100.00	1	1	1	1
263	100.00	1	1	1	1
264	100.00	1	1	1	1
265	100.00	1	1	1	1
266	100.00	1	1	1	1
267	100.00	1	1	1	1
268	100.00	1	1	1	1
269	100.00	1	1	1	1
270	100.00	1	1	1	1
271	100.00	1	1	1	1
272	100.00	1	1	1	1
273	100.00	1	1	1	1
274	100.00	1	1	1	1
275	100.00	1	1	1	1
276	100.00	1	1	1	1
277	100.00	1	1	1	1
278	100.00	1	1	1	1
279	100.00	1	1	1	1
280	100.00	1	1	1	1
281	100.00	1	1	1	1
282	100.00	1	1	1	1
283	100.00	1	1	1	1
284	100.00	1	1	1	1
285	100.00	1	1	1	1
286	100.00	1	1	1	1
287	100.00	1	1	1	1
288	100.00	1	1	1	1
289	100.00	1	1	1	1
290	100.00	1	1	1	1
291	100.00	1	1	1	1
292	100.00	1	1	1	1
293	100.00	1	1	1	1
294	100.00	1	1	1	1
295	100.00	1	1	1	1
296	100.00	1	1	1	1
297	100.00	1	1	1	1
298	100.00	1	1	1	1
299	100.00	1	1	1	1
300	100.00	1	1	1	1

Mandalong Investments Pty Ltd

ABN 21 000223 754
RICK PISATURO AM JP#128788

“Mandalong Park”
579 MAMRE ROAD
ORCHARD HILLS NSW 2748

OFFICE: 02 9834 5092
Email: mandalongstuds@bigpond.com

13 June 2018

Sydney Water
PO Box 399
PARRAMATTA NSW 2124

Dear Sir/Madam

Folio Identifier 2/1233392, being part of the land in Lot 2 in Deposited Plan 1233392 situated at Mamre Road, Erskine Park, NSW and Folio Identifier 214/1013539, being the land in Lot 214 in Deposited Plan 1013539 ("Property") as shown in Annexure 1

I am the sole director and secretary of the registered proprietor of the Property, Mandalong Investments Pty Ltd.

On behalf of Mandalong Investments Pty Ltd, I hereby:

1. authorise you to liaise with The Trust Company (Australia) Limited, Altis Bulky Retail Pty Ltd, Altis Property Partners Ltd and any authorised agents or contractors of those parties in relation to any proposed planning, rezoning, subdivision and development of the property; and
2. authorise The Trust Company (Australia) Limited, Altis Bulky Retail Pty Ltd, Altis Property Partners Pty Ltd and any authorised agents or contractors of those parties to lodge any applications or submissions in relation to any potential planning, rezoning, subdivision application, easement applications, supply applications, development of the Property, including any applications to facilitate any access road connections to Lot 2 DP 1233392 and Lot 214 DP 1013539.

Yours faithfully
MANDALONG INVESTMENTS PTY LTD by its
Attorney, James Arthur Creech, pursuant to
Power of Attorney Registered Book 4742 No 964

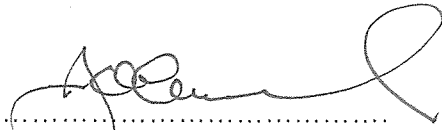
.....
J A Creech

Annexure 1 – Property Plan

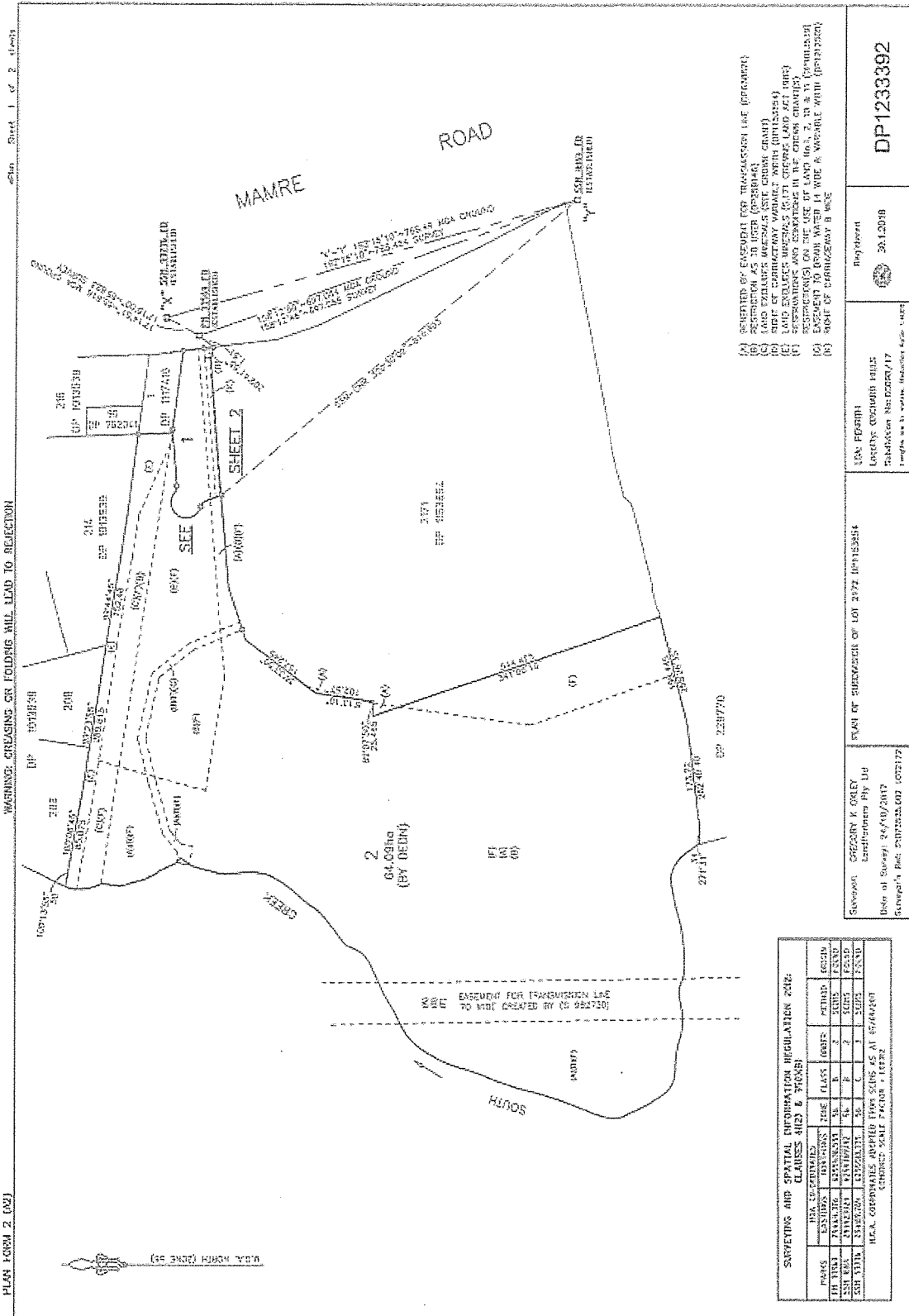

PLAN FORM 2 (02) Sheet 1 of 2 (02)

WARNING: CREASING OR FOLDING WILL LEAD TO REJECTION

SURVEYING AND SPATIAL INFORMATION REGULATION CODE: CLASS 4(2) & 7(2)(B)

PARC	PARC IDENTIFIED	DATE	CLASS	METHOD
1	7444376	2018/05/23	B	SURF
2	2112924	2018/07/17	F	SURF
3	3342520	2018/07/17	C	SURF

HEC-1. COMPANIES APPLIED FOR SURVEY AT 07/04/2017

- (A) BENEVOLENT FOR TRANSMISSION LINE (PROGRAM)
- (B) RESERVATION AS TO USER (PROGRAM)
- (C) RIGHT OF CARRIAGEWAY (PROGRAM)
- (D) LAND EXCLUDES MINERALS (LIT) (GENERAL LAND ACT 1995)
- (E) RESERVATIONS AND EASEMENTS IN THE COMMON CHAIN
- (F) EASEMENTS FOR THE USE OF LAND (ACT 2012) (PROGRAM)
- (G) EASEMENTS FOR THE USE OF LAND (ACT 2012) (PROGRAM)
- (H) RIGHT OF CARRIAGEWAY (PROGRAM)

Surveyor: GREGORY K O'LEARY
 License No: 24740/2017
 Date of Survey: 24/10/2017
 Surveyor's File: 20170124007 1021772

PLAN OF SUBDIVISION OF LOT 2072 (BY DEED)

Lot: 6409011
 Location: COOMBUH HILLS
 Subdivision: 1021772/17
 Register No: 3012018

DP1233392

Mandalong Investments Pty Ltd

ABN 21 000223 754
RICK PISATURO AM JP#128788

“Mandalong Park”
579 MAMRE ROAD
ORCHARD HILLS NSW 2748

OFFICE: 02 9834 5092
Email: mandalongstuds@bigpond.com

13 June 2018

Roads & Maritime Services
PO Box 973
PARRAMATTA NSW 2124

Dear Sir/Madam

Folio Identifier 2/1233392, being part of the land in Lot 2 in Deposited Plan 1233392 situated at Mamre Road, Erskine Park, NSW and Folio Identifier 214/1013539, being the land in Lot 214 in Deposited Plan 1013539 ("Property") as shown in Annexure 1

I am the sole director and secretary of the registered proprietor of the Property, Mandalong Investments Pty Ltd.

On behalf of Mandalong Investments Pty Ltd, I hereby:

1. authorise you to liaise with The Trust Company (Australia) Limited, Altis Bulky Retail Pty Ltd, Altis Property Partners Ltd and any authorised agents or contractors of those parties in relation to any proposed planning, rezoning, subdivision and development of the property; and
2. authorise The Trust Company (Australia) Limited, Altis Bulky Retail Pty Ltd, Altis Property Partners Pty Ltd and any authorised agents or contractors of those parties to lodge any applications or submissions in relation to any potential planning, rezoning, subdivision application, easement applications, development of the Property, including any applications to facilitate any access road connections to Lot 2 DP 1233392 and Lot 214 DP 1013539.

Yours faithfully
MANDALONG INVESTMENTS PTY LTD by its
Attorney, James Arthur Creech, pursuant to
Power of Attorney Registered Book 4742 No 964

.....
J A Creech

Annexure 1 – Property Plan

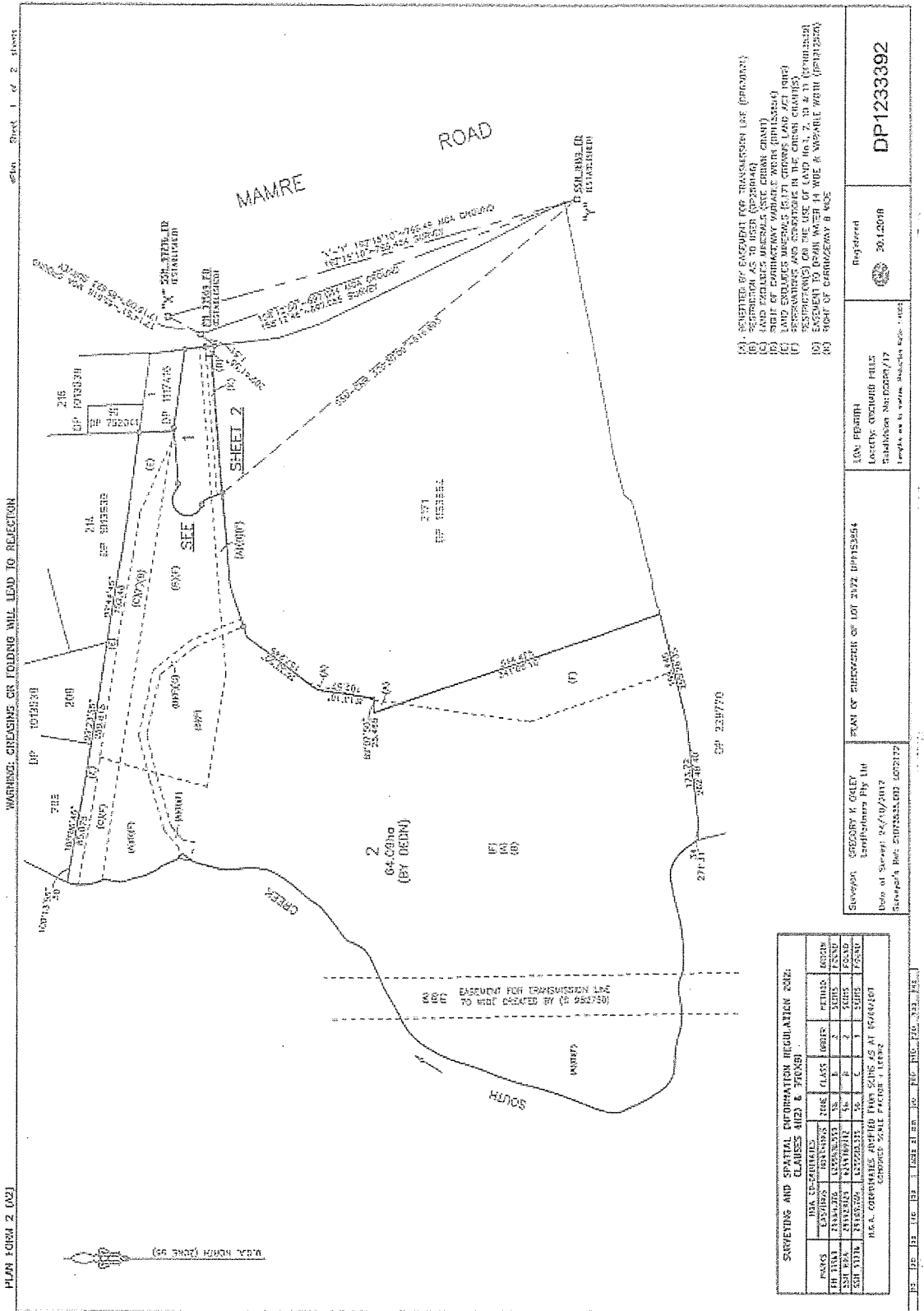

PLAN FORM 2 (A2) Sheet 1 of 2 sheets

WARNING: CREASING OR FOLDING WILL LEAD TO REJECTION

- (A) - REFERRED BY GOVERNOR FOR TRANSMISSION USE (PROPOSED)
- (B) - SUBSTATION AS TO USER (PROPOSED)
- (C) - LOAD CENTER (PROPOSED) (SEE CHAIN CHART)
- (D) - LOAD CENTER (PROPOSED) (SEE CHAIN CHART)
- (E) - LOAD CENTER (PROPOSED) (SEE CHAIN CHART)
- (F) - TRANSMISSION AND SUBSTATION IN THE CHAIN CHARTS
- (G) - SUBSTATION ON THE USE OF LAND (No. 1, 2, 3 & 4) (PROPOSED)
- (H) - EXCEPT TO DEEP WATER 14 WIDE & VARIABLE (No. 1) (PROPOSED)
- (I) - RIGHT OF CONDUITWAY & WIDE

SURVEYING AND SPATIAL INFORMATION REGULATORY BOARD

NAME	REGISTRATION NO.	CLASS	STATUS	METHOD	ACCURACY
MR. J. J. J.	12345678	1	1	1	1
MR. J. J. J.	12345678	1	1	1	1
MR. J. J. J.	12345678	1	1	1	1
MR. J. J. J.	12345678	1	1	1	1
MR. J. J. J.	12345678	1	1	1	1

M.A. CORRECTION APPLIED FROM SHEETS AS AT 18/04/2017
CORRECTION SCALE FACTOR = 1.0000

Surveyor: **STEPHEN K. GALEY**
 Date of Survey: **24/09/2017**
 Surveyor's Reg. No.: **2017222222**

PLAN OF SUBDIVISION OF LOT 2022 DP1233392

Lot: **660000**
 Locality: **COOMBER HILLS**
 Tabulation: **NSW/2004/17**
 Length: see to scale. (Scale: 1:1000)

Registered: **20.12.2018**

DP1233392

Reg: 1233392 / Plan: 1233392 / Rev: 12-Feb-2018 / Sht: CC-01 / Tgt: A11 / Prt: 19-Apr-2018 09:17 / Sht: 1 of 4

Mandalong Investments Pty Ltd

ABN 21 000223 754
RICK PISATURO AM JP#128788

“Mandalong Park”
579 MAMRE ROAD
ORCHARD HILLS NSW 2748

OFFICE: 02 9834 5092
Email: mandalongstuds@bigpond.com

13 June 2018

Penrith City Council
PO Box 60
PENRITH NSW 2751

Dear Sir/Madam

Folio Identifier 2/1233392, being part of the land in Lot 2 in Deposited Plan 1233392 situated at Mamre Road, Erskine Park, NSW and Folio Identifier 214/1013539, being the land in Lot 214 in Deposited Plan 1013539 ("Property") as shown in Annexure 1

I am the sole director and secretary of the registered proprietor of the Property, Mandalong Investments Pty Ltd.

On behalf of Mandalong Investments Pty Ltd, I hereby:

1. authorise you to liaise with The Trust Company (Australia) Limited, Altis Bulky Retail Pty Ltd, Altis Property Partners Ltd and any authorised agents or contractors of those parties in relation to any proposed planning, rezoning, subdivision and development of the property; and
2. authorise The Trust Company (Australia) Limited, Altis Bulky Retail Pty Ltd, Altis Property Partners Pty Ltd and any authorised agents or contractors of those parties to lodge any applications or submissions in relation to any potential planning, rezoning, subdivision application, easement applications, development of the Property, including any applications to facilitate any access road connections to Lot 2 DP 1233392 and Lot 214 DP 1013539;
3. give consent to The Trust Company (Australia) Limited and Altis Bulky Retail Pty Ltd to enter into a Voluntary Planning Agreement with the Department of Planning and Environment (DPE) and The Roads and Maritime Service in relation to the Property.

Yours faithfully

MANDALONG INVESTMENTS PTY LTD by its
Attorney, James Arthur Creech, pursuant to
Power of Attorney Registered Book 4742 No 964

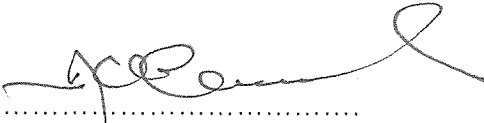
.....
J A Creech

