

KEY PLAN

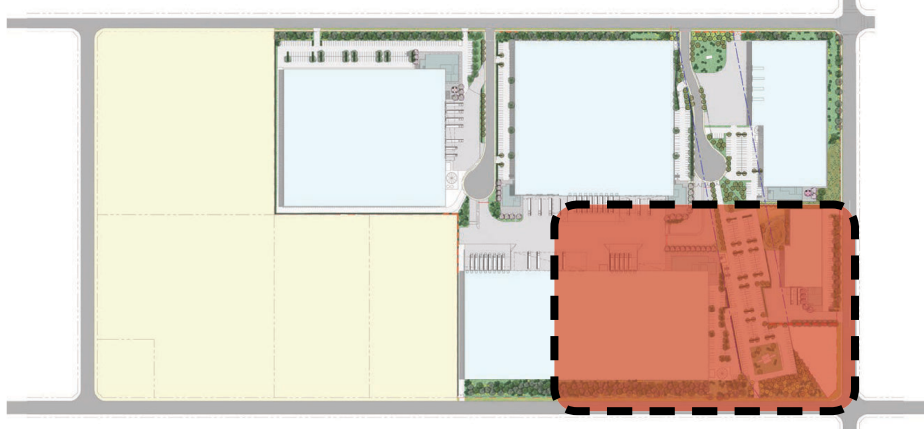

LEGEND

- SITE BOUNDARY
- BLACK MESH SECURITY FENCE 1.8m HIGH WITH 3 BARB WIRE TO TOP
- PALISADE FENCE 1.8m HIGH
- TRANSMISSION EASEMENT LINE
- EXISTING TREE TO BE REMOVED
- COPSE OF TREES TO BE REMOVED
- CANOPY TREE PLANTING WITHIN LANDSCAPE BUFFER ZONES AND TO INTERNAL SITE
- TREES UNDER 4M HIGH
- SCREEN SHRUB PLANTING
- DECIDUOUS TREE PLANTING AROUND OFFICE BUILDINGS
- HEDGE PLANTING
- MASS PLANTED AREAS OF GROUNDCOVERS AND LOW SHRUBS
- NATIVE GRASSES TO SWALE AND AREAS OF ABORIGINAL SITE
- PYLON SIGNAGE
- PROPOSED CONTOURS TO ENGINEERING DETAILS
- SPOT LEVELS TO ENGINEERING DETAILS
- EXISTING SPOT LEVELS
- NOISE WALL LOCATIONS REFER TO ACOUSTIC REPORT
- SECTION LOCATIONS R EFER TO LD08 & LD09

NOTE:  
Landscape design to Prestons Creek Bank Aboriginal site area subject to preparation of Aboriginal Heritage Management Plan and incorporation of heritage interpretive elements.

**Landscape Plan Area 4**  
Drawing LDA05

07.03.2016

Project: **WAREHOUSE & DISTRIBUTION ESTATE**  
Prestons, NSW

Project Number: 20150717

Client: **LOGOS PROPERTY**

Architect: **Axis Architectural**

Project Manager: **DBL**

Scale: 1:500 @ A1 (1:1000 @ A3)



**groundink.**  
landscape architecture · design visuals

© Ground Ink Pty Ltd ABN 55 163 025 45 Suite 201 / 75 Archer St, Chatswood, NSW 2067