

ARCADIA
LANDSCAPE ARCHITECTURE



SAINT IGNATIUS' COLLEGE, RIVERVIEW
LANE COVE NSW
STAGE 1 - LANDSCAPE DEVELOPMENT APPLICATION
APRIL 2018

LANDSCAPE COLOUR PLAN | HANDBALL COURTS

DESIGN PRINCIPLES

The proposed extension of Stage 1 landscape works aims to maintain a connection to the heritage handball courts at St Ignatius College through the use of subtle interpretive elements, which will complement the contemporary new school extension.

It is proposed to cut the remaining brick wall down to 2.0m height and enclose a new passive recreation / outdoor learning space with tiered sandstone seating walls, with a backdrop of new planting. An inground sandstone pebble inlay is proposed within the garden beds, to reference the alignment of the old brick walls of the other handball courts.

An interpretive signage element is also proposed to be installed to commemorate the original school layout.

KEY PLAN



LEGEND

- 01/ Sandstone seating terraces
- 02/ Existing brick walls to be cut down to 2.0m height
- 03/ Garden beds with layered native shrub and groundcover planting
- 04/ Concrete pavement with dark oxide to match new paving works
- 05/ Inground inlay within garden beds along old wall alignments, sandstone pebble between steel edging 600mm wide
- 06/ Interpretive heritage signage element to face of brick wall
- 07/ Tennis court fencing to be installed to top of reduced height brick wall
- 08/ Open interface to Gorman Field



STAGE 1 - LANDSCAPE PLAN | HANDBALL COURTS

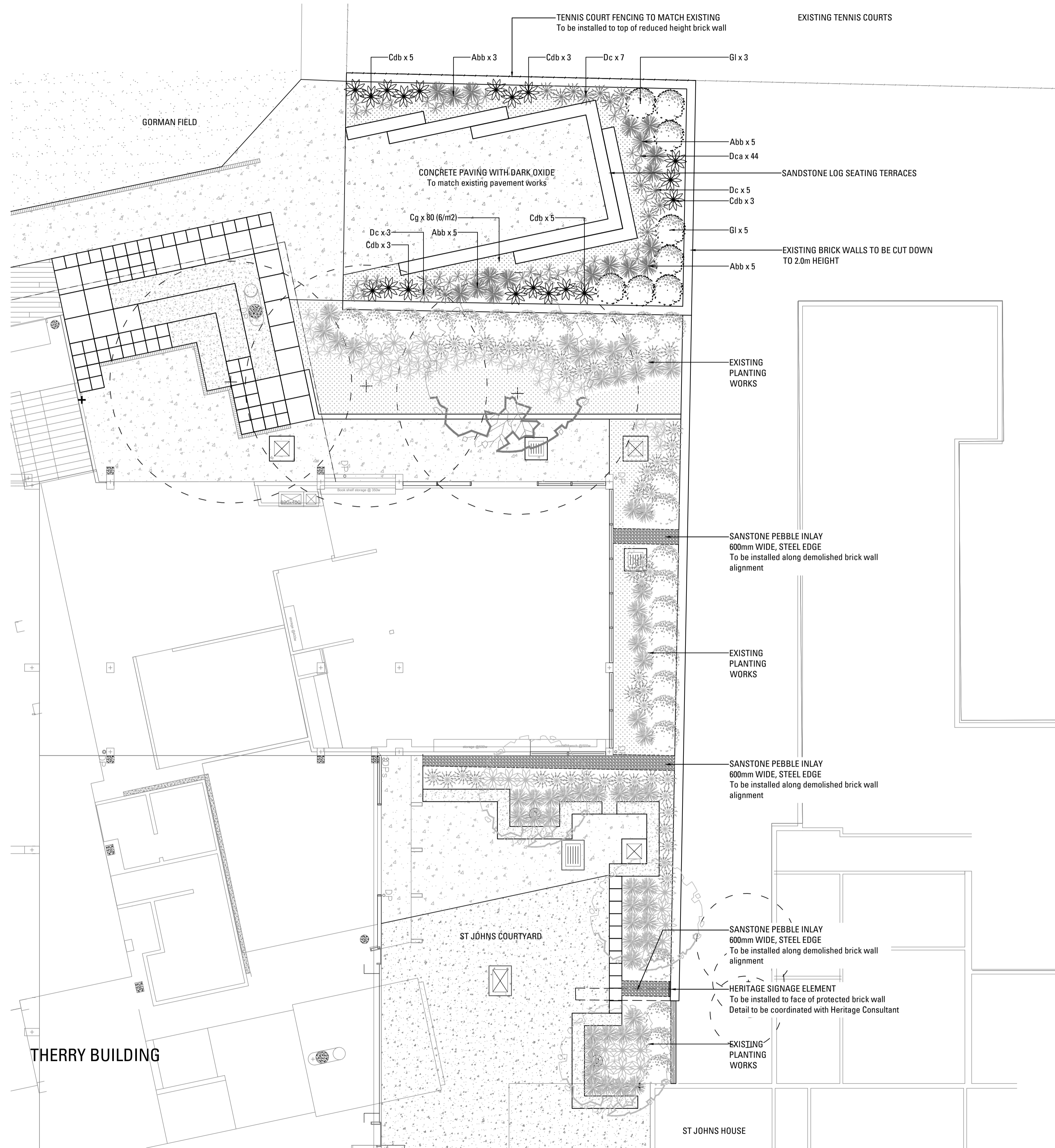

15-290 SAINT IGNATIUS, RIVERVIEW PLANT SCHEDULE - HANDBALL COURTS

CODE	BOTANIC NAME	COMMON NAME	MATURE SIZE (h x w) (m)	PROPOSED POT SIZE	QUANTITY
SHRUBS & ACCENTS					
Abb	<i>Anigozanthus 'Bush Blitz'</i>	Kangaroo Paw	1 x 1	200mm	18
Cdb	<i>Correa reflexa</i>	Common Correa	1 x 1	200mm	19
Gl	<i>Grevillea linearifolia</i>	White Spider Flower	2 x 2	200mm	8
GRASSES & RUSHES					
Dca	<i>Dianella caerulea</i>	Flax Lily	0.5 x 0.5	200mm	44
Dc	<i>Dichelachne crinita</i>	Long Haired Plume Grass	1 x 1	200mm	15
GROUNDCOVERS & CLIMBERS					
Cg	<i>Carpobrotus glaucescens</i>	Pig Face	0.25 x spreading	150mm	80

1:100 @ A1

