

DUKE DATA CENTRE

2-22 KENT ROAD & 685 GARDENERS ROAD,
MASCOT, 2020

LANDSCAPE DETAIL DRAWINGS

DRAWING REGISTER

SSD-000	Landscape Cover Sheet
SSD-101	Master Plan
SSD-102	Ground Floor Detail Plan Sheet 1
SSD-103	Ground Floor Detail Plan Sheet 2
SSD-104	Ground Floor Detail Plan Sheet 3
SSD-105	Ground Floor Detail Plan Sheet 4
SSD-106	Level 3 Mezzanine Terrace Detail Plan & Imagery
SSD-107	Landscape Details & Matrices
SSD-108	Landscape Maintenance Plan & Specification Notes
SSD-109	Planting Schedules & Imagery



GEOSCAPES
LANDSCAPE ARCHITECTS

The use of recycled brick to highlight the entrances and connect with the colonial history. To be loose laid with no mortar to allow water to infiltrate to soil/groundwater

Banksia integrifolia tree

Feature Xanthoreas to the entrance of site as an acknowledgement of country

Dry bed with Estuarine Reedland grasses to the batters with water filtering through as it enters into the stormwater system and returned back to the natural water cycle.

Melaleuca shade trees to car parking blisters

Paving bands to provide wayfinding from the car parking to the main entrances.

Proposed basin to engineers details. Water tolerant Melaleuca trees to edge of basin with grasses to the base

Moments of pause. Meandering deco granite paths with a recycled brick edge and informal seating in the form of sandstone rocks for staff to find refuge within landscaping.

3m offset from the security fence to include low groundcovers/creepers and is free from obstructions.

Banksia integrifolia and Banksia serratta trees to Gardeners Road frontage. Understorey to include a mix of shrubs to screen building.

Earth battering down to a dry bed with Estuarine Reedland grasses to the batters with water filtering through as it enters into the stormwater system and returned back to the natural water cycle

Moments of pause. Meandering deco granite paths with a recycled brick edge and informal seating in the form of sandstone rocks for staff to find refuge within landscaping.

Gravel and stone as a base of the dry bed that will naturally have dips in the landscaping to hold water. A moist and spongy environment with the native grasses to provide shelter for smaller fauna

RICKETTY STREET

GARDENERS ROAD

KENT ROAD

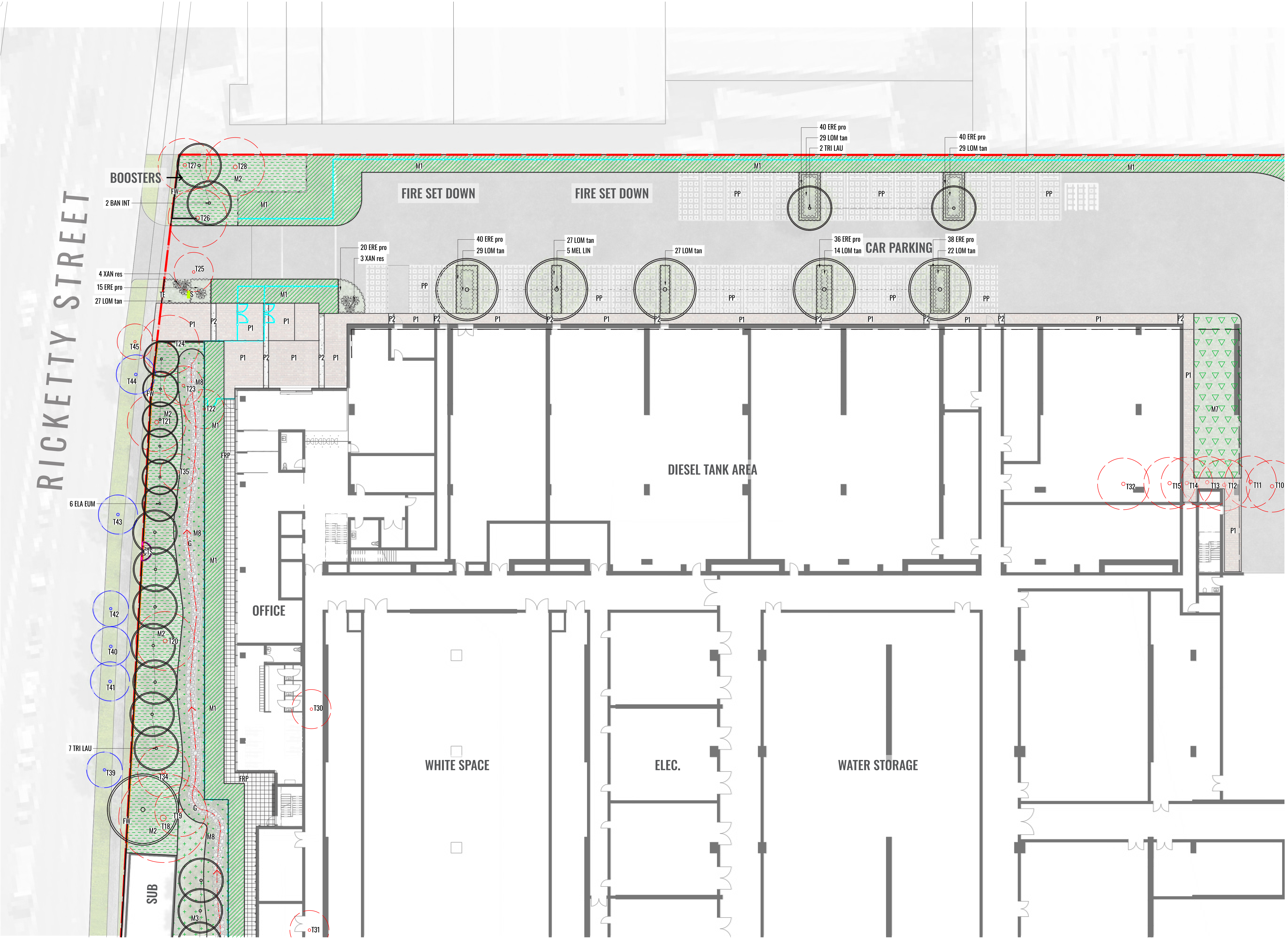

LEGEND

SITE BOUNDARY

SECURITY FENCE TO ARCHITECTS DETAILS

PROPOSED TREES

EXISTING TREES TO BE RETAINED. REFER TO ARBORIST REPORT.

EXISTING TREES TO BE REMOVED. REFER TO ARBORIST REPORT.

PROPOSED GROUNDCOVER PLANTING

ACCENT/FEATURE SHRUB

MATRIX DETAIL 1. REFER TO SSD-107 FOR PLANT ARRANGEMENT

MATRIX DETAIL 2. REFER TO SSD-107 FOR PLANT ARRANGEMENT

MATRIX DETAIL 3. REFER TO SSD-107 FOR PLANT ARRANGEMENT

MATRIX DETAIL 4. REFER TO SSD-107 FOR PLANT ARRANGEMENT

MATRIX DETAIL 5. REFER TO SSD-107 FOR PLANT ARRANGEMENT

MATRIX DETAIL 6. REFER TO SSD-107 FOR PLANT ARRANGEMENT

MATRIX DETAIL 7. REFER TO SSD-107 FOR PLANT ARRANGEMENT

MATRIX DETAIL 8. REFER TO SSD-107 FOR PLANT ARRANGEMENT

MATRIX DETAIL 9. REFER TO SSD-107 FOR PLANT ARRANGEMENT

DRY BED FLOW DIRECTION

RECYCLED BRICK. TO BE OF LOOSE LAY NO MORTAR TO ALLOW WATER INFILTRATION

LIGHT EXPOSED AGGREGATE CONCRETE PAVING BANDS

FLOOD WALL TO ENGINEERS DETAIL

GRAVEL/RIVER PEBBLE TO BASE OF SWALE

PERMEABLE PAVERS TO ARCHITECTS DETAIL

ROOT BARRIER

FRP WALKWAY

PYLON SIGNAGE TO ARCHITECTS DETAILS

TIMBER EDGING

RECYCLED BRICK EDGING

DECO GRANITE

SANDSTONE ROCKS

CURVED TIMBER SEATING

LEGEND

NOT FOR CONSTRUCTION

GEOSCAPES
LANDSCAPE ARCHITECTS

Suite 303, 8 Help St, Chatswood NSW 2067
Ph. (02) 9411 1485
www.geoscapes.com.au
ABN 84 620 205 781 ACN 620 205 781

Client:

Drawing Title:

**GROUND FLOOR DETAIL PLAN
SHEET 1**

DWG No:

SSD-102

Scale: 1:300 @ A1
1:600 @ A3

Date: 21.05.2025

Job Number: 240419

North:

Project: **DUKE DATA CENTRE**
2-22 KENT ROAD & 685 GARDENERS ROAD, MASCOT, NSW 2020

Revision				FOR SSDA	
Rev	Date	Description	Drawn	Checked	
1	26.09.24	FOR SSDA	KC	BG	
2	21.05.25	SSDA Amendment	KC	BG	



LEGEND

SITE BOUNDARY

SECURITY FENCE TO ARCHITECTS DETAILS

PROPOSED TREES

EXISTING TREES TO BE RETAINED. REFER TO ARBORIST REPORT.

EXISTING TREES TO BE REMOVED. REFER TO ARBORIST REPORT.

PROPOSED GROUND COVER PLANTING

ACCENT/FEATURE SHRUB

MATRIX DETAIL 1. REFER TO SSD-107 FOR PLANT ARRANGEMENT

MATRIX DETAIL 2. REFER TO SSD-107 FOR PLANT ARRANGEMENT

MATRIX DETAIL 3. REFER TO SSD-107 FOR PLANT ARRANGEMENT

MATRIX DETAIL 4. REFER TO SSD-107 FOR PLANT ARRANGEMENT

MATRIX DETAIL 5. REFER TO SSD-107 FOR PLANT ARRANGEMENT

MATRIX DETAIL 6. REFER TO SSD-107 FOR PLANT ARRANGEMENT

MATRIX DETAIL 7. REFER TO SSD-107 FOR PLANT ARRANGEMENT

MATRIX DETAIL 8. REFER TO SSD-107 FOR PLANT ARRANGEMENT

MATRIX DETAIL 9. REFER TO SSD-107 FOR PLANT ARRANGEMENT

DRY BED FLOW DIRECTION

RECYCLED BRICK. TO BE OF LOOSE LAY NO MORTAR TO ALLOW WATER INFILTRATION

LIGHT EXPOSED AGGREGATE CONCRETE PAVING BANDS

FLOOD WALL TO ENGINEERS DETAIL

GRAVEL/RIVER PEBBLE TO BASE OF SWALE

PERMEABLE PAVERS TO ARCHITECTS DETAIL

ROOT BARRIER

FRP WALKWAY

PYLON SIGNAGE TO ARCHITECTS DETAILS

TIMBER EDGING

RECYCLED BRICK EDGING

DECO GRANITE

SANDSTONE ROCKS

CURVED TIMBER SEATING

LEGEND

NOT FOR CONSTRUCTION

GEOSCAPES

LANDSCAPE ARCHITECTS

Suite 303, 8 Help St, Chatswood NSW 2067

Ph. (02) 9411 1485

www.geoscapes.com.au

ABN 84 620 205 781 ACN 620 205 781

Client:

Drawing Title:

GROUND FLOOR DETAIL PLAN

SHEET 2

DWG No:

SSD-103

Scale: 1:300 @ A1
1:600 @ A3

Date: 21.05.2025

Job Number: 240419

North:

Project: DUKE DATA CENTRE
2-22 KENT ROAD & 685 GARDENERS ROAD, MASCOT, NSW 2020

Revision			FOR SSDA	
Rev	Date	Description	Drawn	Checked
1	26.09.24	FOR SSDA	KC	BG
2	21.05.25	SSDA Amendment	KC	BG



LEGEND

SITE BOUNDARY

SECURITY FENCE TO ARCHITECTS DETAILS

PROPOSED TREES

EXISTING TREES TO BE RETAINED. REFER TO ARBORIST REPORT.

EXISTING TREES TO BE REMOVED. REFER TO ARBORIST REPORT.

PROPOSED GROUNDCOVER PLANTING

ACCENT/FEATURE SHRUB

M1

MATRIX DETAIL 1. REFER TO SSD-107 FOR PLANT ARRANGEMENT

M2

MATRIX DETAIL 2. REFER TO SSD-107 FOR PLANT ARRANGEMENT

M3

MATRIX DETAIL 3. REFER TO SSD-107 FOR PLANT ARRANGEMENT

M4

MATRIX DETAIL 4. REFER TO SSD-107 FOR PLANT ARRANGEMENT

M5

MATRIX DETAIL 5. REFER TO SSD-107 FOR PLANT ARRANGEMENT

M6

MATRIX DETAIL 6. REFER TO SSD-107 FOR PLANT ARRANGEMENT

M7

MATRIX DETAIL 7. REFER TO SSD-107 FOR PLANT ARRANGEMENT

M8

MATRIX DETAIL 8. REFER TO SSD-107 FOR PLANT ARRANGEMENT

M9

MATRIX DETAIL 9. REFER TO SSD-107 FOR PLANT ARRANGEMENT

DRY BED FLOW DIRECTION

P1

RECYCLED BRICK. TO BE OF LOOSE LAY NO MORTAR TO ALLOW WATER INFILTRATION

P2

LIGHT EXPOSED AGGREGATE CONCRETE PAVING BANDS

FW

FLOOD WALL TO ENGINEERS DETAIL

G

GRAVEL/RIVER PEBBLE TO BASE OF SWALE

PP

PERMEABLE PAVERS TO ARCHITECTS DETAIL

RB

ROOT BARRIER

FRP

FRP WALKWAY

S

PYLON SIGNAGE TO ARCHITECTS DETAILS

TE

TIMBER EDGING

BE

RECYCLED BRICK EDGING

DG

DECO GRANITE

SANDSTONE ROCKS

CTS

CURVED TIMBER SEATING

SSD-104

NOT FOR CONSTRUCTION

GEOSCAPES

Suite 303, 8 Help St, Chatswood NSW 2067
Ph. (02) 9411 1485
www.geoscapes.com.au
ABN 84 620 205 781 ACN 620 205 781

Client:

Goodman

Drawing Title:

GROUND FLOOR DETAIL PLAN
SHEET 3
DWG No:

Scale:

1:300 @ A1
1:600 @ A3

Date:

21.05.2025

Job Number:

240419

North:

Revision

Rev	Date	Description	Drawn	Checked
1	26.09.24	FOR SSDA	KC	BG
2	21.05.25	SSDA Amendment	KC	BG

Project:

DUKE DATA CENTRE
2-22 KENT ROAD & 685 GARDENERS ROAD, MASCOT, NSW 2020

SSD-104

LANDSCAPE DETAILS

TREE/SHRUB SIZE AND QUALITY TO BE TO NATSPEC STANDARD. SPECIES IS TO BE AS PER PLAN AND PLANT SCHEDULE. ENSURE ONLY HEALTHY AND VIGOROUS, DISEASE FREE, WELL MAINTAINED PLANTS ARE USED.

TAKE CARE TO ENSURE FOLIAGE, BRANCHES, TRUNKS AND ROOT CROWNS ARE NOT DAMAGED BEFORE, DURING AND AFTER PLANTING.

ENSURE OPTIMUM MAINTENANCE AND ESTABLISHMENT OF TREES/SHRUBS OCCURS AS SOON AS THEY ARE AT SITE

THOROUGHLY SOAK THE ROOTBALL OF TREE WITH FRESH WATER BEFORE TAKING OFF POT OR BAG. WHEN PLANTING HOLE IS COMPLETE USE A SHARP SPADE TO SHAVE OFF 20-50MM OF THE SIDES AND BASE OF ROOTBALL (TO ROOD PRUNE IT) BEFORE CAREFULLY PLACING INTO PLANTING HOLE. IF NORTH IS MARKED ON THE TREE, ENSURE ORIENTATION IS CORRECT WITH NORTH MARKING TO THE NORTH.

- REMOVE ANY STAKES, TIES AND LABELS. WATER ROOTBALL THOROUGHLY.
- TOP OF ROOTBALL TO FINISH FLUSH WITH TOP OF SOIL.

MASS PLANTING - TYPICAL DETAIL

Scale 1:20

TUBESTOCK PLANTING - TYPICAL DETAIL

Scale 1:10

LANDSCAPE MATRIX DETAILS

M1 - SECURE ZONE

Scale 1:50

M2 - RICKETTY STREET WEST

Scale 1:50

M3 - RICKETTY STREET EAST

Scale 1:50

M4 - KENT ROAD

Scale 1:50

M5 - GARDENERS ROAD EAST

Scale 1:50

M6 - GARDENERS ROAD WEST

Scale 1:50

M7 - UNDER CROFT LANDSCAPE

Scale 1:50

M8 - SWALE BATTERS

Scale 1:50

M9 - BASIN

Scale 1:50

LANDSCAPE MAINTENANCE PLAN AND SPECIFICATION

Maintenance shall mean the care and maintenance of the landscape works by accepted horticultural practice as rectifying any defects that become apparent in the landscape works under normal use. The landscape contractor shall attend the site on a **weekly basis** to maintain the landscape works commencing from practical completion.

Rubbish Removal

The Landscape Contractor shall undertake rubbish removal from the site on a **weekly basis** to ensure the site remains in tidy condition.

Weed Eradication

Weed growth that may occur in grassed, planted or mulched areas is to be removed using environmentally acceptable methods i.e. non-residual glyphosate herbicide (e.g. ‘Roundup’, applied in accordance with the manufacturer’s direction.

Tree Replacement

Trees shall show signs of healthy vigorous growth and be free from disease and not exhibit signs of stress prior to handover to the client. Any trees or plant that die or fail to thrive, or are damaged or stolen will be replaced. Replacement material shall have the initial maintenance period extended in accordance with the landscape contract conditions. Trees and plant materials shall be equal to the minimum requirements of species specified and approved material delivered to site. Should the condition decline from the approved sample the Superintendent reserves the right to reject the tree / plants.

Frequency: as required.

Stakes

Adjust and/or replace stakes and ties where required. Remove staking and guying when instructed by the Superintendent

Pruning

Selective pruning may be required during the establishment period to promote a balanced canopy structure. These activities shall be carried out to the best horticultural and industry practice. All pruned material is to be removed from site.

Mulched Surfaces

All planter beds and garden areas shall have a minimum depth of 75mm organic mulch. All mulch is to be free of deleterious matter such as soil, weeds, sticks and should conform to AS 4454. Mulched surfaces are to be kept clean and tidy and free of any deleterious material and foreign matter. Reinstate depths to a uniform level of 75mm with mulch as specified, mulch to be free of any wood material impregnated with CCA or similar toxic treatment. Top up mulch levels prior to handover to client & estate management.

Watering

Implement an appropriate hand watering regime in areas not irrigated in association with current watering programme to maintain plant health and vigour. The program shall reflect seasonal conditions and plant species.

Frequency: Weekly or as required.

Soil In Natural Ground (D1)

Australian native garden beds to have soil installed consisting of 50% existing site topsoil and 50% new topsoil equal or equivalent to Benedict Smartmix 6 Native Garden Mix (Horizon A). Subsoil (below 300mm) to be of premium grade Native Garden Sub-soil mix of or equivalent to Benedict Smartmix 7 Native Garden subsoil (Horizon B). Soil to conform to AS4419.

Planter Boxes

The waterproofing membrane is to be sealed to the drainage outlet and extend vertically to a height of 100mm above the soil or fill level. A protection board should be installed to minimise root damage to the membrane. The internal fall in the planter box should be a minimum of 1:100 and a suitable safety overflow should be provided. Externally exposed walls of the planter boxes should be waterproofed to prevent failure of the internal membrane. The A Horizon (the top 300mm) of a Planter Box Soil Profile should be a free draining, non-slumping material that has a level of organic matter to improve nutrient levels in the soil. The B Horizon (below 300mm) in a Planter Box Soil Profile, should be a free draining, non-slumping material, that has very low organic matter levels.

Pest and Disease Control

The Landscape Contractor shall spray for pests and disease infestations when the pest and fungal attack has been positively identified and when their populations have increased to a point that will become detrimental to plant growth. Apply all pesticides to manufacturer’s directions.

Frequency: weekly inspection

Fertilising

Generally check for signs of nutrient deficiencies (yellowing of leaves, failure to thrive), and adapt fertiliser regime to suit. Fertiliser should be applied at the beginning and the end of the (summer) growing season.

Irrigation

A sub surface dripper style, electrically automated self timed irrigation system is to be supplied to all garden bed areas and planter container. Regular checks are to be made to ensure continued successful operation. The Landscape Contractor shall be responsible for coordination and engagement of a specialist irrigation designer and installation contractor to design, supply and install an automatic subterranean drip irrigation system to all raised planter beds.

The irrigation system will need to provide designated landscaped areas with enough water for vigorous healthy plant growth. As a general rule landscaped areas will need 20-25mm, species dependant, of water per week. The landscape Contractor will need to monitor natural rainfall using a rain switch in order to set irrigation flow rates accordingly on a monthly basis.

Standards

All grown or purchased plant stock must conform to all the conditions and requirements given in NATSPEC Guide: Specifying Trees. Soils to be in accordance with AS4419, mulching composts and conditioners to be in accordance with AS4454. Soils should conform to best practice specifications as listed in the Landscape Soils Handbook (Simon Leake & Elke Haege 2017).

Record Keeping

The landscape maintenance works that are carried out in accordance with the management plan are to be recorded in a log book by the Contractor responsible for landscape maintenance. The records shall include details of materials and procedures used as well as time and method of application. A record of inclement weather should also be kept verifying inability to carry out work within the specified time frame. A summary report of landscape maintenance works completed is to be prepared at the end of each month and annually by the Contractor.

CATEGORY	TASKS	TIMEFRAMES / FREQUENCY							
		Monthly	Spring	Summer	Autumn	Winter	As Required	Specification	
1. Weeding	Weed garden areas manually or with approved herbicide	✓						Prior approval required for Herbicide use. Approved Herbicide use to be in accordance with regulation rates and manufacturer’s recommendation. Protect plants from overspray and avoid if rain is likely within 12 hour period. Hand weeding should always take preference over the use of herbicides.	
2. Leaf Litter Removal	Do not remove leaf litter from planted areas unless depth of litter is impacting on plant growth Remove leaf litter from pathways	✓							
3. Mulching	Reapply organic mulch to maintain to a depth of 75mm		✓						
4. Plant Fertiliser	Fertilise all plants at specified rates based on soil testing results		✓					Prior approval required for fertiliser use. Slow release fertiliser N:P:K ratio– 18:3:10 at manufacturer’s recommended rate per plant. Initial fertilising at planting based on soil testing results	
5. Pest & Disease Control	Check for incidence of fungal and insect attack	✓							
	Avoid use of chemical sprays Apply appropriate treatment for fungal and insect attack if necessary subject to approval						✓	Prior approval required of chemical to be applied	
6. Pruning & Trimming									
<i>Shrubs & groundcovers</i>	Tip prune to encourage density. Length removed depending on vigour of previous plant growth	✓				✓	✓		
<i>Trees</i>	Remove deadwood, remove suckering roots from rootball, check ties						✓	Notify in writing to Building Management any perceived need for tree structural work	
	Ensure trees are trimmed and not overhanging 3m secure zone from fence	✓					✓		
7. Plant Removal & Repalcements	Inspect for failed or dying plants requiring replacement and record probable cause	✓							
	Replant after dead or failed plant removal						✓	Densities, sizes and species to be in accordance with Landscape Detail Plans	
8. Irrigation System	Check sprinkler operation to make sure they are properly rotating and that there are no leaks and clogged nozzles (at initial installation and following weeks.)	✓							
	Pump system check and flushing of system if required		✓		✓				
	Adjust irrigation rates for winter and summer			✓		✓			

NOT FOR CONSTRUCTION



Suite 303, 8 Help St, Chatswood NSW 2067
Ph. (02) 9411 1485
www.geoscapes.com.au
ABN 84 620 205 781 ACN 620 205 781

Client:



Drawing Title:

LANDSCAPE MAINTENANCE PLAN & SPECIFICATION NOTES

DWG No:

SSD-108

Scale:	Date:	Job Number:	North:
N/A	21.05.2025	240419	N/A
Project:	DUKE DATA CENTRE 2-22 KENT ROAD & 685 GARDENERS ROAD, MASCOT, NSW 2020		

Revision			FOR SSDA	
Rev	Date	Description	Drawn	Checked
1	26.09.24	FOR SSDA	KC	BG
2	21.05.25	SSDA Amendment	KC	BG

GROUND FLOOR PLANT SCHEDULE

Code	Botanical Name	Common Name	Mature Height	Spacing	Install Size	Eastern Suburbs Banksia Scrub or Estuarine Reedland	Native	Qty*
Trees								
BAN INT	<i>Banksia integrifolia</i>	Coast Banksia	5-10m	As Shown	100L	✓	✓	15
BAN SER	<i>Banksia serrata</i>	Old Man Banksia	5-15m	As Shown	100L	✓	✓	13
ELA EUM	<i>Elaeocarpus eumundii</i>	Blueberry Ash	8-10m	As Shown	100L		✓	27
EUC GUM	<i>Eucalyptus Gummifera</i>	Red Bloodwood	20-25m	As Shown	100L	✓	✓	18
MEL LIN	<i>Melaleuca linariifolia</i>	Snow-In-Summer	5-15m	As Shown	100L		✓	13
MEL QUI	<i>Melaleuca quinquenervia</i>	Broad-Leaved Paperbark	12-14m	As Shown	100L	✓	✓	7
TRI LAU	<i>Tristaniopsis laurina</i>	Water Gum	7-12m	As Shown	100L		✓	15
WAT FLO	<i>Waterhousea floribunda</i>	Weeping Lilly Pilly	10-15m	As Shown	100L		✓	2
Shrubs								
AST pin	<i>Astroloma pinifolium</i>	Pine Heath	0.5-1m	As Shown	200mm	✓	✓	68
ERI aus	<i>Eriostemon australasius</i>	Pink Wax Flower	1-2m	As Shown	200mm	✓	✓	72
DIL ret	<i>Dillwynia retorta</i>	Healthy Bush Pea	2m**	As Shown	200mm	✓	✓	129
KUN amb	<i>Kunzea ambigua</i>	Tick Bush	2m**	As Shown	200mm	✓	✓	151
MEL squ	<i>Melaleuca squamea</i>	Swamp Honey Myrtle	2m**	As Shown	200mm	✓	✓	103
PIM lin	<i>Pimelea linifolia</i>	Slender Rice Flower	1m	As Shown	200mm	✓	✓	82
XAN res	<i>Xanthorrhoea resinosa</i>	Grass Tree	1m	As Shown	200mm	✓	✓	7
Grasses & Groundcovers								
ACT hel	<i>Actinotus helianthi</i>	Flannel Flower	0.3-0.9m	5/m2	Tube	✓	✓	959
ACT min	<i>Actinotus minor</i>	Lesser Flannel Flower	0.3m	5/m2	Tube	✓	✓	2541
CAR ros	<i>Carpobrotus rossi</i>	Native Pig Face	0.3m	3/m2	140mm		✓	677
CYA dia	<i>Cyathochaeta diandra</i>	Sheath Sedge	0.6m	5/m2	140mm	✓	✓	714
DIA rev	<i>Dianella revoluta</i>	Blueberry Lily	1m	5/m2	Tube	✓	✓	246
DIC cri	<i>Dichelachne crinita</i>	Longhair Plume Grass	1m**	5/m2	Tube	✓	✓	820
ERA bro	<i>Eragrostis brownii</i>	Browns Lovegrass	0.6m	5/m2	140mm	✓	✓	583
ERE pro	<i>Eremophila glabra 'Prostrate'</i>	Emu Bush	0.3m	3/m2 or 3/Lm	140mm		✓	229
HIB fas	<i>Hibbertia fasciculata</i>	Bundled Guinea-Flower	0.4m	3/m2	200mm	✓	✓	656
LEP sca	<i>Leprodia scariosa</i>	Swamp Grass	0.6m	5/m2	Tube	✓	✓	819
LOM lon	<i>Lomandra longifolia</i>	Basket Grass	0.6-0.9m	5/m2	Tube	✓	✓	699
LOM tan	<i>Lomandra longifolia 'Tanika'</i>	Mat Rush	0.5m	5/m2 or 5/Lm	Tube		✓	414
MYO yar	<i>Myoporum parvifolium 'Yareena'</i>	Creeping Boobialla	0.1m	3/m2	140mm		✓	677
POM umb	<i>Pomax umbellata</i>	Pomax	0.4m	5/m2	Tube	✓	✓	604
VIO hed	<i>Viola hederacea</i>	Native Violet	0.1m	3/m2	Tube		✓	98
WES low	<i>Westringia 'Low Horizon'</i>	Coastal Rosemary	0.3m	3/m2	140mm		✓	677
Dry Bed Edge and Basin Planting								
PQA sie	<i>Poa sieberiana</i>	Blue Tussock Grass	1m	As Shown	Tube	✓	✓	1144
FIC nod	<i>Ficinia nodosa</i>	Club Rush	1m	As Shown	Tube	✓	✓	1144
ISO inu	<i>Isolepsis inundata</i>	Swamp Club Rush	0.5m	As Shown	Tube	✓	✓	1144
JUN kra	<i>Juncus kraussii subsp. Australiensis</i>	Sea Rush	1m	As Shown	Tube	✓	✓	1144
MAC jun	<i>Machaerina juncea</i>	Bare Twig-Rush	0.2-0.9m	As Shown	Tube	✓	✓	1144
PHI lan	<i>Philydrum lanuginosum</i>	Frog Mouth	1m	As Shown	Tube	✓	✓	475
GAH cla	<i>Gahnia clarkiei</i>	Tall Saw-Sedge	1.5m	As Shown	Tube	✓	✓	475
TET tet	<i>Tetragonia tetragonioides</i>	New Zealand Spinach	0.5m	As Shown	Tube	✓	✓	475

* Quantities to be finalised during CC/Tender

** Plants to be trimmed to heights indicated

LEVEL 3 MEZZANINE TERRACE PLANT SCHEDULE

Code	Botanical Name	Common Name	Mature Height	Spacing	Install Size	Native	Qty*
Shrubs							
ASP aus	<i>Asplenium australasicum</i>	Birds Nest Fern	1m	As Shown	200mm	✓	3
HYM gol	<i>Hymenosporum flavum 'Gold Nugget'</i>	Native Frangipani	1m	3/Lm	200mm	✓	54
Grasses & Groundcovers							
DIA sil	<i>Dianella 'Silver Streak'</i>	Flax Lily	0.5m	5/m2 or 5/Lm	Tube	✓	101
LOM tan	<i>Lomandra longifolia 'Tanika'</i>	Mat Rush	0.5m	5/m2 or 5/Lm	Tube	✓	101
MYO yar	<i>Myoporum parvifolium 'Yareena'</i>	Creeping Boobialla	0.1m	3/m2 or 3/Lm	140mm	✓	60
VIO hed	<i>Viola hederacea</i>	Native Violet	0.1m	5/m2 or 5/Lm	Tube	✓	46

* Quantities to be finalised during CC/Tender

GROUND FLOOR PLANTING IMAGERY



Banksia integrifolia



Tristaniopsis laurina 'Luscious'



Banksia serrata



Melaleuca linariifolia



Astroloma pinifolium



Hibbertia fasciculata



Kunzea ambigua



Melaleuca squamea



Pimelea linifolia



Xanthorrhoea resinosa



Actinotus helianthi



Dianella revoluta



Dichelachne crinita



Eremophila 'Blue Horizon'



Lomandra longifolia 'Tanika'



Myoporum parvifolium 'Yareena'



Actinotus minor



Pratia pedunculata



Lomandra longifolia



Westringia 'Low Horizon'