

GFA Area Plans  
Tower B (Indicative Scheme)

Key	
<div></div>	Non GFA
<div></div>	Retail
<div></div>	Hotel
<div></div>	Design Excellence Bonus GFA

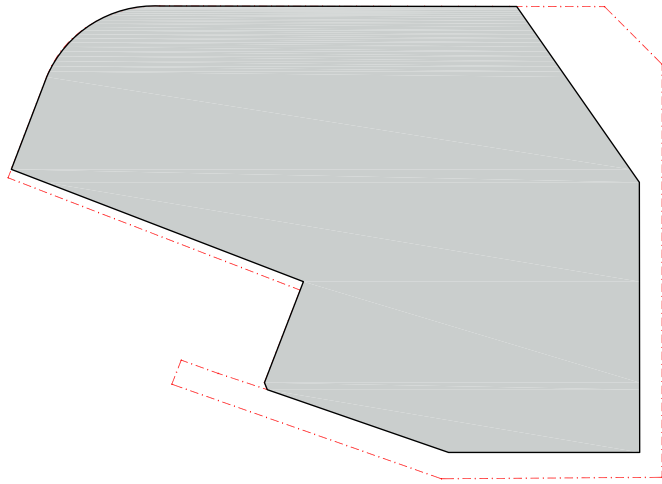

B6 - CAR PARK

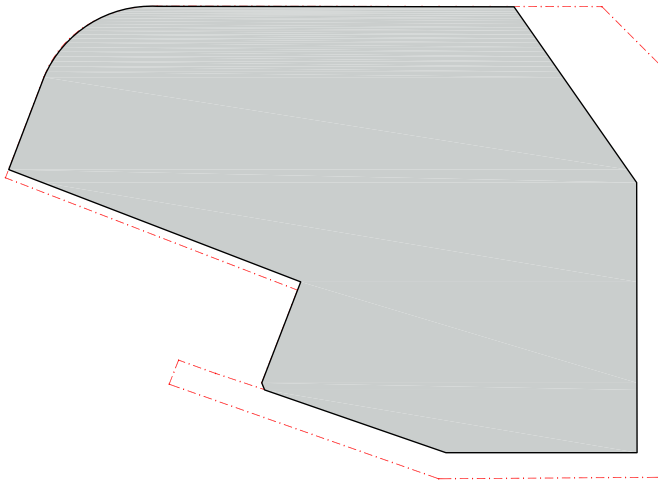

B5 - CAR PARK

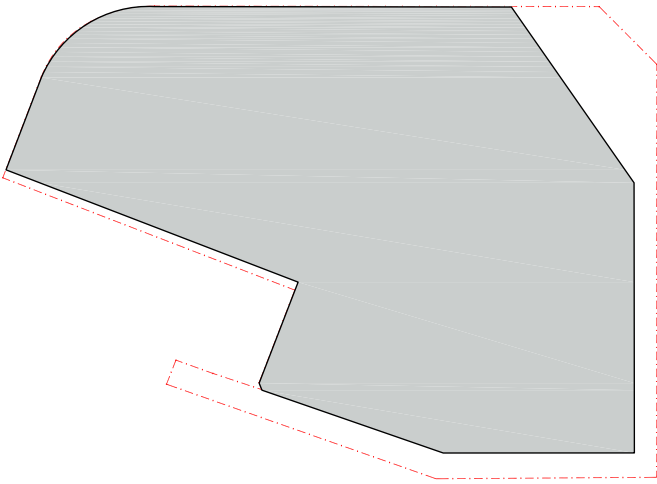

B4 - CAR PARK

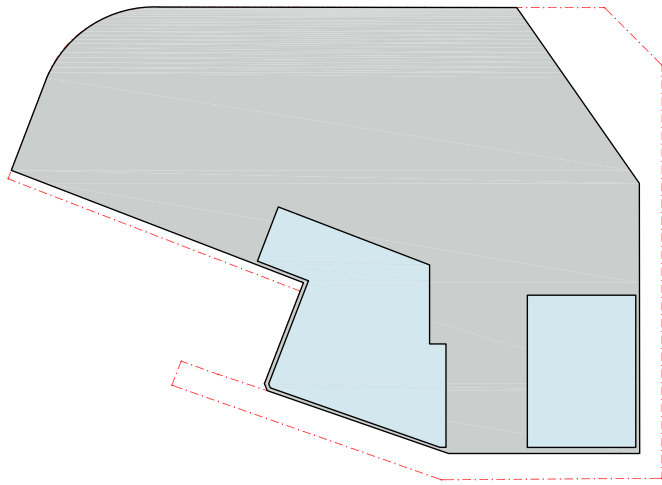

B3 - CARPARK + HOTEL BACK OF HOUSE

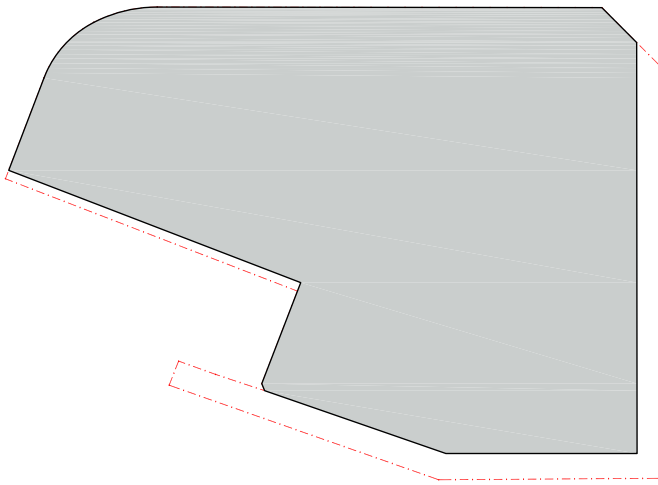

B2 - CAR PARK

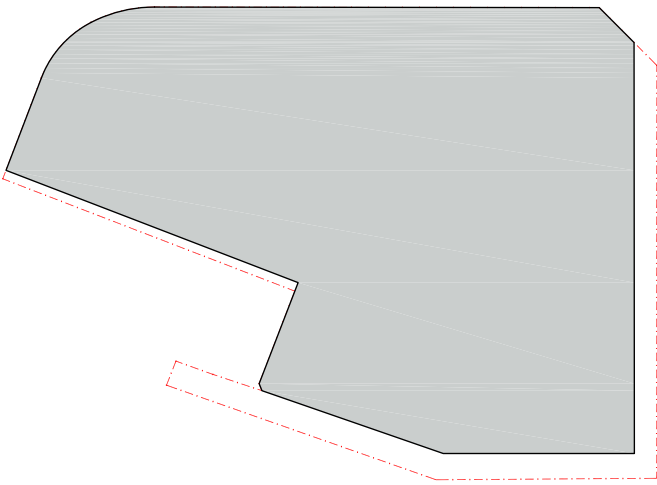

B1 - CAR PARK

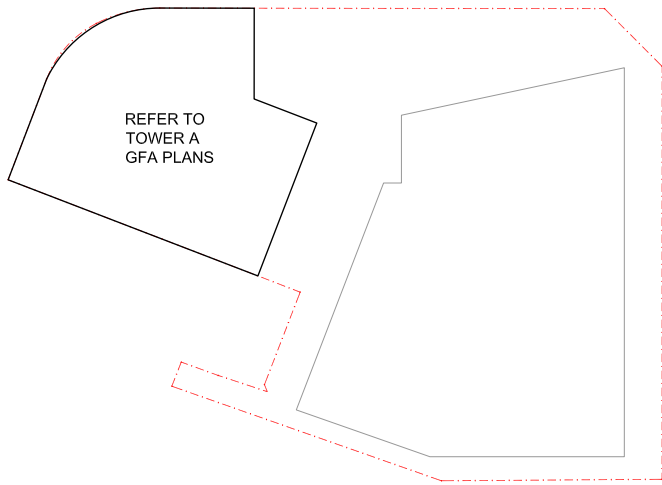

LG - RETAIL + BACK OF HOUSE

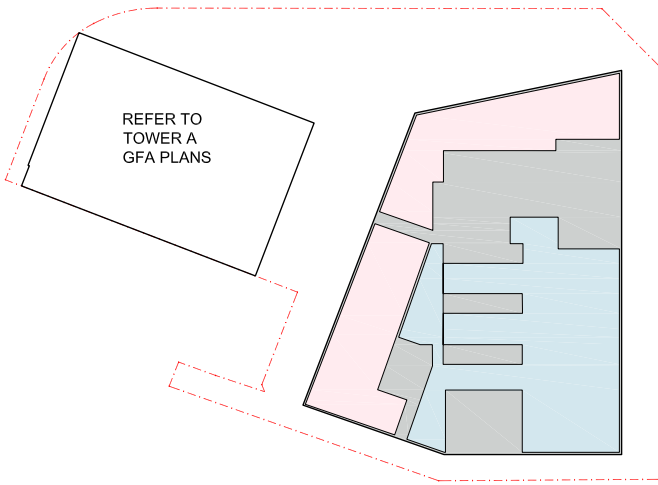

G - RETAIL + HOTEL LOBBY

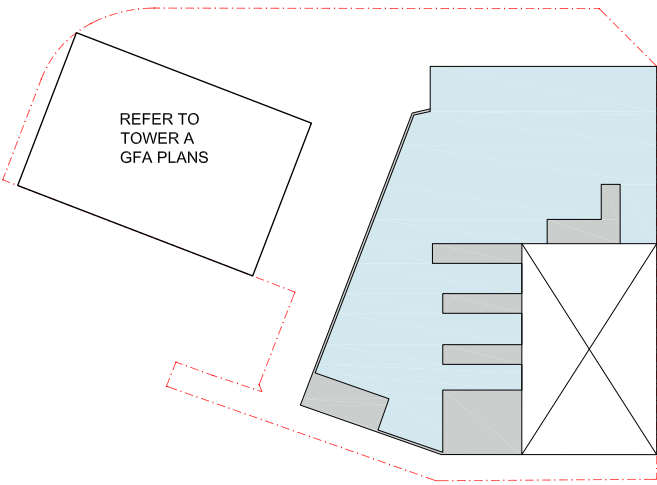

L1 - POOL + FITNESS CAFE

GFA Area Plans  
Tower B (Indicative Scheme)

Key	
<div></div>	Non GFA
<div></div>	Retail
<div></div>	Hotel
<div></div>	Design Excellence Bonus GFA

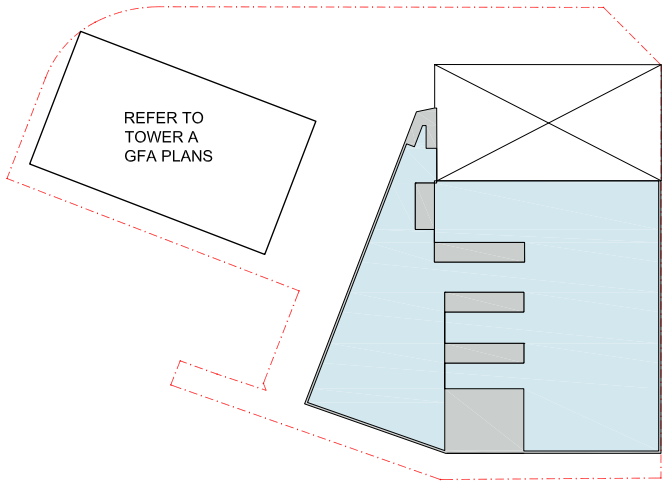

L2 - SPA + GYM

L2M - NO LONGER IN USE

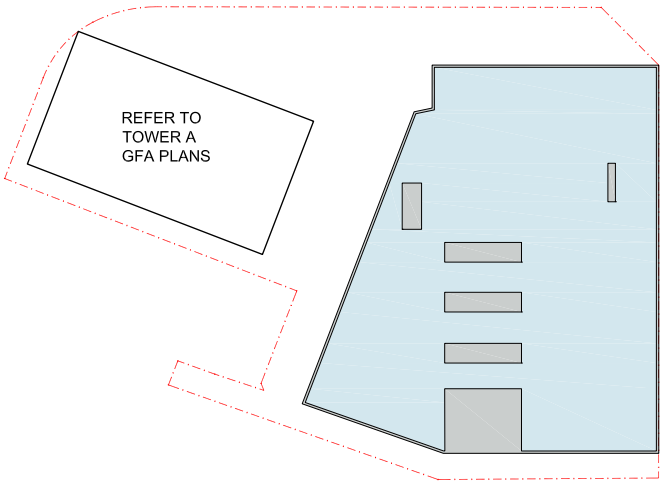

L3 - GRAND BALLROOM

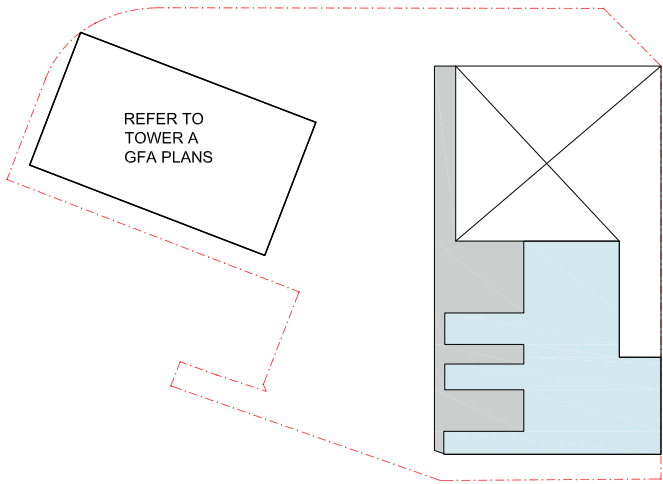

L3FM - OFFICE

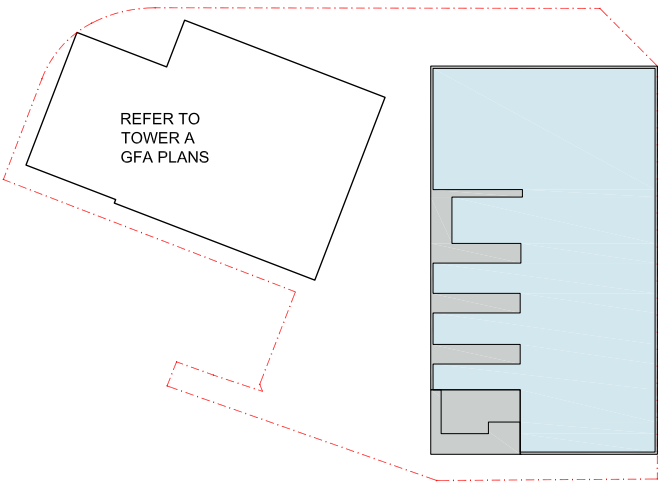

L4 - ALL DAY DINING

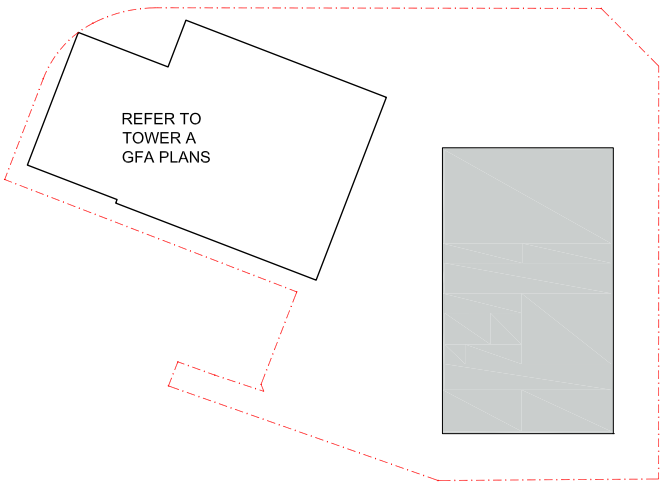

L5 - PLANT

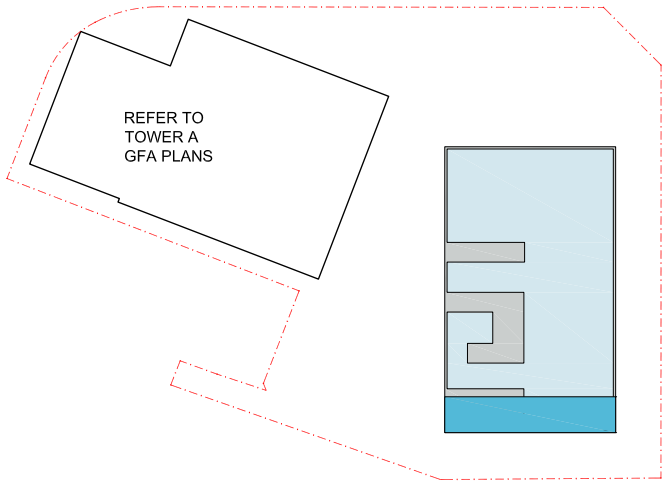

L6 - 15 - HOTEL ROOMS

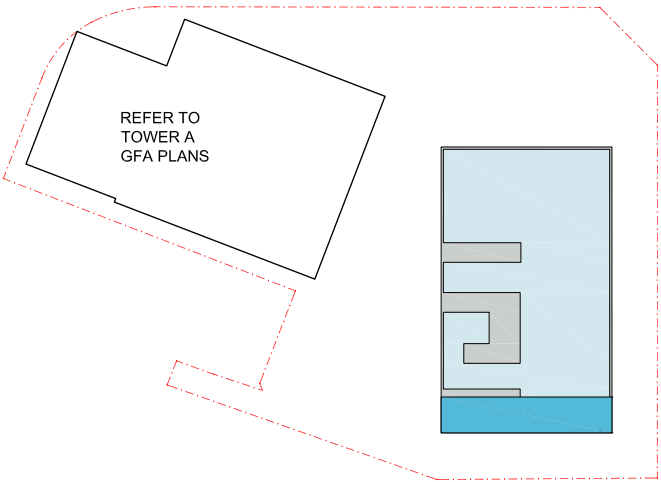

L16 - 21 - HOTEL ROOMS

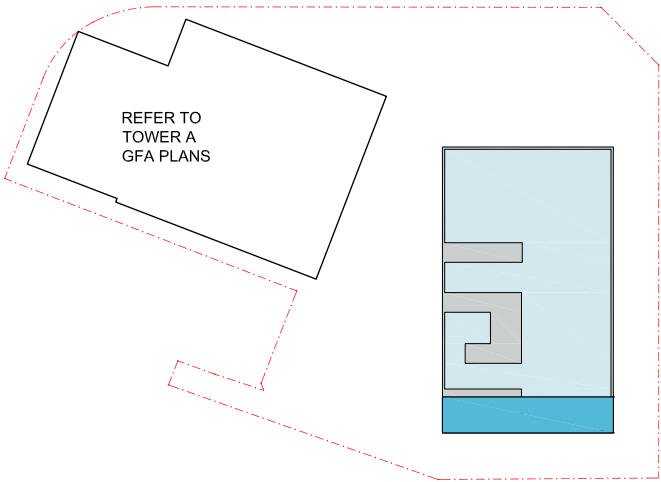

L22 - HOTEL ROOMS

GFA Area Plans  
Tower B (Indicative Scheme)

Key

Non GFA	
Retail	
Hotel	
Design Excellence Bonus GFA	

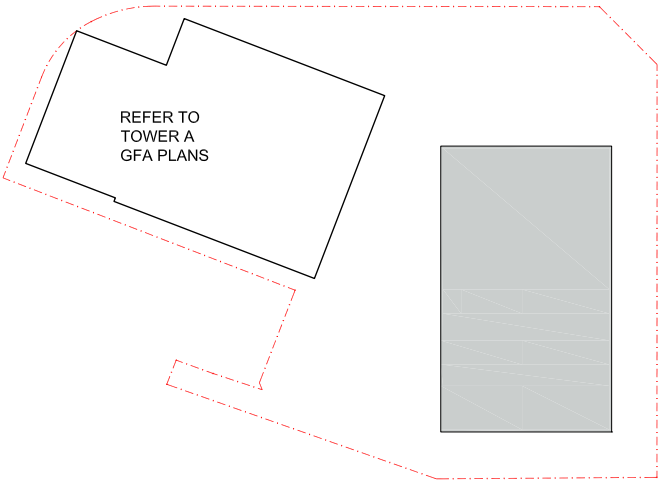
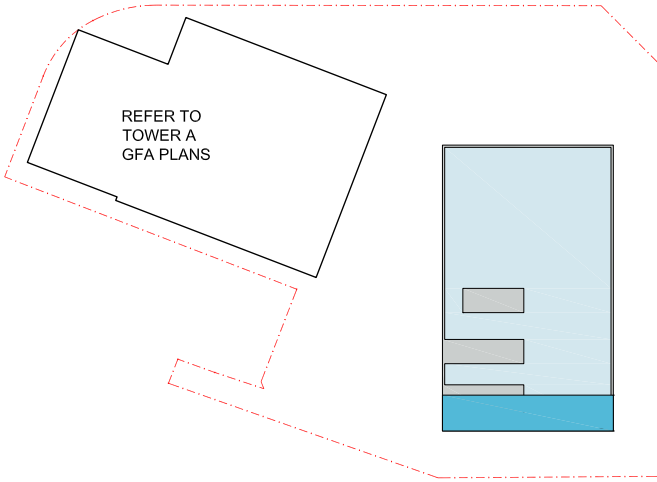
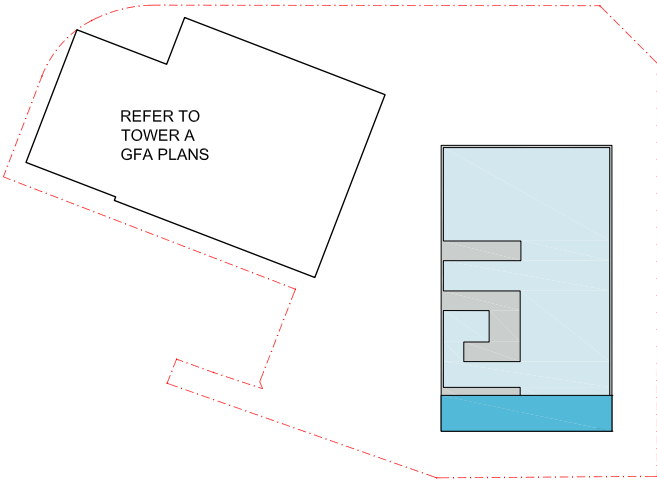
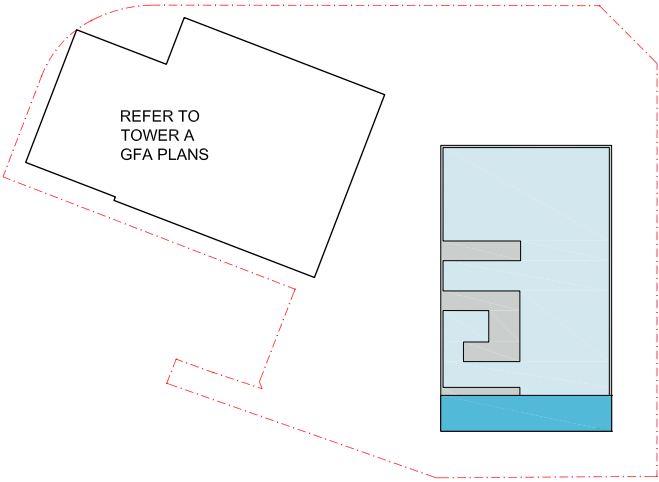

# GFA Area Schedule

## Tower B (Indicative Scheme)

### Area Schedule based on Indicative Scheme

#### 1. GFA (Gross Floor Area) measured according to SLEP 2012:

Gross Floor Area means the sum of the floor area of each floor of a building measured from the internal face of external walls, or from the internal face of walls separating the building from any other building, measured at a height of 1.4 metres above the floor, and includes:

- (a) the area of a mezzanine, and
- (b) habitable rooms in a basement or an attic, and
- (c) any shop, auditorium, cinema, and the like, in a basement or attic, but excludes:
- (d) any area for common vertical circulation, such as lifts and stairs, and
- (e) any basement:
- (i) storage, and
- (ii) vehicular access, loading areas, garbage and services, and
- (f) plant rooms, lift towers and other areas used exclusively for mechanical services or ducting, and
- (g) car parking to meet any requirements of the consent authority (including access to that car parking), and
- (h) any space used for the loading or unloading of goods (including access to it), and
- (i) terraces and balconies with outer walls less than 1.4 metres high, and
- (j) voids above a floor at the level of a storey or storey above.

#### 2. The Indicative Scheme Area Schedule include the Design Excellence 10% additional floor space. Refer to GFA Area Plans - Tower B (Indcative Scheme) for details.

Levels	Use	Hotel	Retail
		GFA	GFA
Roof			
26 F	Plant	0m²	
25 F	Bar & Club	710m²	
24 F	Speciality Restaurant	717m²	
23 F	Hotel - Presidential Suite	673m²	
22 F	Hotel -Premier Suite	673m²	
21 F	Hotel - Suite	673m²	
20 F	Hotel - Suite	673m²	
19 F	Hotel - Suite	673m²	
18 F	Hotel - Suite	673m²	
17 F	Hotel - Suite	673m²	
16 F	Hotel - Standard	673m²	
15 F	Hotel - Standard	673m²	
14 F	Hotel - Standard	673m²	
13 F	Hotel - Standard	673m²	
12 F	Hotel - Standard	673m²	
11 F	Hotel - Standard	673m²	
10 F	Hotel - Standard	673m²	
9 F	Hotel - Standard	673m²	
8 F	Hotel - Standard	673m²	
7 F	Hotel - Standard	673m²	
6 F	Hotel - Standard	673m²	
5 F	Hotel Office / Plant	0m²	
TOWER		13,533m²	
4 F	All Day Dinning	1,270m²	
3FM	Hotel Office / Plant	500m²	
3F	Ballroom / Meeting	1,724m²	
2F	Gym / Spa / Connection	1,375m²	
1F	Pool / Speciality Restaurant	1,173m²	0m²
GF Mezz	Pool Plant		
GROUND FLOOR	Hotel Lobby / Retail	573m²	475m²
PODIUM		6,615m²	475m²
B1	Loading / Garbage Areas / Staff		
B2	Carpark Hotel & VIP Garage / Residents Drop Off	786m²	
B3	Carpark Hotel / BOH Staff		
B4	Carpark Residential		
B5	Carpark Residential		
B6	Carpark Residential / MEP		
BASEMENT		786m²	
TOTAL		20,934m²	475m²
		HOTEL GFA	RETAIL GFA
TOTAL BUILDING B	INCLUDES: HOTEL, RETAIL	21,409m²	

Key

Non GFA

Retail

Hotel