

3.6 Car Park Levels

Planning Principles

The basement levels have been arranged to be accommodated efficiently within the building's structural grid providing the optimum layout for car parking, plant and other spaces required in the basement levels.

A simple one way system is organised around the central columns with car parking flanking the routed to both sides allowing the highest amount of car spaces to be accommodated.

Areas to the far northern side of the basement accommodate the end of trip facilities, plant rooms, storage rooms and waste rooms offering a clear and efficient organisation of spaces. The bike storage cage is easily accessible in the centre of the carpark.

In total the basements offer 96 Car Parks according to the University of Sydney requirements. The basements also contain 21 Motorbike Parking and 76 secure Bicycle Parking..

The End of Trip facilities aligns to the University's standards and for males consists of:

- 4 showers,
- 1 WC ,
- 2 urinals,
- 2 basins

The facility for females consist's of:

- 3 showers,
- 2 WC's,
- 2 basins

An additional private EOT room and Disabled shower room has also been provided. Each consist of 1 WC, 1 shower and 1 basin.

Basement Level 1

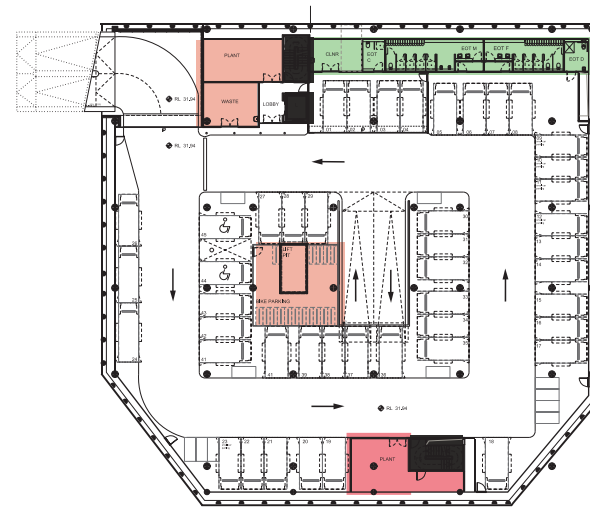

Basement Level 2

