

FOR CONTINUATION OF FLOOR PLAN REFER TO PREVIOUS DRAWING

CONCRETE BEAM MEMBER SCHEDULE	
MARK	SIZE (W x D)
B1	240w x 420d
B2	450w x 420d
B3	195w x 420d
B4	90w x 420d
B5	60w x 255d
B11	855w x 420d
B12	600w x 420d
B13	600w x 255d

COLUMN SCHEDULE			
MARK	DESCRIPTION	SIZE (W x D)	F _c (MPa)
C1	TD COLUMN	400 x 400	50
C2	TD COLUMN	400 x 600	50
C3	ED COLUMN	100 DIA.	50

NOTES:
 STAIR WALLS TO BE 90 THICK REINFORCED CONCRETE LIND.
 LIFT WALLS TO BE 90 THICK REINFORCED CONCRETE LIND.
 ALL RC WALLS TO BE 90 THICK LIND.
 75 MINIMUM TOPPING SLAB WHERE ARCHITECT SHOWS OVER LEVEL 1 SLAB. SLAB FISH FALLS TO ARCH SAWN JOINTS AT MAX 5m CTS.
 SECTION LOCATIONS IN TOPPING SLAB REFER TO ARCHITECTS DRAWINGS.

DENOTES AREA OF BEAM ZONE REINFORCEMENT FREE

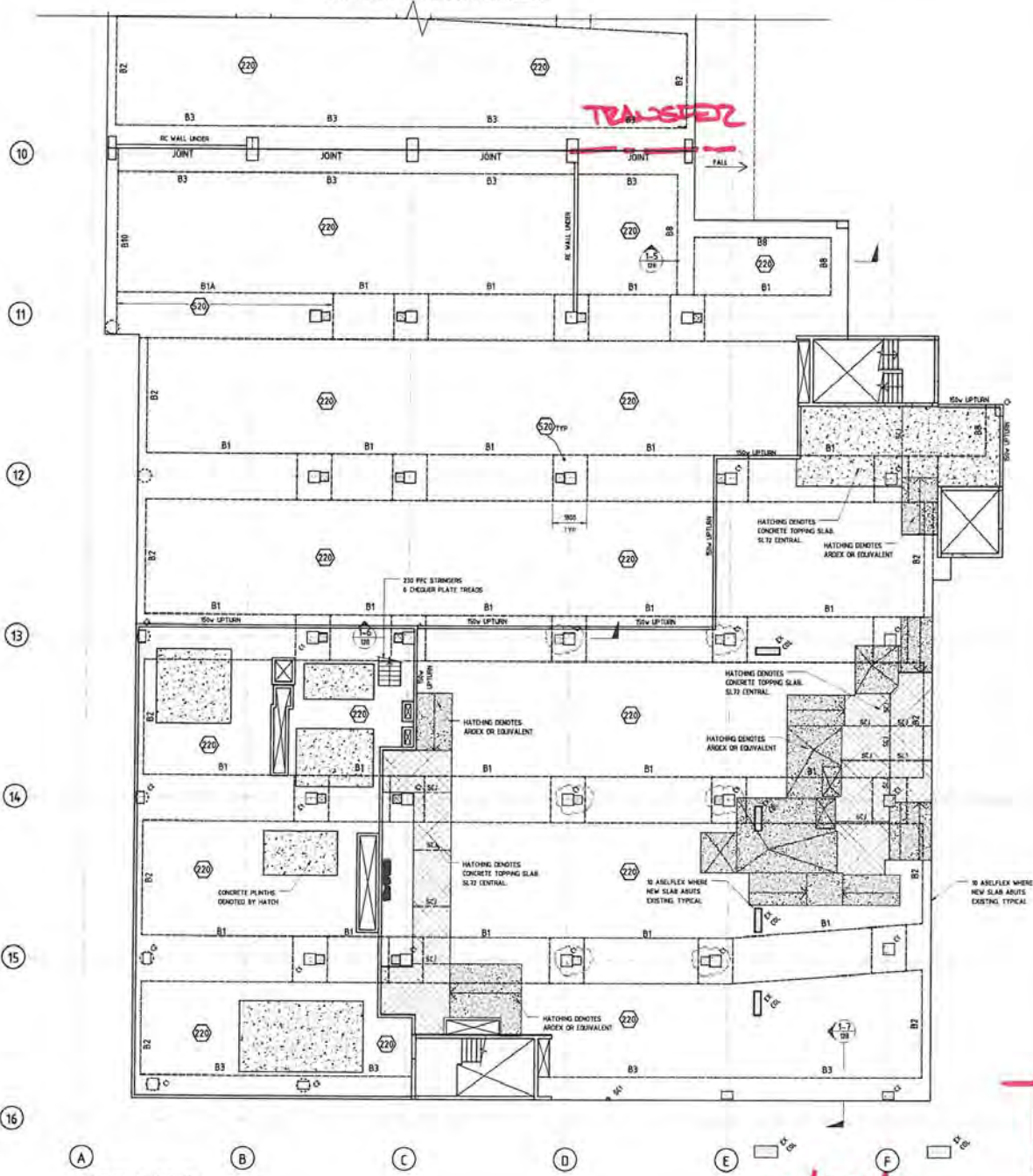
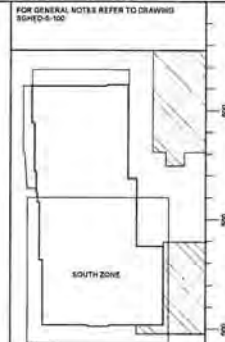

LEVEL 1 - SOUTH
 SCALE: 1:100

13/08/14

**WE CORNER FLZ CONTROLLED
 PERIM TRANSFER REQUIREMENTS**

<p>1.1 HMF FREE ZONE ACCESS</p> <p>1.2 CONSTRUCTION ISSUE</p> <p>1.3 CO-ORDINATION ISSUE</p> <p>1.4 FOR INFORMATION</p> <p>1.5 REINFORCEMENT FREE ZONE AMEND</p> <p>1.6 CONSTRUCTION ISSUE</p>	<p>DATE</p> <p>BY</p>
<p>QA</p> <p>ST GEORGE HOSPITAL EMERGENCY DEPARTMENT</p>	<p>DATE</p> <p>BY</p>
<p>NSW Health Infrastructure</p>	<p>DATE</p> <p>BY</p>
<p>PROJECTS INTERNATIONAL</p>	<p>DATE</p> <p>BY</p>

APPENDIX G

North East Corner Option 2 Planning Arrangement
Structural Framing Systems

GROUND FLOOR
SCALE: 1.500

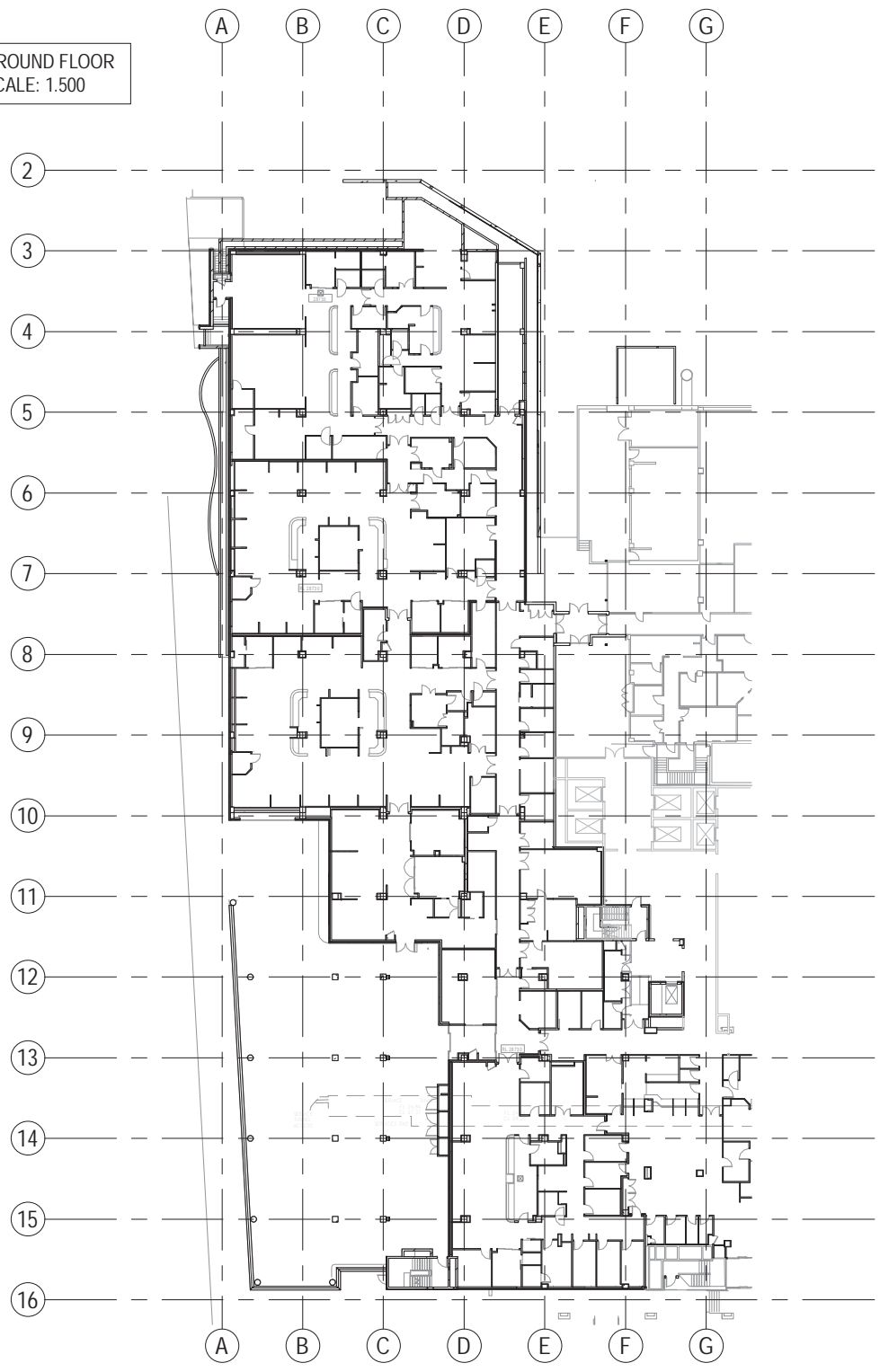

LEVEL 1
SCALE: 1.500

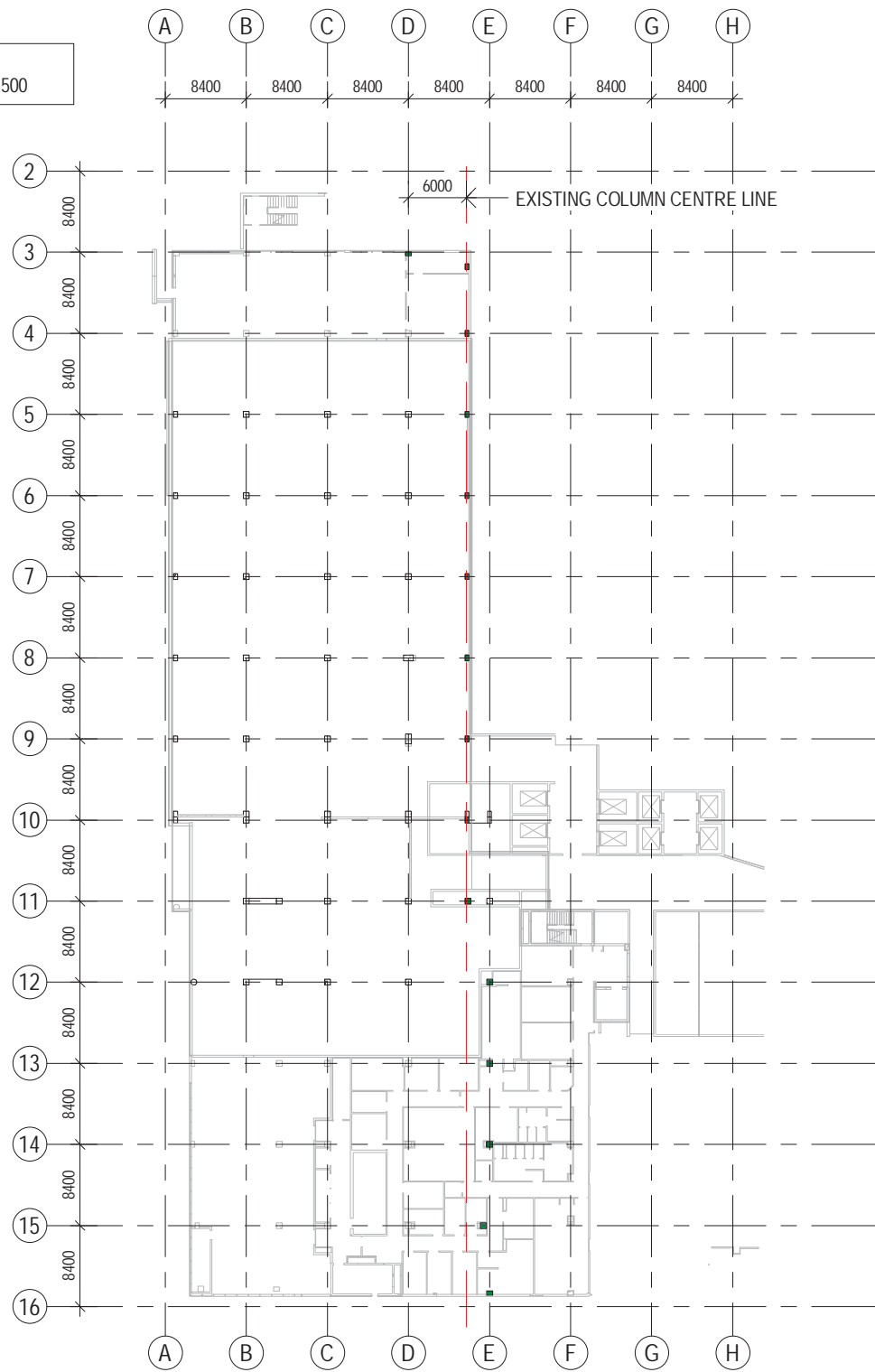

LEVEL 2
SCALE: 1.500

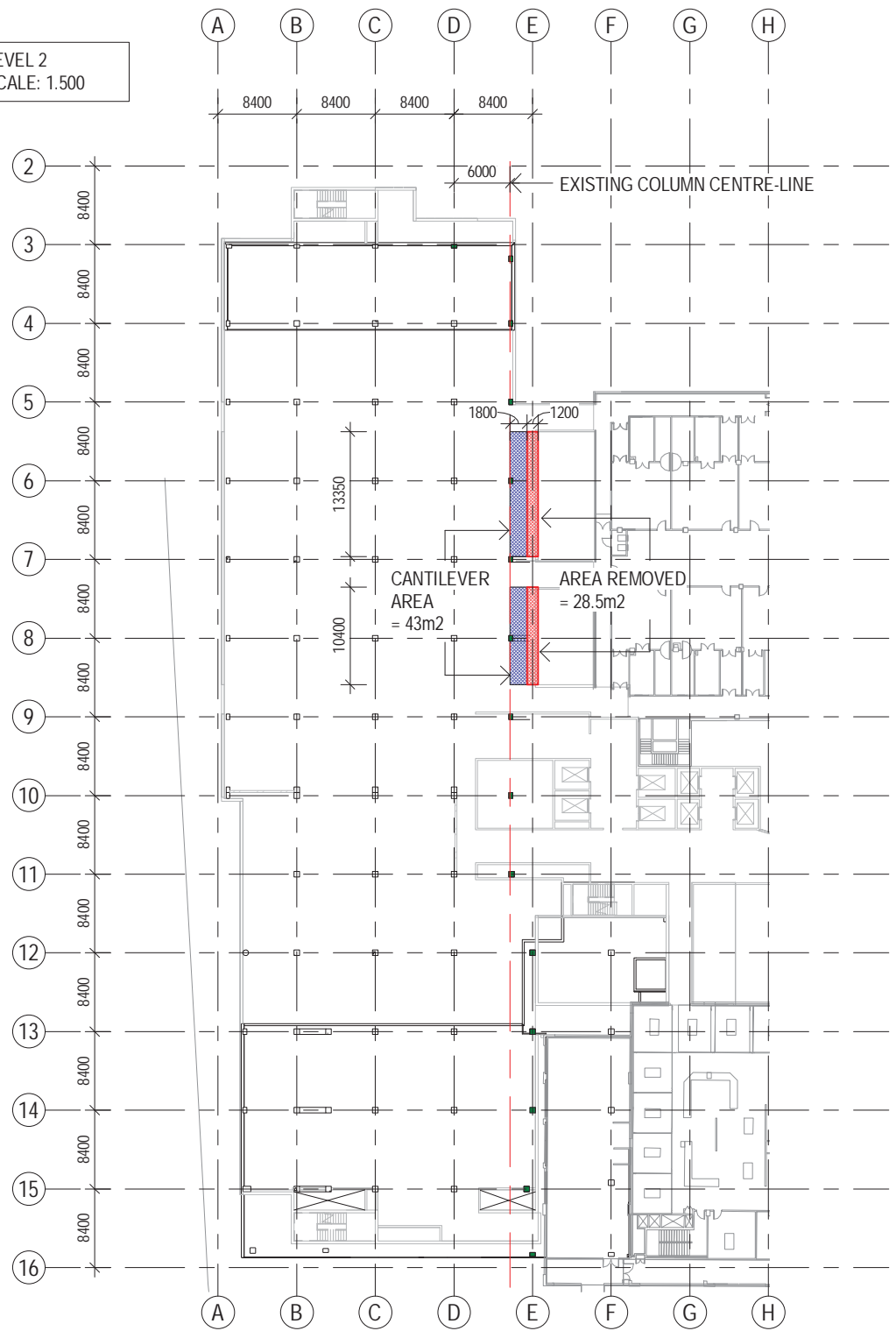

LEVEL 3
SCALE: 1.500

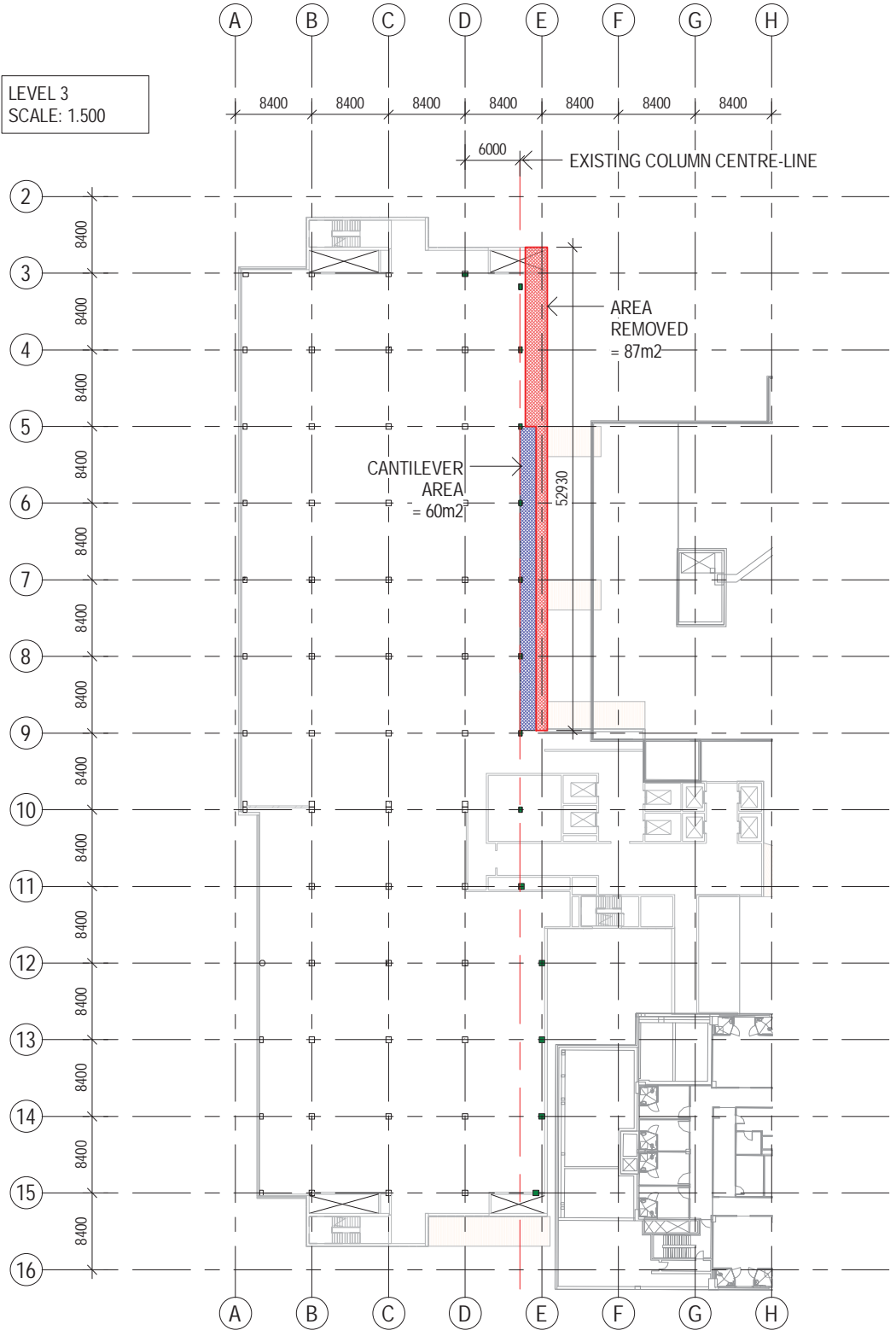

LEVEL 4
SCALE: 1.500

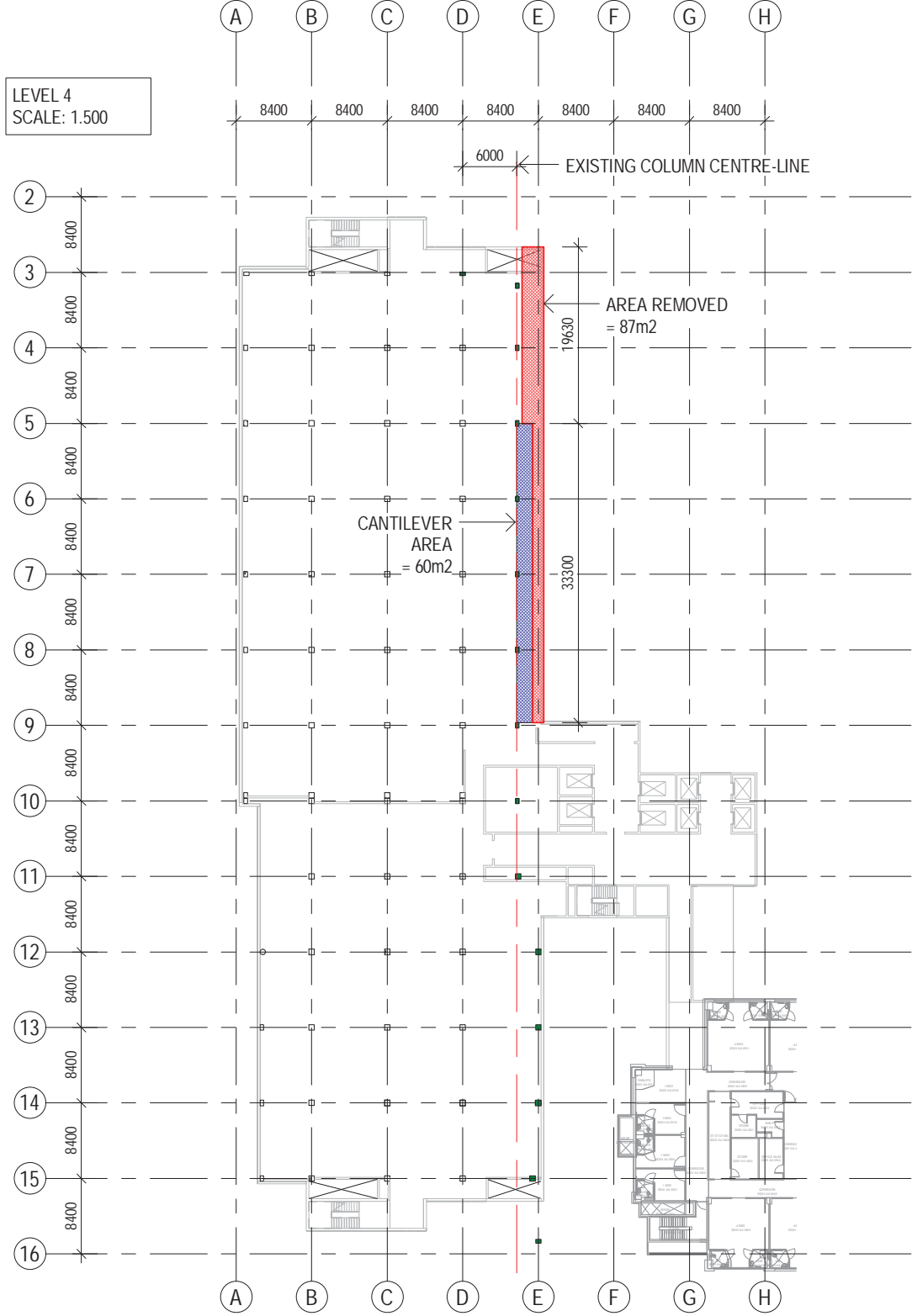

LEVEL 5
SCALE: 1:500

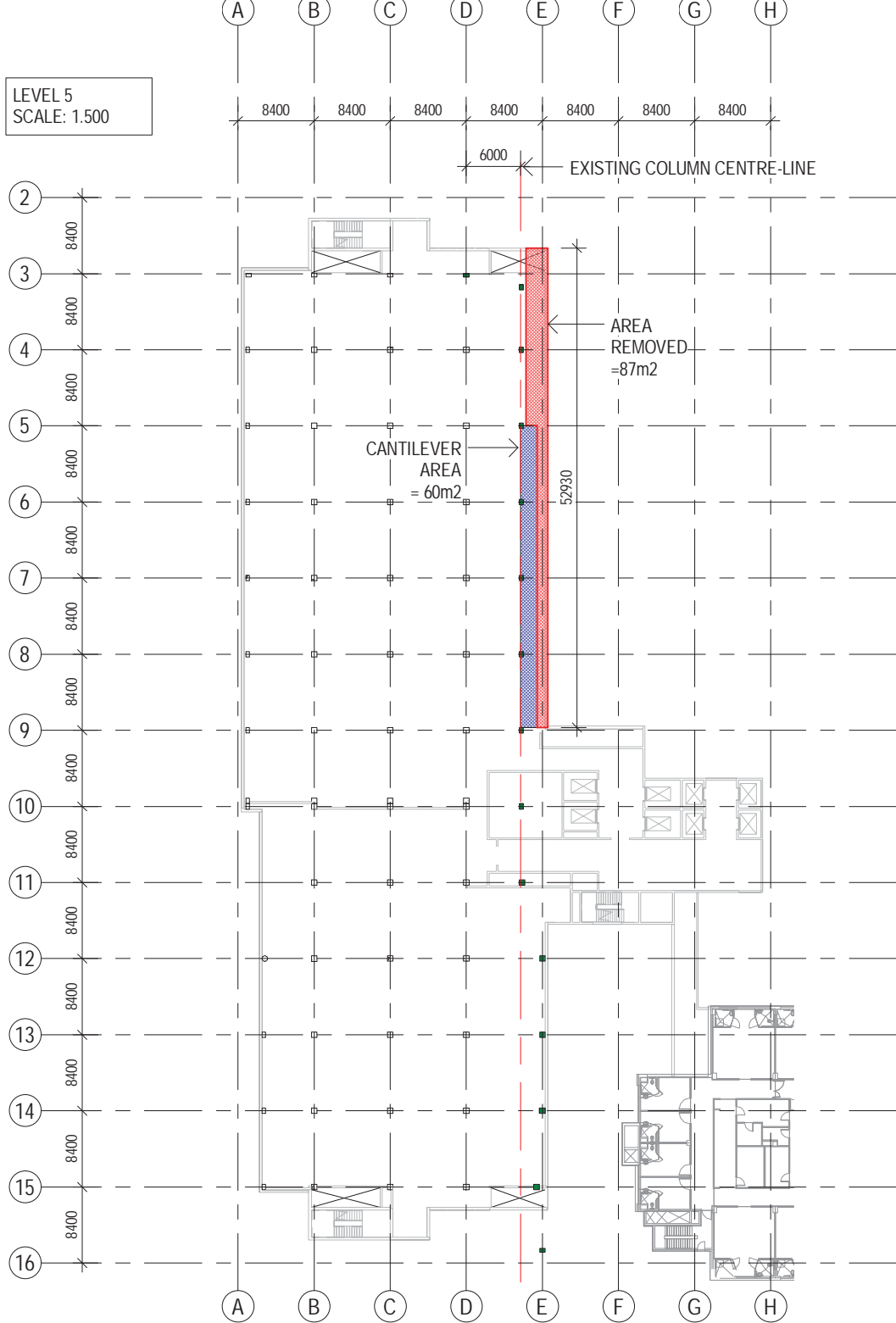

LEVEL 6
SCALE: 1.500

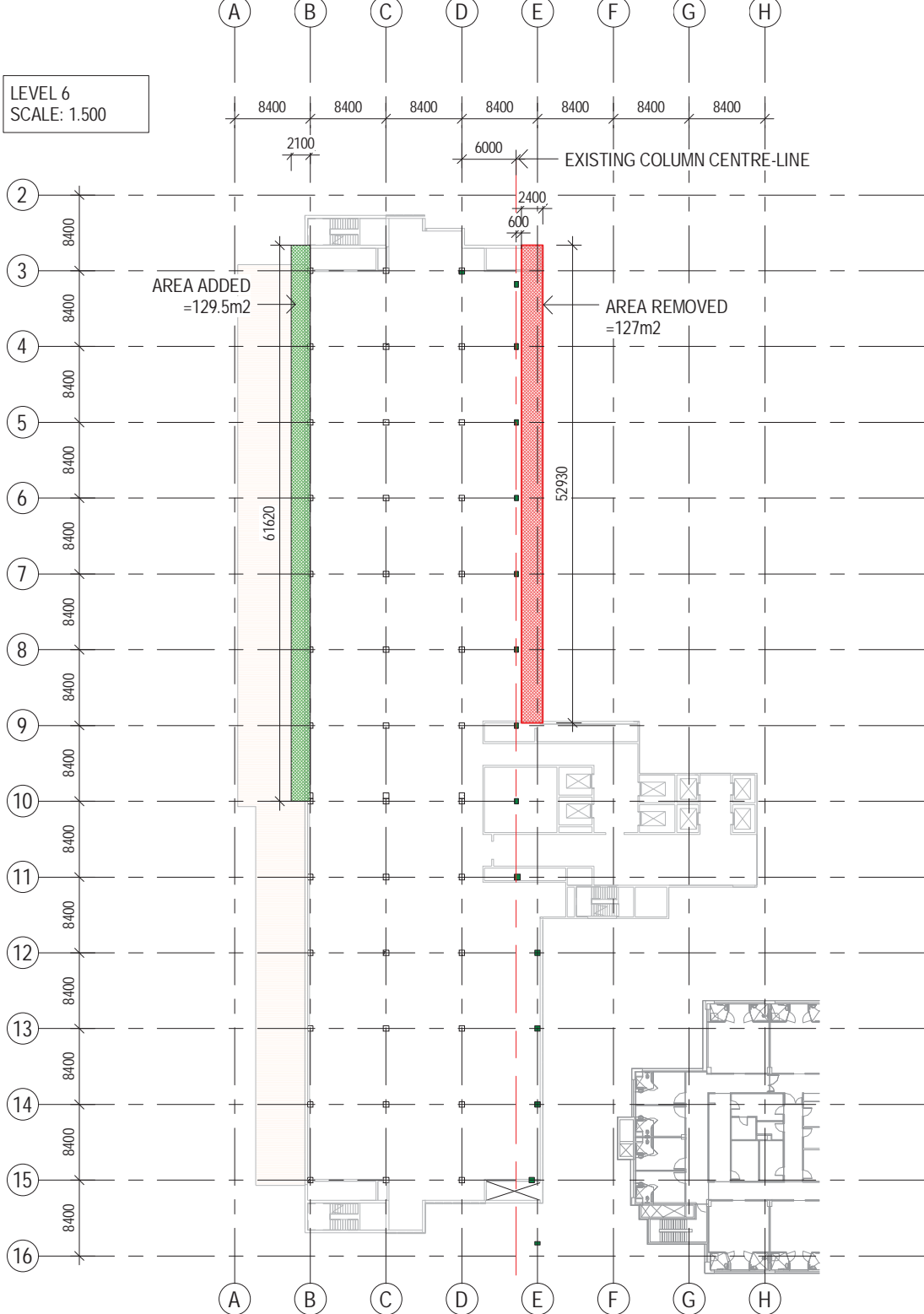

LEVEL 7
SCALE: 1.500

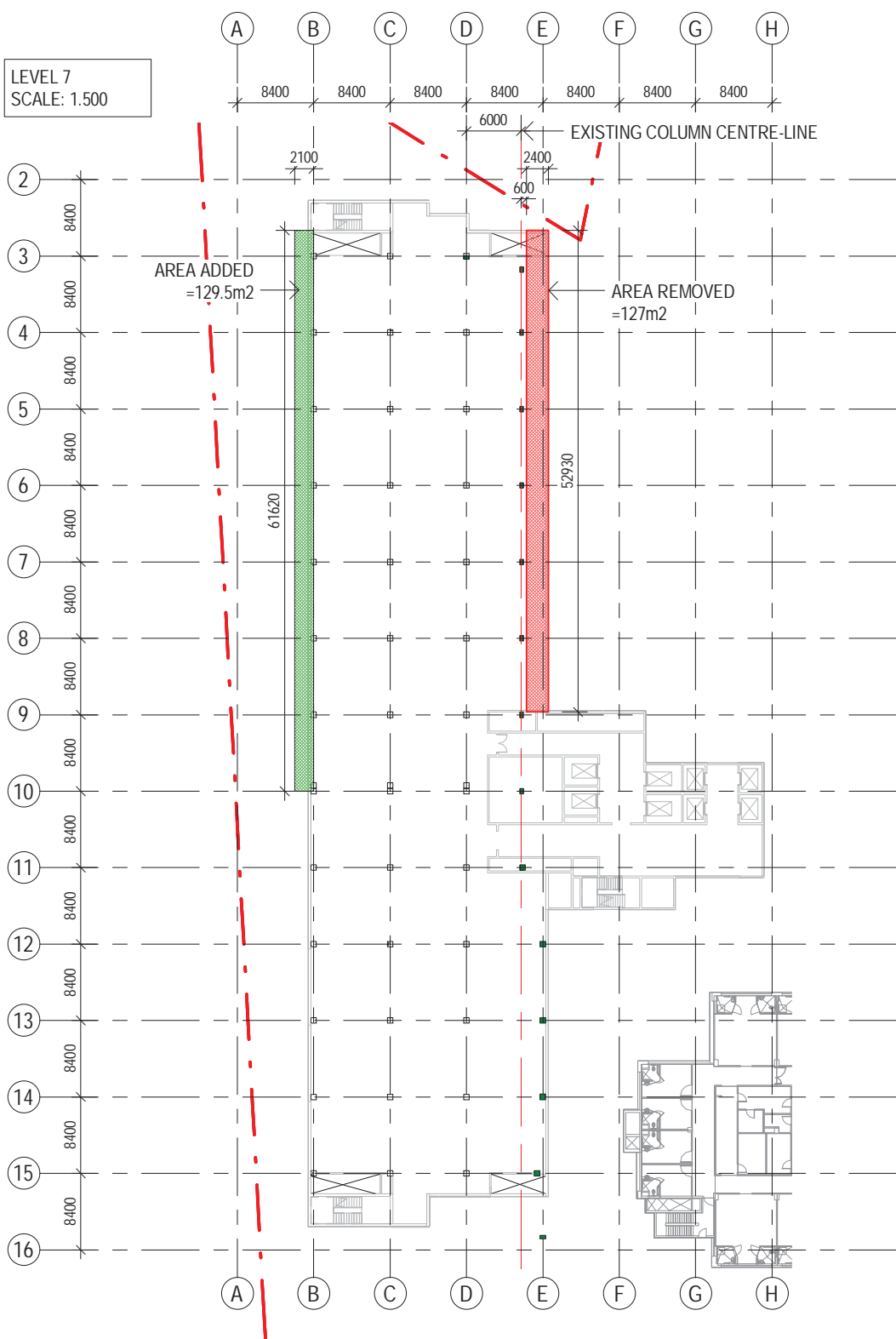

APPENDIX H

Zone Above the Ambulance Bay Structural Transfer Systems

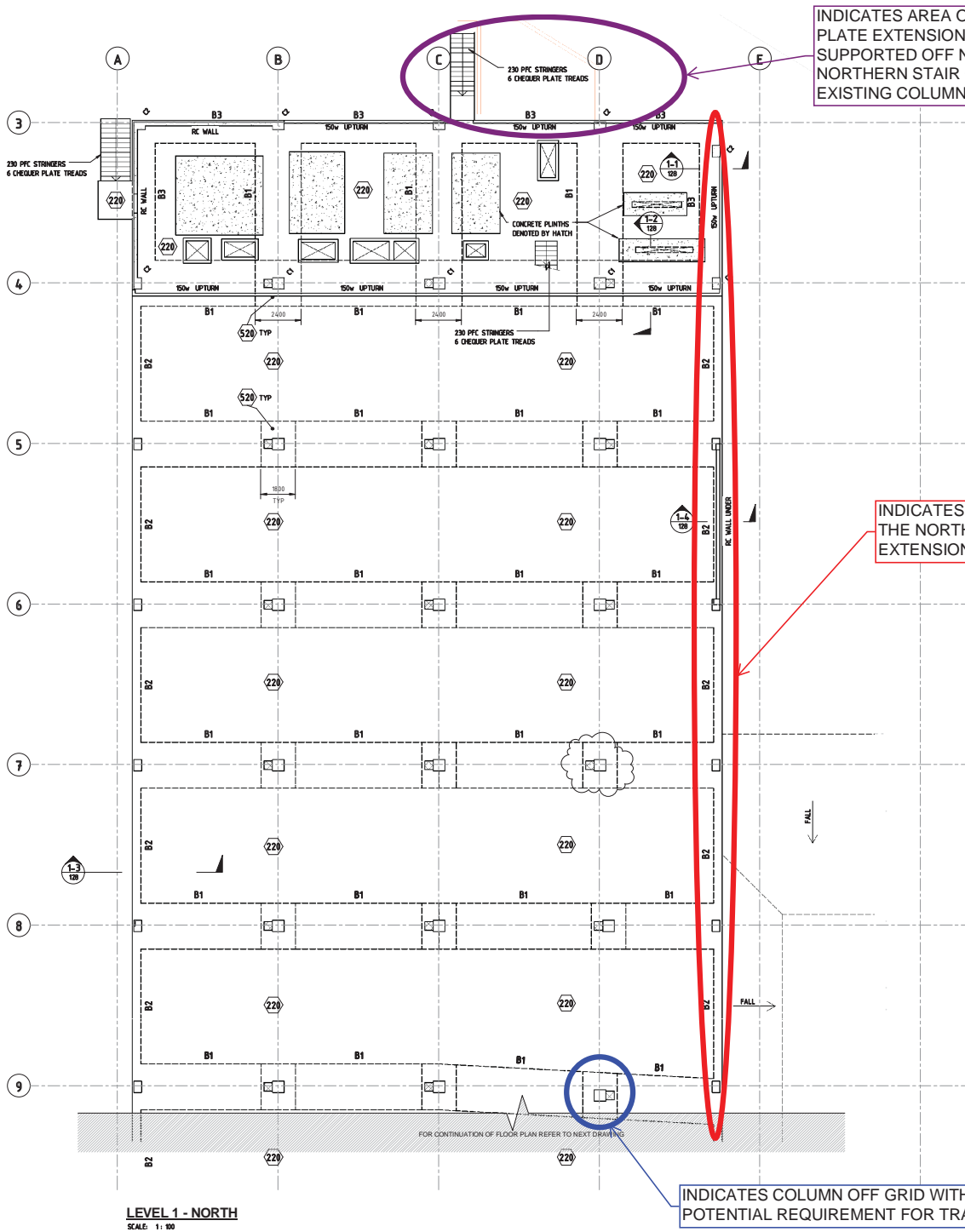

INDICATES AREA OF FLOOR
 PLATE EXTENSION TO BE
 SUPPORTED OFF NEW
 NORTHERN STAIR CORE AND
 EXISTING COLUMNS

INDICATES COLUMNS OFF GRID ALONG
 THE NORTH EAST EDGE WITH
 EXTENSION OF FLOOR PLATE REQUIRED

INDICATES COLUMN OFF GRID WITH
 POTENTIAL REQUIREMENT FOR TRANSFER

COLUMN SCHEDULE			
MARK	DESCRIPTION	SIZE (W x D)	F _c (MPa)
C1	ED COLUMN	600 x 600	50
C2	ED COLUMN	400 x 600	50
C3	ED COLUMN	700 DIA.	50

CONCRETE BEAM MEMBER SCHEDULE	
MARK	SIZE (W x D)
B1	2400v x 420d
B2	420v x 420d
B3	3000v x 420d
B6	900v x 420d
B10	600v x 720d
B11	1050v x 420d
B12	900v x 420d
B13	1500v x 520d

NOTES:
 ALL STAIR WALLS TO BE 90 THICK REINFORCED CONCRETE UNO.
 ALL LEFT WALLS TO BE 100 THICK REINFORCED CONCRETE UNO.
 ALL RC WALLS TO BE 90 THICK UNO.
 150 WIDE UPTURN HEIGHTS TO ARCHITECTS SPECIFICATION
 15 MINIMUM TOPPING SLAB WHERE ARCHITECT SHOWS OVER LEVEL 1 SLABS. 50mm MESH FALLS TO ARCH. SAWM JOINTS AT MAX 5m CTS.
 SETDOWN LOCATIONS IN-TOPPING SLAB REFER TO ARCHITECTS DRAWINGS

☒ DENOTES AREA OF BEAM ZONED REINFORCEMENT FREE

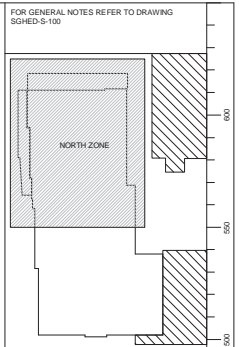

LEVEL 1 - NORTH
 SCALE: 1:100

USE FIGURED DIMENSIONS ONLY. DO NOT SCALE. ALL DIMENSIONS SHALL BE VERIFIED ON SITE AND DISCREPANCIES IMMEDIATELY BROUGHT TO THE ATTENTION OF THE PROJECT MANAGER FOR RESOLUTION.

↑ DIMENSIONS ARE INTENDED AS GUIDES AND NOT NECESSARILY DESCRIBE THE FULL EXTENT OF REVISIONS. ASCERTAIN FULL EXTENT BY COMPARISON WITH PREVIOUS VERSION.

FOR CONTINUATION OF FLOOR PLAN REFER TO NEXT DRAWING



DATE:	2012	Drawn:	C.S.B.	Checked:	T.A.	Date:	SEPT 2012	Scale:	1:100
PROJECT NAME: NORTH ZONE									
DRAWING TITLE: LEVEL 1 PLAN - NORTH ZONE									

REV	REVISION DESCRIPTION	DATE	BY
C3	CONSTRUCTION ISSUE	05/09	PP
C2	REINFORCEMENT FREE ZONES AMENDED	17/08	PP
C1	CONSTRUCTION ISSUE	09/11	PP

Project: ST GEORGE HOSPITAL EMERGENCY DEPARTMENT

Principal: NSW Health Infrastructure

TRUE NORTH

PROJECT NORTH

HPi HEALTH PROJECTS INTERNATIONAL
 Architects and Health Facility Planners
 Ground Floor, Suite 1, 49 Wines Street
 West Melbourne, VIC 3207, Australia

REVIT 2012 SGHED-S-120

C:\Users\hcfhe.lamson\Documents\SGHED-S\MAIN_MODEL_2012_07\main.rvt

FOR CONTINUATION OF FLOOR PLAN REFER TO PREVIOUS DRAWING

CONCRETE BEAM MEMBER SCHEDULE	
MARK	SIZE (W x D)
B1	240w x 420d
B2	450w x 420d
B3	100w x 420d
B8	900w x 420d
B10	600w x 720d
B11	300w x 420d
B12	300w x 420d
B13	150w x 520d

COLUMN SCHEDULE			
MARK	DESCRIPTION	SIZE (W x D)	F _{ck} (MPa)
C1	ED COLUMN	600 x 600	50
C2	ED COLUMN	400 x 600	50
C3	ED COLUMN	700 DIA.	50

NOTES:
 STAR WALLS TO BE 100 THICK REINFORCED CONCRETE UNO.
 LIFT WALLS TO BE 100 THICK REINFORCED CONCRETE UNO.
 ALL RC WALLS TO BE 100 THICK UNO.
 75 MINIMUM TOPPING SLAB WHERE ARCHITECT SHOWS OVER LEVEL 1 SLABS. SLAB MESH FALLS TO ARCH. SAWN JOINTS AT MAX 5m CTS. SETDOWN LOCATIONS IN TOPPING SLAB REFER TO ARCHITECT'S DRAWINGS.

☒ DENOTES AREA OF BEAM ZONED REINFORCEMENT FREE

INDICATES COLUMNS OFF GRID ALONG THE NORTH EAST EDGE WITH EXTENSION OF FLOOR PLATE REQUIRED

INDICATES COLUMN OFF GRID WITH POTENTIAL REQUIREMENT FOR TRANSFER

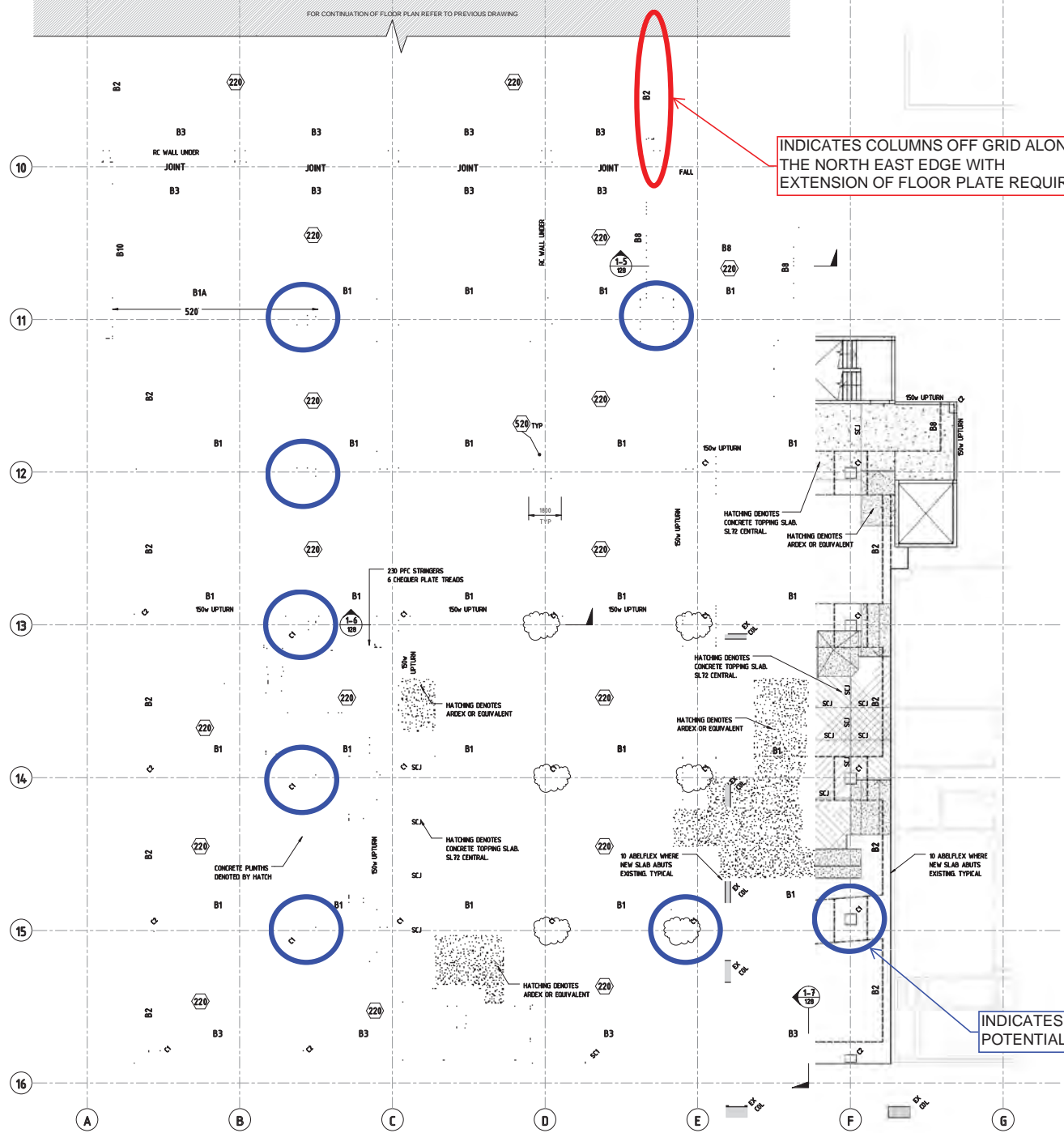
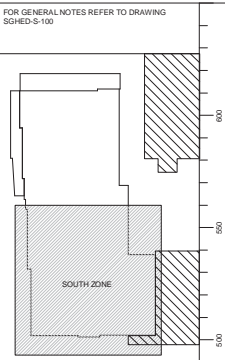

LEVEL 1 - SOUTH
 SCALE: 1:100

USE FIGURED DIMENSIONS ONLY. DO NOT SCALE. ALL DIMENSIONS SHALL BE VERIFIED ON SITE AND DISCREPANCIES IMMEDIATELY BROUGHT TO THE ATTENTION OF THE PROJECT MANAGER FOR RESOLUTION.

*CLOUDS & REVISIONS ARE INTENDED AS GUIDES AND NOT NECESSARILY DESCRIBE THE FULL EXTENT OF REVISIONS. ASCERTAIN FULL EXTENT BY COMPARISON WITH PREVIOUS VERSION.



Block Zone	SOUTH ZONE	Sheet	C6-B	Checked	YH	Date	08/11/2012	Drawn By	YH
Drawing Title	LEVEL 1 PLAN - SOUTH ZONE								

REV	REVISION DESCRIPTION	DATE	BY
C6	REIN. FREE ZONES ADDED	08/09/12	YH
C5	CONSTRUCTION ISSUE	05/09/12	YH
C4	COORDINATION ISSUE	22/08/12	YH
C3	FOR INFORMATION	15/08/12	YH
C2	REIN. ORCHMENT FREE ZONES AMENDED	17/05/12	YH
C1	CONSTRUCTION ISSUE	23/11/11	YH

Project: ST GEORGE HOSPITAL EMERGENCY DEPARTMENT

Principal: NSW Health Infrastructure

PROJECT NORTH

Health Projects International Architects and Health Facility Planners

Revit 2012 SGHED-S-121

C:\Users\hills\appdata\Documents\SGHED-S-MIN_MODEL_2012_rhrs_saratom.rvt 9/10/2013 10:02:21 AM

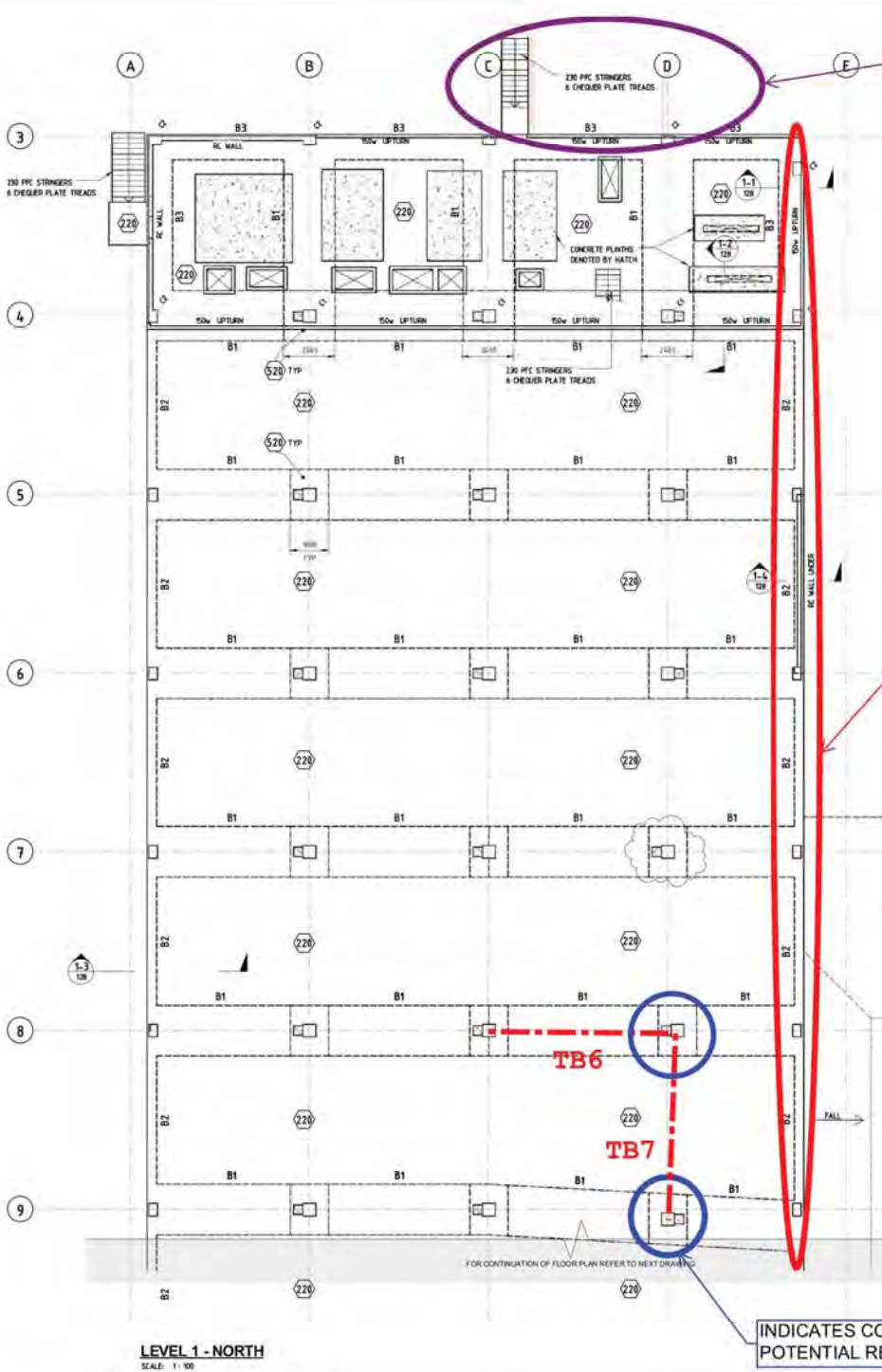

INDICATES AREA OF FLOOR PLATE EXTENSION TO BE SUPPORTED OFF NEW NORTHERN STAIR CORE AND EXISTING COLUMNS

MARK	DESCRIPTION	SIZE (W x D)	F _c (MPa)
C1	ED COLUMN	600 x 600	50
C2	ED COLUMN	400 x 400	50
C3	ED COLUMN	700 DIA.	50

MARK	SIZE (W x DI)
B1	2400w x 450d
B2	1500w x 450d
B3	1200w x 475d
B4	900w x 475d
B5	600w x 700d
B6	350w x 475d
B7	300w x 475d
B8	600w x 570d

NOTES:
 ALL STAIR WALLS TO BE 100 THICK REINFORCED CONCRETE UNLS.
 ALL LIFT WALLS TO BE 100 THICK REINFORCED CONCRETE UNLS.
 ALL RC WALLS TO BE 100 THICK UNLS.
 50 WIDE LIFTURN HEIGHTS TO ARCHITECT'S SPECIFICATION.
 IF IMPACT TOPPING SLAB WHERE ARCHITECT SHOWS OVER LEVEL 1 SLAB; SLAB FRESH FALLS TO ARCH. SAWN JOINTS AT MAX SW LTL. SETDOWN LOCATIONS IN TOPPING SLAB REFER TO ARCHITECT'S DRAWINGS.
 [Symbol] DENOTES AREA OF BEAM ZONED REINFORCEMENT FREE

INDICATES COLUMNS OFF GRID ALONG THE NORTH EAST EDGE WITH EXTENSION OF FLOOR PLATE REQUIRED

St George Transfer Beam Sizes

Beam #	Beam Depth	Beam Width	PT KGS	REO KGS	STEEL TRUSS KGS
TB1	0.95	2.4	1100	1000	3000
TB2	1.2	2.4	1350	1300	6600
TB3	0.7	2.1	750	600	2200
TB4	0.6	2.1	650	450	1500
TB5	0.9	2.4	1050	1100	3200
TB6	0.6	2.1	650	450	2200
TB7	0.65	2.1	600	500	2400

INDICATES COLUMN OFF GRID WITH POTENTIAL REQUIREMENT FOR TRANSFER

LEVEL 1 - NORTH
SCALE: 1:100

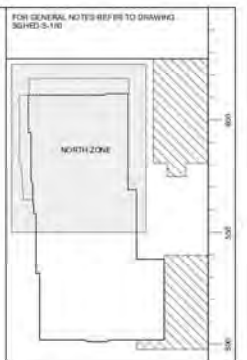

QA CHECKS

Issue	By	Check	Date

Project: ST GEORGE HOSPITAL EMERGENCY DEPARTMENT

Client: NSW Health Infrastructure

Project North

Revision: REVIT 2019 SGHED-S-120

FOR CONTINUATION OF FLOOR PLAN REFER TO PREVIOUS DRAWING

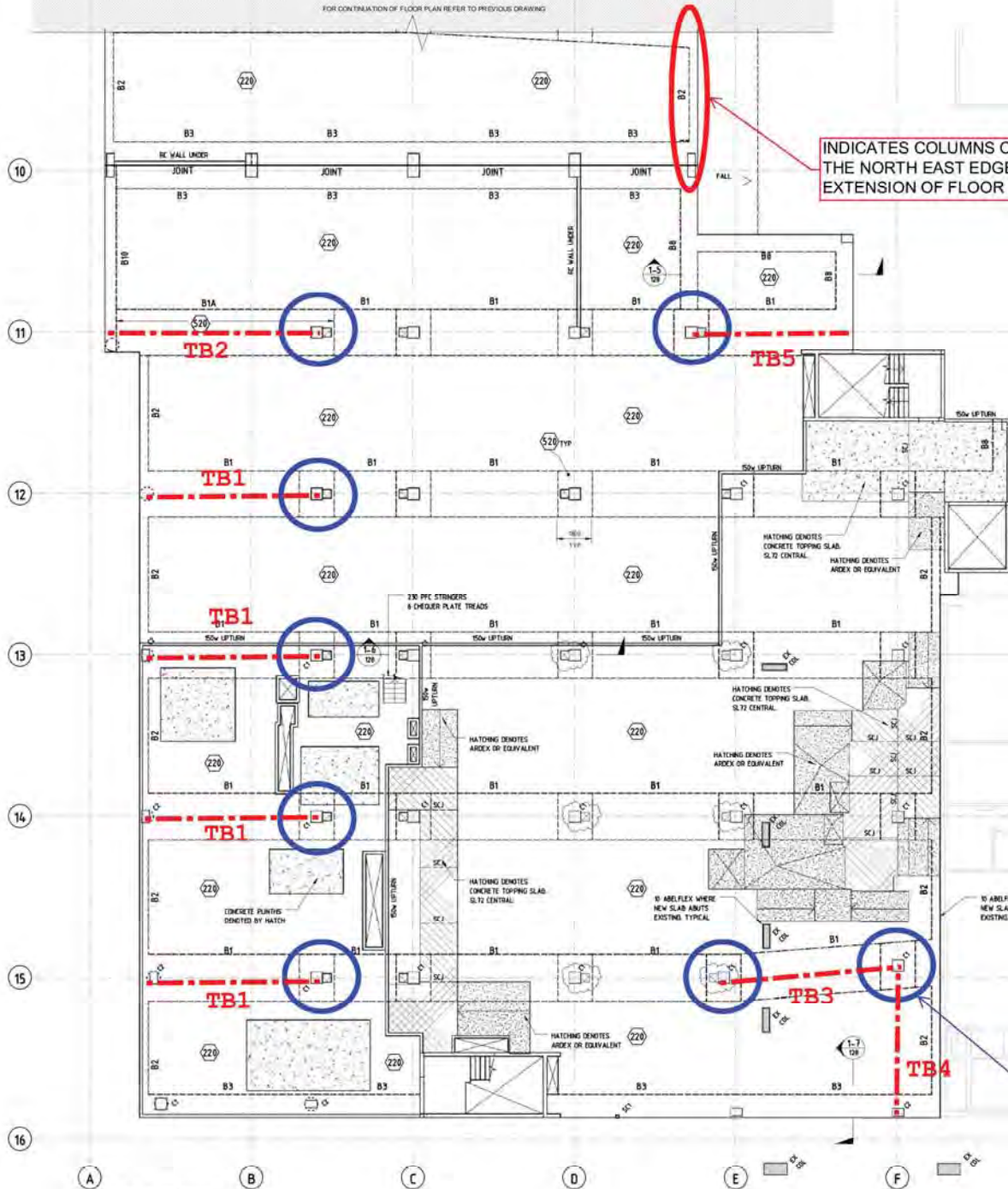

INDICATES COLUMNS OFF GRID ALONG THE NORTH EAST EDGE WITH EXTENSION OF FLOOR PLATE REQUIRED

MARK	SIZE (W x D)
B1	240w x 420d
B2	450w x 420d
B3	1000w x 420d
B4	800w x 420d
B5	800w x 750d
B6	800w x 420d
B7	800w x 420d
B8	800w x 520d

MARK	DESCRIPTION	SIZE (W x D)	F'C (MPa)
C1	ED COLUMN	600 x 600	50
C2	ED COLUMN	450 x 600	50
C3	ED COLUMN	300 DIA	50

NOTES:

- STAR WALLS TO BE 100 THICK REINFORCED CONCRETE UNO
- LIFT WALLS TO BE 100 THICK REINFORCED CONCRETE UNO
- ALL RE WALLS TO BE 100 THICK UNO
- 75 MINIMUM TOPPING SLAB WHERE ARCHITECT SHOWS OVER LEVEL 1 SLABS. SLAB MESH FALLS TO ARCH. SAWN JOINTS AT MAX SW CTS
- SETDOWN LOCATIONS IN TOPPING SLAB REFER TO ARCHITECT'S DRAWINGS.

☒ DENOTES AREA OF BEAM ZONED REINFORCEMENT FREE



St George Transfer Beam Sizes					
Beam #	Beam Depth	Beam Width	PT KGS	REO KGS	STEEL TRUSS KGS
TB1	0.95	2.4	1100	1000	3000
TB2	1.2	2.4	1350	1300	6600
TB3	0.7	2.1	750	600	2200
TB4	0.6	2.1	650	450	1500
TB5	0.9	2.4	1050	1100	3200
TB6	0.6	2.1	650	450	2200
TB7	0.65	2.1	600	500	2400

INDICATES COLUMN OFF GRID WITH POTENTIAL REQUIREMENT FOR TRANSFER

LEVEL 1 - SOUTH
SCALE: 1:50

SEE FINISHED DIMENSIONS ON ALL OBJECTS UNLESS OTHERWISE SPECIFIED. DIMENSIONS SHALL BE GIVEN TO THE FACE UNLESS OTHERWISE SPECIFIED. DIMENSIONS SHALL BE GIVEN TO THE FACE UNLESS OTHERWISE SPECIFIED. DIMENSIONS SHALL BE GIVEN TO THE FACE UNLESS OTHERWISE SPECIFIED.

APPENDIX I

ED Building Vertical and Lateral Loading
Allowance Diagram by Cardno

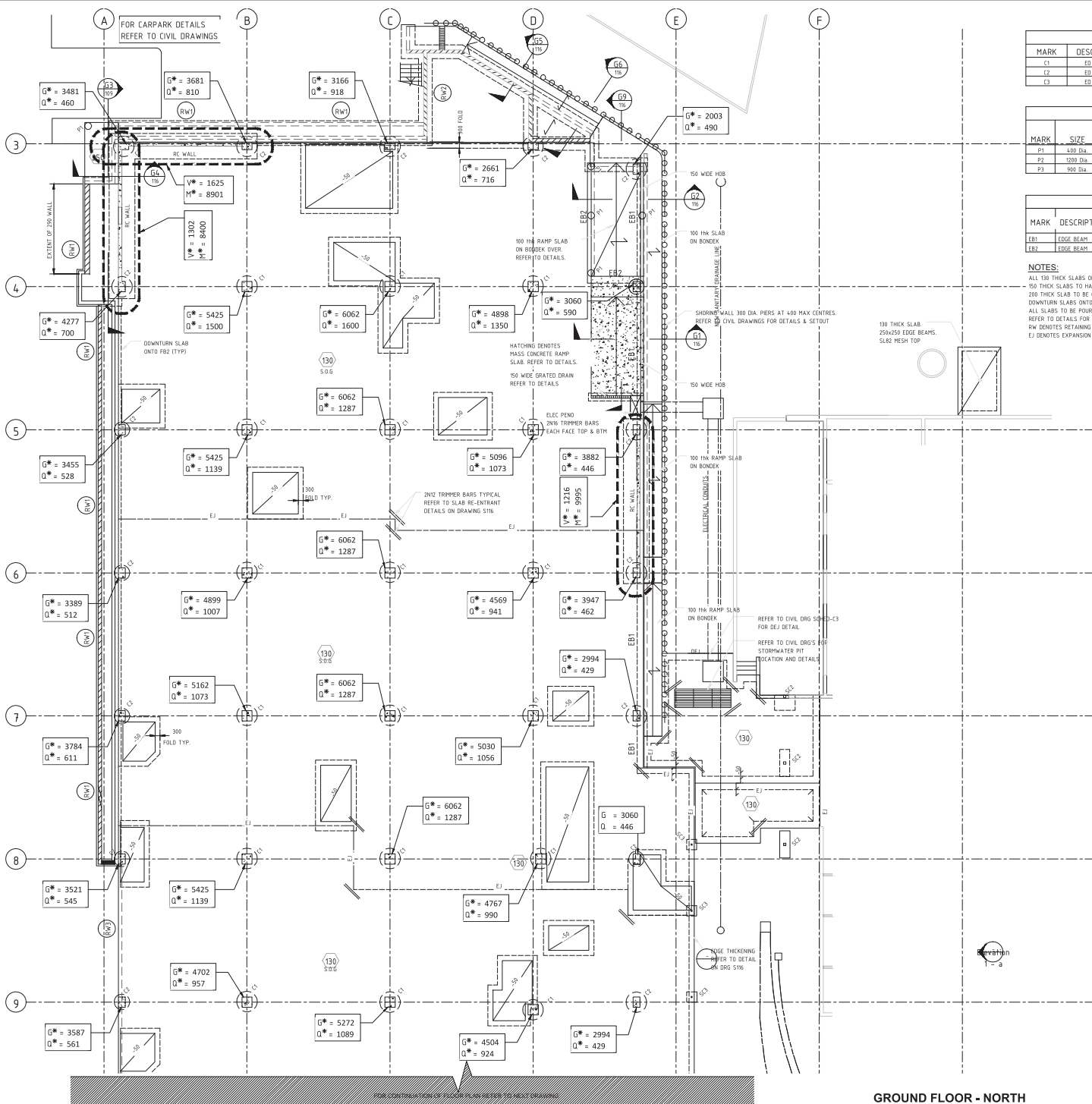

COLUMN SCHEDULE			
MARK	DESCRIPTION	SIZE (W x D)	F _c (MPa)
C1	ED COLUMN	600 x 600	50
C2	ED COLUMN	600 x 600	50
C3	ED COLUMN	700 DIA	50

PILE SCHEDULE (F _c = 32MPa)			
MARK	SIZE	SOCKET DEPTH (INTO CLASS III SANDSTONE)	REINFORCEMENT
P1	400 Dia	1.0m (5.0m CONTRACT LENGTH)	2N16 VERT, R20-300 TIES
P2	1200 Dia	1.0m (5.0m CONTRACT LENGTH)	4N16 TOP, 3N16 BTH, 2N12-300 TIES
P3	900 Dia	0.7m (4.3m CONTRACT LENGTH)	2N16 VERT, N12-300 TIES

GROUND FLOOR BEAM SCHEDULE			
MARK	DESCRIPTION	SIZE (W x D)	REINFORCEMENT
EB1	EDGE BEAM	450 x 400 (240 x 100 REBATE)	4N16 TOP, 3N16 BTH, 2N12-300 TIES
EB2	EDGE BEAM	450 x 400	3N16 TOP, 3N16 BTH, 2N12-300 TIES

NOTES:
 ALL 100 THICK SLABS ON GROUND REINFORCED USING S101 MESH 20' COVER, ON 120 THICK LAYER FINE CRUSHED ROCK.
 150 THICK SLABS TO HAVE S182 MESH TOP AND BOTTOM 30 COVER, ON 120 THICK LAYER FINE CRUSHED ROCK.
 200 THICK SLAB TO BE ON 50 THICK LAYER OF FINE CRUSHED ROCK, REINFORCED USING N16-250 TOP & BOTTOM, EACH WAY.
 DOWNTURN SLABS ONTO FOOTING BEAMS AND PERS. TYPICAL.
 ALL SLABS TO BE POURED ON CRUSHED ROCK, BLINDED WITH SAND + VAPOUR BARRIER, UNO.
 REFER TO DETAILS FOR BEAM DETAILS (EB1, EB2 AND EB3)
 RW DENOTES RETAINING WALL TYPE - REFER TO DETAILS
 EJ DENOTES EXPANSION JOINT

LEGEND:
 G* = ULTIMATE DEAD LOAD IN kN
 Q* = ULTIMATE LIVE LOAD IN kN
 V* = ULTIMATE SHEAR FORCE IN kN
 M* = ULTIMATE BENDING MOMENT IN kNm

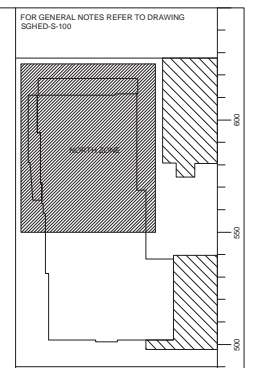

FOR GENERAL NOTES REFER TO DRAWING SGHED-S-100

REV	REVISION DESCRIPTION	DATE	BY
C5	DESIGN LOADS ADDED	21/09/14	PP
C4	SLAB LAYOUT REDESIGNED	03/07/14	PP
C3	CONCRETE PLINTH ADDED	06/04/14	PP
C2	CONSTRUCTION ISSUE	26/01/14	PP
C1	CONSTRUCTION ISSUE	26/01/14	PP

QA CHECK

Submit By	Date	Submit By	Date
WBS		STRUCT	
ARCH		SPCL CONSL	
MEP		SEVP	

Project: ST GEORGE HOSPITAL EMERGENCY DEPARTMENT

Principal: NSW Health Infrastructure

TRUE NORTH

PROJECT NORTH

HPi HEALTH PROJECTS INTERNATIONAL
 Architects and Health Facility Planners
 10/11-12/13, 14/15, 16/17, 18/19, 20/21, 22/23, 24/25, 26/27, 28/29, 30/31, 32/33, 34/35, 36/37, 38/39, 40/41, 42/43, 44/45, 46/47, 48/49, 50/51, 52/53, 54/55, 56/57, 58/59, 60/61, 62/63, 64/65, 66/67, 68/69, 70/71, 72/73, 74/75, 76/77, 78/79, 80/81, 82/83, 84/85, 86/87, 88/89, 90/91, 92/93, 94/95, 96/97, 98/99, 100/101, 102/103, 104/105, 106/107, 108/109, 110/111, 112/113, 114/115, 116/117, 118/119, 120/121, 122/123, 124/125, 126/127, 128/129, 130/131, 132/133, 134/135, 136/137, 138/139, 140/141, 142/143, 144/145, 146/147, 148/149, 150/151, 152/153, 154/155, 156/157, 158/159, 160/161, 162/163, 164/165, 166/167, 168/169, 170/171, 172/173, 174/175, 176/177, 178/179, 180/181, 182/183, 184/185, 186/187, 188/189, 190/191, 192/193, 194/195, 196/197, 198/199, 200/201, 202/203, 204/205, 206/207, 208/209, 210/211, 212/213, 214/215, 216/217, 218/219, 220/221, 222/223, 224/225, 226/227, 228/229, 230/231, 232/233, 234/235, 236/237, 238/239, 240/241, 242/243, 244/245, 246/247, 248/249, 250/251, 252/253, 254/255, 256/257, 258/259, 260/261, 262/263, 264/265, 266/267, 268/269, 270/271, 272/273, 274/275, 276/277, 278/279, 280/281, 282/283, 284/285, 286/287, 288/289, 290/291, 292/293, 294/295, 296/297, 298/299, 300/301, 302/303, 304/305, 306/307, 308/309, 310/311, 312/313, 314/315, 316/317, 318/319, 320/321, 322/323, 324/325, 326/327, 328/329, 330/331, 332/333, 334/335, 336/337, 338/339, 340/341, 342/343, 344/345, 346/347, 348/349, 350/351, 352/353, 354/355, 356/357, 358/359, 360/361, 362/363, 364/365, 366/367, 368/369, 370/371, 372/373, 374/375, 376/377, 378/379, 380/381, 382/383, 384/385, 386/387, 388/389, 390/391, 392/393, 394/395, 396/397, 398/399, 400/401, 402/403, 404/405, 406/407, 408/409, 410/411, 412/413, 414/415, 416/417, 418/419, 420/421, 422/423, 424/425, 426/427, 428/429, 430/431, 432/433, 434/435, 436/437, 438/439, 440/441, 442/443, 444/445, 446/447, 448/449, 450/451, 452/453, 454/455, 456/457, 458/459, 460/461, 462/463, 464/465, 466/467, 468/469, 470/471, 472/473, 474/475, 476/477, 478/479, 480/481, 482/483, 484/485, 486/487, 488/489, 490/491, 492/493, 494/495, 496/497, 498/499, 500/501, 502/503, 504/505, 506/507, 508/509, 510/511, 512/513, 514/515, 516/517, 518/519, 520/521, 522/523, 524/525, 526/527, 528/529, 530/531, 532/533, 534/535, 536/537, 538/539, 540/541, 542/543, 544/545, 546/547, 548/549, 550/551, 552/553, 554/555, 556/557, 558/559, 560/561, 562/563, 564/565, 566/567, 568/569, 570/571, 572/573, 574/575, 576/577, 578/579, 580/581, 582/583, 584/585, 586/587, 588/589, 590/591, 592/593, 594/595, 596/597, 598/599, 600/601, 602/603, 604/605, 606/607, 608/609, 610/611, 612/613, 614/615, 616/617, 618/619, 620/621, 622/623, 624/625, 626/627, 628/629, 630/631, 632/633, 634/635, 636/637, 638/639, 640/641, 642/643, 644/645, 646/647, 648/649, 650/651, 652/653, 654/655, 656/657, 658/659, 660/661, 662/663, 664/665, 666/667, 668/669, 670/671, 672/673, 674/675, 676/677, 678/679, 680/681, 682/683, 684/685, 686/687, 688/689, 690/691, 692/693, 694/695, 696/697, 698/699, 700/701, 702/703, 704/705, 706/707, 708/709, 710/711, 712/713, 714/715, 716/717, 718/719, 720/721, 722/723, 724/725, 726/727, 728/729, 730/731, 732/733, 734/735, 736/737, 738/739, 740/741, 742/743, 744/745, 746/747, 748/749, 750/751, 752/753, 754/755, 756/757, 758/759, 760/761, 762/763, 764/765, 766/767, 768/769, 770/771, 772/773, 774/775, 776/777, 778/779, 780/781, 782/783, 784/785, 786/787, 788/789, 790/791, 792/793, 794/795, 796/797, 798/799, 800/801, 802/803, 804/805, 806/807, 808/809, 810/811, 812/813, 814/815, 816/817, 818/819, 820/821, 822/823, 824/825, 826/827, 828/829, 830/831, 832/833, 834/835, 836/837, 838/839, 840/841, 842/843, 844/845, 846/847, 848/849, 850/851, 852/853, 854/855, 856/857, 858/859, 860/861, 862/863, 864/865, 866/867, 868/869, 870/871, 872/873, 874/875, 876/877, 878/879, 880/881, 882/883, 884/885, 886/887, 888/889, 890/891, 892/893, 894/895, 896/897, 898/899, 900/901, 902/903, 904/905, 906/907, 908/909, 910/911, 912/913, 914/915, 916/917, 918/919, 920/921, 922/923, 924/925, 926/927, 928/929, 930/931, 932/933, 934/935, 936/937, 938/939, 940/941, 942/943, 944/945, 946/947, 948/949, 950/951, 952/953, 954/955, 956/957, 958/959, 960/961, 962/963, 964/965, 966/967, 968/969, 970/971, 972/973, 974/975, 976/977, 978/979, 980/981, 982/983, 984/985, 986/987, 988/989, 990/991, 992/993, 994/995, 996/997, 998/999, 1000/1001, 1002/1003, 1004/1005, 1006/1007, 1008/1009, 1010/1011, 1012/1013, 1014/1015, 1016/1017, 1018/1019, 1020/1021, 1022/1023, 1024/1025, 1026/1027, 1028/1029, 1030/1031, 1032/1033, 1034/1035, 1036/1037, 1038/1039, 1040/1041, 1042/1043, 1044/1045, 1046/1047, 1048/1049, 1050/1051, 1052/1053, 1054/1055, 1056/1057, 1058/1059, 1060/1061, 1062/1063, 1064/1065, 1066/1067, 1068/1069, 1070/1071, 1072/1073, 1074/1075, 1076/1077, 1078/1079, 1080/1081, 1082/1083, 1084/1085, 1086/1087, 1088/1089, 1090/1091, 1092/1093, 1094/1095, 1096/1097, 1098/1099, 1100/1101, 1102/1103, 1104/1105, 1106/1107, 1108/1109, 1110/1111, 1112/1113, 1114/1115, 1116/1117, 1118/1119, 1120/1121, 1122/1123, 1124/1125, 1126/1127, 1128/1129, 1130/1131, 1132/1133, 1134/1135, 1136/1137, 1138/1139, 1140/1141, 1142/1143, 1144/1145, 1146/1147, 1148/1149, 1150/1151, 1152/1153, 1154/1155, 1156/1157, 1158/1159, 1160/1161, 1162/1163, 1164/1165, 1166/1167, 1168/1169, 1170/1171, 1172/1173, 1174/1175, 1176/1177, 1178/1179, 1180/1181, 1182/1183, 1184/1185, 1186/1187, 1188/1189, 1190/1191, 1192/1193, 1194/1195, 1196/1197, 1198/1199, 1200/1201, 1202/1203, 1204/1205, 1206/1207, 1208/1209, 1210/1211, 1212/1213, 1214/1215, 1216/1217, 1218/1219, 1220/1221, 1222/1223, 1224/1225, 1226/1227, 1228/1229, 1230/1231, 1232/1233, 1234/1235, 1236/1237, 1238/1239, 1240/1241, 1242/1243, 1244/1245, 1246/1247, 1248/1249, 1250/1251, 1252/1253, 1254/1255, 1256/1257, 1258/1259, 1260/1261, 1262/1263, 1264/1265, 1266/1267, 1268/1269, 1270/1271, 1272/1273, 1274/1275, 1276/1277, 1278/1279, 1280/1281, 1282/1283, 1284/1285, 1286/1287, 1288/1289, 1290/1291, 1292/1293, 1294/1295, 1296/1297, 1298/1299, 1300/1301, 1302/1303, 1304/1305, 1306/1307, 1308/1309, 1310/1311, 1312/1313, 1314/1315, 1316/1317, 1318/1319, 1320/1321, 1322/1323, 1324/1325, 1326/1327, 1328/1329, 1330/1331, 1332/1333, 1334/1335, 1336/1337, 1338/1339, 1340/1341, 1342/1343, 1344/1345, 1346/1347, 1348/1349, 1350/1351, 1352/1353, 1354/1355, 1356/1357, 1358/1359, 1360/1361, 1362/1363, 1364/1365, 1366/1367, 1368/1369, 1370/1371, 1372/1373, 1374/1375, 1376/1377, 1378/1379, 1380/1381, 1382/1383, 1384/1385, 1386/1387, 1388/1389, 1390/1391, 1392/1393, 1394/1395, 1396/1397, 1398/1399, 1400/1401, 1402/1403, 1404/1405, 1406/1407, 1408/1409, 1410/1411, 1412/1413, 1414/1415, 1416/1417, 1418/1419, 1420/1421, 1422/1423, 1424/1425, 1426/1427, 1428/1429, 1430/1431, 1432/1433, 1434/1435, 1436/1437, 1438/1439, 1440/1441, 1442/1443, 1444/1445, 1446/1447, 1448/1449, 1450/1451, 1452/1453, 1454/1455, 1456/1457, 1458/1459, 1460/1461, 1462/1463, 1464/1465, 1466/1467, 1468/1469, 1470/1471, 1472/1473, 1474/1475, 1476/1477, 1478/1479, 1480/1481, 1482/1483, 1484/1485, 1486/1487, 1488/1489, 1490/1491, 1492/1493, 1494/1495, 1496/1497, 1498/1499, 1500/1501, 1502/1503, 1504/1505, 1506/1507, 1508/1509, 1510/1511, 1512/1513, 1514/1515, 1516/1517, 1518/1519, 1520/1521, 1522/1523, 1524/1525, 1526/1527, 1528/1529, 1530/1531, 1532/1533, 1534/1535, 1536/1537, 1538/1539, 1540/1541, 1542/1543, 1544/1545, 1546/1547, 1548/1549, 1550/1551, 1552/1553, 1554/1555, 1556/1557, 1558/1559, 1560/1561, 1562/1563, 1564/1565, 1566/1567, 1568/1569, 1570/1571, 1572/1573, 1574/1575, 1576/1577, 1578/1579, 1580/1581, 1582/1583, 1584/1585, 1586/1587, 1588/1589, 1590/1591, 1592/1593, 1594/1595, 1596/1597, 1598/1599, 1600/1601, 1602/1603, 1604/1605, 1606/1607, 1608/1609, 1610/1611, 1612/1613, 1614/1615, 1616/1617, 1618/1619, 1620/1621, 1622/1623, 1624/1625, 1626/1627, 1628/1629, 1630/1631, 1632/1633, 1634/1635, 1636/1637, 1638/1639, 1640/1641, 1642/1643, 1644/1645, 1646/1647, 1648/1649, 1650/1651, 1652/1653, 1654/1655, 1656/1657, 1658/1659, 1660/1661, 1662/1663, 1664/1665, 1666/1667, 1668/1669, 1670/1671, 1672/1673, 1674/1675, 1676/1677, 1678/1679, 1680/1681, 1682/1683, 1684/1685, 1686/1687, 1688/1689, 1690/1691, 1692/1693, 1694/1695, 1696/1697, 1698/1699, 1700/1701, 1702/1703, 1704/1705, 1706/1707, 1708/1709, 1710/1711, 1712/1713, 1714/1715, 1716/1717, 1718/1719, 1720/1721, 1722/1723, 1724/1725, 1726/1727, 1728/1729, 1730/1731, 1732/1733, 1734/1735, 1736/1737, 1738/1739, 1740/1741, 1742/1743, 1744/1745, 1746/1747, 1748/1749, 1750/1751, 1752/1753, 1754/1755, 1756/1757, 1758/1759, 1760/1761, 1762/1763, 1764/1765, 1766/1767, 1768/1769, 1770/1771, 1772/1773, 1774/1775, 1776/1777, 1778/1779, 1780/1781, 1782/1783, 1784/1785, 1786/1787, 1788/1789, 1790/1791, 1792/1793, 1794/1795, 1796/1797, 1798/1799, 1800/1801, 1802/1803, 1804/1805, 1806/1807, 1808/1809, 1810/1811, 1812/1813, 1814/1815, 1816/1817, 1818/1819, 1820/1821, 1822/1823, 1824/1825, 1826/1827, 1828/1829, 1830/1831, 1832/1833, 1834/1835, 1836/1837, 1838/1839, 1840/1841, 1842/1843, 1844/1845, 1846/1847, 1848/1849, 1850/1851, 1852/1853, 1854/1855, 1856/1857, 1858/1859, 1860/1861, 1862/1863, 1864/1865, 1866/1867, 1868/1869, 1870/1871, 1872/1873, 1874/1875, 1876/1877, 1878/1879, 1880/1881, 1882/1883, 1884/1885, 1886/1887, 1888/1889, 1890/1891, 1892/1893, 1894/1895, 1896/1897, 1898/1899, 1900/1901, 1902/1903, 1904/1905, 1906/1907, 1908/1909, 1910/1911, 1912/1913, 1914/1915, 1916/1917, 1918/1919, 1920/1921, 1922/1923, 1924/1925, 1926/1927, 1928/1929, 1930/1931, 1932/1933, 1934/1935, 1936/1937, 1938/1939, 1940/1941, 1942/1943, 1944/1945, 1946/1947, 1948/1949, 1950/1951, 1952/1953, 1954/1955, 1956/1957, 1958/1959, 1960/1961, 1962/1963, 1964/1965, 1966/1967, 1968/1969, 1970/1971, 1972/1973, 1974/1975, 1976/1977, 1978/1979, 1980/1981, 1982/1983, 1984/1985, 1986/1987, 1988/1989, 1990/1991, 1992/1993, 1994/1995, 1996/1997, 1998/1999, 2000/2001, 2002/2003, 2004/2005, 2006/2007, 2008/2009, 2010/2011, 2012/2013, 2014/2015, 2016/2017, 2018/2019, 2020/2021, 2022/2023, 2024/2025, 2026/2027, 2028/2029, 2030/2031, 2032/2033, 2034/2035, 2036/2037, 2038/2039, 2040/2041, 2042/2043, 2044/2045, 2046/2047, 2048/2049, 2050/2051, 2052/2053, 2054/2055, 2056/2057, 2058/2059, 2060/2061, 2062/2063, 2064/2065, 2066/2067, 2068/2069, 2070/2071, 2072/2073, 2074/2075, 2076/2077, 2078/2079, 2080/2081,

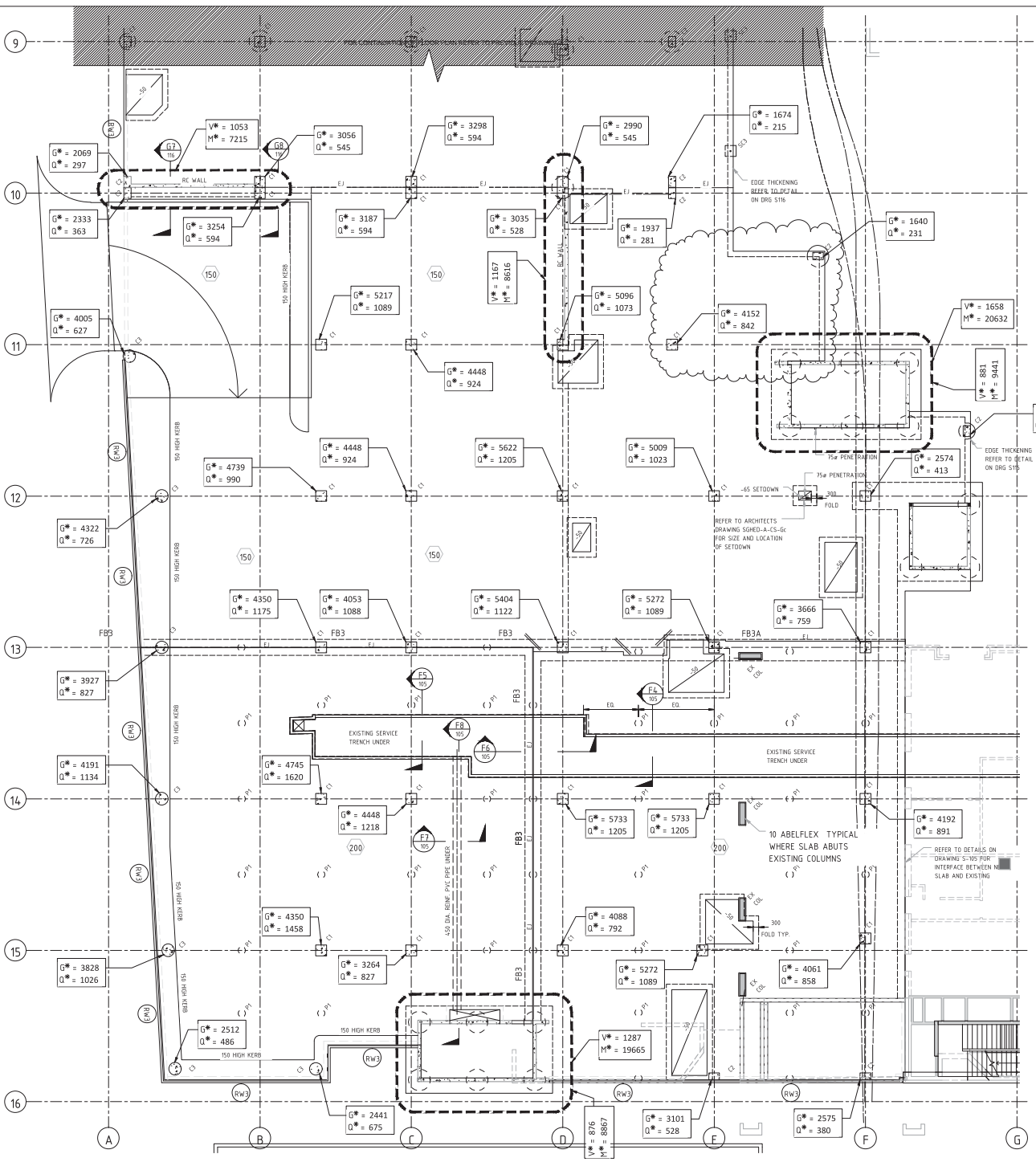

GROUND FLOOR - SOUTH

SCALE: 1:100

COLUMN SCHEDULE			
MARK	DESCRIPTION	SIZE (W x D)	F'c (MPa)
C1	ED COLUMN	400 x 600	50
C2	ED COLUMN	400 x 600	50
C3	ED COLUMN	700 DIA.	50

PILE SCHEDULE (F'c = 32MPa)			
MARK	SIZE	SOCKET DEPTH (INTO CLASS III SANDSTONE)	REINFORCEMENT
P1	400 Dia	10m (5.0m CONTRACT LENGTH)	3N16 VERT. R10-300 TIES
P2	700 Dia	14m (5.5m CONTRACT LENGTH)	3N16 VERT. R10-300 TIES
P3	900 Dia	0.9m (4.3m CONTRACT LENGTH)	3N24 VERT. N12-300 TIES

GROUND FLOOR BEAM SCHEDULE			
MARK	DESCRIPTION	SIZE (W x D)	REINFORCEMENT
EB1	EDGE BEAM	450 x 450 (240 x 100 REBATE)	4N16 TOP. 3N16. B1M. 2N12-300 TIES.
EB2	EDGE BEAM	450 x 450	3N16 TOP. 3N16. B1M. 2N12-300 TIES.

NOTES:
 ALL 150 THICK SLABS ON GROUND REINFORCED USING 50MM MESH TOP, 30 COVER, ON 100 THICK LAYER FINE CRUSHED ROCK.
 150 THICK SLABS TO HAVE 50MM MESH TOP AND BOTTOM 30 COVER, ON 100 THICK LAYER FINE CRUSHED ROCK.
 200 THICK SUSPENDED SLAB ON GRADE TO BE ON 50 THICK LAYER OF FINE CRUSHED ROCK, REINFORCED USING N16-250 TOP & BOTTOM, EACH WAY.
 DOWNPOUR SLABS ONTO FOOTING BEAMS AND PIERS, TYPICAL.
 ALL SLABS TO BE POURED ON CRUSHED ROCK, BLENDED WITH SAND + VAPOUR BARRIER, UNDO.
 REFER TO DETAILS FOR BEAM DETAILS (EB1, EB2 AND B11)
 RW DENOTES RETAINING WALL TYPE - REFER TO DETAILS
 EJ DENOTES EXPANSION JOINT

LEGEND:
 G* = ULTIMATE DEAD LOAD IN KN
 Q* = ULTIMATE LIVE LOAD IN KN
 V* = ULTIMATE SHEAR FORCE IN KN
 M* = ULTIMATE BENDING MOMENT IN KN

FOR GENERAL NOTES REFER TO DRAWING SCHED-S-100

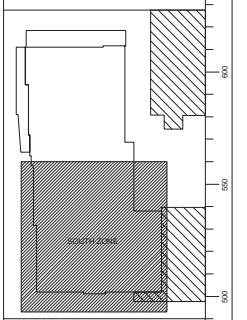

C4	REGIONAL LOAD ADDED	2018/04/01	PP
C3	CT ROOM REVISED	2017/11/01	PP
C2	SETDOWN ADDED, 75 DIA. PENETRATIONS ADDED, RC LIFTURN ADDED, SECTION G15 ADDED	24-06-16	PP
C1	CONSTRUCTION ISSUE	22-11-16	PP

Project: ST GEORGE HOSPITAL EMERGENCY DEPARTMENT

Principal:

TRUE NORTH

PROJECT NORTH

Health Projects International
 Architects and Health Facility Planners
 100 West Street
 Suite 100
 St. George, NSW 2250

Project Manager: [Blank]

Client Ref: [Blank] / [Blank] / [Blank]

Drawn By: [Blank]

Checked By: [Blank]

Scale: 1:100

Date: [Blank]

Revit: 2012

Sheet: SGHED-S-111

Scale: 1:100

APPENDIX J

MRI Options

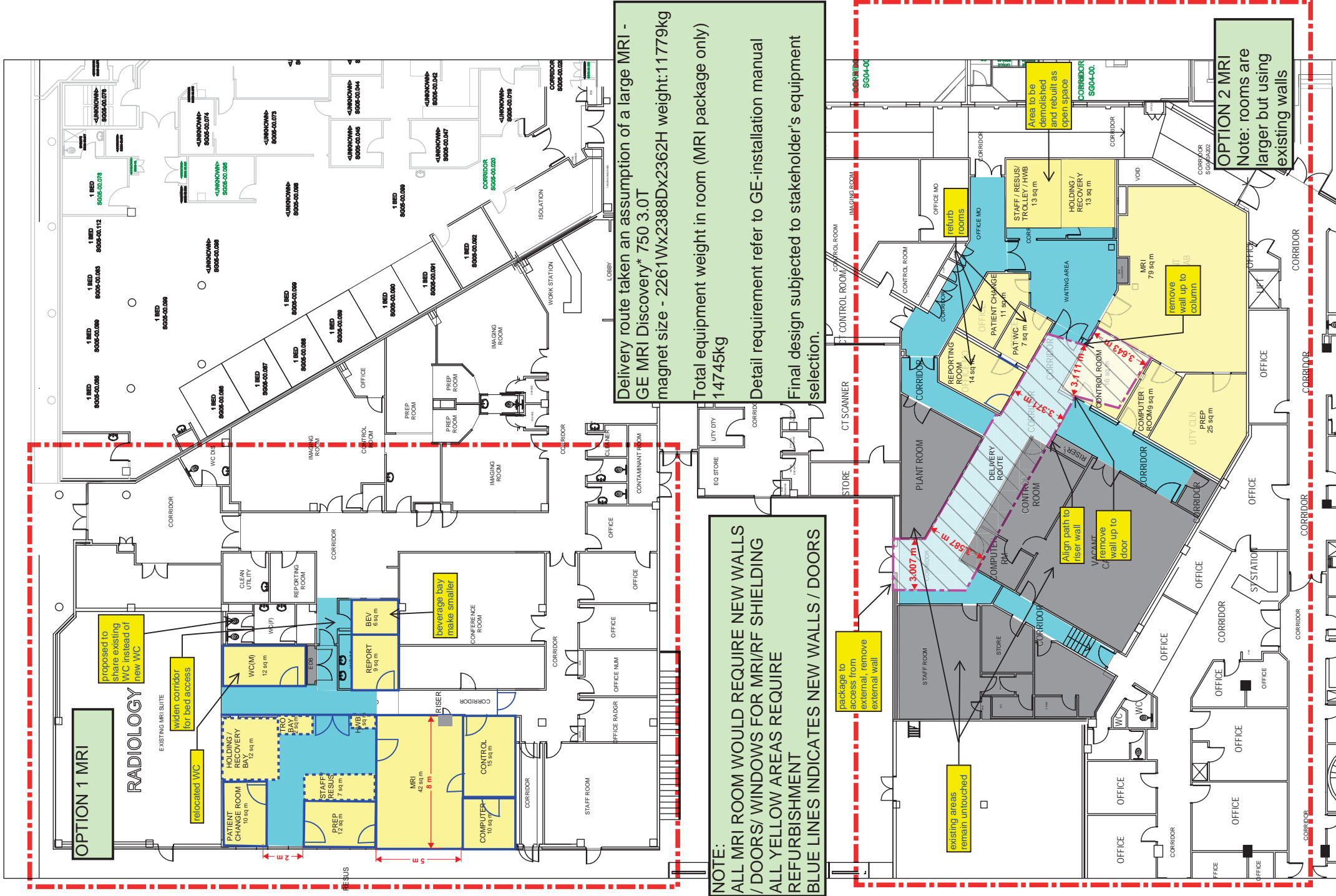

OPTION 1 MRI

RADIOLOGY

proposed to share existing WC instead of new WC

relocated WC

widen corridor for bed access

leverage bay to make smaller

NOTE:
 ALL MRI ROOM WOULD REQUIRE NEW WALLS / DOORS / WINDOWS FOR MRI/RF SHIELDING
 ALL YELLOW AREAS REQUIRE REFURBISHMENT
 BLUE LINES INDICATES NEW WALLS / DOORS

Delivery route taken an assumption of a large MRI - GE MRI Discovery* 750 3.0T magnet size - 2261Wx2388Dx2362H weight:11779kg
 Total equipment weight in room (MRI package only) 14745kg
 Detail requirement refer to GE-installation manual
 Final design subjected to stakeholder's equipment selection.

existing areas remain untouched

package to access from external, remove external wall

Align path to riser wall

remove wall up to door

remove wall up to door

Area to be demolished and rebuilt as open space

OPTION 2 MRI
 Note: rooms are larger but using existing walls

