

- DA site boundary
  - Building envelope boundary
  - Basement footprint below
  - ① Harpullia pendula
  - ② Flindersia australis
  - ③ Turf
  - ④ Porphyry paving
  - ⑤ Granite paving (CoS standard)
  - ⑥ Building R4A porte cochere
  - ⑦ Stage 1B Basement entry below (Refer to Basement DA)
- PROPOSED MODIFICATIONS**
- M1 Deletion of 2 trees
  - M2 Development application boundary changed
  - M3 Vestibule amended
  - M4 M4 administrative shift of Strada & associated conditions to SSD8892218'

All Landscaping outside of residential lot line can be referred to Public Domain approval SSD 7944

P02 design has been updated to reflect the design approved by the Secretary under condition B31

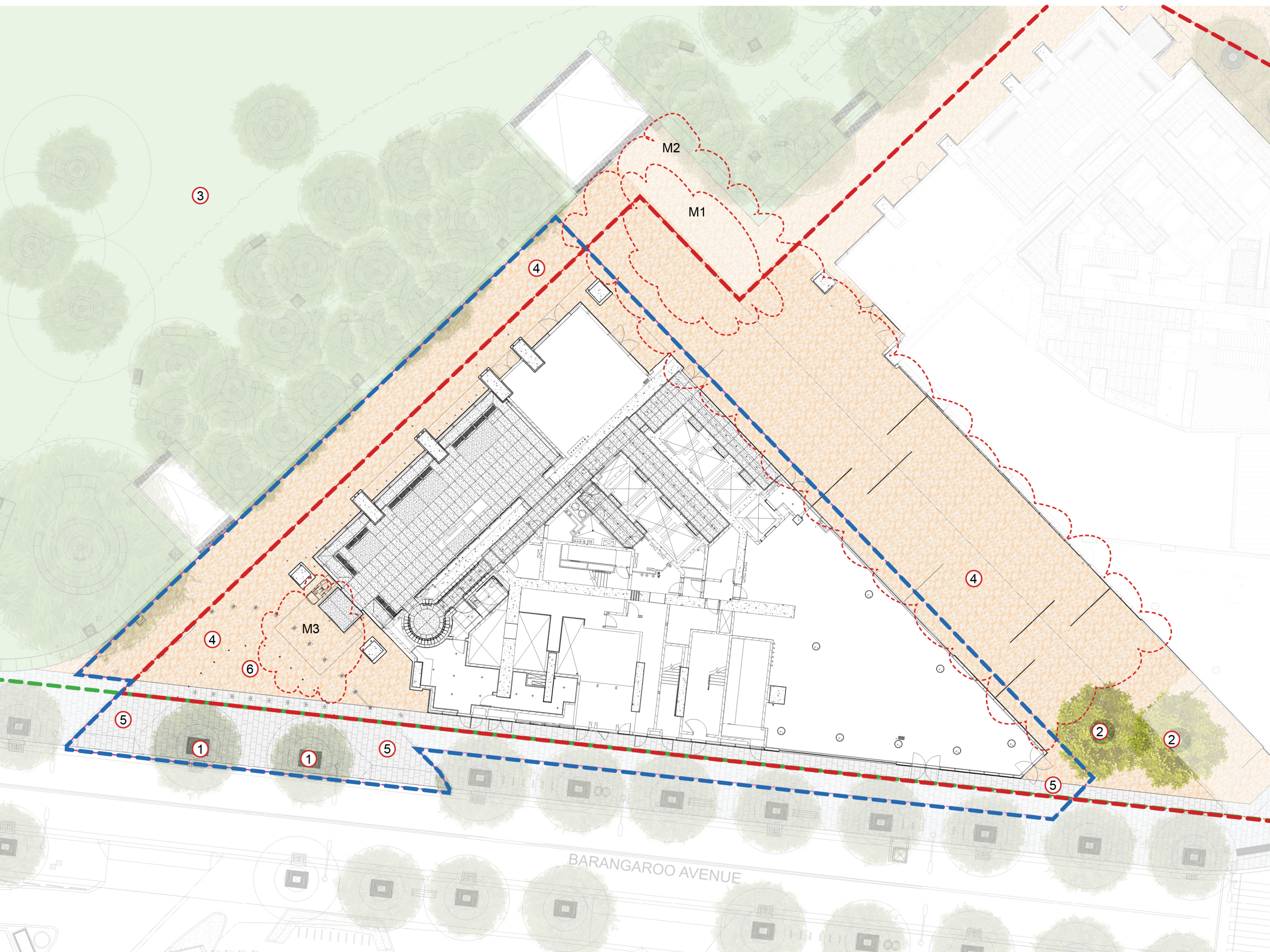



- DA site boundary
- Building envelope boundary
- Basement footprint below
- ① Harpullia pendula
- ② Flindersia australis
- ③ Turf
- ④ Porphyry paving
- ⑤ Granite paving (CoS standard)
- ⑥ Building R4A porte cochere

#### PROPOSED MODIFICATIONS

- M1 Deletion of 2 trees
- M2 Development application boundary changed
- M3 Vestibule amended

All Landscaping outside of residential lot line can be referred to Public Domain approval SSD 7944



© Copyright McGregor Coxall  
AUS ACN 082 334 290  
UK 10199853  
PRC ID NO. 06000002201607080008  
Sydney Melbourne Shenzhen Bristol  
www.mcgregorcoxall.com

Client



Project Name

ONE SYDNEY HARBOUR

Project No.

0853SYD

Address

Barangaroo

Scale

1:200 @ A1



All dimensions are in millimetres unless otherwise noted.  
Do not scale from this drawing.

North

Phase

SECTION 4.55-MOD4

Sheet Title

R4A-DA Ground Floor

Sheet No.

RPB430-GE-R4A002\_GRND

Rev

T

Date : 30.06.2021



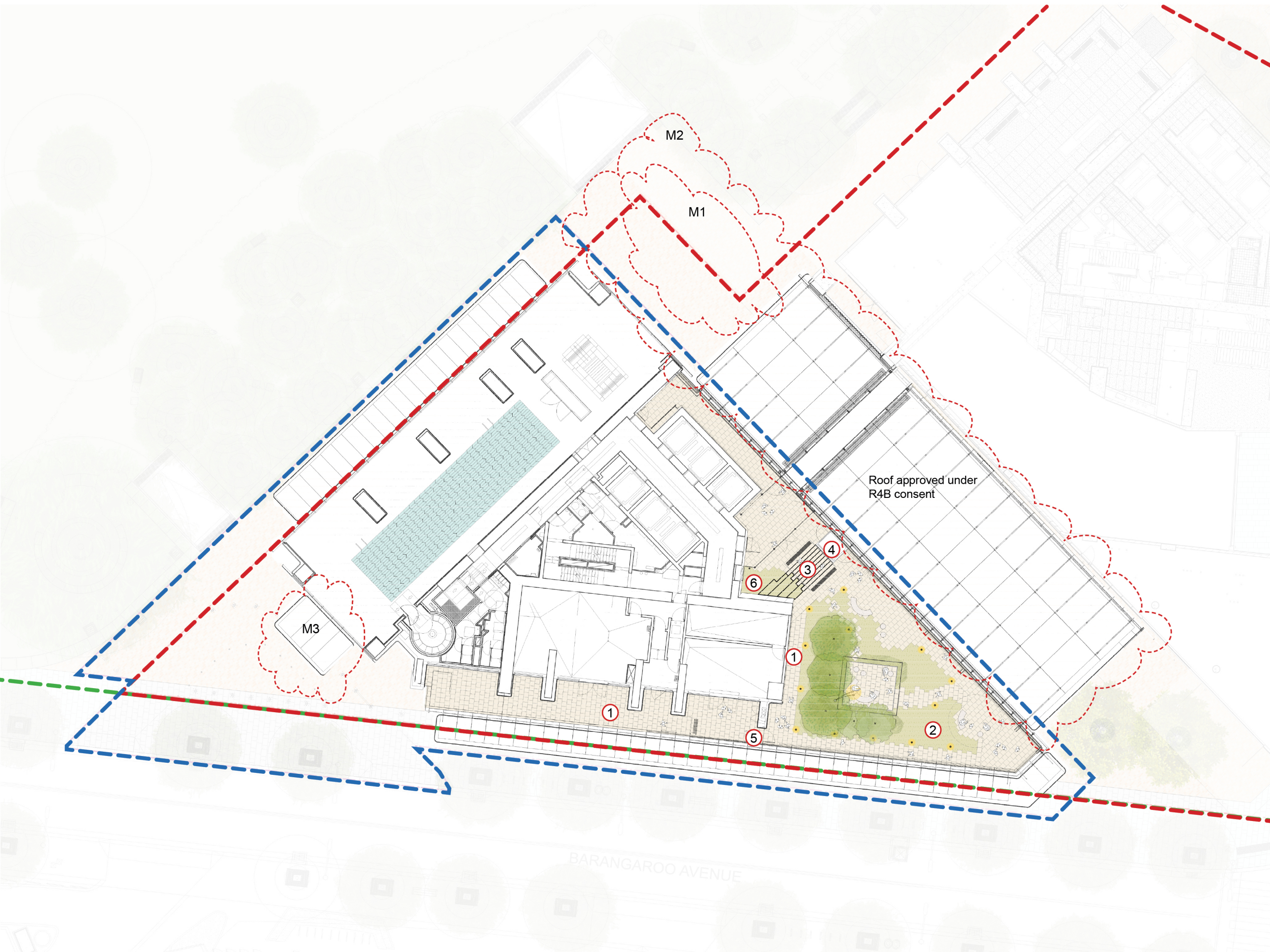

- DA site boundary
- Building envelope boundary
- Basement footprint below
- ① Stone paving on Podium level 02
- ② Turf
- ③ Podium steps
- ④ Disabled lift
- ⑤ Restricted Access Gate
- ⑥ Shrub planting

#### PROPOSED MODIFICATIONS

- M1 Deletion of 2 trees
- M2 Development application boundary changed
- M3 Vestibule amended

All Landscaping outside of residential lot line can be referred to Public Domain approval SSD 7944

P02 design has been updated to reflect the design approved by the Secretary under condition B31



© Copyright McGregor Coxall  
AUS ACN 082 334 290  
UK 10199853  
PRC ID NO. 06000002201607080008  
Sydney Melbourne Shenzhen Bristol  
www.mcgregorcoxall.com

Client



Project Name

ONE SYDNEY HARBOUR

Project No.

0853SYD

Address

Barangaroo

Scale

1:200 @ A1



All dimensions are in millimetres unless otherwise noted.  
Do not scale from this drawing.

North

Phase

SECTION 4.55-MOD4

Sheet Title

R4A-DA Podium Level 02

Sheet No.

RPB430-GE-R4A003\_P02

Rev

S

Date : 30.06.2021