

ROAD 07 LONGITUDINAL SECTION
 SCALE 1:500 HORI.
 1:100 VERT.

B

Issue	Description	Date
B	ISSUED FOR MOD 4 APPLICATION	05-05-17
A	ISSUED FOR REVIEW	13-04-16

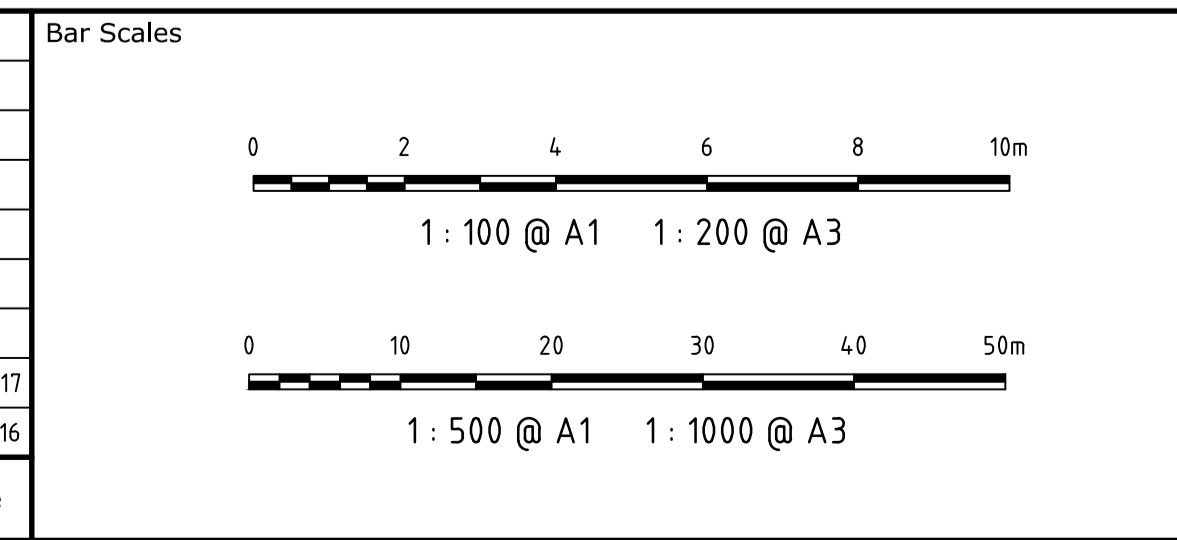

THIS DRAWING CANNOT BE COPIED OR REPRODUCED IN ANY FORM OR USED FOR ANY OTHER PURPOSE OTHER THAN THAT ORIGINALLY INTENDED WITHOUT THE WRITTEN PERMISSION OF AT&L



Scales 1 : 100 (V) 1:500 (H)	Drawn	JB
	Designed	JB
	Checked	AMc
Grid MGA	Approved	
Height Datum AHD		

Project OAKDALE SOUTH	Title ROAD LONGITUDINAL SECTIONS SHEET 5
Status FOR APPROVAL NOT TO BE USED FOR CONSTRUCTION	
Drawing No. C1225	Project No. 14-193
Issue B	

Civil Engineers and Project Managers

Level 7, 153 Walker Street
 North Sydney NSW 2060
 ABN 96 130 882 405
 Tel: 02 9439 1777
 Fax: 02 9923 1055
 www.atl.net.au
 info@atl.net.au



Issue	Description	Date
E	ISSUED FOR MOD 4 APPLICATION	05-05-17
D	ISSUED FOR REVIEW	13-04-16
C	ISSUED FOR S96 APPLICATION	19-09-16
B	ISSUED FOR INFORMATION	15-07-16
A	ISSUED FOR SSD APPLICATION	03-09-15

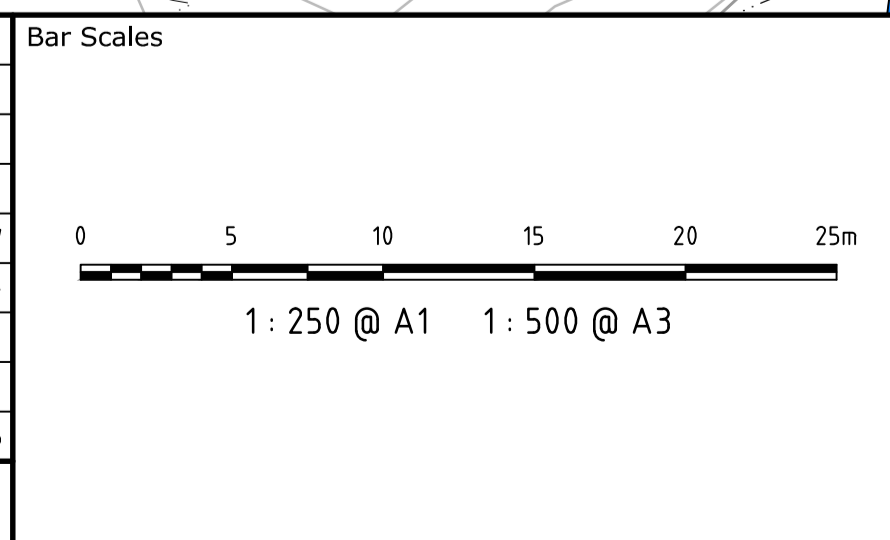

Key Plan

Client



Scales	AS SHOWN	Drawn	JB
		Designed	JB
Grid	MGA	Checked	AMc
Height Datum	AHD	Approved	

THIS DRAWING CANNOT BE COPIED OR REPRODUCED IN ANY FORM OR USED FOR ANY OTHER PURPOSE OTHER THAN THAT ORIGINALLY INTENDED WITHOUT THE WRITTEN PERMISSION OF AT&L

Project
OAKDALE SOUTH ESTATE INDUSTRIAL DEVELOPMENT

Title
BIO-RETENTION BASIN B DETAIL PLAN

Civil Engineers and Project Managers

Level 7, 153 Walker Street
North Sydney NSW 2060
ABN 96 130 882 405
Tel: 02 9439 1777
Fax: 02 9923 1055
www.atl.net.au
info@atl.net.au

Status
FOR APPROVAL
NOT TO BE USED FOR CONSTRUCTION

Drawing No. C1244	Project No. 14-193	Issue E
-----------------------------	------------------------------	-------------------

CATCHMENT	CATCHMENT AREA (Ha)	DESIGN BASIN VOLUME (m ³)	DESIGN BIO-RETENTION BASIN AREA (m ²)
A	12.41	5660	1610
B	13.98	3006	933
C	27.8	10379	2356
D	6.69	2759	920
E	14.38	4289	1890

NOTES

1 - STORAGE REQUIREMENT OF 250m³/Ha TO MATCH OAKDALE CENTRAL DEVELOPMENT.

2 - BIO-RETENTION BASINS SIZED TO ACHIEVE FOLLOWING TREATMENT RATES:

- TOTAL SUSPENDED SOLIDS = 85%
- TOTAL PHOSPHOROUS = 65%
- TOTAL NITROGEN = 45%

LEGEND

— CATCHMENT BOUNDARY

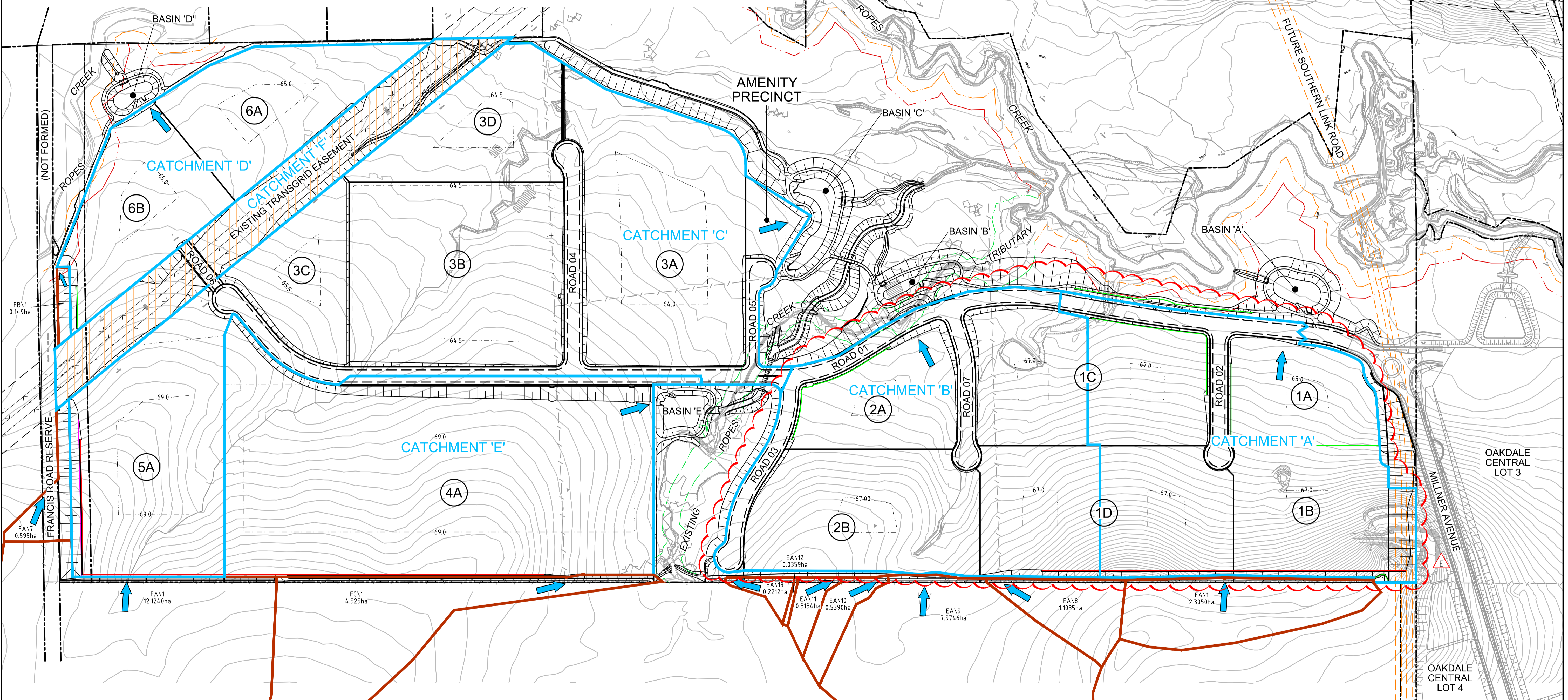

Issue	Description	Date
E	ISSUED FOR MOD 4 APPLICATION	05-05-17
D	ISSUED FOR REVIEW	13-04-16
C	ISSUED FOR S96 APPLICATION	19-09-16
B	ISSUED FOR INFORMATION	15-07-16
A	ISSUED FOR SSD APPLICATION	03-09-15

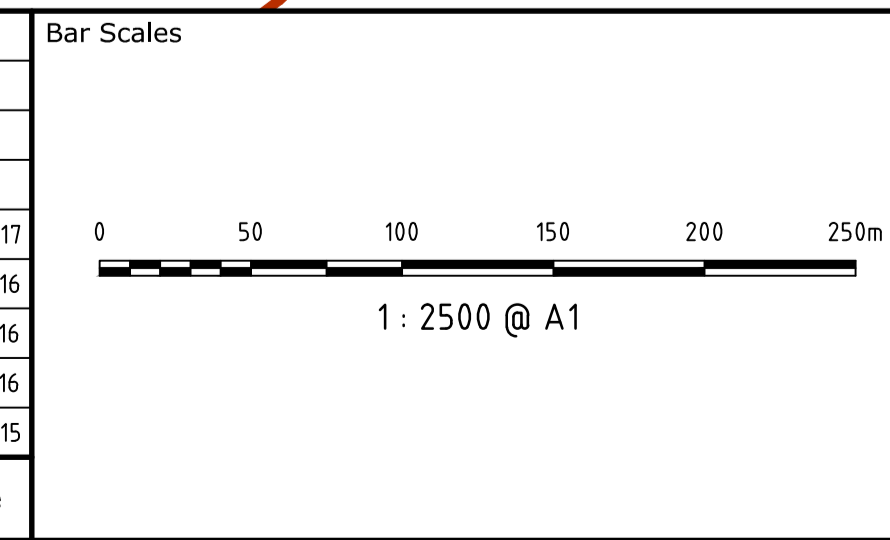

Key Plan

Client



Scales	1 : 2500	Drawn	JB
		Designed	JB
Grid	MGA	Checked	AMc
Height Datum	AHD	Approved	

Project

OAKDALE SOUTH ESTATE INDUSTRIAL DEVELOPMENT

Title

STORMWATER CATCHMENT PLAN

THIS DRAWING CANNOT BE COPIED OR REPRODUCED IN ANY FORM OR USED FOR ANY OTHER PURPOSE OTHER THAN THAT ORIGINALLY INTENDED WITHOUT THE WRITTEN PERMISSION OF AT&L

Civil Engineers and Project Managers	
at&l	
Level 7, 153 Walker Street North Sydney NSW 2060 ABN 96 130 882 405 Tel: 02 9439 1777 Fax: 02 9923 1055 www.atl.net.au info@atl.net.au	
Status	FOR APPROVAL
NOT TO BE USED FOR CONSTRUCTION	
Drawing No.	Project No.
C1301	14-193
Issue	E

Civil Engineers and Project Managers	
at&l	
Level 7, 153 Walker Street North Sydney NSW 2060 ABN 96 130 882 405 Tel: 02 9439 1777 Fax: 02 9923 1055 www.atl.net.au info@atl.net.au	
Status	FOR APPROVAL
NOT TO BE USED FOR CONSTRUCTION	
Drawing No.	Project No.
C1301	14-193
Issue	E

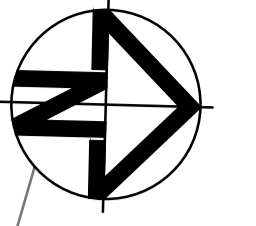

ROAD 01

60km/h S_{ISD} = 123m (R_t = 2.0s)

NO STREET TREES OR PLANTING IN LANDSCAPING ZONE WITHIN HATCHED AREA

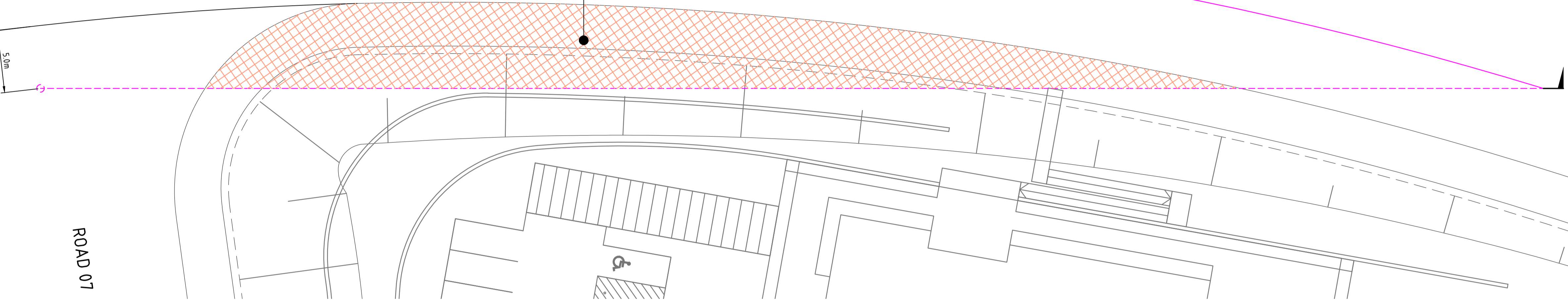

ROAD 07

PLAN
1 : 200

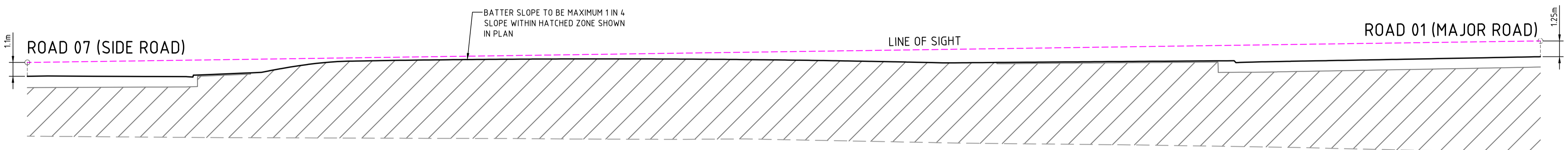

BATTER SLOPE TO BE MAXIMUM 1 IN 4 SLOPE WITHIN HATCHED ZONE SHOWN IN PLAN

LINE OF SIGHT

ROAD 01 (MAJOR ROAD)

ROAD 07 (SIDE ROAD)

SECTION 1
1 : 200

Issue	Description	Date
A	ISSUED FOR MOD 4 APPLICATION	05-05-17

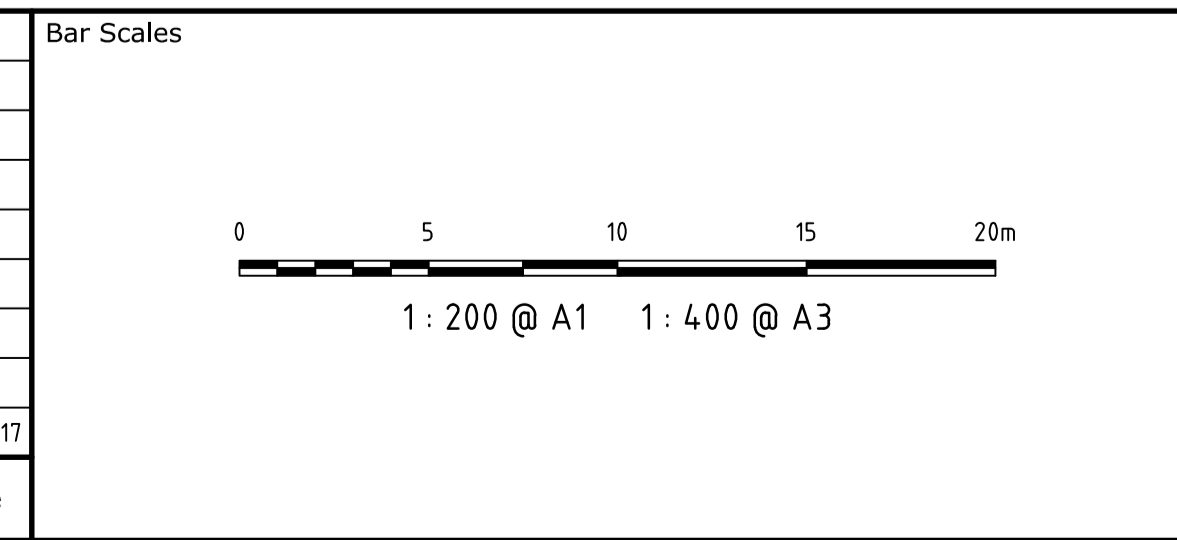

THIS DRAWING CANNOT BE COPIED OR REPRODUCED IN ANY FORM OR USED FOR ANY OTHER PURPOSE OTHER THAN THAT ORIGINALLY INTENDED WITHOUT THE WRITTEN PERMISSION OF AT&L



Scales	1 : 200	Drawn	JB
		Designed	JB
		Checked	AMc
Grid	MGA	Approved	
Height Datum	AHD		

Project	OAKDALE SOUTH
Title	ROAD 07 SIGHT DISTANCE PLAN

Civil Engineers and Project Managers

Level 7, 153 Walker Street
North Sydney NSW 2060
ABN 96 130 882 405
Tel: 02 9439 1777
Fax: 02 9923 1055
www.atl.net.au
info@atl.net.au

Status	FOR APPROVAL NOT TO BE USED FOR CONSTRUCTION	A1
Drawing No.	C1311	Issue
Project No.	14-193	A