

- LEVEL 4**
- \* Revised Landscape Design throughout
  - \* Car park layout revised to a split level arrangement
  - \* Car park repositioned and extended towards Showground Road
  - \* Decrease in number of cars from 172 to 166
  - 3 Reduced number of lifts to car park Entry Hub
  - 4 Side setbacks introduced to car park to allow for natural ventilation

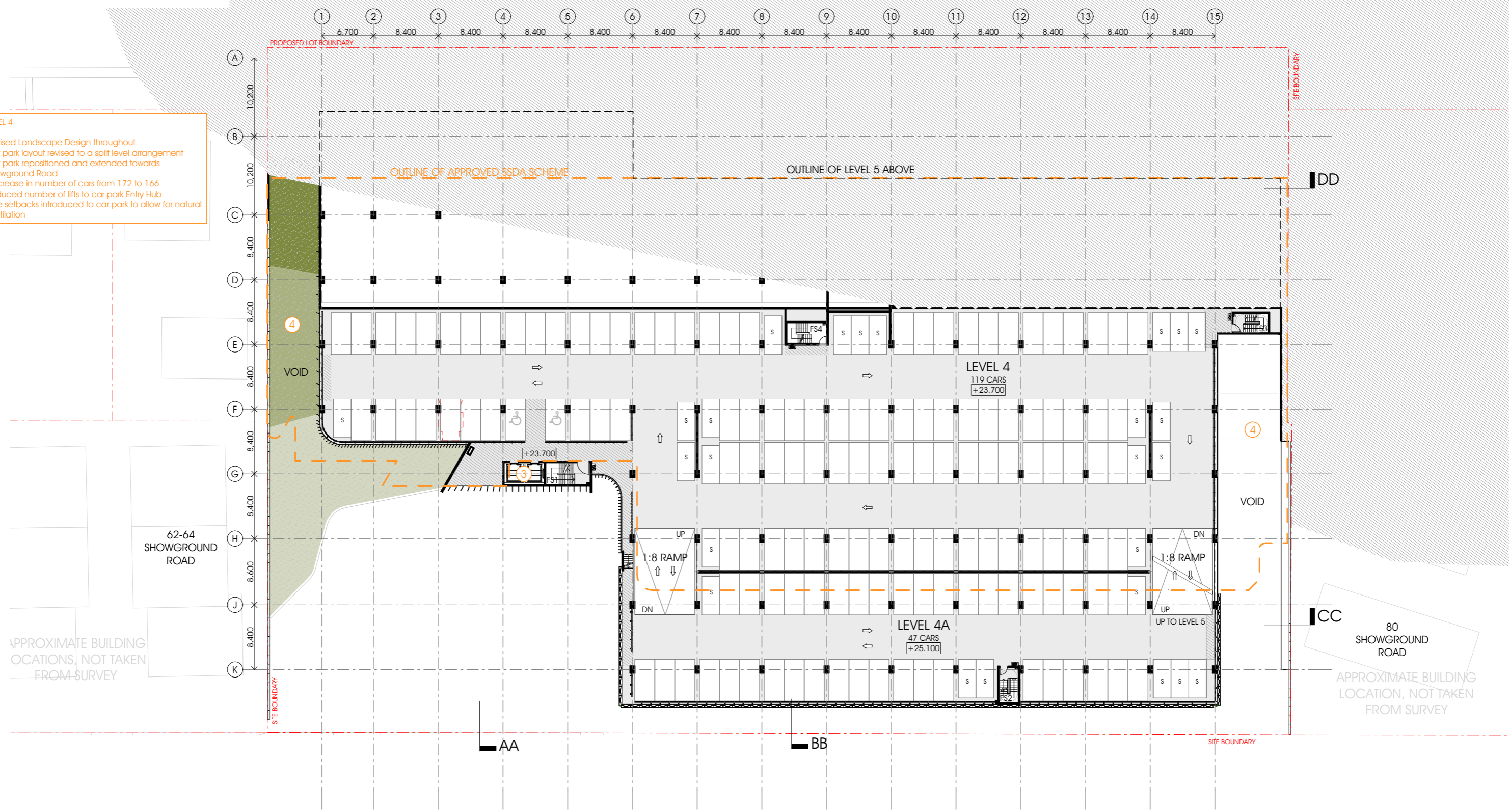

1:500 @ A3  
 0 5m 10m 20m

Gosford Hospital Redevelopment

Section 96 Submission

This drawing is issued upon the condition it is not copied, reproduced, retained or disclosed to any unauthorised person either wholly or in part without prior consent in writing of fitzpatrick+partners.  
 Do not scale drawings. Check dimensions before commencing work.

Drawings show design intent only. Shop drawings are to be provided for approval prior to construction or manufacture. Inconsistencies are to be reported to fitzpatrick + partners.



PROJECT NORTH  
 SCALE @ A3  
 1:500  
 PRINT DATE  
 20/07/2016

fitzpatrick+partners  
 © Copyright 2016  
 PJ + 61 2 8274 8200 WJ www.fitzpatrickpartners.com

DRAWING  
 LEVEL 4

PROJECT NO. 21516	DRAWING NO. DA-09	ISSUE A
----------------------	----------------------	------------