



Consulting.TM
an Elephants Foot Company

Stage 1
106 and 120-122 Smith Street and 3A Charlotte Street,
Wollongong NSW 2500
Mixed Use Development

OPERATIONAL WASTE MANAGEMENT PLAN

28/11/2025
Report No. 4239
Revision H

Client

The Smith Street Development Partnership

Suite 110, Level 1, 180-186 Burwood Road, Burwood NSW 2134

www.urbanpropertygroup.com.au

T 02 9744 3333 • E reception@urbanpropertygroup.com.au

Architect

Teams 2 Architects



REVISION REFERENCE

Revision	Date	Prepared by	Description
A	03/08/2023	D Trinder	Draft
B	16/08/2023	D Trinder	Amendment
C	16/10/2023	D Trinder	Final
D	26/10/2023	D Trinder	Updated Plans
E	26/03/2024	D Trinder	SEARs Update
F	05/04/2024	M. Cuevas	Updated Plans
G	20/11/2024	M. Cuevas	RFI
H	28/11/2025	M. Cuevas	S 4.55

The information contained in this document produced by Elephants Foot Consulting (EFC) is solely for the use of the client identified on the cover sheet for the purpose for which it has been prepared for. EFC undertakes no duty, nor accepts any responsibility for any third party who may rely upon this document. Reproduction, publication or distribution of this document without written permission from EFC is strictly prohibited.

TABLE OF CONTENTS

REVISION REFERENCE	ii
TABLE OF FIGURES	iv
LIST OF TABLES.....	iv
GLOSSARY OF ABBREVIATIONS AND TERMS	i
1.0 ACKNOWLEDGEMENT OF COUNTRY	3
2.0 INTRODUCTION.....	3
2.1 SCOPE OF REPORT	3
2.2 REPORT CONDITIONS	4
3.0 LEGISLATION & GUIDANCE.....	5
3.1 COUNCIL OBJECTIVES	5
4.0 DEVELOPMENT OVERVIEW.....	6
4.1 SITE LOCATION.....	6
5.0 RESIDENTIAL WASTE MANAGEMENT	8
5.1 RESIDENTIAL WASTE GENERATION ESTIMATES.....	8
5.2 RESIDENTIAL BIN SUMMARY	8
5.3 RESIDENTIAL WASTE DISPOSAL PROCEDURES.....	9
5.3.1 RESIDENTIAL GENERAL WASTE AND RECYCLING DISPOSAL PROCEDURES.....	9
5.3.2 RESIDENTIAL FOGO DISPOSAL PROCEDURES	9
5.4 residential WASTE COLLECTION PROCEDURES	10
5.5 OTHER RESIDENTIAL WASTE MANAGEMENT CONSIDERATIONS	10
5.5.1 RESIDENTIAL COMMON AREAS.....	10
5.5.2 LANDSCAPED AREAS AND GARDEN ORGANICS.....	10
5.6 BULKY WASTE PROCEDURES.....	11
6.0 COMMERCIAL WASTE MANAGEMENT	12
6.1 COMMERCIAL WASTE GENERATION ESTIMATES.....	12
6.2 BIN SUMMARY	12
6.3 COMMERCIAL WASTE DISPOSAL PROCEDURES.....	13
6.4 COMMERCIAL WASTE COLLECTION PROCEDURES.....	13
6.5 OTHER WASTE MANAGEMENT CONSIDERATIONS	14
6.5.1 KITCHEN, OFFICE TEA ROOMS AND FOOD PREPARATION AREAS.....	14
6.5.2 BATHROOMS	14
6.5.3 PRINTING & PHOTOCOPYING ROOMS	14
6.5.4 LIQUID WASTE	14
6.5.5 PROBLEM WASTE.....	14
7.0 STAKEHOLDER ROLES & RESPONSIBILITIES	15
8.0 SOURCE SEPARATION.....	16
9.0 EDUCATION	17

9.1	SIGNAGE.....	17
9.2	POLLUTION PREVENTION.....	18
10.0	EQUIPMENT SUMMARY	19
11.0	WASTE ROOMS	19
12.0	BIN MOVEMENTS	22
13.0	CONSTRUCTION REQUIREMENTS.....	23
12.1	ADDITIONAL CONSIDERATIONS	23
13.0	USEFUL CONTACTS.....	24
APPENDIX A:	ARCHITECTURAL PLANS.....	25
APPENDIX: A.1	GROUND FLOOR PLAN.....	26
APPENDIX B:	INSTALLATION EQUIPMENT	27
APPENDIX: B.1	TYPICAL SINGLE CHUTE SHAFT & PENETRATION LAYOUT	28
APPENDIX: B.2	EXAMPLE RESIDENTIAL LEVEL RECYCLING BIN LAYOUT	29
APPENDIX: B.3	TYPICAL LINEAR TRACK SYSTEM FOR 1100L MGBS	30
APPENDIX: B.4	CEILING-MOUNTED COMPACTOR	32
APPENDIX C:	PRIMARY WASTE MANAGEMENT PROVISIONS.....	33
APPENDIX: C.1	TYPICAL BIN SPECIFICATIONS.....	34
APPENDIX: C.2	SIGNAGE FOR WASTE AND RECYCLING BINS.....	35
APPENDIX: C.3	TYPICAL COLLECTION VEHICLE INFORMATION.....	37
APPENDIX: C.4	EXAMPLE BIN MOVER.....	39
APPENDIX: C.5	EXAMPLE SEATED BIN MOVERS	40
APPENDIX: C.6	EXAMPLE BIN LIFTER FOR 240L BINS.....	42
APPENDIX D:	SECONDARY WASTE MANAGEMENT PROVISIONS.....	43
APPENDIX: D.1	EXAMPLE APARTMENT STYLE COMPOST BIN	44
APPENDIX: D.2	TYPICAL SOURCE SEPARATION BINS	45

TABLE OF FIGURES

Figure 1: Indicative site boundary and surrounding context	6
Figure 2: Project Area Map.....	7

LIST OF TABLES

Table 1: Estimated Waste and Recycling Volumes – Block 1 East	7
Table 2: Estimated Waste, Recycling and FOGO Volumes	8
Table 3: Estimated Waste and Recycling Volumes – Commercial.....	12
Table 4: Stakeholder Roles and Responsibilities	15
Table 5: Operational Waste Streams.....	16
Table 6: Equipment Summary.....	19
Table 7: Waste Room Areas.....	19
Table 8: Waste Room Requirements.....	21

GLOSSARY OF ABBREVIATIONS AND TERMS

TERM	DESCRIPTION
<i>Baler</i>	A device that compresses waste into a mould to form bales which may be self-supporting or retained in shape by strapping
<i>Bin-carting Route</i>	Travel route for transferring bins from the storage area to a nominated collection point
<i>Chute</i>	A ventilated, vertical pipe passing from floor to floor of a building with openings as required to connect with hoppers and normally terminating at its lower end at the roof of the central waste room(s)
<i>Chute Discharge</i>	The point at which refuse exits from the refuse chute
<i>Chute Discharge Room</i>	A secure, enclosed area or room housing the discharge and associated equipment for the refuse chute
<i>Collection Area/Point</i>	The identified position or area where general waste or recyclables are loaded onto the collection vehicle
<i>Compactor</i>	A machine for compressing waste into disposable or reusable containers
<i>Composter</i>	A container/machine used for composting specific food scraps
<i>Crate</i>	A plastic box used for the collection of recyclable materials
<i>DA</i>	Development Application
<i>DCP</i>	Development Control Plan
<i>EPA</i>	Environmental Protection Authority
<i>HRV</i>	Heavy Rigid Vehicle described by AS 2890.2-2002 Parking facilities – Off-street commercial vehicle facilities
<i>L</i>	Litre(s)
<i>LEP</i>	Local Environmental Plans guide planning decisions for local government areas
<i>Liquid Waste</i>	Non-hazardous liquid waste generated by commercial premises that must be connected to sewer or collected for treatment and disposal by a liquid waste contractor (including grease trap waste)
<i>Mixed Use Development</i>	A development comprised of two or more different uses
<i>MUD</i>	Multi-Unit Dwellings comprise of a development with more than one dwelling. This ranges from dual occupancies and attached dwellings to high-rise residential developments
<i>Mobile Garbage Bin(s) (MGB)</i>	A waste container generally constructed of plastic with wheels with a capacity in litres of 120, 240, 360, 660, 1000 or 1100
<i>MRV</i>	Medium Rigid Vehicle described by AS 2890.2-2002 Parking facilities – Off-street commercial vehicle facilities

<i>Onsite Collection</i>	When the collection vehicle enters the property and services the development within the property boundary from a designated loading area
<i>Owners Corporation</i>	An organisation or group of persons that is identified by a particular name and acts, or may act, as an entity
<i>Service Bins</i>	Bin set side to be placed under a chute while the remainder of the bins are being collected
<i>SRV</i>	Small Rigid Vehicle described by AS 2890.2-2002 Parking facilities – Off-street commercial vehicle facilities
<i>WHS</i>	Workplace Health and Safety
<i>Wheel-in wheel-out service</i>	A type of waste collection service offered by local councils where the council waste collection personnel enter the premises to collect the bins and returns them to the property

1.0 ACKNOWLEDGEMENT OF COUNTRY

We acknowledge Australia's First Nations People as the Traditional Custodians of this land. We pay respect to ancestors and Elders, past and present. We honour Aboriginal and Torres Strait Islander people and their connection to land, waters and seas, and their vital contribution to the vibrant nation that we share, Australia.

2.0 INTRODUCTION

Elephants Foot Consulting (EFC) has been engaged to prepare the following waste management plan to accompany a State Significant Development Application (SSDA) for an In-fill Affordable Housing Development for the site located at 106 and 120-122 Smith Street, and 3A Charlotte Street Wollongong NSW 2500.

Waste management strategies and audits are required for new developments in order to support the design and sustainable performance of the building. It is EFC's belief that a successful waste management strategy contains three key objectives:

- i. **Promote responsible source separation** to reduce the amount of waste that goes to landfill by implementing convenient and efficient waste management systems.
- ii. **Ensure adequate waste provisions and robust procedures** that will cater for potential changes during the operational phase of the development.
- iii. **Comply** with all relevant council codes, policies, and guidelines.

To achieve these objectives, this operational waste management plan (OWMP) identifies the different waste streams likely to be generated during the operational phase of the development, as well as how the waste will be handled and disposed, details of bin sizes/quantities and waste rooms, descriptions of the proposed waste management equipment used, and information on waste collection points and frequencies.

It is essential that this OWMP is integrated into the overall management of the building and is clearly communicated to all relevant stakeholders.

2.1 SCOPE OF REPORT

This operational waste management plan (OWMP) only applies to the **operational** phase of the proposed development; therefore, the requirements outlined in this OWMP must be implemented during the operational phase of the site and may be subject to review upon further expansion of, and/or changes to the development.

The waste management of the **construction** and **demolition** phases of the development are not addressed in this report. A construction and demolition WMP will need to be provided separately. EFC can supply this if required.

2.2 REPORT CONDITIONS

The purpose of this report is to document an OWMP as part of a development application, which is supplied by EFC with the following limitations:

- Drawings, estimates and information contained in this OWMP have been prepared by analysing the information, plans and documents supplied by the client and third parties including Council and other government agencies. The assumptions based on the information contained in the OWMP is outside the control of EFC,
- The figures presented in the report are an estimate only – the actual amount of waste generated will be dependent on the occupancy rate of the building/s and waste generation intensity as well as the building management's approach to educating residents and tenants regarding waste management operations and responsibilities,
- The building manager will adjust waste management operations as required based on actual waste volumes (e.g. if waste is greater than estimated) and increase the number of bins and collections accordingly,
- The report will not be used to determine or forecast operational costs or prepare any feasibility study or to document any safety or operational procedures,
- The report has been prepared with all due care; however no assurance is made that the OWMP reflects the actual outcome of the proposed waste facilities, services, and operations, and EFC will not be liable for plans or results that are not suitable for purpose due to incorrect or unsuitable information or otherwise,
- EFC offer no warranty or representation of accuracy or reliability of the OWMP unless specifically stated,
- Any manual handling equipment recommended in this OWMP should be provided at the recommendation of the appropriate equipment provider who will assess the correct equipment for supply,
- Design of waste management chute equipment and systems must be approved by the supplier,
- EFC cannot be held accountable for late changes to the design after the OWMP has been submitted to Council,
- EFC will provide specifications and recommendations on bin access and travel paths within the OWMP, however it is the architect's responsibility to ensure the architectural drawings meet these provisions,
- EFC are not required to provide information on collection vehicle swept paths, head heights, internal manoeuvring or loading requirements. It is assumed this information will be provided by a traffic consultant,
- Council are subject to changing waste and recycling policies and requirements at their own discretion.

This OWMP is only finalised once the Draft Watermark has been removed. If the Draft Watermark is present, the information in the OWMP is not confirmed.

3.0 LEGISLATION & GUIDANCE

Waste management and resource recovery regulation in Australia is administered by the Australian Constitution, Commonwealth laws, and international agreements. State and territory governments maintain primary responsibility for controlling development and regulating waste. The following legislation has been enacted in New South Wales, and provides the lawful underpinnings of this OWMP.

- NSW Environmental Planning & Assessment Act 1979
- NSW Protection of the Environment Operations Act 1997
- NSW Waste Avoidance & Resource Recovery Act 2001

At the local level, councils or Local Government Areas (LGAs) require OWMPs to be included in new development applications. This OWMP is specifically required by:

- Wollongong Development Control Plan 2009
- Wollongong LEP 2009

The primary purpose of a development control plan (DCP) is to guide development according to the aims of the corresponding local environmental plan (LEP). The DCP must be read in conjunction with the provisions of the relevant LEP.

Information provided in this OWMP comes from a wide range of waste management guidance at the local, state, and federal levels. The primary sources of guidance include:

- Wollongong Development Control Plan 2009
- Wollongong Waste & Resource Recovery Strategy 2022
- NSW Better Practice Guidelines for Waste Management and Recycling in Commercial and Industrial Facilities 2012
- NSW Better practice guide for resource recovery in residential developments 2019
- NSW Waste Avoidance and Resource Recovery (WARR) Strategy 2014-2021
- NSW Waste Classification Guidelines 2014
- Australia's National Waste Policy 2018

3.1 COUNCIL OBJECTIVES

Wollongong City Council considers waste management to be highly important for the protection and enhancement of both the natural and built environments. As such, Council aims to:

- Encourage development which facilitates waste minimisation and complements waste services offered by Council or private contractors.
- Reduce the demand for waste disposal.
- Maximise reuse and recycling of building materials and household, industrial and commercial waste.
- Provide appropriately located, sized and accessible waste storage facilities.
- Ensure waste management systems are compatible with collection services.
- Support the principles of Ecologically Sustainable Development (ESD).
- Avoid illegal dumping of waste.

4.0 DEVELOPMENT OVERVIEW

The proposed development falls under the LGA of Wollongong City Council, and consists of:

- One (1) building of two towers with up to 12 levels
 - 176 residential units in total
 - separated into four cores
 - Three (3) commercial tenancies with a total GFA of 601.9 m²

All figures and calculations are based on area schedules as advised by our client and shown on architectural drawings.

4.1 SITE LOCATION

The site is legally described as Lots 1,2 DP 153352 Lot 500 DP 1056709 Lot 2412 DP 1097900 Lot 300 DP 1239092, Lot 253 DP 787299, Lot 211 DP 1011740, Lot 2411 DP 1097900 & Lot 253 DP 787299, 106 and 120-122 Smith Street and 3A Charlotte Street WOLLONGONG NSW 2500.

The site forms part of the Wollongong City Centre Precinct, as identified in the Wollongong Local Environmental Plan 2009 (WLEP). It is near existing services, being approximately 500m north-west of Wollongong Central Shopping Centre and approximately 800m north of the Wollongong Railway Station. The site also has ample access to public open space, being approximately 200m southeast of Beaton Park and approximately 1.1km from the beachfront.

The site comprises a significant land holding with street frontages to Smith Street and Charlotte Street. The site's area is 5,565m².

Figure 1: Indicative site boundary and surrounding context



The western portion of the site is subject to a future development application and no physical works on this land are proposed as part of this application. On this basis, the development area only comprises land in which physical works are proposed, which has a total area of 5,565m². **Figure 2** below illustrates the project area relative to the overall site area.

Figure 2: Project Area Map

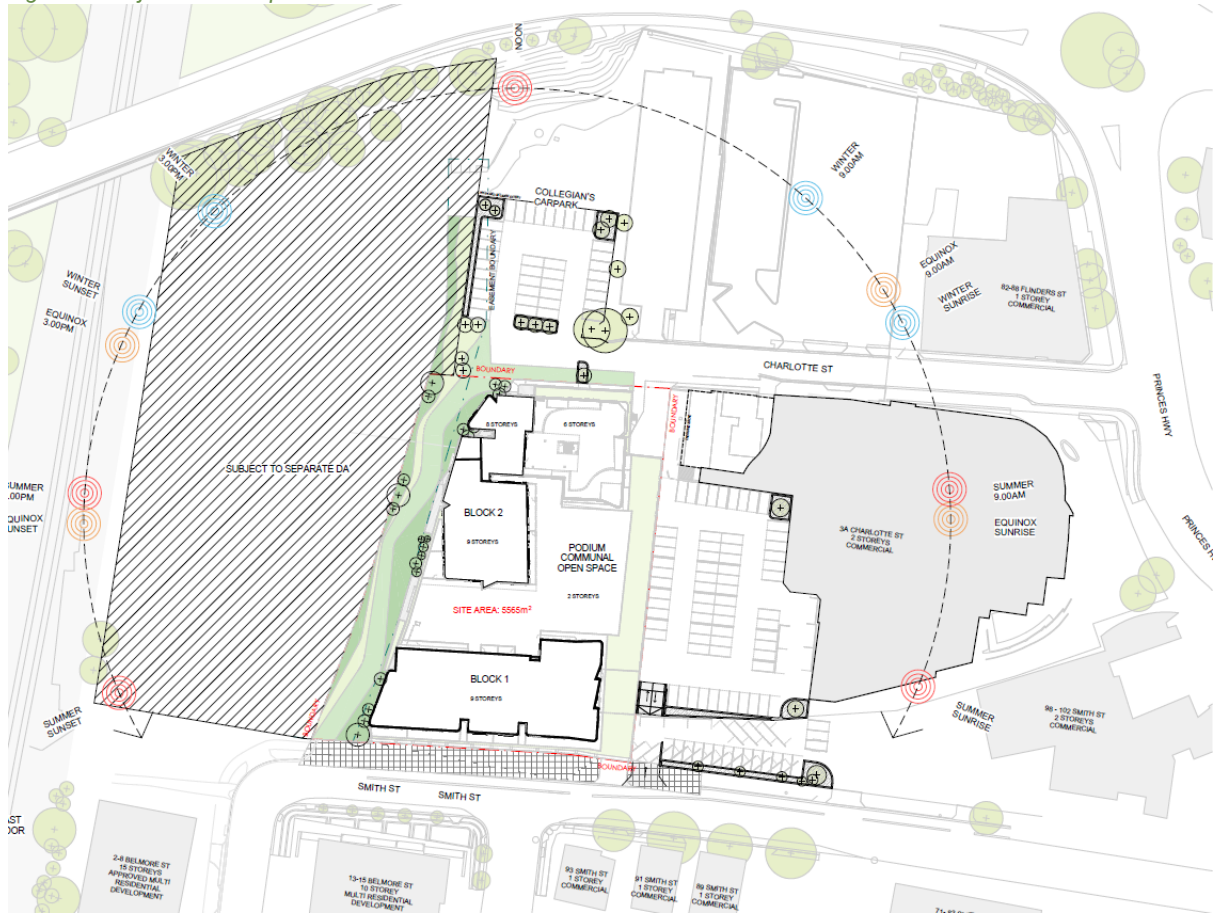

This report has been prepared in response to the Secretary's Environmental Assessment Requirements (SEARS) dated 19 March 2024 for SSD-67895459. Specifically, this report has been prepared to respond to those SEARS summarised in **Table 1**.

Table 1: Estimated Waste and Recycling Volumes – Block 1 East

Item	Description of Requirement	Section Reference (this report)
19. Waste Management		
	Identify, quantify, and classify the likely waste streams to be generated during construction and operation.	5.1, 6.1
	Provide the measures to be implemented to manage, reuse, recycle and safely dispose of this waste.	5.3, 5.4, 5.5, 6.3, 6.4, 6.5, 7, 8, 9
	Identify appropriate servicing arrangements for the site.	5.4, 6.4

5.0 RESIDENTIAL WASTE MANAGEMENT

The following section outlines best practice waste management for the residential component of the development, including waste generation estimates and waste disposal and collection procedures.

5.1 RESIDENTIAL WASTE GENERATION ESTIMATES

Wollongong Council has provided the following rates to calculate the total number of bins required for the residential units. Calculations are based on generic waste, recycling, and FOGO rates.

The following table shows the estimated volume (L) of general waste, recyclables and FOGO generated by the residential component of the development.

Table 2: Estimated Waste, Recycling and FOGO Volumes

Core	# Units	General Waste Generation Rate (L/unit/week)	Generated General Waste (L/week)	Compacted General Waste (2:1) (L/week)	Recycling Generation Rate (L/unit/week)	Generated Recycling (L/week)	FOGO Generation Rate (L/unit/week)	Generated FOGO (L/week)
Core 1	36	120	4320	2160	120	4320	40	1440
Core 2	35	120	4200	2100	120	4200	40	1400
Core 3	71	120	8520	4260	120	8520	40	2840
Core 4	34	120	4080	2040	120	4080	40	1360
TOTAL	176		21120	10560		21120		7040
Bins and Collections		Bin Size (L)	1100	1100	Bin Size (L)	1100	Bin Size (L)	240
		Bins/Week	19	10	Bins/Week	19.20	Bins/Week	29.33
		Collections/Week	1	1	Collections/Week	0.5	Collections/Week	1
		Bins for Collection	20	10	Bins for Collection	39	Bins for Collection	30

*Note: An additional 1100L MGB should be provided for each chute discharge for use during collection periods. These bins are not included in the above figures.

**Note: It is strongly recommended bins/equipment at the base of each chute allow for 2-days' worth of waste or recycling generation.

5.2 RESIDENTIAL BIN SUMMARY

Based on the estimated volumes of general waste, recycling and FOGO generated by the residential component of this development, the recommended bin quantities and collection frequencies are as follows:

General Waste: 10 x 1100L bins collected **weekly**

Recycling: 39 x 1100L bins collected **fortnightly**

FOGO: 30 x 240L bins collected **weekly**

Service Bins: 3 x 1100L bin

During operation, it is the responsibility of the building manager to monitor the number of bins required for the residential component. Waste and recycling volumes may change according to residents' attitudes to waste disposal and recycling, building occupancy levels or development's management.

Any requirements for adjusting the capacity of the waste facilities can be achieved by changing the number of bins, the bin sizes or collection frequencies. Building management

will be required to negotiate any changes to bins or collections with the collection service provider.

5.3 RESIDENTIAL WASTE DISPOSAL PROCEDURES

All units will be provided with a storage area capable of holding separate receptacles for general waste, recycling and FOGO. This is typically located within kitchen areas beneath the workbench. This space should be sized to accommodate 40L receptacles (minimum) to account for 2 days' worth of general waste, recycling and 20L for FOGO storage.

5.3.1 RESIDENTIAL GENERAL WASTE AND RECYCLING DISPOSAL PROCEDURES

4 x single waste chutes will be installed with access on each residential level of each core. Residents will wrap or bag their general waste before placing in the chute. Bagged waste should not exceed 3kg in weight, or 35cm x 35cm x 35cm.

The general waste will discharge from the chute into 1100L MGBs in the residential waste rooms located on the ground level (see APPENDIX A.1). General waste will be compacted.

A separate cupboard for the storage of 240L MGBs will be provided next to each waste chute for the storage of commingled recyclables. Residents will be responsible for loosely placing their recyclables into the 240L MGBs. Recyclables must not be bagged.

Refer to Council guidance for the types of materials accepted in the general waste and recycling streams.

5.3.2 RESIDENTIAL FOGO DISPOSAL PROCEDURES

The majority of organics waste generated from multi-unit residential developments comprises of food waste as opposed to garden waste. As such, calculations and management recommendations provided in this report considers that FOGO bins will primarily comprise of food organics.

The residents of each unit will be provided with a kitchen caddy for the separation of FOGO. Caddies and liners should be no more than 250mm x 250mm x 250mm (H x W x D) in size to comply with the chute access point.

Food organics must be contained in accordance with Wollongong Council's future FOGO collection service procedures (for example a compostable liner). Any clippings from vegetation in residential units can also be disposed of with the FOGO.

In addition to the general waste chute and the 240L MGB recycling bin, a 240L MGB will be provided on each level of each building, with access for all residents on each residential level. Residents will be responsible for walking their FOGO to their allocated disposal point and placing it in the FOGO bins.

FOGO bins will be transported by the building caretaker to the bin holding area/collection area located on the ground level for collection.

5.4 RESIDENTIAL WASTE COLLECTION PROCEDURES

Council will be engaged to collect the residential waste and recycling in accordance with Council's collection schedule. This report assumes waste and FOGO will be collected weekly and recycling fortnightly.

On the nominated waste collection day, the building caretaker will be responsible for transporting the 1100L MGBs from the chute discharge rooms with the aid of a bin tug to the bin holding room/waste collection room located on the ground level (see APPENDIX A.1). It is recommended that extra 1100L service bins are placed under the chutes to collect discharge while the other bins are being serviced.

On the nominated recycling collection day, the building caretaker will be responsible for transporting the 240L recycling MGBs from each residential level to the bin holding/waste collection room located on the ground level and decant them into the 1100L MGBs (see APPENDIX A.1).

To service the bins, a Council collection vehicle will enter the site from Charlotte Street and park in the loading bay (see APPENDIX A.1). The building caretaker will provide the driver with access to the waste collection room. Once the bins are serviced, the collection vehicle will exit the site onto Charlotte Street in a forward direction.

All access and clearances to the waste collection room must be able to accommodate a 10.24m long HRV.

It is the responsibility of the caretaker to ensure that the loading area is clear of any vehicles or obstructions prior to waste collection. When waste collection is complete, the building caretaker will return the bins to resume operational use.

5.5 OTHER RESIDENTIAL WASTE MANAGEMENT CONSIDERATIONS

The following sections outline other waste management considerations for the residential components.

5.5.1 RESIDENTIAL COMMON AREAS

Residential common areas will be supplied with suitably branded source separation receptacles where considered appropriate. Receptacles should be placed in convenient locations which are accessible to all residents. The building manager will monitor the capacity of these receptacles and empty the contents into the central collection bins as required.

5.5.2 LANDSCAPED AREAS AND GARDEN ORGANICS

Garden organics generated from surrounding landscaped areas and indoor foliage typically consists of lawn clippings, cuttings, leaves and branches.

Garden organics generated from surrounding landscaped areas will be managed and removed from the site by the designated landscaping contractors as they carry out scheduled landscaping maintenance works.

5.6 BULKY WASTE PROCEDURES

An area will be made available for the storage of discarded residential bulky items (e.g., white goods, furniture, etc.). An interim and a central bulky waste room are allocated within the site, with a minimum doorway width of 1.5m to allow for easy movement of large waste items in and out of the rooms.

Residents will need to liaise with building management regarding the transportation of bulky items and the availability of the bulky waste room on the Ground Floor (see APPENDIX A.1). The caretaker is responsible for moving the bulky waste items from the interim room to the central bulky waste room, arranging collection dates with the Council, and then coordinating with the residents.

On the day of bulky waste collection, a Council collection vehicle will enter the site from Charlotte Street and park in the loading bay. The building caretaker will provide the driver with access to the central bulky waste room. Once bulky items have been loaded, the collection vehicle will exit the site onto Charlotte Street in a forward direction.

Refer to Council's website for acceptable items and other information regarding bulky waste collection.

6.0 COMMERCIAL WASTE MANAGEMENT

The following section outlines best practice waste management for the commercial components of the development, including waste generation estimates and waste disposal and collection procedures.

6.1 COMMERCIAL WASTE GENERATION ESTIMATES

Wollongong Development Control Plan 2009 Chapter E07 Waste Management has been referenced to calculate the total number of bins required for the anticipated tenants. Calculations are based on generic figures, and waste generation rates may differ according to the tenants' actual waste management practice.

The following table shows the estimated volume (L) of general waste and recyclables that will be generated by the commercial tenants. Estimates are based on a five-day operating week.

Table 3: Estimated Waste and Recycling Volumes – Commercial

Tenancy	Generation Rate Type	NLA (m ²)	General Waste Generation Rates (L/100m ² /day)	Generated Garbage (L/week)	Recycling Generation Rate (L/100m ² /day)	Generated Recycling (L/week)	
Commercial	Offices	64.6	10	45.22	10	45.22	
Commercial	Offices	42.7	10	29.89	10	29.89	
Commercial	Offices	319.7	10	223.79	10	223.79	
Commercial	Offices	174.9	10	122.43	10	122.43	
	TOTAL	601.9		421.33		421.33	
Equipment and Collections		General Waste Bin Size (L)		240	Recycling Bin Size (L)		240
		General Waste Bins Per Week		2	Recycling Bins Per Week		2
		General Waste Collections per Week		1	Recycling Collections per Week		1

6.2 BIN SUMMARY

Based on the estimated waste generated by the commercial tenancies, the recommended bin quantities and collection frequencies are as follows:

General Waste: 2 x 240L MGBs collected **1 x weekly**

Recycling: 2 x 240L MGBs collected **1 x weekly**

Bin sizes, quantities, and/or collection frequencies may be modified by the building manager once the proposed development is operational. Building management will be required to negotiate any changes to bins or collections with the collection service provider. Seasonal peak periods such as public and school holidays should also be considered.

6.3 COMMERCIAL WASTE DISPOSAL PROCEDURES

For commercial offices, on completion of each trading day or as required, nominated staff or contracted cleaners will transport all general waste and recyclables to the commercial waste room and place into the appropriate collection bins (see APPENDIX A.1). Waste will not be compacted, and recyclables are not baled.

Small office / home office (SOHO) tenants will be responsible for their own waste within the designated commercial area of the apartment. Tenants should separate waste and recycling using small bins within the commercial space suitable for at least one day's storage.

All waste and recycling should be disposed of in the appropriate bins located in the commercial waste room located on Ground level.

Where a tenant chooses to engage or utilise a cleaner, it is recommended they coordinate with the building manager/caretaker to ensure consistent and safe use of the facilities.

Tenants should also be encouraged to engage an office paper recycler to further reduce waste output.

Please note that all collection receptacles and bins should be branded with the appropriate stickers and the Mobius loop or similar used to identify recycling equipment.

6.4 COMMERCIAL WASTE COLLECTION PROCEDURES

A private waste collection contractor will be engaged to service the commercial waste and recycling bins per an agreed schedule. This report assumes waste and recycling is collected weekly.

On the day of service, a private waste collection vehicle will enter the site from Charlotte Street and park in the loading bay. The building caretaker will provide the driver with access to the commercial waste room. Once the bins are serviced, the collection vehicle will exit the site onto Charlotte Street in a forward direction.

Please note that the collection of commercial bins should occur on separate days from the collection of residential bins to ensure proper segregation of waste streams.

6.5 OTHER WASTE MANAGEMENT CONSIDERATIONS

Based on the types of tenancies anticipated for this development, the following waste management practices are recommended.

6.5.1 KITCHEN, OFFICE TEA ROOMS AND FOOD PREPARATION AREAS

Any food preparation area, including kitchens and office tea rooms will be provided with dedicated source separation bins including a general waste bin and a recycling bin. Cleaners or nominated staff will be responsible for monitoring these bins and emptying them as required.

6.5.2 BATHROOMS

Washroom facilities should be supplied with collection bins for paper towels (if used). Sanitary bins for female restroom facilities must also be arranged with an appropriate contractor.

6.5.3 PRINTING & PHOTOCOPYING ROOMS

It is recommended that printing rooms and photocopying rooms are supplied with bins for the collection of paper, as well as separate receptacles for ink toner cartridges for recycling. The cleaners or nominated staff are responsible for monitoring these bins and ensuring the items are collected and recycled by an appropriate contractor.

6.5.4 LIQUID WASTE

Liquid wastes such cleaning products, chemicals, paints, etc., will be stored in a secure space that is bunded and drained to a grease trap in accordance with State government authorities and legislation.

6.5.5 PROBLEM WASTE

The building manager is responsible for making arrangements for the disposal and recycling of problem waste streams with an appropriate contractor. Problem wastes cannot be placed in general waste as they can have adverse impacts to human health and the environment if disposed of in landfill. Retail and Commercial tenants will need to liaise with the building manager when disposing of problem waste streams.

Problem waste streams include:

- Chemical Waste
- Liquid wastes
- Toner cartridges
- Lightbulbs
- eWaste
- Batteries

7.0 STAKEHOLDER ROLES & RESPONSIBILITIES

The following table demonstrates the primary roles and responsibilities of the respective stakeholders:

Table 4: Stakeholder Roles and Responsibilities

Roles	Responsibilities
Strata, Body Corporate or Management	<ul style="list-style-type: none"> • Ensure all waste service providers submit monthly reports on all equipment movements and waste quantities/weights; • Organise internal waste audits/visual assessments on a regular basis • Purchase any on-going waste management equipment or maintenance of equipment once building is operational; and • Manage any non-compliances/complaints reported through waste audits.
Building Manager or Waste Caretaker	<ul style="list-style-type: none"> • Maintain and clean chute doors on each level; • Coordinate general waste and recycling collections; • Clean and transport bins as required; • Organise replacement or maintenance requirements for bins; • Organise, maintain and clean the waste holding area; • Organise bulky goods collection when required • Investigate and ensure prompt clean-up of illegally dumped waste materials. • Prevent storm water pollution by taking necessary precautions (secure bin rooms, prevent overfilling of bins) • Abide by all relevant WH&S legislation, regulations, and guidelines; • Provide staff/contractors with equipment manuals, training, health and safety procedures, risk assessments, and PPE to control hazards associated with all waste management; • Assess any manual handling risks and prepare a manual handling control plan for waste and bin transfers; • Ensure site safety for residents, children, visitors, staff and contractors; and • Ensure effective signage, communication and education is provided to occupants, tenants, maintenance staff, and cleaning contractors.
Residents	<ul style="list-style-type: none"> • Dispose of all general waste and recycling in the allocated waste chutes and/or MGBs provided; • Ensure adequate separation of general waste and recycling; and • Comply with the provisions of Council and the OWMP.
Commercial Tenants	<ul style="list-style-type: none"> • Manage the back of house storage of generated waste and recycling during daily operation. • Correctly separate waste and recycling streams; bag general waste and ensure recyclables are not bagged. • Flatten cardboard within the recycling bin. • If required, arrange for storing used and unused cooking oil in a bunded area, • Organise grease interceptor trap servicing, • Ensure dry basket arrestors are provided to the floor wastes in the food preparation, and • Ensure the suitable storage for chemicals, pesticides and cleaning products waste back of house.
Waste Collection Contractor	<ul style="list-style-type: none"> • Provide a reliable and appropriate waste collection service; • Provide feedback to building managers/residents regarding contamination of recyclables; and • Work with building managers to customise waste systems where possible.
Gardening/Landscaping Contractor	<ul style="list-style-type: none"> • Remove all garden organic waste generated during gardening maintenance activities for recycling at an offsite location.
Developer	<ul style="list-style-type: none"> • Purchase all equipment required to implement this OWMP prior to the occupation of the building to be provided to the strata or Body Corporate.

8.0 SOURCE SEPARATION

Better practice waste management includes the avoidance, reuse, and recovery of unwanted items, which can be achieved through source separation. The table below outlines what is typically included in various waste streams and how they can be managed. Refer to your local council for a list of accepted materials. Planet Ark can be accessed online to find other facilities that recover unwanted items.

Table 5: Operational Waste Streams

Waste Stream	Description	Typical Destination	Waste Stream Management
General Waste	The remaining portion of the waste stream that is not recovered for reuse, processing, or recycling. May include soft plastics, food scraps, polystyrene, etc.	Landfill	Waste should be bagged before placing in chutes, or in designated waste bins.
Paper and Cardboard Recyclables	Cardboard and paper products are recyclable materials that can be re-processed into new products.	Resource Recovery Centre	Bulky cardboard must not be placed in any chute. Cardboard should be flattened before placing in the designated cardboard bin.
Commingled Recyclables	A mixture of items that are usually segregated through a MRF. Typically include food and beverage containers (e.g. aluminium, glass, steel, hard plastics, cartons).	Materials Recovery Facility (MRF)	Commingled recyclables must not be bagged, and instead should be placed loosely in the designated recycling bins.
Secure Documents	Secure documents are printed paper materials that contain sensitive information.	Recycling Facility	Secure documents are placed in allocated secure document bins. Private contractor removes bins from site.
Green Waste	Unwanted organic materials that are easily biodegradable and/or compostable (e.g. lawn clippings, branches)	Resource Recovery Centre	Landscape Maintenance Contractors will remove the green waste from site during scheduled maintenance.
Food Waste	Unwanted or uneaten kitchen scraps that are easily compostable/ biodegradable (e.g. vegetable peels, fruit rinds, coffee grounds).	Composting facility or Landfill	Food waste can be composted on-site, off-site, or else included in the general waste stream.
Electronic Waste	Discarded e-waste, electronic components and materials such as computers, mobile phones, keyboards, etc.	Resource Recovery Centre	Building manager arranges collection for e-waste recycling as needed by residents. Commercial tenants arrange for recycling of their own e-waste.
Bulky Items	Items that are too large to place into general rubbish collection. This includes disused and/or broken furniture, mattresses, white goods, etc.	Resource Recovery Centre or Landfill	Residents liaise with building manager to store in Bulky Goods Room. Building manager arranges with Council for removal. Commercial tenants are responsible for removal of their bulky items.
Sanitary Waste	Feminine hygiene waste generated from female bathrooms.	Incineration or Landfill	Sanitary bins are serviced by sanitary waste contractor.
Other	Other recyclable items that require special recovery may include ink cartridges, batteries, chemical waste, fluorescent tubes, etc.	Resource Recovery Facility	Building manager arranges collection by appropriate recycling services when required.

9.0 EDUCATION

Educational materials encouraging correct separation of general waste and recyclables must be provided to each resident and commercial tenant. This should include the correct disposal process for bulky waste such as old furniture, large discarded items, and other materials including electronic and chemical wastes. It is recommended that the building caretaker provides information in multiple languages to support correct behaviours, and to minimise the possibility of chute blockages and contamination in communal waste bins.

Education and communication must be provided regularly to encourage behaviour change and account for transient building personnel such as new residents, tenants, or cleaning staff. It is also recommended that the owners' corporation website contain information for residents' referral regarding use of the chute. Information should include:

- Directions on using the chute doors;
- Descriptions of items accepted in the recycling and general waste streams (refer to Council guidance);
- How to dispose of bulky goods and any other items that are not general waste or recycling (refer to Council guidance);
- Residents' obligations to health and safety as well as building management; and
- How to prevent damage or blockages to the chute (example below).

To prevent damage or blockage to rubbish chute DO NOT dispose of any umbrellas, bedding, cigarettes, cartons, coat hangers, brooms, mops, large plastic wrappings from furniture, white goods, any sharp objects, hot liquid or ashes, oil, unwrapped vacuum dust, syringes, paint and solvents, car parts, bike parts, chemicals, corrosive and flammable items, soil, timber, furniture, bricks or other building materials down the chute.

9.1 SIGNAGE

Signage and education are essential to support best practice waste management including resource recovery, source separation, and diversion of waste from landfill.

Signage should include:

- Clear and correctly labelled waste and recycling bins,
- Instructions for separating and disposing of waste items. Different languages should be considered,
- Locations of, and directions to, the waste storage areas with directional signs, arrows, or lines,
- The identification of all hazards or potential dangers associated with the waste facilities, and
- Emergency contact information should there be issues with the waste systems or services in the building.

The building manager is responsible for waste room signage including safety signage. Appropriate signage must be prominently displayed on doors, walls and above all bins, clearly stating what type of waste or recyclables is to be placed in each bin.

All chute doors on all residential levels will be labelled with signs directing chute operations and use of chute door.

All signage should conform to the relevant Australian Standards.

9.2 POLLUTION PREVENTION

Building management shall be responsible for the following to minimise dispersion of site litter and prevent stormwater pollution to avoid impact to the environment and local amenity:

- Promoting adequate waste disposal into the bins
- Securing all bin rooms (whilst affording access to staff/contractors)
- Prevent overfilling of bins, keep all bin lids closed and bungs leak-free
- Taking action to prevent dumping or unauthorised use of waste areas
- Require collection contractor/s to clean up any spillage when clearing bins

10.0 EQUIPMENT SUMMARY

Table 6: Equipment Summary

Part		Qty	Notes
Chutes	Please refer to supplier's information	4	(See APPENDIX B.1 for Typical Single Chute Layout)
Chute Equipment	Ceiling mounted compactor	3	(See APPENDIX B.3 for Typical Ceiling Mounted Compactor)
	2 – Bin linear track system for 1100L bins	1	(See APPENDIX B.3 for Typical Ceiling Mounted Compactor)
Other Equipment	Suitable Bin Moving Equipment	1	(See APPENDIX C.4 for Typical Bin Movers)
	Bin lifter for 240L MGBs	1	(See APPENDIX C.6 for Typical Bin lifters)

11.0 WASTE ROOMS

The areas allocated for waste storage and collection areas are detailed in the table below, and are estimates only. Final areas will depend on room and bin layouts.

Table 7: Waste Room Areas

Level	Waste Room Type	Bins & Equipment	Estimated Area Required (m ²)
G	Chute Discharge Room Core 1	Minimum 1 x 1100L MGBS general waste 1 x 1100L MGBs service bin	8
G	Chute Discharge Room Core 2	Minimum 1 x 1100L MGBS general waste 1 x 1100L MGBs service bin	8
G	Chute Discharge Room Core 3	Minimum 2 -linear track system for 1100L (general waste)	10
G	Chute Discharge Room Core 4	Minimum 1 x 1100L MGBS general waste 1 x 1100L MGBs service bin	8
G	Residential Bin Collection Room	10 x 1100L MGBS general waste 39 x 1100L MGBs recyclables 30 x 240L MGSs FOGO Bin Lifter Bin Mover	159
G	Central Bulky Goods Room		38
G	Interim Bulky Goods Room		
G	Commercial Waste Room	2 x 240L MGBs general waste 2 x 240L MGBs recycling	> 4

EFC recommends bins sizes, collection frequencies and/or equipment for best practice waste management at this site, however EFC also acknowledges there are a range of other suitable options that may alter waste room requirements (e.g. floor area, accessibility, head height, etc.)

The waste room areas have been calculated based on equipment requirements and/or bin dimensions with an additional 50% -70% of bin GFA factored in for manoeuvrability. The residential waste collection room has an additional 60% of bin GFA factored in.

In addition, all doorways and passageways facilitating the movement of bins and/or bulky waste items must be at least 1500mm wide per Council's DCP. The following table provides further waste room requirements.

Table 8: Waste Room Requirements

Waste Room Type	Waste Room Requirements
Chute Discharge Rooms	<ul style="list-style-type: none"> • Ceiling clearance height must be a minimum of 3000mm (subject to penetration location) • The chute penetration must have a minimum 500mm clearance of any service pipes or other overhead obstacles • All waste discharge points should be caged off to ensure the safety of any personnel accessing the waste room • 200mm clearance is required around compaction equipment • Where a chute offset is required, the angle of the offset must not exceed 40 degrees (subject to number of consecutive offset and/or up to 1500mm)
Residential Bin Collection Room	<ul style="list-style-type: none"> • Bins must not be stacked in rows that are more than two bins deep
Bulky Goods Room	<ul style="list-style-type: none"> • May be a dedicated room or screened area within another waste room • Must be in close proximity to the collection area • Area must also be allocated for the segregation of e-waste, gas bottles, cardboard, etc. • Doorway should be a minimum of 1500mm wide
Commercial Waste Room	<ul style="list-style-type: none"> • In order to ensure staff safety, all bins should be arranged so they can be accessed without moving another bin

12.0 BIN MOVEMENTS

The building caretaker is responsible for the transportation of bins as required from their designated operational locations to the bin holding room as required and returning them once emptied to resume operational use.

Transfer of bins should minimise manual handling where possible, as bins become heavy when full. The building manager must assess manual handling risks and provide any relevant documentation to key personal.

The routes along the bin moving path should;

- Allow for a continuous route that is wholly within the property boundary.
- Be free from obstruction and obstacles such as steps and kerbs.
- Be constructed of solid materials with a non-slip surface
- Be A minimum of 300mm wider than the largest bin used onsite.
- If bins are moved manually, the route must not exceed a grade of 1:14.
- If a bin moving device is used, the route cannot exceed the maximum operating grade of the device. This is typically a grade of 1:4, however this will vary depending on the model of bin moving device acquired for the site.

As the distance of the bin moving paths exceed 10m, a bin moving device is required to aid the movement of full bins. The developer is responsible for supplying all equipment required for moving bins this includes any bin lifters, bin moving devices and waste transfer bins. This equipment must be new and appropriate for the site. The developer should contact a bin-tug, trailer or tractor consultant to provide equipment recommendations.

Once the site is operational (and the developers is no longer involved) the building proprietors/strata/body corporate will be responsible for maintaining, repairing and replacing waste management equipment.

Bins may have to be fitted with hitches to enable the simultaneous transportation of multiple bins to the collection area. Council must be informed of any hitch attachments required to be installed on bins.

13.0 CONSTRUCTION REQUIREMENTS

Waste room construction must comply with the minimum standards as outlined in the *Wollongong Development Control Plan 2009*, in order to minimise odours, deter vermin, protect surrounding areas, and make it a user-friendly and safe area.

The *NSW Better practice guide for resource recovery in residential developments (2019)* also states that better practice bin storage areas should achieve more than the minimum compliance requirements, which are as follows:

- Ensuring BCA compliance, including ventilation. Where required, ventilation system must comply with AS1668.4-2012 The use of ventilation and air conditioning in buildings.
- Ensuring storage areas are well lit (sensor lighting preferred) and have lighting available 24 hours a day.
- Provision of bin washing facilities, including taps for hot and cold water provided through a centralised mixing valve. The taps must be protected from bins and be located where they can be easily accessed even when the area is at bin capacity.
- Floor constructed of concrete at least 75mm thick.
- Floor graded so that any water is directed to a sewer authority approved drainage connection to ensure washing bins and/or waste storage areas do not discharge flow into the stormwater drain.
- Provision of smooth, cleanable and durable floor and wall surfaces that extend up the wall to a height equivalent to any bins held in the area.
- Ensuring ceilings are finished with a smooth-faced non-absorbent material capable of being cleaned.
- All surfaces (walls, ceiling and floors) finished in a light colour.

12.1 ADDITIONAL CONSIDERATIONS

- Waste room floor to be sealed with a two-pack epoxy;
- All corners coved and sealed 100mm up, this is to eliminate build-up of dirt;
- Tap height and light switch height of 1.6m;
- Storm water access preventatives (grate);
- All walls painted with light colour and washable paint;
- Equipment electric outlets to be installed 1700mm above finished floor level;
- Optional automatic odour and pest control system installed
- If 660L or 1100L bins are utilised, 2 x 820mm (minimum) double-doors must be used;
- All personnel doors are hinged, lockable and self-closing;
- Conform to the Building Code of Australia, Australian standards and local laws; and
- Childproofing and public/operator safety shall be assessed and ensured
- Waste and recycling rooms must have their own exhaust ventilation system either;
 - Mechanically - exhausting at a rate of 5L/m² floor area, with a minimum rate of 100L/s minimum. Mechanical exhaust systems shall comply with AS1668.4.2012 and not cause any inconvenience, noise or odour problem; or
 - Naturally - permanent, unobstructed, and opening direct to the external air, not less than one-twentieth (1/20) of the floor area.

13.0 USEFUL CONTACTS

EFC does not warrant or make representation for goods or services provided by suppliers.

LOCAL COUNCIL

Wollongong Customer Service Ph: (02) 4227 7111 E: council@wollongong.nsw.gov.au

PRIVATE WASTE COLLECTION PROVIDER

Capital City Waste Services	Ph: 02 9599 9999	E: service@ccws.net.au
Remondis	Ph: 1300 362 360	
Suez Environmental	Ph: 13 13 35	
Wastewise NSW	Ph: 1300 550 408	E: admin@wastewise.com.au

BIN MOVING DEVICE SUPPLIERS

Electrodrive	Ph: 1800 333 002	E: sales@electrodrive.com.au
Sitecraft	Ph: 1300 363 152	E: sales@sitecraft.com.au
Spacepac	Ph: 1300 763 444	

ODOUR CONTROL

EF Neutralizer Ph: 1300 435 374 E: info@elephantsfoot.com.au

SOURCE SPERATION BINS

Source Separation Systems Ph: 1300 739 913 E: info@sourceseparationsystems.com.au

MOBILE GARBAGE BINS, BULK BINS AND BIN EQUIPMENT

SULO	Ph: 1300 364 388	E: sales@sulo.com.au
OTTO Australia	Ph: 02 9153 6999	

CHUTES, COMPACTORS AND EDIVERTER SYSTEMS

Elephants Foot Ph: 1800 025 073 E: info@elephantsfoot.com.au

APPENDIX A: ARCHITECTURAL PLANS

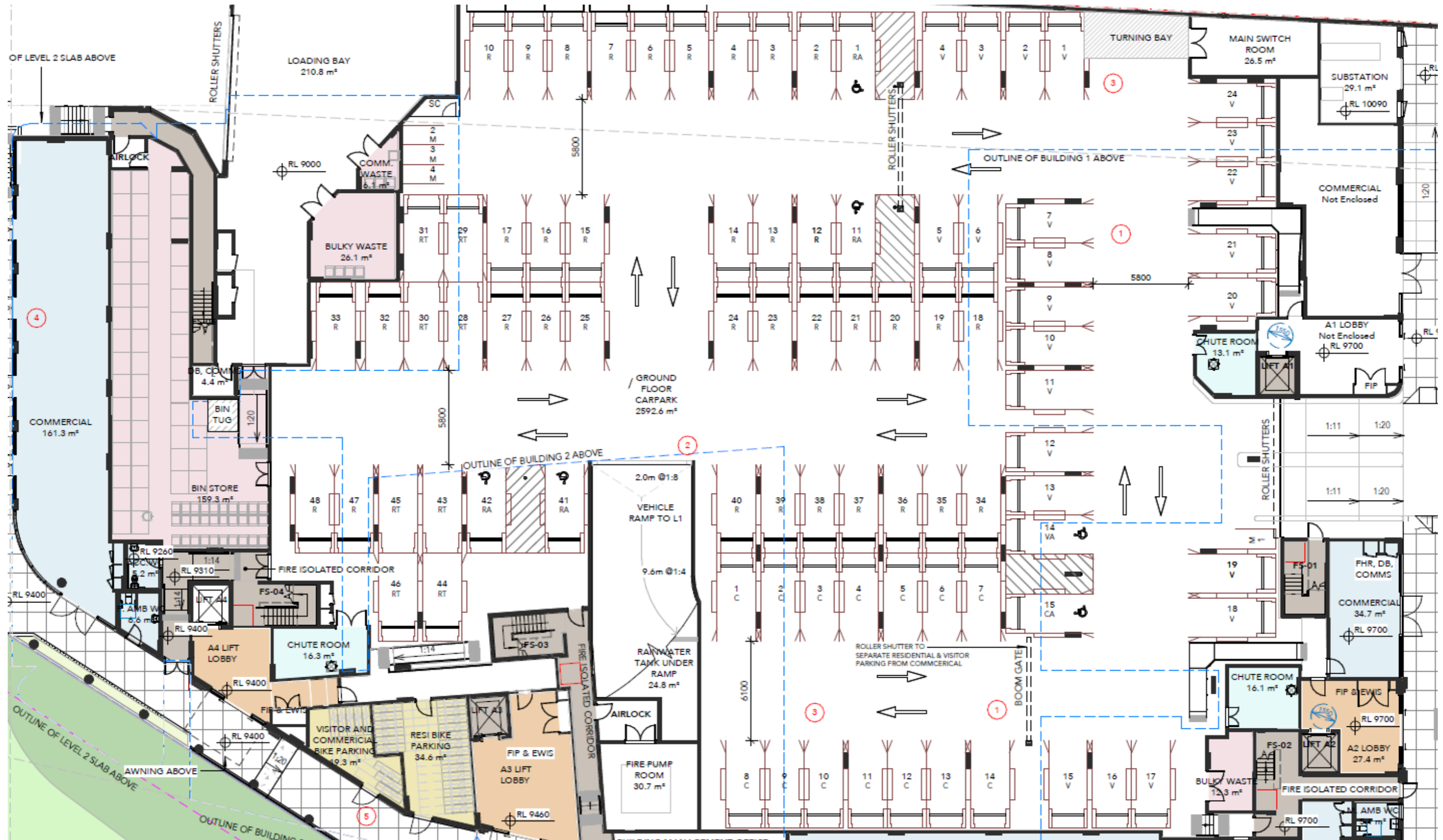
APPENDIX: A.1 GROUND FLOOR PLAN

Source: Teams 2 Architects, DA-0300, Rev 5, Ground Level Floor Plan, 09.09.2025

APPENDIX B: INSTALLATION EQUIPMENT

APPENDIX: B.1 TYPICAL SINGLE CHUTE SHAFT & PENETRATION LAYOUT

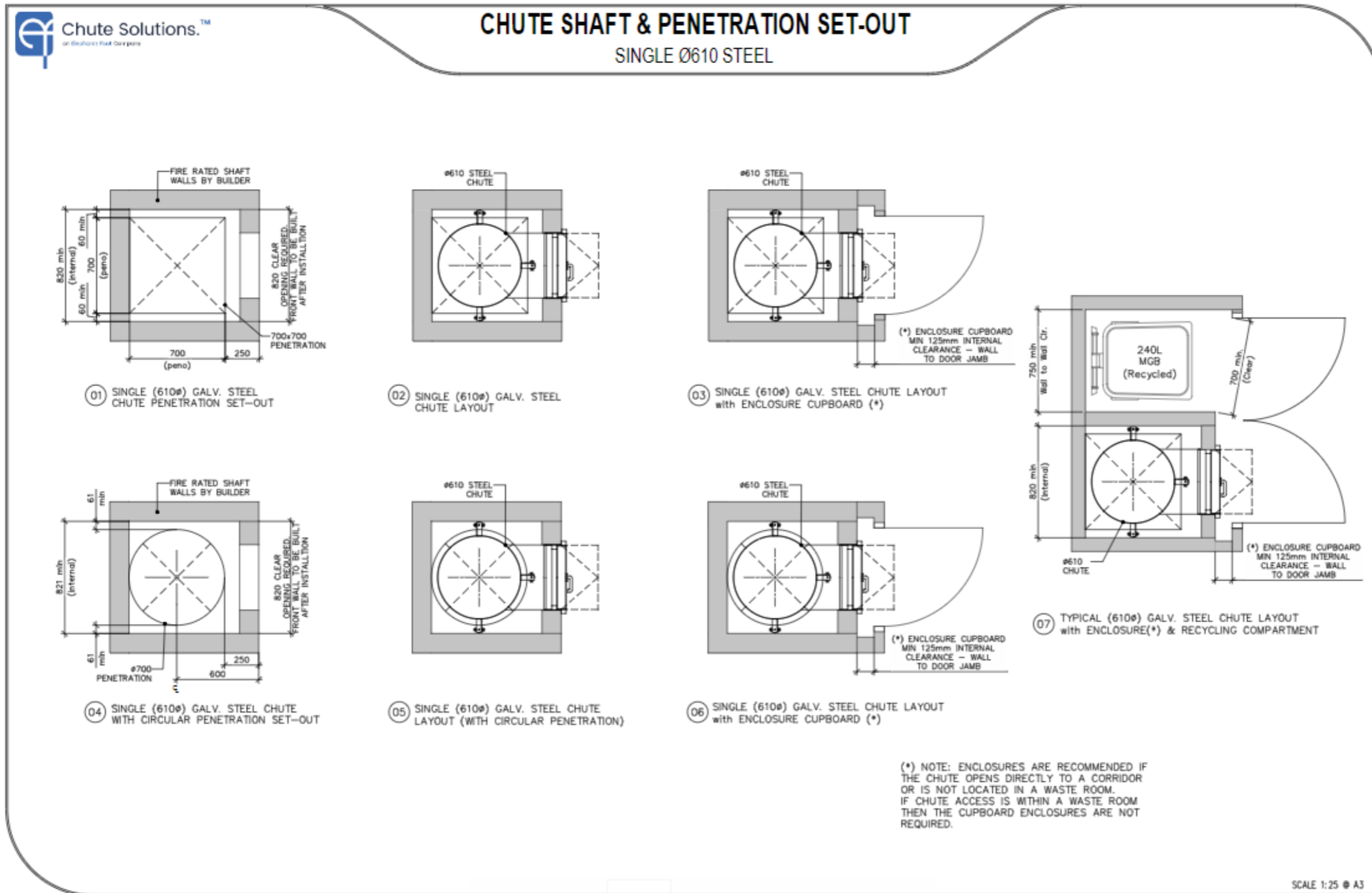

(*) NOTE: ENCLOSURES ARE RECOMMENDED IF THE CHUTE OPENS DIRECTLY TO A CORRIDOR OR IS NOT LOCATED IN A WASTE ROOM. IF CHUTE ACCESS IS WITHIN A WASTE ROOM THEN THE CUPBOARD ENCLOSURES ARE NOT REQUIRED.

SCALE 1:25 @ A3

Chute Shaft & Peno – Ver 1.2 April 26, 2022

Please Note: This is an example only – please refer to supplier's information and specification.

APPENDIX: B.2 EXAMPLE RESIDENTIAL LEVEL RECYCLING BIN LAYOUT

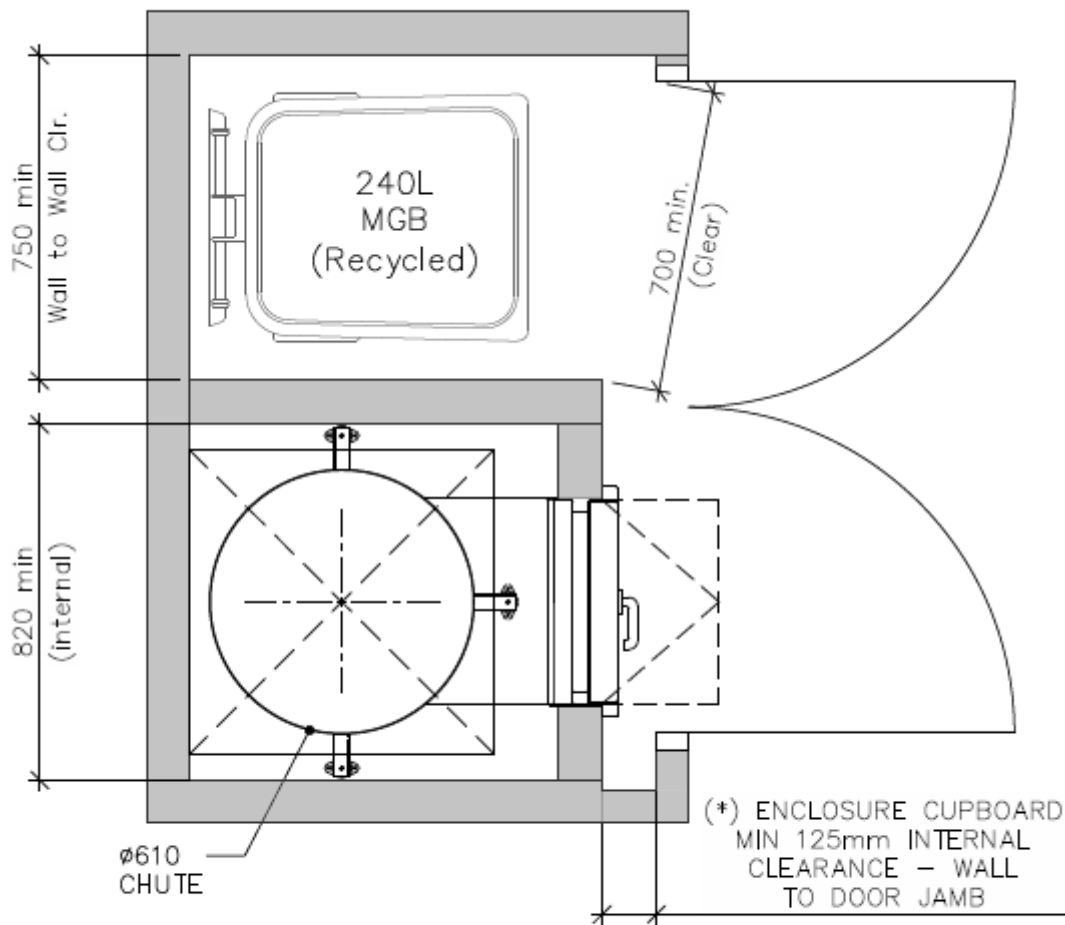

07 TYPICAL (610 ϕ) GALV. STEEL CHUTE LAYOUT
with ENCLOSURE(*) & RECYCLING COMPARTMENT

Please Note: This is an example only – please refer to supplier's information and specification

APPENDIX: B.3 TYPICAL LINEAR TRACK SYSTEM FOR 1100L MGBS



1100 LITRE LINEAR TRACK SYSTEM

PRODUCT INFORMATION

Elephants Foot 1100 Litre bin Linear Track System is a versatile waste handling solution for many types of multi-storey or multi-level developments. The Linear Track System collects waste or recycling being disposed from the floors above through the chute system, discharging the material via a hopper that feeds the bins. Electromechanically driven with automated operation, the system utilises linear motion to automatically change over full bins. Once all the bins are filled, an indicator light will illuminate signifying that the bins are ready for withdrawal and collection. Available with or without compaction unit, our standard 660 litre bin Linear Track System is available in the standard 2 bin option. Our 3 Bin option is available as a special order.



SPECIFICATIONS

System Control	Electric PLC
Power Supply	415 V AC / 10A / 5 PIN
Motor Size (kW)	1.1
Maximum bin load	440 kg
Noise (dBA)	<85
Bin Size (L)	1100
Cycle time (sec)	60
Bin Quantity options	2 or 3

OPTIONAL EXTRAS

- Compaction unit – Please refer to the bin compactor product information sheet for details and specifications
- Enhanced safety add on's – Interlocking barriers, occupancy sensors or safety light curtains (presence sensing light barriers)
- Full bin SMS and email notification
- CMMS and BMS integration
- Extend warranty – Terms and conditions apply

STANDARD FEATURES & BENEFITS

- Simple operation with user friendly controls
- Increased waste servicing efficiency for the development.
- Automatic system control with manual override
- Robust unit construction for long performance life
- Low service and maintain costs
- Rotating flashing beacon (activated during operation)
- Quiet and efficient system operation
- Maximise safety for residents, caretakers and collectors
- Restrained design with minimal moving parts
- Can suit low ceiling clearances
- Floor contact components fully galvanised steel
- Retro fitting options to suit other chutes systems
- Compliant with relevant Building Codes and Standards
- Standard 12 month warranty



1,100 LITRE LINEAR TRACK SYSTEM



No. of Bins	Reference (mm)		
	A	B	C
2	900	3700	5300
3	2100	5940	7550

Available with or without compaction unit, our standard 1100 litre bin Linear Track System is available in the standard 2 bin option. Our 3 Bin option is available as a special order.

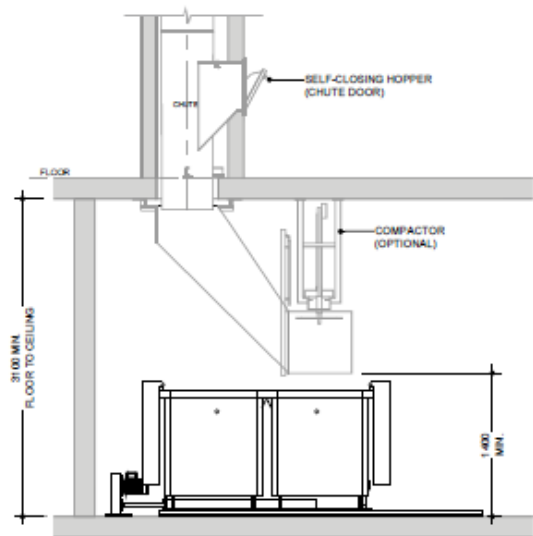
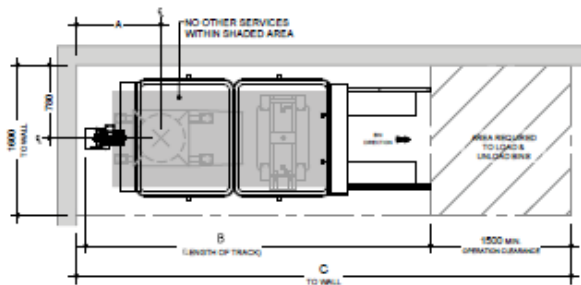

Notes:
 Bins not provided by Elephants Foot

Drawings shown are for general information purposes only and provide minimum equipment spacial requirements for waste room design.

These drawings are not intended for site specific use or for construction. Each project is unique and will be designed to suit.

Additional equipment options, systems and configurations are available. For design assessment, information and advice, please contact an Elephants Foot design consultant on 1300 435 374

Please Note: This is an example only – please refer to supplier's information and specification

APPENDIX: B.4 CEILING-MOUNTED COMPACTOR

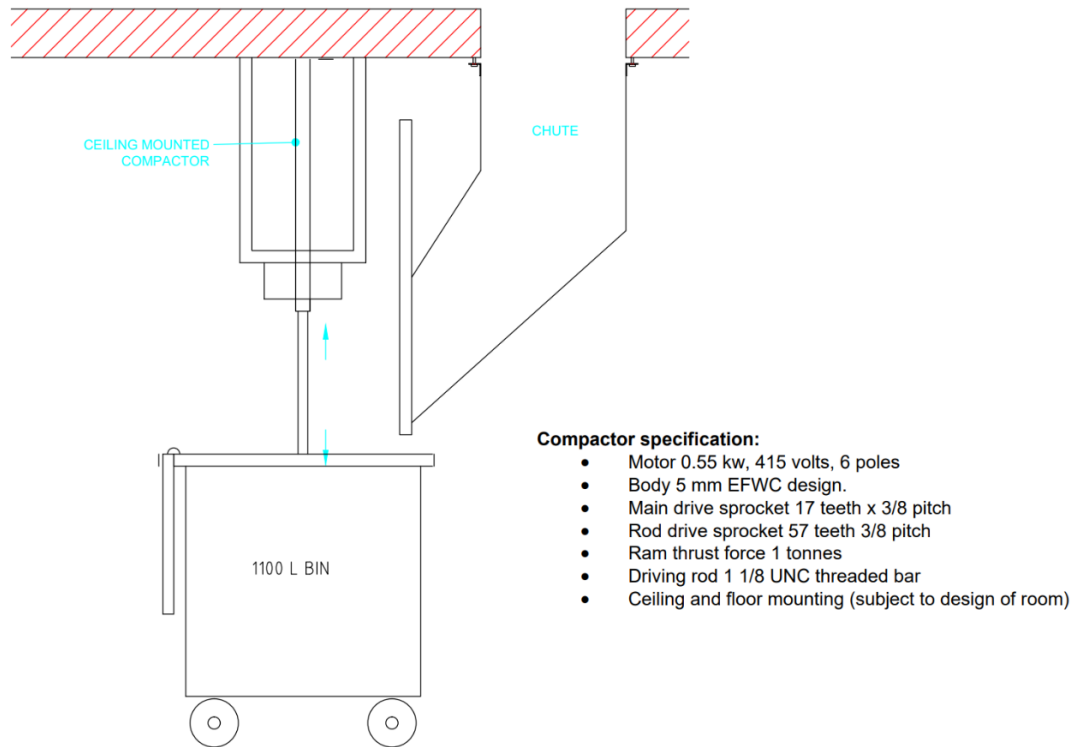

Please Note: This is an example only – please refer to supplier's information and specification

APPENDIX C: PRIMARY WASTE MANAGEMENT PROVISIONS

APPENDIX: C.1 TYPICAL BIN SPECIFICATIONS

Mobile bins

Mobile bins come in a variety of sizes and are designed for lifting and emptying by purpose-built equipment.

Mobile bins with capacities of up to 1700L must comply with *AS4123.6-2006 Mobile waste containers* which specifies standard sizes and sets out the colour designations for the bodies and lids of mobile waste containers indicating the type of materials they are used to collect.

The most common bin sizes are provided below, although not all sizes are shown. The dimensions are a guide only and differ slightly between manufacturers. Some bins have flat or domed lids and are used with different lifting devices. Refer to *AS4123.6-2006* for further details.

Table G1.1: Average dimension ranges for two-wheel mobile bins



Bin capacity	80L	120L	140L	240L	360L
Height (mm)	870	940	1065	1080	1100
Depth (mm)	530	530	540	735	820
Width (mm)	450	485	500	580	600
Approximate footprint (m ²)	0.24	0.26–0.33	0.27-0.33	0.41–0.43	0.49
Approximate weight (kg)	8.5	9.5	10.4	15.5	23
Approximate maximum load (kg)	32	48	56	96	Not known

Wheelie bin

Sources include Sulo, Single Waste, Cleanaway, SUEZ, just wheelie bins and Perth Waste for two-wheel mobile bins

Table G1.2: Average dimension ranges for four-wheel bulk bins



Bin capacity	660L	770L	1100L	1300L	1700L
Height (mm)	1250	1425	1470	1480	1470
Depth (mm)	850	1100	1245	1250	1250
Width (mm)	1370	1370	1370	1770	1770
Approx footprint (m ²)	0.86–1.16	1.51	1.33–1.74	2.21	2.21
Approx weight (kg)	45	Not known	65	Not known	Not known
Approx maximum load (kg)	310	Not known	440	Not known	Not known

Dome or flat lid container

Sources include Sulo, Signal Waste, Cleanaway, SUEZ, Just Wheelie Bins and Perth Waste

Source: *Better Practice Guide For Resource Recovery In Residential Developments 2019*, NSW Environmental Protection Authority

APPENDIX: C.2 SIGNAGE FOR WASTE AND RECYCLING BINS

Waste signs

Signs and educational materials perform several functions including:

- informing residents why it is important to recover resources and protect the environment
- providing clear instructions on how to use the bins and services provided
- alerting people to any dangers or hazards within the bin storage areas.

All waste, recycling and organic bins should be Australian Standard colours and clearly and correctly labelled, such as by a sticker on the lid and/or the body of the bin.

Communal bin storage areas should be clearly signposted with signs outlining how to correctly separate waste into the bins provided. The local council responsible for waste services may be a good source of signs and posters and can advise on what signs are suitable.

Information on who to contact to find out more about the recycling and/or other resource recovery services in the building should also be displayed in communal areas, such as on a noticeboard.

The Planet Ark website also has resources available free of charge for use by businesses and councils. These signs can be found at businessrecycling.com.au/research/signage.cfm

Figure I1.1: Examples of waste wall posters (EPA supplied)



Figure I1.2: Examples of bin lid stickers (EPA supplied)



Source: *Better Practice Guide For Resource Recovery In Residential Developments 2019*, NSW Environmental Protection Authority

Problem waste signs

The EPA has also produced a range of images and signs that can be used for problem wastes, such as fluoro globes and tubes, household and car batteries, e-waste and smoke detectors. To access these resources, contact the NSW EPA. Some examples are shown below.

Figure I2.1: Problem waste signs



Safety signs

The use of safety signs for waste resource recovery rooms must comply with *AS1319 Safety signs for occupational environments*. Safety signs must be used to regulate and control safety related to behaviour, warn of hazards and provide emergency information, including fire protection information. Suitable signs should be decided for each development as required.

Figure I3.1: Example safety signs



Source: *Better Practice Guide For Resource Recovery In Residential Developments 2019*, NSW Environmental Protection Authority

APPENDIX: C.3 TYPICAL COLLECTION VEHICLE INFORMATION

General

Appropriate heavy rigid vehicle standards should be incorporated into the road and street designs in new developments where onsite collections are proposed. Road and street designs must comply with relevant Acts, regulations, guidelines, and codes administered by Austroads, Standards Australia, NSW Roads and Maritime Services, WorkSafe NSW and any local council traffic requirements.

Applicants and building designers should consult with councils and other relevant authorities before designing new roads or streets and access points for waste collection vehicles to establish specific design requirements.

Table H4.1: Australian Standards for turning circles for medium and heavy rigid class vehicles

Vehicle class	Overall length (m)	Design width (m)	Design turning radius (m)	Swept circle (m)	Clearance (travel) height (m)
Medium rigid vehicle	8.80	2.5	10.0	21.6	4.5
Heavy rigid vehicle	12.5	2.5	12.5	27.8	4.5

Source: *Better Practice Guide For Resource Recovery In Residential Developments 2019*, NSW Environmental Protection Authority

Large collection vehicles

Waste collection vehicles may be side-loading, rear-loading, front-lift-loading, hook or crane lift trucks. Vehicle dimensions vary by collection service, manufacturer, make and model. It is not possible to provide definitive dimensions, so architects and developers should consult with the local council and/or contractors.

The following characteristics represent typical collection vehicles and are provided for guidance only. Reference to *AS2890.2 Parking facilities: off-street commercial vehicle facilities* for detailed requirements, including vehicle dimensions, is recommended.

Table B2.1: Collection vehicle dimensions

Vehicle type	Rear-loading	Side-loading*	Front-lift-loading	Hook truck	Crane truck
Length overall (m)	10.5	9.6	11.8	10.0	10.0
Width overall (m)	2.5	2.5	2.5	3.0	2.5
Travel height (m)	3.9	3.6	4.8	4.7	3.8
Operational height for loading (m)	3.9	4.2	6.5	3.0	8.75
Vehicle tare weight (t)	13.1	11.8	16.7	13.0	13.0
Maximum payload (t)	10.0	10.8	11.0	14.5	9.5
Turning circle (m)	25.0	21.4	25.0	25.0	18

* The maximum reach of a side arm is 3 m.

Sources: JJ Richards, SUEZ, MacDonald Johnson, Cleanaway, Garwood, Ros Roca, Bingo and Edbro. Figures shown represent the maximum dimensions for each vehicle type.

Rear-loading collection vehicles

These vehicles are commonly used for domestic waste collections from MUDs and RFBs and sometimes for recycling. They can be used to collect waste stored in mobile bins or bulk bins, particularly where bins are not presented at the kerbside. They are also used for collecting bulky waste.

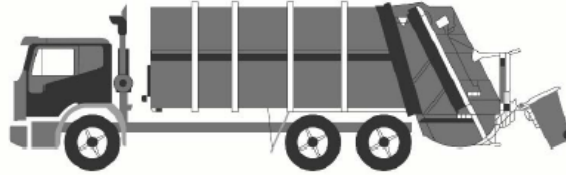

Rear-loading waste collection vehicle

Side-loading collection vehicles

This is the most commonly used vehicle for domestic waste, recycling and organics collections. It is only suitable for collecting mobile bins up to 360L in capacity.

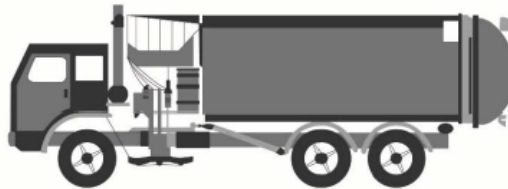

Side-loading waste collection vehicle

Front-lift-loading collection vehicles

These vehicles are commonly used for collecting commercial and industrial waste. They can only collect specially designed front-lift bulk bins and not mobile bins.



Front-lift-loading waste collection vehicle

Small collection vehicles

Typically, councils and their contractors operate with large collection vehicles (heavy rigid class vehicles) because they carry greater payloads and allow for more cost-effective collection services. Some councils, or their contractors, may have smaller collection vehicles in their fleet. Early discussion with the council is important to confirm this, but it should not be assumed that the council will have access to small collection vehicles.

The waste management systems and the location of the collection point should always be designed so that the council can provide the standard domestic waste service.

Source: *Better Practice Guide For Resource Recovery In Residential Developments 2019*, NSW Environmental Protection Authority

APPENDIX: C.4 EXAMPLE BIN MOVER

Battery powered tug with a 1 or 2 tonne tow capacity



Features at a glance

One tonne (Evo 1T) or two tonne (Evo 2T) tow capacity

Auto latching hitch

Three speed motor with emergency stop

Typical applications

The Tug Evo is suitable for airports, factories, warehouses, apartment buildings or large facilities. This powered tug is also suitable for transporting medical carts around hospitals or moving heavy specialist equipment.

Features:

- 1 or 2 tonne tow capacity of inclines up to 6 degrees
- 500kg tow capacity if inclines up to 14 degrees
- CE Compliant
- 5 km/h max speed
- 2 x 12V 42Ah MK-gel batteries with 24V smart charger.
- Powerful transaxle

Safety Features:

- Intuitive control with standard automatic safety brake, forward and reverse drive.
- Emergency stop button.

Emergency back-off button

Source: <http://www.electrodrive.com.au/products/tugs/tug-evo.aspx>

APPENDIX: C.5 EXAMPLE SEATED BIN MOVERS
SITECRAFT
 MATERIALS HANDLING EQUIPMENT

 17 Macquarie Drive, Thomastown, VIC 3074
 Phone: 1300 363 152 Fax: 1300 722 383
 E: sales@sitecraft.com.au ABN: 36 423 328 526

SITECRAFT HEAVY DUTY ELECTRIC TOW TRACTOR

- > Towing capacities from 2000 kg to 6,000 kg
- > **Full AC electric system** has a brake-releasing function, making the unit easy and effortless to operate; The maintenance-free motor completely solves the issues of DC motor carbon brush.
- > Batteries located in the lowest part of frame ensures excellent stability
- > Quick open back service cover for easy maintenance and part replacement
- > CANbus technology reduces wiring complexity and increases reliability
- > H type axle design provides excellent stability.
- > New high-range steering design; light steering and easy to maintain.
- > New large-screen instrument display provides information clearly and directly to the operator.

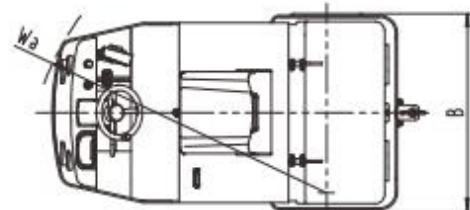
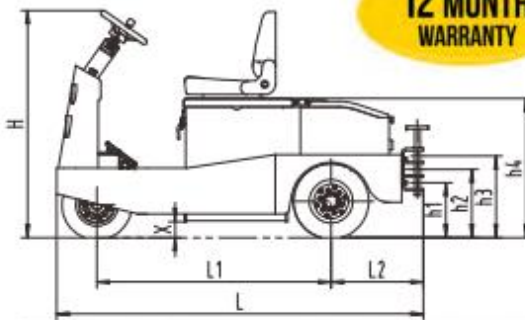
**12 MONTH
WARRANTY**

Model		ST-2000AC	ST-3000AC	ST-5000AC	ST-6000AC
Towing Capacity	Kg	2000	3000	5000	6000
Drawbar Centre Height	h1/h2/h3 mm	280/350/420	280/350/420	280/350/420	280/350/420
Motor	Kw / V	3Kw / 36V	3Kw / 36V	5Kw / 48V	5Kw / 48V
Total Size	L x B x H mm	1720 x 968 x 1270	1720 x 968 x 1270	1975 x 1100 x 1270	1975 x 1100 x 1270
Total Weight (With Batteries)	Kg	740	780	1240	1280
Wheel Size	Solid Rubber	15*4-8	15*4-8	15*4-8	15*4-8
Wheelbase	L1 mm	1055	1055	1280	1280
Rear Hanging Distance	L2 mm	382	382	500	500
Seat Height	h4 mm	910	910	910	910
Ground Clearance	X mm	90	90	90	90
Turning Radius	Wa mm	1500	1500	1650	1650
Maximum Speed	Km/h	10	8	14	12
Battery	V/Ah	36/200	36/250	48/360	48/400
Battery Weight	Kg	200	250	610	650
Charger	On-board V/Ah	36/30	36/30	48/50	48/50

SITECRAFT

MATERIALS HANDLING EQUIPMENT



17 Macquarie Drive, Thomastown, VIC 3074
 Phone: 1300 363 152 Fax: 1300 722 383
 E: sales@sitecraft.com.au ABN: 36 423 328 526

SITECRAFT HEAVY DUTY ELECTRIC TOW TRACTOR



Sitecraft ST3000-AC tow tug moving 660 & 1100 litre bins



Sitecraft ST3000-AC tow tug moving 660 & 1100 litre bins

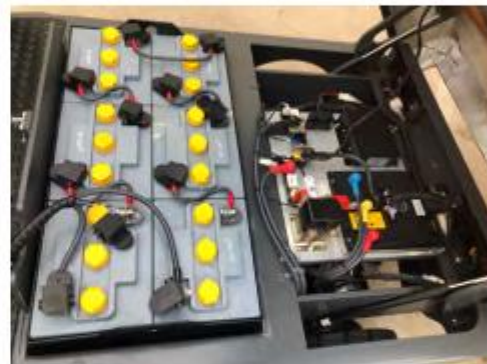

ST3000-AC tow tug complete with 6 x 250AH heavy duty batteries



Optional steel / aluminium trailers for moving waste bins, linen trolleys, food trolleys, delivery boxes, etc ...

Source: <https://www.sitecraft.net.au/materials-handling/tow-tugs-powered-vehicles/electric-tow-vehicles/>

APPENDIX: C.6 EXAMPLE BIN LIFTER FOR 240L BINS

versatip

Versatip Bin Tipper – 1500mm Tip



Specifications

Product Code	69121009
Product Name	1500mm Tip – Battery Powered
Capacity (kg)	250
Height (mm)	2085
Length (mm)	1330
Power Source	Battery Powered
Tipping Height (mm)	1500
Width (mm)	990

Please Note: This is an example only – please contact supplier for specific recommendations.

Source: Elephants Foot Equipment - www.elephantsfoot.com.au/equipment/

APPENDIX D: SECONDARY WASTE MANAGEMENT PROVISIONS

APPENDIX: D.1 EXAMPLE APARTMENT STYLE COMPOST BIN



Apartment Style Compost bin – available from hardware stores

Suitable for:

- Vegetables
- Coffee grounds and filters
- Tea and tea bags
- Crushed eggshells (but not eggs)
- Nutshells
- Houseplants
- Leaves
- Cardboard rolls, cereal
- Boxes, brown paper bags
- Clean paper
- Shredded newspaper
- Fireplace ashes
- Wood chips, sawdust,
- Toothpicks, burnt matches
- Cotton and wool rags
- Dryer and vacuum cleaner lint
- Hair and fur
- Hay and straw

APPENDIX: D.2 TYPICAL SOURCE SEPARATION BINS



Source: <https://www.sourceseparationsystems.com.au/>