

**Photograph**



**Significance**

High

**Recommendation**

This room was the former Metropolitan Lands Court and this table was moved in subsequent to the Court period. Further research is required to determine its former location and use in the Lands Building as it is possible that this was a board room from one of the meeting rooms.

<b>Location</b> Lands Building	<b>Room No</b> 119 First Floor	<b>Item No</b> 70
<b>Title</b> Coat of Arms		
<b>Description</b> NSW State Coat of Arms, low relief, painted and gilded and mounted on a frame.		
<b>Date</b> Mid 20 <sup>th</sup> century	<b>Condition</b> Good	<b>Dimensions (W x D x H)</b> Not recorded
<b>Photograph</b>		
		
<b>Significance</b> High - formerly associated with the Metropolitan Land Court which sat in this room.		
<b>Recommendation</b> Retain in situ for interpretive purposes.		

## EAST CORRIDOR [141] [144]

### First Floor

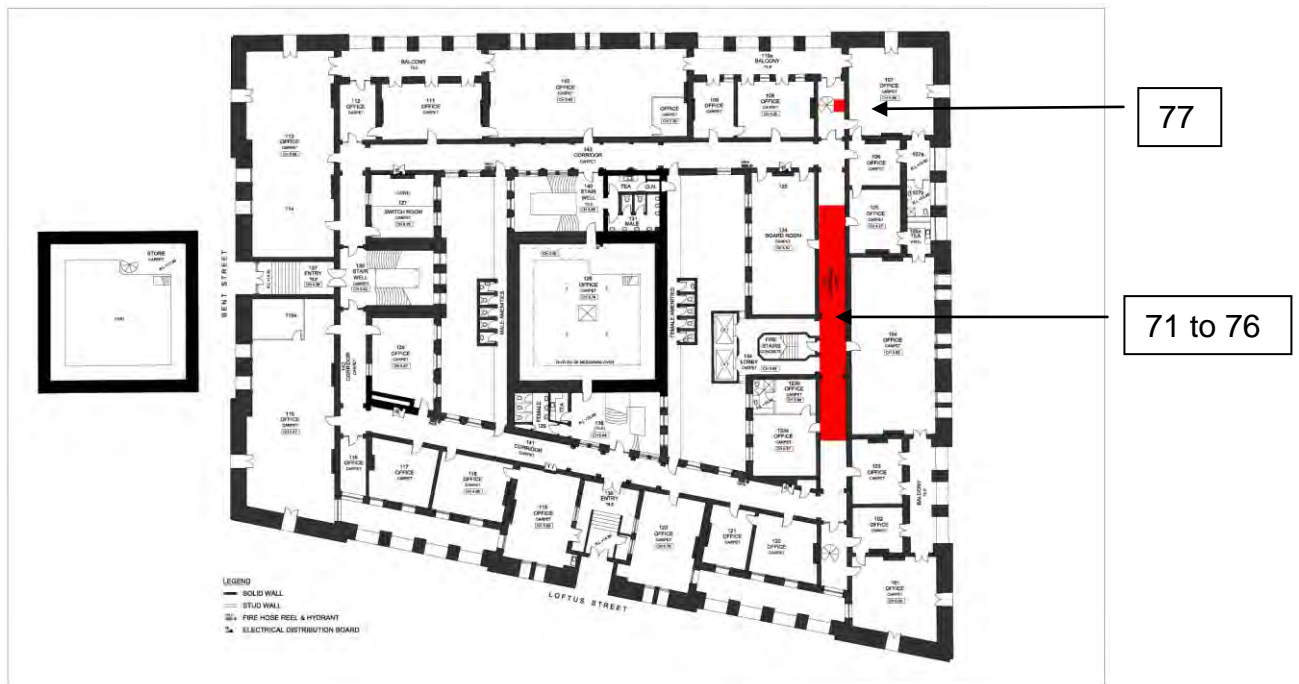



<b>Location</b> Lands Building	<b>Room No</b> 141 East Corridor	<b>Item No</b> 71
<b>Title</b> Photographs		
<b>Description</b> Framed chronological sequence of photographs of Ministers for Lands 1856-1889, 18 images (9 images x 2 rows) grey mount, gilt edged window, inscribed brass name plate under each photo, stained timber frame, surmounted by shaped board inscribed in gilt "Ministers for Lands 1856 to 1889".		
<b>Date</b> 20 <sup>th</sup> century	<b>Condition</b> Excellent	<b>Dimensions (W x D x H)</b> Frame 143 x 63cm, title plate 83 x 10.2cm
<b>Photograph</b>		
		
<b>Significance</b> High – copies of original images in the public domain, not original to the fit-out, but important for interpretive value.		
<b>Recommendation</b> Retain for interpretive use.		

<b>Location</b> Lands Building	<b>Room No</b> 141 First Floor Corridor	<b>Item No</b> 72
<b>Title</b> Photographs		
<b>Description</b> Framed chronological sequence of photographs of Ministers for Lands 1889-1930, 18 images (9 images x 2 rows), grey mount, gilt edged windows, inscribed metal plate below each photo, stained timber frame, surmounted by shaped board inscribed in gilt "Ministers for Lands 1889 to 1930".		
<b>Date</b> 20 <sup>th</sup> century	<b>Condition</b> Excellent	<b>Dimensions (W x D x H)</b> Frame 143 x 63.5cm, title plate 83 x 10.2 cm
<b>Photograph</b>		
		
<b>Significance</b> High – copies of original images in the public domain, not original to the fit-out, but important for interpretive value.		
<b>Recommendation</b> Retain for interpretive use.		

<b>Location</b> Lands Building	<b>Room No</b> 141 First Floor Corridor	<b>Item No</b> 73
<b>Title</b> Photographs		
<b>Description</b> Framed chronological sequence of photographs of Ministers for Lands 1930-1984, 18 images (9 images x 2 rows) grey mount, gilt edged window, inscribed brass name plate under each photo, stained timber frame, surmounted by shaped board inscribed in gilt "Ministers for Lands 1930 to 1984".		
<b>Date</b> 20 <sup>th</sup> century	<b>Condition</b> Excellent	<b>Dimensions (W x D x H)</b> Frame 143 x 62.5cm, name plate 83 x 10.2cm
<b>Photograph</b>		
		
<b>Significance</b> High – copies of original images in the public domain, not original to the fit-out, but important for interpretive value.		
<b>Recommendation</b> Retain for interpretive use.		

<b>Location</b> Lands Building	<b>Room No</b> 141 First Floor Corridor	<b>Item No</b> 74
<b>Title</b> Photographs		
<b>Description</b> Framed chronological sequence of photographs of Ministers for Lands from 1984, 9 images (9 images along 1 row and 9 empty mounts in row below) grey mount, gilt edged window, inscribed brass name plate under each photo, stained timber frame, surmounted by shaped board , inscribed in gilt "Ministers for Lands 1984 to ".		
<b>Date</b> 20 <sup>th</sup> century	<b>Condition</b> Excellent	<b>Dimensions (W x D x H)</b> Frame 143 x 63cm, name plate 83 x 10.2cm
<b>Photograph</b>		
		
<b>Significance</b> High – copies of original images in the public domain, not original to the fit-out, but important for interpretive value.		
<b>Recommendation</b> Retain for interpretive use.		

<b>Location</b> Lands Building	<b>Room No</b> 141 First Floor Corridor	<b>Item No</b> 75
<b>Title</b> Photographs		
<b>Description</b> Framed chronological sequence of photographs of Under Secretaries for Lands 1856-1985, 24 images (12 images x 2 rows) grey mount, gilt edged window, inscribed brass name plate under each photo, stained timber frame, surmounted by shaped board inscribed in gilt "Under Secretaries for Lands 1856 to 1985".		
<b>Date</b> 20 <sup>th</sup> century	<b>Condition</b> Excellent	<b>Dimensions (W x D x H)</b> Frame 143 x 63cm, title plate 83 x 10.2cm
<b>Photograph</b>		
		
<b>Significance</b> High – copies of original images in the public domain, not original to the fit-out, but important for interpretive value.		
<b>Recommendation</b> Retain for interpretive use.		

<b>Location</b> Lands Building	<b>Room No</b> 141 First Floor Corridor	<b>Item No</b> 76
<b>Title</b> Photographs		
<b>Description</b> Framed chronological sequence of photographs of Under Secretaries for Lands from 1985, 18 images 9 images in top row of 12 windows above 2 <sup>nd</sup> row of 12 empty windows) grey mount, gilt edged windows, inscribed brass name plate under each photo, and gilded window edges in stained timber frame, surmounted by shaped board inscribed in gilt "Under Secretaries for Lands 1985 to ".		
<b>Date</b> 20 <sup>th</sup> century	<b>Condition</b> Excellent	<b>Dimensions (W x D x H)</b> Frame 143 x 63cm, title plate 83 x 10.2cm
<b>Photograph</b>		
		
<b>Significance</b> High – copies of original images in the public domain, not original to the fit-out, but important for interpretive value.		
<b>Recommendation</b> Retain for interpretive use.		

<b>Location</b> Lands Building	<b>Room No</b> 141 First Floor Corridor, NW stairwell	<b>Item No</b> 77
<b>Title</b> Map holder		
<b>Description</b> Stained timber map holder, with 2 maps on rollers, inscribed in gilt in centre front, New South Wales, Supplied by F C Robinson		
<b>Date</b> 20 <sup>th</sup> century	<b>Condition</b> Good	<b>Dimensions (W x D x H)</b> 75 x 23.5cm
<b>Photograph</b> 		
<b>Significance</b> High – used by former Ministers for Lands as reference material.		
<b>Recommendation</b> Retain for interpretive use.		

# FORMER SURVEYOR-GENERAL'S OFFICE [201]

## Second Floor

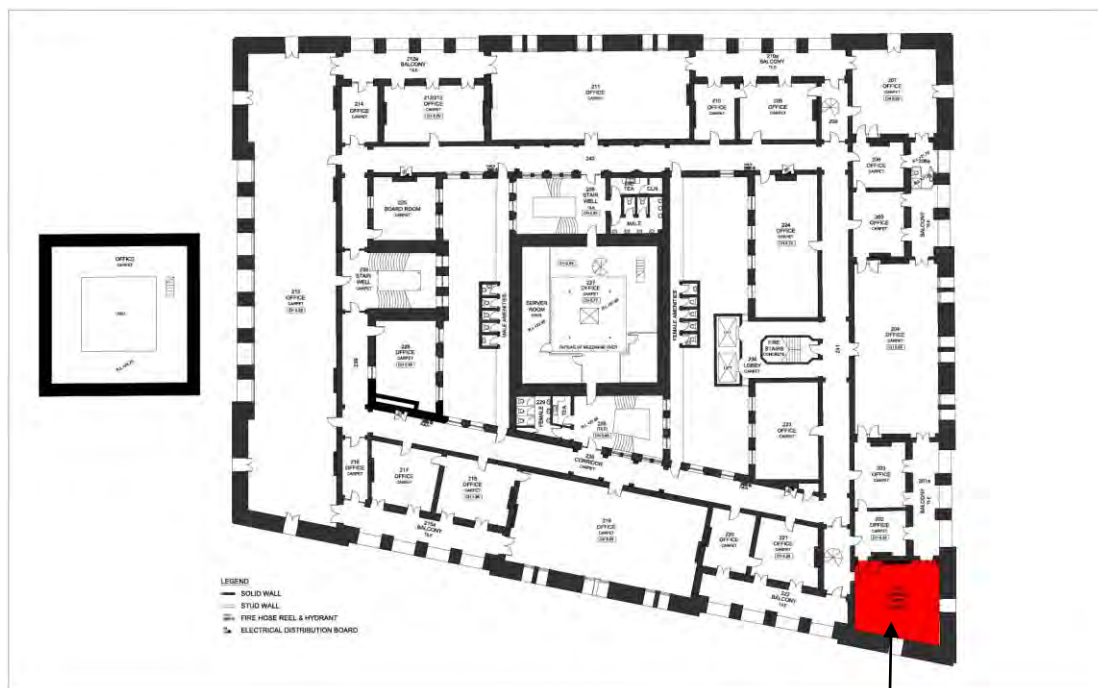

78 to 87

<b>Location</b> Lands Building	<b>Room No</b> 201 Second floor	<b>Item No</b> 78
<b>Title</b> Desk		
<b>Description</b> Australian red cedar double pedestal partner's desk, each pedestal with 4 graduated drawers to one side each with turned wooden handles, single cupboard to the other on plinth base with canted corners, gilt tooled green leather insert to desk top which has shaped chair recess. Trade label "Manufactured by Alex W Norton cabinetmaker 52-54 Hunter Street". Modified with electrical cabling.		
<b>Date</b> 1880	<b>Condition</b> Excellent	<b>Dimensions (W x D x H)</b> 183 x 120 x 76cm
<b>Photograph</b>		
		

**Photograph**



**Significance**

Exceptional – item of original furnishing of Surveyor-General's office in Lands Department building, work of colonial cabinetmaker Alexander Norton, unusual example of desk construction with cut-out for chair.

**Recommendation**

Retain in situ.

<b>Location</b> Lands Building	<b>Room No</b> 201 Second Floor	<b>Item No</b> 79
<b>Title</b> Bookcase		
<b>Description</b> Australian red cedar bookcase, 2 glazed doors enclosing 2 adjustable shelves, panelled back above a 2 door cupboard base, moulded panel doors.		
<b>Date</b> Circa 1880	<b>Condition</b> Excellent	<b>Dimensions (W x D x H)</b> 122 x 46 x 217cm
<b>Photograph</b>		
		
<b>Significance</b> Exceptional – original furnishing from Under Secretary for Mines office in Lands Department building.		
<b>Recommendation</b> Retain in situ.		

<b>Location</b> Lands Building	<b>Room No</b> 201 Second Floor	<b>Item No</b> 80
<b>Title</b> Chair		
<b>Description</b> Oak swivel chair, shaped arms, padded back studded within timber frame, stuff over seat secured to seat rail with studs, supported on four out-swept legs.		
<b>Date</b> Early 20 <sup>th</sup> century	<b>Condition</b> Good	<b>Dimensions (W x D x H)</b> 49 x 49 x 89cm
<b>Photograph</b>		
		
<b>Significance</b> High – original to furnishing in Lands Department building. Further investigation required to determine if ensuite with the desk.		
<b>Recommendation</b> Retain in situ.		

<b>Location</b> Lands Building	<b>Room No 201</b> Second Floor	<b>Item No</b> 81
<b>Title</b> Desk		
<b>Description</b> Cedar desk, top with gilt tooled green leather insert, single drawer to deep apron, turned wooden handles, turned wooden legs.		
<b>Date</b> Circa 1880	<b>Condition</b> Very good	<b>Dimensions (W x D x H)</b> 123 x 70 x 76cm
<b>Photograph</b>		
		
<b>Significance</b> High – original to furnishing of Lands Department building.		
<b>Recommendation</b> Retain in situ.		

<b>Location</b> Lands Building	<b>Room No</b> 201 Second Floor	<b>Item No</b> 82
<b>Title</b> Chair		
<b>Description</b> Cedar chair, upholstered in red vinyl, stuff over seat, arms with padded arm rests and spindle-turned supports above seat rail, timber stiles and padded back, supported on turned front legs with casters.		
<b>Date</b> Circa 1880	<b>Condition</b> Very good	<b>Dimensions (W x D x H)</b> 63 x 58 x 83cm
<b>Photograph</b>		
		
<b>Significance</b> High – original item of furniture from Lands Department building.		
<b>Recommendation</b> This chair should be retained in the Lands Building, but could be reallocated with complementary furniture (Items 13, 14, 15 and 28) to make a suite.		

<b>Location</b> Lands Building	<b>Room No</b> 201 Second Floor	<b>Item No</b> 83
<b>Title</b> Chairs (7)		
<b>Description</b> Cedar chairs, curved front seat rail, reeded stiles and upholstered stuff over back above a row of spindles, stuff over seat, black leather upholstery, turned front legs.		
<b>Date</b> Circa 1880	<b>Condition</b> Very good	<b>Dimensions (W x D x H)</b> 46 x 41 x 81cm
<b>Photograph</b>		
		
<b>Significance</b> Exceptional – original to furnishing of Minister for Lands office.		
<b>Recommendation</b> These chairs may have migrated from the Minister for Lands office (107) but further research is required. In the interim, retain in situ.		

<b>Location</b> Lands Building	<b>Room No</b> 202 Second Floor	<b>Item No</b> 84
<b>Title</b> Chair		
<b>Description</b> Cedar chair curved front seat rail, reeded stiles and upholstered stuff over back, stuff over seat, black leather upholstery, turned front legs.		
<b>Date</b> Circa 1880	<b>Condition</b> Very good	<b>Dimensions (W x D x H)</b> 46.5 x 43 x 87cm
<b>Photograph</b>		
		
<b>Significance</b> High – original to furnishing in Lands Department building. Item 46		
<b>Recommendation</b> This chair may have migrated from the Minister for Lands office (107) but further research is required (See historic image for Item 48). In the interim, retain in situ.		

<b>Location</b> Lands Building	<b>Room No</b> G201 Second Floor	<b>Item No</b> 85
<b>Title</b> Chair		
<b>Description</b> Cedar chairs, straight front seat rail, reeded stiles and upholstered squab below a row of spindles, carved Aesthetic Movement detail to top rail , stuff over seat, black leather upholstery, turned front legs.		
<b>Date</b> Circa 1880	<b>Condition</b> Very good	<b>Dimensions (W x D x H)</b> 46.5 x 43 x 87cm
<b>Photograph</b> 		
<b>Significance</b> High – original to furnishing in Lands Department building.		
<b>Recommendation</b> This chair may have migrated from the Minister for Lands office (107) but further research is required (See historic <a href="#">image for Item 64</a> ). In the interim, retain in situ.		

<b>Location</b> Lands Building	<b>Room No</b> 201 Second floor	<b>Item No</b> 86
<b>Title</b> Table		
<b>Description</b> Australian red cedar map table, gilt tooled leather insert, deep apron, supported on turned legs, resting on wooden blocks. Metal bracing below table top.		
<b>Date</b> Circa 1880	<b>Condition</b> Very good	<b>Dimensions (W x D x H)</b> 306 x 114.5 x 77.5cm
<b>Photograph</b>		
		
<b>Significance</b> High – original to furnishing in Lands Department building		
<b>Recommendation</b> Retain in situ.		

<b>Location</b> Lands Building	<b>Room No</b> 201 Second Floor	<b>Item No</b> 87
<b>Title</b> Bookcase		
<b>Description</b> Two door glazed bookcase on plinth base		
<b>Date</b> Modern, circa 1980s	<b>Condition</b> Excellent	<b>Dimensions (W x D x H)</b> Not recorded
<b>Photograph</b>		
		
<b>Significance</b> Neutral		
<b>Recommendation</b> Not recommended for retention. Replacement with an original 19 <sup>th</sup> century item of furniture (Item 19) currently in storage is recommended.		

# FORMER ASSISTANT SURVEYOR - GENERAL'S OFFICE [207]

## Second Floor

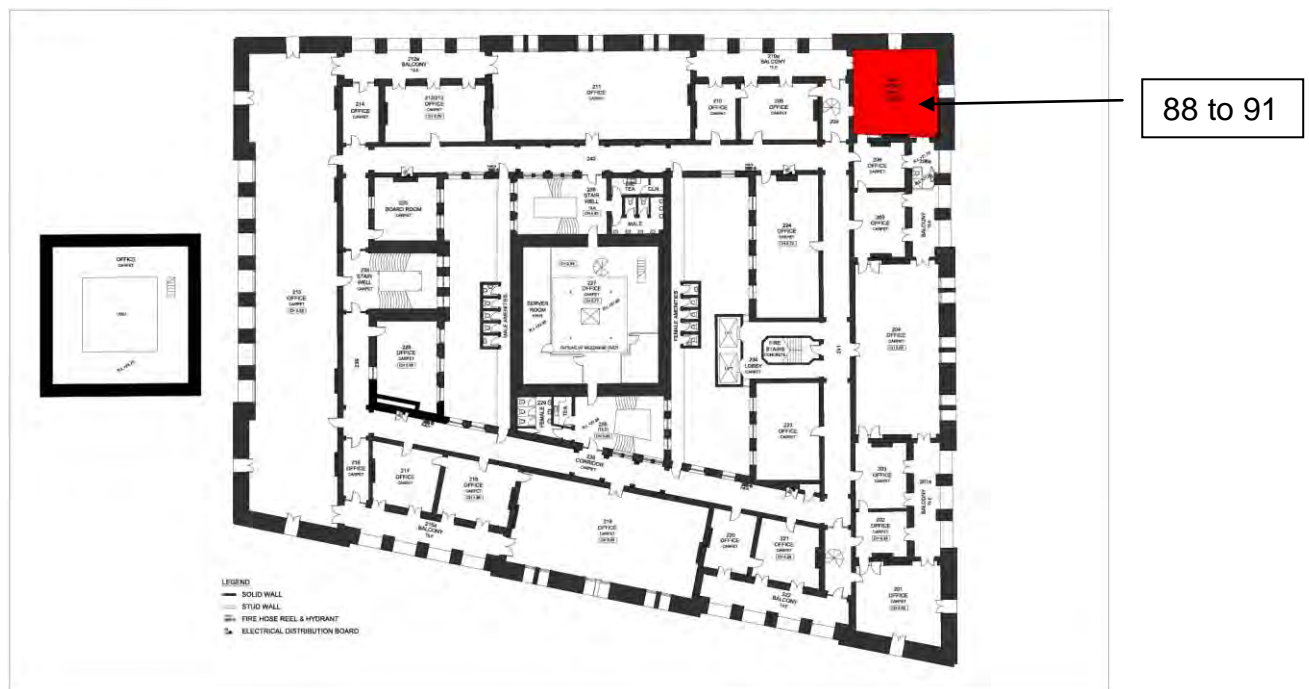

<b>Location</b> Lands Building	<b>Room No</b> 207 Second Floor	<b>Item No</b> 88
<b>Title</b> Chaise longue		
<b>Description</b> Cedar chaise longue, scroll carved backboard, upholstered in red leather, stuff over seat buttoned along seat rail, buttoned back and sloped side, supported on carved turned legs on brass and porcelain casters.		
<b>Date</b> Circa 1880	<b>Condition</b> Excellent	<b>Dimensions (W x D x H)</b> 189 x 62 x 94cm
<b>Photograph</b>		
		
<b>Significance</b> High— original furnishing for Lands Department building, probably associated with Under Secretary or Surveyor General's office NB Desk currently in this room is modern and should be replaced by one in storage if this office remains as a functional room.		
<b>Recommendation</b> Retain in situ.		

<b>Location</b> Lands Building	<b>Room No</b> 207 Second Floor	<b>Item No</b> 89
<b>Title</b> Chairs (10)		
<b>Description</b> Cedar chairs, deep curved top rail, stiles joined by scroll carved back rail, stuff over upholstered seat, green brocade, turned front legs.		
<b>Date</b> Circa 1880	<b>Condition</b> Excellent	<b>Dimensions (W x D x H)</b> 46 x 44 x 92cm
<b>Photograph</b>		
		
<b>Significance</b> High – original furnishing for Lands Department building		
<b>Recommendation</b> Retain in situ.		

<b>Location</b> Lands Building	<b>Room No</b> G207 Second Floor	<b>Item No</b> 90
<b>Title</b> Table		
<b>Description</b> Cedar board room table, rectangular, solid top (with glass), four turned legs		
<b>Date</b> Circa 1880	<b>Condition</b> Excellent	<b>Dimensions (W x D x H)</b> 290 x 105 x 79cm
<b>Photograph</b>		
		
<b>Significance</b> High – original furnishing for Lands Department building		
<b>Recommendation</b> Retain in situ.		

<b>Location</b> Lands Building	<b>Room No</b> 207 Second Floor	<b>Item No</b> 91
<b>Title</b> Hat and coat stand		
<b>Description</b> Australian red cedar hat and coat stand, waisted form, shaped pediment above a hat peg, arched mirror surrounded by a decorative cut-out with 6 coat pegs, shelf supported on t 2 front turned uprights, with shaped cut out for umbrella handles, shaped base with lead lined drip tray.		
<b>Date</b> Circa 1880	<b>Condition</b> Damage to pediment, missing drip tray	<b>Dimensions (W x D x H)</b> 57 x 34 x 140cm
<b>Photograph</b>		
		
<b>Significance</b> High – original furnishing for Lands Department building		
<b>Recommendation</b> Retain in situ.		

## EAST CORRIDOR [241]

### Second Floor

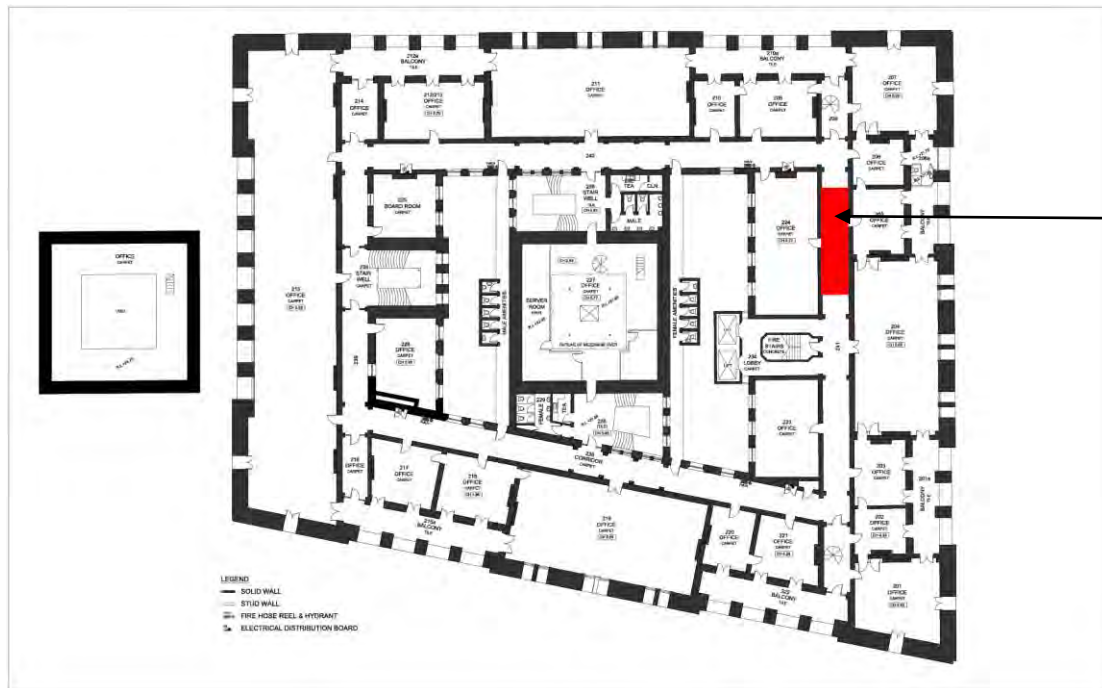

92 to 94

<b>Location</b> Lands Building	<b>Room No 241</b> Second Floor Corridor	<b>Item No</b> 92
<b>Title</b> Photographs		
<b>Description</b> Framed chronological sequence of photographs of Surveyors General of New South Wales, 1803-1916, 12 images (6 images x 2 rows) grey mount, gilt edged window, inscribed brass name plate under each photo, stained timber frame.		
<b>Date</b> 20 <sup>th</sup> century	<b>Condition</b> Good	<b>Dimensions (W x D x H)</b> 125.5 x 73.5cm
<b>Photograph</b>		
		
<b>Significance</b> High – copies of original images in the public domain, not original to the fit-out, but important for interpretive value		
<b>Recommendation</b> Retain for interpretive use.		

<b>Location</b> Lands Building	<b>Room No 241</b> Second Floor Corridor	<b>Item No</b> 93
<b>Title</b> Photographs		
<b>Description</b> Framed chronological sequence of photographs of Surveyors General of New South Wales, 1922-1985, 12 images (6 images x 2 rows) grey mount, gilt edged window, inscribed brass name plate under each photo, stained timber frame, surmounted by a shaped timber board inscribed in gilt "Surveyors General of New South Wales".		
<b>Date</b> 20 <sup>th</sup> century	<b>Condition</b> Good	<b>Dimensions (W x D x H)</b> Frame 125.5 x 73.5cm, name plate 80.5 x 13cm
<b>Photograph</b>		
		
<b>Significance</b> High – copies of original images in the public domain, not original to the fit-out, but important for interpretive value		
<b>Recommendation</b> Retain for interpretive use.		

<b>Location</b> Lands Building	<b>Room No 241</b> Second Floor Corridor	<b>Item No</b> 94
<b>Title</b> Photographs		
<b>Description</b> Framed chronological sequence of photographs of Surveyors General of New South Wales, from 1986, 1 images grey mount, gilt edged window (6 x 2 rows), inscribed brass name plate under each photo, stained timber frame.		
<b>Date</b> 20 <sup>th</sup> century	<b>Condition</b> Good	<b>Dimensions (W x D x H)</b> 125.5 x 73.5cm
<b>Photograph</b>		
		
<b>Significance</b> High – copies of original images in the public domain, not original to the fit-out, but important for interpretive value		
<b>Recommendation</b> Retain for interpretive use.		

## SURVEY RECORDS ROOM [316]

### Second Floor

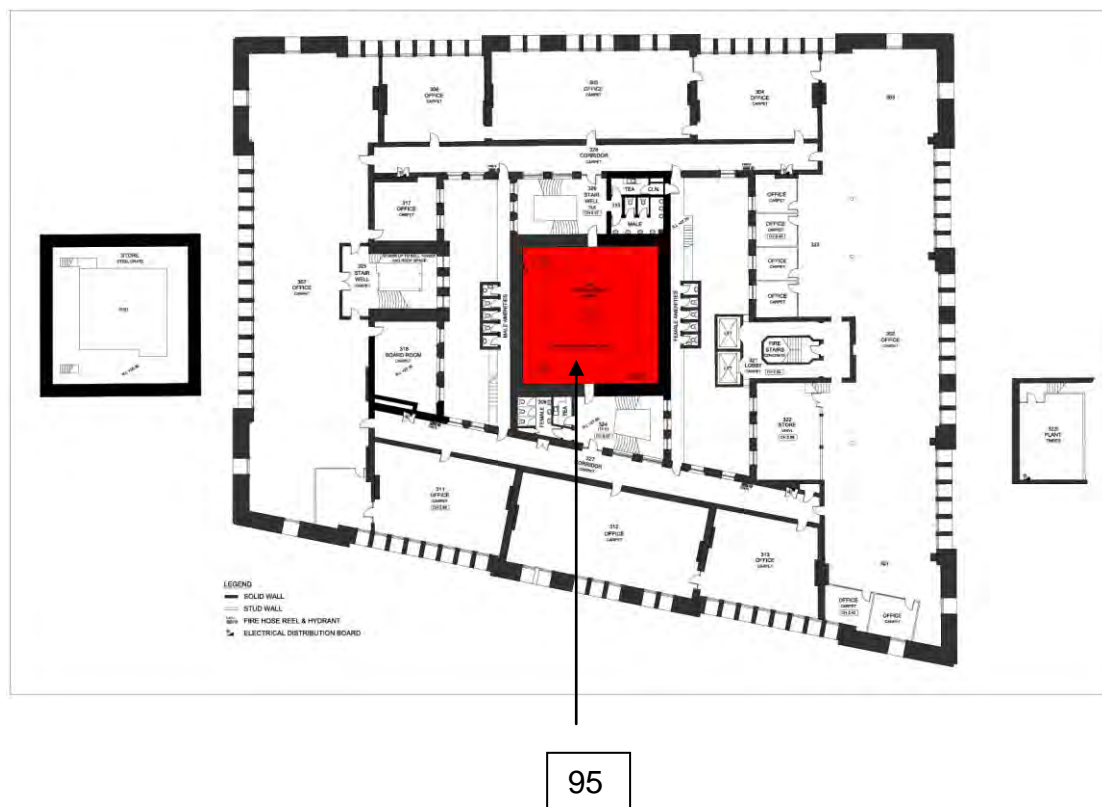

<b>Location</b> Lands Building	<b>Room No 316</b> Third Floor	<b>Item No</b> 95
<b>Title</b> Records furniture		
<b>Description</b> Quantity of filing systems, plan cabinets, map tubes and associated labelling housing survey records		
<b>Date</b> Content from early 19 <sup>th</sup> century to present	<b>Condition</b> Good	<b>Dimensions (W x D x H)</b> Various
<b>Photograph</b> 		

**Photograph**







**ITEMS SIGNIFICANT TO THE  
LANDS DEPARTMENT  
IN McKELL BUILDING**

<b>Location</b> Lands Building	<b>Room No</b> GAO, Public Works L19 McKell Building	<b>Item No</b> 96
<b>Title</b> Ballot box		
<b>Description</b> Australian red cedar ballot box, rectangular, mounted on timber base, with numbered balls		
<b>Date</b> Early 20 <sup>th</sup> century	<b>Condition</b> Good	<b>Dimensions (W x D x H)</b> 40 x 26.5 x 36cm
<b>Other information</b>		
		
Ballot box and tray in Minister for Lands office SLNSW Government Printer		

**Photograph**



**Photograph**



## Accompanying documentation

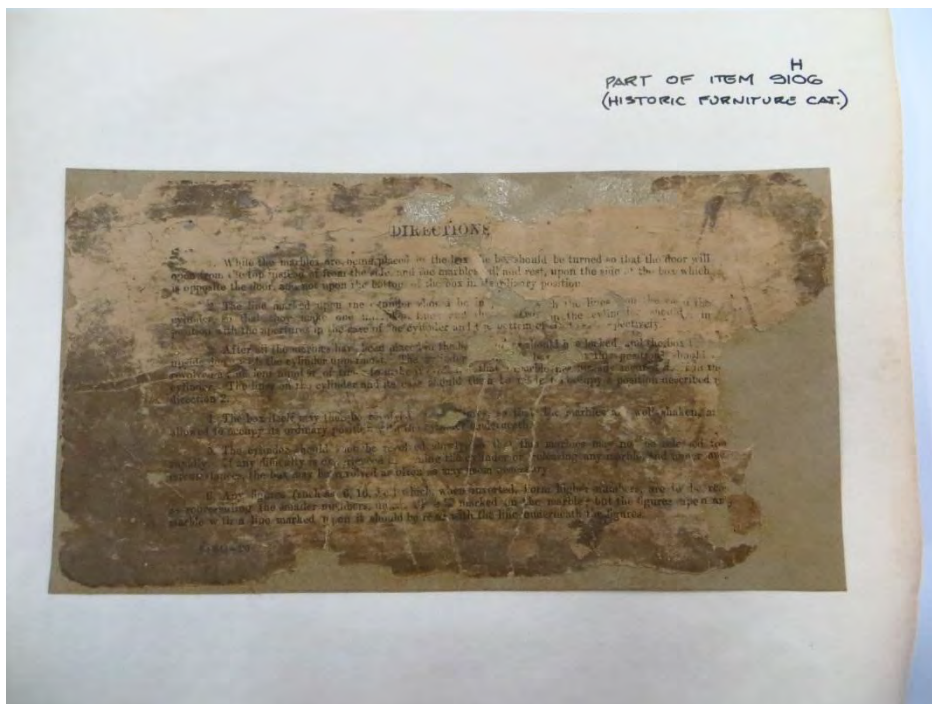
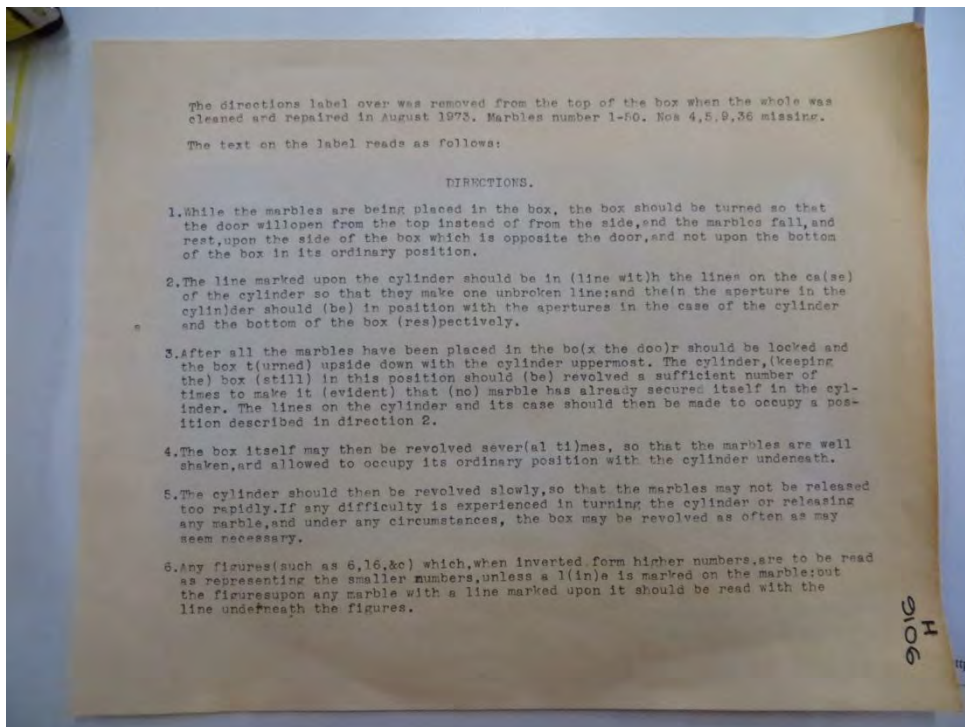

**Associated information****Significance**

Exceptional – associated with public office of Lands Department, high interpretive value

**Recommendation**

This item has museum value as an item of State significance. However, it would be more relevant to incorporate it into a permanent interpretive display in the Lands Building if its long term safety could be ensured.

<b>Location</b> Lands Building	<b>Room No</b> GAO, NSW Public Works, McKell Building	<b>Item No</b> 97
<b>Title</b> Ballot box		
<b>Description</b> Australian red cedar ballot box, rectangular, with oval opening		
<b>Date</b> Early-mid 20 <sup>th</sup> century	<b>Condition</b> Very good	<b>Dimensions (W x D x H)</b> 30 x 15 x 15.5cm
<b>Photograph</b>		
		
<b>Significance</b> High – associated with public office and activity of Lands Department, associated with land releases in NSW		
<b>Recommendation</b> This item has museum value as an item of State significance. However, it would be more relevant to incorporate it into a permanent interpretive display in the Lands Building if its long term safety could be ensured.		