

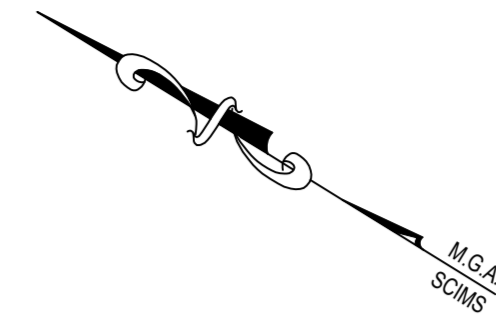

PO BOX 3222,
 REDFERN NSW 2016
 Ph: 02 8065 1156
 Fax: 02 8065 1297
 Email: survey@daw-walton.com.au

REVISION: 18
 DATED: 22-04-2026

SITE PLAN



SHORT/ARC LINE TABLE		
	Bearing	Distance
1	78° 09' 45"	3.925
2	34° 02' 25"	3.885
3	350° 19' 05"	3.885
4	86° 36' 00"	1.680
	2.06 ARC	0.955 RAD

DRAFT STRATUM SUBDIVISION PLAN - AMENDING SSD APPLICATION
 PREPARED FROM ARCHITECTURAL PLANS BY TURNER,
 JOB No: 19073, DATED: 24-10-2025

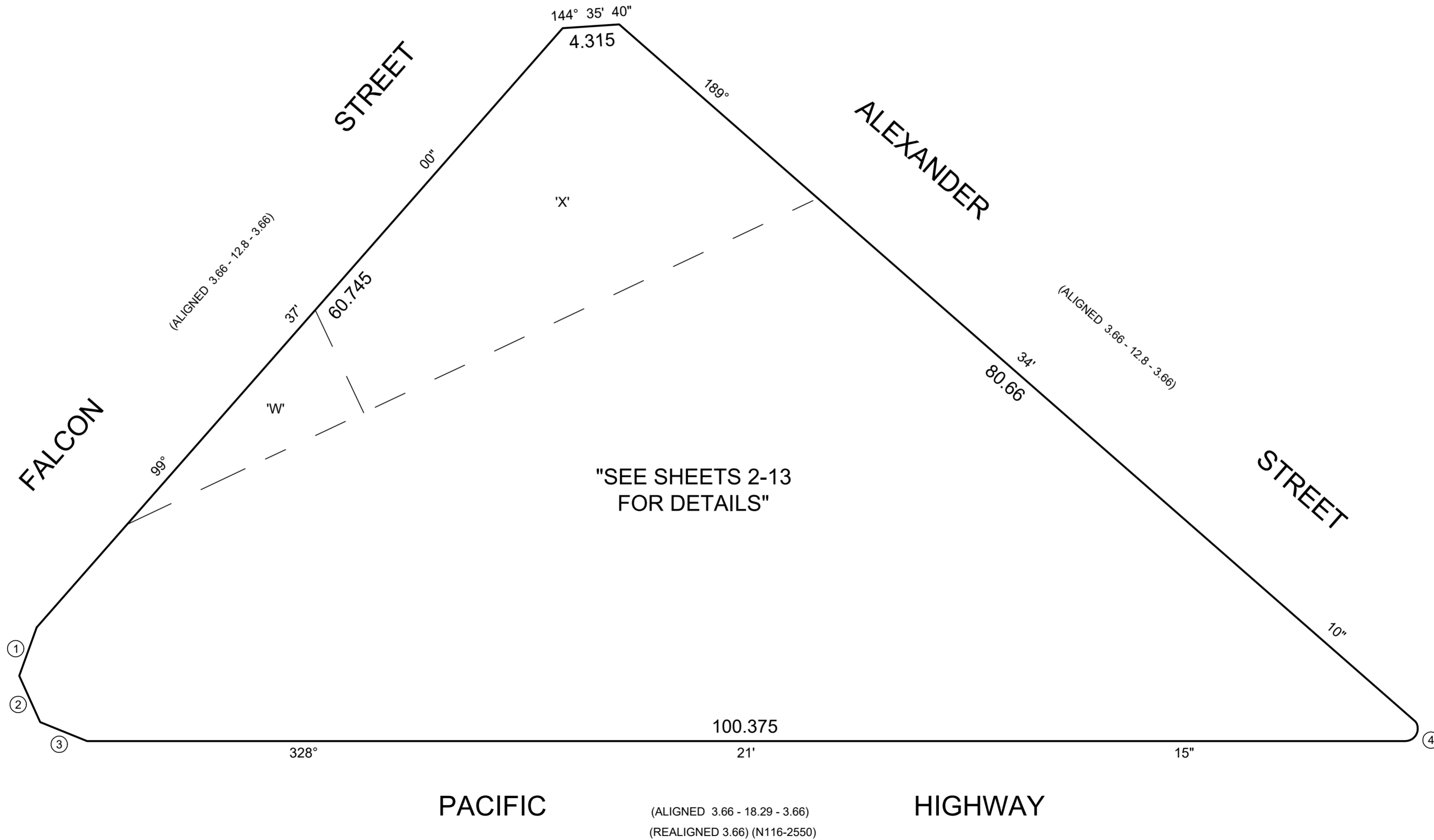

LOT 1 IS UNLIMITED IN HEIGHT AND DEPTH EXCEPT FOR THE PARTS DESIGNATED 'W' & 'X'

'W' DENOTES PART LOT UNLIMITED IN HEIGHT & DEPTH EXCLUDING THE LAND BETWEEN RL50.25 AND RL 73.35, BEING PART LOT 70 IN DP1231642

'X' DENOTES PART LOT UNLIMITED IN HEIGHT & DEPTH EXCLUDING THE LAND BETWEEN RL48.25 AND RL 71.35, BEING PART LOT 70 IN DP1231642

SURVEYOR: **JOHN WALTON**
 DATE OF SURVEY: -----
 SURVEYOR'S REF: **4950-20DP**

PLAN OF: **SUBDIVISION OF LOT 1
 IN DP1305704**

LGA: **NORTH SYDNEY**
 LOCALITY: **CROWS NEST**
 SUBDIVISION No:
 Lengths are in metres. Reduction Ratio **1:200**

REGISTERED:

DP1305704



PO BOX 3222,
 REDFERN NSW 2016
 Ph: 02 8065 1156
 Fax: 02 8065 1297
 Email: survey@daw-walton.com.au

REVISION: 18
 DATED: 22-04-2026

DRAFT STRATUM SUBDIVISION PLAN - AMENDING SSD APPLICATION
 PREPARED FROM ARCHITECTURAL PLANS BY TURNER,
 JOB No: 19073, DATED: 24-10-2025

**BASEMENT 3
& BELOW**

- LOT 1 RETAIL
- LOT 2 HOTEL
- LOT 3 RESIDENTIAL
- LOT 4 AFFORDABLE

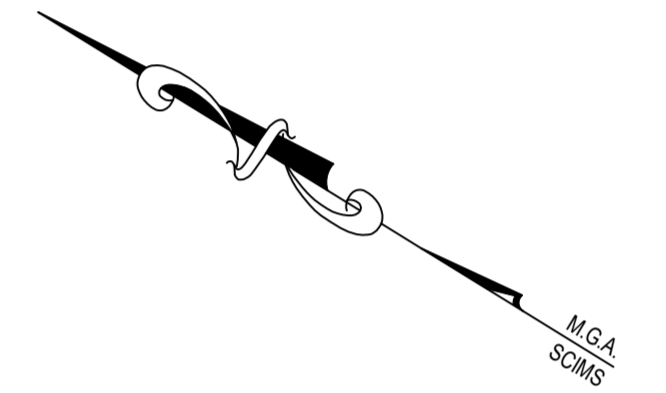

PT3 & 4
 (3200m²)

BASEMENT BOUNDARIES AND EASEMENTS TO BE CONFIRMED
 UPON COMPLETION OF CARPARK AND STORAGE ALLOCATIONS
 AND FINAL SURVEY IN ACCORDANCE WITH APPROVED DA

PROPOSED BOUNDARIES HEREIN SUBJECT TO CHANGE TO FACILITATE FUTURE
 ALLOCATIONS, PLAN AMENDMENTS AND DEVELOPMENT CONDITIONS/APPROVALS

EASEMENTS TO BE ADDED TO FINAL PLAN OF SUBDIVISION AS REQUIRED BY THE
 DEVELOPMENT APPROVAL, SITE ACCESS AND SERVICING REQUIREMENTS OF THE
 DEVELOPMENT

PART LOT HEIGHT LIMITATIONS TO BE ADDED TO FINAL PLAN OF SUBDIVISION

SURVEYOR: **JOHN WALTON**
 DATE OF SURVEY: -----
 SURVEYOR'S REF: **4950-20DP**

PLAN OF: **SUBDIVISION OF LOT 1
 IN DP1305704**

LGA: **NORTH SYDNEY**
 LOCALITY: **CROWS NEST**
 SUBDIVISION No:
 Lengths are in metres. Reduction Ratio 1:200

REGISTERED:

DP1305704



PO BOX 3222,
 REDFERN NSW 2016
 Ph: 02 8065 1156
 Fax: 02 8065 1297
 Email: survey@daw-walton.com.au

REVISION: 18
 DATED: 22-04-2026

DRAFT STRATUM SUBDIVISION PLAN - AMENDING SSD APPLICATION
 PREPARED FROM ARCHITECTURAL PLANS BY TURNER,
 JOB No: 19073, DATED: 24-10-2025

BASEMENT 2

- LOT 1 RETAIL
- LOT 2 HOTEL
- LOT 3 RESIDENTIAL
- LOT 4 AFFORDABLE

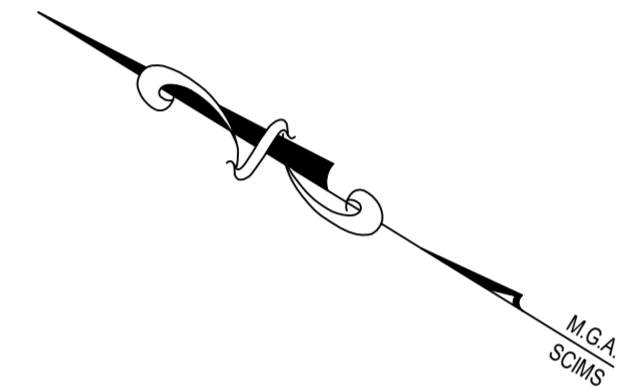

PT3 & 4
 (3184m²)

PT2
 (16m²)

BASEMENT BOUNDARIES AND EASEMENTS TO BE CONFIRMED
 UPON COMPLETION OF CARPARK AND STORAGE ALLOCATIONS
 AND FINAL SURVEY IN ACCORDANCE WITH APPROVED DA

PROPOSED BOUNDARIES HEREIN SUBJECT TO CHANGE TO FACILITATE FUTURE
 ALLOCATIONS, PLAN AMENDMENTS AND DEVELOPMENT CONDITIONS/APPROVALS

EASEMENTS TO BE ADDED TO FINAL PLAN OF SUBDIVISION AS REQUIRED BY THE
 DEVELOPMENT APPROVAL, SITE ACCESS AND SERVICING REQUIREMENTS OF THE
 DEVELOPMENT

PART LOT HEIGHT LIMITATIONS TO BE ADDED TO FINAL PLAN OF SUBDIVISION

SURVEYOR: **JOHN WALTON**
 DATE OF SURVEY: -----
 SURVEYOR'S REF: **4950-20DP**

PLAN OF: **SUBDIVISION OF LOT 1
 IN DP1305704**

LGA: **NORTH SYDNEY**
 LOCALITY: **CROWS NEST**
 SUBDIVISION No:
 Lengths are in metres. Reduction Ratio 1:200

REGISTERED:

DP1305704



PO BOX 3222,
REDFERN NSW 2016
Ph: 02 8065 1156
Fax: 02 8065 1297
Email: survey@daw-walton.com.au

REVISION: 18
DATED: 22-04-2026

DRAFT STRATUM SUBDIVISION PLAN - AMENDING SSD APPLICATION
PREPARED FROM ARCHITECTURAL PLANS BY TURNER,
JOB No: 19073, DATED: 24-10-2025

BASEMENT 1

- LOT 1 RETAIL
- LOT 2 HOTEL
- LOT 3 RESIDENTIAL
- LOT 4 AFFORDABLE

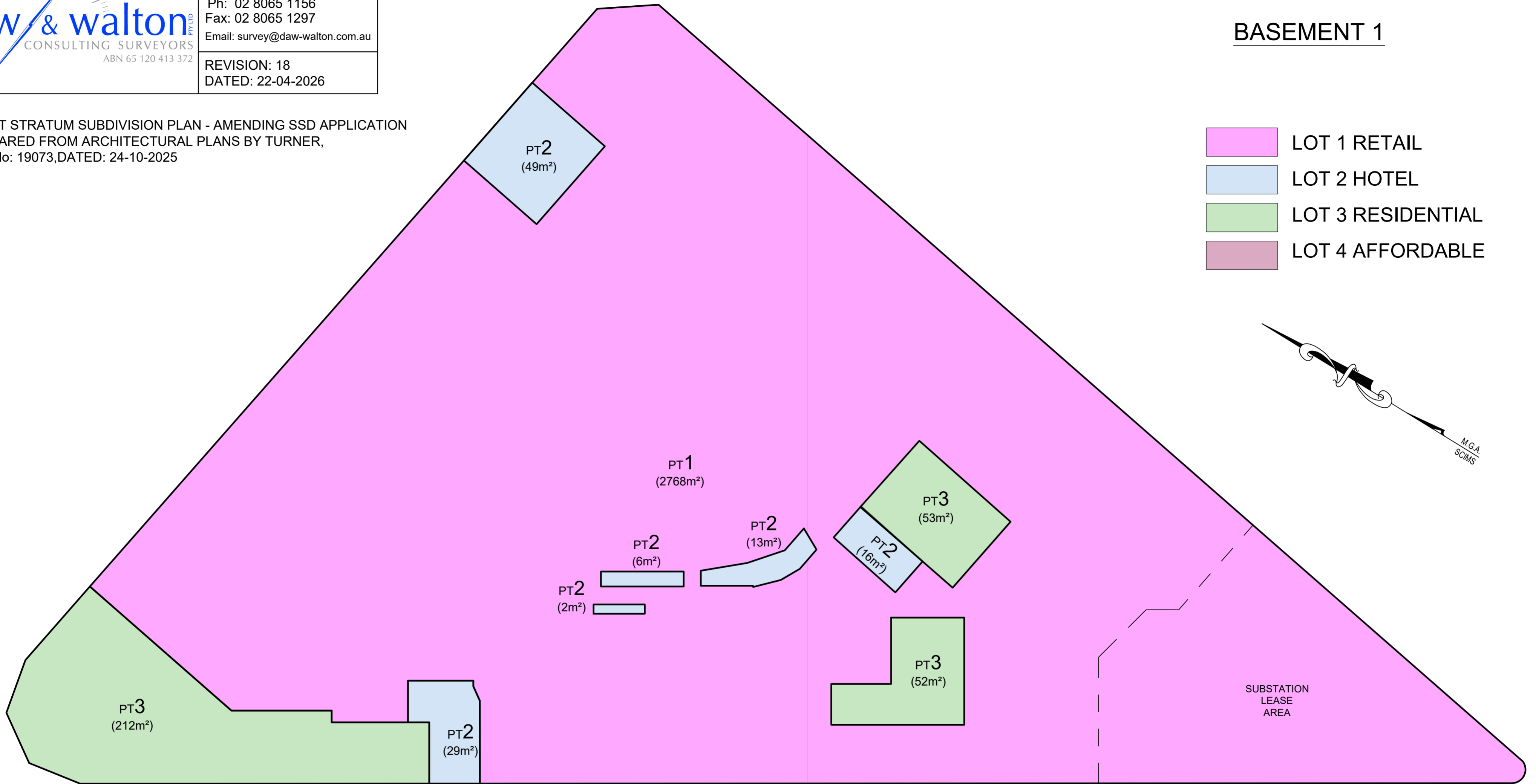
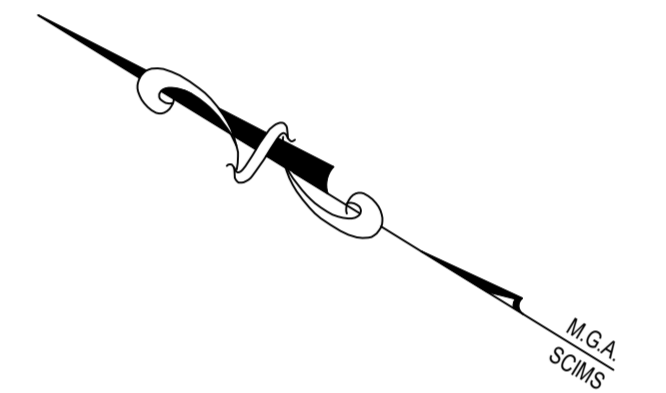

PROPOSED BOUNDARIES HEREIN SUBJECT TO CHANGE TO FACILITATE FUTURE ALLOCATIONS, PLAN AMENDMENTS AND DEVELOPMENT CONDITIONS/APPROVALS

EASEMENTS TO BE ADDED TO FINAL PLAN OF SUBDIVISION AS REQUIRED BY THE DEVELOPMENT APPROVAL, SITE ACCESS AND SERVICING REQUIREMENTS OF THE DEVELOPMENT

PART LOT HEIGHT LIMITATIONS TO BE ADDED TO FINAL PLAN OF SUBDIVISION

SURVEYOR: **JOHN WALTON**
DATE OF SURVEY: -----
SURVEYOR'S REF: **4950-20DP**

PLAN OF: **SUBDIVISION OF LOT 1
IN DP1305704**

LGA: **NORTH SYDNEY**
LOCALITY: **CROWS NEST**
SUBDIVISION No:
Lengths are in metres. Reduction Ratio 1:200

REGISTERED:

DP1305704



PO BOX 3222,
 REDFERN NSW 2016
 Ph: 02 8065 1156
 Fax: 02 8065 1297
 Email: survey@daw-walton.com.au

REVISION: 18
 DATED: 22-04-2026

DRAFT STRATUM SUBDIVISION PLAN - AMENDING SSD APPLICATION
 PREPARED FROM ARCHITECTURAL PLANS BY TURNER,
 JOB No: 19073, DATED: 24-10-2025

GROUND FLOOR

- LOT 1 RETAIL
- LOT 2 HOTEL
- LOT 3 RESIDENTIAL
- LOT 4 AFFORDABLE

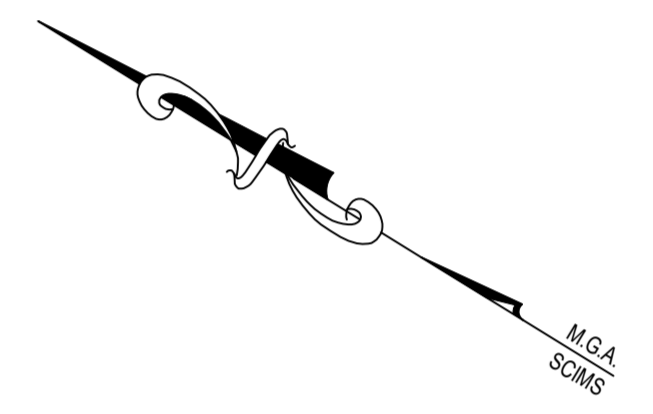

PROPOSED BOUNDARIES HEREIN SUBJECT TO CHANGE TO FACILITATE FUTURE ALLOCATIONS, PLAN AMENDMENTS AND DEVELOPMENT CONDITIONS/APPROVALS

EASEMENTS TO BE ADDED TO FINAL PLAN OF SUBDIVISION AS REQUIRED BY THE DEVELOPMENT APPROVAL, SITE ACCESS AND SERVICING REQUIREMENTS OF THE DEVELOPMENT

PART LOT HEIGHT LIMITATIONS TO BE ADDED TO FINAL PLAN OF SUBDIVISION

SURVEYOR: **JOHN WALTON**
 DATE OF SURVEY: -----
 SURVEYOR'S REF: **4950-20DP**

PLAN OF: **SUBDIVISION OF LOT 1
 IN DP1305704**

LGA: **NORTH SYDNEY**
 LOCALITY: **CROWS NEST**
 SUBDIVISION No:
 Lengths are in metres. Reduction Ratio 1:200

REGISTERED:

DP1305704



PO BOX 3222,
 REDFERN NSW 2016
 Ph: 02 8065 1156
 Fax: 02 8065 1297
 Email: survey@daw-walton.com.au

REVISION: 18
 DATED: 22-04-2026

DRAFT STRATUM SUBDIVISION PLAN - AMENDING SSD APPLICATION
 PREPARED FROM ARCHITECTURAL PLANS BY TURNER,
 JOB No: 19073, DATED: 24-10-2025

MEZZANINE

- LOT 1 RETAIL
- LOT 2 HOTEL
- LOT 3 RESIDENTIAL
- LOT 4 AFFORDABLE



PROPOSED BOUNDARIES HEREIN SUBJECT TO CHANGE TO FACILITATE FUTURE ALLOCATIONS, PLAN AMENDMENTS AND DEVELOPMENT CONDITIONS/APPROVALS

EASEMENTS TO BE ADDED TO FINAL PLAN OF SUBDIVISION AS REQUIRED BY THE DEVELOPMENT APPROVAL, SITE ACCESS AND SERVICING REQUIREMENTS OF THE DEVELOPMENT

PART LOT HEIGHT LIMITATIONS TO BE ADDED TO FINAL PLAN OF SUBDIVISION

SURVEYOR: **JOHN WALTON**
 DATE OF SURVEY: -----
 SURVEYOR'S REF: **4950-20DP**

PLAN OF: **SUBDIVISION OF LOT 1
 IN DP1305704**

LGA: **NORTH SYDNEY**
 LOCALITY: **CROWS NEST**
 SUBDIVISION No:
 Lengths are in metres. Reduction Ratio 1:200

REGISTERED:

DP1305704



PO BOX 3222,
REDFERN NSW 2016
Ph: 02 8065 1156
Fax: 02 8065 1297
Email: survey@daw-walton.com.au

REVISION: 18
DATED: 22-04-2026

DRAFT STRATUM SUBDIVISION PLAN - AMENDING SSD APPLICATION
PREPARED FROM ARCHITECTURAL PLANS BY TURNER,
JOB No: 19073, DATED: 24-10-2025

LEVEL 1

- LOT 1 RETAIL
- LOT 2 HOTEL
- LOT 3 RESIDENTIAL
- LOT 4 AFFORDABLE

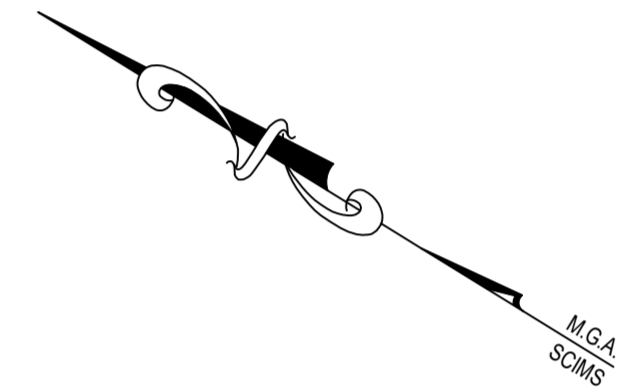
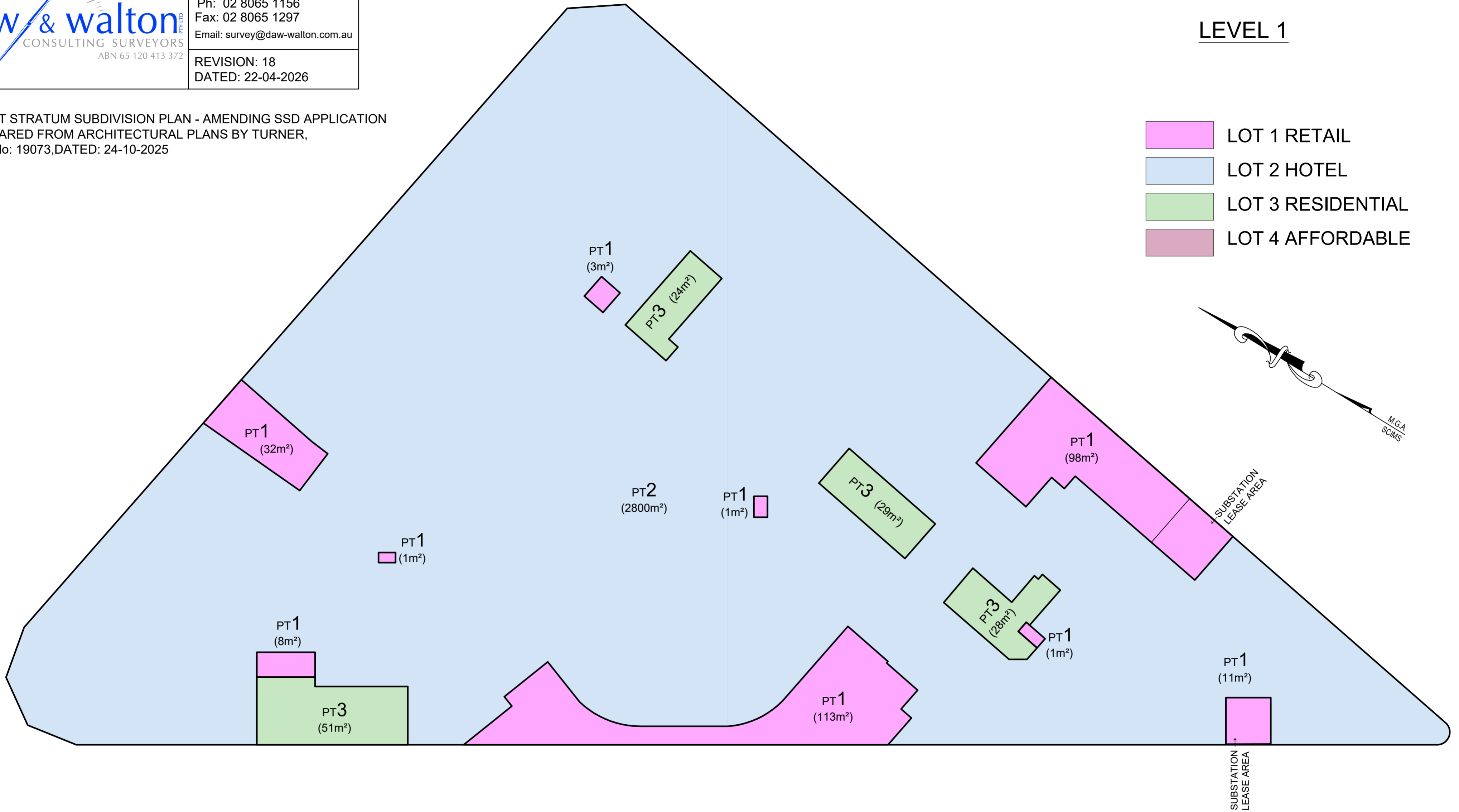

PROPOSED BOUNDARIES HEREIN SUBJECT TO CHANGE TO FACILITATE FUTURE ALLOCATIONS, PLAN AMENDMENTS AND DEVELOPMENT CONDITIONS/APPROVALS

EASEMENTS TO BE ADDED TO FINAL PLAN OF SUBDIVISION AS REQUIRED BY THE DEVELOPMENT APPROVAL, SITE ACCESS AND SERVICING REQUIREMENTS OF THE DEVELOPMENT

PART LOT HEIGHT LIMITATIONS TO BE ADDED TO FINAL PLAN OF SUBDIVISION

SURVEYOR: **JOHN WALTON**
DATE OF SURVEY: -----
SURVEYOR'S REF: **4950-20DP**

PLAN OF: **SUBDIVISION OF LOT 1
IN DP1305704**

LGA: **NORTH SYDNEY**
LOCALITY: **CROWS NEST**
SUBDIVISION No:
Lengths are in metres. Reduction Ratio 1:200

REGISTERED:

DP1305704



PO BOX 3222,
 REDFERN NSW 2016
 Ph: 02 8065 1156
 Fax: 02 8065 1297
 Email: survey@daw-walton.com.au

REVISION: 18
 DATED: 22-04-2026

DRAFT STRATUM SUBDIVISION PLAN - AMENDING SSD APPLICATION
 PREPARED FROM ARCHITECTURAL PLANS BY TURNER,
 JOB No: 19073, DATED: 24-10-2025

LEVEL 2

- LOT 1 RETAIL
- LOT 2 HOTEL
- LOT 3 RESIDENTIAL
- LOT 4 AFFORDABLE

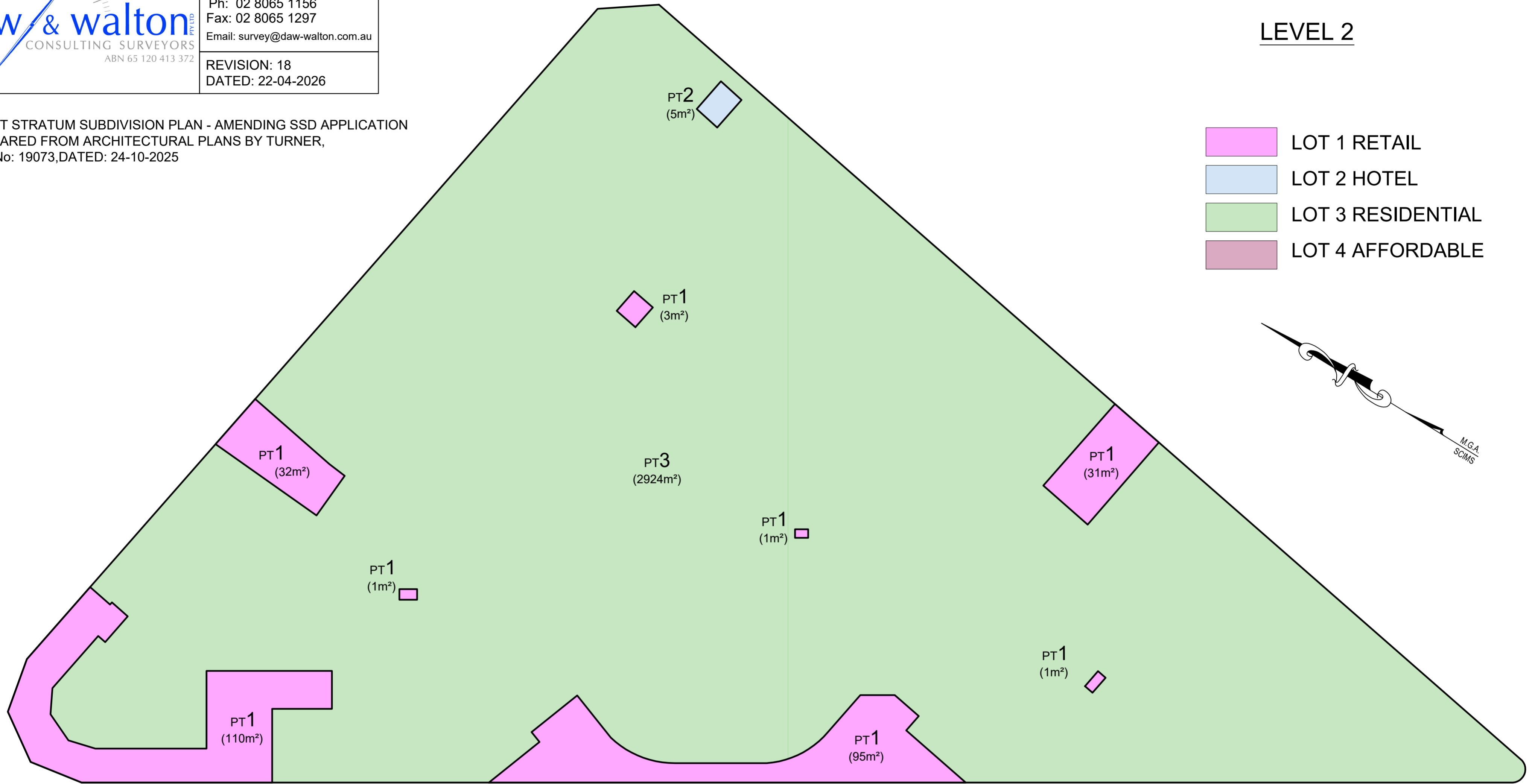
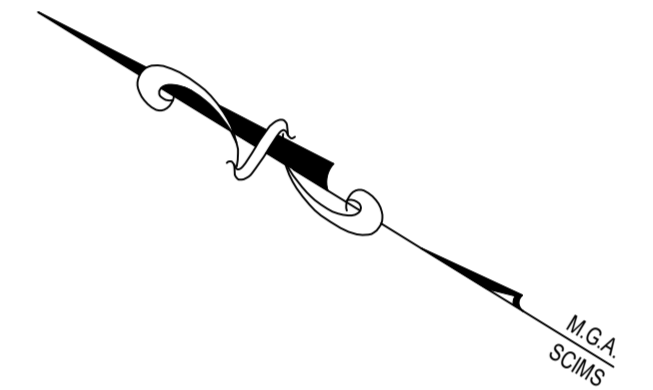

PROPOSED BOUNDARIES HEREIN SUBJECT TO CHANGE TO FACILITATE FUTURE ALLOCATIONS, PLAN AMENDMENTS AND DEVELOPMENT CONDITIONS/APPROVALS

EASEMENTS TO BE ADDED TO FINAL PLAN OF SUBDIVISION AS REQUIRED BY THE DEVELOPMENT APPROVAL, SITE ACCESS AND SERVICING REQUIREMENTS OF THE DEVELOPMENT

PART LOT HEIGHT LIMITATIONS TO BE ADDED TO FINAL PLAN OF SUBDIVISION

SURVEYOR: **JOHN WALTON**
 DATE OF SURVEY: -----
 SURVEYOR'S REF: **4950-20DP**

PLAN OF: **SUBDIVISION OF LOT 1
 IN DP1305704**

LGA: **NORTH SYDNEY**
 LOCALITY: **CROWS NEST**
 SUBDIVISION No:
 Lengths are in metres. Reduction Ratio 1:200

REGISTERED:

DP1305704



PO BOX 3222,
 REDFERN NSW 2016
 Ph: 02 8065 1156
 Fax: 02 8065 1297
 Email: survey@daw-walton.com.au

REVISION: 18
 DATED: 22-04-2026

DRAFT STRATUM SUBDIVISION PLAN - AMENDING SSD APPLICATION
 PREPARED FROM ARCHITECTURAL PLANS BY TURNER,
 JOB No: 19073, DATED: 24-10-2025

LEVEL 3

- LOT 1 RETAIL
- LOT 2 HOTEL
- LOT 3 RESIDENTIAL
- LOT 4 AFFORDABLE

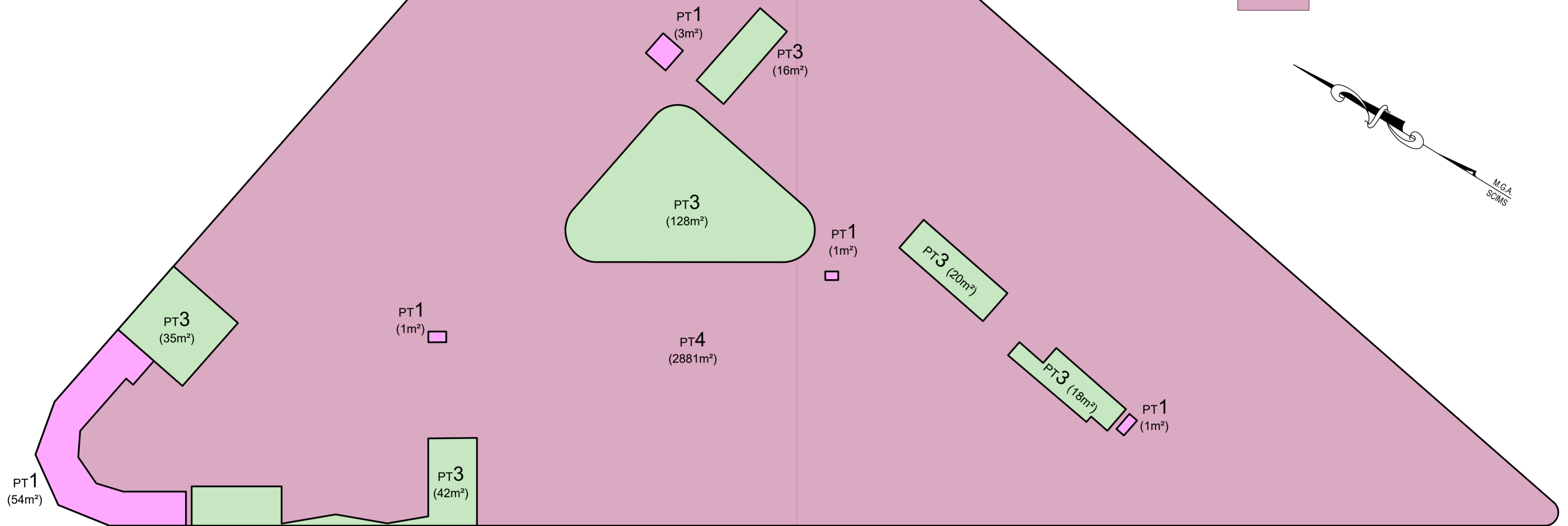
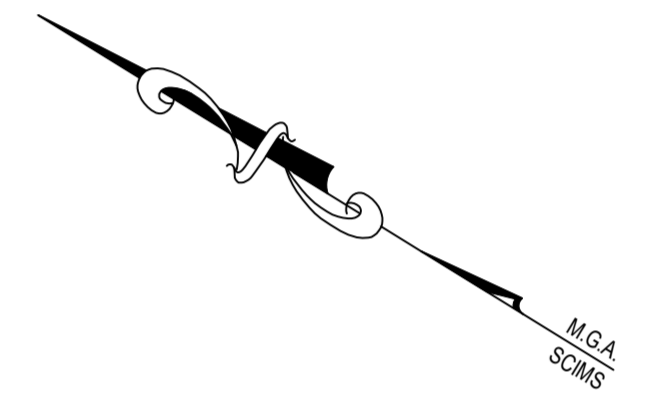

PROPOSED BOUNDARIES HEREIN SUBJECT TO CHANGE TO FACILITATE FUTURE ALLOCATIONS, PLAN AMENDMENTS AND DEVELOPMENT CONDITIONS/APPROVALS

EASEMENTS TO BE ADDED TO FINAL PLAN OF SUBDIVISION AS REQUIRED BY THE DEVELOPMENT APPROVAL, SITE ACCESS AND SERVICING REQUIREMENTS OF THE DEVELOPMENT

PART LOT HEIGHT LIMITATIONS TO BE ADDED TO FINAL PLAN OF SUBDIVISION

SURVEYOR: **JOHN WALTON**
 DATE OF SURVEY: -----
 SURVEYOR'S REF: **4950-20DP**

PLAN OF: **SUBDIVISION OF LOT 1
 IN DP1305704**

LGA: **NORTH SYDNEY**
 LOCALITY: **CROWS NEST**
 SUBDIVISION No:
 Lengths are in metres. Reduction Ratio 1:200

REGISTERED:

DP1305704



PO BOX 3222,
REDFERN NSW 2016
Ph: 02 8065 1156
Fax: 02 8065 1297
Email: survey@daw-walton.com.au

REVISION: 18
DATED: 22-04-2026

DRAFT STRATUM SUBDIVISION PLAN - AMENDING SSD APPLICATION
PREPARED FROM ARCHITECTURAL PLANS BY TURNER,
JOB No: 19073, DATED: 24-10-2025

LEVEL 4-7

- LOT 1 RETAIL
- LOT 2 HOTEL
- LOT 3 RESIDENTIAL
- LOT 4 AFFORDABLE

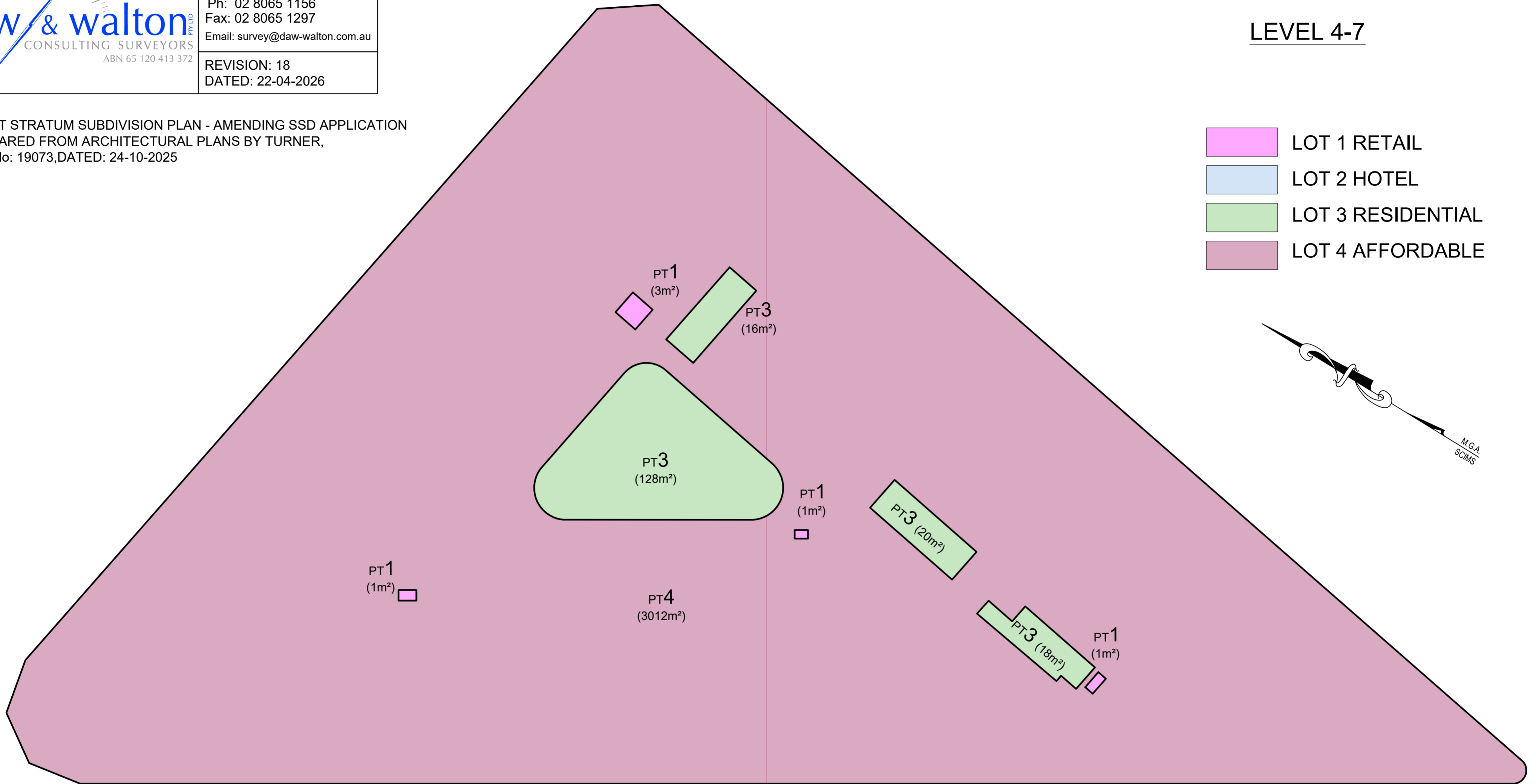
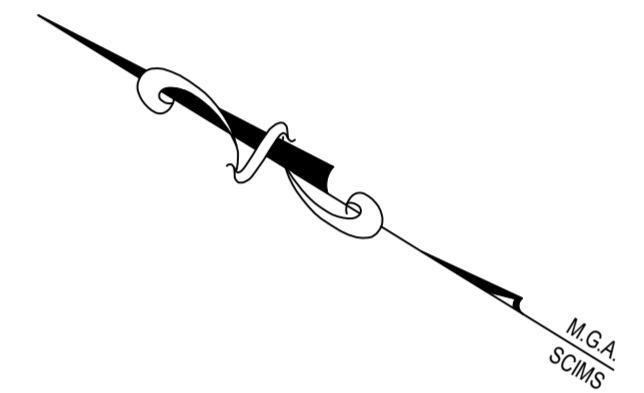

PROPOSED BOUNDARIES HEREIN SUBJECT TO CHANGE TO FACILITATE FUTURE ALLOCATIONS, PLAN AMENDMENTS AND DEVELOPMENT CONDITIONS/APPROVALS

EASEMENTS TO BE ADDED TO FINAL PLAN OF SUBDIVISION AS REQUIRED BY THE DEVELOPMENT APPROVAL, SITE ACCESS AND SERVICING REQUIREMENTS OF THE DEVELOPMENT

PART LOT HEIGHT LIMITATIONS TO BE ADDED TO FINAL PLAN OF SUBDIVISION

SURVEYOR: **JOHN WALTON**
DATE OF SURVEY: -----
SURVEYOR'S REF: **4950-20DP**

PLAN OF: **SUBDIVISION OF LOT 1
IN DP1305704**

LGA: **NORTH SYDNEY**
LOCALITY: **CROWS NEST**
SUBDIVISION No:
Lengths are in metres. Reduction Ratio 1:200

REGISTERED:

DP1305704



PO BOX 3222,
 REDFERN NSW 2016
 Ph: 02 8065 1156
 Fax: 02 8065 1297
 Email: survey@daw-walton.com.au

REVISION: 18
 DATED: 22-04-2026

DRAFT STRATUM SUBDIVISION PLAN - AMENDING SSD APPLICATION
 PREPARED FROM ARCHITECTURAL PLANS BY TURNER,
 JOB No: 19073, DATED: 24-10-2025

LEVEL 8-28

- LOT 1 RETAIL
- LOT 2 HOTEL
- LOT 3 RESIDENTIAL
- LOT 4 AFFORDABLE

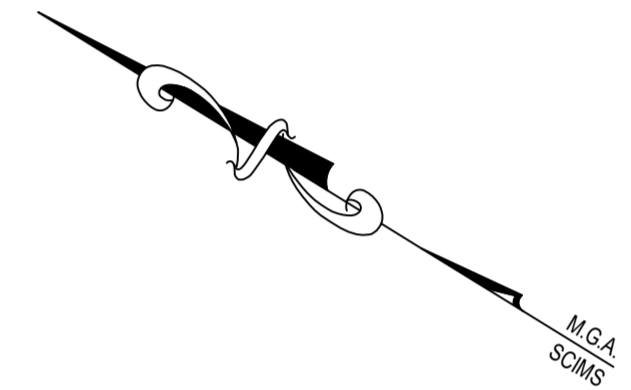
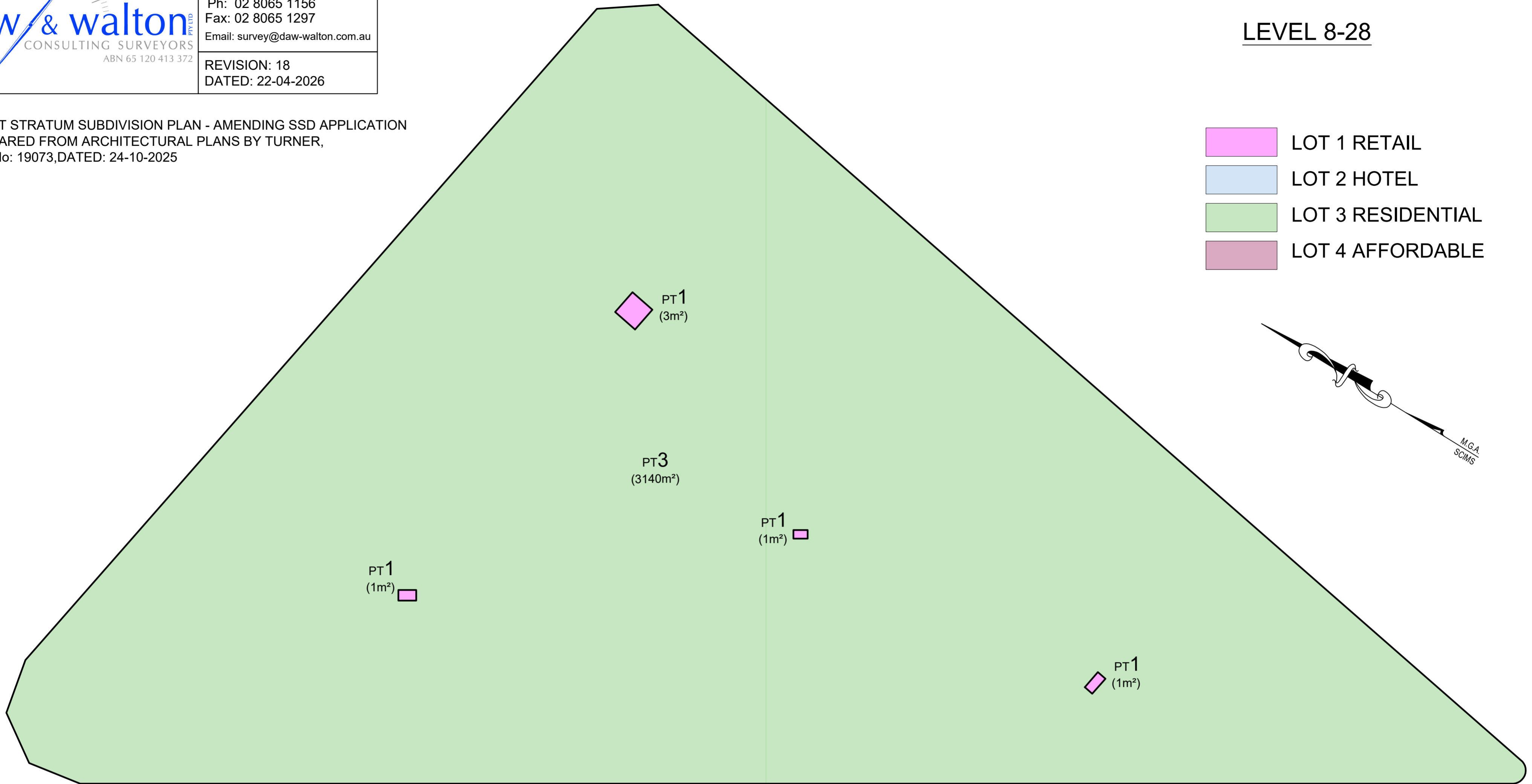

PROPOSED BOUNDARIES HEREIN SUBJECT TO CHANGE TO FACILITATE FUTURE ALLOCATIONS, PLAN AMENDMENTS AND DEVELOPMENT CONDITIONS/APPROVALS

EASEMENTS TO BE ADDED TO FINAL PLAN OF SUBDIVISION AS REQUIRED BY THE DEVELOPMENT APPROVAL, SITE ACCESS AND SERVICING REQUIREMENTS OF THE DEVELOPMENT

PART LOT HEIGHT LIMITATIONS TO BE ADDED TO FINAL PLAN OF SUBDIVISION

SURVEYOR: **JOHN WALTON**
 DATE OF SURVEY: -----
 SURVEYOR'S REF: **4950-20DP**

PLAN OF: **SUBDIVISION OF LOT 1
 IN DP1305704**

LGA: **NORTH SYDNEY**
 LOCALITY: **CROWS NEST**
 SUBDIVISION No:
 Lengths are in metres. Reduction Ratio 1:200

REGISTERED:

DP1305704



PO BOX 3222,
 REDFERN NSW 2016
 Ph: 02 8065 1156
 Fax: 02 8065 1297
 Email: survey@daw-walton.com.au

REVISION: 18
 DATED: 22-04-2026

DRAFT STRATUM SUBDIVISION PLAN - AMENDING SSD APPLICATION
 PREPARED FROM ARCHITECTURAL PLANS BY TURNER,
 JOB No: 19073, DATED: 24-10-2025

LEVEL 29
COMMUNAL TERRACE

- LOT 1 RETAIL
- LOT 2 HOTEL
- LOT 3 RESIDENTIAL
- LOT 4 AFFORDABLE

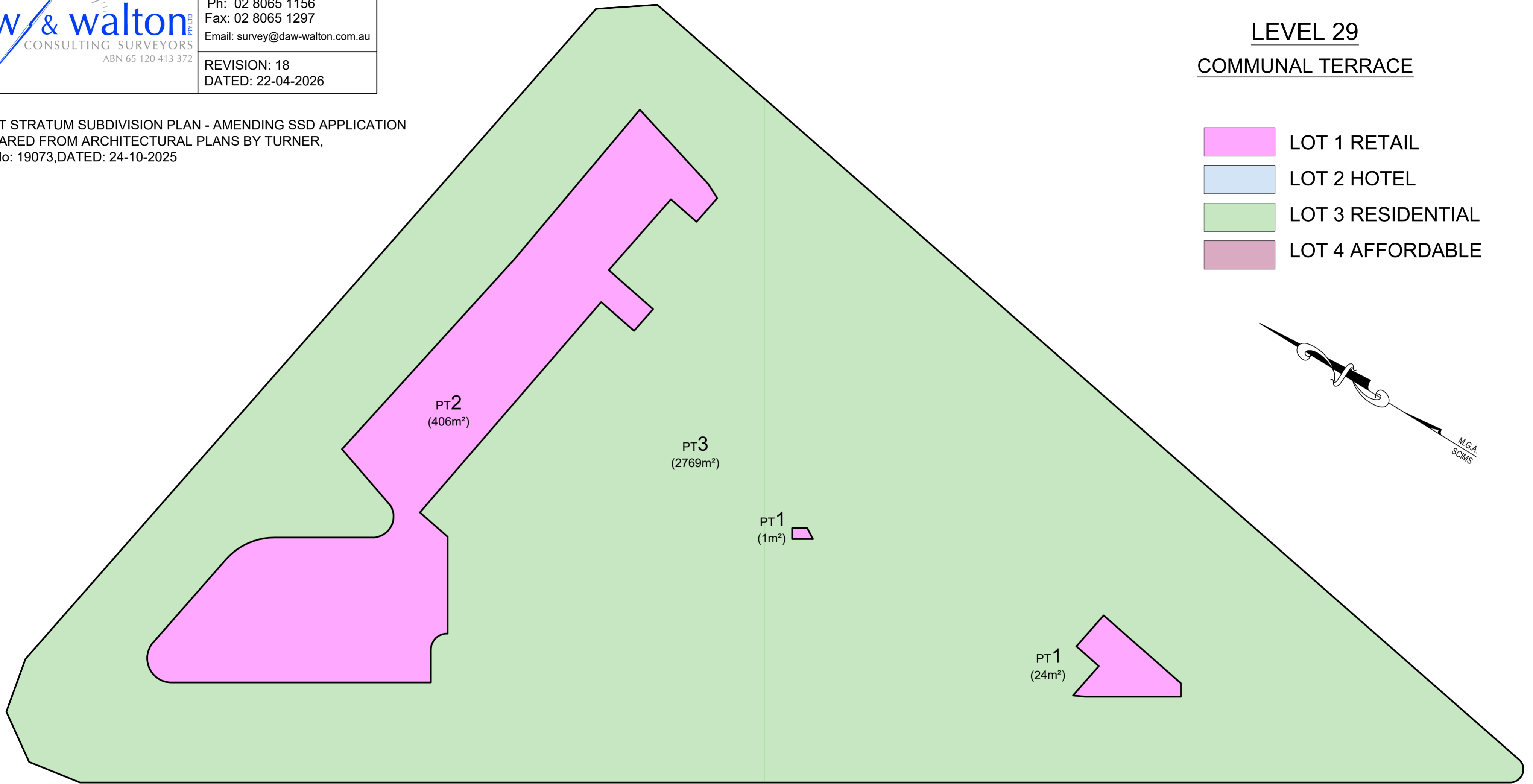

PROPOSED BOUNDARIES HEREIN SUBJECT TO CHANGE TO FACILITATE FUTURE ALLOCATIONS, PLAN AMENDMENTS AND DEVELOPMENT CONDITIONS/APPROVALS

EASEMENTS TO BE ADDED TO FINAL PLAN OF SUBDIVISION AS REQUIRED BY THE DEVELOPMENT APPROVAL, SITE ACCESS AND SERVICING REQUIREMENTS OF THE DEVELOPMENT

PART LOT HEIGHT LIMITATIONS TO BE ADDED TO FINAL PLAN OF SUBDIVISION

SURVEYOR: **JOHN WALTON**
 DATE OF SURVEY: -----
 SURVEYOR'S REF: **4950-20DP**

PLAN OF: **SUBDIVISION OF LOT 1
 IN DP1305704**

LGA: **NORTH SYDNEY**
 LOCALITY: **CROWS NEST**
 SUBDIVISION No:
 Lengths are in metres. Reduction Ratio 1:200

REGISTERED:

DP1305704



PO BOX 3222,
 REDFERN NSW 2016
 Ph: 02 8065 1156
 Fax: 02 8065 1297
 Email: survey@daw-walton.com.au

REVISION: 18
 DATED: 22-04-2026

DRAFT STRATUM SUBDIVISION PLAN - AMENDING SSD APPLICATION
 PREPARED FROM ARCHITECTURAL PLANS BY TURNER,
 JOB No: 19073, DATED: 24-10-2025

UPPER ROOF
AND ABOVE

- LOT 1 RETAIL
- LOT 2 HOTEL
- LOT 3 RESIDENTIAL
- LOT 4 AFFORDABLE

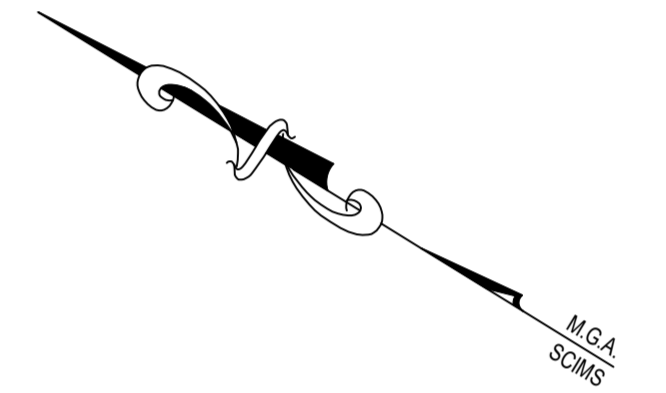
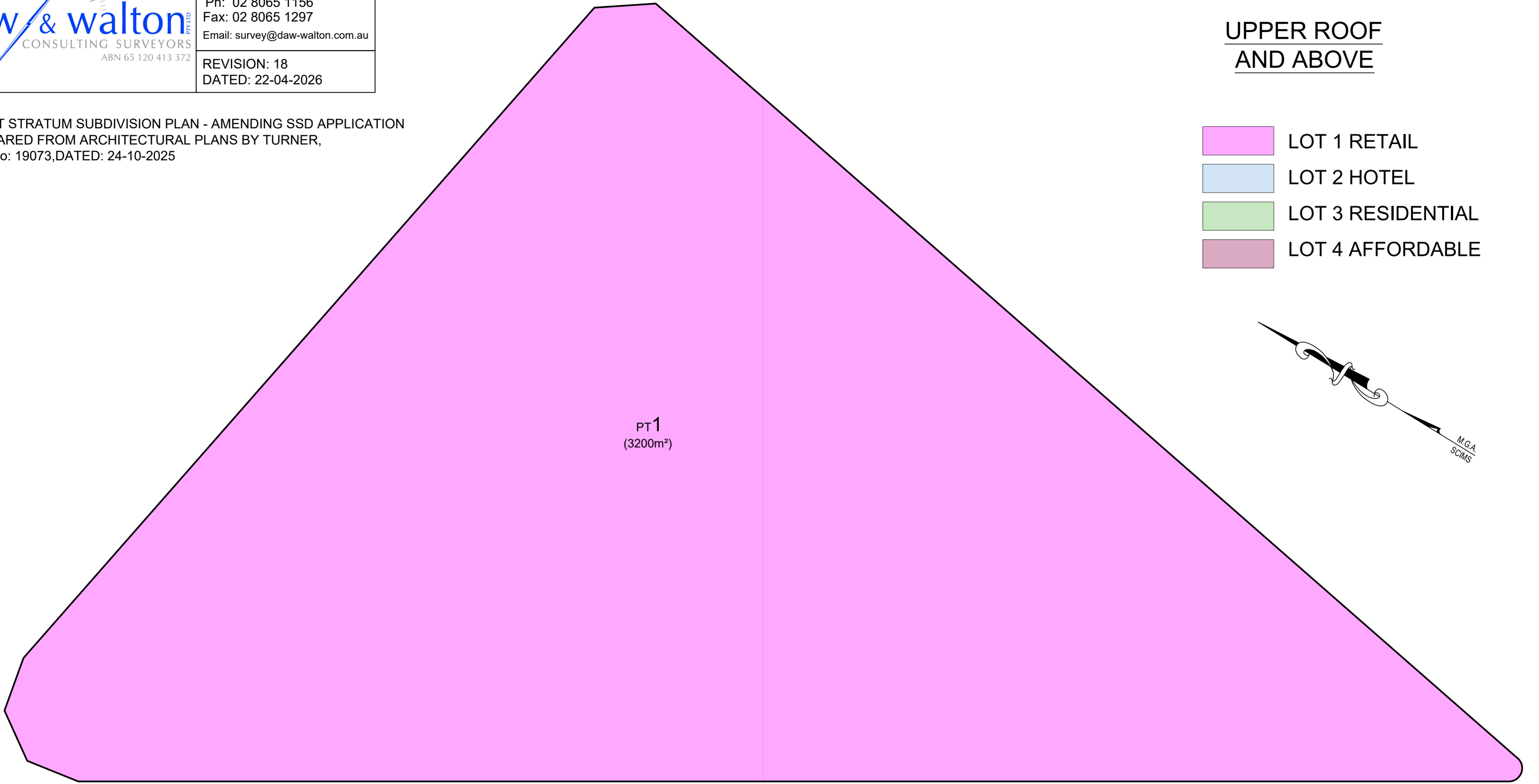

PROPOSED BOUNDARIES HEREIN SUBJECT TO CHANGE TO FACILITATE FUTURE ALLOCATIONS, PLAN AMENDMENTS AND DEVELOPMENT CONDITIONS/APPROVALS

EASEMENTS TO BE ADDED TO FINAL PLAN OF SUBDIVISION AS REQUIRED BY THE DEVELOPMENT APPROVAL, SITE ACCESS AND SERVICING REQUIREMENTS OF THE DEVELOPMENT

PART LOT HEIGHT LIMITATIONS TO BE ADDED TO FINAL PLAN OF SUBDIVISION

SURVEYOR: **JOHN WALTON**
 DATE OF SURVEY: -----
 SURVEYOR'S REF: **4950-20DP**

PLAN OF: **SUBDIVISION OF LOT 1
 IN DP1305704**

LGA: **NORTH SYDNEY**
 LOCALITY: **CROWS NEST**
 SUBDIVISION No:
 Lengths are in metres. Reduction Ratio 1:200

REGISTERED:

DP1305704