

Do not scale from drawings.
 Check all dimensions on site before commencing work.
 The Architect shall not be liable for any loss or damage whatsoever arising from or in respect of any errors, omissions or resulting from data transferred from the computer system of the Architect to systems of the Client or other Contractors.
 The Architect shall be responsible for checking accuracy and completeness of data received.
 Any use of the electronic data in part or whole shall be at the user's risk.
 The CAD files and their contents are solely representations of the Project information and cannot be relied upon to represent the representation shown on the PDF versions of the drawings as provided by the Architect.

No.	Amendment	By	Date
2	ISSUED FOR INFORMATION - REVISED BASEMENT		23/03/15
1	ISSUED FOR INFORMATION - REVISED BASEMENT		09/01/15

Key Plan:

Consultants:

Client:

FRASERS PROPERTY

L11, 488 Kent St.
 Sydney
 NSW, Australia 2000
 Tel. 61 2 8823 8800
 Fax. 61 2 8823 8801

Foster + Partners

Riverside, 22 Heister Road
 London SW11 4AN
 T +44 (0)20 7738 0455
 F +44 (0)20 7738 1107

Local Collaborating Architect

PTW Architects

Level 13, 9 Castlereagh St
 Sydney NSW Australia 2000

T +612 9232 5877
 F +612 9221 4139

NSW Non-Registered Architects
 S. Parsons Architect No. 6098
 D. Jones Architect No. 4778
 A. Parker Architect No. 5075
 A. Rossi Architect No. 5057

Approvals	By:	Date:
PTW Approval:		
Client Approval:		

NOT TO BE USED FOR CONSTRUCTION

Project:
Block 1 & 4N
 20-102 Broadway, Sydney, NSW 2000

Title:
B4N BASEMENT 04 PLAN

<Check Scalebar Scale>

Scale:	Plot Date:	Job No:
As indicated	23/03/2015 12:27:42 PM	212028

Dwg No:	Revision:
PA-A1-1750	2

Status:



Do not scale from drawings.
 Check all dimensions on site before commencing work.
 The Architect shall not be liable for any loss or damage whatsoever arising from or in respect of any errors, omissions or resulting from data transferred from the computer system of the Architect to systems of the Client or other Contractors.
 The recipient of the data shall be responsible for checking accuracy and completeness of data received.
 Any use of the electronic data in part or whole shall be at the user's risk.
 The CAD files and their contents are solely representations of the Project information and cannot be relied upon beyond the representation shown on the PDF versions of the drawings as provided by the Architect.

No.	Amendment	By	Date
2	ISSUED FOR INFORMATION - REVISED BASEMENT		23/03/15
1	ISSUED FOR INFORMATION - REVISED BASEMENT		09/01/15

Key Plan:

Consultants:

Client:
FRASERS PROPERTY
 L11, 488 Kent St.
 Sydney
 NSW Australia 2000
 Tel. 61 2 8823 8800
 Fax. 61 2 8823 8801

Foster + Partners
 Riverside, 22 Heister Road
 London SW11 4AN
 T +44 (0)20 7738 0455
 F +44 (0)20 7738 1107

Local Collaborating Architect
PTW Architects **PTW**
 Level 13, 9 Castlereagh St
 Sydney NSW Australia 2000
 T +612 9232 5877
 F +612 9221 4139
NSW Non-qualified Architects
 S Popovic Architect No. 6098
 D Jones Architect No. 4778
 A Popovic Architect No. 5075
 A Rossi Architect No. 5057

Approvals	By:	Date:
PTW Approval:		
Client Approval:		

NOT TO BE USED FOR CONSTRUCTION

Project:
Block 1 & 4N
 20-102 Broadway, Sydney, NSW 2000

Title:
B4N BASEMENT 02 PLAN

<Check Scalebar Scale>		
Scale: As indicated	Plot Date: 23/03/2015 12:27:45 PM	Job No: 212028
Dwg No: PA-A1-1752	Revision: 2	

Status:

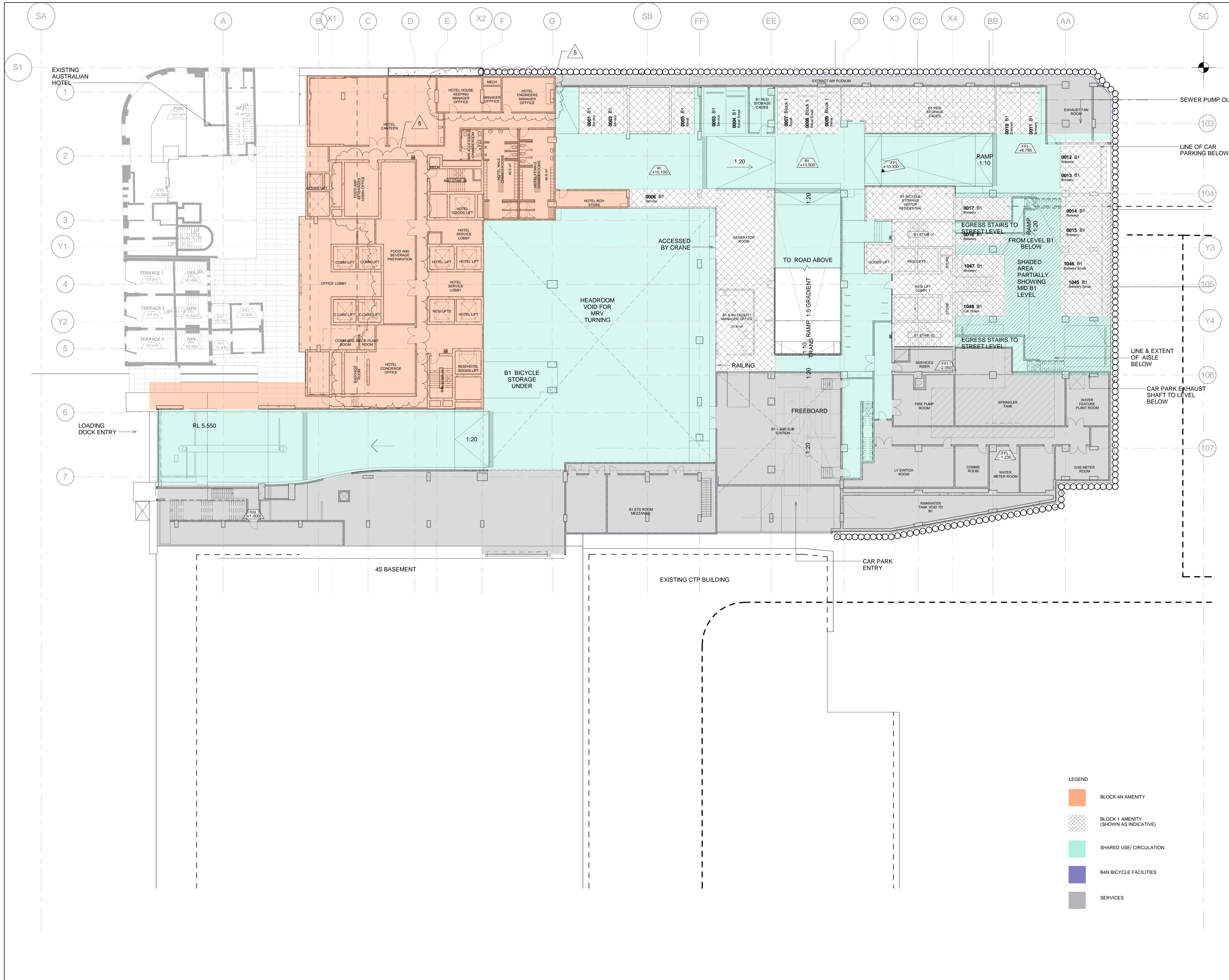

Do not scale from drawings.
 Verify all dimensions on site before commencing work.
 The ARCHITECT shall not be liable for any loss or damage whatsoever arising from or in respect of any errors, omissions or resulting from data transferred from the computer system of the Architect to systems of the Client or other Contractors.
 The recipient of the data shall be responsible for checking accuracy and completeness of data received.
 Any use of the electronic data in part or whole shall be at the user's risk.
 The CAD files and their contents are solely representations of the Project information and cannot be relied upon to reproduce the representation shown on the PDF versions of the drawings as provided by the Architect.

No.	Amendment	By	Date
5	ISSUED FOR INFORMATION - REVISED BASEMENT		29/06/15
4	ISSUED FOR INFORMATION - REVISED BASEMENT		26/06/15
3	ISSUED FOR INFORMATION - REVISED BASEMENT		19/06/15
2	ISSUED FOR INFORMATION - REVISED BASEMENT		23/03/15
1	ISSUED FOR INFORMATION - REVISED BASEMENT		09/01/15

Key Plan:

Consultants:
 Client:

FRASERS PROPERTY
 L11, 488 Kent St.
 Sydney
 NSW, Australia 2000
 Tel. 61 2 8823 8800
 Fax. 61 2 8823 8801

Foster + Partners
 Riverside, 22 Heister Road
 London SW11 4AN
 T +44 (0)20 7738 0455
 F +44 (0)20 7738 1107

Local Collaborating Architect
PTW Architects **PTW**
 Level 13, 9 Castlereagh St
 Sydney NSW Australia 2000
 T +612 9232 5877
 F +612 9221 4139
 NSW Non-Registered Architects
 S Partners Architect No. 6099
 D Jones Architect No. 4778
 A Partners Architect No. 5075
 A Rossi Architect No. 5057

Approvals	By:	Date:
PTW Approval:	Troy Uleman	29/06/15
Client Approval:		

NOT TO BE USED FOR CONSTRUCTION

Project:
CENTRAL PARK - BLOCK 1, 4N AND COMBINED BASEMENT
 20-102 Broadway, Sydney, NSW 2000
 Title:
B4N BASEMENT 00 PLAN

<Check Scalebar Scale>		
Scale: As indicated	Plot Date: 29/06/2015 11:18:09 AM	Job No: 212028
Dwg No: PA-A1-1754	Revision: 5	
Status:		

- LEGEND**
- BLOCK 4N AMENITY
 - BLOCK 1 AMENITY (SHOWN AS INDICATIVE)
 - SHARED USE/ CIRCULATION
 - B4N BICYCLE FACILITIES
 - SERVICES