

BARANGAROO SOUTH.



R7 Commercial Building
Project Application SSD-6623

ARCHITECTURAL DRAWINGS:

- BR7_ASK_PA1_0000 - TITLE SHEET
- BR7_ASK_PA1_0001 - BASEMENT PLAN LEVEL B1
- BR7_ASK_PA1_0002 - BASEMENT PLAN LEVEL B2
- BR7_ASK_PA1_0003 - BASEMENT PLAN LEVEL B3
- BR7_ASK_PA1_0101 - CROSS SECTION 1-1
- BR7_ASK_PA1_0102 - LONGITUDINAL SECTION 2-2

INDICATIVE LAYOUT ONLY



GRAHAM W JONES
Principal Architect
FRAIA NSW ARB 4005

Lend Lease (Millers Point)
Pty Limited

BARANGAROO SOUTH
STAGE 1

R7 Commercial Building
Project Application SSD-6623
Title Sheet

Purpose: Approved: Date:

Scale

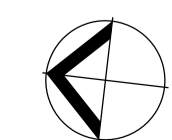



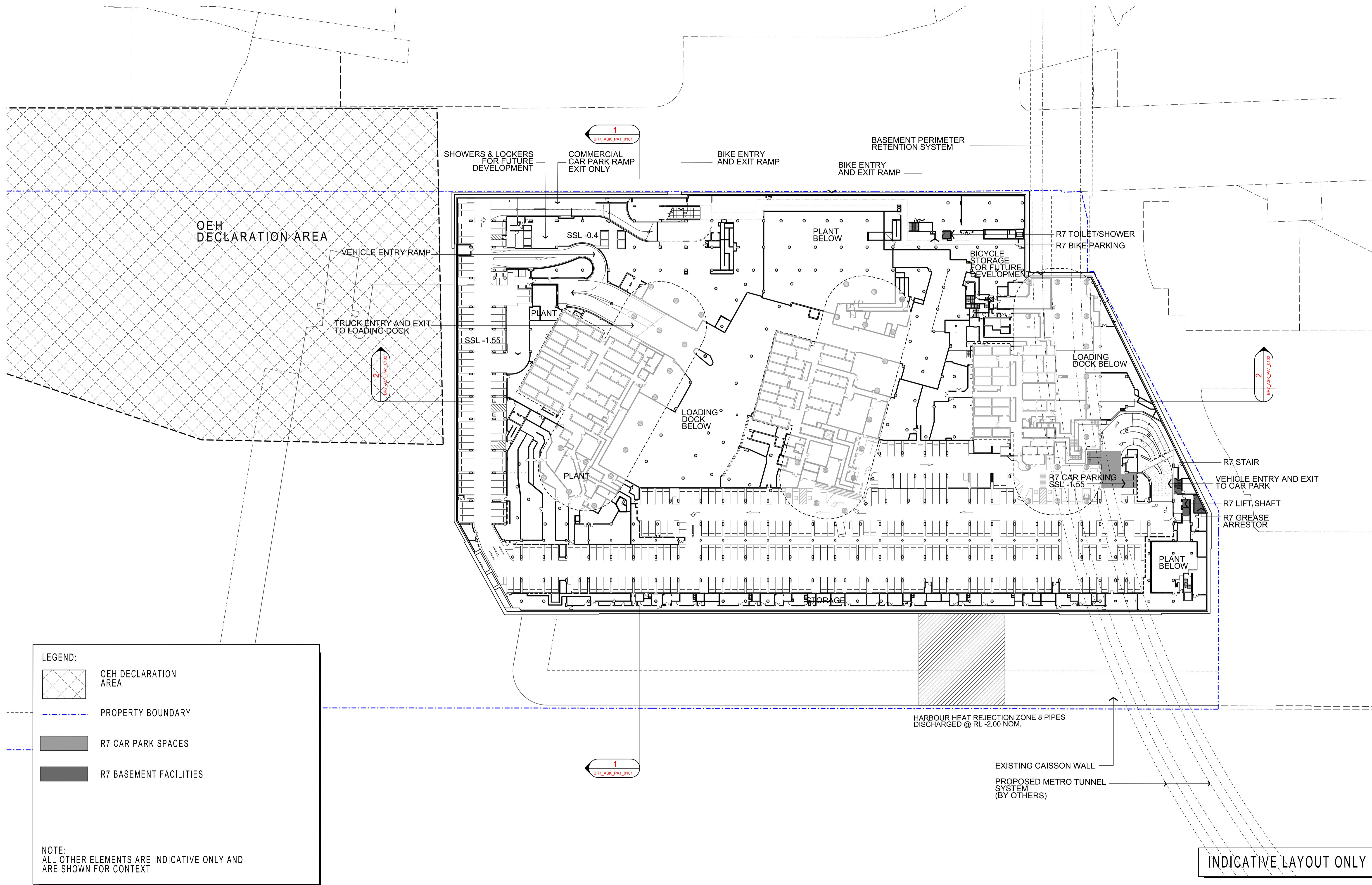

Dwg. No. BR7_ASK_PA1_0000
Date 08/09/14 Revision 01

BR7_ASK_PA1_0000.dgn LLdesign phat988 8/09/2014 4:11:41 PM

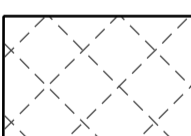

LEGEND:

-  OEH DECLARATION AREA
-  PROPERTY BOUNDARY
-  R7 CAR PARK SPACES
-  R7 BASEMENT FACILITIES

NOTE:
ALL OTHER ELEMENTS ARE INDICATIVE ONLY AND ARE SHOWN FOR CONTEXT

INDICATIVE LAYOUT ONLY

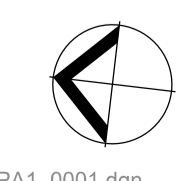
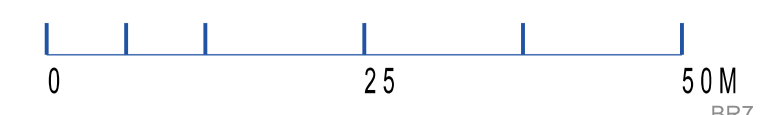

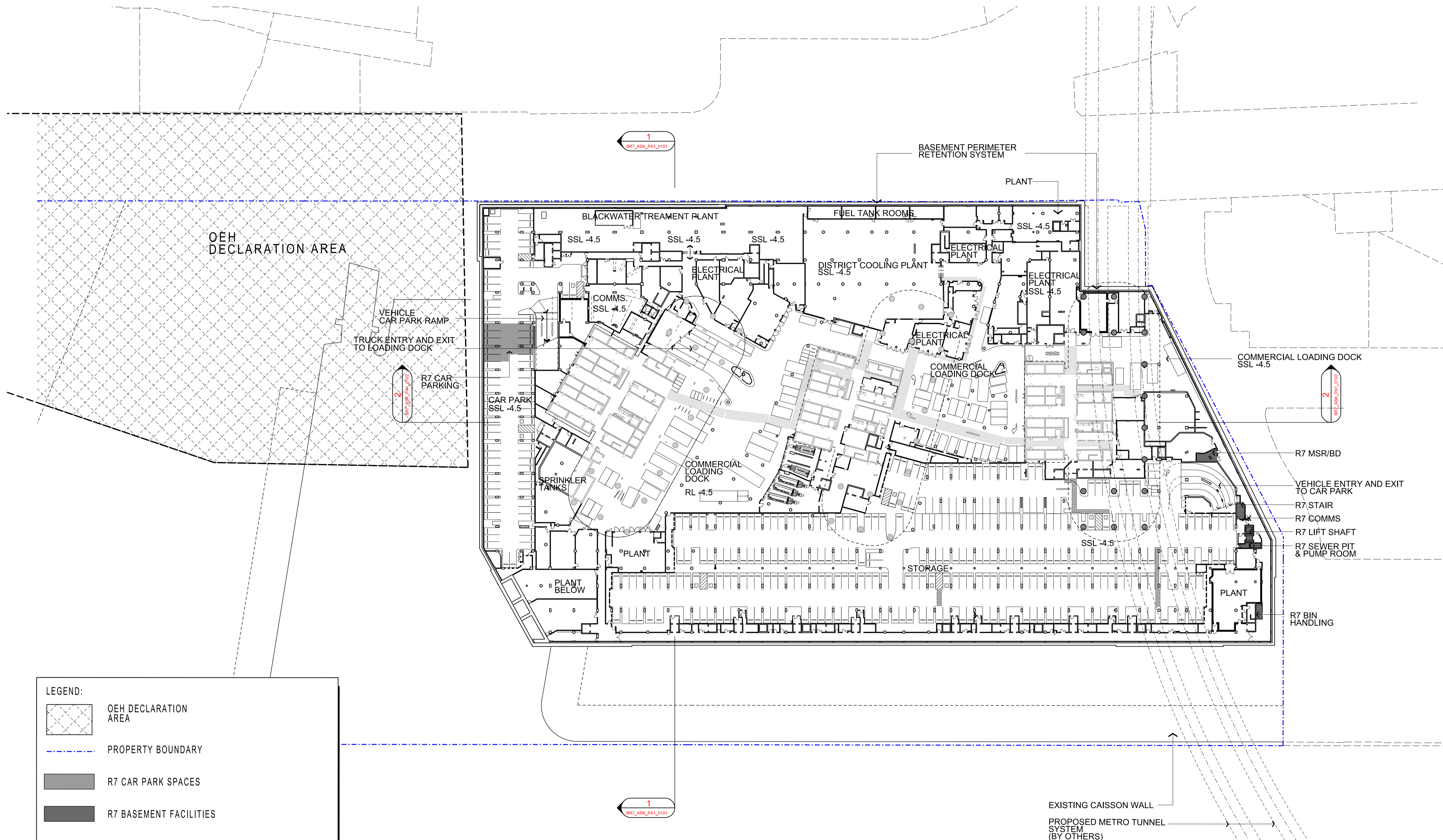

OEH DECLARATION AREA

1
BR7_ASK_PA1_0101

BASEMENT PERIMETER RETENTION SYSTEM

PLANT

BLACKWATER TREATMENT PLANT

FUEL TANK ROOMS

DISTRICT COOLING PLANT

COMMS

COMMERCIAL LOADING DOCK

COMMERCIAL LOADING DOCK

VEHICLE CAR PARK RAMP

TRUCK ENTRY AND EXIT TO LOADING DOCK

R7 CAR PARKING

CAR PARK

COMMERCIAL LOADING DOCK

R7 MSR/BD

VEHICLE ENTRY AND EXIT TO CAR PARK

R7 STAIR

R7 COMMS

R7 LIFT SHAFT

R7 SEWER PIT & PUMP ROOM

R7 BIN HANDLING

SPRINKLER TANKS





PLANT

SSL -4.5

PLANT BELOW

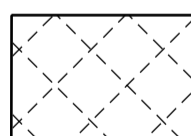
STORAGE

PLANT





- LEGEND:
-  OEH DECLARATION AREA
 -  PROPERTY BOUNDARY
 -  R7 CAR PARK SPACES
 -  R7 BASEMENT FACILITIES

NOTE:
ALL OTHER ELEMENTS ARE INDICATIVE ONLY AND ARE SHOWN FOR CONTEXT

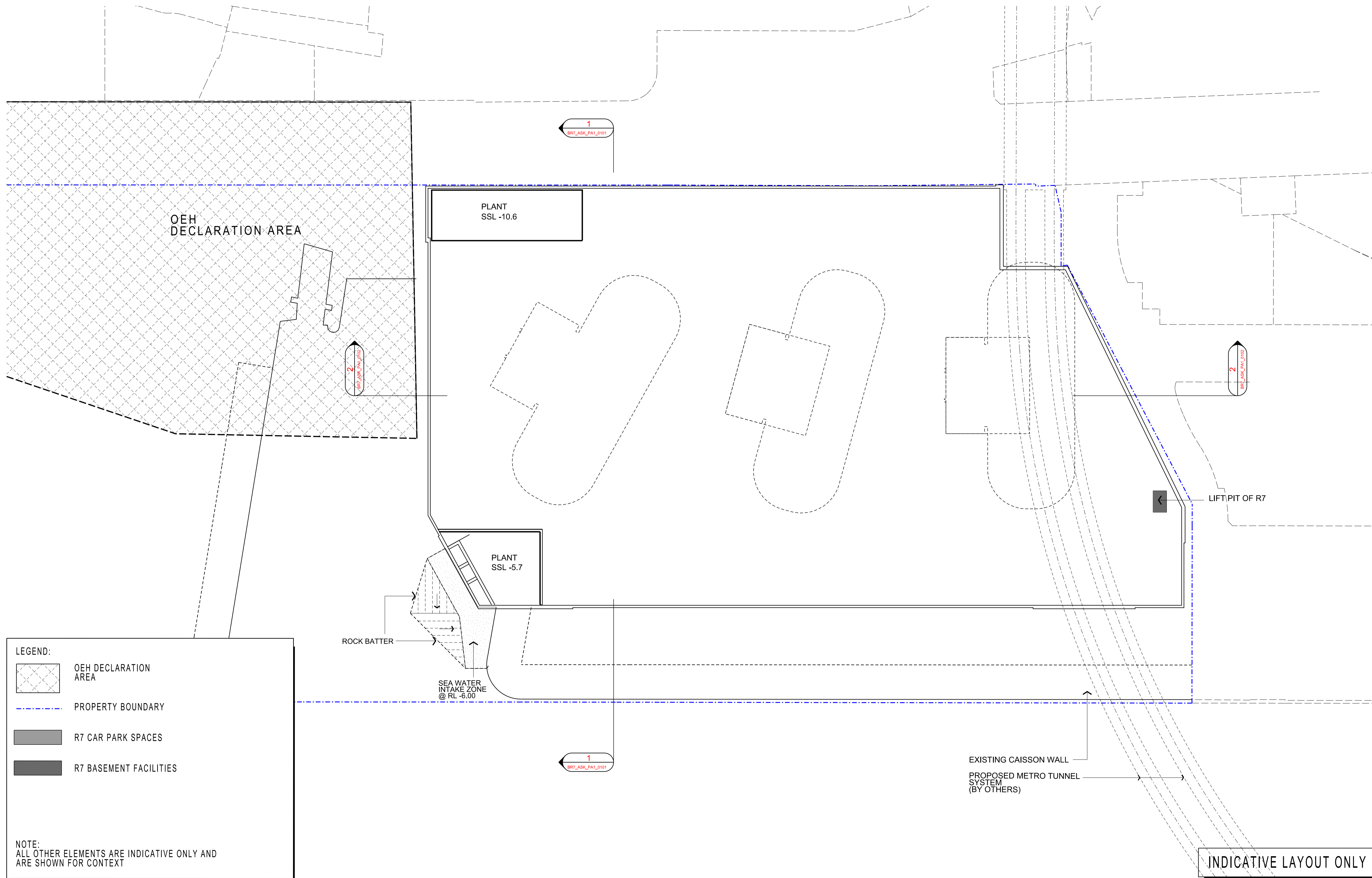
EXISTING CAISSON WALL
PROPOSED METRO TUNNEL SYSTEM (BY OTHERS)

INDICATIVE LAYOUT ONLY



- LEGEND:**
-  OEH DECLARATION AREA
 -  PROPERTY BOUNDARY
 -  R7 CAR PARK SPACES
 -  R7 BASEMENT FACILITIES

NOTE:
ALL OTHER ELEMENTS ARE INDICATIVE ONLY AND ARE SHOWN FOR CONTEXT

INDICATIVE LAYOUT ONLY

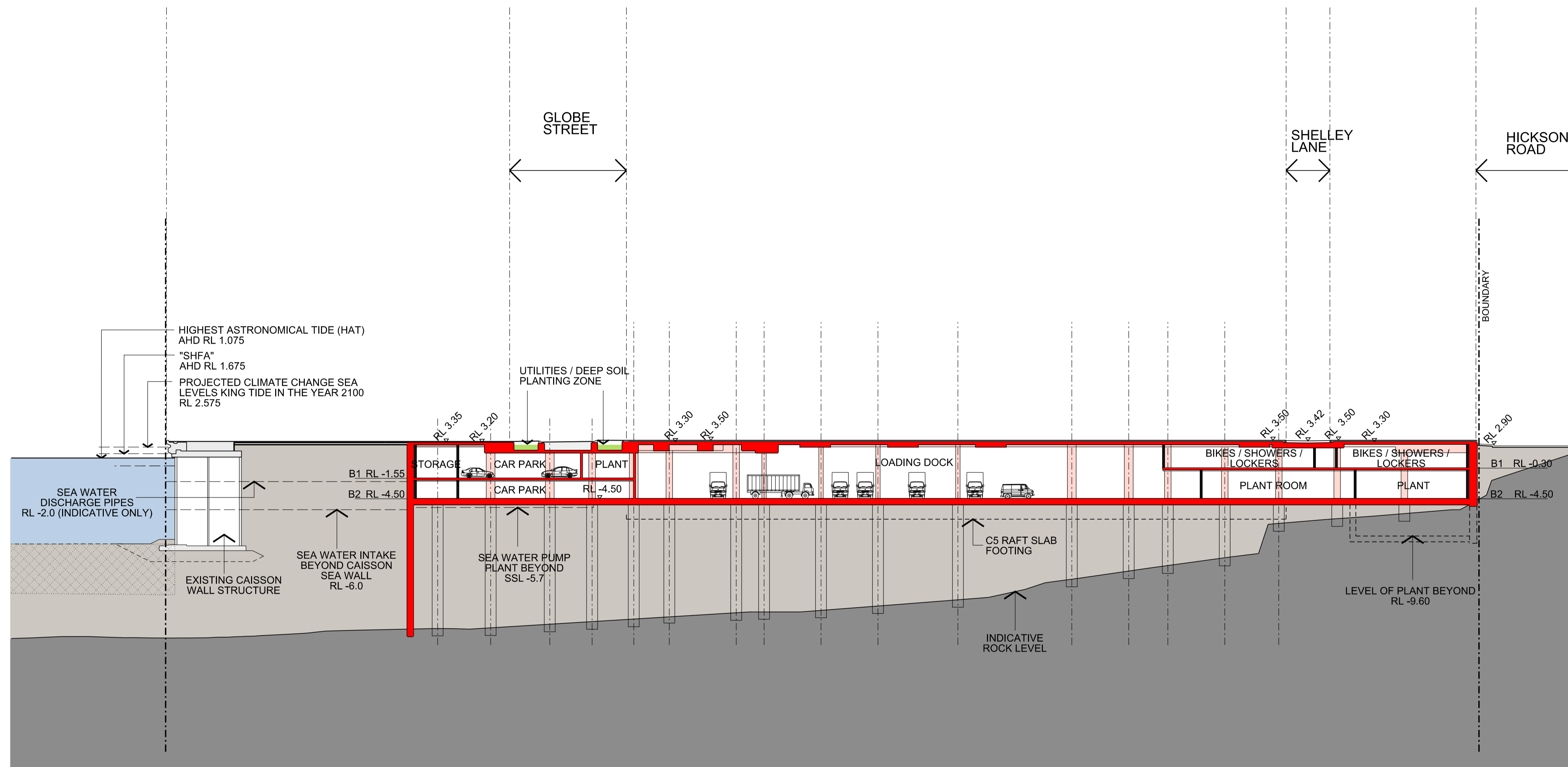

CROSS SECTION 1-1

INDICATIVE LAYOUT ONLY



GRAHAM W JONES
Principal Architect
FRAIA NSW ARB 4005

Lend Lease (Millers Point)
Pty Limited

BARANGAROO SOUTH
STAGE 1

R7 Commercial Building
Project Application SSD-6623
Cross Section 1-1

Purpose: Approved: Date:

Scale 1:300 @ B1 1:750 @ A3

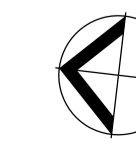

Dwg. No. BR7_ASK_PA1_0101
Date 08/09/14 Revision 01

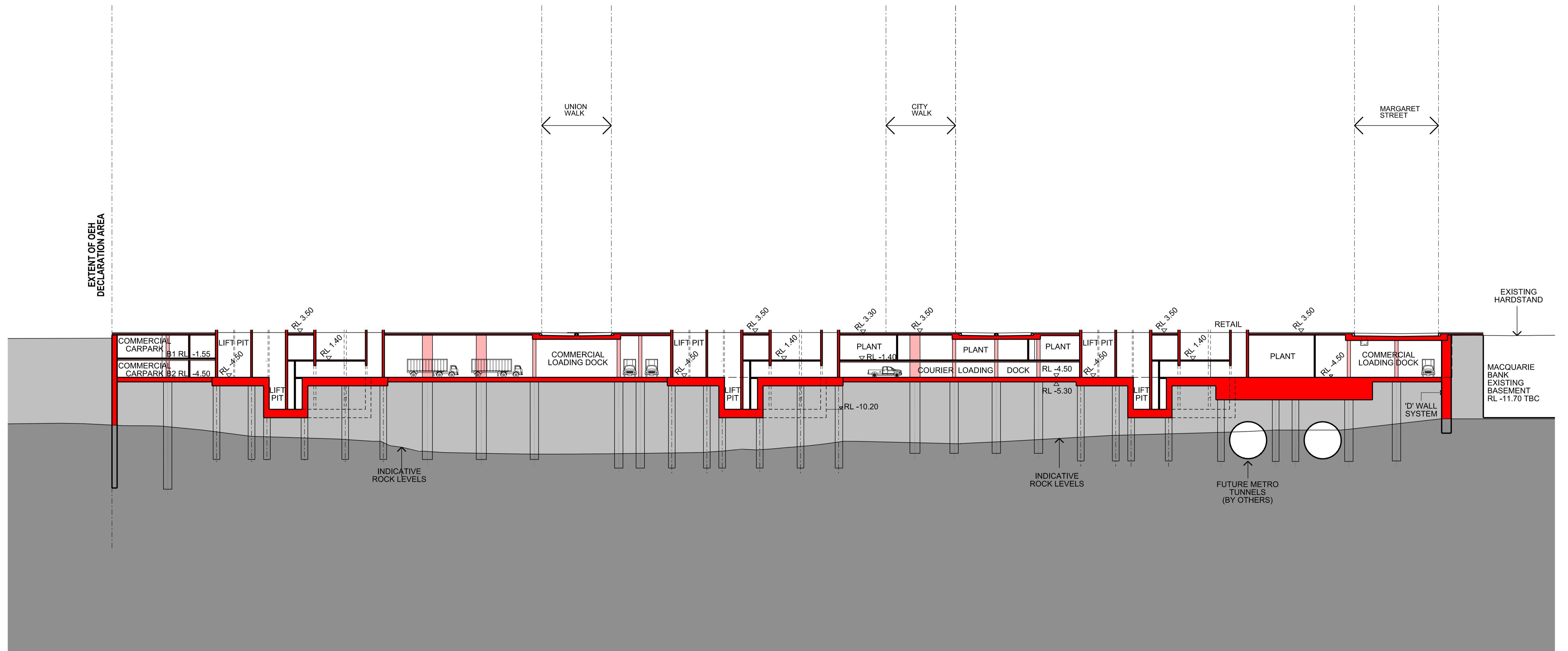

LONGITUDINAL SECTION 2-2

INDICATIVE LAYOUT ONLY



GRAHAM W JONES
Principal Architect
FRAIA NSW ARB 4005

Lend Lease (Millers Point)
Pty Limited

BARANGAROO SOUTH
STAGE 1

R7 Commercial Building
Project Application SSD-6623
Longitudinal Section 2-2

Purpose: Approved: Date:

Scale 1:300 @ B1 1:750 @ A3

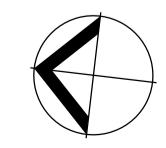

Dwg. No. BR7_ASK_PA1_0102

Date 08/09/14

Revision 01

BR7_ASK_PA1_0102.dgn LLdesign phat988 8/09/2014 4:13:04 PM