

Check all dimensions and site conditions prior to commencement of any work, the purchase or ordering of any materials, fittings, plant, services or equipment and the preparation of shop-drawings and/or the fabrication of any components.

All drawings to be read in conjunction with all architectural documents and all other consultants documents.

Do not scale drawings - refer to figured dimensions only. Any discrepancies shall immediately be referred to the architect for clarification.

All drawings may not be reproduced or distributed without prior permission from the architect.

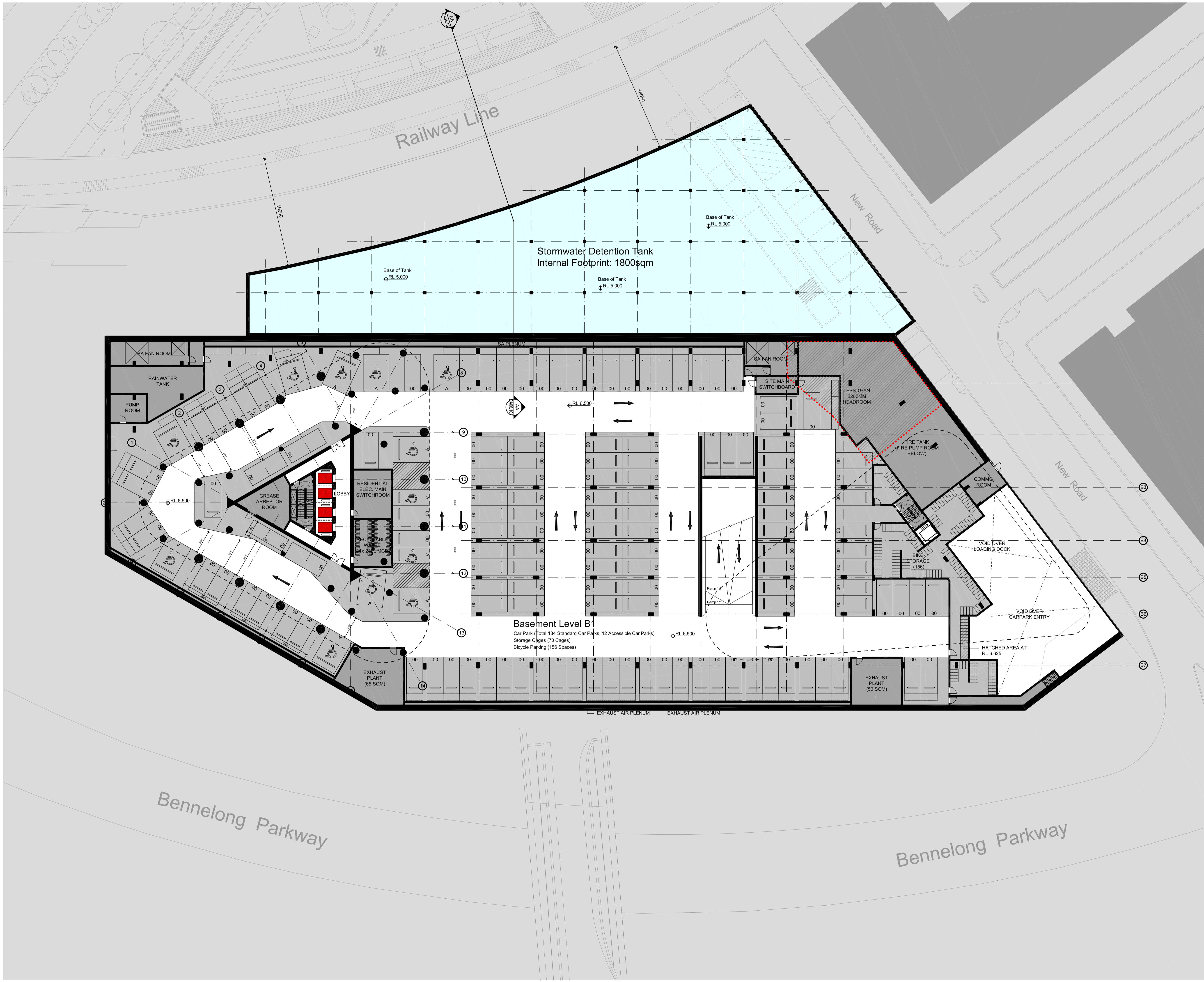

Revision Summary:

Revision No.	Revision Date	Description	Initial	Checked
07	03.11.14	Development Application	KM	MLS
06	19.09.14	Development Application	KM	MLS
05	03.09.14	For Information	JC	MLS
04	29.08.14	For Information	JC	MLS
03	26.08.14	For Information	JC	MLS
02	02.07.14	For Information	JC	MLS
01	25.06.14	For Information	JC	MLS

NOT FOR CONSTRUCTION

Revision No.	Revision Date	Description	Initial	Checked
07	03.11.14	Development Application	KM	MLS
06	19.09.14	Development Application	KM	MLS
05	03.09.14	For Information	JC	MLS
04	29.08.14	For Information	JC	MLS
03	26.08.14	For Information	JC	MLS
02	02.07.14	For Information	JC	MLS
01	25.06.14	For Information	JC	MLS

Site 68
Sydney Olympic Park

Plan
Basement Level B1

Scale	1:250 @ A1 1:500 @ A3
Drawn	Checked
Project No.	S11611
Status	DA
Plot Date	3/11/2014 12:16 PM
Plot File	S:\11600-11699\11611_ecove_sopsite6800_main\trans\03_m... ..._stones\140919_DA_FINAL REPORT AND DRAWINGS\Archit [Revision]
Drawing No.	

DA02.B1[07]

Melbourne 1 Nicholson Street
Melbourne VIC 3000 Australia
T 03 8664 6200 F 03 8664 6300
email mel@batessmart.com.au
http://www.batessmart.com.au

Sydney 43 Brisbane Street
Surry Hills NSW 2010 Australia
T 02 8354 5100 F 02 8354 5199
email syd@batessmart.com.au
http://www.batessmart.com.au

Bates Smart Architects Pty Ltd ABN 68 094 740 986

