

**LEGEND**

- BLOCK 1 AMENITY
- BLOCK 4N AMENITY (SHOWN AS INDICATIVE)
- SHARED USE/ CIRCULATION
- BICYCLE FACILITIES
- SERVICES

Do not scale from drawings.  
 Check all dimensions on site before commencing work.  
 The Architect shall not be liable for any loss or damage whatsoever arising from or in respect of any errors, omissions or resulting from data transferred from the computer system of the Architect to systems of the Client or other Contractors.  
 The recipient of the data shall be responsible for checking accuracy and completeness of data received.  
 Any use of the electronic data in part or whole shall be at the user's risk.  
 The CAD files and their contents are solely representations of the Project information and cannot be relied upon beyond the representation shown on the PDF versions of the drawings as provided by the Architect.

No.	Amendment	By	Date
2	ISSUED FOR INFORMATION - REVISED BASEMENT		01/07/15
1	ISSUED FOR INFORMATION - REVISED BASEMENT		09/01/15

Key Plan:

Consultants:

Client:

**FRASERS PROPERTY**

L11, 488 Kent St.  
 Sydney  
 NSW, Australia 2000  
 Tel. 61 2 8823 8800  
 Fax. 61 2 8823 8801

**Foster + Partners**

Riverside, 22 Hecker Road  
 London SW11 4AN  
 T +44 (0)20 7738 0455  
 F +44 (0)20 7738 1107

Local Collaborating Architect

**PTW Architects** **PTW**

Level 13, 9 Castlereagh St  
 Sydney NSW Australia 2000

T +612 9232 5877  
 F +612 9221 4139

NSW Non-Registered Architects  
 S Partners Architect No 6098  
 D Jones Architect No 4778  
 A Partners Architect No 5075  
 A Partners Architect No 5057

Approvals	By:	Date:
PTW Approval:	Checker	01/08/15
Client Approval:		

**NOT TO BE USED FOR CONSTRUCTION**

Project:  
**CENTRAL PARK - BLOCK 1, 4N AND COMBINED BASEMENT**  
 20-102 Broadway, Sydney, NSW 2000

Title:  
**B1 BASEMENT 04 PLAN**

<Check Scalebar Scale>

Scale:	Plot Date:	Job No:
As indicated	@A1 1/07/2015 2:34:52 PM	212028
Dwg No:	Revision:	
PA-A1-1755	2	

Status:





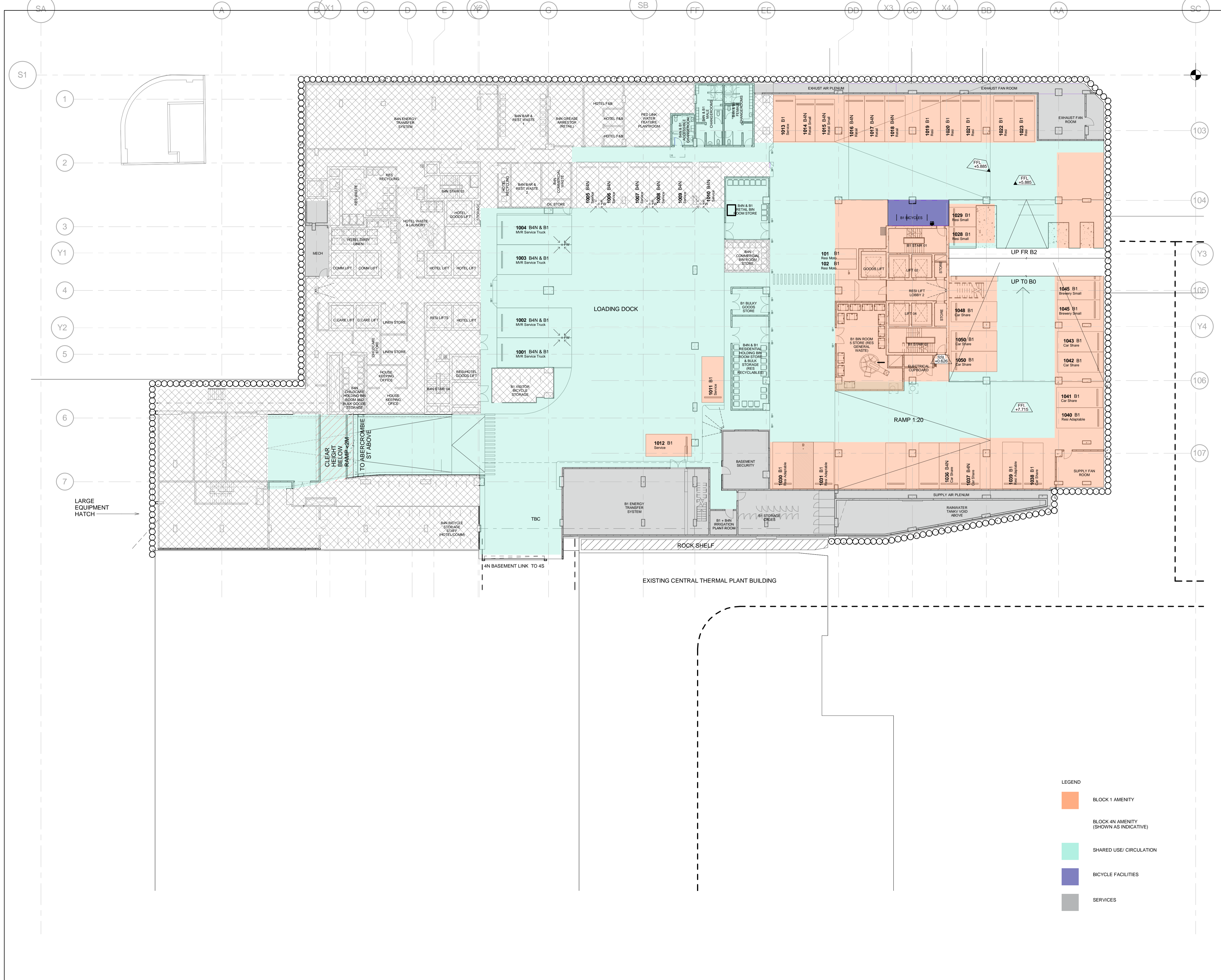

Do not scale from drawings.  
 Verify all dimensions on site before commencing work.  
 The ARCHITECT shall not be liable for any loss or damage whatsoever arising from or in respect of any errors, omissions or resulting from data transferred from the computer system of the Architect to systems of the Client or other Contractors.  
 The recipient of the data shall be responsible for checking accuracy and completeness of data received.  
 Any use of the electronic data in part or whole shall be at the user's risk.  
 The CAD files and their contents are solely representations of the Project information and cannot be relied upon for the representation shown on the PDF versions of the drawings as provided by the Architect.

No.	Amendment	By	Date
2	ISSUED FOR INFORMATION - REVISED BASEMENT		01/07/15
1	ISSUED FOR INFORMATION - REVISED BASEMENT		09/01/15

Key Plan:

Consultants:

Client:  
**FRASERS PROPERTY**  
 L11, 488 Kent St.  
 Sydney  
 NSW, Australia 2000  
 Tel. 61 2 8823 8800  
 Fax. 61 2 8823 8801

**Foster + Partners**  
 Riverside, 22 Heister Road  
 London SW11 4AN  
 T +44 (0)20 7738 0455  
 F +44 (0)20 7738 1107

Local Collaborating Architect  
**PTW Architects** **PTW**  
 Level 13, 9 Castlereagh St  
 Sydney NSW Australia 2000  
 T +612 9232 5877  
 F +612 9221 4139  
 NSW Non-qualified Architects  
 S Parsons Architect No. 6099  
 D Jones Architect No. 4778  
 A Porter Architect No. 5075  
 A Rossi Architect No. 5057

Approvals	By:	Date:
PTW Approval:	Checker	01/08/15
Client Approval:		

**NOT TO BE USED FOR CONSTRUCTION**

Project:  
**CENTRAL PARK - BLOCK 1, 4N AND COMBINED BASEMENT**  
 20-102 Broadway, Sydney, NSW 2000  
 Title:  
**B1 BASEMENT 01 PLAN**

<Check Scalebar Scale>		
Scale: As indicated	Plot Date: @A1 1/07/2015 2:34:59 PM	Job No: 212028
Dwg No: PA-A1-1758	Revision: 2	Status:

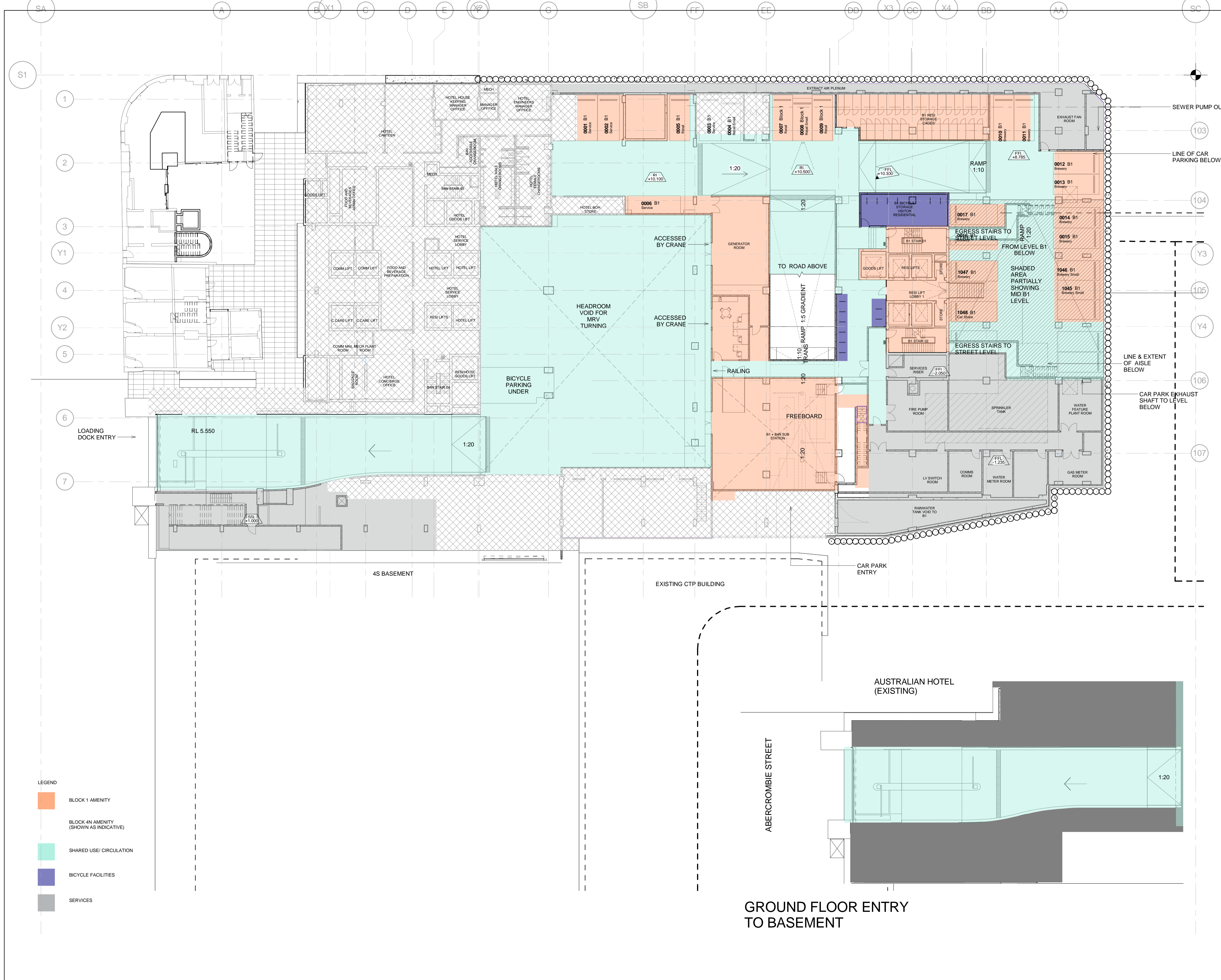

Do not scale from drawings.  
 Check all dimensions on site before commencing work.  
 The Architect shall not be liable for any loss or damage whatsoever arising from or in respect of any errors or omissions in the drawings or any other documents prepared by the Architect or any other person.  
 The Architect shall not be responsible for checking accuracy and completeness of data received from other sources.  
 The user of the drawings shall be responsible for checking accuracy and completeness of data received from other sources.  
 Any use of the drawings in part or whole shall be at the user's risk.  
 The CAD files and their contents are solely representations of the Project information and cannot be relied upon beyond the representation shown on the PDF versions of the drawings as provided by the Architect.

No.	Amendment	By	Date
2	ISSUED FOR INFORMATION - REVISED BASEMENT		01/07/15
1	ISSUED FOR INFORMATION - REVISED BASEMENT		09/01/15

Key Plan:

Consultants:

Client:  
**FRASERS PROPERTY**  
 L11, 488 Kent St.  
 Sydney, Australia 2000  
 Tel. 61 2 8823 8800  
 Fax. 61 2 8823 8801

**Foster + Partners**  
 Riverside, 22 Heister Road  
 London SW11 4AN  
 T +44 (0)20 7738 0455  
 F +44 (0)20 7738 1107

Local Collaborating Architect  
**PTW Architects** **PTW**  
 Level 13, 9 Castlereagh St  
 Sydney NSW Australia 2000  
 T +612 9232 5877  
 F +612 9221 4139  
NSW Registered Architects  
 S Partners Architect No. 6098  
 D Jones Architect No. 4778  
 A Partners Architect No. 5075  
 A Rossi Architect No. 5057

Approvals	By:	Date:
PTW Approval:	Checker	01/08/15
Client Approval:		

**NOT TO BE USED FOR CONSTRUCTION**

Project:  
**CENTRAL PARK - BLOCK 1, 4N AND COMBINED BASEMENT**  
 20-102 Broadway, Sydney, NSW 2000  
 Title:  
**B1 BASEMENT 00 PLAN**

<Check Scalebar Scale>		
Scale: As indicated	Plot Date: 1/07/2015 2:35:04 PM	Job No: 212028
Dwg No: PA-A1-1759	Revision: 2	Status:

- LEGEND
- BLOCK 1 AMENITY
  - BLOCK 4N AMENITY (SHOWN AS INDICATIVE)
  - SHARED USE/ CIRCULATION
  - BICYCLE FACILITIES
  - SERVICES

**GROUND FLOOR ENTRY TO BASEMENT**