

NEW DANCE CENTRE - STAGE 5

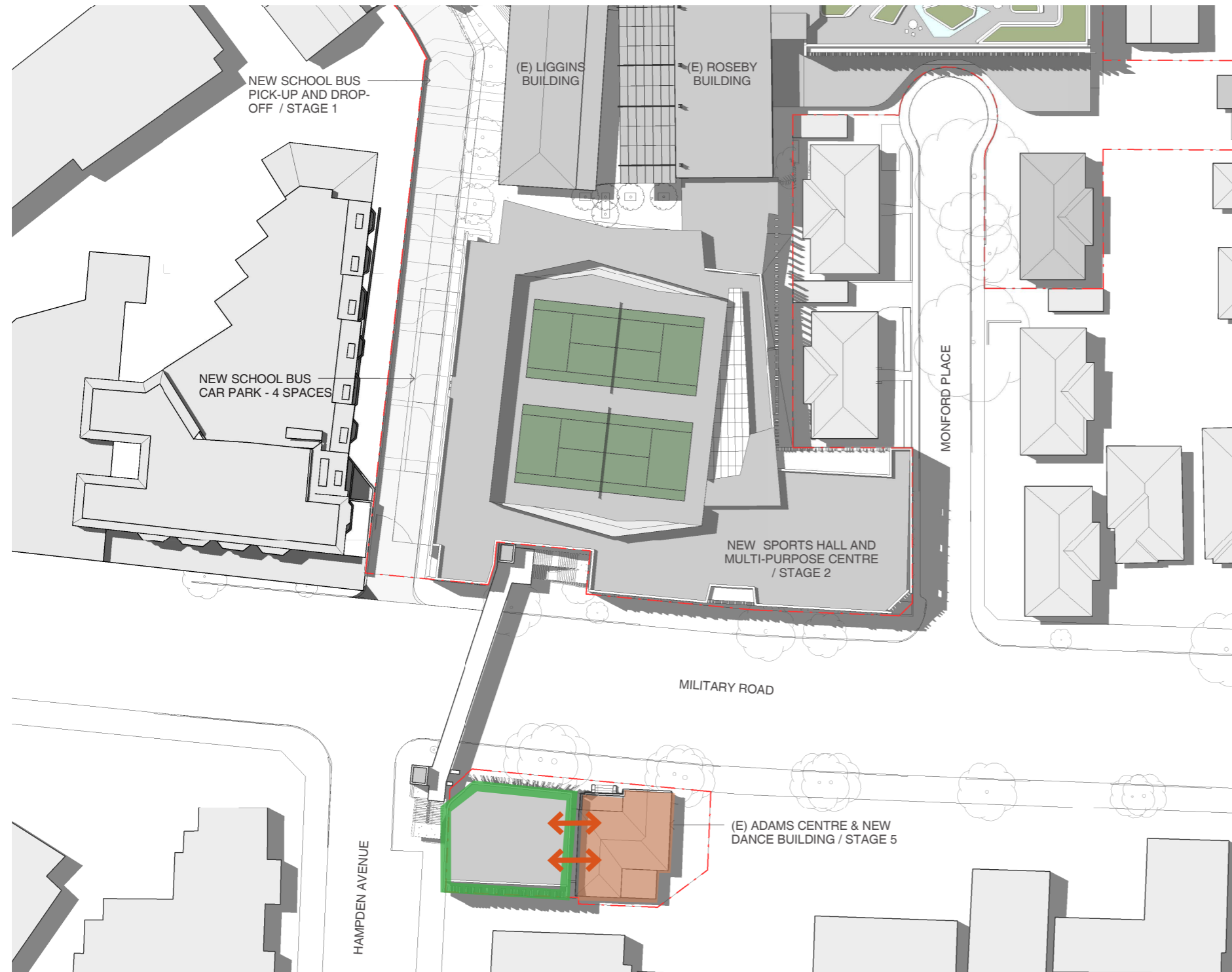

2 KEY ISSUES

- IMPACT ON ADAMS CENTRE HERITAGE SIGNIFICANCE
- BUILDING HEIGHT AND BULK

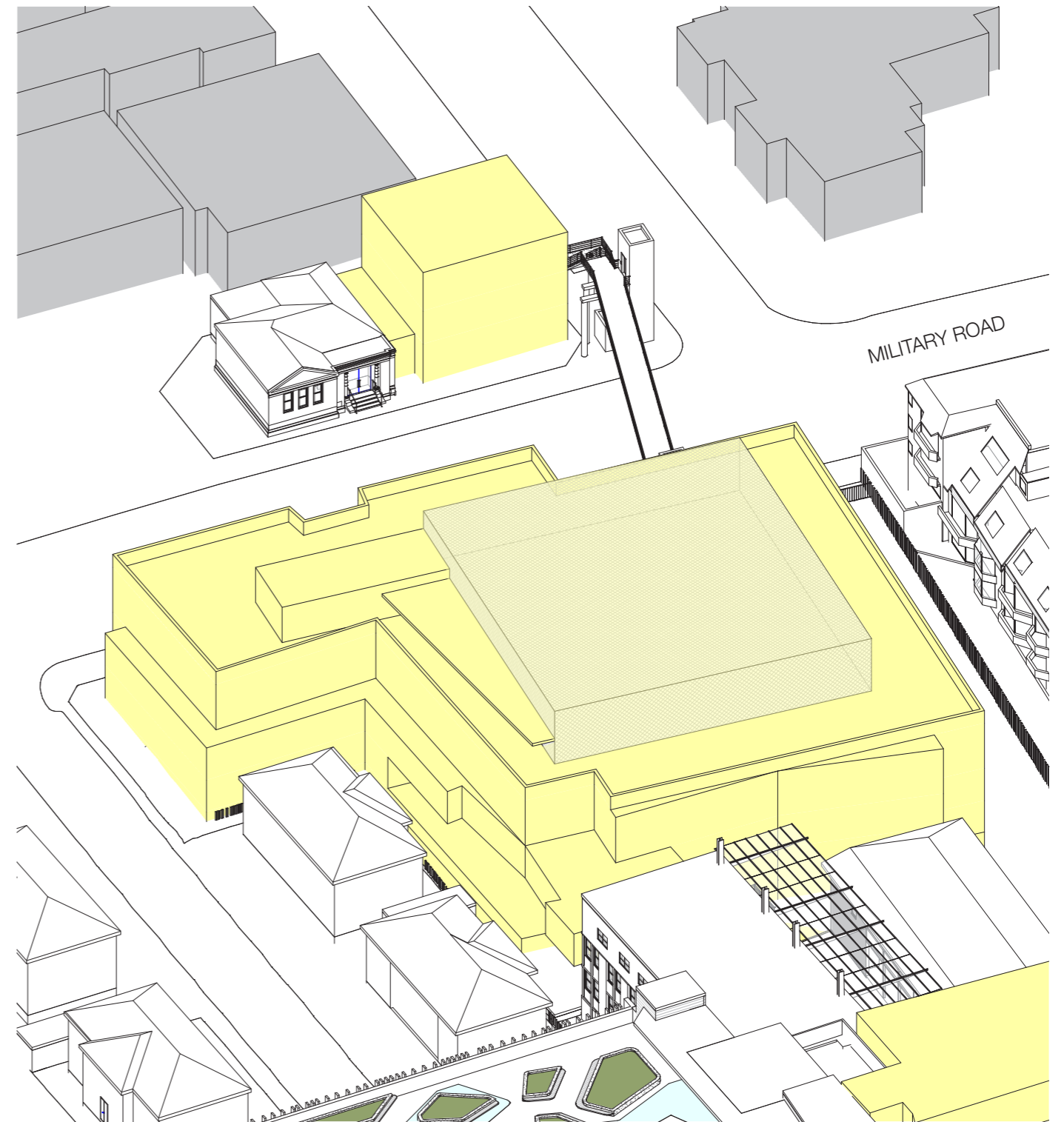
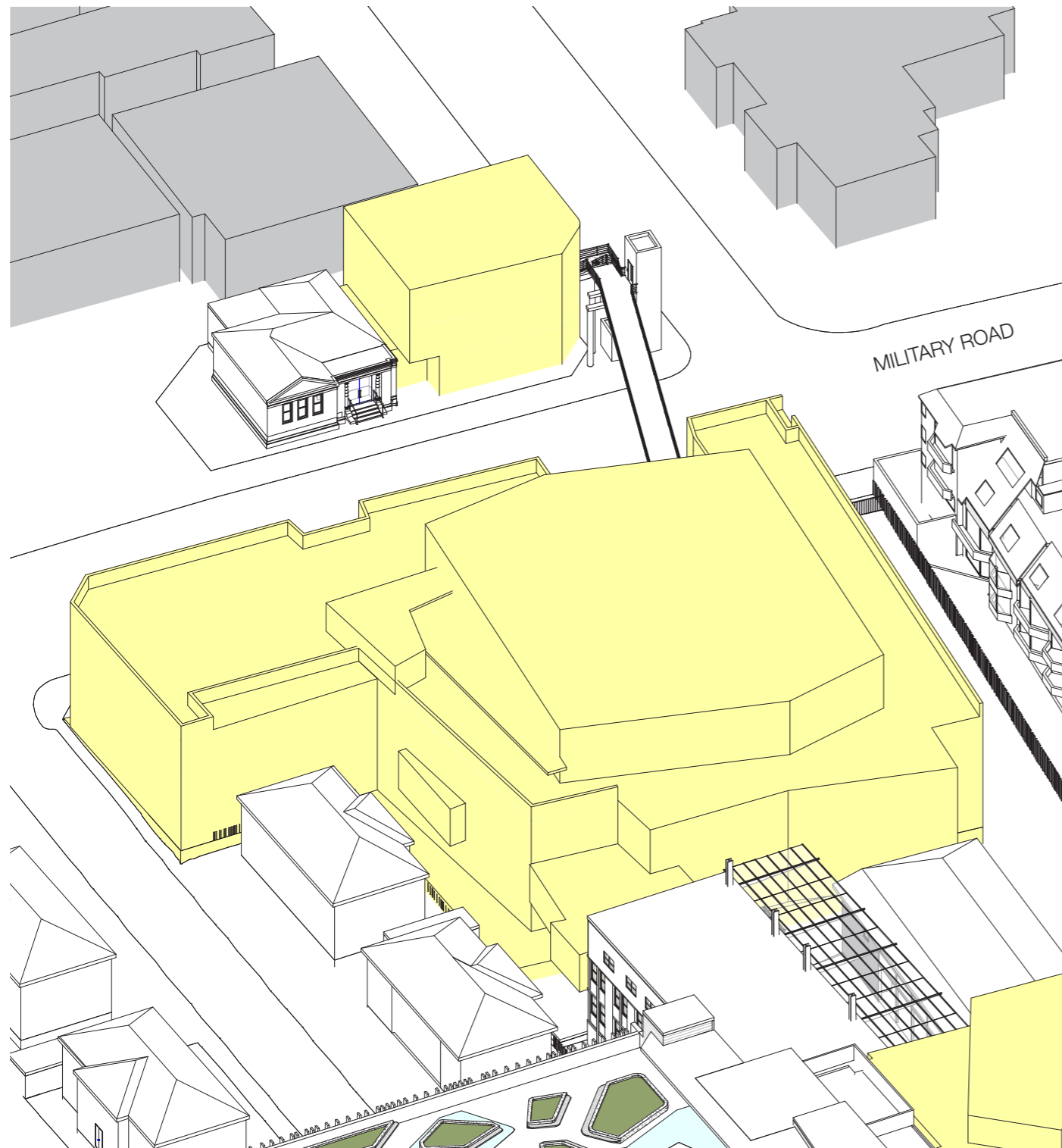

Lodged Application

Revised Design

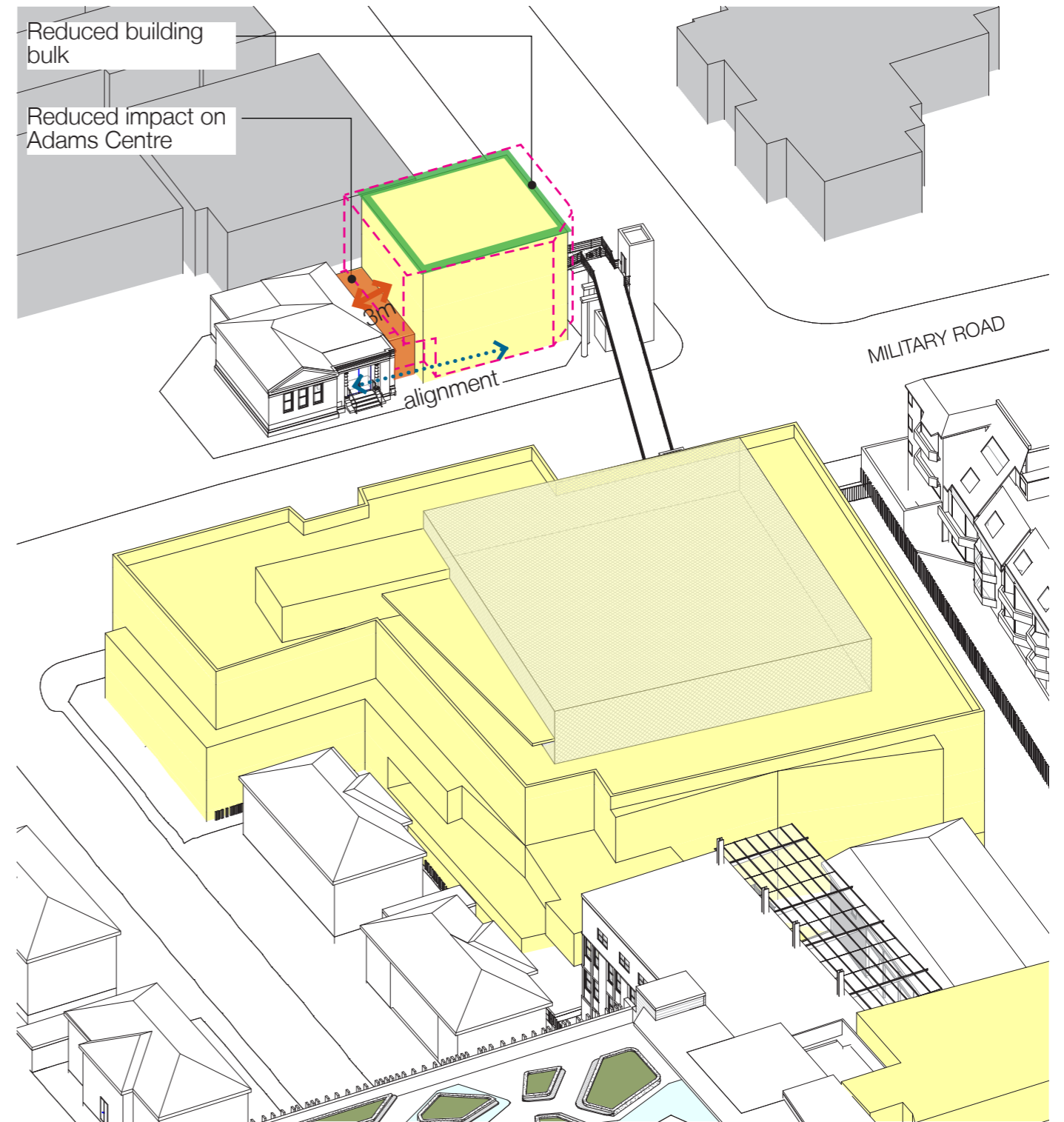
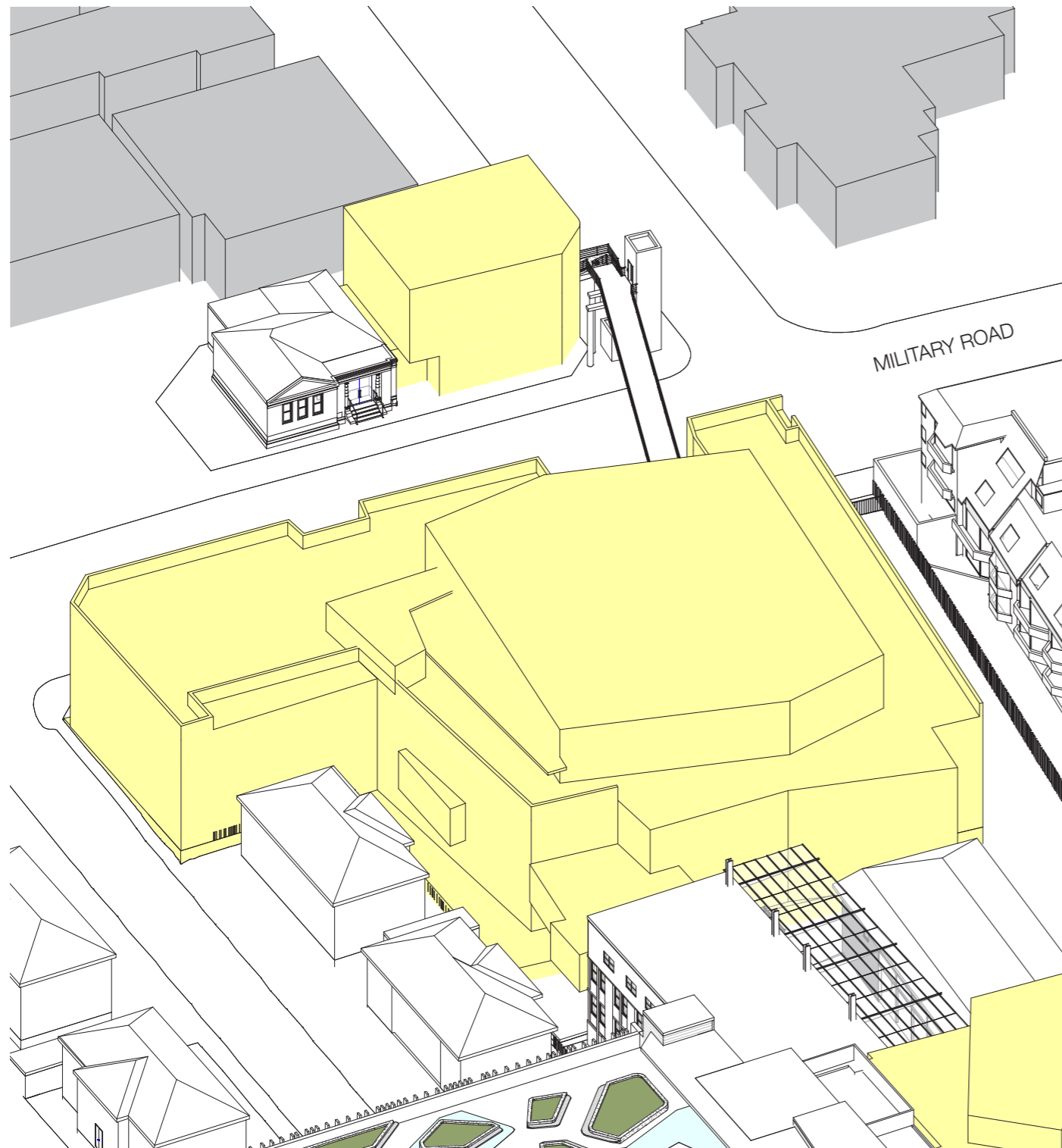

Lodged Application

Revised Design

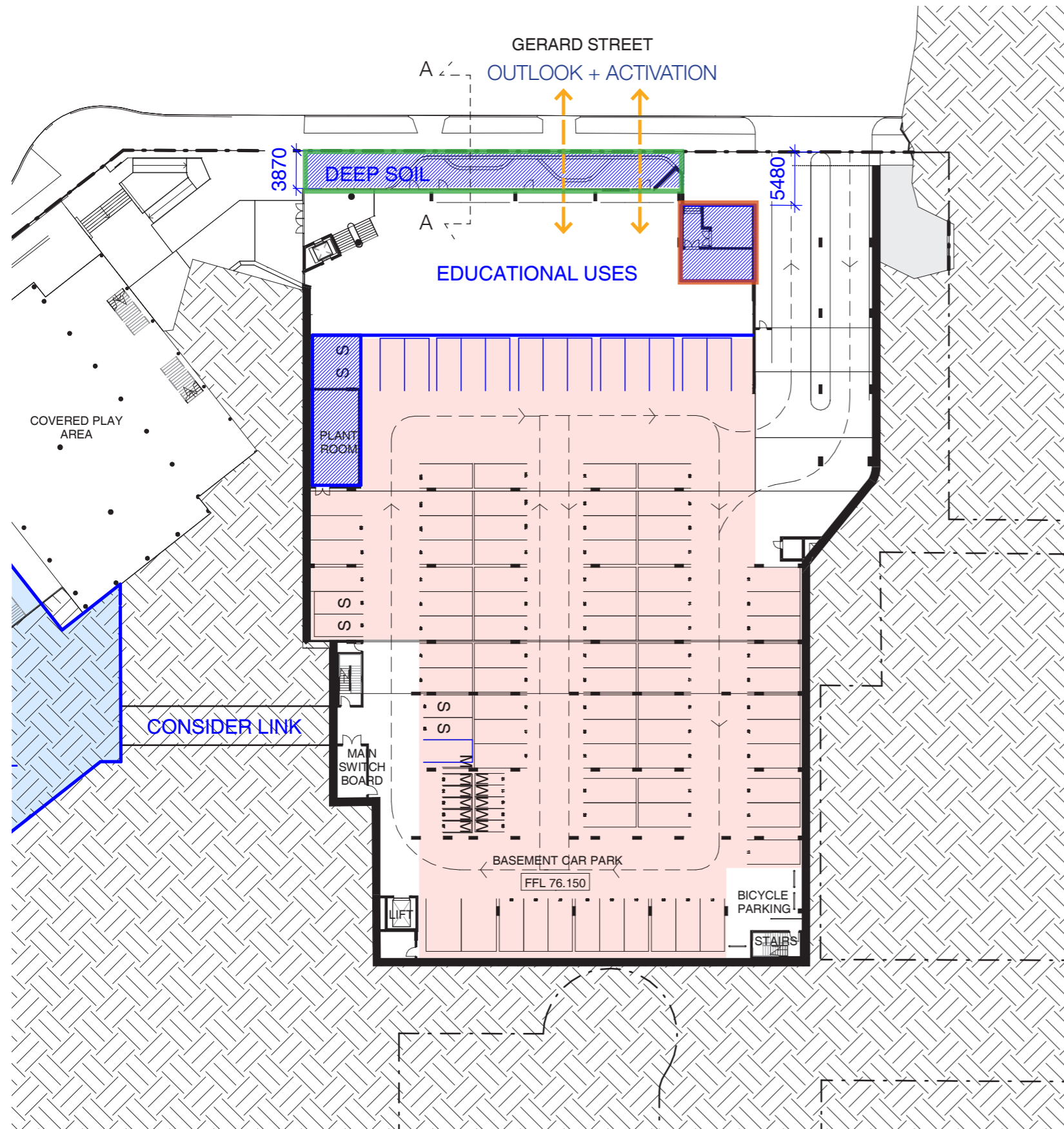

KEY CHANGES

- PUMP ROOM ALIGNED WITH MAIN BUILDING
- DEEP SOIL ALONG GERARD STREET
- PERMANENT EDUCATIONAL SPACES ON GERARD STREET
- 92 CAR SPACES (PREVIOUSLY 115 SPACES)

Basement level

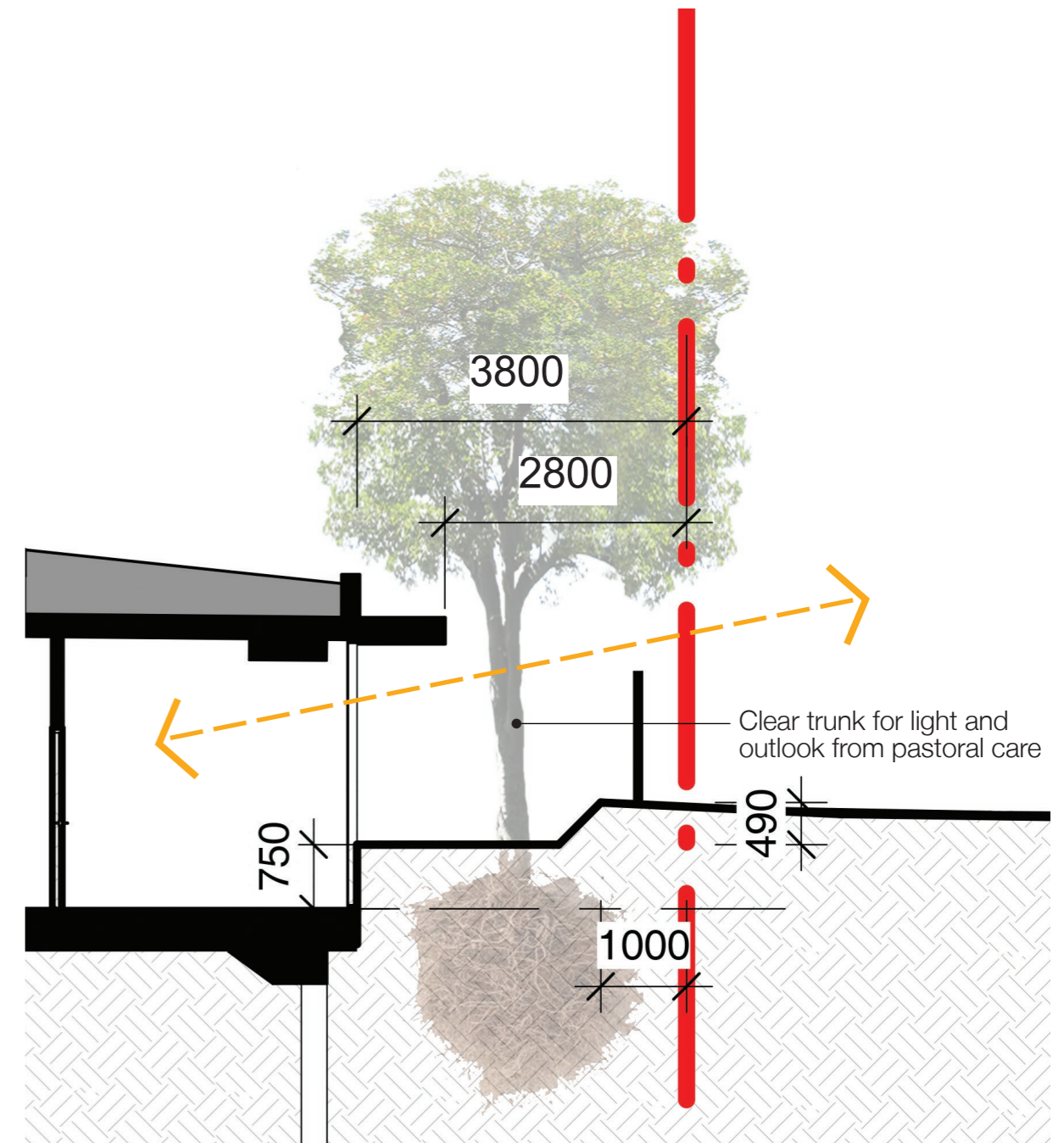
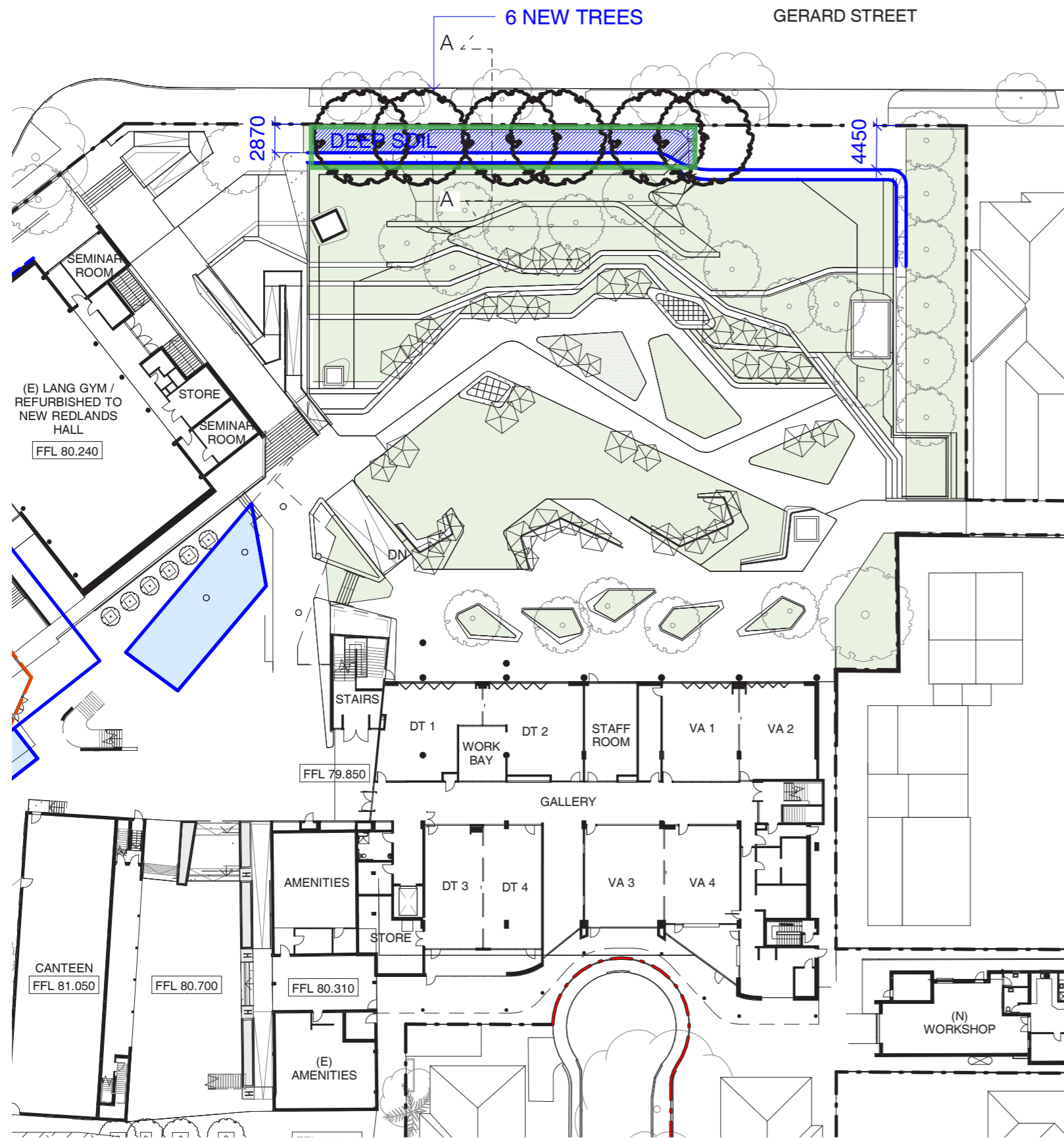

Section A

Level 1

NEW HUMPHERY LEARNING HUB - STAGE 4

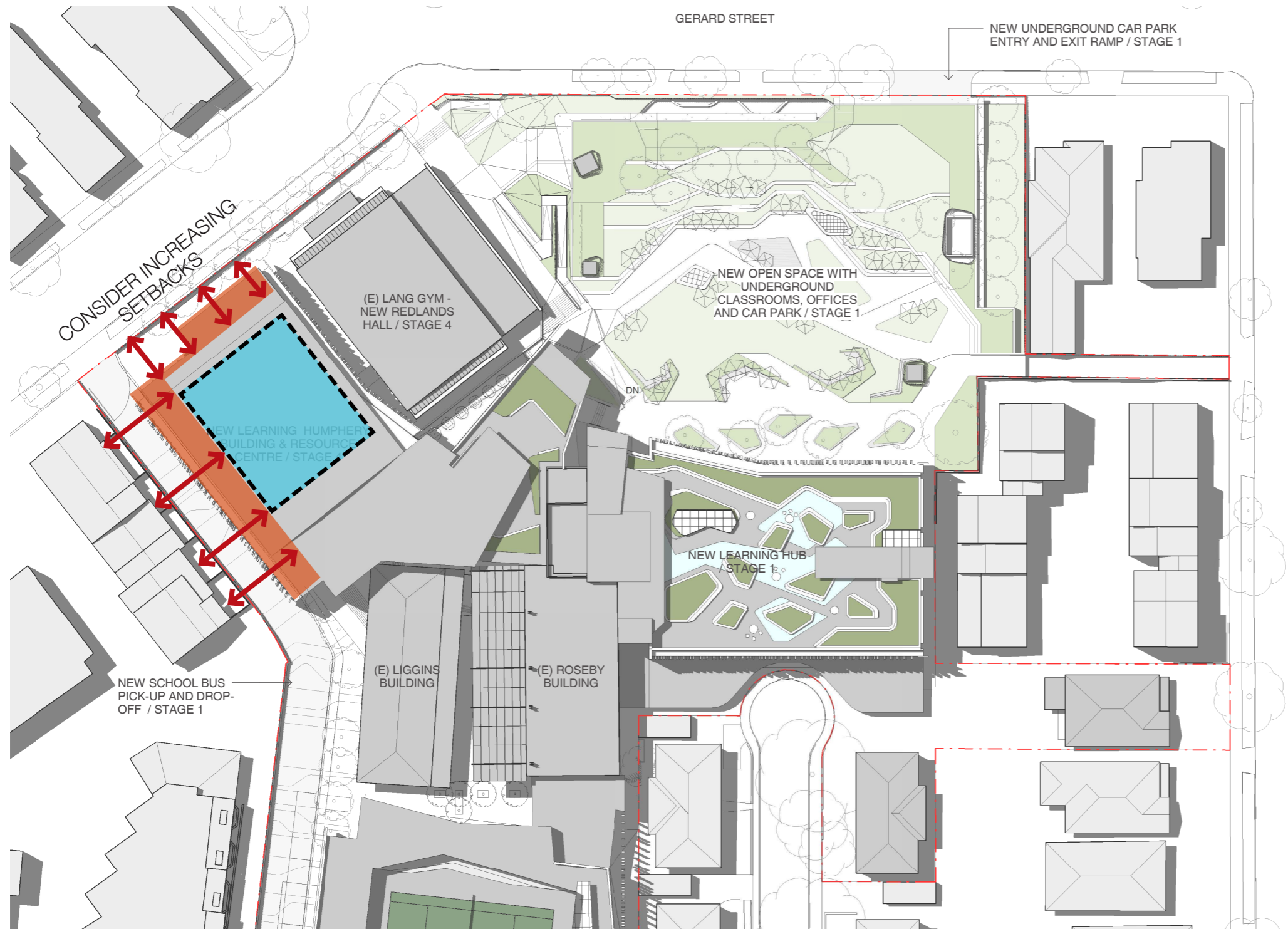

3 KEY ISSUES

- SETBACK
- BUILDING HEIGHT AND BULK
- ROOFTOP POOL

NEW HUMPHERY LEARNING HUB - STAGE 4

BUILDING ENVELOPE

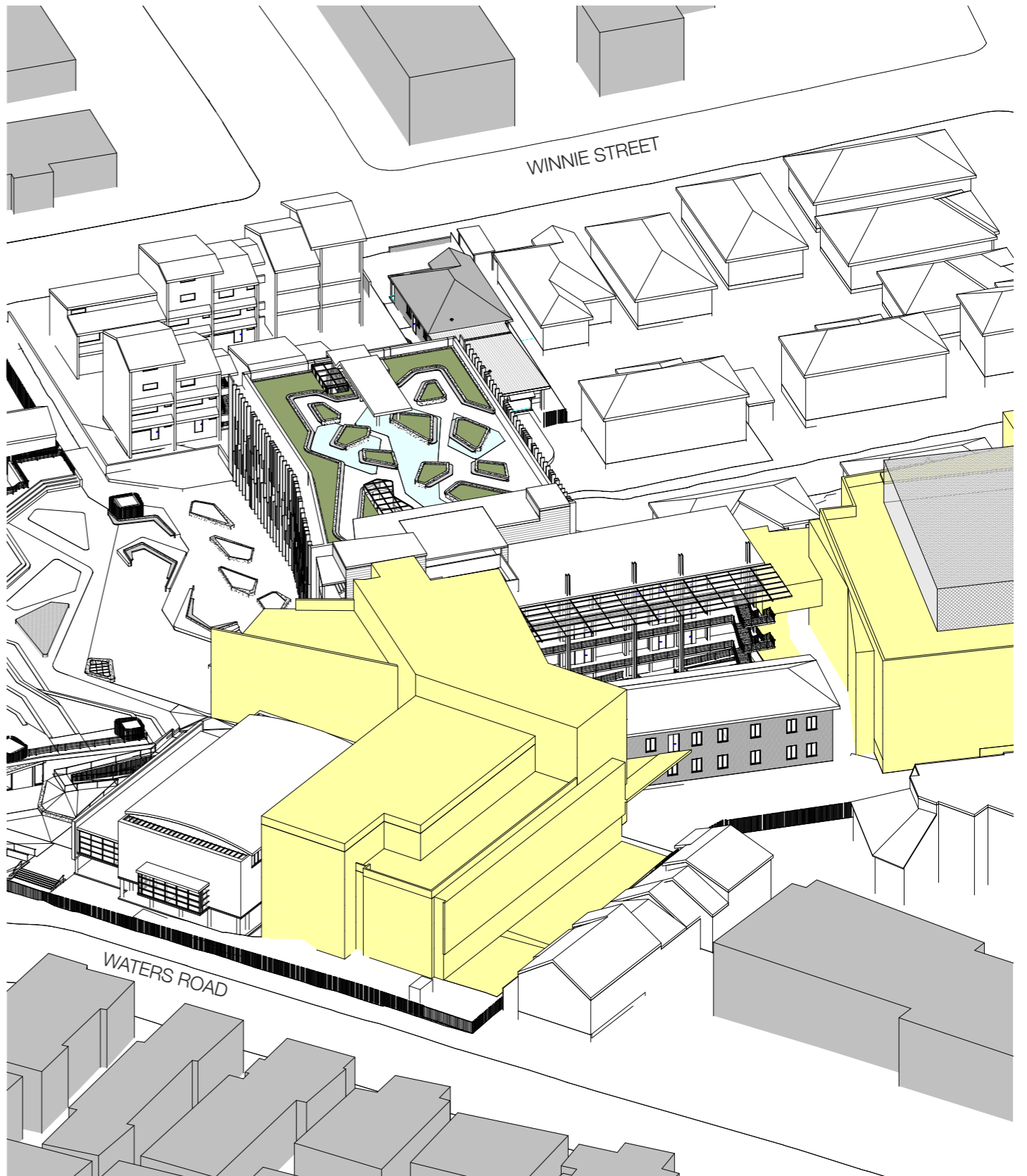
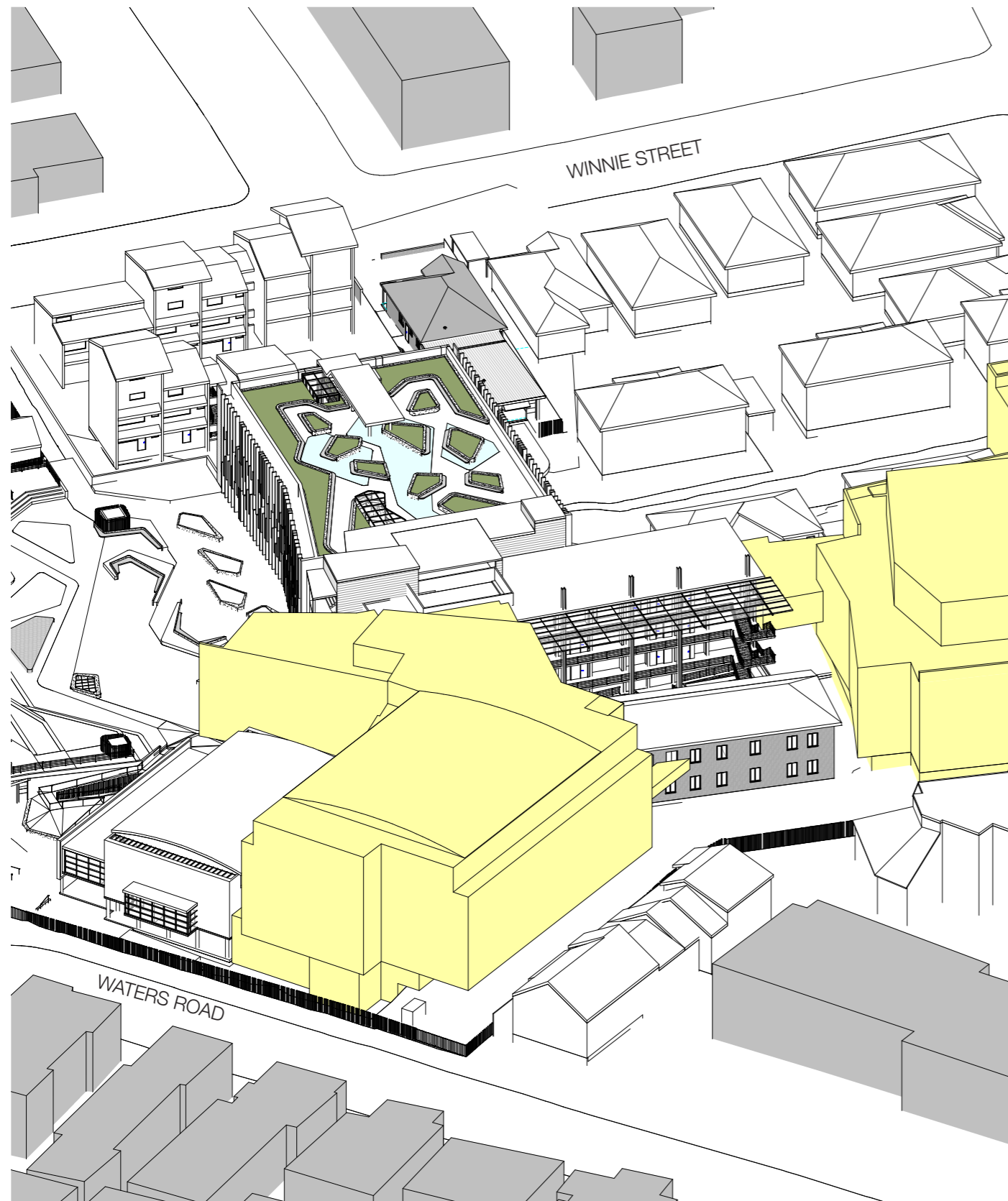

Lodged Application

Revised Design
Additional setbacks + relocate pool to basement

NEW HUMPHERY LEARNING HUB - STAGE 4

BUILDING ENVELOPE

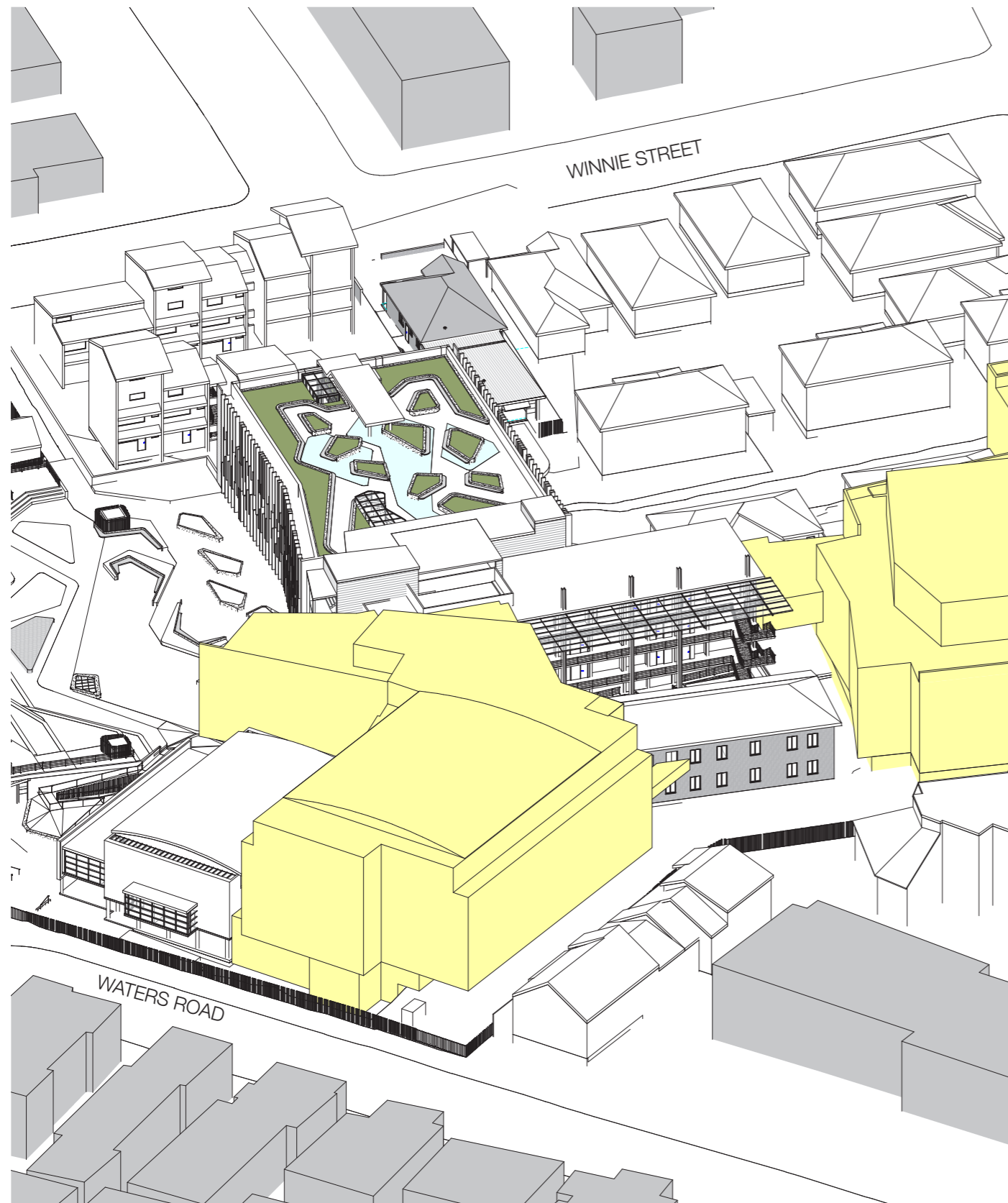

Lodged Application

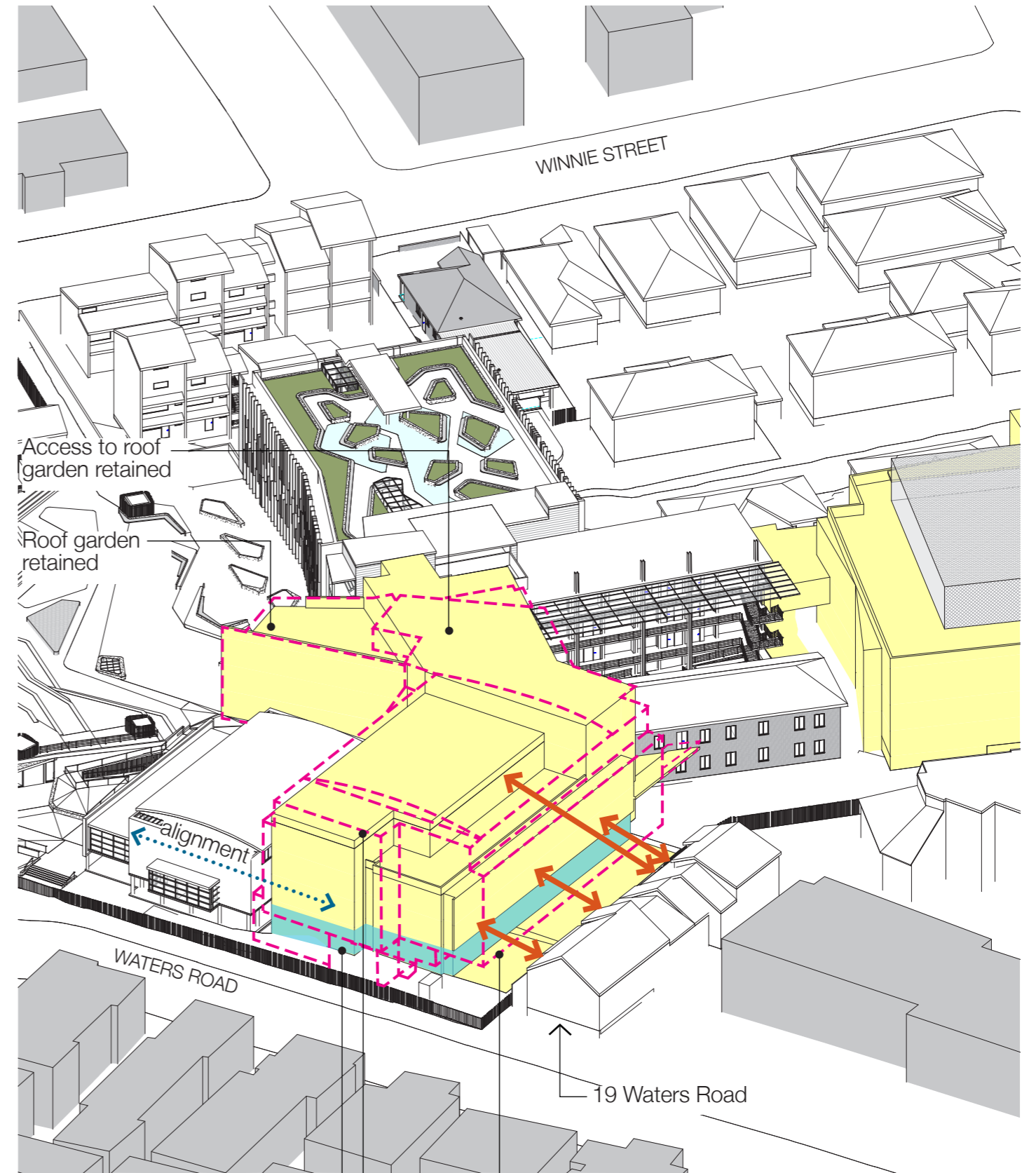

Revised Design
Additional setbacks +
relocate pool to basement

- Increased setback
- Reduced height towards Waters Road
- Pool in basement and level 1



Lodged Application

