



PLANTING ON STRUCTURE:
725.26 SQM

NORTH POINT

Stanic architects is the owner of the copyright subsisting in these drawings, plans, designs and specifications. They must not be used, reproduced or copied, in whole or in part, nor may the information, ideas and concepts therein contained (which are confidential to Stanic architects) be disclosed to any person without the prior written consent of that company.

NSW GOVERNMENT
Planning

Issued under the Environmental Planning and Assessment Act 1979

Approved Application No. SSD 6387

granted on the 1/12/14

Signed [Signature]

Sheet No. 47 of 63

REV	DESCRIPTION OF CHANGE	DATE
H	DA REVISION	05/09/14

PROJECT MANAGER
IONIC MANAGEMENT PTY. LTD
LEVEL 37, CHIFLEY TOWER, 2 CHIFLEY SQUARE SYDNEY 2000
P: 02 8313 0240
0294@ionic.net.au

CLIENT
PAYCE CONSOLIDATED LTD
LEVEL 37, CHIFLEY TOWER, 2 CHIFLEY SQUARE SYDNEY 2000
P: 02 8080 2300
F: 02 8059 2399
reception@payce.com.au

ARCHITECTS
stanic architects
Level 3 346 Kent Street Sydney NSW 2000
T: (61 2) 9299 7874
F: (61 2) 9299 7872
E: info@stanic.com.au
ABN: 11002633481

HR | RICE DAUBNEY

PROJECT
SOPA "DOCK" 1 BURROWAY RD
WENTWORTH POINT, THE WHARF SITE SYDNEY OLYMPIC PARK

DRAWING TITLE
SEPP 65 DIAGRAM
PLANTING ON STRUCTURE

SCALE:
1:400 @ A3

CHECKED: [Signature]
Checker

PROJECT NUMBER: 12005
DRAWING NUMBER: SK-0003
ISSUE: H

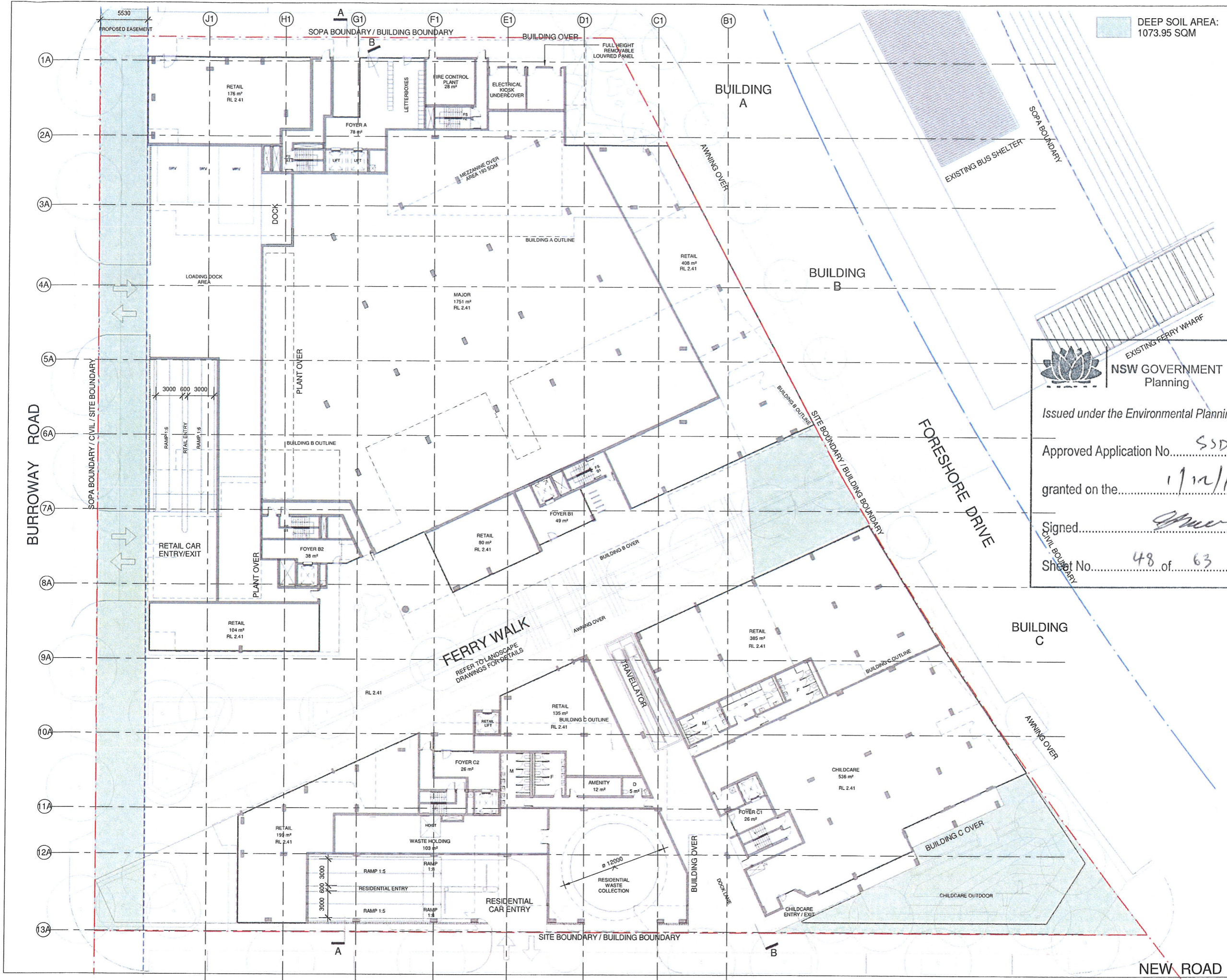

DEEP SOIL AREA:
1073.95 SQM

NORTH POINT

Stanisic architects is the owner of the copyright subsisting in these drawings, plans, designs and specifications. They must not be used, reproduced or copied, in whole or in part, nor may the information, ideas and concepts therein contained (which are confidential to Stanisic architects) be disclosed to any person without the prior written consent of that company.

REV	DESCRIPTION OF CHANGE	DATE
H	DA REVISION	05/09/14



NSW GOVERNMENT
Planning

Issued under the Environmental Planning and Assessment Act 1979

Approved Application No. SSD 6587

granted on the 1/12/14

Signed [Signature]

Sheet No. 48 of 63

PROJECT MANAGER
IONIC MANAGEMENT PTY. LTD
LEVEL 37, CHIFLEY TOWER, 2 CHIFLEY SQUARE SYDNEY 2000 P: 62 8033 0240



CLIENT
PAYCE CONSOLIDATED LTD
LEVEL 37, CHIFLEY TOWER, 2 CHIFLEY SQUARE SYDNEY 2000 P: 62 8009 2300 F: 62 8009 2399



ARCHITECTS
stanisic architects
Level 3 346 Kent Street Sydney NSW 2000 T: (61 2) 9299 7871 F: (61 2) 9299 7872 E: info@stanisic.com.au ABN 11002633481

HDR | RICE DAUBNEY

PROJECT
SOPA "DOCK" 1 BURROWAY RD
WENTWORTH POINT, THE WHARF SITE SYDNEY OLYMPIC PARK

DRAWING TITLE
SEPP 65 DIAGRAM DEEP SOIL

SCALE: 1:400 @ A3 CHECKED: [Signature] Checker

PROJECT NUMBER: 12005 DRAWING NUMBER: SK-0004 ISSUE: H

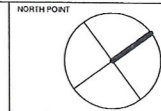

Stanisic architects is the owner of the copyright subsisting in these drawings, plans, designs and specifications. They must not be used, reproduced or copied, in whole or in part, nor may the information, ideas and concepts therein contained (which are confidential to Stanisic architects) be disclosed to any person without the prior written consent of that company.



NSW GOVERNMENT
Planning

Issued under the Environmental Planning and Assessment Act 1979

Approved Application No. SSD 6387

granted on the 1/12/14

Signed [Signature]

Sheet No. 49 of 63

REV	DESCRIPTION OF CHANGE	DATE

PROJECT MANAGER
IONIC MANAGEMENT PTY. LTD
LEVEL 37, CHIFLEY TOWER, 2 CHIFLEY SQUARE SYDNEY 2000 P: 62 8513 0240 cym@ionic.net.au



CLIENT
PAYCE CONSOLIDATED LTD
LEVEL 37, CHIFLEY TOWER, 2 CHIFLEY SQUARE SYDNEY 2000 P: 62 8080 2200 F: 62 8080 2209 reception@payce.com.au



ARCHITECTS
stanisic architects
Level 3 346 Kent Street Sydney NSW 2000 T (61 2) 9299 7871 F (61 2) 9299 7872 E info@stanisic.com.au ABN 11002633481

HDR | RICE DAUBNEY
PROJECT
SOPA
"DOCK" 1 BURROWAY RD
HEINTWORTH POINT, THE WHARF SITE
SYDNEY OLYMPIC PARK

DRAWING TITLE
SEPP 65 DIAGRAM
TYPICAL LOWER RESIDENTIAL
LEVELS SETBACKS (LEVEL 3-5)

SCALE: 1:400 @ A3	CHECKED: Checker
PROJECT NUMBER 12005	DRAWING NUMBER SK-0005
ISSUE: H	

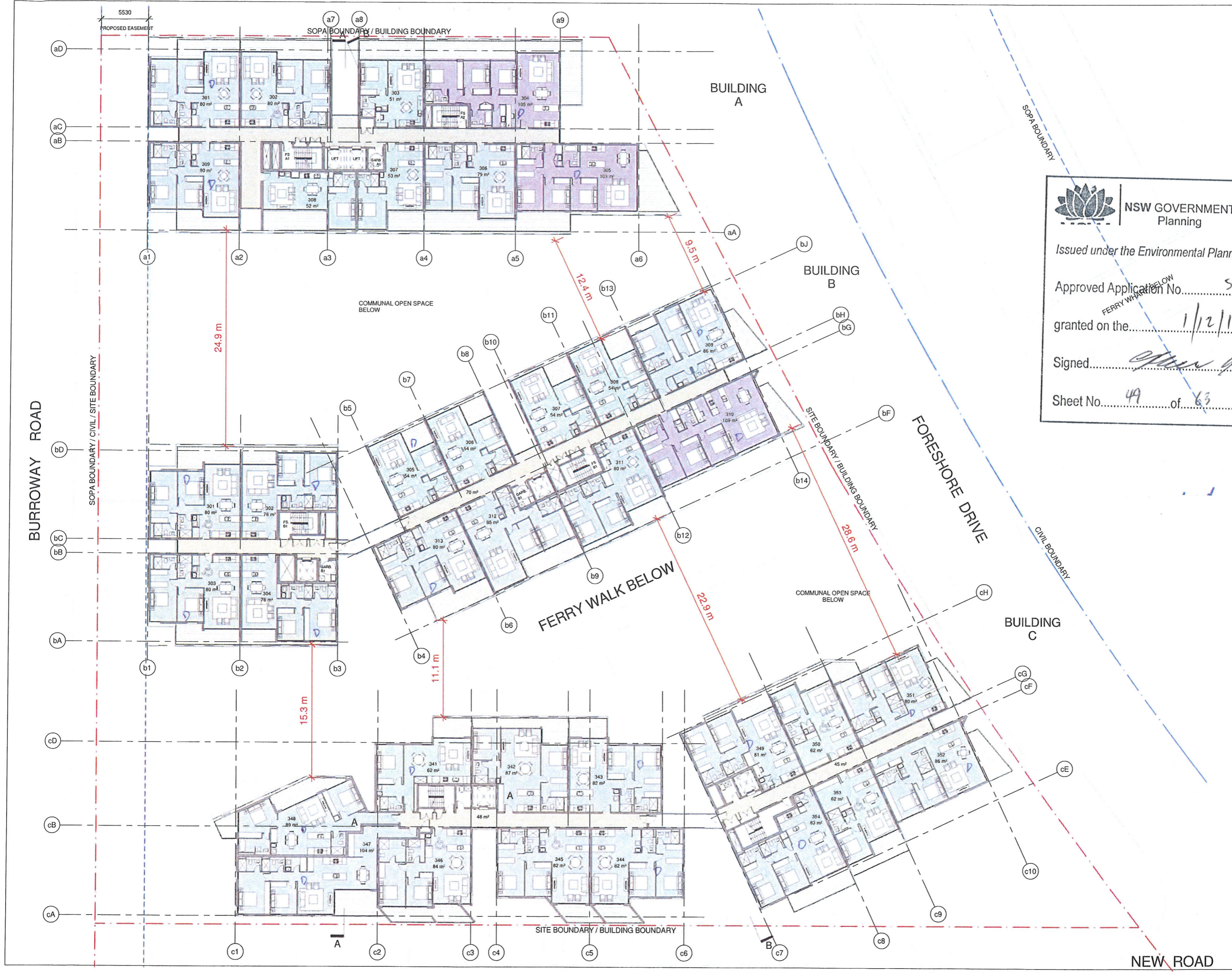

BURROWAY ROAD

FORESHORE DRIVE

NEW ROAD

BUILDING A

BUILDING B

BUILDING C

FERRY WALK BELOW

COMMUNAL OPEN SPACE BELOW

COMMUNAL OPEN SPACE BELOW

SITE BOUNDARY / BUILDING BOUNDARY

SOPA BOUNDARY / BUILDING BOUNDARY

SOPA BOUNDARY

SITE BOUNDARY / BUILDING BOUNDARY

CIVIL BOUNDARY

5530
PROPOSED EASEMENT

24.9 m

12.4 m

9.5 m

28.6 m

22.9 m

11.1 m

15.3 m



NORTH POINT

Stanisic architects is the owner of the copyright subsisting in these drawings, plans, designs and specifications. They must not be used, reproduced or copied, in whole or in part, nor may the information, ideas and concepts therein contained (which are confidential to Stanisic architects) be disclosed to any person without the prior written consent of that company.

REV	DESCRIPTION OF CHANGE	DATE
H	DA REVISION	05/03/14

NSW GOVERNMENT
Planning

Issued under the Environmental Planning and Assessment Act 1979

Approved Application No. SSD 6387

granted on the 1/12/14

Signed [Signature]

Sheet No. 50 of 63

PROJECT MANAGER
IONIC MANAGEMENT PTY. LTD

LEVEL 37, CHIFLEY TOWER, 2 CHIFLEY SQUARE
SYDNEY 2000 P: 02 8313 0240
enquiries@ionic.net.au

CLIENT
PAYCE CONSOLIDATED LTD

LEVEL 37, CHIFLEY TOWER, 2 CHIFLEY SQUARE
SYDNEY 2000 P: 02 8080 2300
F: 02 8080 2299
reception@payce.com.au

ARCHITECTS
stanisic architects

Level 3 346 Kent Street
Sydney NSW 2000
T: (61 2) 9299 7871
F: (61 2) 9299 7872
E: info@stanisic.com.au
ABN: 11 002633481

HDR | RICE DAUBNEY

PROJECT
SOPA
"DOCK" 1 BURROWAY RD
HEWORTH POINT, THE WHARF SITE
SYDNEY OLYMPIC PARK

DRAWING TITLE
**SEPP 65 DIAGRAM
TYPICAL MID RESIDENTIAL LEVELS
SETBACKS (LEVEL 6 - 7)**

SCALE 1:400 @ A3	CHECKED Checker
PROJECT NUMBER 12005	DRAWING NUMBER SK-0006
ISSUE H	

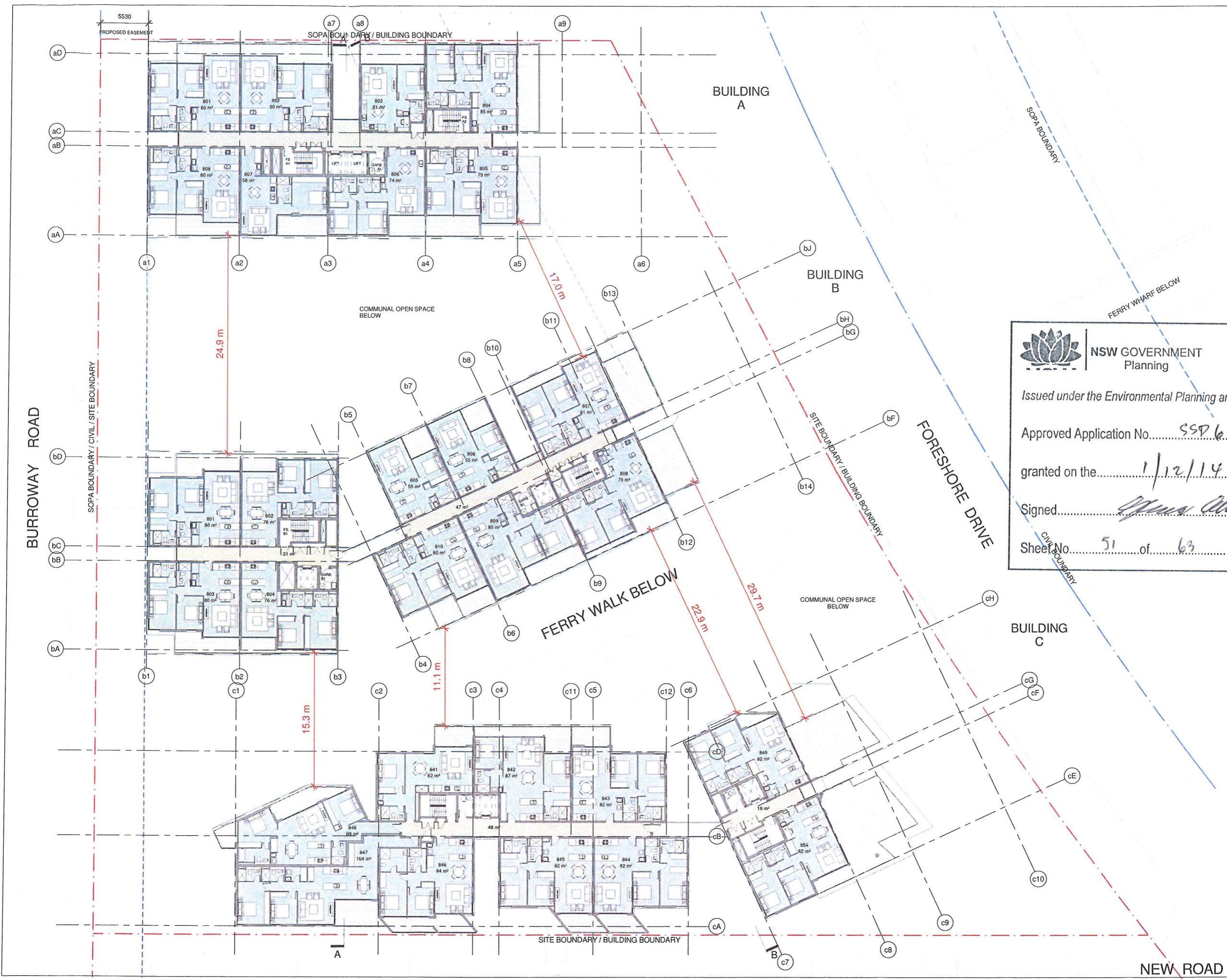

STATIS ARCHITECTS IS THE OWNER OF THE COPYRIGHT SUBSISTING IN THESE DRAWINGS, PLANS, DESIGNS AND SPECIFICATIONS. THEY MUST NOT BE USED, REPRODUCED OR COPIED, IN WHOLE OR IN PART, NOR MAY THE INFORMATION, IDEAS AND CONCEPTS THEREIN CONTAINED (WHICH ARE CONFIDENTIAL TO STATIS ARCHITECTS) BE DISCLOSED TO ANY PERSON WITHOUT THE PRIOR WRITTEN CONSENT OF THAT COMPANY.

REV	DESCRIPTION OF CHANGE	DATE
H	QA REVIEW	05/03/14

NSW GOVERNMENT
Planning

Issued under the Environmental Planning and Assessment Act 1979

Approved Application No. SSP 6327

granted on the 1/12/14

Signed [Signature]

Sheet No. 51 of 63

PROJECT MANAGER
IONIC MANAGEMENT PTY. LTD
LEVEL 37, CHIFLEY TOWER, 2 CHIFLEY SQUARE SYDNEY 2000
P: 02 9313 0340
enquiries@ionic.net.au

CLIENT
PAYCE CONSOLIDATED LTD
LEVEL 37, CHIFLEY TOWER, 2 CHIFLEY SQUARE SYDNEY 2000
P: 02 8080 2300
F: 02 8080 2370
reception@payce.com.au

ARCHITECTS
stanis architects
Level 3 346 Kent Street Sydney NSW 2000
T (61 2) 9299 7871
F (61 2) 9299 7872
E info@stanis.com.au
ABN 11002633481

PROJECT
SOPA "DOCK" 1 BURROWAY RD
WENTWORTH POINT, THE WHARF SITE SYDNEY OLYMPIC PARK

DRAWING TITLE
SEPP 65 DIAGRAM
TYPICAL UPPER RESIDENTIAL LEVELS SETBACKS (LEVEL 8-9)

SCALE	1:400 @ A3	CHECKED	Checker
PROJECT NUMBER	DRAWING NUMBER	ISSUE	
12005	SK-0007	H	

SOPA FERRY WHARF WENTWORTH POINT

MIXED USE DEVELOPMENT

DEVELOPMENT APPLICATION PACKAGE



NSW GOVERNMENT
Planning

Issued under the Environmental Planning and Assessment Act 1979

Approved Application No. SPD 6387

granted on the 1/12/14

Signed [Signature]

Sheet No. 52 of 63

DRAWING SCHEDULE

DRG No.	DRAWING TITLE
C1.01	COVER SHEET, DRAWING SCHEDULE AND LOCALITY PLAN
C2.01	CONCEPT SEDIMENT AND EROSION CONTROL PLAN
C2.11	CONCEPT SEDIMENT AND EROSION CONTROL DETAILS
C4.01	ROAD AND CONCEPT DRAINAGE LAYOUT - SHEET 1
C4.02	ROAD AND CONCEPT DRAINAGE LAYOUT - SHEET 2
C4.11	LONGITUDINAL SECTION
C4.21	TYPICAL CROSS SECTIONS
C5.01	DETAILS SHEET

GENERAL NOTES

- THESE DRAWINGS SHALL BE READ IN CONJUNCTION WITH OTHER CONSULTANTS' DRAWINGS AND SPECIFICATIONS AND WITH OTHER SUCH WRITTEN INSTRUCTIONS AS MAY BE ISSUED DURING THE COURSE OF THE CONTRACT. ANY DISCREPANCY SHALL BE REFERRED TO THE ENGINEER BEFORE PROCEEDING WITH THE WORK.
- ALL DIMENSIONS ARE IN MILLIMETRES & ALL LEVELS ARE IN METRES, UNO (UNLESS NOTED OTHERWISE).
- NO DIMENSION SHALL BE OBTAINED BY SCALING THE DRAWINGS.
- ALL LEVELS AND SETTING OUT DIMENSIONS SHOWN ON THE DRAWINGS SHALL BE CHECKED ON SITE PRIOR TO THE COMMENCEMENT OF THE WORK.
- DETAIL SURVEY DATA WAS SUPPLIED BY TEAM 2, DRAWING DATED 18TH FEBRUARY 2009.
- EXISTING SERVICES WHERE SHOWN HAVE BEEN PLOTTED FROM SUPPLIED DATA AND SUCH THEIR ACCURACY CAN NOT BE GUARANTEED. IT IS THE RESPONSIBILITY OF THE CONTRACTOR TO ESTABLISH THE LEVEL OF ALL EXISTING SERVICES PRIOR TO THE COMMENCEMENT OF WORK.
- ON COMPLETION OF STORMWATER INSTALLATION, ALL DISTURBED AREAS MUST BE RESTORED TO ORIGINAL CONDITION, INCLUDING KERBS, FOOTPATHS, CONCRETE AREAS, GRAVEL AND GRASSED AREAS AND ROAD PAVEMENTS, UNLESS DIRECTED OTHERWISE.

STORMWATER DRAINAGE NOTES

- ALL STORMWATER MANAGEMENT MEASURES SHOWN ON THE DRAWINGS HAVE BEEN PREPARED FOR DEVELOPMENT APPLICATION PURPOSES TO DEMONSTRATE FEASIBILITY. ALL MEASURES WILL BE SUBJECT TO DETAIL DESIGN AT THE CONSTRUCTION CERTIFICATE STAGE AND MAY BE SUBJECT TO VARIATION PROVIDED THAT THE DESIGN INTENT IS MAINTAINED.
- THE FOLLOWING DRAWINGS SHOULD BE REVIEWED IN CONJUNCTION WITH THE INTEGRATED WATER CYCLE MANAGEMENT REPORT PREPARED BY NORTHPROP ENGINEERS
- ALL DRAINAGE LINES SHALL BE UPVC (CLASS SN4) SEWER GRADE DRAINAGE PIPE, U.N.O.
- ALL DRAINAGE LINES SHALL BE LAID AT 1% MIN. FALL, UNO.
- ALL LEVELS ARE AUSTRALIAN HEIGHT DATUM (AHD).
- ALL DOWNPIPES GUTTERS TO BE DESIGNED IN ACCORDANCE WITH AS/NZS 3500.3.2 - 2003 'STORMWATER' DRAINAGE.
- THE STORMWATER DRAINAGE DESIGN HAS BEEN CARRIED OUT IN ACCORDANCE WITH AS/NZS 3500.3.2-2003 'STORMWATER' DRAINAGE.
- ANY VARIATIONS TO THE NOMINATED LEVELS SHALL BE REFERRED TO ENGINEER IMMEDIATELY.
- SUBSOIL DRAINAGE SHALL BE PROVIDED TO ALL RETAINING WALLS & EMBANKMENTS, WITH THE LINES FEEDING INTO THE STORMWATER DRAINAGE SYSTEM.
- ALL GRATES TO BE GALVANISED STEEL WITH HINGES AND CHILD PROOF LOCK.

RAINWATER RE-USE NOTES

- PROVIDE RAINWATER RE-USE SYSTEM TO SUPPLY WATER FOR IRRIGATION AND TOILET FLUSHING.
- GUTTER GUARD TO BE INSTALLED ON ALL EAVES GUTTERS.
- A PERMANENT SIGN IS TO BE LOCATED IN THE VICINITY OF THE TANK STATING THE WATER IS 'NON POTABLE WATER' WITH APPROPRIATE HAZARD IDENTIFICATION.
- PIPEWORK USED FOR RAINWATER SERVICES SHALL BE COLOURED LILAC IN ACCORDANCE WITH AS1345.
- ALL VALVES AND APERTURES SHALL BE CLEARLY AND PERMANENTLY LABELLED WITH SAFETY SIGNS TO COMPLY WITH AS1319.
- RAINWATER TANK RETICULATION SYSTEM AND MAINS WATER BYPASS ARRANGEMENT TO BE INSTALLED IN ACCORDANCE WITH AS/NZS 3500.1.2-2003 AND THE NSW CODE OF PRACTICE - PLUMBING AND DRAINING.
- A FIRST FLUSH FILTRATION DEVICE IS TO BE PROVIDED AT RAINWATER TANK.



LOCALITY MAP

SOURCE : MAPS.GOOGLE.COM (©2013)

DESIGNED: S. MAJUMSKI
DRAWN: R. GRIEVE
JOB MANAGER: M. RICHARDS
VERIFIER:

REVISION	DESCRIPTION	ISSUED	VER'D	APP'D	DATE
1	ISSUED FOR DA APPROVAL	RG		SN	07.02.14
2	RE-ISSUED FOR DA APPROVAL	UM		RH	05.09.14



DRAWING NOT TO BE USED FOR CONSTRUCTION UNLESS VERIFICATION SIGNATURE HAS BEEN ADDED

ARCHITECT



THE COPYRIGHT OF THIS DRAWING REMAINS WITH NORTHPROP CONSULTING ENGINEERS PTY LTD

ALL DIMENSIONS TO BE VERIFIED ON SITE BEFORE COMMENCING WORK. NORTHPROP ACCEPTS NO RESPONSIBILITY FOR THE USABILITY, COMPLETENESS OR SCALE OF DRAWINGS TRANSFERRED ELECTRONICALLY. THIS DRAWING MAY HAVE BEEN PREPARED USING COLOUR, AND MAY BE INCOMPLETE IF COPIED TO BLACK & WHITE.



Level 11, 345 George Street, Sydney NSW 2000
Ph (02) 9241 4188 Fax (02) 9241 4324
Email sydney@northrop.com.au ABN 81 094 433 100

PROJECT
SOPA WENTWORTH POINT

DRAWING TITLE
CIVIL DESIGN
COVER SHEET, DRAWING SCHEDULE AND LOCALITY PLAN

JOB NUMBER
130648

DRAWING NUMBER	REVISION
C1.01	2

DRAWING SHEET SIZE = A1

NOT FOR CONSTRUCTION

Found: O:\2013\jobs\130648 - sopa ferry wharf, wentworth point - mixed use development\drawings\civ\c1.01.dwg
Printed By: umandla
Date: 05-09-14 2:22pm