

DEPOSITED PLAN ADMINISTRATION SHEET

Office Use Only

Office Use Only

Registered:
Title System:
Purpose:

DRAFT
PRINTED 26 JUN 2018
ISSUE 14

PLAN OF PROPOSED SUBDIVISION OF
LOT 5 IN D.P. 1142053 AND
LOT 1 IN D.P. 76719

LGA: SYDNEY
Locality: CHIPPENDALE
Parish: ALEXANDRIA
County: CUMBERLAND

Crown Lands NSW/Western Lands Office Approval

I..... (Authorised Officer) in
approving this plan certify that all necessary approvals in regard
to the allocation of the land shown herein have been given

Signature:
Date:
File Number:
Office:

Surveying Certificate

I, TASY MORAITIS
of Linker Surveying Pty Ltd Suite 301 Level 3 55 Holt St Surry Hills NSW 2010
a surveyor registered under the *Surveying and Spatial Information
Act 2002*, certify that

*(a) The land shown in the plan was surveyed in accordance with the
Surveying and Spatial Information Regulation, 2012, is accurate
and the survey was completed on:

*(b) The part of the land shown in the plan (being/*excluding^.....
.....)
was surveyed in accordance with the Surveying and Spatial
Information Regulation 2012, is accurate and the survey was
completed on, the part not surveyed was
compiled in accordance with that Regulation.

*(c) The land shown in this plan was compiled in accordance with the
Surveying and Spatial Information Regulation 2012.

Signature: Dated:

Surveyor ID:

Datum Line:

Type: *Urban/*Rural

The terrain is *Level-Undulating / *Steep-Mountainous.

*Strike through if inapplicable.

^Specify the land actually surveyed or specify any land shown in the plan that is not
the subject of the survey.

Subdivision Certificate

I.....
*Authorised Person/*General Manager/*accredited Certifier, certify
that the provisions of s.109J of the Environmental Planning and
Assessment Act 1979 have been satisfied in relation to the proposed
subdivision, new road or reserve set out herein.

Signature:
Accreditation no:
Consent/Authority:
Date of Endorsement:
Subdivision Certificate no:
File no:

*Strike through if inapplicable

STATEMENTS of intention to dedicate public roads, public reserves and
drainage easements

Plans used in the preparation of survey/compilation

DP's

If space is insufficient continue on PLAN FORM 6A

Signatures, Seals and Section 88B Statements should appear on
PLAN FORM 6A

SURVEYORS REFERENCE: 141021 DSUB

DEPOSITED PLAN ADMINISTRATION SHEET

Office Use Only

Office Use Only

Registered:

PLAN OF PROPOSED SUBDIVISION OF
LOT 5 IN D.P. 1142053 AND
LOT 1 IN D.P. 76719

Subdivision Certificate No:

Date of Endorsement:

DRAFT

**PRINTED 26 JUN 2018
ISSUE 14**

This sheet is for the provision of the following information as required:

- A schedule of lots and addresses - See 60(c) SSI Regulation 2012
- Statements of intention to create and release affecting interests in accordance with section 88B Conveyancing Act 1919
- Signatures and seals - see 195D Conveyancing Act 1919
- Any information which cannot fit in the appropriate panel of sheet 1 of the administration sheets.

PURSUANT TO SEC. 88B OF THE CONVEYANCING ACT 1919 IT IS INTENDED TO CREATE:

1. EASEMENT FOR SUPPORT & SHELTER (WHOLE OF LOT)
2. EASEMENT FOR SERVICES (WHOLE OF LOT)
3. EASEMENT FOR FIRE STAIRS AND PASSAGE (WHOLE OF LOT)
4. EASEMENT TO ACCESS FACILITIES (WHOLE OF LOT)
5. EASEMENT FOR ACCESS VARIABLE WIDTH (A) (LIMITED IN STRATUM)
6. EASEMENT FOR ACCESS BY FOOT VARIABLE WIDTH (B) (LIMITED IN STRATUM)
7. EASEMENT FOR PLANT ROOM & ROOF ACCESS VARIABLE WIDTH (C) (LIMITED IN STRATUM)
8. EASEMENT TO PERMIT ENCROACHING STRUCTURES TO REMAIN WITHIN ROAD WIDENING VARIABLE WIDTH (D) (LIMITED IN STRATUM)
9. POSITIVE COVENANT (GWTP WITHIN ROAD WIDENING)
10. POSITIVE COVENANT (GWTP WITHIN LOT 50)
11. EASEMENT FOR WTP SERVICES VARIABLE WIDTH (LIMITED IN STRATUM)
12. EASEMENT FOR CTP SERVICES VARIABLE WIDTH (LIMITED IN STRATUM)
13. EASEMENT FOR PUBLIC ACCESS VARIABLE WIDTH (F) (LIMITED IN STRATUM)
14. RESTRICTION ON THE USE OF LAND VARIABLE WIDTH (G) (LIMITED IN STRATUM)
15. EASEMENT FOR EXHAUST PURPOSES VARIABLE WIDTH (H) LIMITED IN STRATUM)
16. EASEMENT FOR END OF JOURNEY FACILITIES VARIABLE WIDTH (J) (LIMITED IN STRATUM)
17. POSITIVE COVENANT (STREET LIGHTING ABOVE ROAD WIDENING LIMITED IN STRATUM)
18. EASEMENT TO ACCESS AND USE CAR SHARE PARKING SPACE VARIABLE WIDTH (K) (LIMITED IN STRATUM)
19. EASEMENT FOR EGRESS PURPOSES VARIABLE WIDTH (L) (LIMITED IN STRATUM)
20. EASEMENT FOR GARBAGE PURPOSES VARIABLE WIDTH (M)(LIMITED IN STRATUM)
21. EASEMENT FOR ACCESS BY FOOT VARIABLE WIDTH (B1) (LIMITED IN STRATUM)

If space is insufficient use additional annexure sheet

SURVEYORS REFERENCE: 141021 DSUB

DEPOSITED PLAN ADMINISTRATION SHEET

Sheet 3 of 3 sheet(s)

Office Use Only

Office Use Only

Registered:

PLAN OF PROPOSED SUBDIVISION OF
LOT 5 IN D.P. 1142053 AND
LOT 1 IN D.P. 76719

Subdivision Certificate No:

Date of Endorsement:

DRAFT

**PRINTED 26 JUN 2018
ISSUE 14**

- This sheet is for the provision of the following information as required:
- A schedule of lots and addresses - See 60(c) SSI Regulation 2012
 - Statements of intention to create and release affecting interests in accordance with section 88B Conveyancing Act 1919
 - Signatures and seals - see 195D Conveyancing Act 1919
 - Any information which cannot fit in the appropriate panel of sheet 1 of the administration sheets.

If space is insufficient use additional annexure sheet

SURVEYORS REFERENCE: 141021 DSUB

THIS PLAN IS BASED ON PLANS BY
FJMT ARCHITECTS
DWG No.: ARC-FJMT-23B201_DWG[05]
21 FEB 2017

BELOW BASEMENT LEVEL 2

SCHEDULE OF STRATUM LOTS

- LOT 50 - RETAIL STRATUM LOT
- LOT 51 - RESIDENTIAL LOT
- LOT 52 - CASTLE CONNELL HOTEL STRATUM LOT
- LOT 53 - O'CONNOR STREET ROAD WIDENING STRATUM LOT
- LOT 54 - WELLINGTON STREET ROAD WIDENING STRATUM LOT

PUBLIC RESERVE
(COUNCIL PARK)

14 D.P. 1194122

S.P. 88565

S.P. 89975

CARLTON STREET

M.G.A. NORTH

O'CONNOR (TO BE DEDICATED) STREET

PT 53

PROPOSED ROAD WIDENING (PARTLY LIMITED IN STRATUM)

HERITAGE TANK

PT 51

PT 50

(AREA BELOW THE BASEMENT LEVEL2 FLOOR SLAB FORMS PART OF LOT 50)

BALFOUR STREET

KENSINGTON STREET

PT 54

PROPOSED ROAD WIDENING (VARIABLE WIDTH AND PARTLY LIMITED IN STRATUM)
WELLINGTON STREET

PT 50

SEE SHEET 5 OF 11

SEE SHEET 5 OF 11

STREET

PT 52

SCHEDULE OF WHOLE OF LOT

- EASEMENTS**
- EASEMENT FOR SUPPORT & SHELTER
 - EASEMENT FOR SERVICES
 - EASEMENT FOR FIRE EGRESS
 - EASEMENT TO ACCESS SHARED FACILITIES

Surveyor: TASY MORAITIS
Date of Survey:
Surveyor's Ref: 141021 DSUB

PLAN OF PROPOSED SUBDIVISION OF
LOT 5 IN D.P. 1142053 AND
LOT 1 IN D.P. 76719

LGA: SYDNEY
Locality: CHIPPENDALE
Subdivision No:
Lengths are in metres. Reduction Ratio 1:300

REGISTERED
CONTRACT PLAN
Plan compiled from
architectural CAD data.
Plan is subject to final
survey after completion
of construction.

DRAFT
PRINTED 26 JUN 2018
ISSUE 14

THIS PLAN IS BASED ON PLANS BY
FJMT ARCHITECTS
DWG No.: ARC-FJMT-23B201_DWG[05]
21 FEB 2017

BASEMENT LEVEL 2

SCHEDULE OF STRATUM LOTS

- LOT 50 - RETAIL STRATUM LOT
- LOT 51 - RESIDENTIAL LOT
- LOT 52 - CASTLE CONNELL HOTEL STRATUM LOT
- LOT 53 - O'CONNOR STREET ROAD WIDENING STRATUM LOT
- LOT 54 - WELLINGTON STREET ROAD WIDENING STRATUM LOT

PUBLIC RESERVE
(COUNCIL PARK)
14 D.P. 1194122

S.P. 88565

S.P. 89975

CARLTON STREET

M.G.A. NORTH

O'CONNOR (TO BE DEDICATED) STREET

PT 53

PROPOSED ROAD WIDENING (PARTLY LIMITED IN STRATUM)

HERITAGE TANK TANK

BALFOUR STREET

PT 51

STREET

PT 50

PT 50

PT 50

PROPOSED ROAD WIDENING (VARIABLE WIDTH AND PARTLY LIMITED IN STRATUM)

WELLINGTON STREET

PT 54

PT 50

STREET

PT 52

KENSINGTON STREET

- (A) - EASEMENT FOR ACCESS VARIABLE WIDTH (LIMITED IN STRATUM)
- (AA) - EASEMENT FOR STORMWATER DRAINAGE AND SEWERAGE PURPOSES (I568157)
- (D) - EASEMENT TO PERMIT ENCRANCHING STRUCTURES TO REMAIN WITHIN ROAD WIDENING (PILE WALL)

<p>Surveyor: TASY MORATIS Date of Survey: Surveyor's Ref: 141021 DSUB</p>	<p>PLAN OF PROPOSED SUBDIVISION OF LOT 5 IN D.P. 1142053 AND LOT 1 IN D.P. 76719</p>	<p>LGA: SYDNEY Locality: CHIPPENDALE Subdivision No: Lengths are in metres. Reduction Ratio 1:300</p>	<p>REGISTERED CONTRACT PLAN Plan compiled from architectural CAD data. Plan is subject to final survey after completion of construction.</p>	<p>DRAFT PRINTED 26 JUN 2018 ISSUE 14</p>
---	--	---	--	--

SCHEDULE OF WHOLE OF LOT EASEMENTS

- EASEMENT FOR SUPPORT & SHELTER
- EASEMENT FOR SERVICES
- EASEMENT FOR FIRE EGRESS
- EASEMENT TO ACCESS SHARED FACILITIES

THIS PLAN IS BASED ON PLANS BY
FJMT ARCHITECTS
DWG No.: ARC-FJMT-23B101_DWG[06]
21 FEB 2017

SCHEDULE OF STRATUM LOTS

- LOT 50 - RETAIL STRATUM LOT
- LOT 51 - RESIDENTIAL LOT
- LOT 52 - CASTLE CONNELL HOTEL STRATUM LOT
- LOT 53 - O'CONNOR STREET ROAD WIDENING STRATUM LOT
- LOT 54 - WELLINGTON STREET ROAD WIDENING STRATUM LOT

PUBLIC RESERVE
(COUNCIL PARK)
14 D.P. 1194122

S.P. 88565

S.P. 89975

BASEMENT LEVEL 1

O'CONNOR (TO BE DEDICATED) STREET

CARLTON STREET

M.G.A. NORTH

PT 53 PROPOSED ROAD WIDENING (PARTLY LIMITED IN STRATUM)

PT 50

BALFOUR STREET

4.4072

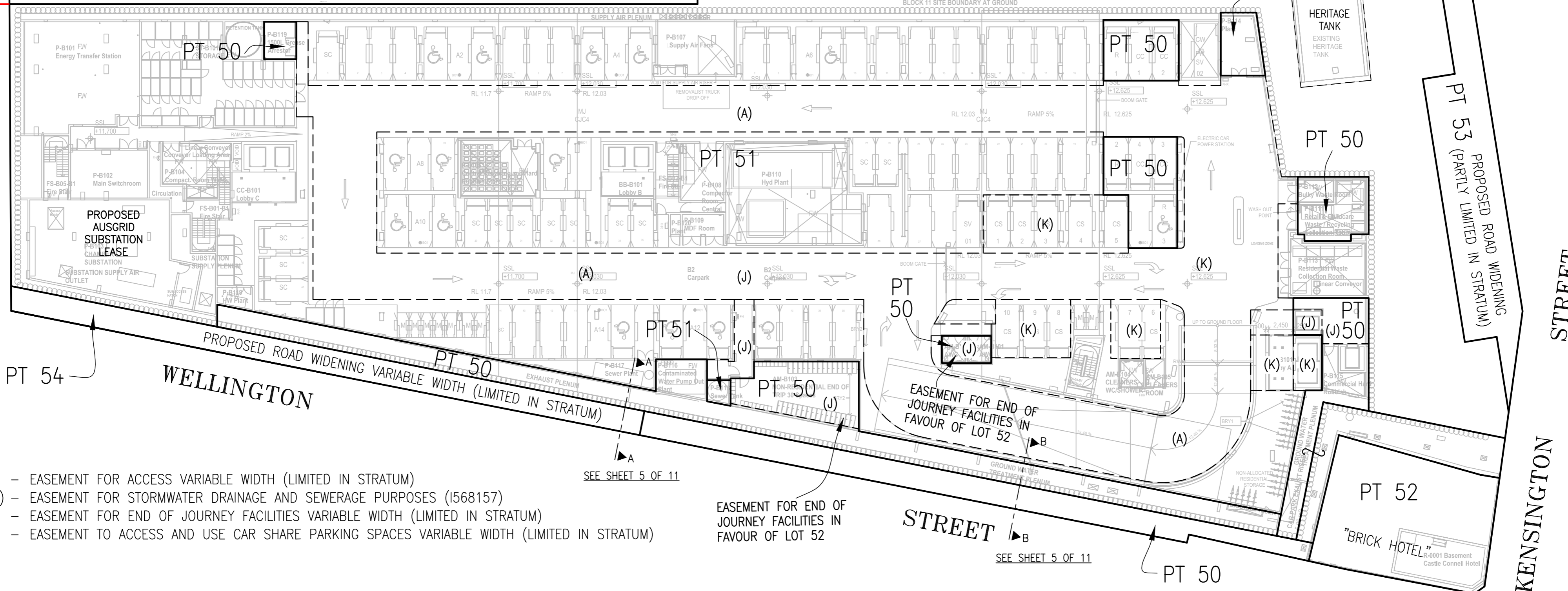

PT 54

WELLINGTON PROPOSED ROAD WIDENING VARIABLE WIDTH (LIMITED IN STRATUM)

- (A) - EASEMENT FOR ACCESS VARIABLE WIDTH (LIMITED IN STRATUM)
- (AA) - EASEMENT FOR STORMWATER DRAINAGE AND SEWERAGE PURPOSES (I568157)
- (J) - EASEMENT FOR END OF JOURNEY FACILITIES VARIABLE WIDTH (LIMITED IN STRATUM)
- (K) - EASEMENT TO ACCESS AND USE CAR SHARE PARKING SPACES VARIABLE WIDTH (LIMITED IN STRATUM)

SEE SHEET 5 OF 11

EASEMENT FOR END OF JOURNEY FACILITIES IN FAVOUR OF LOT 52

SEE SHEET 5 OF 11

SCHEDULE OF WHOLE OF LOT

- EASEMENTS
- EASEMENT FOR SUPPORT & SHELTER
- EASEMENT FOR SERVICES
- EASEMENT FOR FIRE EGRESS
- EASEMENT TO ACCESS SHARED FACILITIES

Surveyor: TASY MORAITIS
Date of Survey:
Surveyor's Ref: 141021 DSUB

PLAN OF PROPOSED SUBDIVISION OF
LOT 5 IN D.P. 1142053 AND
LOT 1 IN D.P. 76719

LGA: SYDNEY
Locality: CHIPPENDALE
Subdivision No:
Lengths are in metres. Reduction Ratio 1:300

REGISTERED
CONTRACT PLAN
Plan compiled from
architectural CAD data.
Plan is subject to final
survey after completion
of construction.

DRAFT
PRINTED 26 JUN 2018
ISSUE 14

THIS PLAN IS BASED ON PLANS BY
FJMT ARCHITECTS
DWG No.: ARC-FJMT-230001_DWG[02]
21 FEB 2017

**GROUND FLOOR
(LEVEL 00)**

SCHEDULE OF STRATUM LOTS

- LOT 50 - RETAIL STRATUM LOT
- LOT 51 - RESIDENTIAL LOT
- LOT 52 - CASTLE CONNELL HOTEL STRATUM LOT
- LOT 53 - O'CONNOR STREET ROAD WIDENING STRATUM LOT
- LOT 54 - WELLINGTON STREET ROAD WIDENING STRATUM LOT

PUBLIC RESERVE
(COUNCIL PARK)

14 D.P.1194122

S.P.88565

S.P.89975

O'CONNOR STREET (TO BE DEDICATED)

PROPOSED ROAD WIDENING (PARTLY LIMITED IN STRATUM)

PT 53

PT 51

PT 50

PT 50

PT 52

BALFOUR STREET

WELLINGTON STREET

PROPOSED ROAD WIDENING (3 WIDE & VARIABLE)

NOTE 1
SEE SHEET 5 OF 11

WELLINGTON STREET

SEE SHEET 5 OF 11

DENOTES APPROX POSITION OF
GROUND WATER MONITORING
PITS & WELLS

- (A) - EASEMENT FOR ACCESS VARIABLE WIDTH (LIMITED IN STRATUM)
- (AA) - EASEMENT FOR STORMWATER DRAINAGE AND SEWERAGE PURPOSES (I568157)
- (B) - EASEMENT FOR ACCESS BY FOOT VARIABLE WIDTH (LIMITED IN STRATUM)
- (B1) - EASEMENT FOR ACCESS BY FOOT VARIABLE WIDTH (LIMITED IN STRATUM)
- (F) - EASEMENT FOR PUBLIC ACCESS & RECREATION VARIABLE WIDTH (LIMITED IN STRATUM)
- (J) - EASEMENT FOR END OF JOURNEY FACILITIES VARIABLE WIDTH (LIMITED IN STRATUM)
- (K) - EASEMENT TO ACCESS AND USE CAR SHARE PARKING SPACES VARIABLE WIDTH (LIMITED IN STRATUM)
- (L) - EASEMENT FOR EGRESS PURPOSES VARIABLE WIDTH (LIMITED IN STRATUM)
- (M) - EASEMENT FOR GARBAGE PURPOSES VARIABLE WIDTH (LIMITED IN STRATUM)

SCHEDULE OF WHOLE OF LOT

- EASEMENTS**
- EASEMENT FOR SUPPORT & SHELTER
 - EASEMENT FOR SERVICES
 - EASEMENT FOR FIRE EGRESS
 - EASEMENT TO ACCESS SHARED FACILITIES

Surveyor: TASY MORAITIS
Date of Survey:
Surveyor's Ref: 141021 DSUB

PLAN OF PROPOSED SUBDIVISION OF
LOT 5 IN D.P. 1142053 AND
LOT 1 IN D.P. 76719

LGA: SYDNEY
Locality: CHIPPENDALE
Subdivision No:
Lengths are in metres. Reduction Ratio 1:300

REGISTERED
CONTRACT PLAN
Plan compiled from
architectural CAD data.
Plan is subject to final
survey after completion
of construction.

DRAFT
PRINTED 26 JUN 2018
ISSUE 14

THIS PLAN IS BASED ON PLANS BY
FJMT ARCHITECTS
DWG No.: ARC-FJMT-230001_DWG[02]
21 FEB 2017

SCHEDULE OF STRATUM LOTS

- LOT 50 - RETAIL STRATUM LOT
- LOT 51 - RESIDENTIAL LOT
- LOT 52 - CASTLE CONNELL HOTEL STRATUM LOT
- LOT 53 - O'CONNOR STREET ROAD WIDENING STRATUM LOT
- LOT 54 - WELLINGTON STREET ROAD WIDENING STRATUM LOT

SECTIONS

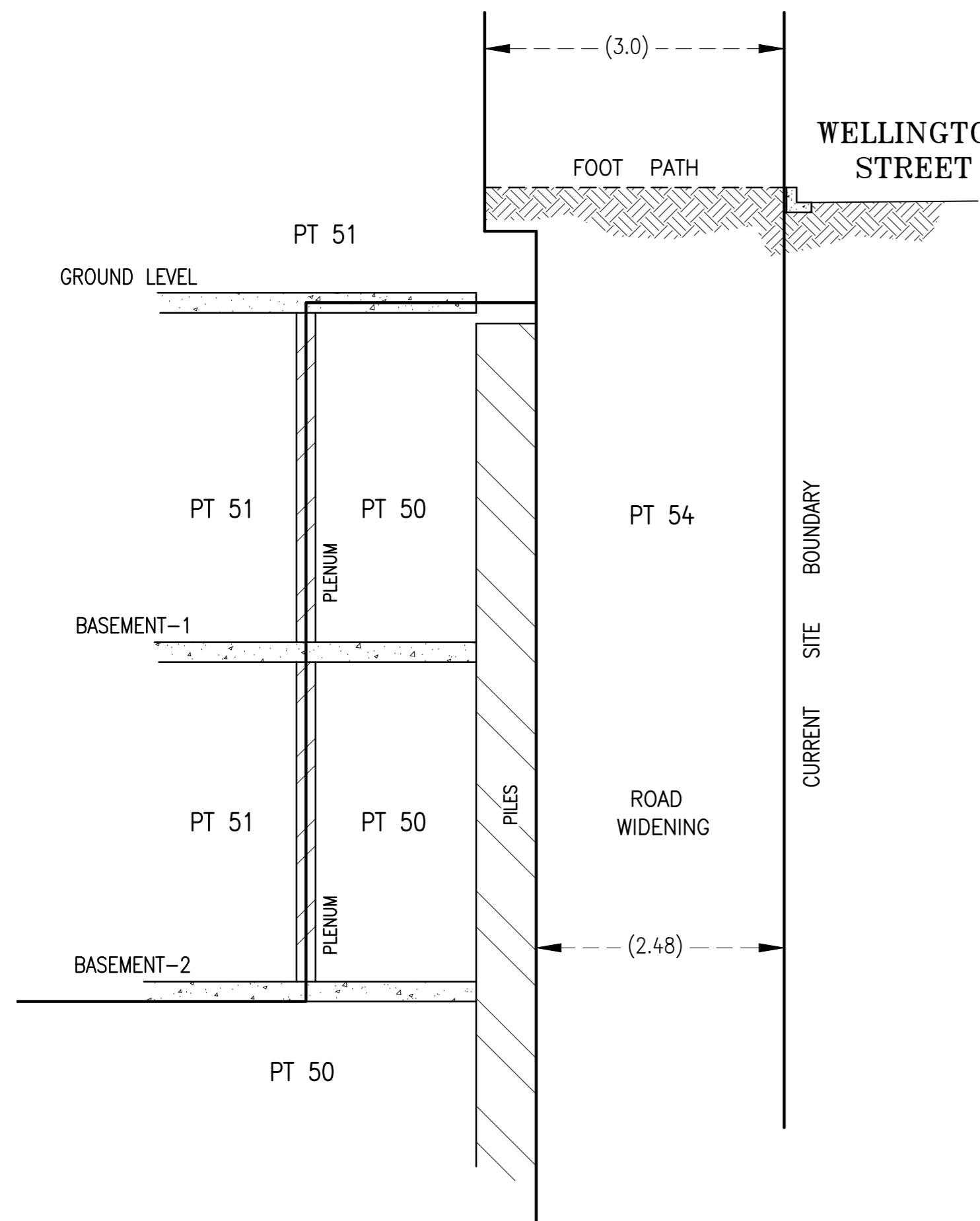

SECTION A-A
SCALE:NTS

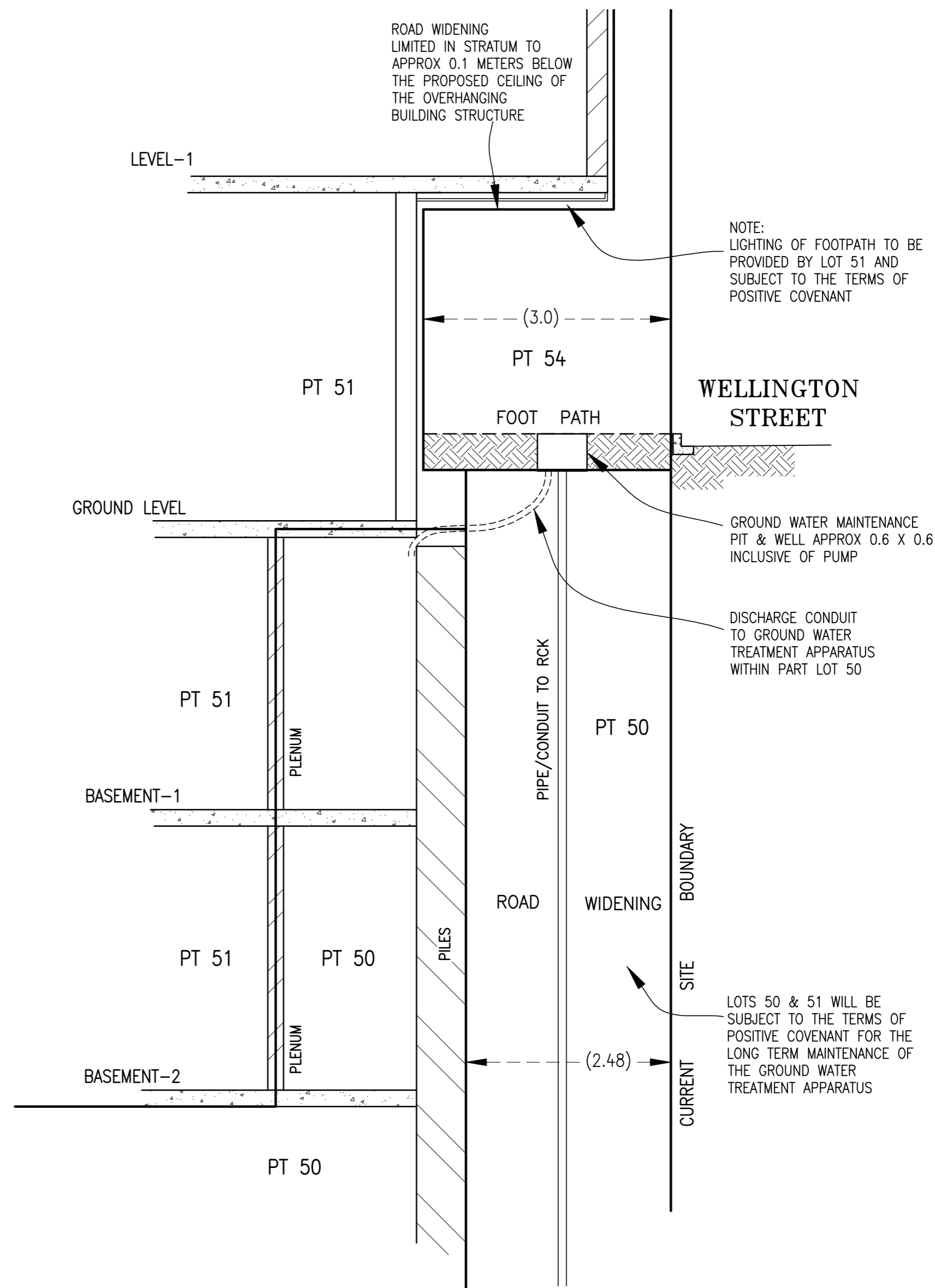

SECTION B-B
SCALE:NTS

SCHEDULE OF WHOLE OF LOT

- EASEMENTS
- EASEMENT FOR SUPPORT & SHELTER
 - EASEMENT FOR SERVICES
 - EASEMENT FOR FIRE EGRESS
 - EASEMENT TO ACCESS SHARED FACILITIES

Surveyor: TASY MORAITIS
Date of Survey:
Surveyor's Ref: 141021 DSUB

PLAN OF PROPOSED SUBDIVISION OF
LOT 5 IN D.P. 1142053 AND
LOT 1 IN D.P. 76719

LGA: SYDNEY
Locality: CHIPPENDALE
Subdivision No:
Lengths are in metres. Reduction Ratio 1:NTS

REGISTERED
CONTRACT PLAN
Plan compiled from
architectural CAD data.
Plan is subject to final
survey after completion
of construction.

DRAFT
PRINTED 26 JUN 2018
ISSUE 14

THIS PLAN IS BASED ON PLANS BY
FJMT ARCHITECTS
DWG No.: ARC-FJMT-230101_DWG[03]
21 FEB 2017

LEVEL-1

SCHEDULE OF STRATUM LOTS

- LOT 50 - RETAIL STRATUM LOT
- LOT 51 - RESIDENTIAL LOT
- LOT 52 - CASTLE CONNELL HOTEL STRATUM LOT
- LOT 53 - O'CONNOR STREET ROAD WIDENING STRATUM LOT
- LOT 54 - WELLINGTON STREET ROAD WIDENING STRATUM LOT

PUBLIC RESERVE
(COUNCIL PARK)

14 D.P. 1194122

S.P. 88565

S.P. 89975

O'CONNOR (TO BE DEDICATED) STREET

PT 53 PROPOSED ROAD WIDENING (PARTLY LIMITED IN STRATUM)

BALFOUR STREET

M.G.A. NORTH

CARLTON STREET

STREET

KENSINGTON STREET

WELLINGTON STREET

PROPOSED ROAD WIDENING (3 WIDE)

(AA) - EASEMENT FOR STORMWATER DRAINAGE AND SEWERAGE PURPOSES (I568157)

NOTE 2 - PART OF ROAD WIDENING LIMITED IN STRATUM BY LEVEL 1 PROPOSED STRUCTURE

SEE SHEET 5 OF 11

SEE SHEET 5 OF 11

SCHEDULE OF WHOLE OF LOT

EASEMENTS

- EASEMENT FOR SUPPORT & SHELTER
- EASEMENT FOR SERVICES
- EASEMENT FOR FIRE EGRESS
- EASEMENT TO ACCESS SHARED FACILITIES

Surveyor: TASY MORAITIS
Date of Survey:
Surveyor's Ref: 141021 DSUB

PLAN OF PROPOSED SUBDIVISION OF
LOT 5 IN D.P. 1142053 AND
LOT 1 IN D.P. 76719

LGA: SYDNEY
Locality: CHIPPENDALE
Subdivision No:
Lengths are in metres. Reduction Ratio 1:300

REGISTERED
CONTRACT PLAN
Plan compiled from
architectural CAD data.
Plan is subject to final
survey after completion
of construction.

DRAFT
PRINTED 26 JUN 2018
ISSUE 14

THIS PLAN IS BASED ON PLANS BY
FJMT ARCHITECTS
DWG No.: ARC-FJMT-230201_DWG[02]
21 FEB 2017

SCHEDULE OF STRATUM LOTS

- LOT 50 - RETAIL STRATUM LOT
- LOT 51 - RESIDENTIAL LOT
- LOT 52 - CASTLE CONNELL HOTEL STRATUM LOT
- LOT 53 - O'CONNOR STREET ROAD WIDENING STRATUM LOT
- LOT 54 - WELLINGTON STREET ROAD WIDENING STRATUM LOT

PUBLIC RESERVE
(COUNCIL PARK)

14 D.P. 1194122

LEVEL-2

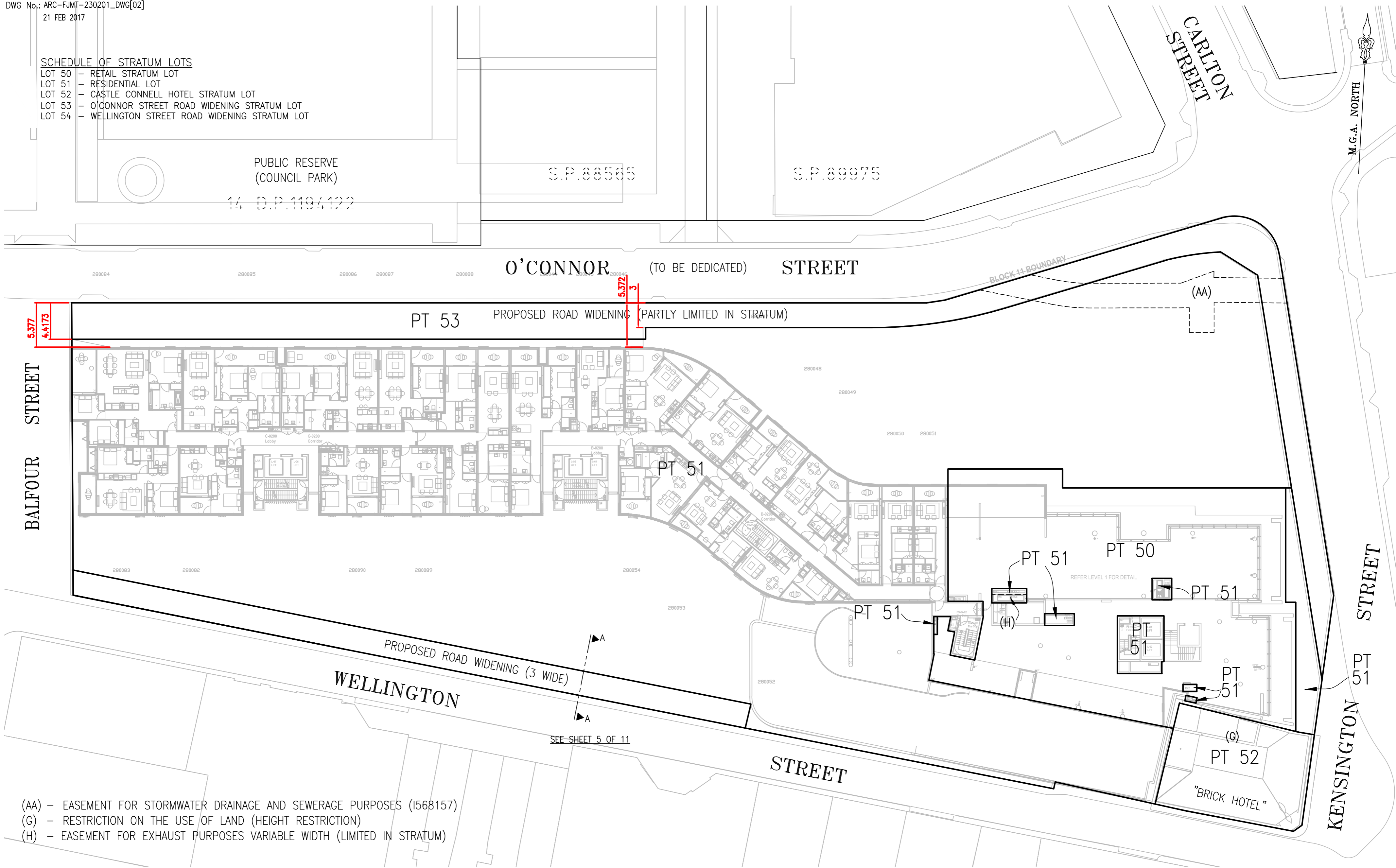

- (AA) - EASEMENT FOR STORMWATER DRAINAGE AND SEWERAGE PURPOSES (I568157)
- (G) - RESTRICTION ON THE USE OF LAND (HEIGHT RESTRICTION)
- (H) - EASEMENT FOR EXHAUST PURPOSES VARIABLE WIDTH (LIMITED IN STRATUM)

SCHEDULE OF WHOLE OF LOT

- EASEMENTS**
- EASEMENT FOR SUPPORT & SHELTER
 - EASEMENT FOR SERVICES
 - EASEMENT FOR FIRE EGRESS
 - EASEMENT TO ACCESS SHARED FACILITIES

<p>Surveyor: TASY MORATIS Date of Survey: Surveyor's Ref: 141021 DSUB</p>	<p>PLAN OF PROPOSED SUBDIVISION OF LOT 5 IN D.P. 1142053 AND LOT 1 IN D.P. 76719</p>	<p>LGA: SYDNEY Locality: CHIPPENDALE Subdivision No: Lengths are in metres. Reduction Ratio 1:300</p>	<p>REGISTERED CONTRACT PLAN Plan compiled from architectural CAD data. Plan is subject to final survey after completion of construction.</p>	<p>DRAFT PRINTED 26 JUN 2018 ISSUE 14</p>
---	--	---	--	--

THIS PLAN IS BASED ON PLANS BY
FJMT ARCHITECTS
DWG No.: ARC-FJMT-230301_DWG[02]
21 FEB 2017

LEVEL-3

SCHEDULE OF STRATUM LOTS

- LOT 50 - RETAIL STRATUM LOT
- LOT 51 - RESIDENTIAL LOT
- LOT 52 - CASTLE CONNELL HOTEL STRATUM LOT
- LOT 53 - O'CONNOR STREET ROAD WIDENING STRATUM LOT
- LOT 54 - WELLINGTON STREET ROAD WIDENING STRATUM LOT

PUBLIC RESERVE
(COUNCIL PARK)

14 D.P. 1194122

S.P. 88565

S.P. 89975

O'CONNOR STREET (TO BE DEDICATED)

CARLTON STREET

M.G.A. NORTH

PT 53

PROPOSED ROAD WIDENING (PARTLY LIMITED IN STRATUM)

BALFOUR STREET

PT 51

KENSINGTON STREET

WELLINGTON STREET

PROPOSED ROAD WIDENING (3 WIDE)

STREET

PT 52

(NOTE 3)

"BRICK HOTEL"

(TOWER PARAPET RL 29.50)

(PARAPET RL 28.00)

- (AA) - EASEMENT FOR STORMWATER DRAINAGE AND SEWERAGE PURPOSES (I568157)
- (G) - RESTRICTION ON THE USE OF LAND (HEIGHT RESTRICTION)
- (H) - EASEMENT FOR EXHAUST PURPOSES VARIABLE WIDTH (LIMITED IN STRATUM)

NOTE 3 - LOT 52 IS LIMITED IN HEIGHT TO THE TOP OF THE EXISTING PARAPET WALL. LOT 52 DOES NOT EXIST ABOVE LEVEL 3 (APPROX PARAPET RLS SHOWN ON PLAN TO BE CONFIRMED BY SURVEY)

SCHEDULE OF WHOLE OF LOT

- EASEMENTS
- EASEMENT FOR SUPPORT & SHELTER
- EASEMENT FOR SERVICES
- EASEMENT FOR FIRE EGRESS
- EASEMENT TO ACCESS SHARED FACILITIES

Surveyor: TASY MORATIS
Date of Survey:
Surveyor's Ref: 141021 DSUB

PLAN OF PROPOSED SUBDIVISION OF
LOT 5 IN D.P. 1142053 AND
LOT 1 IN D.P. 76719

LGA: SYDNEY
Locality: CHIPPENDALE
Subdivision No:
Lengths are in metres. Reduction Ratio 1:300

REGISTERED
CONTRACT PLAN
Plan compiled from
architectural CAD data.
Plan is subject to final
survey after completion
of construction.

DRAFT
PRINTED 26 JUN 2018
ISSUE 14

THIS PLAN IS BASED ON PLANS BY
FJMT ARCHITECTS
DWG No.: ARC-FJMT-230401_DWG[02]
21 FEB 2017

LEVEL-4 TO LEVEL 12

SCHEDULE OF STRATUM LOTS

- LOT 50 - RETAIL STRATUM LOT
- LOT 51 - RESIDENTIAL LOT
- LOT 52 - CASTLE CONNELL HOTEL STRATUM LOT
- LOT 53 - O'CONNOR STREET ROAD WIDENING STRATUM LOT
- LOT 54 - WELLINGTON STREET ROAD WIDENING STRATUM LOT

PUBLIC RESERVE
(COUNCIL PARK)

14 D.P. 1194122

S.P. 88565

S.P. 89975

O'CONNOR STREET (TO BE DEDICATED)

PROPOSED ROAD WIDENING (PARTLY LIMITED IN STRATUM)

PT 53

PT 51

WELLINGTON STREET

PROPOSED ROAD WIDENING (3 WIDE)

STREET

KENSINGTON STREET

CARLTON STREET

M.G.A. NORTH

BALFOUR STREET

5.4
4.4072

5.4007
3



- (AA) - EASEMENT FOR STORMWATER DRAINAGE AND SEWERAGE PURPOSES (I568157)
- (H) - EASEMENT FOR EXHAUST PURPOSES VARIABLE WIDTH (LIMITED IN STRATUM)

SCHEDULE OF WHOLE OF LOT

- EASEMENTS**
- EASEMENT FOR SUPPORT & SHELTER
 - EASEMENT FOR SERVICES
 - EASEMENT FOR FIRE EGRESS
 - EASEMENT TO ACCESS SHARED FACILITIES

Surveyor: TASY MORATIS
 Date of Survey:
 Surveyor's Ref: 141021 DSUB

PLAN OF PROPOSED SUBDIVISION OF
 LOT 5 IN D.P. 1142053 AND
 LOT 1 IN D.P. 76719

LGA: SYDNEY
 Locality: CHIPPENDALE
 Subdivision No:
 Lengths are in metres. Reduction Ratio 1:300

REGISTERED
CONTRACT PLAN
 Plan compiled from
 architectural CAD data.
 Plan is subject to final
 survey after completion
 of construction.

DRAFT
 PRINTED 26 JUN 2018
 ISSUE 14

THIS PLAN IS BASED ON PLANS BY
FJMT ARCHITECTS
DWG No.: ARC-FJMT-231301_DWG[02]
21 FEB 2017

LEVEL-13

SCHEDULE OF STRATUM LOTS

- LOT 50 - RETAIL STRATUM LOT
- LOT 51 - RESIDENTIAL LOT
- LOT 52 - CASTLE CONNELL HOTEL STRATUM LOT
- LOT 53 - O'CONNOR STREET ROAD WIDENING STRATUM LOT
- LOT 54 - WELLINGTON STREET ROAD WIDENING STRATUM LOT

PUBLIC RESERVE
(COUNCIL PARK)

14 D.P.1194122

S.P.88565

S.P.89975

O'CONNOR STREET (TO BE DEDICATED)

5.3717
4.4073
3

BLOCK 11 LOT BOUNDARY

(AA)

PT 53

PROPOSED ROAD WIDENING (PARTLY LIMITED IN STRATUM)

5.401
4.4061

BALFOUR STREET

PT 51

A-1301
38
280034

A-1302
28M
280035

A-1303
29
280036

A-1304
19M
280037

A-1305
28M
280016

A-1306
18M
280017

KENSINGTON STREET

KENSINGTON STREET

PROPOSED ROAD WIDENING (3 WIDE)

WELLINGTON STREET

STREET

- (AA) - EASEMENT FOR STORMWATER DRAINAGE AND SEWERAGE PURPOSES (I568157)
- (C) - EASEMENT FOR PLANT ROOM AND ROOF ACCESS VARIABLE WIDTH (C) (LIMITED IN STRATUM)
- (H) - EASEMENT FOR EXHAUST PURPOSES VARIABLE WIDTH (LIMITED IN STRATUM)

SCHEDULE OF WHOLE OF LOT

EASEMENTS

- EASEMENT FOR SUPPORT & SHELTER
- EASEMENT FOR SERVICES
- EASEMENT FOR FIRE EGRESS
- EASEMENT TO ACCESS SHARED FACILITIES

Surveyor: TASY MORATIS
Date of Survey:
Surveyor's Ref: 141021 DSUB

PLAN OF PROPOSED SUBDIVISION OF
LOT 5 IN D.P. 1142053 AND
LOT 1 IN D.P. 76719

LGA: SYDNEY
Locality: CHIPPENDALE
Subdivision No:
Lengths are in metres. Reduction Ratio 1:300

REGISTERED
CONTRACT PLAN
Plan compiled from
architectural CAD data.
Plan is subject to final
survey after completion
of construction.

DRAFT
PRINTED 26 JUN 2018
ISSUE 14

THIS PLAN IS BASED ON PLANS BY
FJMT ARCHITECTS
DWG No.: 231401 C_Roof
16 MAY 2016

ROOF LEVEL

SCHEDULE OF STRATUM LOTS

- LOT 50 - RETAIL STRATUM LOT
- LOT 51 - RESIDENTIAL LOT
- LOT 52 - CASTLE CONNELL HOTEL STRATUM LOT
- LOT 53 - O'CONNOR STREET ROAD WIDENING STRATUM LOT
- LOT 54 - WELLINGTON STREET ROAD WIDENING STRATUM LOT

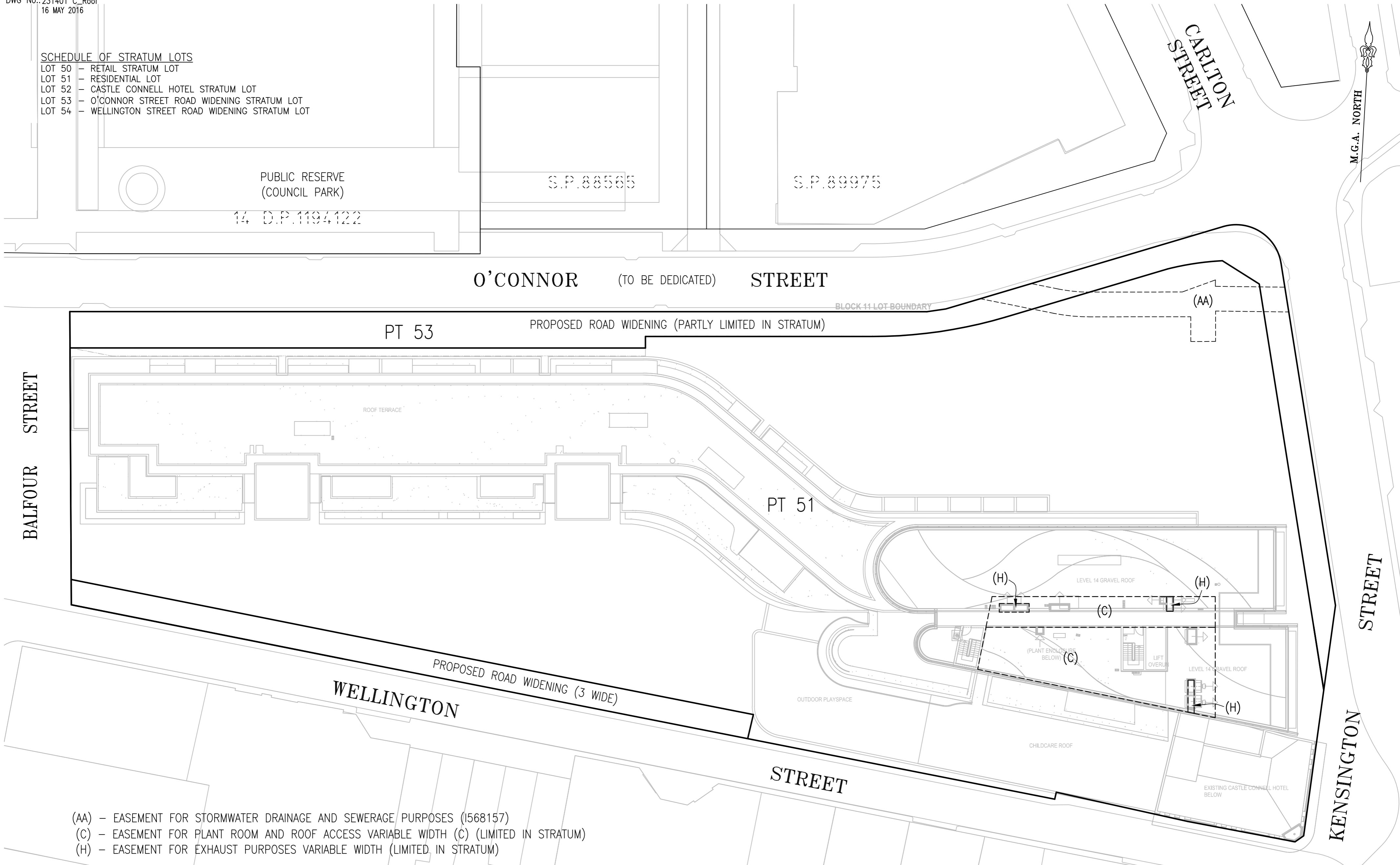

- (AA) - EASEMENT FOR STORMWATER DRAINAGE AND SEWERAGE PURPOSES (I568157)
- (C) - EASEMENT FOR PLANT ROOM AND ROOF ACCESS VARIABLE WIDTH (C) (LIMITED IN STRATUM)
- (H) - EASEMENT FOR EXHAUST PURPOSES VARIABLE WIDTH (LIMITED IN STRATUM)

SCHEDULE OF WHOLE OF LOT

- EASEMENTS**
- EASEMENT FOR SUPPORT & SHELTER
 - EASEMENT FOR SERVICES
 - EASEMENT FOR FIRE EGRESS
 - EASEMENT TO ACCESS SHARED FACILITIES

Surveyor: TASY MORAITIS
 Date of Survey:
 Surveyor's Ref: 141021 DSUB

PLAN OF PROPOSED SUBDIVISION OF
 LOT 5 IN D.P. 1142053 AND
 LOT 1 IN D.P. 76719

LGA: SYDNEY
 Locality: CHIPPENDALE
 Subdivision No:
 Lengths are in metres. Reduction Ratio 1:300

REGISTERED
CONTRACT PLAN
 Plan compiled from
 architectural CAD data.
 Plan is subject to final
 survey after completion
 of construction.

DRAFT
 PRINTED 26 JUN 2018
 ISSUE 14