

GENERAL NOTES
 ALL DIMENSIONS AND EXISTING CONDITIONS SHALL BE CHECKED AND VERIFIED BY THE CONTRACTOR BEFORE PROCEEDING WITH THE WORK
 ALL LEVELS RELATIVE TO AUSTRALIAN HEIGHT DATUM
 DO NOT SCALE DRAWINGS. USE FIGURED DIMENSIONS ONLY

LEGEND

S	STUDIO
1B	1 BED
1BM	1 BED + MEDIA NOOK
1BS	1 BED + STUDY
2B	2 BED
2BM	2 BED + MEDIA NOOK
2BK	2 BED DUAL KEY
2BT	2 BED 2 STOREY TERRACE
3B	3 BED
3BM	3 BED + MEDIA NOOK
3BS	3 BED + STUDY
4B	4 BED
	RETAIL + NON-RESIDENTIAL
	CHILDCARE
	EXTERNAL AREA
	COURTYARD/BALCONY/WINTER-GARDEN

- 2 HOURS OF SUNLIGHT ACCESS
- NATURAL VENTILATION (NV)
- WIDE FRONTAGE NATURALLY VENTILATED
- ASSISTED VENTILATION
- SOUTH FACING APARTMENT
- ADAPTABLE APARTMENT
- LOBBY DUCTED VENTILATION
- APARTMENT ASSISTED VENT. SLICE
- ASSISTED VENTILATION
- FOOD VENTILATION
- NATURAL VENTILATION
- LOBBY CROSS VENTILATION

- FAC01** Anodised aluminium Curtain Wall System with integrated operable windows with aluminium clip-on custom profiled extrusions
- FAC02** Anodised aluminium Window Wall System with integrated operable windows and door systems (allow for 50/50 split between sliding and bi-fold functionality). Finestration to facade system being anodised aluminium operable bi-fold perforated sunshade screens (allow for floor to floor coverage)
- FAC03** Anodised aluminium Window Wall System with integrated operable windows and door systems (allow for 50/50 split between sliding and bi-fold functionality).
- FAC04** Terracotta cladding (allow for minimum 1200 wide module)
- FAC05** Anodised aluminium sliding sunshade screen batten panels with battens at typically 100mm CC, 50mm SHS profile to framing and battens
- FAC06** Anodised aluminium Curtain Wall System with integrated operable windows and door systems (allow for 50/50 split between sliding and bi-fold functionality) with aluminium clip-on custom profiled extrusions
- FAC07** Anodised aluminium Curtain Wall System with integrated operable windows and door systems (allow for 50/50 split between sliding and bi-fold functionality) with aluminium clip-on custom profiled extrusions to facade
- FAC08** Full height aluminium clip-on custom profiled extrusions
- FAC09** Brick Type 1 colour (earthy rust). Bowled pressed or similar. Final selection as per materials board
- FAC10** Rendered Masonry with integrated anodised aluminium window systems
- FAC11** Balustrade. Frameless glazing with powder coated 8mm plate aluminium portal framing. Glazing is not captured all round
- FAC12** Profiled anodised aluminium vertical batten using "clip-on" fixing as noted in elevation (to stairs)
- FAC13** Fixed horizontal glass louvers
- BS01** Stainless steel Boltard
- BS01** Balustrade Type 01
- BYR1** Stainless steel Bicycle Rail
- DG1** Decomposed Granite Gravel
- DG2** Decorative Gravel
- HR2** Stainless steel handrail
- LPI** Lighting strip
- P1** Paving Type 1
- P2** City of Sydney Precast Paving
- P3** Paving Type 3
- P4** Precast Concrete Paving with Granite stone inlay
- P5** Paving Type 4
- P6** Paving Type 5
- P7** Precast aggregate Concrete path
- P8** Precast paving to traffic areas
- P9** Paving Type 6
- PIT** Proposed Service Pits
- RW1** Brick base with a Timber capping Retaining wall
- RW2** Brick base with a Precast concrete capping Retaining wall
- RW3** In situ concrete Retaining wall
- RW4** Heritage Interpretation wall
- ST1** Corbin Steel Edging
- TD1** Timber Bench Seats
- TD2** Timber Composite vertical batten screen
- TD3** Timber Decking
- CCV** CCTV Camera

REV.	DATE	DESCRIPTION	BY
04	01/12/2016	ISSUED FOR S96 APPROVAL	FJMT
03	21/06/2016	REVISED SSDA	FJMT
02	03/07/2015	REFER REVISION CLOUDS	FJMT
01	24/10/2014	ISSUED FOR SSDA APPROVAL	FJMT

CLIENT
FRASERS PROPERTY
 Suite 11, Lumiere Commercial,
 Level 12, 101 Bathurst Street,
 Sydney, NSW, 2000, Australia

ARCHITECT
fjmt
 francis-jones morehen thorp
 SYDNEY
 Level 5, 70 King Street
 Sydney NSW 2000 Australia
 T +61 2 9251 7077
 F +61 2 9251 7072
 E fjmt@fjmt.com.au
 W www.fjmt.com.au

PROJECT
Central Park Block 11
 O'Connor Street, Chippendale
 Sydney
 Frasers Broadway

TITLE
PLANS
 Roof

SCALE	1:250 @ A1	DRAWN	FJMT	PROJECT CODE
DATE	24/10/2014	APPROVED	SB	FB11
SHEET NO.	SSDA-11-211		REVISION	04

WHEN PRINTED AT 50% ON A3 THE SCALE IS 1:500
Issued for Approval

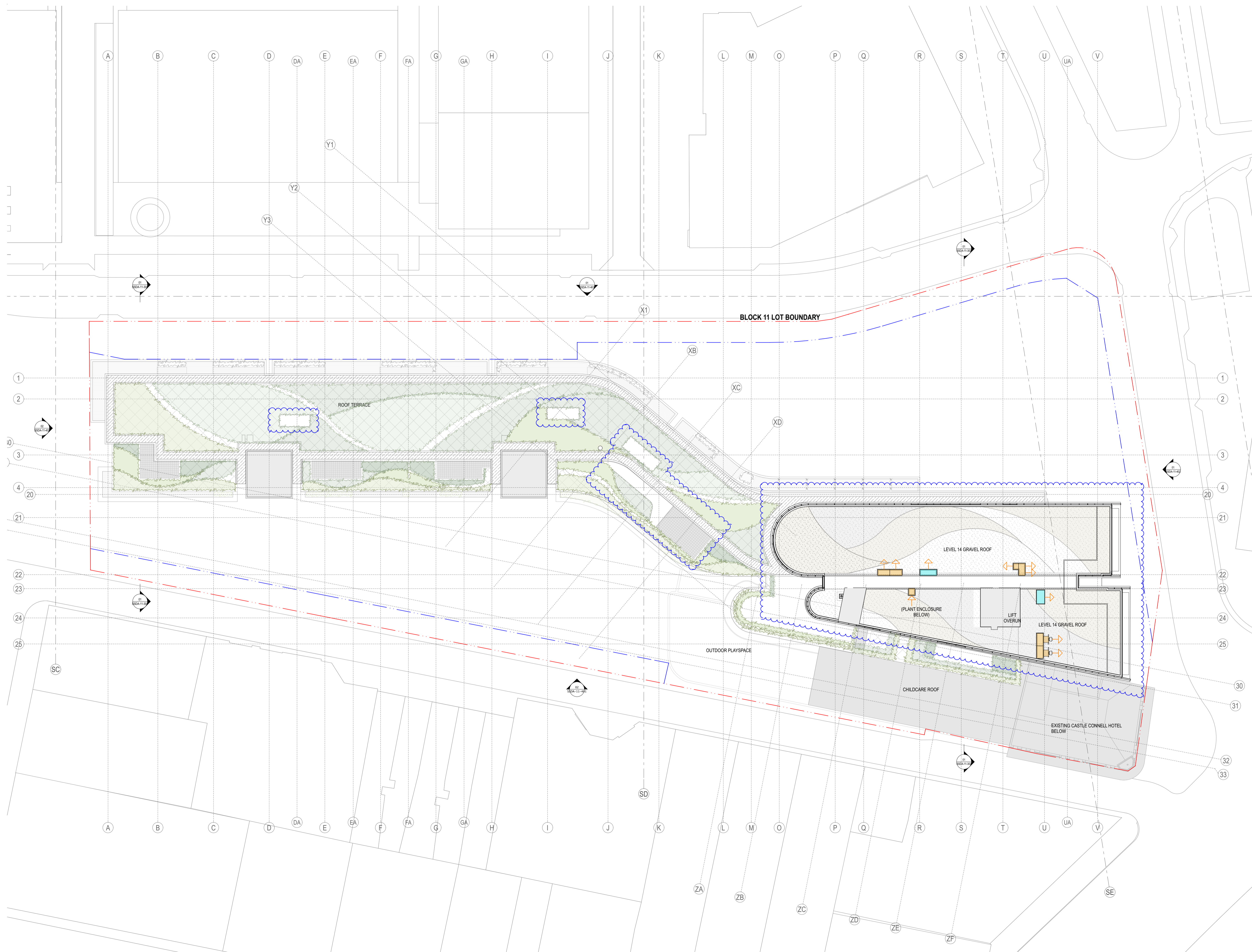

01 PLAN Roof
 1:250