

PAD 5

OPEN DRAIN

BREAK LINE - REFER TO DRG. 41 (SHEET 1) FOR CONTINUATION

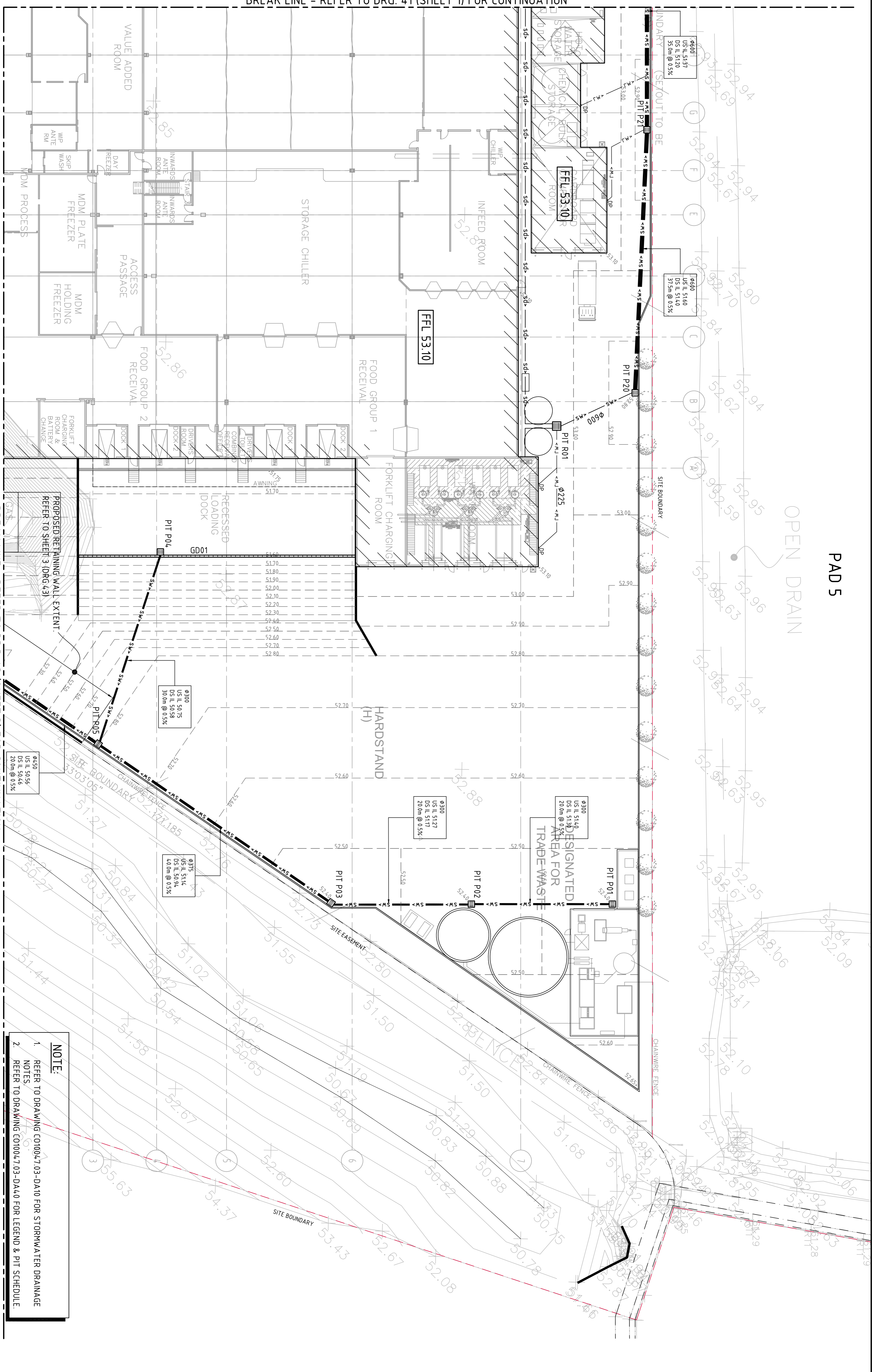

BREAK LINE - REFER TO DRG. 43 (SHEET 3) FOR CONTINUATION

STORMWATER DRAINAGE PLAN - SHEET 2  
SCALE 1:250

**FOR DEVELOPMENT APPLICATION**

ISSUED FOR DEVELOPMENT APPLICATION	30/07/13	C	CLIENT		
ISSUED FOR CLIENT REVIEW	22/07/13	B	PROJECT	<b>FOOD PROCESSING &amp; PACKAGING FACILITY</b> PART LOT 2304, TEMPLAR ROAD ERSKING PARK, NSW	
ISSUED FOR CLIENT REVIEW	17/07/13	A	DESIGNED (DRAWN)	DATE	CHECKED
AMENDMENTS	DATE	ISSUE	NW	XC	06/2013
			SCALE	AT	AS SHOWN
			CAD REF.	C01004.7.03-DA42	
			CONSULTANT		
			CONSULTING ENGINEERS	Level 1, 8 Miranda Street Tel: (02) 952 2900 Fax: (02) 924 3781 email: mail@costinroe.com.au	
			DRAWING TITLE	STORMWATER DRAINAGE PLAN	
			SHEET	SHEET 2	
			DRAWING NO.	C01004.7.03-DA42	
			ISSUE	C	

**NOTE:**

- REFER TO DRAWING C01004.7.03-DA10 FOR STORMWATER DRAINAGE NOTES.
- REFER TO DRAWING C01004.7.03-DA40 FOR LEGEND & PIT SCHEDULE.



**CostinRoe Consulting**  
Value in Engineering and Management