

BREAK LINE - REFER TO DRG. 42 (SHEET 2) FOR CONTINUATION

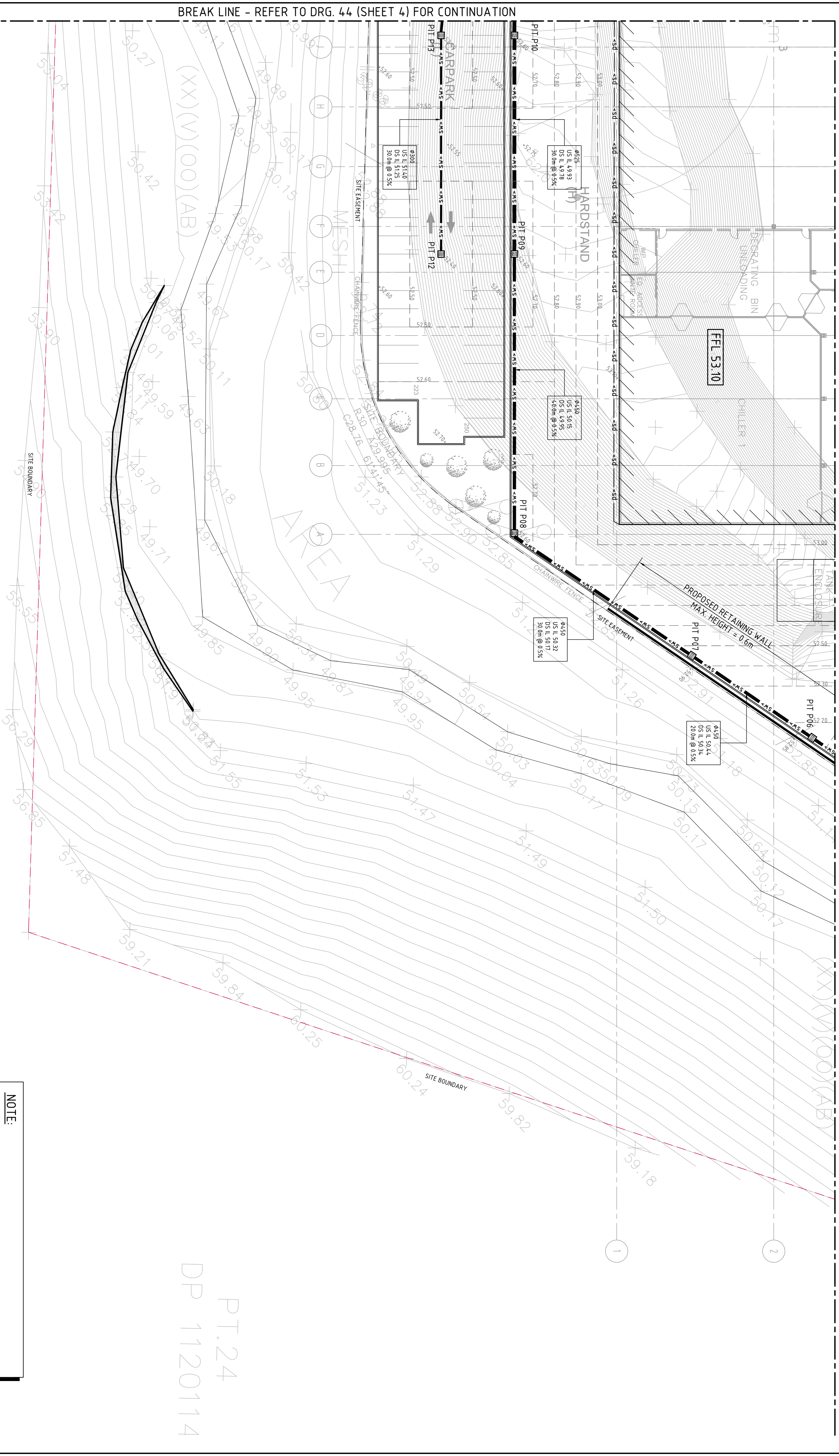

BREAK LINE - REFER TO DRG. 44 (SHEET 4) FOR CONTINUATION

STORMWATER DRAINAGE PLAN - SHEET 3  
SCALE 1:250

**NOTE:**  
1. REFER TO DRAWING C01004.7.03-DA10 FOR STORMWATER DRAINAGE NOTES.  
2. REFER TO DRAWING C01004.7.03-DA4.0 FOR LEGEND & PIT SCHEDULE.

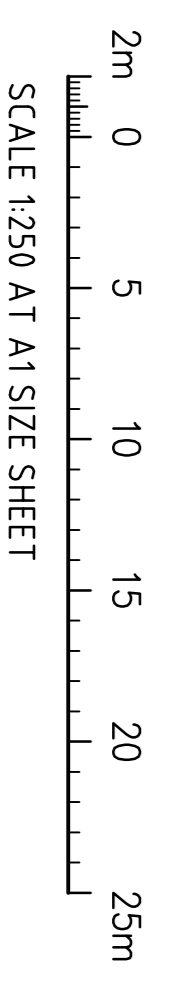

PT.24  
DP 1120114

ISSUED FOR DEVELOPMENT APPLICATION	30.07.13	C	CLIENT	<p><b>CIP</b> Building Success</p>	<p><b>PROJECT</b> FOOD PROCESSING &amp; PACKAGING FACILITY PART LOT 2304, TEMPLAR ROAD ERSKING PARK, NSW</p>	<p>CONDUCT AUSTRALIA</p>	<p>Costin Roe Consulting Pty Ltd. Consulting Engineers Level 1, 8 Hindmarsh Street Melbourne, VIC 3000 Tel: (03) 9593 2900 Fax: (03) 9241-3781 email: mail@costinroe.com.au</p>	<p><b>DRAWING TITLE</b> STORMWATER DRAINAGE PLAN SHEET 3</p>					
ISSUED FOR CLIENT REVIEW	22.07.13	B	AMENDMENTS						DESIGNED (DRAWN)	DATE	CHECKED	SCALE	CAD REF.
ISSUED FOR CLIENT REVIEW	17.07.13	A	AMENDMENTS						NW	XC	AT	AS SHOWN	C01004.7.03-DA4.3
AMENDMENTS	DATE	ISSUE	AMENDMENTS	DATE	ISSUE	AMENDMENTS	DATE	ISSUE	AMENDMENTS				

**FOR DEVELOPMENT APPLICATION**

**CostinRoe Consulting**

Value in Engineering and Management

DRAWING No. C01004.7.03-DA4.3