

## DRAWING LIST

NUMBER	TITLE	SCALE	ISSUE
<b>SITE</b>			
L001	DRAWING LIST + DRAWING LAYOUT	-	DEVELOPMENT APPLICATION
<b>DEMOLITION AND SITE PREPARATION</b>			
L101	TREE REMOVAL PLAN	1:500	DEVELOPMENT APPLICATION
<b>GENERAL ARRANGEMENT</b>			
L201	SCOPE OF WORKS PLAN	1:500	DEVELOPMENT APPLICATION
L202	DICKSON'S LANE PLAN	1:200	DEVELOPMENT APPLICATION
<b>DESIGN PRINCIPLES</b>			
L210	PAVING PLAN	1:500	DEVELOPMENT APPLICATION
L211	PLANTING PLAN	1:500	DEVELOPMENT APPLICATION
L212	URBAN ELEMENTS PLAN	1:500	DEVELOPMENT APPLICATION
<b>SECTIONAL ELEVATIONS</b>			
L301	SECTIONAL ELEVATIONS	1:100	DEVELOPMENT APPLICATION

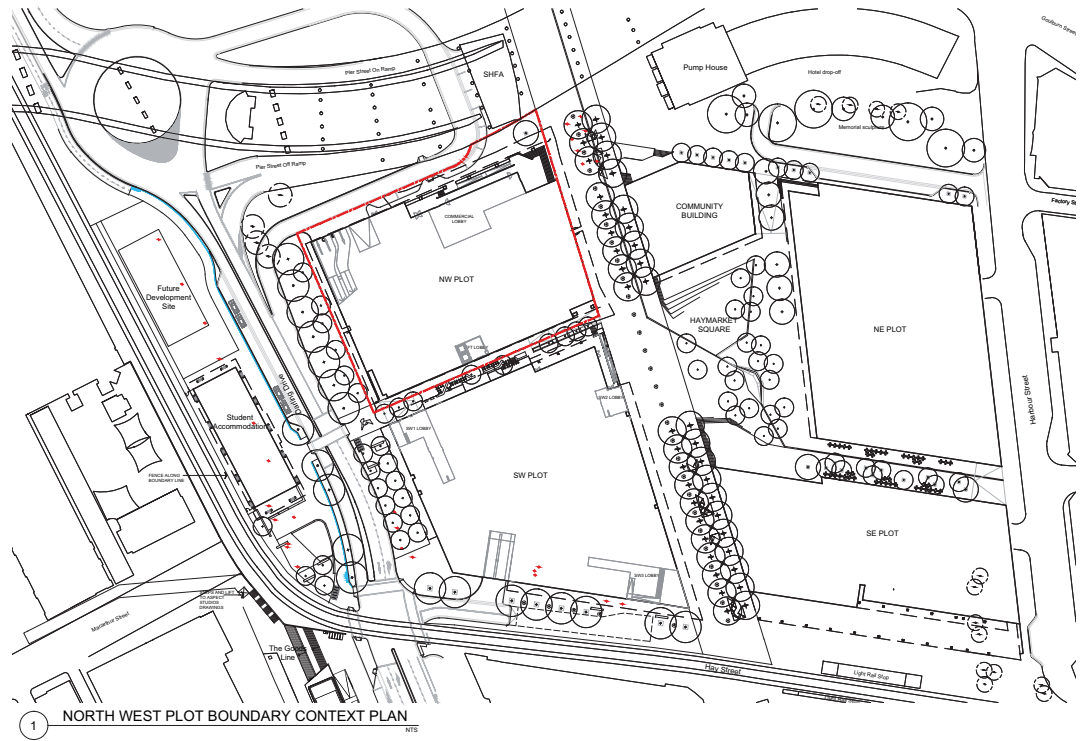

## DARLING HARBOUR LIVE

<p>REFERENCE MAP</p>	<p><b>NOTES</b></p> <ol style="list-style-type: none"> <li>DO NOT SCALE DRAWINGS. WRITTEN DIMENSIONS GOVERN.</li> <li>ALL DIMENSIONS ARE IN MILLIMETRES UNLESS NOTED OTHERWISE.</li> <li>ALL DIMENSIONS SHALL BE VERIFIED ON SITE BEFORE PROCEEDING WITH THE WORK. HASSELL SHALL BE NOTIFIED IN WRITING OF ANY DISCREPANCIES.</li> <li>THESE PLANS ARE TO BE READ IN CONJUNCTION WITH ARCHITECTURAL AND ENGINEERING DRAWINGS.</li> <li>ALL LEVELS ARE INDICATIVE ONLY BASED ON COMPOSITE SURVEY DATA PROVIDED BY LEND LEASE AND NOT TO BE RELIED UPON FOR COSTING OR CONSTRUCTION PURPOSES.</li> </ol> <p>© COPYRIGHT OF THIS DRAWING IS VESTED IN HASSELL, LTD. 2013 HASSELL, LTD.</p> <p>THIS DRAWING IS AN UNCONTROLLED COPY, UNLESS NOTED OTHERWISE.</p>	<table border="1" style="width: 100%; border-collapse: collapse;"> <thead> <tr> <th>REV</th> <th>DESCRIPTION</th> <th>DATE</th> </tr> </thead> <tbody> <tr> <td>C</td> <td>Issue for Development Application</td> <td>10.05.13</td> </tr> <tr> <td>B</td> <td>Issue for Development Application</td> <td>25.04.13</td> </tr> <tr> <td>A</td> <td>Draft Issue For Review</td> <td>19.04.13</td> </tr> </tbody> </table>	REV	DESCRIPTION	DATE	C	Issue for Development Application	10.05.13	B	Issue for Development Application	25.04.13	A	Draft Issue For Review	19.04.13	<p><b>CLIENT</b></p> <p><b>Lend Lease</b> LEND LEASE DEVELOPMENT PTY LTD LEVEL 4, THE BOND, 30 HICKSON RD MILLERS POINT, NSW 2000</p> <p><b>CONSULTANTS</b></p> <p><b>Hyder</b> CIVIL / TRAFFIC SERVICES 5141 WALKER ST, NORTH SYDNEY NSW 2060</p> <p><b>ARCHITECTURAL SERVICES</b> <b>DENTON CORKER MARSHALL</b> 49 EXHIBITION ST, MELBOURNE VIC 3000</p>	<p><b>LANDSCAPE ARCHITECT - PRINCIPAL DESIGN CONSULTANT</b></p> <p><b>HASSELL</b> HASSELL LIMITED ACN 007 711 435 LEVEL 2 PIER 8/9 23 HICKSON ROAD SYDNEY NSW 2000 AUSTRALIA SYDNEY@HASSELLSTUDIO.COM T 61 2 9101 2000</p> <p><b>HASSELL</b></p> <p><b>PROJECT</b></p> <p><b>SICEEP</b> <b>DARLING HARBOUR</b> <b>HAYMARKET-NORTH WEST PLOT</b></p>	<p><b>DRAWING TITLE</b></p> <p><b>DRAWING LIST AND DRAWING LAYOUT</b></p> <p><b>STATUS</b></p> <p><b>DEVELOPMENT APPLICATION</b></p> <table border="1" style="width: 100%; border-collapse: collapse;"> <thead> <tr> <th>SCALE @ A1</th> <th>DRAWN</th> <th>CO-ORD</th> <th>REVIEWED</th> <th>APPROVED</th> </tr> </thead> <tbody> <tr> <td>NTS</td> <td>JC</td> <td>VS</td> <td>VS</td> <td>AB</td> </tr> </tbody> </table> <table border="1" style="width: 100%; border-collapse: collapse;"> <thead> <tr> <th>PROJECT NUMBER</th> <th>DRAWING NUMBER</th> <th>REV</th> </tr> </thead> <tbody> <tr> <td>005198</td> <td>L001</td> <td>C</td> </tr> </tbody> </table>	SCALE @ A1	DRAWN	CO-ORD	REVIEWED	APPROVED	NTS	JC	VS	VS	AB	PROJECT NUMBER	DRAWING NUMBER	REV	005198	L001	C
REV	DESCRIPTION	DATE																															
C	Issue for Development Application	10.05.13																															
B	Issue for Development Application	25.04.13																															
A	Draft Issue For Review	19.04.13																															
SCALE @ A1	DRAWN	CO-ORD	REVIEWED	APPROVED																													
NTS	JC	VS	VS	AB																													
PROJECT NUMBER	DRAWING NUMBER	REV																															
005198	L001	C																															

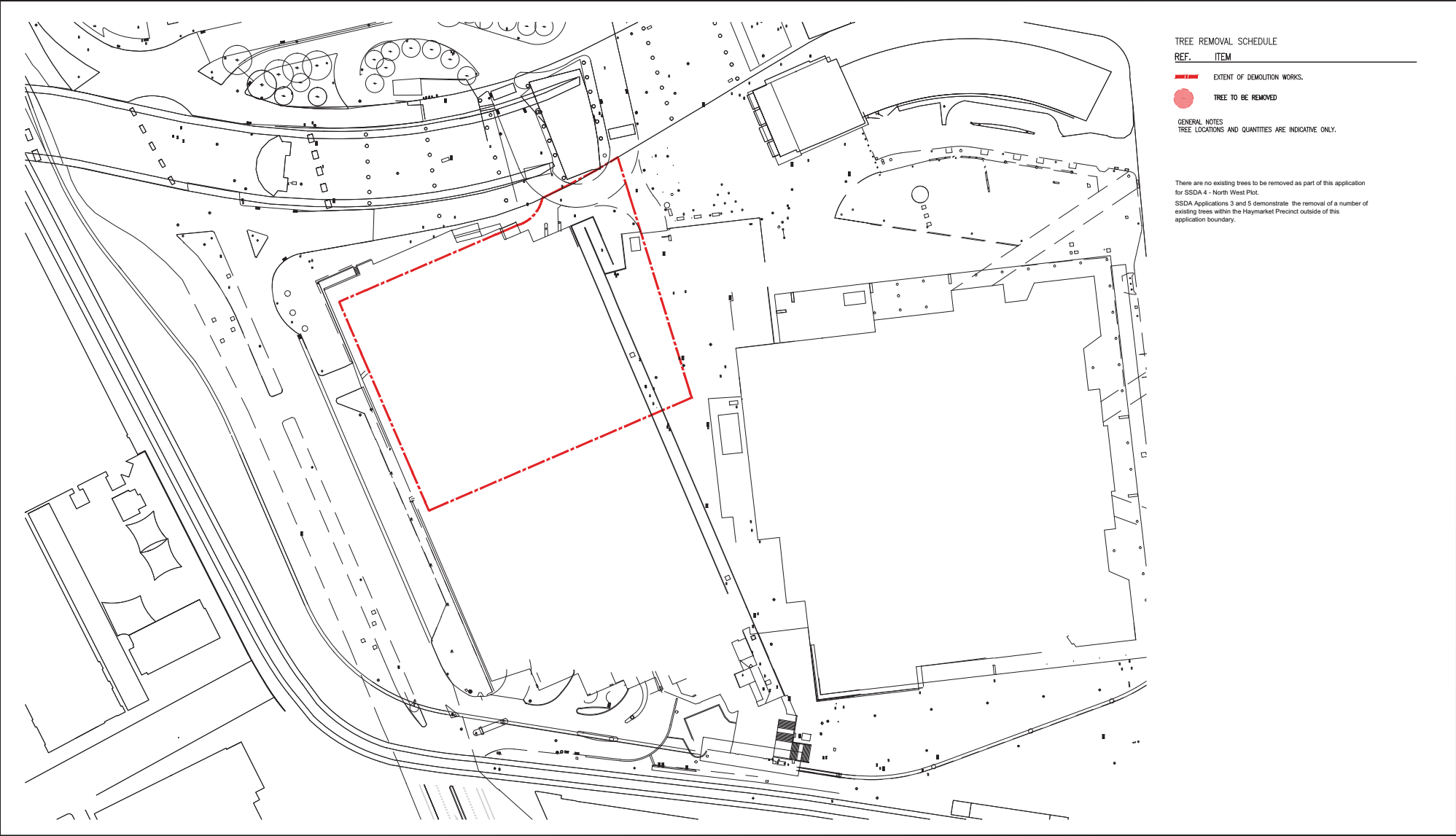

**TREE REMOVAL SCHEDULE**

REF.	ITEM
------	------

- - - EXTENT OF DEMOLITION WORKS.
- TREE TO BE REMOVED

GENERAL NOTES  
TREE LOCATIONS AND QUANTITIES ARE INDICATIVE ONLY.

There are no existing trees to be removed as part of this application for SSDA 4 - North West Plot.  
SSDA Applications 3 and 5 demonstrate the removal of a number of existing trees within the Haymarket Precinct outside of this application boundary.

**DARLING HARBOUR LIVE**

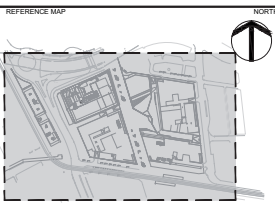

**NOTES**

- DO NOT SCALE DRAWINGS. WRITTEN DIMENSIONS GOVERN.
- ALL DIMENSIONS ARE IN MILLIMETRES UNLESS NOTED OTHERWISE.
- ALL DIMENSIONS SHALL BE VERIFIED ON SITE BEFORE PROCEEDING WITH THE WORK. HASSELL SHALL BE NOTIFIED IN WRITING OF ANY DISCREPANCIES.
- THESE PLANS ARE TO BE READ IN CONJUNCTION WITH ARCHITECTURAL AND ENGINEERING DRAWINGS.
- ALL LEVELS ARE INDICATIVE ONLY BASED ON COMPOSITE SURVEY DATA PROVIDED BY LEND LEASE AND NOT TO BE RELIED UPON FOR COSTING OR CONSTRUCTION PURPOSES.

© COPYRIGHT OF THIS DRAWING IS VESTED IN HASSELL, LTD. 2013 HASSELL, LTD.

THIS DRAWING IS AN UNCONTROLLED COPY UNLESS NOTED OTHERWISE.

REV	DESCRIPTION	DATE
C	Issue for Development Application	10.05.13
B	Issue for Development Application	25.04.13
A	Draft Issue For Review	19.04.13

**CLIENT**

**Lend Lease**  
LEND LEASE DEVELOPMENT PTY LTD  
LEVEL 4, THE BOND, 30 HICKSON RD  
MILLERS POINT, NSW 2000

**CONSULTANTS**

**Hyder**  
CIVIL / TRAFFIC SERVICES  
5/41 WALKER ST, NORTH SYDNEY  
NSW 2060

**DENTON CORKER MARSHALL**  
ARCHITECTURAL SERVICES  
49 EXHIBITION ST, MELBOURNE  
VIC 3000

**LANDSCAPE ARCHITECT - PRINCIPAL DESIGN CONSULTANT**

HASSELL LIMITED ACN 007 711 435  
LEVEL 2 PIER 8/9 23 HICKSON ROAD  
SYDNEY NSW 2000 AUSTRALIA  
SYDNEY@HASSELLSTUDIO.COM  
T 61 2 9101 2000

**HASSELL**

**PROJECT**

SICEEP  
DARLING HARBOUR  
HAYMARKET-NORTH WEST PLOT

**DRAWING TITLE**

TREE REMOVAL PLAN

**STATUS**

DEVELOPMENT APPLICATION

SCALE @ A1	DRAWN	CO-ORD	REVIEWED	APPROVED
1:500	JC	VS	VS	AB

PROJECT NUMBER	DRAWING NUMBER	REV
005198	L101	C



**DARLING HARBOUR LIVE**

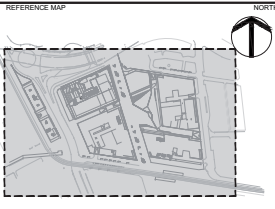

**NOTES**

- DO NOT SCALE DRAWINGS. WRITTEN DIMENSIONS GOVERN.
- ALL DIMENSIONS ARE IN MILLIMETRES UNLESS NOTED OTHERWISE.
- ALL DIMENSIONS SHALL BE VERIFIED ON SITE BEFORE PROCEEDING WITH THE WORK. HASSELL SHALL BE NOTIFIED IN WRITING OF ANY DISCREPANCIES.
- THESE PLANS ARE TO BE READ IN CONJUNCTION WITH ARCHITECTURAL AND ENGINEERING DRAWINGS.
- ALL LEVELS ARE INDICATIVE ONLY BASED ON COMPOSITE SURVEY DATA PROVIDED BY LEND LEASE AND NOT TO BE RELIED UPON FOR COSTING OR CONSTRUCTION PURPOSES.

© COPYRIGHT OF THIS DRAWING IS VESTED IN HASSELL, LTD.  
2013 HASSELL, LTD.

THIS DRAWING IS AN UNCONTROLLED COPY UNLESS NOTED OTHERWISE.

REV	DESCRIPTION	DATE
C	Issue for Development Application	10.05.13
B	Issue for Development Application	26.04.13
A	Draft Issue For Review	19.04.13

**CLIENT**

**Lend Lease**  
LEND LEASE DEVELOPMENT PTY LTD  
LEVEL 4, THE BOND, 30 HICKSON RD  
MILLERS POINT, NSW 2000

**CONSULTANTS**

**Hyder**  
CIVIL / TRAFFIC SERVICES  
5141 WALKER ST, NORTH SYDNEY  
NSW 2060

**DENTON CORKE MARSHALL**  
ARCHITECTURAL SERVICES  
49 EXHIBITION ST, MELBOURNE  
VIC 3000

**LANDSCAPE ARCHITECT - PRINCIPAL DESIGN CONSULTANT**

HASSELL LIMITED ACN 007 711 435  
LEVEL 2 PIER 89 20 HICKSON ROAD  
SYDNEY NSW 2000 AUSTRALIA  
SYDNEY@HASSELLSTUDIO.COM  
T 61 2 9101 2000

**HASSELL**

**PROJECT**

SICEEP  
DARLING HARBOUR  
HAYMARKET-NORTH WEST PLOT

**DRAWING TITLE**

**SCOPE OF WORKS PLAN**

**STATUS**

**DEVELOPMENT APPLICATION**

SCALE @ A1	DRAWN	CO-ORD	REVIEWED	APPROVED
1:500	JC	VS	VS	AB

PROJECT NUMBER	DRAWING NUMBER	REV
005198	L201	C



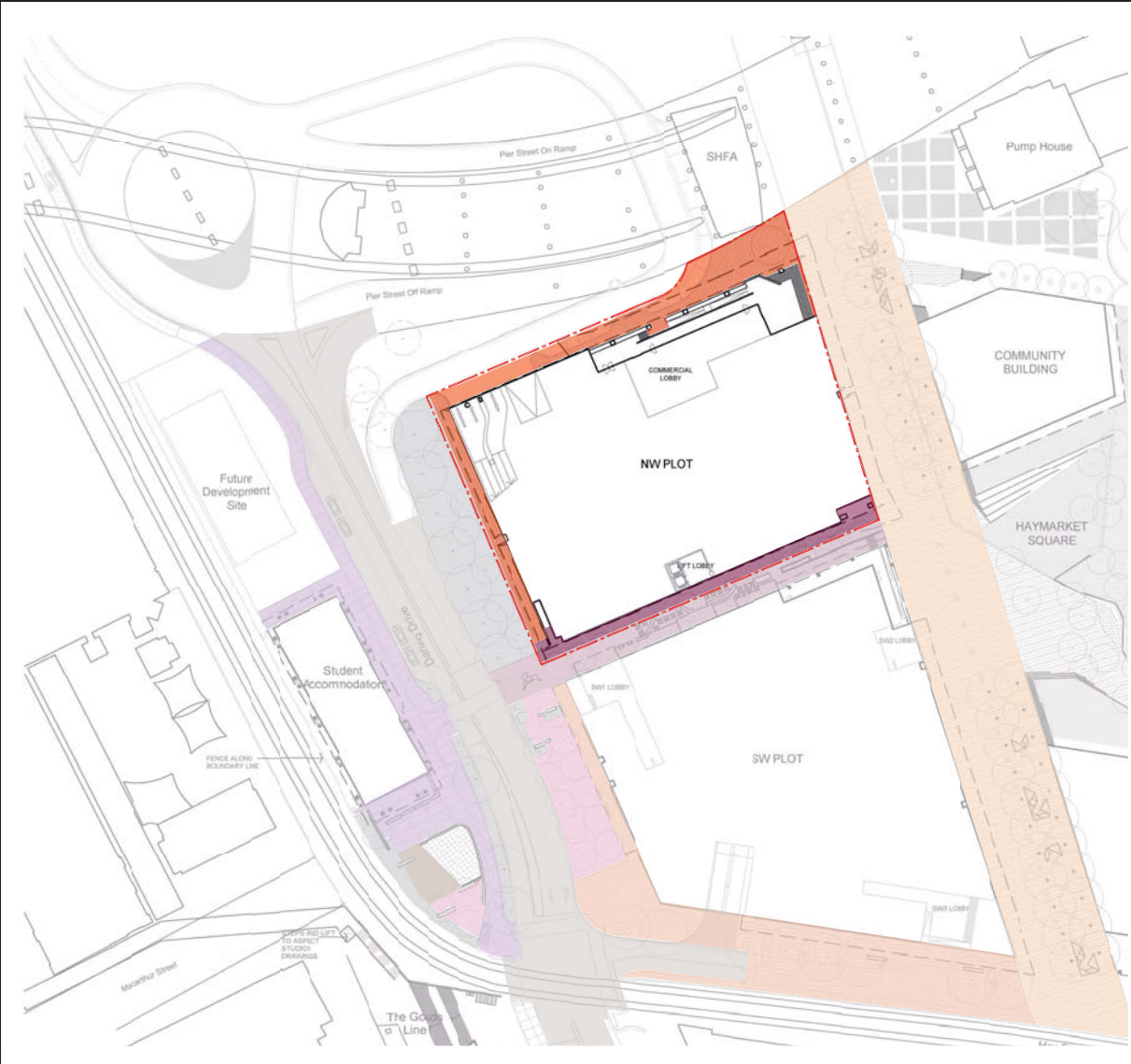

PAVING	
<b>DICKSON'S LANE</b>	
	Material: Granite Finish: Exfoliated to AS/ Hammered Colour: Austral Grey Thickness: 50mm
	Material: Granite (highlight) Finish: Exfoliated to AS Colour: Austral Verde Thickness: 50mm
	Material: In situ concrete (highlight) Finish: Class 2 finish Colour: Grey/ Exposed aggregate Thickness: To engineer's specification
<b>DARLING DRIVE</b>	
	Material: Granite Finish: Exfoliated to AS Colour: Austral Black Thickness: 50mm

**DARLING HARBOUR LIVE**

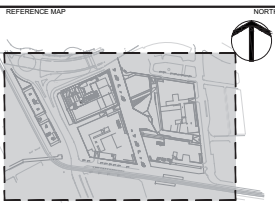

**NOTES**

- DO NOT SCALE DRAWINGS. WRITTEN DIMENSIONS GOVERN.
- ALL DIMENSIONS ARE IN MILLIMETRES UNLESS NOTED OTHERWISE.
- ALL DIMENSIONS SHALL BE VERIFIED ON SITE BEFORE PROCEEDING WITH THE WORK. HASSELL SHALL BE NOTIFIED IN WRITING OF ANY DISCREPANCIES.
- THESE PLANS ARE TO BE READ IN CONJUNCTION WITH ARCHITECTURAL AND ENGINEERING DRAWINGS.
- ALL LEVELS ARE INDICATIVE ONLY BASED ON COMPOSITE SURVEY DATA PROVIDED BY LEND LEASE AND NOT TO BE RELIED UPON FOR COSTING OR CONSTRUCTION PURPOSES.

© COPYRIGHT OF THIS DRAWING IS VESTED IN HASSELL, LTD. 2013 HASSELL, LTD.

THIS DRAWING IS AN UNCONTROLLED COPY UNLESS NOTED OTHERWISE.

0 2 4 8m

REV	DESCRIPTION	DATE
C	Issue for Development Application	10.05.13
B	Issue for Development Application	26.04.13
A	Draft Issue For Review	19.04.13

**CLIENT**

**Lend Lease**  
LEND LEASE DEVELOPMENT PTY LTD  
LEVEL 4, THE BOND, 30 HECKSON RD  
MILLERS POINT, NSW 2000

**CONSULTANTS**

**Hyder**  
CIVIL / TRAFFIC SERVICES  
5141 WALKER ST, NORTH SYDNEY  
NSW 2060

**DENTON COKER MARSHALL**  
ARCHITECTURAL SERVICES  
49 EXHIBITION ST, MELBOURNE  
VIC 3000

**LANDSCAPE ARCHITECT - PRINCIPAL DESIGN CONSULTANT**

HASSELL LIMITED ACN 007 711 435  
LEVEL 2 PIER 8/9 20 HICKSON ROAD  
SYDNEY NSW 2000 AUSTRALIA  
SYDNEY@HASSELLSTUDIO.COM  
T 61 2 9101 2000

**HASSELL**

**PROJECT**

SICEEP  
DARLING HARBOUR  
HAYMARKET-NORTH WEST PLOT

DRAWING TITLE				
<b>PAVING PLAN</b>				
STATUS				
<b>DEVELOPMENT APPLICATION</b>				
SCALE @ A1	DRAWN	COORD	REVIEWED	APPROVED
1:500	JC	VS	VS	AB
PROJECT NUMBER	DRAWING NUMBER		REV	
005198	L210		C	

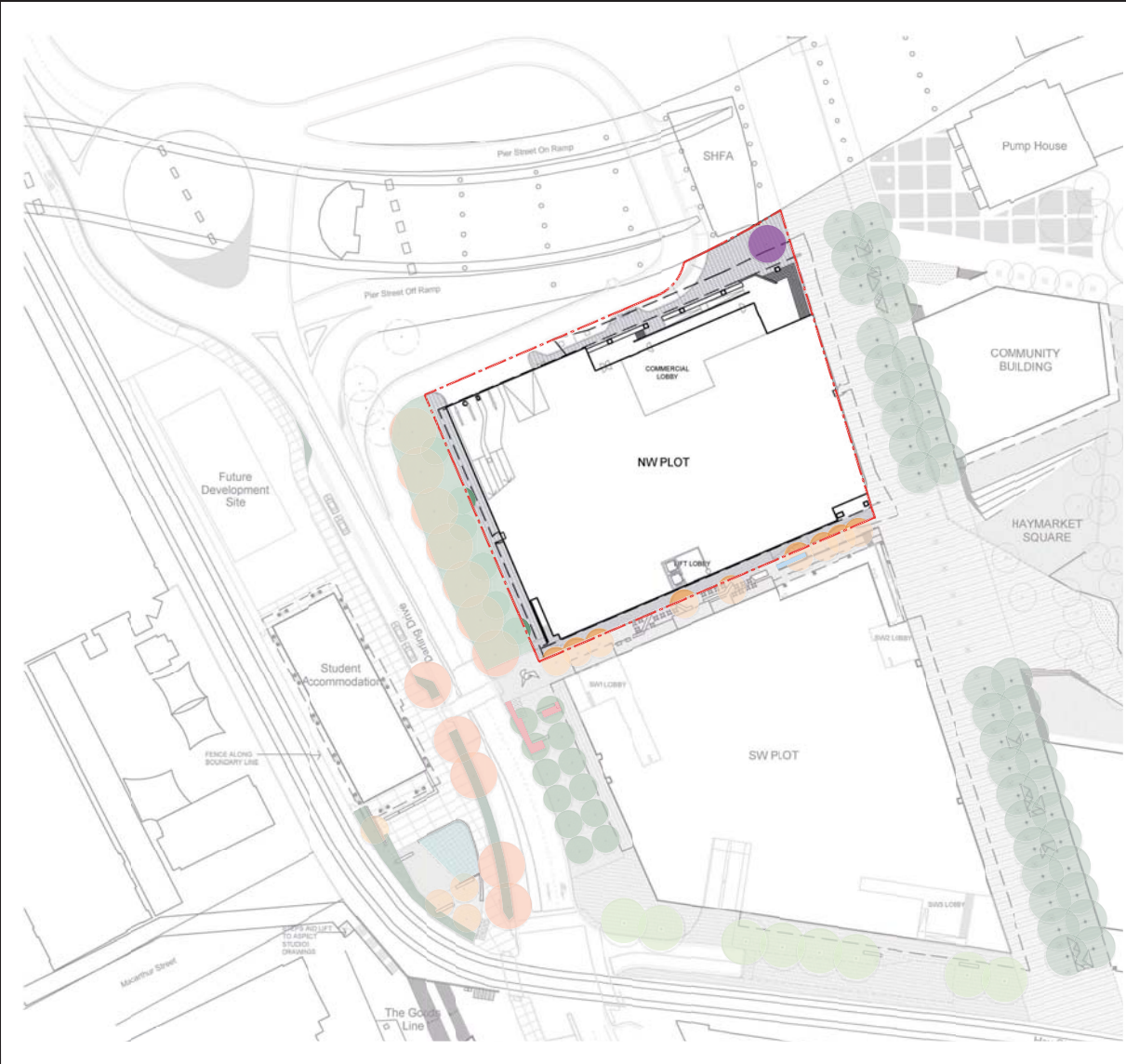

**TREES**

**BACK OF PIER STREET**



Species	Magnolia grandiflora 'Exmouth'
Common Name	Bull Bay Magnolia
Size at maturity	Height: 12-15m Width: 5m
Pot size at planting	1000 minimum

**DARLING HARBOUR LIVE**

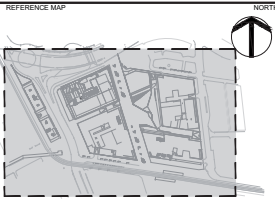

**NOTES**

- DO NOT SCALE DRAWINGS. WRITTEN DIMENSIONS GOVERN.
- ALL DIMENSIONS ARE IN MILLIMETRES UNLESS NOTED OTHERWISE.
- ALL DIMENSIONS SHALL BE VERIFIED ON SITE BEFORE PROCEEDING WITH THE WORK. HASSELL SHALL BE NOTIFIED IN WRITING OF ANY DISCREPANCIES.
- THESE PLANS ARE TO BE READ IN CONJUNCTION WITH ARCHITECTURAL AND ENGINEERING DRAWINGS.
- ALL LEVELS ARE INDICATIVE ONLY BASED ON COMPOSITE SURVEY DATA PROVIDED BY LEND LEASE AND NOT TO BE RELIED UPON FOR COSTING OR CONSTRUCTION PURPOSES.

© COPYRIGHT OF THIS DRAWING IS VESTED IN HASSELL, LTD. 2013 HASSELL, LTD.

THIS DRAWING IS AN UNCONTROLLED COPY UNLESS NOTED OTHERWISE.

0 2 4 8m

REV	DESCRIPTION	DATE
C	Issue for Development Application	10.05.13
B	Issue for Development Application	26.04.13
A	Draft Issue For Review	19.04.13

**CLIENT**

**Lend Lease**  
LEND LEASE DEVELOPMENT PTY LTD  
LEVEL 4, THE BOND, 30 HICKSON RD  
MILLERS POINT, NSW 2000

**CONSULTANTS**

**Hyder**  
CIVIL / TRAFFIC SERVICES  
5141 WALKER ST, NORTH SYDNEY  
NSW 2060

**DENTON COKER MARSHALL**  
ARCHITECTURAL SERVICES  
49 EXHIBITION ST, MELBOURNE  
VIC 3000

**LANDSCAPE ARCHITECT - PRINCIPAL DESIGN CONSULTANT**

HASSELL LIMITED ACN 007 711 435  
LEVEL 2 PIER 8/9 20 HICKSON ROAD  
SYDNEY NSW 2000 AUSTRALIA  
SYDNEY@HASSELLSTUDIO.COM  
T 61 2 9101 2000

**HASSELL**

**PROJECT**

SICEEP  
DARLING HARBOUR  
HAYMARKET-NORTH WEST PLOT

**DRAWING TITLE**

**PLANTING PLAN**

**STATUS**

**DEVELOPMENT APPLICATION**

SCALE @ A1	DRAWN	COORD	REVIEWED	APPROVED
1:500	JC	VS	VS	AB

PROJECT NUMBER	DRAWING NUMBER	REV
005198	L211	C

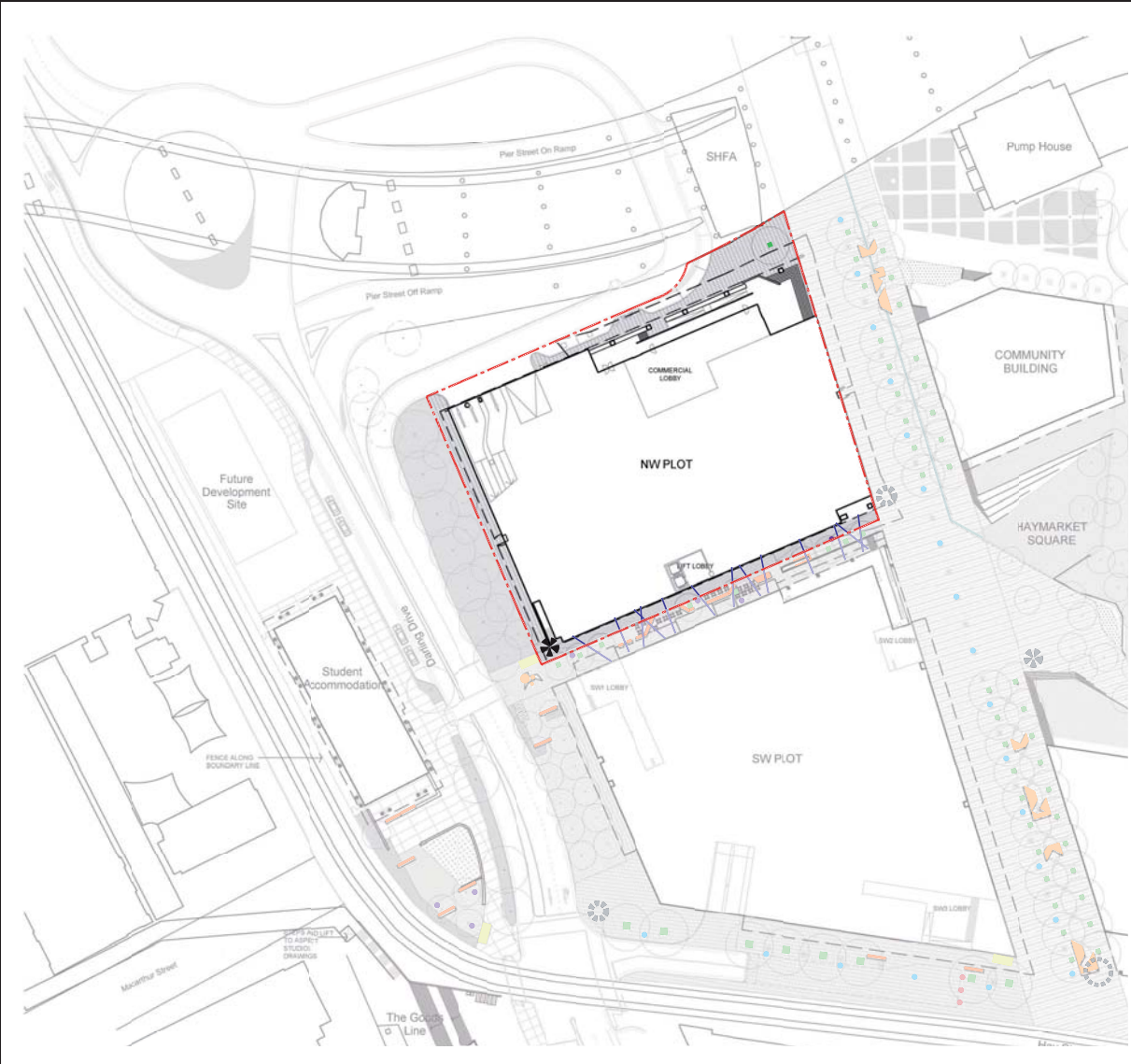

**FURNITURE**

TREE GRATE	
	Material Granite setts Location Site wide Size Refer CoS detail * Finish Refer CoS detail * Colour Austral Black

DRINKING FOUNTAIN	
	Material Stainless steel Location Site wide Size Refer CoS detail * Finish Grade 316 Colour Stainless steel Fixing Refer CoS detail *

BOLLARD (Fixed/ removable)	
	Material Stainless steel Location Site wide Size Min 100mm high Finish Grade 316 Colour Stainless steel Fixing Refer CoS detail *

\* City of Sydney, Draft Sydney Streets Design Code, 2006  
& City of Sydney, Interim Sydney Streets Design Code, November 2010.  
Indicative only. Subject to further stakeholder consultation and resolution.

**LIGHTING**

CATENARY LIGHTING	
	Material Stainless steel Location Dickson's Lane Size Varies, Type dependent Fixing Waterproof Supplier Hess

**SIGNAGE - Wayfinding and information**

TERTIARY INFORMATION SIGN	
	Material To future detail Location Site wide Size To future detail Colour To future detail Fixing To future detail

**DARLING HARBOUR LIVE**

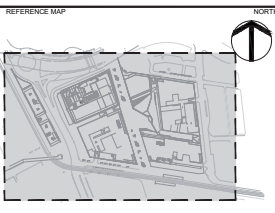

**NOTES**

- DO NOT SCALE DRAWINGS. WRITTEN DIMENSIONS GOVERN.
- ALL DIMENSIONS ARE IN MILLIMETRES UNLESS NOTED OTHERWISE.
- ALL DIMENSIONS SHALL BE VERIFIED ON SITE BEFORE PROCEEDING WITH THE WORK. HASSELL SHALL BE NOTIFIED IN WRITING OF ANY DISCREPANCIES.
- THESE PLANS ARE TO BE READ IN CONJUNCTION WITH ARCHITECTURAL AND ENGINEERING DRAWINGS.
- ALL LEVELS ARE INDICATIVE ONLY BASED ON COMPOSITE SURVEY DATA PROVIDED BY LEND LEASE AND NOT TO BE RELIED UPON FOR COSTING OR CONSTRUCTION PURPOSES.

© COPYRIGHT OF THIS DRAWING IS VESTED IN HASSELL, LTD. 2013 HASSELL, LTD.

THIS DRAWING IS AN UNCONTROLLED COPY UNLESS NOTED OTHERWISE.



REV	DESCRIPTION	DATE
C	Issue for Development Application	10.05.13
B	Issue for Development Application	26.04.13
A	Draft Issue For Review	19.04.13

**CLIENT**

**Lend Lease**  
LEND LEASE DEVELOPMENT PTY LTD  
LEVEL 4, THE BOND, 30 HECKSON RD  
MILLERS POINT, NSW 2000

**CONSULTANTS**

**Hyder**  
CIVIL / TRAFFIC SERVICES  
5141 WALKER ST, NORTH SYDNEY  
NSW 2060

**DENTON COKER MARSHALL**  
ARCHITECTURAL SERVICES  
49 EXHIBITION ST, MELBOURNE  
VIC 3000

**LANDSCAPE ARCHITECT - PRINCIPAL DESIGN CONSULTANT**

HASSELL LIMITED ACN 007 711 435  
LEVEL 2 PIER 89 20 HECKSON ROAD  
SYDNEY NSW 2000 AUSTRALIA  
SYDNEY@HASSELLSTUDIO.COM  
T 61 2 9101 2000

**HASSELL**

**PROJECT**

SICEEP  
DARLING HARBOUR  
HAYMARKET-NORTH WEST PLOT

DRAWING TITLE					
URBAN ELEMENTS PLAN					
STATUS					
DEVELOPMENT APPLICATION					
SCALE @ A1	DRAWN	CO-ORD	REVIEWED	APPROVED	
1:500	JC	VS	VS	AB	
PROJECT NUMBER	DRAWING NUMBER	REV			
005198	L212	C			

