

SICEEP SUBDIVISION SITE

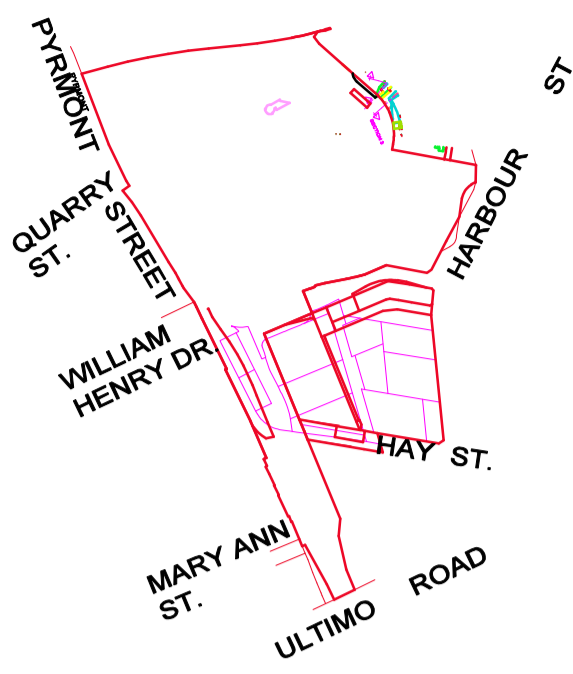

No.	EASTING	NORTHING
1	333574.67	6249832.09
2	333593.46	6249889.40
3	333598.32	6249891.48
4	333598.87	6249891.73
5	333593.80	6249905.48
6	333596.88	6249914.73
7	333599.23	6249916.06
8	333648.90	6249937.37
9	333656.77	6249953.06
10	333665.62	6249956.18
11	333678.57	6249962.09
12	333693.73	6249970.17
13	333700.60	6249948.77
14	333722.35	6249945.45
15	333750.12	6249941.21
16	333816.52	6249930.70
17	333823.38	6249991.98
18	333829.78	6249836.38
19	333835.59	6249785.88
20	333829.62	6249781.47
21	333813.52	6249783.93
22	333747.94	6249793.96
23	333751.32	6249782.78
24	333733.01	6249785.56
25	333616.09	6249800.23
26	333598.53	6249811.14
27	333590.27	6249822.53
28	333727.65	6249785.38
29	333563.17	6249874.34
30	333541.93	6249914.94
31	333558.76	6249923.75
32	333562.43	6249925.67
33	333569.72	6249928.38
34	333557.27	6249930.23
35	333554.72	6249931.58
36	333552.24	6249832.55
37	333554.69	6249831.90
38	333559.19	6249831.11
39	333567.67	6249831.01
40	333580.00	6249883.15
41	333607.11	6249831.34
42	333632.41	6249811.16
43	333625.12	6249834.88
44	333619.47	6249845.98
45	333615.60	6249853.38
46	333605.48	6249872.76
47	333603.75	6249876.75
48	333624.62	6249857.26
49	333642.47	6249815.53
50	333647.62	6249803.78
51	333731.28	6249791.18
52	333714.16	6249846.70
53	333700.69	6249890.36
54	333681.84	6249851.50
55	333689.98	6249835.48
56	333704.27	6249837.39
57	333712.59	6249894.58
58	333716.52	6249896.18
59	333725.76	6249851.88
60	333730.52	6249851.29
61	333743.41	6249794.65
62	333781.32	6249846.66
63	333754.77	6249801.98
64	333753.32	6249812.18
65	333807.12	6249839.78
66	333827.95	6249797.94
67	333834.99	6249797.13
68	333878.68	6249792.11
69	333716.96	6249787.75
70	333717.05	6249788.75
71	333727.79	6249787.37



NOTES:
 BOUNDARY SURVEY MADE. IF ANY CONSTRUCTION IS INTENDED IN THE PROXIMITY OF THE BOUNDARIES IT IS RECOMMENDED THAT A FURTHER SURVEY BE REQUESTED FOR THE MARKING OF THE RELEVANT BOUNDARIES.
 ORIGIN OF CO-ORDINATES:
 SSM 168145
 E 333 679.368
 N 6249942.260
 ORIGIN OF AZIMUTH:
 SSM 54327 TO SSM 168146
 ORIGIN OF LEVELS:
 PM 55082 RL 3.288 AHD
 THIS PLAN HAS BEEN CREATED AT A SCALE OF 1:500 AND MAY NOT BE SATISFACTORY FOR OTHER PURPOSES. THE ACCURACY OF ANY ENLARGEMENT OR OTHER REPRODUCTION MAY BE LESS THAN THAT OF THE ORIGINAL.

NO PART OF THIS PLAN MAY BE REPRODUCED, COMMUNICATED, STORED IN A RETRIEVAL SYSTEM OR TRANSMITTED IN ANY FORM WITHOUT THE WRITTEN PERMISSION OF THE COPYRIGHT OWNER EXCEPT AS PERMITTED BY THE COPYRIGHT ACT 1968. ANY PERMITTED DOWNLOADING, ELECTRONIC STORAGE, DISPLAY, PRINT, COPY, REPRODUCTION OR COMMUNICATION OF THIS SURVEY SHOULD CONTAIN NO ALTERATION OR ADDITION TO THE ORIGINAL SURVEY.
COPYRIGHT © RYGATE & COMPANY PTY. LIMITED 2013.
 LOT DETAILS OBTAINED FROM COMPUTER FILE PROVIDED 005198 HAYMARKET STAGING.DWG.
 BOUNDARIES OF HAY AND HARBOUR STREETS REDEFINED CAD FILE PROVIDED ADJUSTED ACCORDINGLY
 FINAL BOUNDARIES, DIMENSIONS AND CO-ORDINATES MAY VARY SUBJECT TO APPROVAL AND REGISTRATION PROVIDED AT TITLES OFFICE.
 LOT NUMBERING SHOWN HEREON IN ACCORDANCE WITH ABOVEMENTIONED PROVIDED CAD FILE.

REV.	DATE	AMENDMENTS
A	14/5/13	BOUNDARY LOTS 5, 4, 4a, 11 AND 1a AMENDED TO BE APPROX. 3m FROM THE ADJACENT RAIL LOTS 4 AND 5 NORTHERN AND SOUTHERN BOUNDARIES ALIGNED WITH PREVIOUS EXTENTS, COMMON BOUNDARY APPROX CENTRAL TO PROPOSED BUILDING, EASTERN BOUNDARY 19m FROM WESTERN BOUNDARY.

RYGATE SURVEYORS
 Rygate & Company Pty Limited
 P.W. Rygate & West
 ABN 61 001 204 897
 Suite 904 Level 9, 89 York St
 Sydney NSW 2000
 P +61 2 9262 8800
 F +61 2 9262 8843
 e surveyors@rygate.com.au
 w rygate.com.au
 SURVEYING SINCE 1893

SUBDIVISION | STRATA PLANS | STRATUM SUBDIVISION | LEASE PLANS | TOPOGRAPHIC SURVEYS | GPS SURVEYS | 3D MODELLING | RACECOURSE DESIGN | PROJECT MANAGEMENT | SUN SHADOW DIAGRAMS

SURVEYOR	DRAWN	CHECKED	APPROVED
-	-	-	-

DATUM :
 CONTOUR INTERVAL :
 ORIGIN OF LEVELS :

THIS TITLE BLOCK AND NOTES FORM AN INTEGRAL PART OF THE PLAN AND MUST BE REPRODUCED IN ANY USE, DUPLICATION OR AMENDMENT.

CLIENT
LEND LEASE DEVELOPMENTS

LOCALITY
DARLING HARBOUR

L.G.A.
SYDNEY

PLAN
 SHOWING PROPOSED LOT DIMENSIONS,
 PROPOSED SICEEP HAYMARKET BOUNDARY
 AND EXISTING TITLE LOCATIONS
 HAYMARKET REMEDIATION

CAD REFERENCE 75813_005198_haymarket staging_220513.dgn

REFERENCE No.	PLAN No.	DATE	SHEET No. -
75813	75813_2	6/5/2013	OF - SHEETS

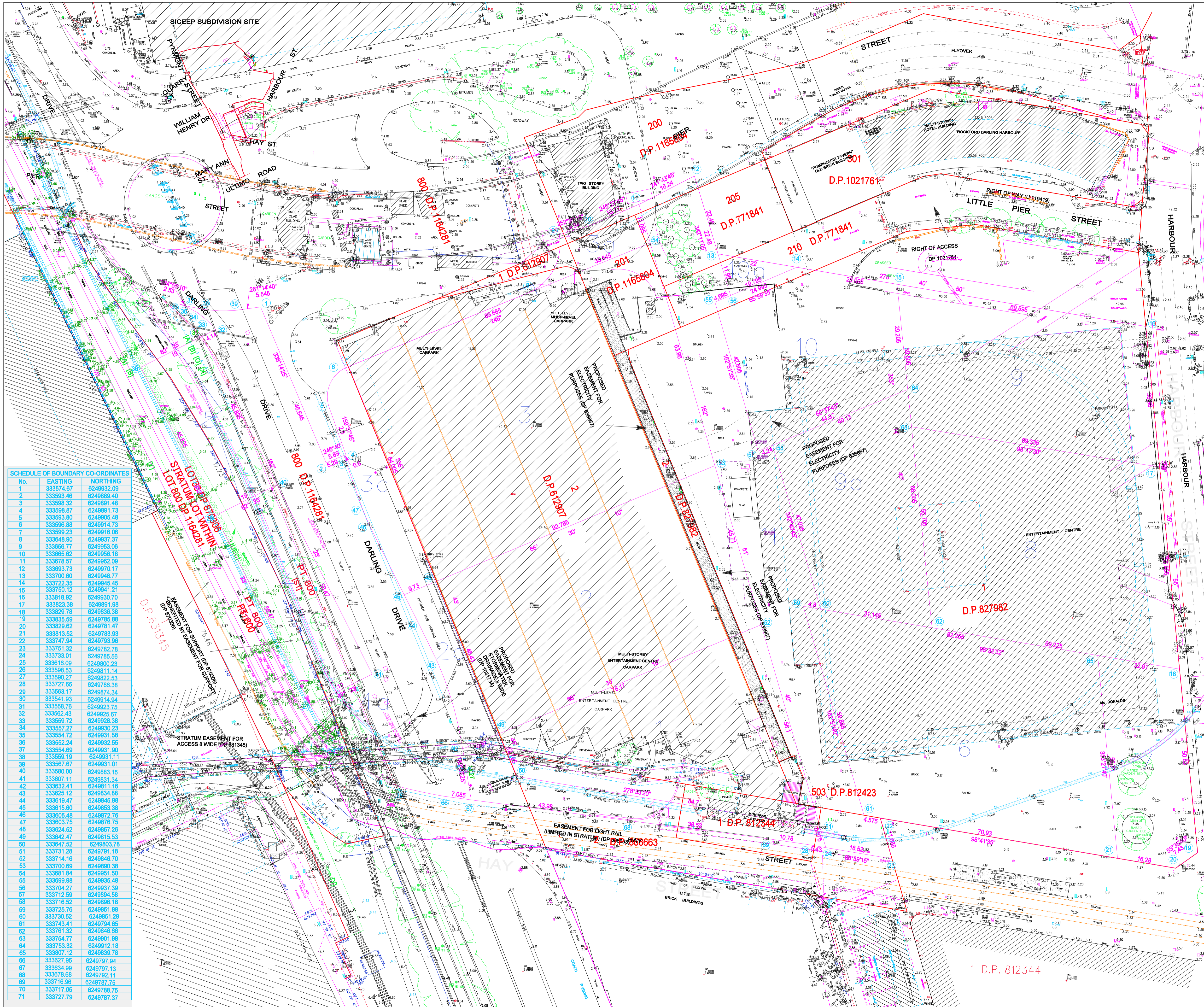

No.	EASTING	NORTHING
1	333574.67	6249832.09
2	333593.46	6249889.40
3	333598.32	6249891.48
4	333598.87	6249891.73
5	333593.80	6249905.48
6	333596.88	6249914.73
7	333599.23	6249916.06
8	333648.80	6249937.37
9	333656.77	6249953.06
10	333665.62	6249956.18
11	333678.57	6249962.09
12	333693.73	6249970.17
13	333700.60	6249948.77
14	333722.35	6249945.45
15	333750.12	6249941.21
16	333816.92	6249930.70
17	333823.38	6249991.98
18	333829.78	6249836.38
19	333835.59	6249785.88
20	333829.62	6249781.47
21	333813.52	6249783.93
22	333747.94	6249793.96
23	333751.32	6249782.78
24	333733.01	6249785.56
25	333616.09	6249800.23
26	333598.53	6249811.14
27	333590.27	6249822.53
28	333727.65	6249785.58
29	333563.17	6249874.34
30	333541.93	6249914.94
31	333558.76	6249923.75
32	333562.43	6249925.67
33	333569.72	6249928.38
34	333567.27	6249930.23
35	333564.72	6249931.58
36	333562.24	6249932.55
37	333554.69	6249931.90
38	333559.19	6249931.11
39	333567.67	6249931.01
40	333560.00	6249883.15
41	333607.11	6249831.34
42	333632.41	6249811.16
43	333625.12	6249834.08
44	333619.47	6249845.90
45	333615.60	6249853.39
46	333605.48	6249872.76
47	333603.75	6249876.75
48	333624.62	6249857.26
49	333642.47	6249815.53
50	333647.52	6249803.78
51	333731.28	6249791.18
52	333714.16	6249846.70
53	333700.69	6249890.39
54	333681.84	6249851.50
55	333689.98	6249835.48
56	333704.27	6249837.39
57	333712.59	6249894.58
58	333716.52	6249896.18
59	333725.76	6249851.88
60	333730.52	6249851.29
61	333743.41	6249794.65
62	333781.32	6249846.66
63	333754.77	6249801.98
64	333753.32	6249812.18
65	333807.12	6249839.78
66	333827.95	6249797.94
67	333834.99	6249797.13
68	333878.68	6249792.11
69	333716.96	6249787.75
70	333717.05	6249788.75
71	333727.79	6249787.37

NOTES:

LIMITED BOUNDARY SURVEY MADE. IF ANY CONSTRUCTION IS INTENDED IN THE PROXIMITY OF THE BOUNDARIES IT IS RECOMMENDED THAT A FURTHER SURVEY BE REQUESTED FOR THE MARKING OF THE RELEVANT BOUNDARIES.

ORIGIN OF CO-ORDINATES:
SSM 168145
E 333 679.368
N 6249942.260

ORIGIN OF AZIMUTH:
SSM 54327 TO SSM 168146

ORIGIN OF LEVELS:
PM 55082 RL 3.288 AHD

THIS PLAN HAS BEEN CREATED AT A SCALE OF 1:500 AND MAY NOT BE SATISFACTORY FOR OTHER PURPOSES. THE ACCURACY OF ANY ENLARGEMENT OR OTHER REPRODUCTION MAY BE LESS THAN THAT OF THE ORIGINAL.

NO PART OF THIS PLAN MAY BE REPRODUCED, COMMUNICATED, STORED IN A RETRIEVAL SYSTEM OR TRANSMITTED IN ANY FORM WITHOUT THE WRITTEN PERMISSION OF THE COPYRIGHT OWNER EXCEPT AS PERMITTED BY THE COPYRIGHT ACT. ANY UNPERMITTED DOWNLOADING, ELECTRONIC STORAGE, DISPLAY, PRINT, COPY, REPRODUCTION OR COMMUNICATION OF THIS SURVEY SHOULD CONTAIN NO ALTERATION OR ADDITION TO THE ORIGINAL SURVEY.

COPYRIGHT © RYGATE & COMPANY PTY. LIMITED 2013.

LOT DETAILS OBTAINED FROM COMPUTER FILE PROVIDED 005198 HAYMARKET STAGING.DWG.

BOUNDARIES OF HAY AND HARBOUR STREETS REDEFINED CAD FILE PROVIDED ADJUSTED ACCORDINGLY

FINAL BOUNDARIES, DIMENSIONS AND CO-ORDINATES MAY VARY SUBJECT TO APPROVAL AND REGISTRATION PROVIDED AT TITLES OFFICE.

LOT NUMBERING SHOWN HEREON IN ACCORDANCE WITH ABOVEMENTIONED PROVIDED CAD FILE.

THE DETAIL AND LEVELS INFORMATION SHOWN IN THIS PLAN HAS BEEN CREATED BY COMBINING VARIOUS DETAIL AND LEVEL SURVEYS CARRIED OUT SINCE 2001 REQUESTED FOR VARYING PURPOSES TO PREPARE A FILE FOR PLOTTING AT A SCALE OF 1:200. AND MAY NOT BE SATISFACTORY FOR OTHER PURPOSES. THE ACCURACY OF ANY ENLARGEMENT OR OTHER REPRODUCTION MAY BE LESS THAN THAT OF THE ORIGINAL.

IF ANY CONSTRUCTION OR DESIGN WORKS ARE PROPOSED WITHIN THE CLOSE VICINITY OF THE BOUNDARIES A SURVEY DEFINING THE BOUNDARIES MUST BE CARRIED OUT

REV.	DATE	AMENDMENTS
A	14/5/13	BOUNDARY LOTS 5, 4, 4a, 11 AND 1A AMENDED TO BE APPROX. 3m FROM THE ADJACENT RAIL LOTS 4 AND 5 NORTHERN AND SOUTHERN BOUNDARIES ALIGNED WITH PREVIOUS EXTENTS, COMMON BOUNDARY APPROX CENTRAL TO PROPOSED BUILDING, EASTERN BOUNDARY 19m FROM WESTERN BOUNDARY.

RYGATE SURVEYORS
SURVEYING SINCE 1893

Rygate & Company Pty Limited
P.W. Rygate & West
ABN 61 001 204 897

Suite 904 Level 9, 89 York St
Sydney NSW 2000
P +61 2 9262 6800
F +61 2 9262 6843
surveys@rygate.com.au
rygate.com.au

SUBDIVISION | STRATA PLANS | STRATUM SUBDIVISION | LEASE PLANS | TOPOGRAPHIC SURVEYS | GPS SURVEYS | 3D MODELLING | RACECOURSE DESIGN | PROJECT MANAGEMENT | SUN SHADOW DIAGRAMS

SURVEYOR	DRAWN	CHECKED	APPROVED

DATUM :
CONTOUR INTERVAL :
ORIGIN OF LEVELS :

THIS TITLE BLOCK AND NOTES FORM AN INTEGRAL PART OF THE PLAN AND MUST BE REPRODUCED IN ANY USE, DUPLICATION OR AMENDMENT.

CLIENT

LEND LEASE DEVELOPMENTS

LOCALITY **DARLING HARBOUR**

L.G.A. **SYDNEY**

PLAN

SHOWING PROPOSED LOT DIMENSIONS,
PROPOSED SICEEP HAYMARKET BOUNDARY
AND EXISTING TITLE LOCATIONS
HAYMARKET REMEDIATION

CAD REFERENCE 75813_005198_hoymarket staging_220513.dgn

REFERENCE No.	PLAN No.	DATE	SHEET No. -
75813	75813.3	6/5/2013	OF - SHEETS