

**STORMWATER DRAINAGE LAYOUT SHOWN IS CONCEPTUAL AND FOR DA PURPOSES ONLY**

**STORMWATER NOTE:**  
HAY-LACKEY CULVERT ALIGNMENT BASED ON AVAILABLE DATA. LOCATION TO BE CONFIRMED

**PAVEMENT NOTES**  
1. ALL PAVEMENTS SUBJECT TO DESIGN BY QUALIFIED GEOTECHNICAL ENGINEER.

**LEGEND**

- GRASS
- PAVEMENT

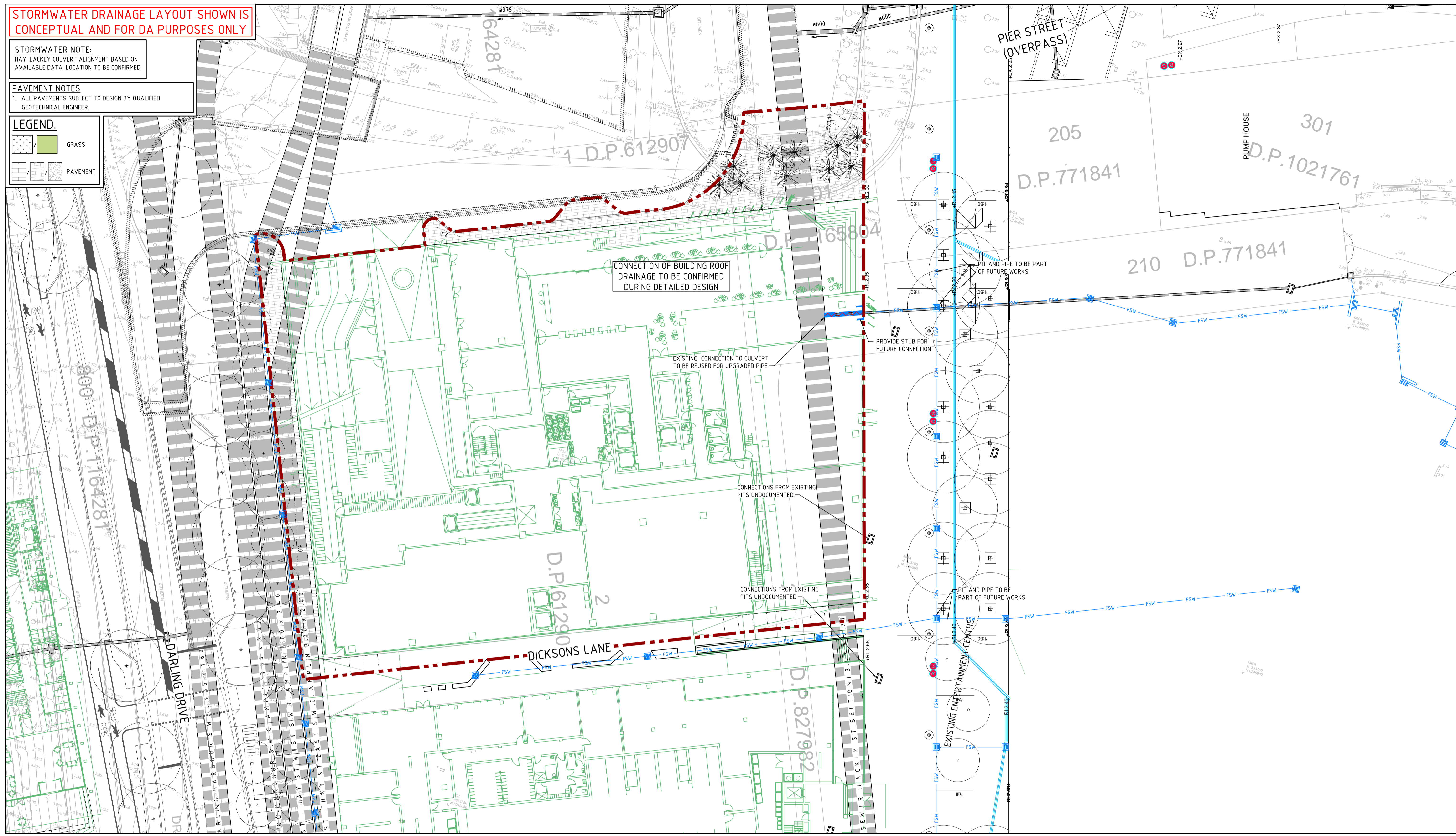

SYDNEY INTERNATIONAL CONVENTION, EXHIBITION AND ENTERTAINMENT PRECINCT

**DARLING HARBOUR LIVE**

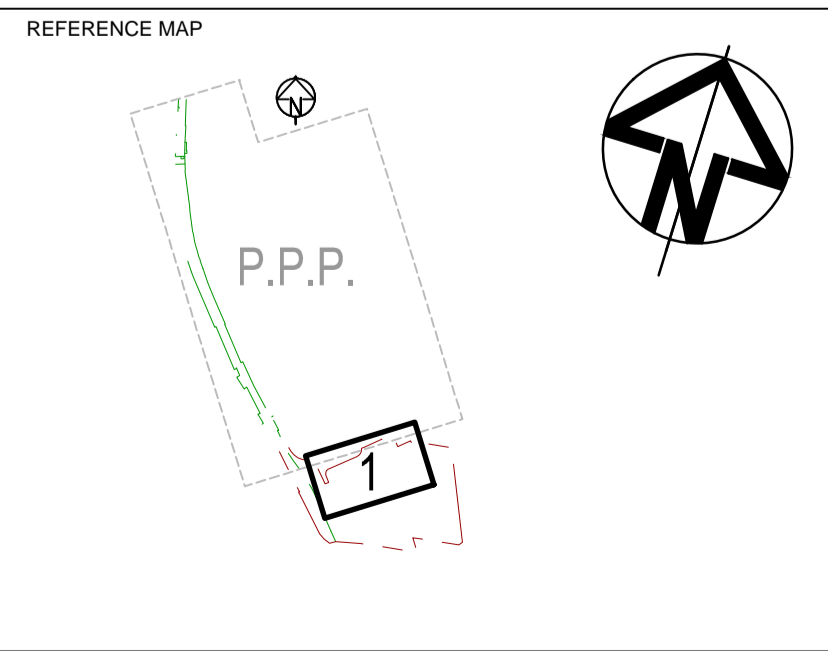

- NOTES:**
- DO NOT SCALE FROM DRAWINGS. WORK TO WRITTEN DIMENSIONS ONLY.
  - ALL DIMENSIONS IN METRES UNLESS NOTED OTHERWISE.
  - ALL COORDINATES TO MGA. ALL LEVELS TO AHD.
  - ALL DIMENSIONS, COORDINATES AND LEVELS TO BE VERIFIED ON SITE BEFORE PROCEEDING WITH WORK. HYDER SHALL BE NOTIFIED IN WRITING OF ANY DISCREPANCIES.
  - THIS DRAWING MUST BE READ IN CONJUNCTION WITH ALL RELEVANT CONTRACTS, SPECIFICATIONS AND DRAWINGS.

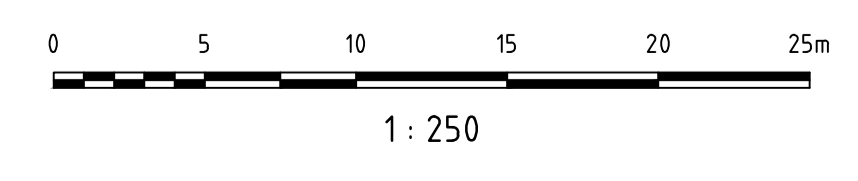

REV	DESCRIPTION	DATE
04	AMENDED AS PER CLIENT REQUEST	31/01/2014
03	DRAFT ISSUE	01/05/2013
02	DRAFT ISSUE	24/04/2013
01	DRAFT ISSUE	12/04/2013

**CLIENT**  
**Lend Lease**  
LEND LEASE BUILDING PTY. LTD.  
LEVEL 4, THE BOND, 30 HICKSON RD.  
MILLERS POINT, NSW 2000

**CONSULTANTS**  
**HASSELL + POPULOUS** LANDSCAPE ARCHITECT  
LEVEL 2, 88 CUMBERLAND STREET,  
SYDNEY NSW 2000

**DENTON ARCHITECT**  
**CORKER MARSHALL** EXHIBITION STREET,  
MELBOURNE VICTORIA 3000

**CIVIL / TRAFFIC / FACADES**  
**HYDER CONSULTING PTY LTD**  
ABN 76 104 485 289  
LEVEL 5, 141 WALKER ST,  
NORTH SYDNEY NSW 2060  
AUSTRALIA

Tel: +61 (0)2 8907 9000  
Fax: +61 (0)2 8907 9001  
www.hyderconsulting.com  
© Copyright reserved

**PROJECT**  
**SICEP - DARLING HARBOUR**  
**HAYMARKET (PDA)**  
**NORTH WEST PLOT**



**DRAWING TITLE**  
**CIVIL WORKS AND STORMWATER PLAN**

**STATUS**  
**PRELIMINARY ONLY**

SCALE @ A1	DRAWN	DESIGNED	REVIEWED	APPROVED
1 : 250	RD	RR		

PROJECT NUMBER	DRAWING NUMBER	REV
AA004399	PD-CI-2301	04