

PROJECT MARVEL - 20 Kelso Crescent, Moorebank, NSW 2170

Landscape Documentation for State Significant Development



IMAGE TAKEN FROM GOOGLE MAPS 2023

Drawing Register

Dwg No.	Drawing Name
SSD-00	Landscape Cover Sheet
SSD-01	Landscape Plan
SSD-02	Landscape Detail Plan 1
SSD-03	Landscape Detail Plan 2
SSD-04	Landscape Detail Plan 3
SSD-05	Landscape Detail Plan 4
SSD-06	Tree Canopy Cover Plan
SSD-07	Tree Retention Plan
SSD-08	Level 1 Detail Plan
SSD-09	Landscape Sections AA & BB
SSD-10	Landscape Sections CC & DD
SSD-11	Specification & Details
SSD-12	Plant Schedule & Imagery



SITE PLAN

Drawing Title:
Landscape Cover Sheet
DWG No:

SSD-00

GEOSCAPES
LANDSCAPE ARCHITECTS
Suite 303, 8 Help St, Chatswood NSW 2067 Ph. (02) 9411 1485
www.geoscapes.com.au
ABN 84 620 205 781 ACN 620 205 781

Architect:
nettleontribe
architecture

Client:
maple^otree

Scale: Date: Job Number: North:
13.09.2023 230301

Project: Project Marvel
20 Kelso Crescent, Moorebank, NSW 2170

Revision				FOR SSD	
Rev	Date	Description	Drawn	Checked	
A	11.08.23	For SSD	PT/KC	BG	BG
B	07.09.23	For SSD	KC	BG	BG
C	11.09.23	For SSD	KC	BG	BG
D	13.09.23	For SSD	KC	BG	BG

NOT FOR CONSTRUCTION

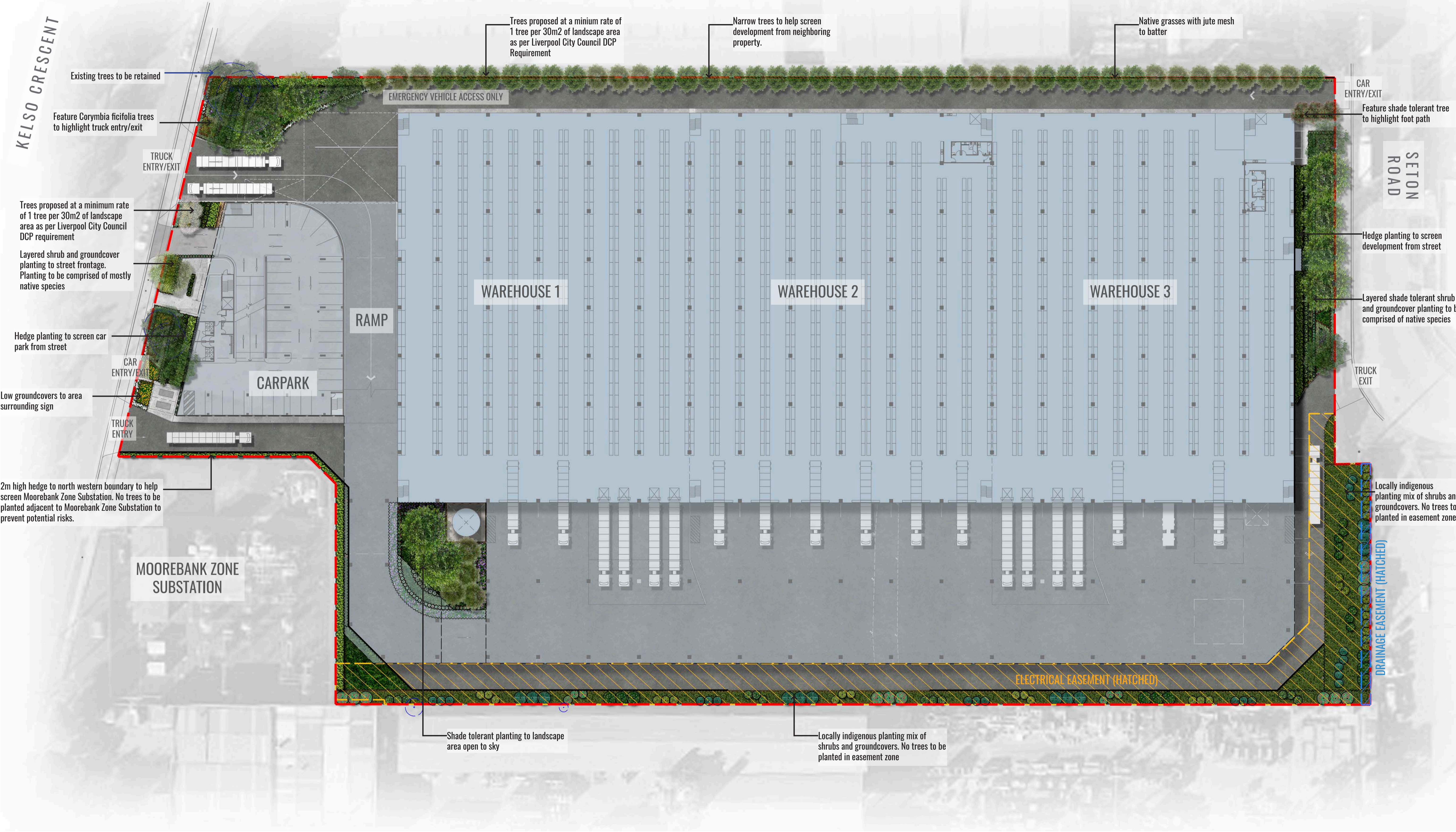

Drawing Title:
Landscape Plan
 DWG No:
SSD-01

GEOSCAPES
 LANDSCAPE ARCHITECTS
 Suite 303, 8 Help St, Chatswood NSW 2067 Ph. (02) 9411 1485
 www.geoscapes.com.au
 ABN 84 620 205 781 ACN 620 205 781

Architect:
nettletontribe
 architecture

Client:
maple tree

Scale:
 1:400 @ A1
 1:800 @ A3
 Date:
 13.09.2023
 Job Number:
 230301
 Project:
Project Marvel
 20 Kelso Crescent, Moorebank, NSW 2170

Revision			FOR SSD	
Rev	Date	Description	Drawn	Checked
A	11.08.23	For SSD	PT/KC	BG
B	07.09.23	For SSD	KC	BG
C	11.09.23	For SSD	KC	BG
D	13.09.23	For SSD	KC	BG

NOT FOR CONSTRUCTION

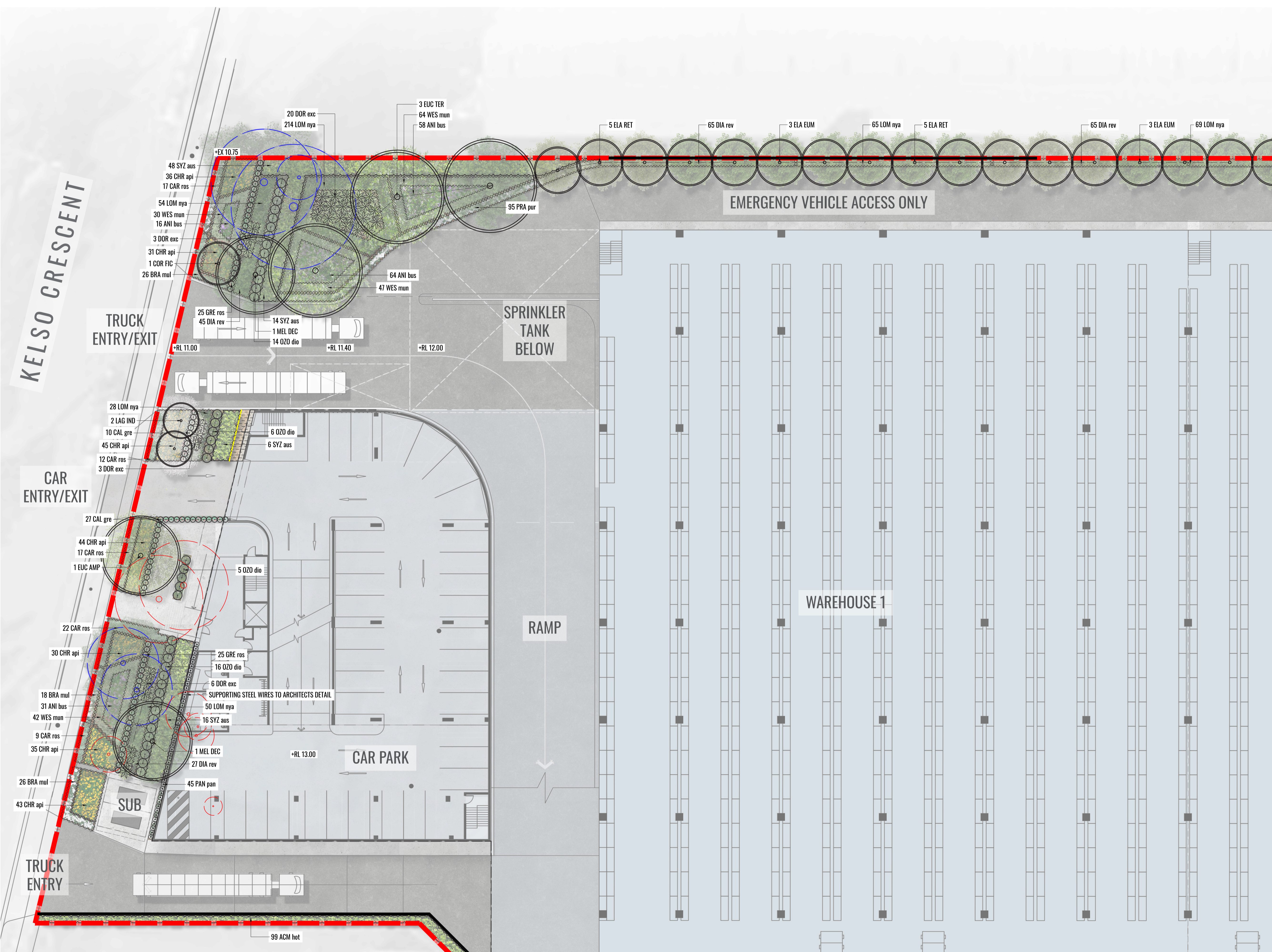

LEGEND

	SITE BOUNDARY
	PROPOSED TREES
	EXISTING TREES TO BE RETAINED
	EXISTING TREES TO BE REMOVED
	MASS HEDGE/SHRUB PLANTING
	PROPOSED SHRUB PLANTING
	ACCENT/FEATURE PLANTING
	PROPOSED GROUNDCOVER PLANTING
	ELECTRICAL EASEMENT
	DRAINAGE EASEMENT
	MATRIX 1 REFER TO DETAIL FOR SHRUBS AND GROUNDCOVERS
	MATRIX 2 REFER TO DETAIL FOR SHRUBS AND GROUNDCOVERS
	GRAVEL AREA
	RETAINING WALL TO ENGINEERS DETAIL
	TIMBER EDGE

Drawing Title:
Landscape Detail Plan 1
 DWG No:
SSD-02

GEOSCAPES
 LANDSCAPE ARCHITECTS
 Suite 303, 8 Help St, Chatswood NSW 2067 Ph. (02) 9411 1485
 www.geoscapes.com.au
 ABN 84 620 205 781 ACN 620 205 781

Architect:
nettletontribe
 architecture

Client:
maple tree

Scale:
 1:200 @ A1
 1:400 @ A3
 Date:
 13.09.2023
 Job Number:
 230301
 North:

 Project:
Project Marvel
 20 Kelso Crescent, Moorebank, NSW 2170

Revision			FOR SSD	
Rev	Date	Description	Drawn	Checked
A	11.08.23	For SSD	PT/KC	BG
B	07.09.23	For SSD	KC	BG
C	11.09.23	For SSD	KC	BG
D	13.09.23	For SSD	KC	BG

NOT FOR CONSTRUCTION

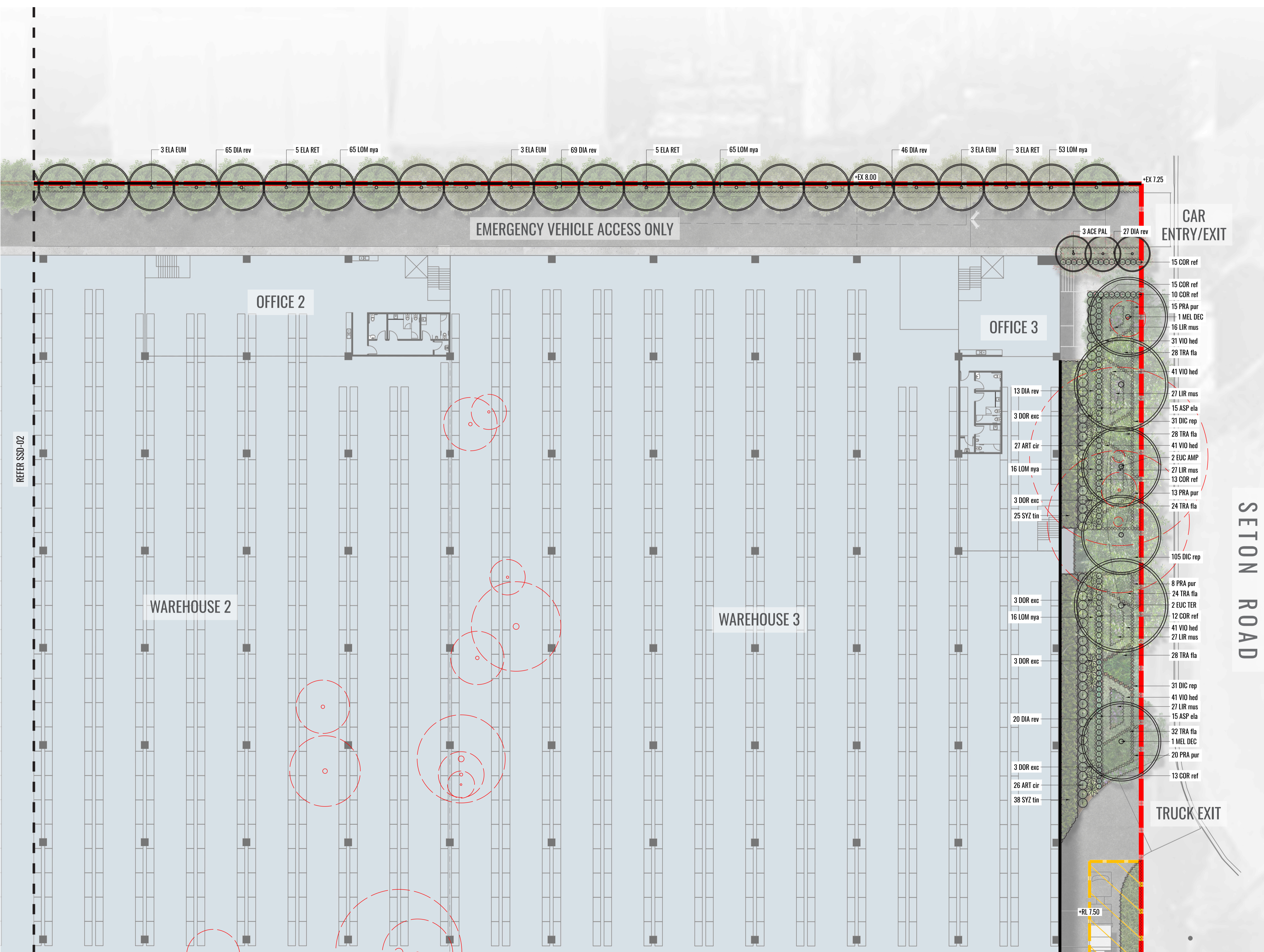

- LEGEND**
- SITE BOUNDARY
 - PROPOSED TREES
 - EXISTING TREES TO BE RETAINED
 - EXISTING TREES TO BE REMOVED
 - MASS HEDGE/SHRUB PLANTING
 - PROPOSED SHRUB PLANTING
 - ACCENT/FEATURE PLANTING
 - PROPOSED GROUNDCOVER PLANTING
 - ELECTRICAL EASEMENT
 - DRAINAGE EASEMENT
 - MATRIX 1 REFER TO DETAIL FOR SHRUBS AND GROUNDCOVERS
 - MATRIX 2 REFER TO DETAIL FOR SHRUBS AND GROUNDCOVERS
 - GRAVEL AREA
 - RETAINING WALL TO ENGINEERS DETAIL
 - TIMBER EDGE

Drawing Title:
Landscape Detail Plan 2
 DWG No:
SSD-03

GEOSCAPES
 LANDSCAPE ARCHITECTS
 Suite 303, 8 Help St, Chatswood NSW 2067 Ph. (02) 9411 1485
 www.geoscapes.com.au
 ABN 84 620 205 781 ACN 620 205 781

Architect:
nettletontribe
 architecture

Client:
mapletree

Scale:
 1:200 @ A1
 1:400 @ A3

Date:
 13.09.2023

Job Number:
 230301

North:

Project:
Project Marvel
 20 Kelso Crescent, Moorebank, NSW 2170

Revision			FOR SSD	
Rev	Date	Description	Drawn	Checked
A	11.08.23	For SSD	PT/KC	BG
B	07.09.23	For SSD	KC	BG
C	11.09.23	For SSD	KC	BG
D	13.09.23	For SSD	KC	BG

NOT FOR CONSTRUCTION

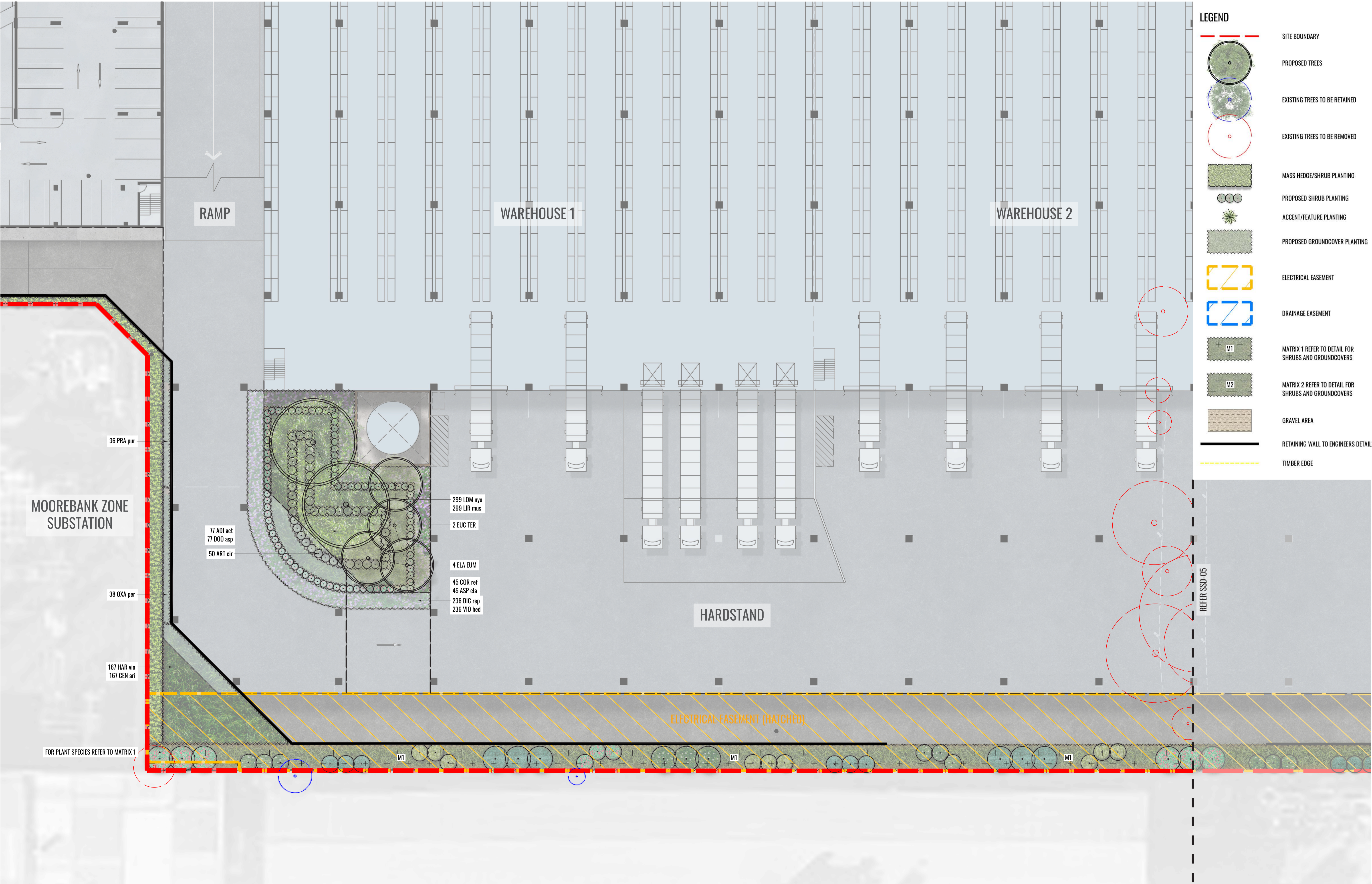

- LEGEND**
- SITE BOUNDARY
 - PROPOSED TREES
 - EXISTING TREES TO BE RETAINED
 - EXISTING TREES TO BE REMOVED
 - MASS HEDGE/SHRUB PLANTING
 - PROPOSED SHRUB PLANTING
 - ACCENT/FEATURE PLANTING
 - PROPOSED GROUNDCOVER PLANTING
 - ELECTRICAL EASEMENT
 - DRAINAGE EASEMENT
 - MATRIX 1 REFER TO DETAIL FOR SHRUBS AND GROUNDCOVERS
 - MATRIX 2 REFER TO DETAIL FOR SHRUBS AND GROUNDCOVERS
 - GRAVEL AREA
 - RETAINING WALL TO ENGINEERS DETAIL
 - TIMBER EDGE

MOOREBANK ZONE SUBSTATION

RAMP

WAREHOUSE 1

WAREHOUSE 2

HARDSTAND

ELECTRICAL EASEMENT (HATCHED)

REFER SSD-05

FOR PLANT SPECIES REFER TO MATRIX 1

Drawing Title:
Landscape Detail Plan 3
DWG No:

SSD-04

GEOSCAPES
LANDSCAPE ARCHITECTS
Suite 303, 8 Help St, Chatswood NSW 2067 Ph. (02) 9411 1485
www.geoscapes.com.au
ABN 84 620 205 781 ACN 620 205 781

Architect:
nettletontribe
architecture

Client:
maple^otree

Scale: 1:200 @ A1
1:400 @ A3
Date: 13.09.2023
Job Number: 230301
North:
Project: **Project Marvel**
20 Kelso Crescent, Moorebank, NSW 2170

Revision			FOR SSD	
Rev	Date	Description	Drawn	Checked
A	11.08.23	For SSD	PT/KC	BG
B	07.09.23	For SSD	KC	BG
C	11.09.23	For SSD	KC	BG
D	13.09.23	For SSD	KC	BG

NOT FOR CONSTRUCTION

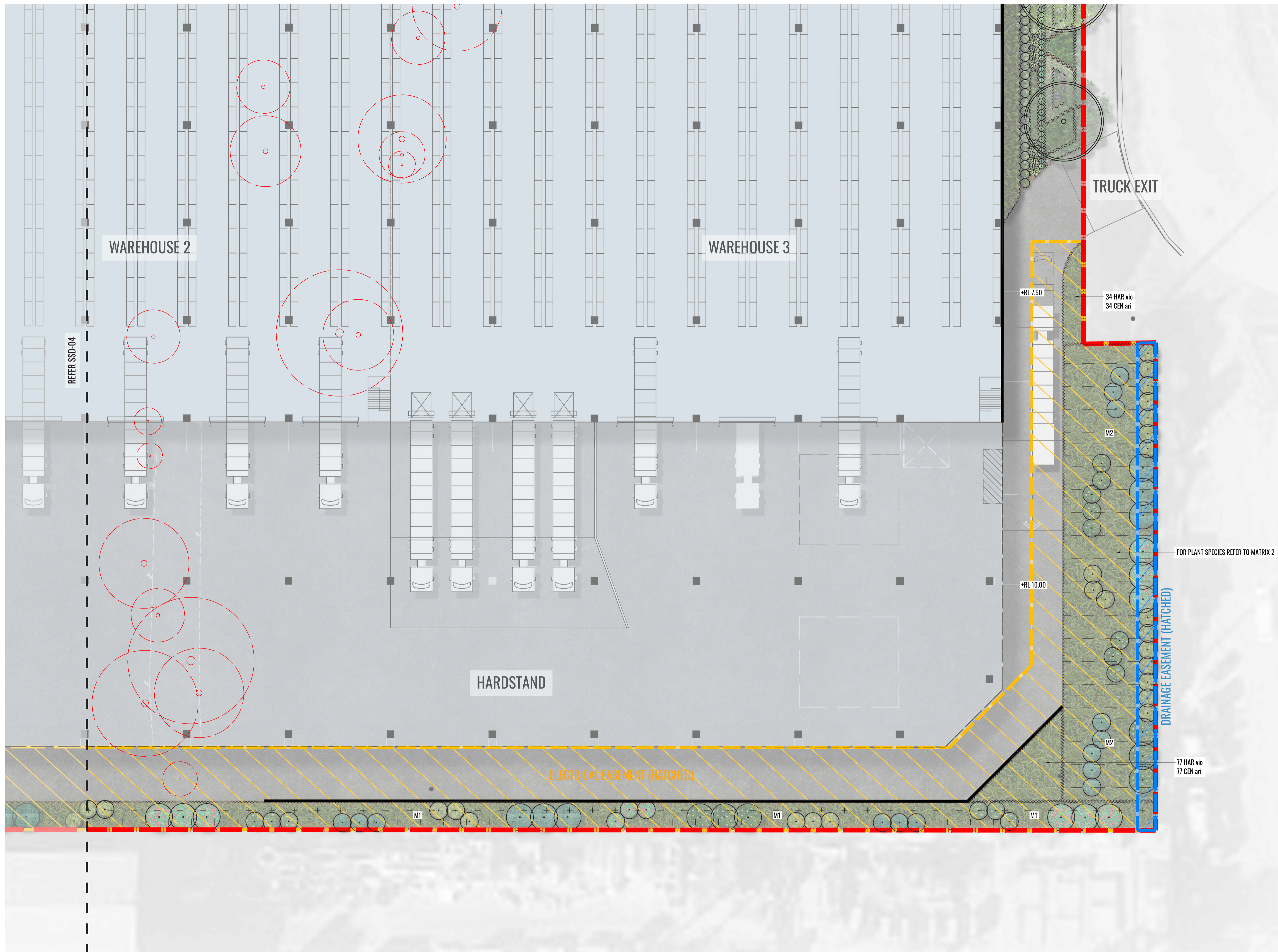

LEGEND

	SITE BOUNDARY
	PROPOSED TREES
	EXISTING TREES TO BE RETAINED
	EXISTING TREES TO BE REMOVED
	MASS HEDGE/SHRUB PLANTING
	PROPOSED SHRUB PLANTING
	ACCENT/FEATURE PLANTING
	PROPOSED GROUNDCOVER PLANTING
	ELECTRICAL EASEMENT
	DRAINAGE EASEMENT
	MATRIX 1 REFER TO DETAIL FOR SHRUBS AND GROUNDCOVERS
	MATRIX 2 REFER TO DETAIL FOR SHRUBS AND GROUNDCOVERS
	GRAVEL AREA
	RETAINING WALL TO ENGINEERS DETAIL
	TIMBER EDGE

Drawing Title:
Landscape Detail Plan 4
 DWG No:

SSD-05

GEOSCAPES
 LANDSCAPE ARCHITECTS
 Suite 303, 8 Help St, Chatswood NSW 2067 Ph. (02) 9411 1485
 www.geoscapes.com.au
 ABN 84 620 205 781 ACN 620 205 781

Architect:
nettletontribe
 architecture

Client:
maple^otree

Scale:
 1:200 @ A1
 1:400 @ A3

Date:
 13.09.2023

Job Number:
 230301

North:

Project:

Project Marvel

20 Kelso Crescent, Moorebank, NSW 2170

Revision				FOR SSD	
Rev	Date	Description	Drawn	Checked	
A	11.08.23	For SSD	PT/KC	BG	
B	07.09.23	For SSD	KC	BG	
C	11.09.23	For SSD	KC	BG	
D	13.09.23	For SSD	KC	BG	

NOT FOR CONSTRUCTION



LEGEND

- PROPOSED TREES
- TREES TO BE RETAINED

LANDSCAPE AREA AND DCP CONTROL

- Landscape area = 3560m² (10.1%)
- DCP Control = 1 tree every 30m² of landscape area
- Landscape area within drainage/electrical easement and Moorebank zone substation where trees cannot be proposed = 1447.92m²
- Total landscape area available for tree planting = 2112m²

TREE PLANTING CALCULATION

- Number of Trees Required (minus easement and substation zone) = 70
- Proposed Trees = 67
- Trees to be retained = 5
- Total Number of Trees (proposed trees + trees to be retained) = 72

CANOPY COVER CALCULATION

- Site Area = 35,190m²
- Existing Canopy Cover = 260.34m²
- Proposed Canopy Cover = 1996.63m²
- Total Canopy Cover = 2256.97m² (6.4%)

Drawing Title:
Tree Canopy Cover Plan
DWG No:
SSD-06

GEOSCAPES
LANDSCAPE ARCHITECTS
Suite 303, 8 Help St, Chatswood NSW 2067 Ph. (02) 9411 1485
www.geoscapes.com.au
ABN 84 620 205 781 ACN 620 205 781

Architect:
nettletontribe
architecture

Client:
maple^{tree}

Scale: 1:400 @ A1
1:800 @ A3
Date: 13.09.2023
Job Number: 230301
North:
Project: Project Marvel
20 Kelso Crescent, Moorebank, NSW 2170

Revision				FOR SSD	
Rev	Date	Description	Drawn	Checked	
A	11.08.23	For SSD	PT/KC	BG	
B	07.09.23	For SSD	KC	BG	
C	11.09.23	For SSD	KC	BG	
D	13.09.23	For SSD	KC	BG	

NOT FOR CONSTRUCTION

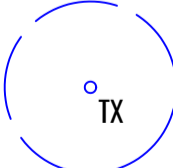
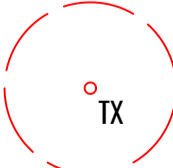

LEGEND

-  TREES TO BE RETAINED
-  TREES TO BE REMOVED

Drawing Title:
Tree Retention Plan
DWG No:

SSD-07

GEOSCAPES
LANDSCAPE ARCHITECTS
Suite 303, 8 Help St, Chatswood NSW 2067 Ph. (02) 9411 1485
www.geoscapes.com.au
ABN 84 620 205 781 ACN 620 205 781

Architect:
nettletontribe
architecture

Client:
mapleiree

Scale:
1:400 @ A1
1:800 @ A3

Date:
13.09.2023

Job Number:
230301

North:

Project:
Project Marvel
20 Kelso Crescent, Moorebank, NSW 2170

Revision			FOR SSD	
Rev	Date	Description	Drawn	Checked
A	11.08.23	For SSD	PT/KC	BG
B	07.09.23	For SSD	KC	BG
C	11.09.23	For SSD	KC	BG
D	13.09.23	For SSD	KC	BG

NOT FOR CONSTRUCTION

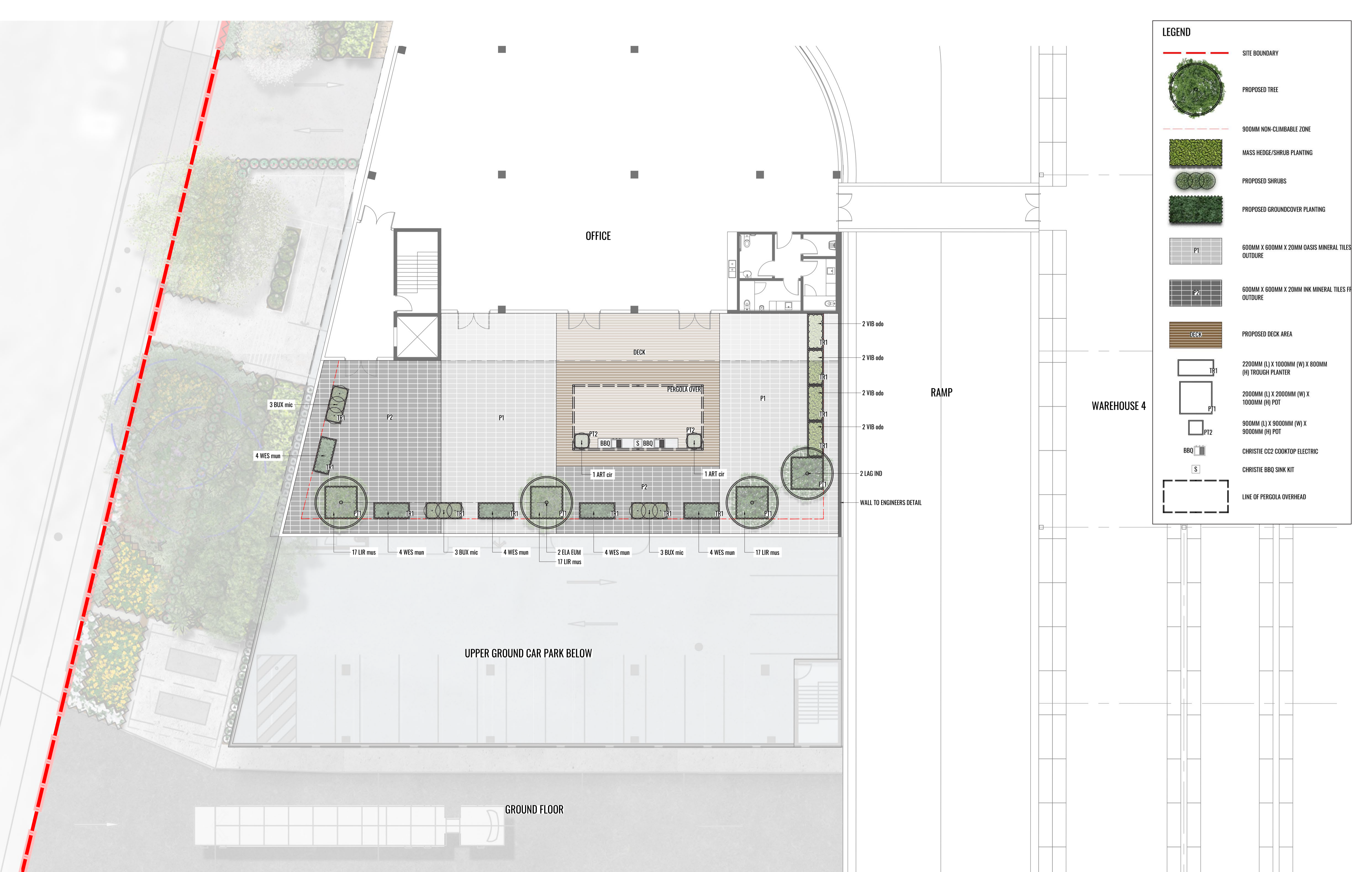

LEGEND	
	SITE BOUNDARY
	PROPOSED TREE
	900MM NON-CLIMBABLE ZONE
	MASS HEDGE/SHRUB PLANTING
	PROPOSED SHRUBS
	PROPOSED GROUNDCOVER PLANTING
	600MM X 600MM X 20MM OASIS MINERAL TILES OUTDORE
	600MM X 600MM X 20MM INK MINERAL TILES FF OUTDORE
	PROPOSED DECK AREA
	2200MM (L) X 1000MM (W) X 800MM (H) TROUGH PLANTER
	2000MM (L) X 2000MM (W) X 1000MM (H) POT
	900MM (L) X 900MM (W) X 900MM (H) POT
	CHRISTIE CC2 COOKTOP ELECTRIC
	CHRISTIE BBQ SINK KIT
	LINE OF PERGOLA OVERHEAD

Drawing Title:
Level 1 Detail Plan
 DWG No:
SSD-08

GEOSCAPES
 LANDSCAPE ARCHITECTS
 Suite 303, 8 Help St, Chatswood NSW 2067 Ph. (02) 9411 1485
 www.geoscapes.com.au
 ABN 84 620 205 781 ACN 620 205 781

Architect:
nettletontribe
 architecture

Client:
maple^otree

Scale:
 1:100 @ A1
 1:200 @ A3
 Date:
 13.09.2023
 Job Number:
 230301
 Project:
Project Marvel
 20 Kelso Crescent, Moorebank, NSW 2170

Revision				FOR SSD	
Rev	Date	Description	Drawn	Checked	
A	11.08.23	For SSD	PT/KC	BG	
B	07.09.23	For SSD	KC	BG	
C	11.09.23	For SSD	KC	BG	
D	13.09.23	For SSD	KC	BG	

NOT FOR CONSTRUCTION

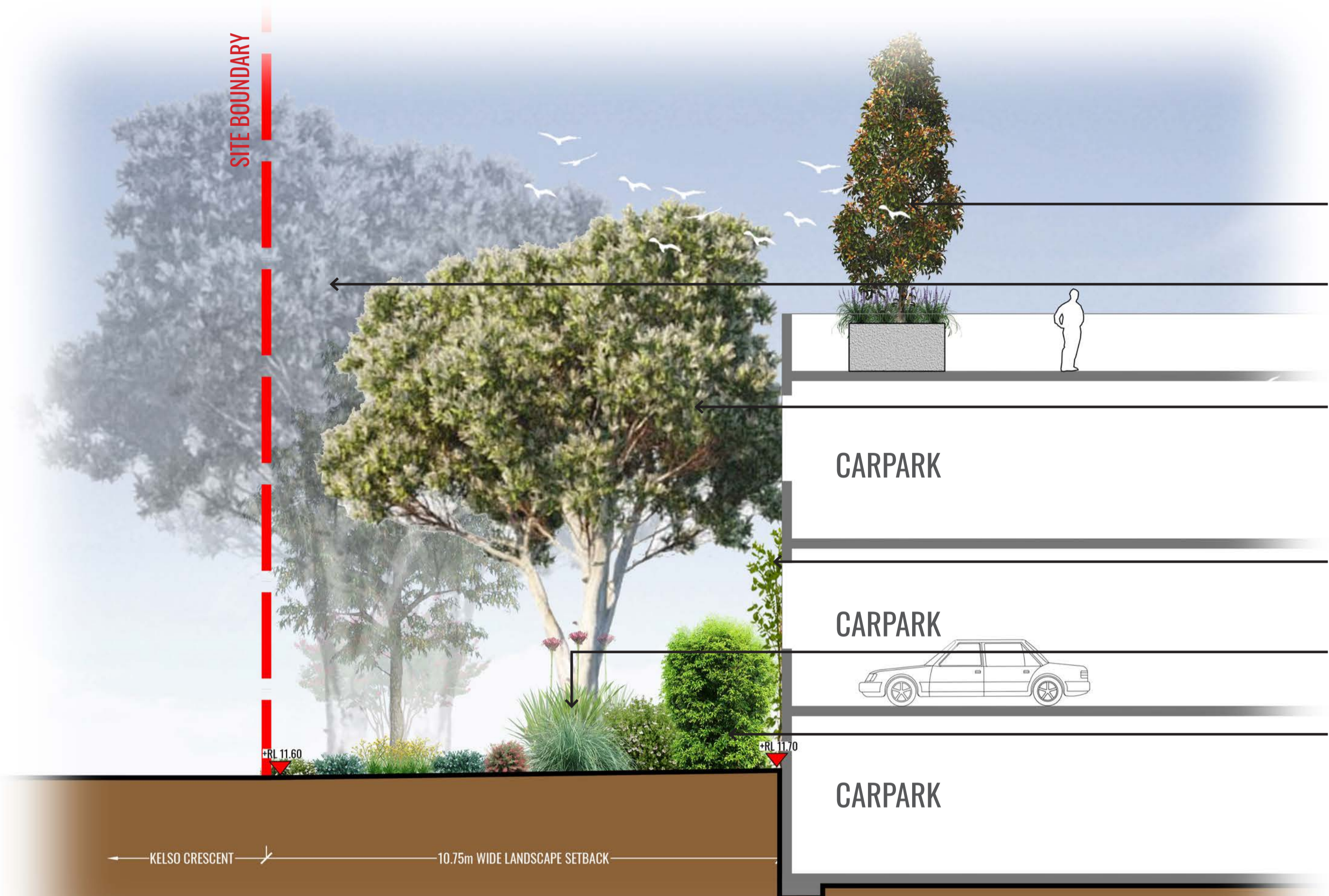

2m L x 1m H pot with small tree underplanted with native Viola

Existing trees to be retained

Trees proposed at a minimum rate of 1 tree per 30m² of landscape area as per Liverpool City Council DCP requirement

Pandorea pandorana climbers to north facade. Supporting steel wires to architects detail. Layered shrub and groundcover planting to street frontage. Planting to be comprised of mostly native species

Hedge planting for screening

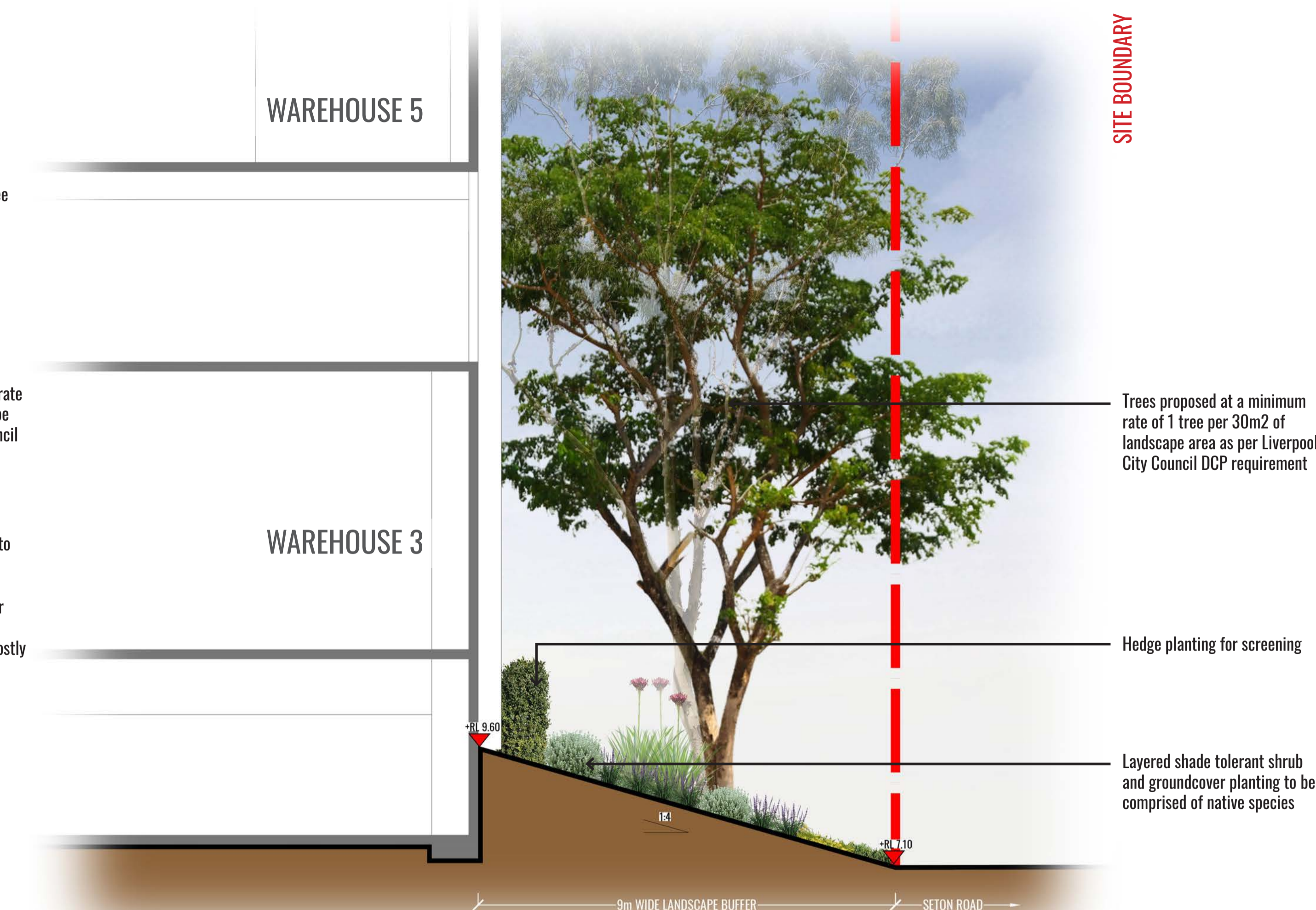

Trees proposed at a minimum rate of 1 tree per 30m² of landscape area as per Liverpool City Council DCP requirement

Hedge planting for screening

Layered shade tolerant shrub and groundcover planting to be comprised of native species

SECTION AA - KELSO CRESCENT

SECTION BB - SETON ROAD



Drawing Title:
Landscape Sections AA & BB
 DWG No: **SSD-09**

GEOSCAPES
 LANDSCAPE ARCHITECTS
 Suite 303, 8 Help St, Chatswood NSW 2067 Ph. (02) 9411 1485
 www.geoscapes.com.au
 ABN 84 620 205 781 ACN 620 205 781

Architect:
nettletontribe
 architecture

Client:
maple^otree

Scale:
 1:75 @ A1
 1:150 @ A3

Date:
 13.09.2023

Job Number:
 230301

North:

Project:
Project Marvel
 20 Kelso Crescent, Moorebank, NSW 2170

Revision			FOR SSD	
Rev	Date	Description	Drawn	Checked
A	11.08.23	For SSD	PT/KC	BG
B	07.09.23	For SSD	KC	BG
C	11.09.23	For SSD	KC	BG
D	13.09.23	For SSD	KC	BG

NOT FOR CONSTRUCTION

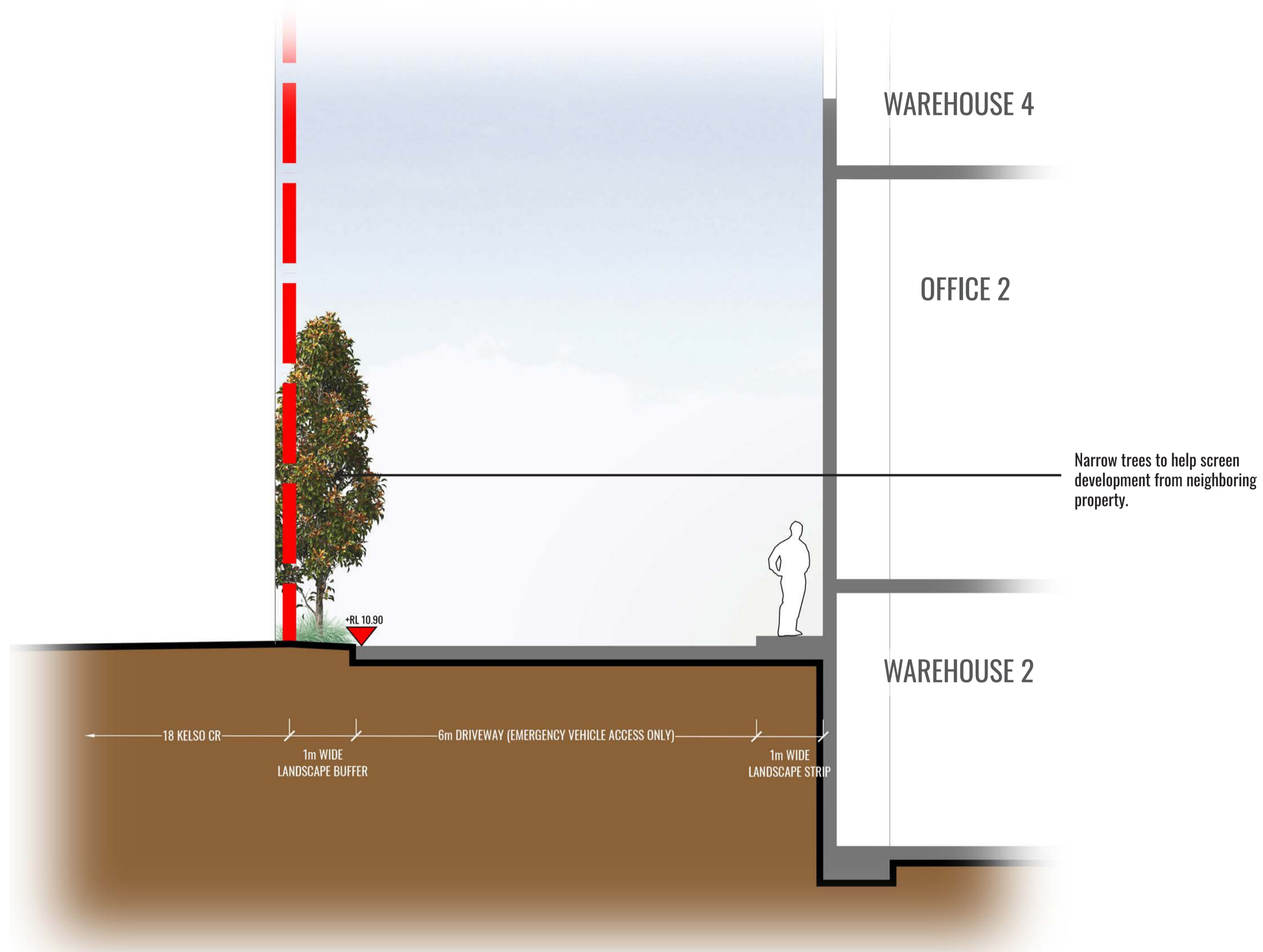

SECTION CC

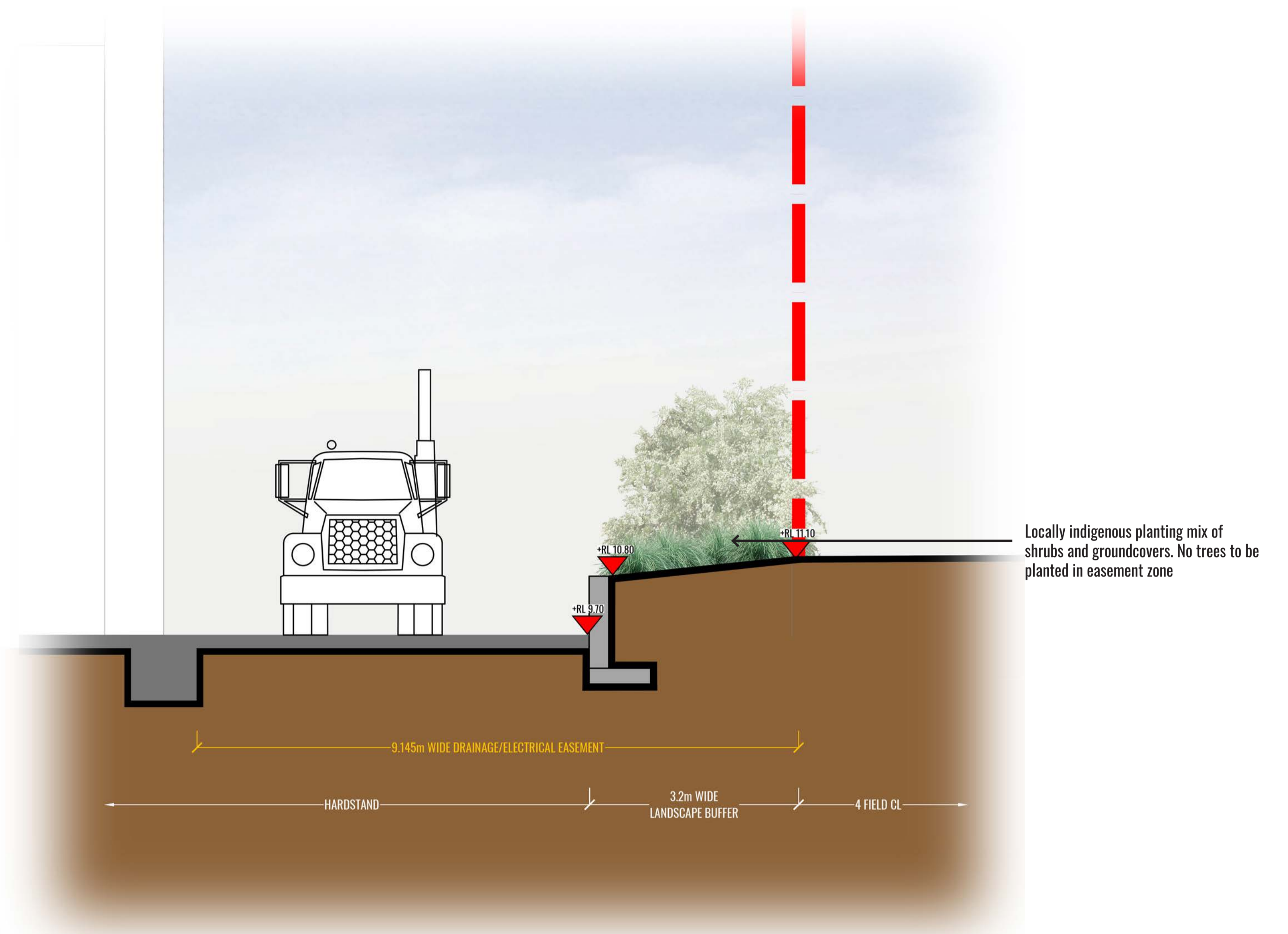

SECTION DD



Drawing Title:
Landscape Sections CC & DD
 DWG No: **SSD-10**

GEOSCAPES
 LANDSCAPE ARCHITECTS
 Suite 303, 8 Help St, Chatswood NSW 2067 Ph. (02) 9411 1485
 www.geoscapes.com.au
 ABN 84 620 205 781 ACN 620 205 781

Architect:
nettletontribe
 architecture

Client:
maple^otree

Scale: 1:50 @ A1
 1:100 @ A3
 Date: 13.09.2023
 Job Number: 230301
 Project: **Project Marvel**
 20 Kelso Crescent, Moorebank, NSW 2170

Revision			FOR SSD	
Rev	Date	Description	Drawn	Checked
A	11.08.23	For SSD	PT/KC	BG
B	07.09.23	For SSD	KC	BG
C	11.09.23	For SSD	KC	BG
D	13.09.23	For SSD	KC	BG

NOT FOR CONSTRUCTION

MAINTENANCE PLAN

Maintenance shall mean the care and maintenance of the landscape works by accepted horticultural practice as rectifying any defects that become apparent in the landscape works under normal use. The landscape contractor shall attend the site on a **weekly basis** to maintain the landscape works commencing from practical completion.

Rubbish Removal

The Landscape Contractor shall undertake rubbish removal from the site on a **weekly basis** to ensure the site remains in tidy condition.

Weed Eradication

Weed growth that may occur in grassed, planted or mulched areas is to be removed using environmentally acceptable methods i.e. non-residual glyphosate herbicide (e.g. 'Roundup', applied in accordance with the manufacturer's direction.

Tree Replacement

Trees shall show signs of healthy vigorous growth and be free from disease and not exhibit signs of stress prior to handover to the client. Any trees or plant that die or fail to thrive, or are damaged or stolen will be replaced. Replacement material shall have the initial maintenance period extended in accordance with the landscape contract conditions. Trees and plant materials shall be equal to the minimum requirements of species specified and approved material delivered to site. Should the condition decline from the approved sample the Superintendent reserves the right to reject the tree / plants.

Frequency: as required.

Stakes

Adjust and/or replace stakes and ties where required. Remove staking and guying when instructed by the Superintendent

Pruning

Selective pruning may be required during the establishment period to promote a balanced canopy structure. These activities shall be carried out to the best horticultural and industry practice. All pruned material is to be removed from site.

Mulched Surfaces

All planter beds and garden areas shall have a minimum depth of 75mm organic mulch. All mulch is to be free of deleterious matter such as soil, weeds, sticks and should conform to AS 4454.

Mulched surfaces are to be kept clean and tidy and free of any deleterious material and foreign matter. Reinstate depths to a uniform level of 75mm with mulch as specified, mulch to be free of any wood material impregnated with CCA or similar toxic treatment. Top up mulch levels prior to handover to client & estate management.

Watering

Implement an appropriate hand watering regime in areas not irrigated in association with current watering programme to maintain plant health and vigour. The program shall reflect seasonal conditions and plant species.

Frequency: Weekly or as required.

Soil In Natural Ground

Non-Australian native garden beds to have soil installed consisting of 50% existing site topsoil and 50% new topsoil equal or equivalent to 'Organic Garden Mix' as supplied by Australian Native Landscapes. Australian native garden beds to have soil installed consisting of 50% existing site topsoil and 50% new topsoil equal or equivalent to 'Native Low 'P' Mix' as supplied by Australian Native Landscapes. Soil to conform to AS4419 refer to typical detail.

Pest and Disease Control

The Landscape Contractor shall spray for pests and disease infestations when the pest and fungal attack has been positively identified and when their populations have increased to a point that will become detrimental to plant growth. Apply all pesticides to manufacturer's directions.

Frequency: weekly inspection

Fertilising

Generally check for signs of nutrient deficiencies (yellowing of leaves, failure to thrive), and adapt fertiliser regime to suit. Fertiliser should be applied at the beginning and the end of the (summer) growing season.

Irrigation

A sub surface dripper style, electrically automated self timed irrigation system is to be supplied only to the front setback area (approx. 500m²). Regular checks are to be made to ensure continued successful operation. The irrigation system will need to provide designated landscaped areas with enough water for vigorous healthy plant growth. As a general rule landscaped areas will need 20-25mm, species dependant, of water per week. The landscape Contractor will need to monitor natural rainfall using a rain switch in order to set irrigation flow rates accordingly on a monthly basis. All other garden beds will be hand watered.

Standards

All grown or purchased plant stock must conform to all the conditions and requirements given in NATSPEC Guide: Specifying Trees. Soils to be in accordance with AS4419, mulching composts and conditioners to be in accordance with AS4454. Soils should conform to best practice specifications as listed in the Landscape Soils Handbook (Simon Leake & Elke Haegle 2017).

TYPICAL LANDSCAPE DETAILS

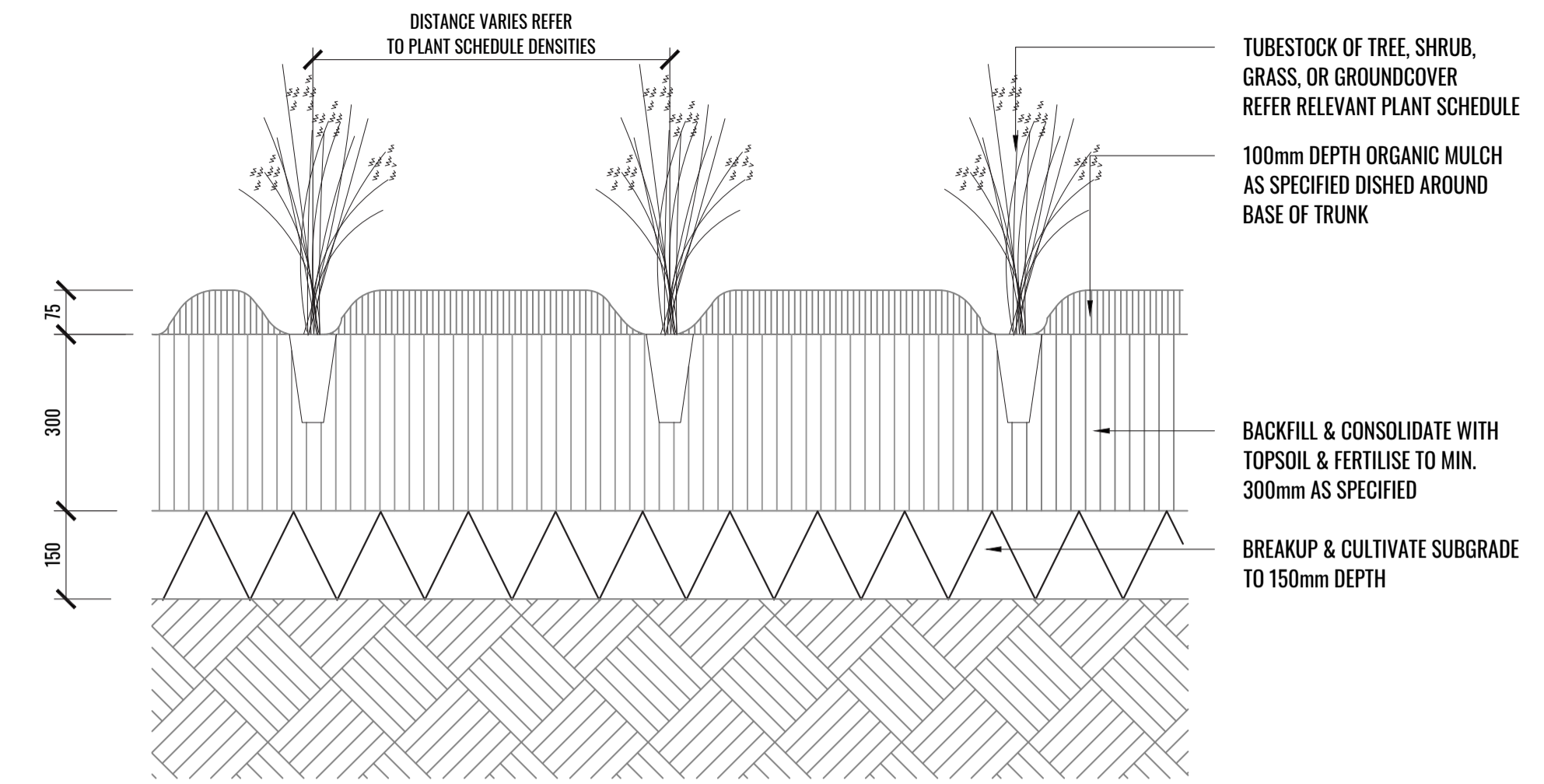

2 TUBE STOCK PLANTS TYPICAL DETAIL

TYPICAL SECTION

SCALE 1:10

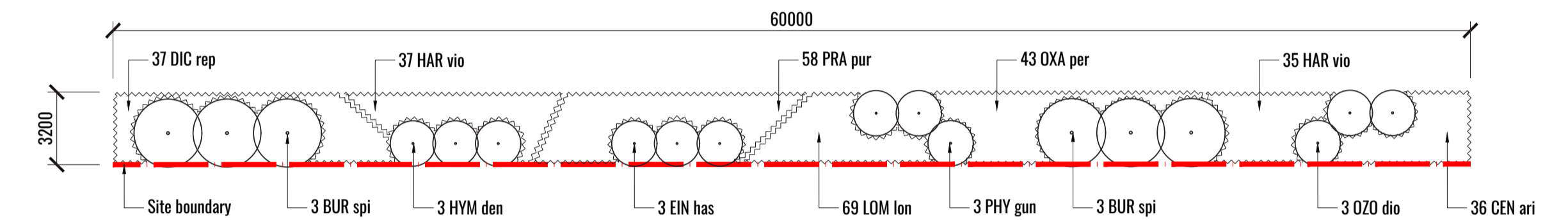

3 MATRIX DETAIL 1

TYPICAL PLAN

SCALE 1:200

TREE/SHRUB SIZE AND QUALITY TO BE TO NATSPEC STANDARD. SPECIES IS TO BE AS PER PLAN AND PLANT SCHEDULE. ENSURE ONLY HEALTHY AND VIGOROUS, DISEASE FREE, WELL MAINTAINED PLANTS ARE USED. TAKE CARE TO ENSURE FOLIAGE, BRANCHES, TRUNKS AND ROOT CROWNS ARE NOT DAMAGED BEFORE, DURING AND AFTER PLANTING. ENSURE OPTIMUM MAINTENANCE AND ESTABLISHMENT OF TREES/SHRUBS OCCURS AS SOON AS THEY ARE AT SITE

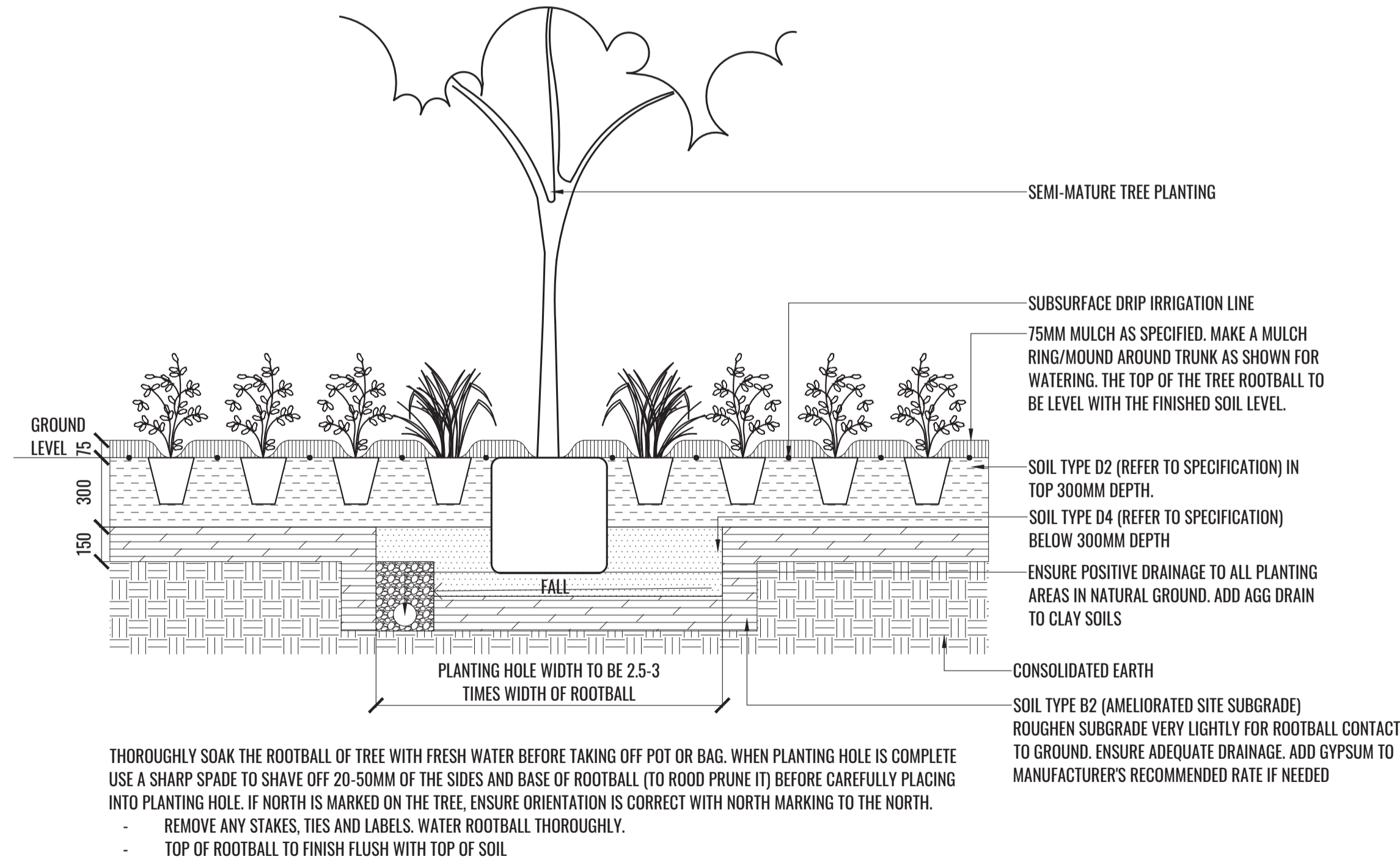

1 MASS PLANTING AND TREE DETAIL

TYPICAL SECTION

SCALE 1:20

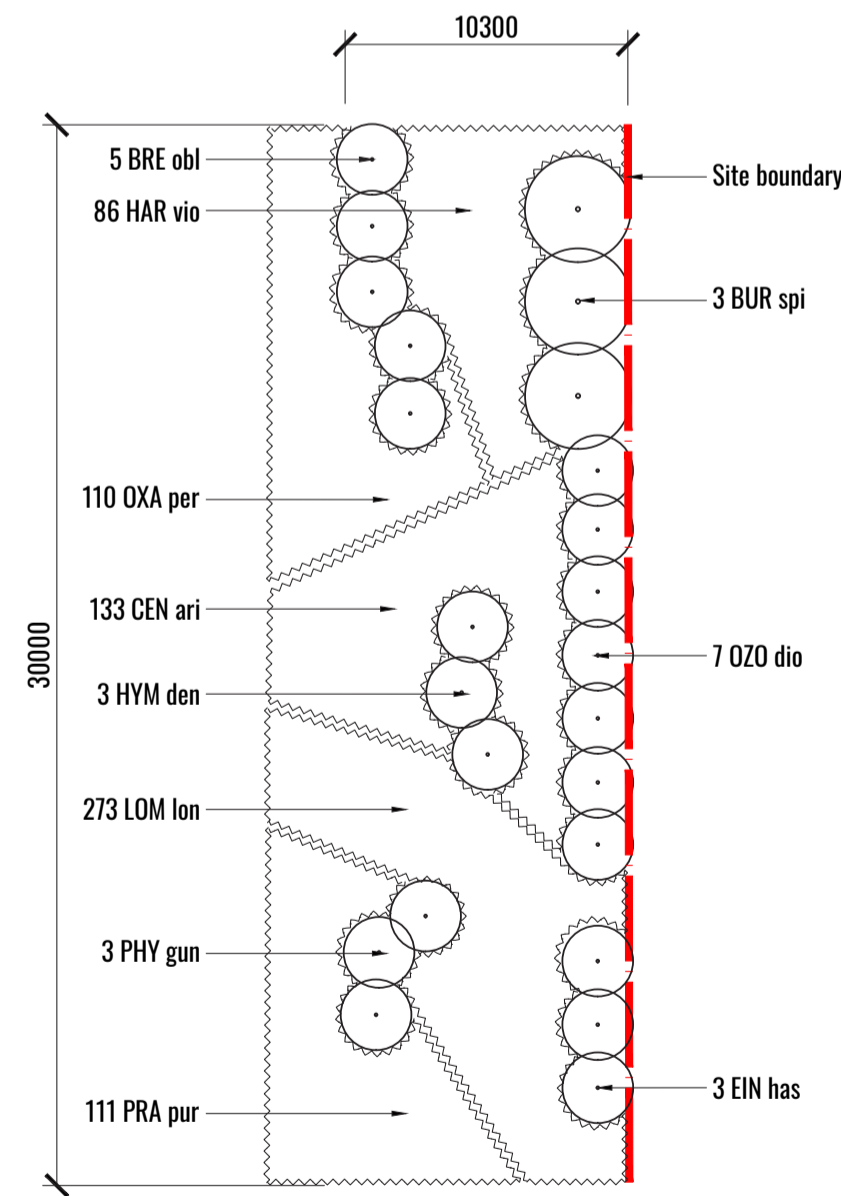

4 MATRIX DETAIL 2

TYPICAL PLAN

SCALE 1:200

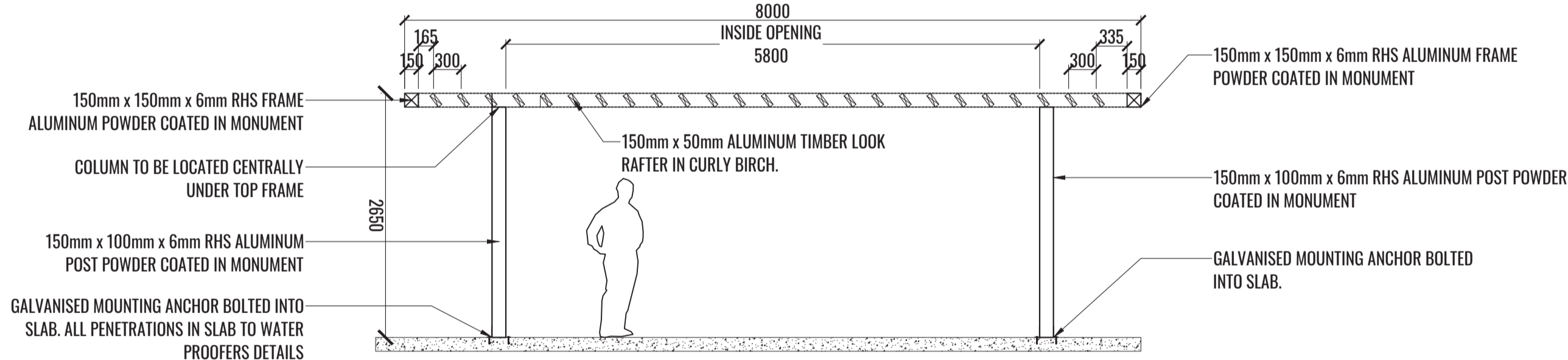

5 TYPICAL PERGOLA SECTION

TYPICAL SECTION

SCALE 1:50

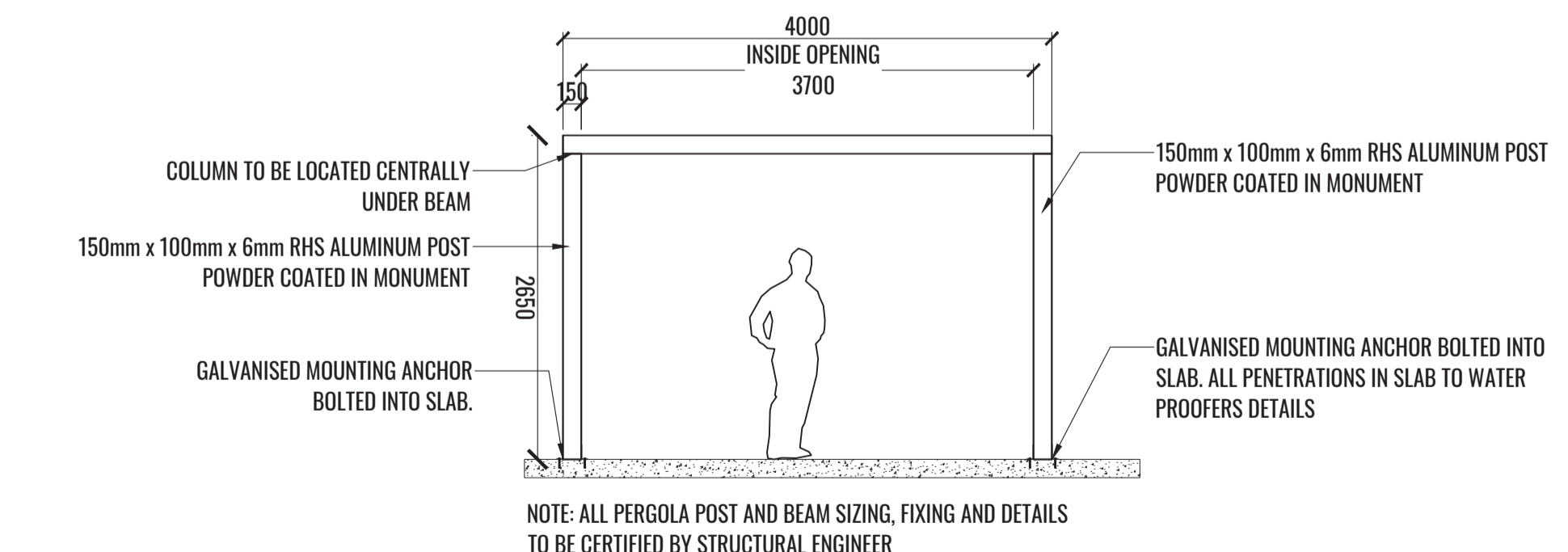

6 TYPICAL PERGOLA ELEVATION

TYPICAL SECTION

SCALE 1:50

Drawing Title:
Specification & Details
DWG No:

SSD-11

GEOSCAPES
LANDSCAPE ARCHITECTS
Suite 303, 8 Help St, Chatswood NSW 2067 Ph. (02) 9411 1485
www.geoscapes.com.au
ABN 84 620 205 781 ACN 620 205 781

Architect:
nettleontribe
architecture

Client:
maple tree

Scale:	Date:	Job Number:	North:	Revision		FOR SSD		
AS SHOWN @ A1 AS SHOWN @ A3	13.09.2023	230301		Rev	Date	Description	Drawn	Checked
Project: Project Marvel 20 Kelso Crescent, Moorebank, NSW 2170				A	11.08.23	For SSD	PT/KC	BG
				B	07.09.23	For SSD	KC	BG
				C	11.09.23	For SSD	KC	BG
				D	13.09.23	For SSD	KC	BG

NOT FOR CONSTRUCTION

PLANTING SCHEDULE

Ground Floor Plant Schedule									
Code	Botanical Name	Common Name	Mature Height	Spacing	Install Size	Locally Indigenous**	Native	Low Water Use	Qty**
Trees									
ACE PAL	<i>Acer palmatum</i>	Japanese Maple	10m	As Shown	75L				3
COR FIG	<i>Corymbia ficifolia</i>	Red Flowering Gum	8m	As Shown	75L		✓	✓	1
ELA EUM	<i>Elaeocarpus eumundi</i>	Smooth Quandong	8m	As Shown	75L		✓	✓	19
ELA RET	<i>Elaeocarpus reticulatus</i>	Blueberry Ash	9m	As Shown	75L	✓	✓	✓	28
EUC AMP	<i>Eucalyptus amplifolia</i>	Cabbage Gum	30m	As Shown	75L	✓	✓	✓	3
EUC TER	<i>Eucalyptus tereticornis</i>	Forest Red Gum	35m	As Shown	75L	✓	✓	✓	7
LAG IND	<i>Lagerstroemia indica 'Natchez'</i>	White Crepe Myrtle	8m	As Shown	75L			✓	2
MEL DEC	<i>Melaleuca decora</i>	White Feather Honeymyrtle	12m	As Shown	75L	✓	✓	✓	4
Shrubs									
ACM hot	<i>Acmena smithii 'Hot Flush'</i>	Dwarf Lilly Pilly	0.8m*	1000mm centres	300mm		✓	✓	99
ART cir	<i>Arthropodium cirratum</i>	New Zealand Rock Lily	0.8m	As Shown	200mm			✓	103
ASP ela	<i>Aspidistra elatior</i>	Cast Iron Plant	0.5m	As Shown	200mm			✓	75
BRE obl	<i>Breynia oblongifolia</i>	Coffee Bush	2m	As Shown	Tube stock	✓	✓	✓	8
BUR spi	<i>Bursaria spinosa</i>	Sweet Bursaria	3-4m	As Shown	Tube stock	✓	✓	✓	27
CAL gre	<i>Callistemon 'Green John'</i>	Dwarf Callistemon	0.8m	As Shown	200mm			✓	37
COR ref	<i>Correa reflexa</i>	Native Fuchsia	0.5-1m	As Shown	200mm			✓	123
EIN has	<i>Einadia hastata</i>	Berry Saltbush	1-2m	As Shown	Tube stock	✓	✓	✓	16
GRE ros	<i>Grevillea rosmarinifolia 'H16'</i>	Grevillea Crimson Villea	0.8m	As Shown	200mm		✓	✓	50
HYM den	<i>Hymenathera dentata</i>	Tree Violet	2m	As Shown	Tube stock	✓	✓	✓	16
OZO dio	<i>Ozothamnus diosmitifolius</i>	Rice Flower	1.5m	As Shown	200mm	✓	✓	✓	63
PHY gun	<i>Phyllanthus gunnii</i>	Scrubby Spurge	2m	As Shown	Tube stock	✓	✓	✓	16
SYZ aus	<i>Syzygium australe 'Select Form'</i>	Lilly Pilly	3m*	1000mm centres	300mm			✓	84
SYZ tin	<i>Syzygium australe 'Tiny Trev'</i>	Lilly Pilly	0.75m	750mm centres	200mm			✓	63
Accent Shrubs									
DOR exc	<i>Doryanthes excelsa</i>	Gynea Lily	2-4m	As Shown	300mm			✓	47
Grasses & Groundcovers									
ANI bus	<i>Anigozanthos 'Bush Pearl'</i>	Kangaroo Paw	0.6-0.8m	3/m2	140mm			✓	169
ADI aet	<i>Adiantum aethiopicum</i>	Common Maidenhair Fern	0.5m	3/m2	140mm	✓	✓		77
BRA mul	<i>Brachyscome multifida 'Mauve Delight'</i>	Rock Daisy	0.3m	3/Lm	140mm			✓	70
CAR ros	<i>Carpobrotus glaucescens 'White Hot'</i>	Pigface	0.2m	2/Lm	140mm			✓	77
CEN ari	<i>Centella aristata</i>	Asiatic Pennywort	0.5m	3/m2	140mm	✓	✓	✓	627
CHR api	<i>Chrysocephalum apiculatum</i>	Yellow Buttons	0.4m	3/m2	140mm			✓	264
DIA rev	<i>Dianella revoluta</i>	Flax Lily	1m	5/m2 or 3/Lm	Tube stock			✓	442
DIC rep	<i>Dichondra repens</i>	Kidney Weed	0.15m	3/m2	140mm	✓	✓	✓	537
DOO asp	<i>Doodia aspera</i>	Prickly Rasp Fern	0.35m	3/m2	140mm	✓	✓		77
HAR vio	<i>Hardenbergia violacea</i>	Purple Coral Pea	1m	3/m2	140mm			✓	680
LIR mus	<i>Liriope muscari 'Royal Purple'</i>	Lily Turf	0.4m	5/m2	140mm				423
LOM lon	<i>Lomandra longifolia</i>	Spiny Head Mat Rush	1m	5/m2	Tube stock	✓	✓	✓	699
LOM nya	<i>Lomandra longifolia 'Nyalla'</i>	Nyalla Lomandra	0.8m	5/m2 or 3/Lm	Tube stock			✓	994
OXA per	<i>Oxalis perennans</i>	Yellow Wood Sorrel	0.3m	3/m2	140mm	✓	✓	✓	375
PRA pur	<i>Eratia purpurascens</i>	White Root	0.15m	3/m2	140mm	✓	✓	✓	580
TRA fla	<i>Trachelospermum asiaticum 'Flat Mat'</i>	Star Jasmine	0.4m	3/m2	140mm			✓	164
VIO hed	<i>Viola hederacea</i>	Native Violet	0.2m	3/m2	140mm	✓	✓	✓	431
WES mun	<i>Westringia mundi</i>	Dwarf Coast Rosemary	0.4m	2/Lm	140mm			✓	183
Climbers									
PAN pan	<i>Pandorea pandorana</i>	Wonga Wonga Vine	2-20m	400mm centres	140mm	✓	✓	✓	45
Total						3636	6975		7808
Percentage of Locally Indigenous & Native Planting						47%	89%		

* Plants to be trimmed to heights indicated

**Quantities to be finalised during CC-Tender stage

***River Flat Eucalypt Forest Plant Community

Level 1 Plant Schedule									
Code	Botanical Name	Common Name	Mature Height	Spacing	Install Size	Locally Indigenous	Native	Low Water Use	Qty**
Trees									
ELA EUM	<i>Elaeocarpus eumundi</i>	Smooth Quandong	8m	As Shown	75L		✓	✓	2
LAG IND	<i>Lagerstroemia indica 'Natchez'</i>	White Crepe Myrtle	8m	As Shown	75L			✓	2
Shrubs									
ART cir	<i>Arthropodium cirratum</i>	New Zealand Rock Lily	0.8m	As Shown	200mm			✓	2
BUX mic	<i>Buxus microphylla</i>	Japanese Box	1m	As Shown	200mm				9
VIB odo	<i>Viburnum odoratissimum</i>	Sweet Viburnum	3m*	1000mm centres	300mm				8
Grasses & Groundcovers									
LIR mus	<i>Liriope muscari 'Royal Purple'</i>	Lily Turf	0.4m	5/m2	140mm				51
WES mun	<i>Westringia mundi</i>	Dwarf Coast Rosemary	0.4m	2/Lm	140mm		✓	✓	20
Total						50	26		94
Total Locally Indigenous & Native Planting						53%	28%		

* Plants to be trimmed to heights indicated

**Quantities to be finalised during CC-Tender stage

PLANT IMAGES



Drawing Title:
Planting Schedule & Imagery
DWG No: **SSD-12**

GEOSCAPES
LANDSCAPE ARCHITECTS
Suite 303, 8 Help St, Chatswood NSW 2067 Ph. (02) 9411 1485
www.geoscapes.com.au
ABN 84 620 205 781 ACN 620 205 781

Architect:
nettletontribe
architecture

Client:
maple tree

Scale:	Date:	Job Number:	North:	Revision		FOR SSD		
	13.09.2023	230301		Rev	Date	Description	Drawn	Checked
Project: Project Marvel 20 Kelso Crescent, Moorebank, NSW 2170				A	11.08.23	For SSD	PT/KC	BG
				B	07.09.23	For SSD	KC	BG
				C	11.09.23	For SSD	KC	BG
				D	13.09.23	For SSD	KC	BG

NOT FOR CONSTRUCTION