

Appendix B

Example Specifications for a Waste Collection Vehicle

REAR LIFT COLLECTION

THE REAR LIFT COLLECTION SYSTEM IS BEST SUITED TO SITES WITH **LIMITED ACCESS AND SPACE**.



CONTAINER SPECIFICATIONS

Plastic (polyethelene)

Capacity	120L	240L	660L	1100L
Height	0.92m	1.075m	1.235m	1.485m
Width	0.54m	0.58m	1.36m	1.36m
Length	0.62m	0.715m	0.765m	1.07m
Weight	9.5kg	13.5kg	45kg	65kg

*Availability of the complete suite of bin sizes varies across states. Sizes are approximate measurements and may vary by location.



SUPPORTED BY OUR NATIONAL NETWORK OF **SUSTAINABLE RESOURCE RECOVERY FACILITIES**, SITA AUSTRALIA'S COLLECTION SYSTEMS WILL HELP YOU SAVE ON DISPOSAL COSTS THROUGH **SERVICE EXCELLENCE AND REDUCING EXPOSURE TO LANDFILL LEVIES**.

BY ADOPTING SIMPLE AND RELIABLE COLLECTION SYSTEMS TAILORED TO THE WASTE GENERATION PROFILE OF YOUR BUSINESS, YOU CAN **IMPROVE CORPORATE RESPONSIBILITY AND BUILD ENVIRONMENTALLY SUSTAINABLE PERFORMANCE**.

OVERVIEW

- Best suited for lightweight and small to mid-sized waste volumes.
- Ideal for workshops, offices, restaurants and retail outlets.
- Suits businesses that generate odorous food wastes as the waste can be bagged and cleared daily.
- Perfect secondary partner for a primary Front Lift or Roll-on/Roll-off (RORO) system.
- Convenient range of standard containers from 120L to 1100L capacities.
- Bins are colour-coded to Australian Standards for easy identification of waste streams.
- Reduced labour costs when bin is located close to waste generation source.
- Easily manoeuvrable due to solid rubber wheels.
- Equally suitable for indoor or outdoor use.
- Carts can be supplied in a range of sizes ensuring flexibility and total compatibility with the customer's site.

CONTAINER OPTIONS AND ACCESSORIES

- Foot pedal operated lid
- Wheel locking device
- Range of bin sizes
- Tow hitches
- Flip top and roll top lids
- Wheel brakes
- Liners
- Security posts
- Cart cradle
- Waste ID labels
- Bin lifters
- Padlocks and chains



THE LEADER IN RESOURCE RECOVERY



SITA

REAR LIFT COLLECTION

VEHICLE SPECIFICATIONS

Overall length	8.0m
Overall width	2.5m
Height (travel)	3.4m
Height (in operation)	3.4m
Weight (vehicle only)	13.0t
Weight (payload)	9.5t
Turning circle	25.0m

** Vehicle specifications are approximate and may vary by location.



SITA's full range of collection services include:

- General waste
- Paper and cardboard
- Co-mingled recyclables (containers)
- Food and garden organics
- Electronic waste
- Batteries, globes and fluorescent tubes
- Metals
- Plastics
- Document destruction (confidential)
- Product destruction
- Untreated timber
- Construction waste
- Sanitary
- Quarantine waste
- Liquids
- Hazardous waste
- Medical/clinical waste

FOR MORE DETAILS CONTACT YOUR LOCAL SITA CUSTOMER SERVICE CENTRE ON 13 13 35

SITA IS COMMITTED TO ENSURING THAT ALL OF OUR OPERATIONS ARE CONDUCTED IN A MANNER THAT PROTECTS THE HEALTH AND SAFETY OF OUR EMPLOYEES, CUSTOMERS, CONTRACTORS, SUPPLIERS AND THE GENERAL PUBLIC, PROVIDING A SAFE AND HEALTHY WORKING ENVIRONMENT.

Printed on 100% recycled paper created entirely from post consumer waste, using vegetable oil based inks and an alcohol-free ISO 14001 certified printing process.



13 13 35 SITA.COM.AU
THE LEADER IN RESOURCE RECOVERY



Appendix C

Car Park Ramping Swept Path Assessments

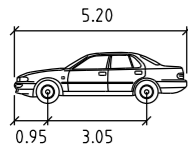

B99 6.3mR
 Width : 1.94 metres
 Track : 1.77
 Lock to Lock Time : 6.0
 Steering Angle : 34.0

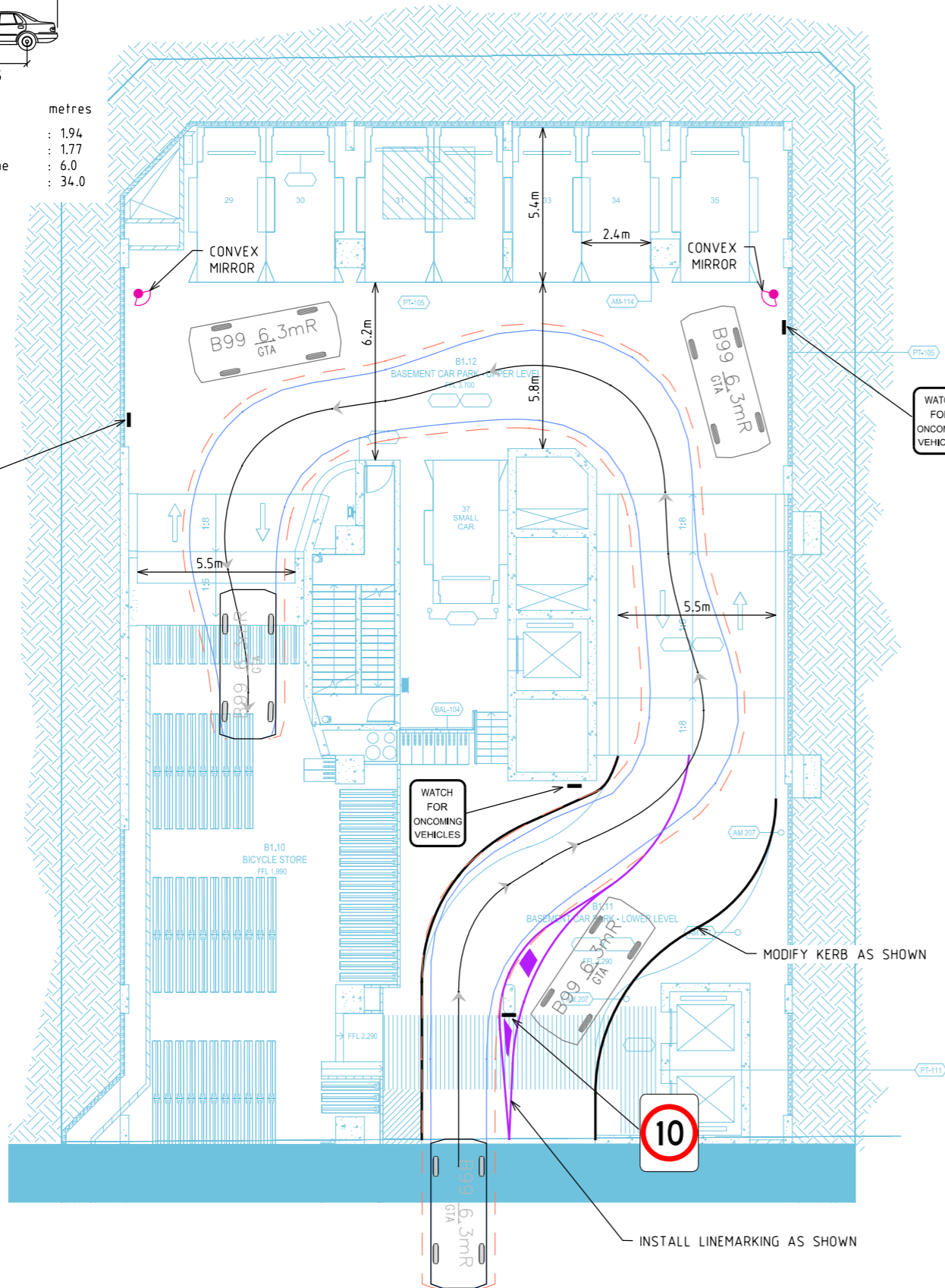

BASEMENT 1 - ACCESS & CIRCULATION

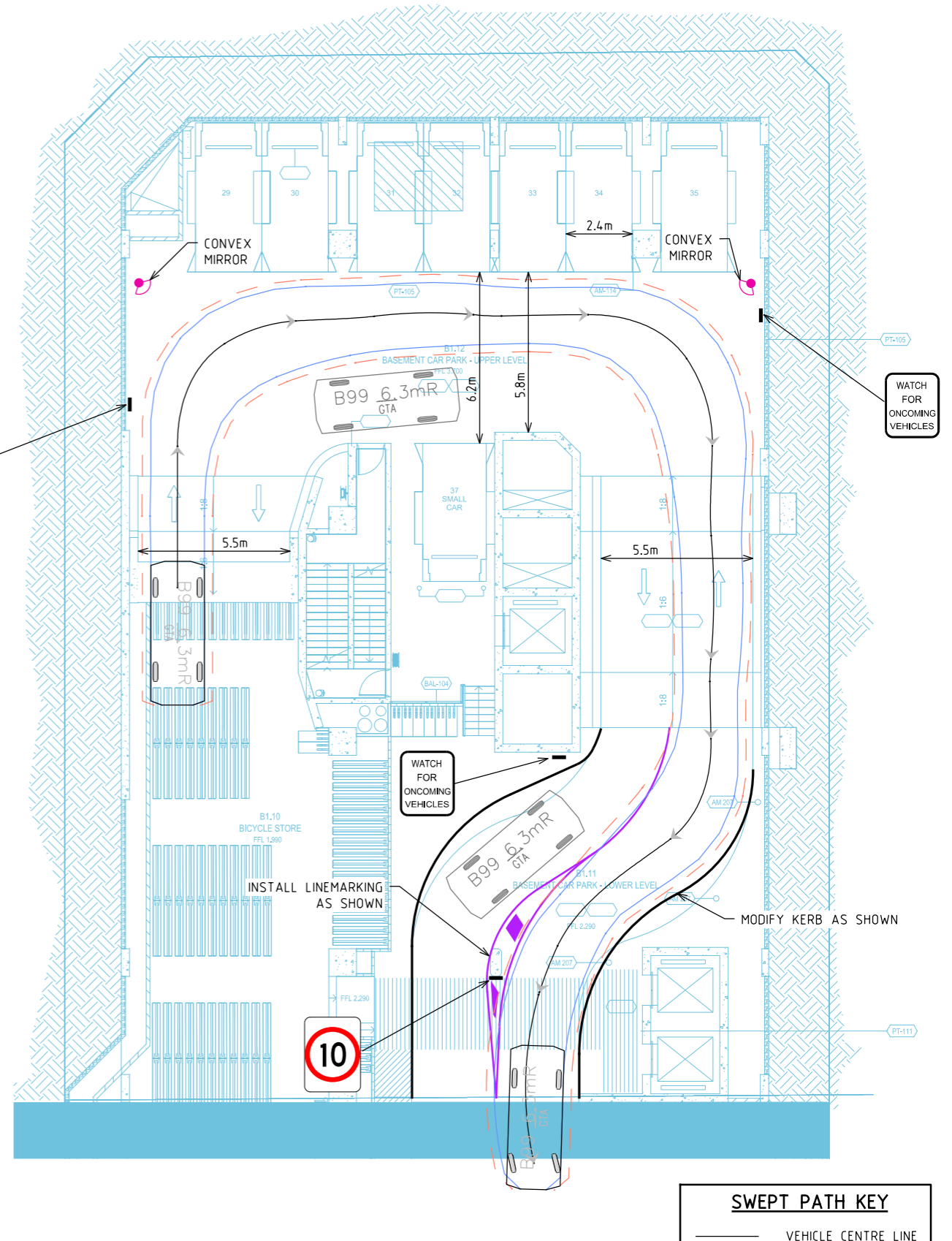

BASEMENT 1 - ACCESS & CIRCULATION

SWEEP PATH KEY	
	VEHICLE CENTRE LINE
	VEHICLE BODY PATH
	300mm CLEARANCE FROM VEHICLE BODY
ASSUMED SPEED 5km/h	

PLOTTED BY: Tom.Napierkowski ON: 5/11/2015 AT 11:37:48 AM 13S1213000-19-01-P5.dgn

Melbourne 03 9851 9600
 Sydney 02 8448 1800
 Brisbane 07 3113 5000
 Canberra 02 6243 9400
 Adelaide 08 8334 3600
 Gold Coast 07 5510 4814
 Townsville 07 4722 2765
 Perth 08 6316 4634



PRELIMINARY PLAN
 FOR DISCUSSION PURPOSES ONLY
 SUBJECT TO CHANGE WITHOUT
 NOTIFICATION

SHELL HOUSE - WYNARD PLACE
 BASEMENT 1
 B99 ACCESS & CIRCULATION SWEEP PATHS

DATE: 05.11.2015
 SCALE: 1:200@A3
 APPROVED: TDY
 DRAWING NO. 13S1213000-19-01-P5



SHEET: 01 OF 03

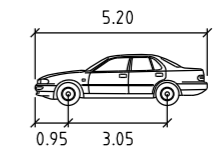

B99 6.3mR	metres
Width	: 1.94
Track	: 1.77
Lock to Lock Time	: 6.0
Steering Angle	: 34.0

SWEPT PATH KEY

- VEHICLE CENTRE LINE
- - VEHICLE TYRE PATH
- VEHICLE BODY PATH
- - 300mm CLEARANCE FROM VEHICLE BODY

ASSUMED SPEED 5km/h

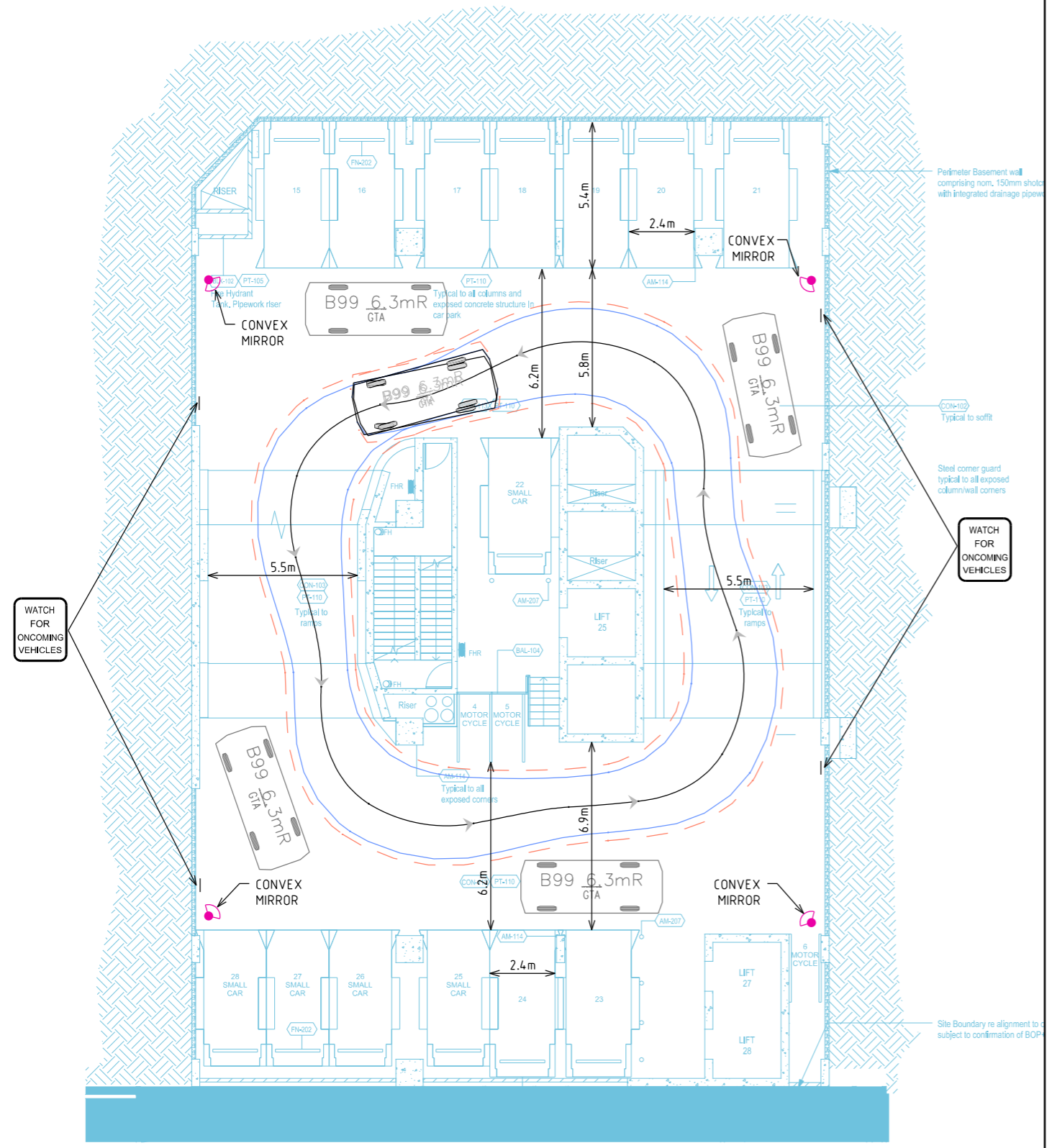

HUNTER CONCOURSE - CIRCULATION

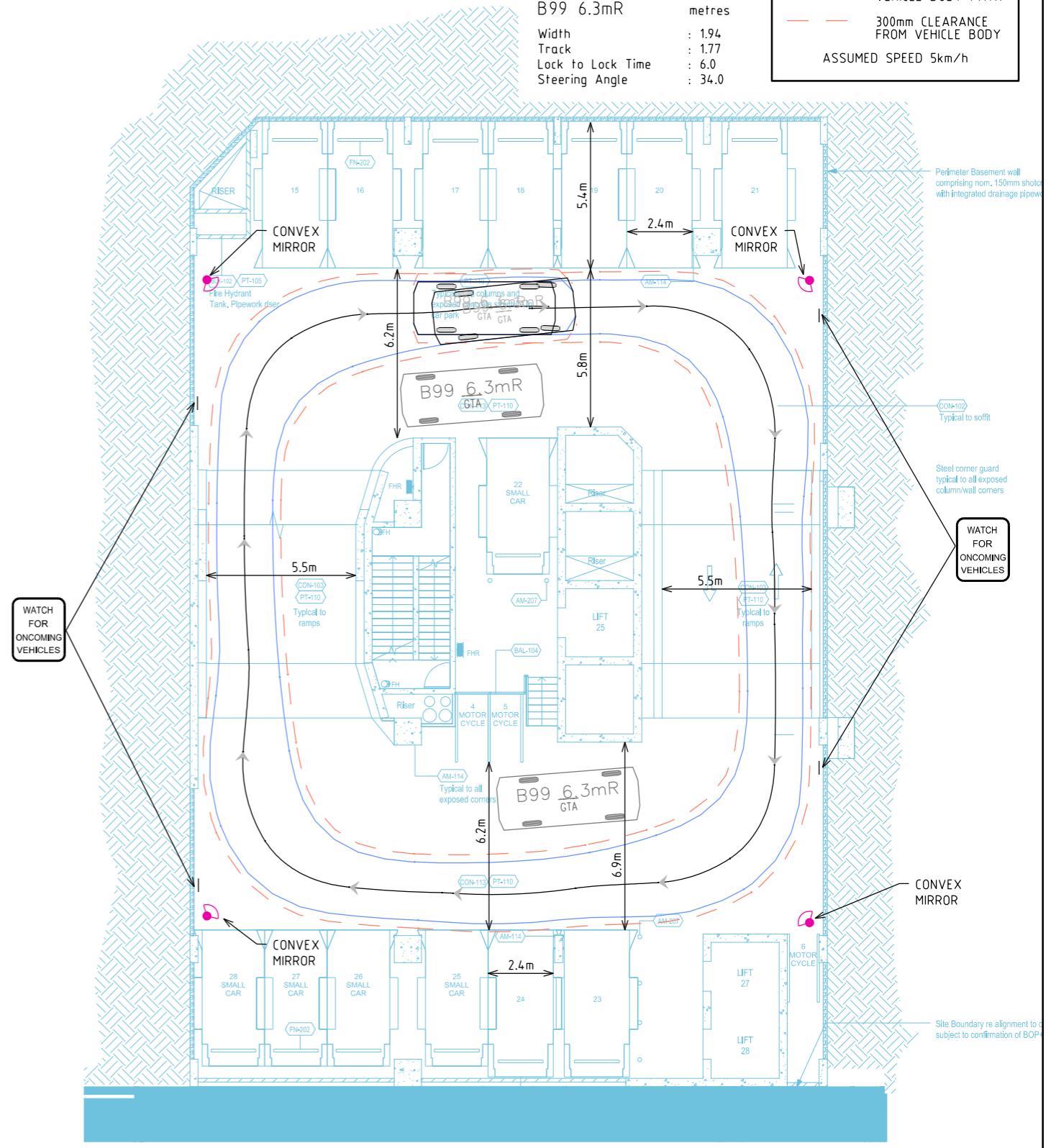

HUNTER CONCOURSE - CIRCULATION

PLOTTED BY: Tom.Napierkowski ON: 5/11/2015 AT 12:34:55 PM ISS: 13S1213000-19-02-P5.dgn

Melbourne 03 9851 9600
 Sydney 02 8448 1800
 Brisbane 07 3113 5000
 Canberra 02 6243 9400
 Adelaide 08 8334 3600
 Gold Coast 07 5510 4814
 Townsville 07 4722 2765
 Perth 08 6316 4634



PRELIMINARY PLAN
 FOR DISCUSSION PURPOSES ONLY
 SUBJECT TO CHANGE WITHOUT
 NOTIFICATION

SHELL HOUSE - WYNYARD PLACE
 HUNTER CONCOURSE
 B99 CIRCULATION SWEEP PATHS

DATE: 05.11.2015
 SCALE: 1:200@A3
 APPROVED: TDY
 DRAWING NO. 13S1213000-19-02-P5

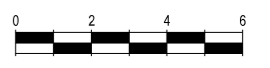

SHEET: 02 OF 03

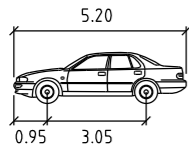

B99 6.3mR metres
 Width : 1.94
 Track : 1.77
 Lock to Lock Time : 6.0
 Steering Angle : 34.0

SWEEP PATH KEY	
	VEHICLE CENTRE LINE
	VEHICLE BODY PATH
	300mm CLEARANCE FROM VEHICLE BODY
ASSUMED SPEED 5km/h	

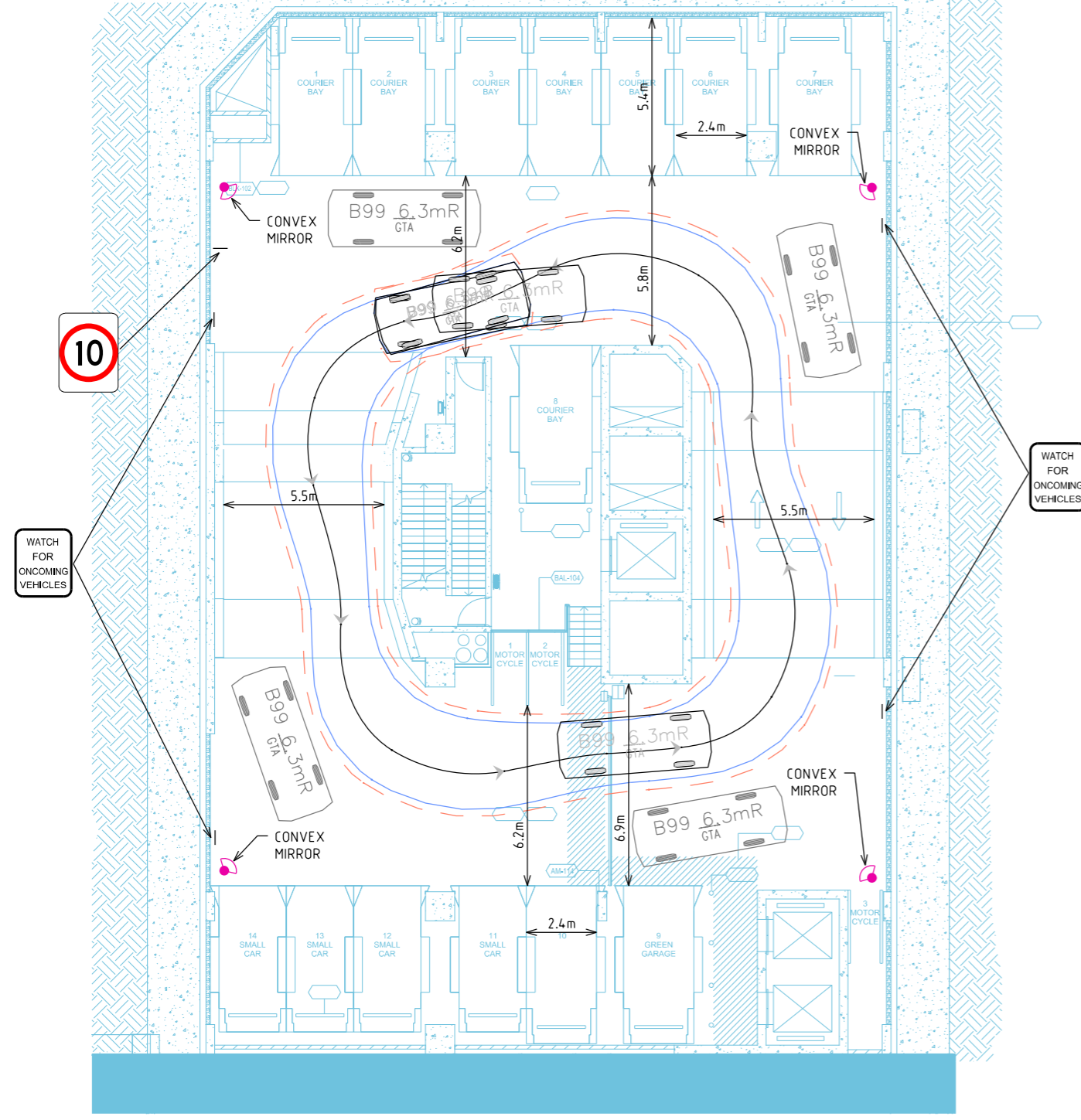

CONCOURSE - CIRCULATION

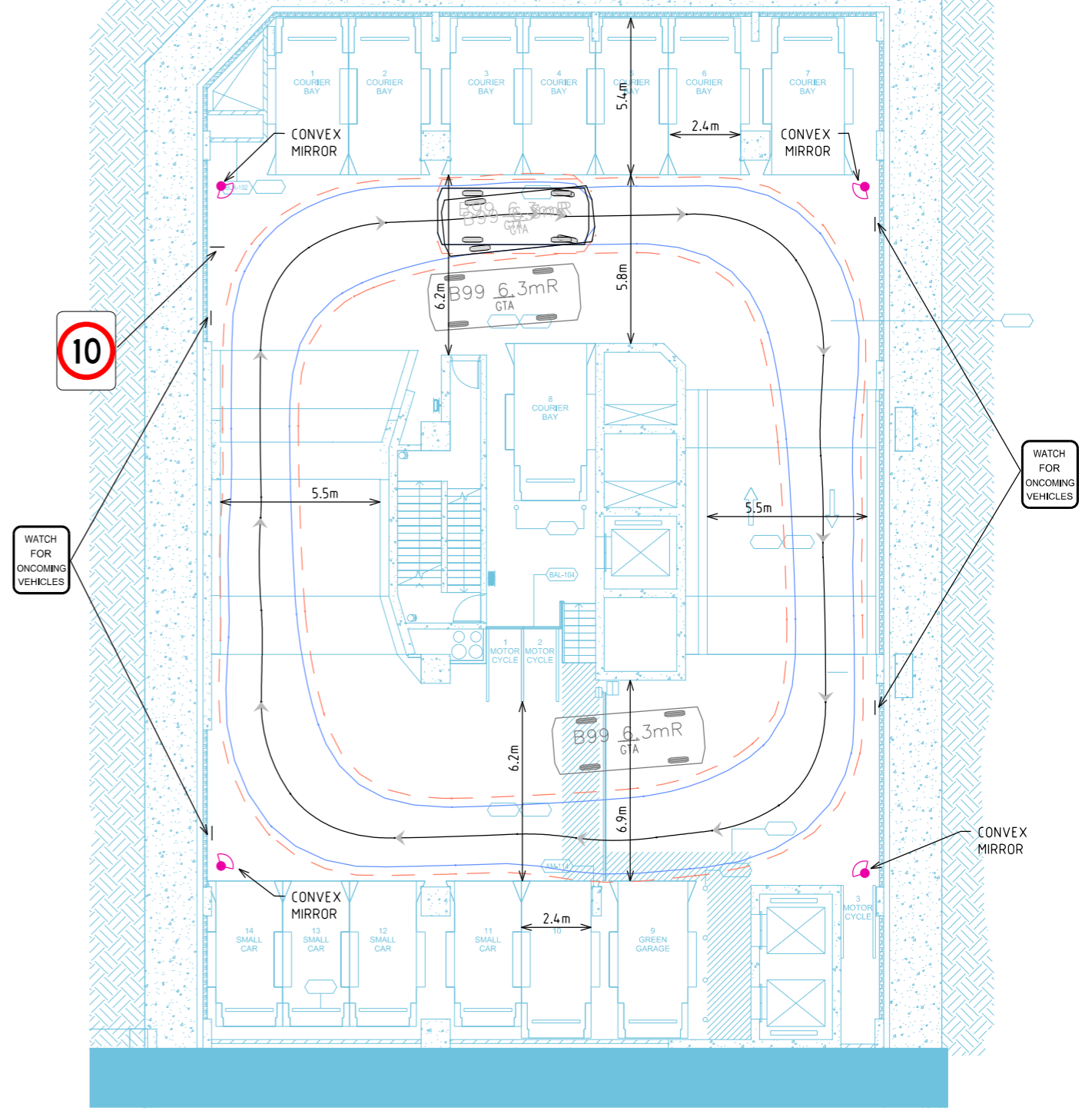

CONCOURSE - CIRCULATION

PLOTTED BY: Tom.Napierkowski ON: 5/11/2015 AT 12:35:06 PM 13S1213000-19-03-P5.dgn

Melbourne 03 9851 9600
 Sydney 02 8448 1800
 Brisbane 07 3113 5000
 Canberra 02 6243 9400
 Adelaide 08 8334 3600
 Gold Coast 07 5510 4814
 Townsville 07 4722 2765
 Perth 08 6316 4634



PRELIMINARY PLAN
 FOR DISCUSSION PURPOSES ONLY
 SUBJECT TO CHANGE WITHOUT
 NOTIFICATION

SHELL HOUSE - WYNARD PLACE
 CONCOURSE
 B99 CIRCULATION SWEEP PATHS

DATE: 05.11.2015 SCALE: 1:200@A3
 APPROVED: TDY DRAWING NO. 13S1213000-19-03-P5 SHEET: 03 OF 03

