

REFER TO EXHIBITION SERIES FOR CONTINUATION

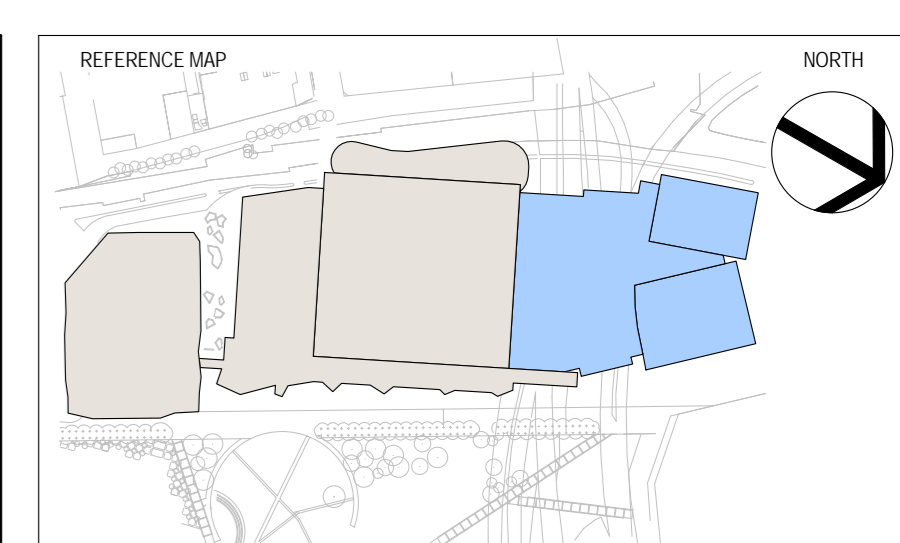

0 5 10 20m  
1:250

- NOTES
1. DO NOT SCALE DRAWINGS. WRITTEN DIMENSIONS GOVERN.
  2. ALL DIMENSIONS ARE IN MILLIMETRES UNLESS NOTED OTHERWISE.
  3. ALL DIMENSIONS SHALL BE VERIFIED ON SITE BEFORE PROCEEDING WITH THE WORK. HASSELL+POPULOUS SHALL BE NOTIFIED IN WRITING OF ANY DISCREPANCIES.
  4. THIS DRAWING MUST BE READ IN CONJUNCTION WITH ALL RELEVANT CONTRACTS, SPECIFICATIONS AND DRAWINGS.

© COPYRIGHT OF THIS DRAWING IS VESTED IN HASSELL+POPULOUS. 2013 HASSELL+POPULOUS PTY LTD  
THIS DRAWING IS AN UNCONTROLLED COPY UNLESS NOTED OTHERWISE.

| REV | DESCRIPTION                        | DATE     |
|-----|------------------------------------|----------|
| 1   | ISSUED FOR INFORMATION             | 09.05.13 |
| 2   | ISSUED FOR INFORMATION             | 17.05.13 |
| 3   | ISSUED FOR INFORMATION             | 23.05.13 |
| 4   | ISSUED FOR INFORMATION             | 06.06.13 |
| A   | ISSUED FOR DEVELOPMENT APPLICATION | 24.06.13 |
| 5   | DS1 PLANNING FREEZE                | 01.07.13 |
| 6   | ISSUED FOR DS1                     | 11.07.13 |
| 7   | ISSUED FOR DS1                     | 24.07.13 |
| 8   | CURTAIN WALL AFT ISSUE             | 25.07.13 |
| 9   | ISSUED FOR INFORMATION             | 13.08.13 |
| 10  | ISSUED FOR INFORMATION             | 30.08.13 |
| 11  | ISSUED FOR INFORMATION             | 06.09.13 |
| 12  | ISSUED FOR INFORMATION             | 24.09.13 |
| 13  | ISSUED FOR INFORMATION             | 01.10.13 |
| 14  | ISSUED FOR INFORMATION             | 04.10.13 |
| 15  | ISSUED FOR INFORMATION             | 22.10.13 |
| 16  | ISSUED FOR REVIEW                  | 05.11.13 |
| 17  | ISSUED FOR INFORMATION             | 06.11.13 |
| 18  | ISSUED FOR SERVICES INFORMATION    | 11.11.13 |
| 19  | ISSUED FOR INFORMATION             | 12.11.13 |
| B   | ISSUED FOR SECTION 96 APPLICATION  | 04.12.13 |

ARCHITECT - PRINCIPAL DESIGN CONSULTANT  
**HASSELL+POPULOUS**  
HASSELL + POPULOUS PTY LTD ABN 3454979317  
LEVEL 2, PIER 8/9  
23 HICKSON ROAD  
SYDNEY NSW 2000 AUSTRALIA  
T +61 2 9101 2000 F +61 2 9101 2100

- CONSULTANTS
- Robert Bird Group** STRUCTURAL SERVICES  
LEVELS 1, 9 CASTLEREAGH ST, SYDNEY NSW 2000 (02) 9334 3000
  - AECOM** BUILDING / ENVIRONMENTAL SERVICES  
LEVEL 2, 425 GEORGE ST, SYDNEY NSW 2000 (02) 9334 0000
  - ARMIS** HYDRAULIC SERVICES  
LEVEL 2, 24 HICKSON RD, MILLERS POINT NSW 2000 (02) 8038 8370
  - Hyder** CIVIL / TRAFFIC SERVICES  
31/41 MALDEN ST, NORTH SYDNEY NSW 2000 (02) 8907 9000

CLIENT  
**Lend Lease**  
LEND LEASE BUILDING PTY LTD  
LEVEL 4, THE BOND, 20 HICKSON RD  
MILLERS POINT, NSW 2000  
(02) 9236 6111

PROJECT  
**SICEEP\_DARLING HARBOUR**  
ICC

DRAWING TITLE  
**GA PLANS - LOBBY**

LEVEL 0  
RL 3.5

STATUS  
**SECTION 96**

SCALE @ A1 (50% @ A2) DRAWN: LM CO-ORD: DH REVIEWED: MD APPROVED: GS  
PROJECT NUMBER: 003688 DRAWING NUMBER: CO\_AR\_D\_200000 REV: B

**FOR APPROVAL**

C:\Users\pope\Documents\003688\_CO\_AR\_D\_200000.dwg 11/20/2013 5:27:29 PM

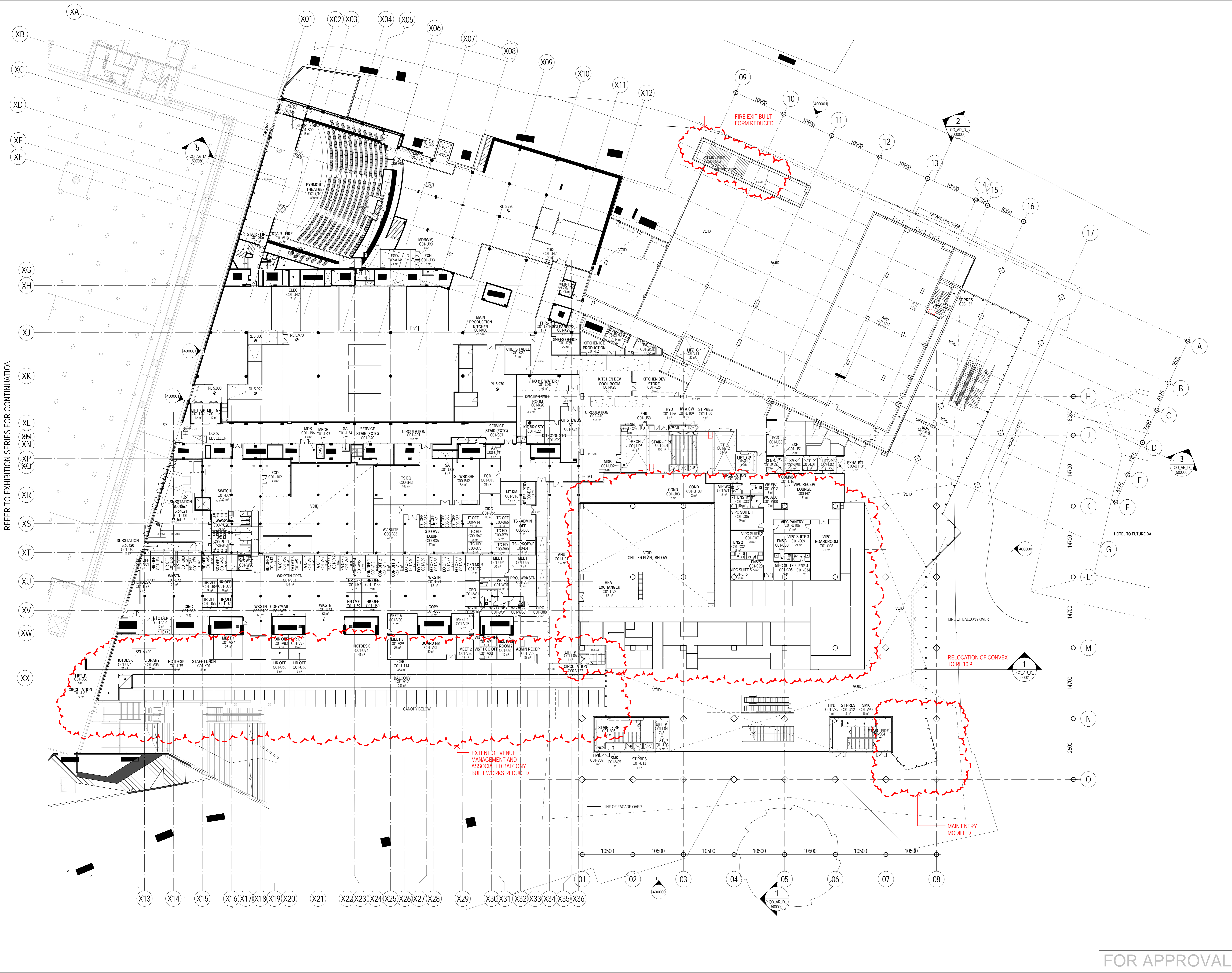

REFER TO EXHIBITION SERIES FOR CONTINUATION

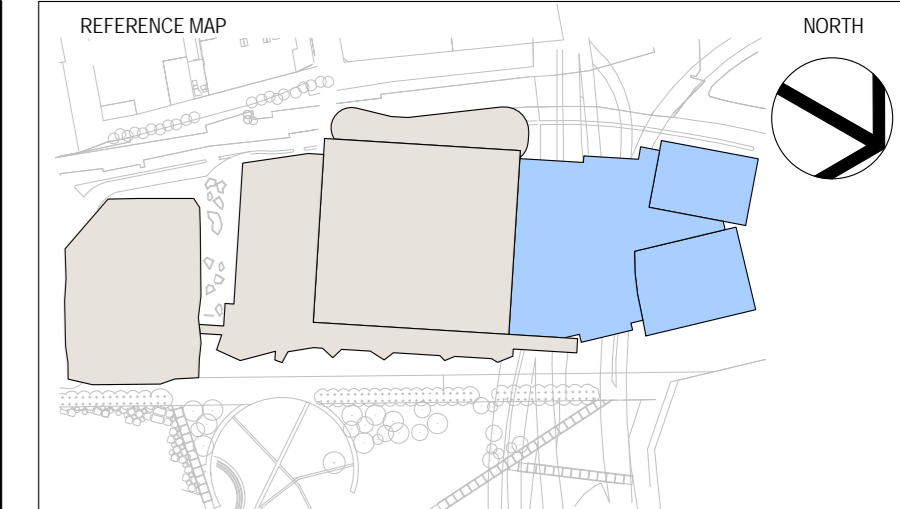

- NOTES
1. DO NOT SCALE DRAWINGS. WRITTEN DIMENSIONS GOVERN.
  2. ALL DIMENSIONS ARE IN MILLIMETRES UNLESS NOTED OTHERWISE.
  3. ALL DIMENSIONS SHALL BE VERIFIED ON SITE BEFORE PROCEEDING WITH THE WORK. HASSELL+POPULOUS SHALL BE NOTIFIED IN WRITING OF ANY DISCREPANCIES.
  4. THIS DRAWING MUST BE READ IN CONJUNCTION WITH ALL RELEVANT CONTRACTS, SPECIFICATIONS AND DRAWINGS.

© COPYRIGHT OF THIS DRAWING IS HELD BY HASSELL+POPULOUS. 2013 HASSELL+POPULOUS PTY LTD

THIS DRAWING IS AN UNCONTROLLED COPY UNLESS NOTED OTHERWISE

| REV | DESCRIPTION                        | DATE     |
|-----|------------------------------------|----------|
| 1   | ISSUED FOR INFORMATION             | 09.05.13 |
| 2   | ISSUED FOR INFORMATION             | 17.05.13 |
| 3   | ISSUED FOR INFORMATION             | 23.05.13 |
| 4   | ISSUED FOR INFORMATION             | 06.06.13 |
| A   | ISSUED FOR DEVELOPMENT APPLICATION | 24.06.13 |
| 5   | DS1 PLANNING FREEZE                | 01.07.13 |
| 6   | ISSUED FOR DS1                     | 11.07.13 |
| 7   | ISSUED FOR DS1                     | 24.07.13 |
| 8   | CURTAIN WALL AFT ISSUE             | 25.07.13 |
| 9   | ISSUED FOR INFORMATION             | 13.08.13 |
| 10  | ISSUED FOR INFORMATION             | 30.08.13 |
| 11  | ISSUED FOR INFORMATION             | 06.09.13 |
| 12  | ISSUED FOR INFORMATION             | 24.09.13 |
| 13  | ISSUED FOR INFORMATION             | 01.10.13 |
| 14  | ISSUED FOR INFORMATION             | 04.10.13 |
| 15  | ISSUED FOR INFORMATION             | 22.10.13 |
| 16  | ISSUED FOR REVIEW                  | 05.11.13 |
| 17  | ISSUED FOR INFORMATION             | 08.11.13 |
| 18  | ISSUED FOR SERVICES INFORMATION    | 11.11.13 |
| 19  | ISSUED FOR INFORMATION             | 12.11.13 |
| B   | ISSUED FOR SECTION 96 APPLICATION  | 04.12.13 |

ARCHITECT - PRINCIPAL DESIGN CONSULTANT  
**HASSELL+POPULOUS**  
 HASSELL + POPULOUS PTY LTD ABN 3454197317  
 LEVEL 2, PIER 8/9  
 23 HICKSON ROAD  
 SYDNEY NSW 2000 AUSTRALIA  
 T +61 2 9101 2000 F +61 2 9101 2100

- CONSULTANTS
- RobertIRDGroup**  
STRUCTURAL SERVICES  
LEVEL 5, 9 CASTLEREAGH ST, SYDNEY  
NSW 2000  
(02) 8246 3000
  - AECOM**  
BUILDING / ENVIRONMENTAL SERVICES  
LEVEL 2, 425 GEORGE ST, SYDNEY  
NSW 2000  
(02) 9334 0000
  - ARMIS**  
HYDRAULIC SERVICES  
LEVEL 2, 425 GEORGE ST, MILLERS POINT  
NSW 2000  
(02) 8038 8370
  - Hyder**  
CIVIL / TRAFFIC SERVICES  
5/14 HAWKER ST, NORTH SYDNEY  
NSW 2060  
(02) 8907 9000

CLIENT  
**Lend Lease**  
 LEND LEASE BUILDING PTY LTD  
 LEVEL 4, THE BOND, 20 HICKSON RD  
 MILLERS POINT, NSW 2000  
 (02) 9236 6111

PROJECT  
**SICEEP\_DARLING HARBOUR  
 ICC**

DRAWING TITLE  
**GA PLANS - VENUE MANAGEMENT**

LEVEL 1  
 RL 7.2

STATUS  
**SECTION 96**

SCALE @ A3 (50% @ A2) DRAWN: LM CO-ORD: DH REVIEWED: GS APPROVED: GS

PROJECT NUMBER: 003688 DRAWING NUMBER: CO\_AR\_D\_201000 REV: B

**FOR APPROVAL**

Original Sheet Size: A0 - 1189 x 841mm

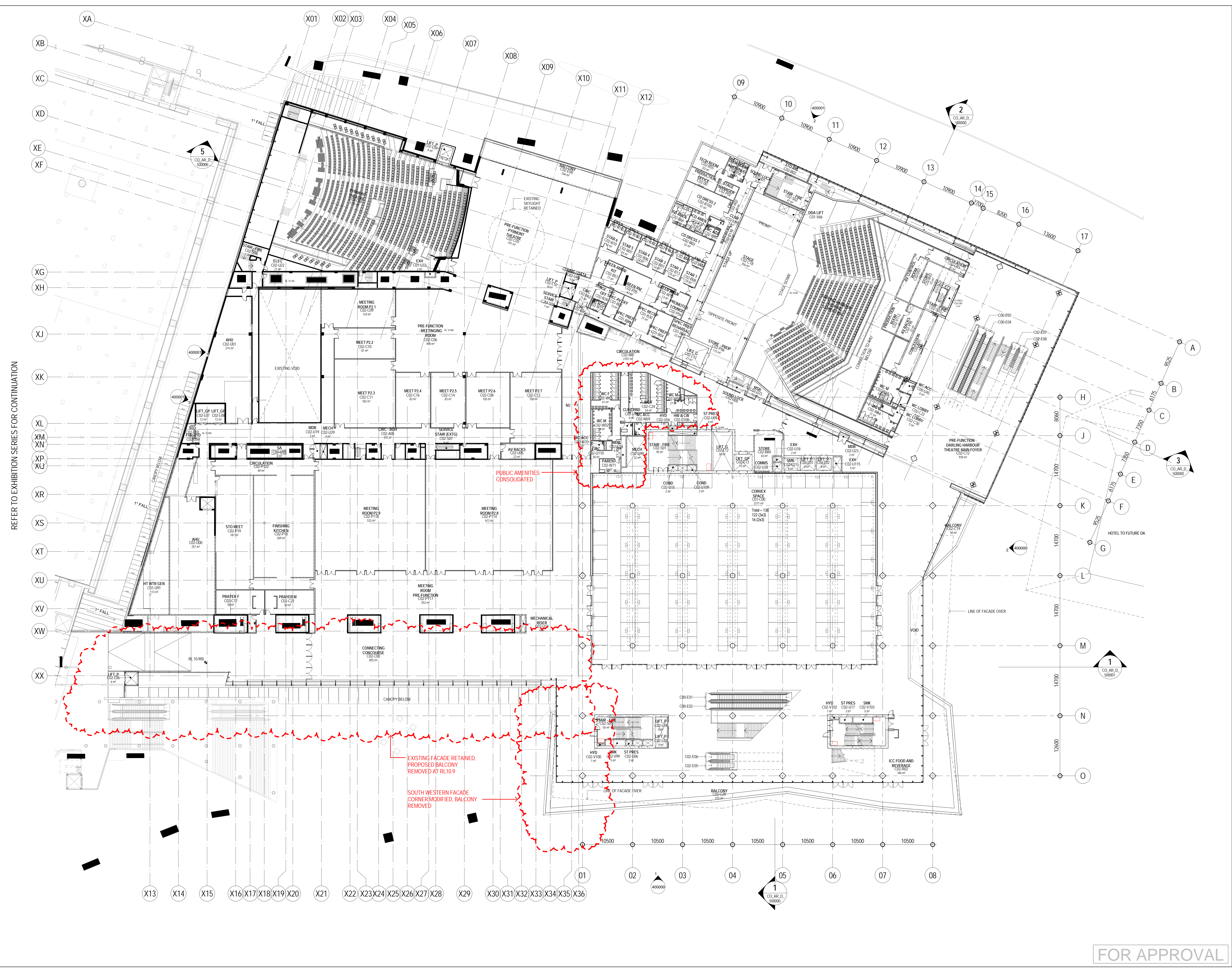

REFER TO EXHIBITION SERIES FOR CONTINUATION

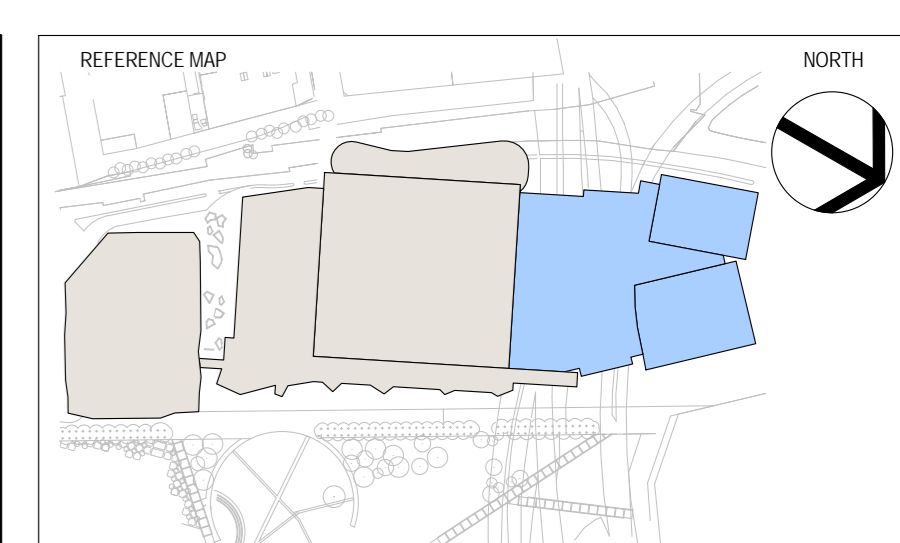

NOTES

- DO NOT SCALE DRAWINGS. WRITTEN DIMENSIONS GOVERN.
- ALL DIMENSIONS ARE IN MILLIMETRES UNLESS NOTED OTHERWISE.
- ALL DIMENSIONS SHALL BE VERIFIED ON SITE BEFORE PROCEEDING WITH THE WORK. HASSELL+POPULOUS SHALL BE NOTIFIED IN WRITING OF ANY DISCREPANCIES.
- THIS DRAWING MUST BE READ IN CONJUNCTION WITH ALL RELEVANT CONTRACTS, SPECIFICATIONS AND DRAWINGS.

© COPYRIGHT OF THIS DRAWING IS VESTED IN HASSELL+POPULOUS. 2013 HASSELL+POPULOUS PTY LTD

THIS DRAWING IS AN UNCONTROLLED COPY, UNLESS NOTED OTHERWISE.

| REV | DESCRIPTION                        | DATE     |
|-----|------------------------------------|----------|
| 1   | ISSUED FOR INFORMATION             | 09.05.13 |
| 2   | ISSUED FOR INFORMATION             | 17.05.13 |
| 3   | ISSUED FOR INFORMATION             | 23.05.13 |
| 4   | ISSUED FOR INFORMATION             | 06.06.13 |
| A   | ISSUED FOR DEVELOPMENT APPLICATION | 24.06.13 |
| 5   | DS1 PLANNING FREEZE                | 01.07.13 |
| 6   | ISSUED FOR DS1                     | 11.07.13 |
| 7   | ISSUED FOR DS1                     | 24.07.13 |
| 8   | CURTAIN WALL AFT ISSUE             | 25.07.13 |
| 9   | ISSUED FOR INFORMATION             | 13.08.13 |
| 10  | ISSUED FOR INFORMATION             | 30.08.13 |
| 11  | ISSUED FOR INFORMATION             | 06.09.13 |
| 12  | ISSUED FOR INFORMATION             | 24.09.13 |
| 13  | ISSUED FOR INFORMATION             | 01.10.13 |
| 14  | ISSUED FOR INFORMATION             | 04.10.13 |
| 15  | ISSUED FOR INFORMATION             | 22.10.13 |
| 16  | ISSUED FOR REVIEW                  | 05.11.13 |
| 17  | ISSUED FOR INFORMATION             | 06.11.13 |
| 18  | ISSUED FOR SERVICES INFORMATION    | 11.11.13 |
| 19  | ISSUED FOR INFORMATION             | 12.11.13 |
| B   | ISSUED FOR SECTION 96 APPLICATION  | 04.12.13 |

| ARCHITECT               | PRINCIPAL DESIGN CONSULTANT   |
|-------------------------|---|
| <b>HASSELL+POPULOUS</b> | HASSELL + POPULOUS PTY LTD ABN 3461679317<br>LEVEL 2, PIER 8/9<br>23 HICKSON ROAD<br>SYDNEY NSW 2000 AUSTRALIA<br>T +61 2 9101 2000 F +61 2 9101 2100 |
| CONSULTANTS             |   |
| <b>RobertIRDGroup</b>   | STRUCTURAL SERVICES<br>LEVEL 5, 9 CASTLEREAGH ST, SYDNEY<br>NSW 2000<br>(02) 8246 3000  |
| <b>AECOM</b>            | BUILDING / ENVIRONMENTAL SERVICES<br>LEVEL 21, 420 GEORGE ST, SYDNEY<br>NSW 2000<br>(02) 9334 0000  |
| <b>C.J. ARMIB</b>       | HYDRAULIC SERVICES<br>S1141 WALKER ST, MILLERS POINT<br>NSW 2000<br>(02) 8036 8370  |
| <b>Hyder</b>            | CIVIL / TRAFFIC SERVICES<br>S1141 WALKER ST, NORTH SYDNEY<br>NSW 2000<br>(02) 8907 9000   |
| CLIENT                  |   |
| <b>Lend Lease</b>       | LEND LEASE BUILDING PTY LTD<br>LEVEL 4, THE BOND, 30 HICKSON RD<br>MILLERS POINT, NSW 2000<br>(02) 9236 6111  |
| PROJECT                 | SICEEP_DARLING HARBOUR<br>ICC   |
| DRAWING TITLE           | GA PLANS - PLENARY 1 - 2<br>LEVEL 2<br>RL 10.9  |
| STATUS                  | SECTION 96  |
| SCALE                   | AS SHOWN @ A2   |
| PROJECT NUMBER          | 003688  |
| DRAWING NUMBER          | CO_AR_D_202000  |
| REV                     | B   |

FOR APPROVAL

Original Sheet Size: A0 - 1189 x 841mm

REFER TO EXHIBITION SERIES FOR CONTINUATION

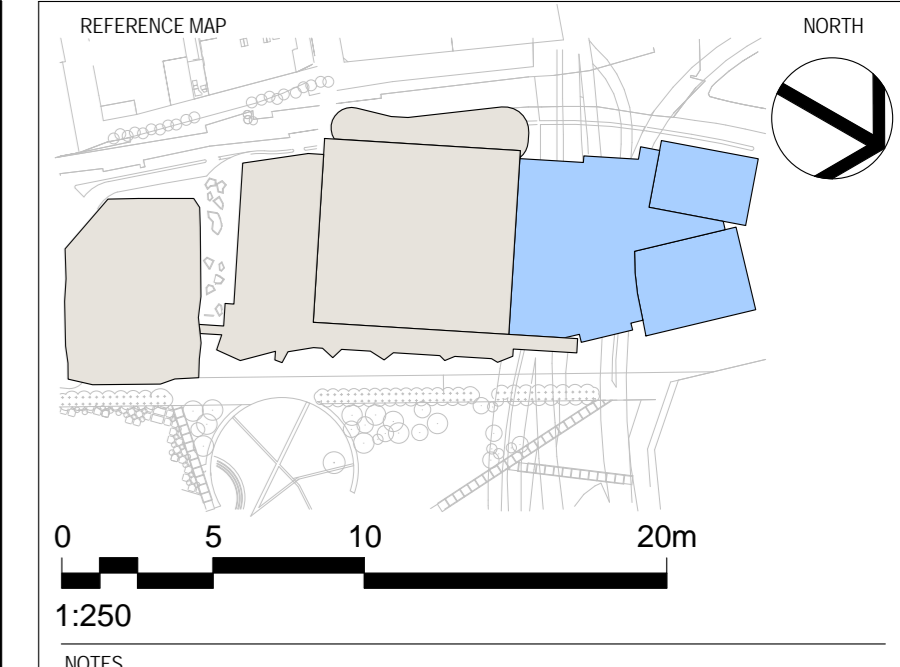
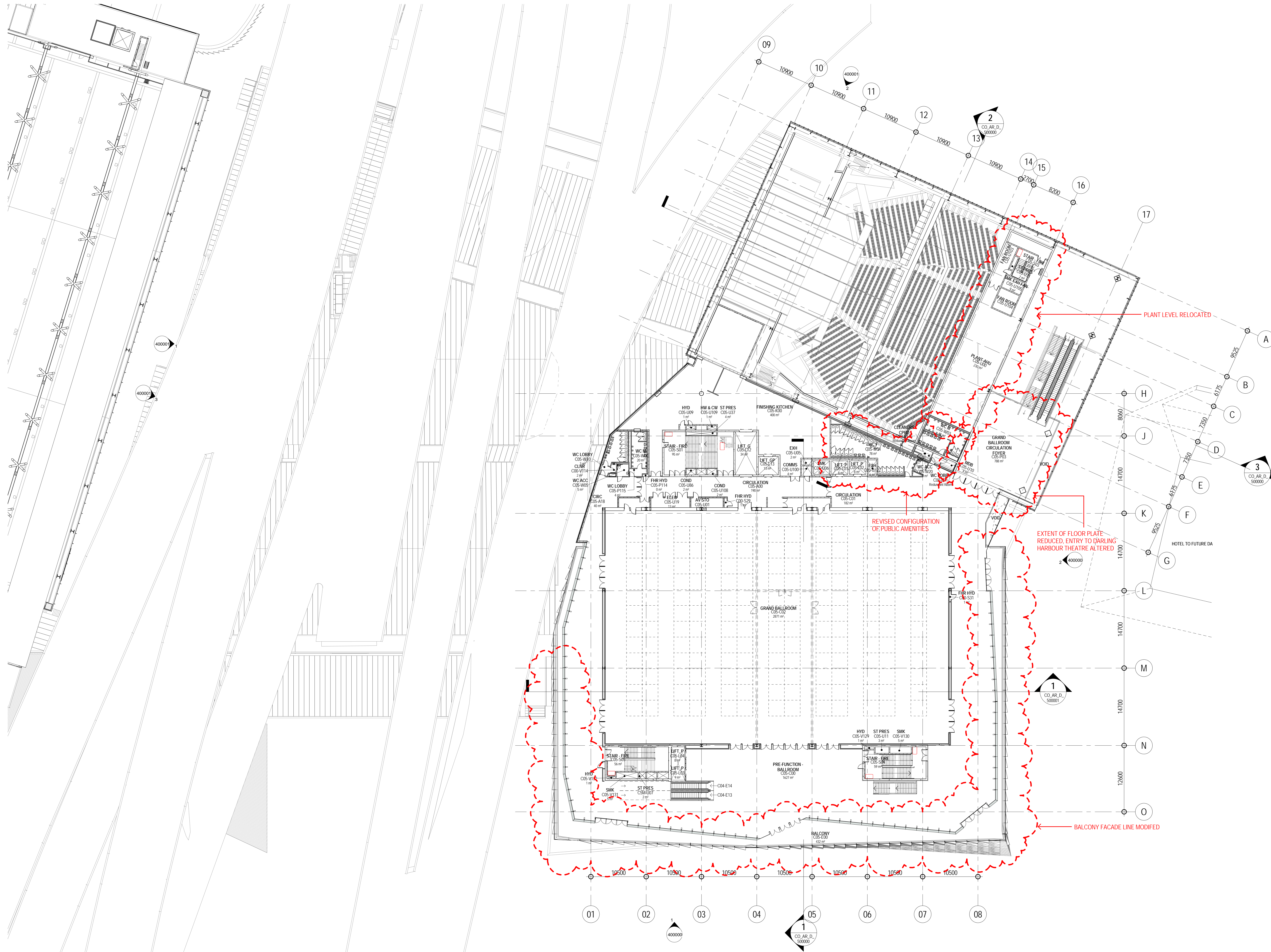

- NOTES
1. DO NOT SCALE DRAWINGS. WRITTEN DIMENSIONS GOVERN.
  2. ALL DIMENSIONS ARE IN MILLIMETRES UNLESS NOTED OTHERWISE.
  3. ALL DIMENSIONS SHALL BE VERIFIED ON SITE BEFORE PROCEEDING WITH THE WORK. HASSELL+POPULOUS SHALL BE NOTIFIED IN WRITING OF ANY DISCREPANCIES.
  4. THIS DRAWING MUST BE READ IN CONJUNCTION WITH ALL RELEVANT CONTRACTS, SPECIFICATIONS AND DRAWINGS.

© COPYRIGHT OF THIS DRAWING IS VESTED IN HASSELL+POPULOUS. 2013 HASSELL+POPULOUS PTY LTD  
THIS DRAWING IS AN UNCONTROLLED COPY UNLESS NOTED OTHERWISE.

| REV | DESCRIPTION                        | DATE     |
|-----|------------------------------------|----------|
| 1   | ISSUED FOR INFORMATION             | 06.06.13 |
| 2   | ISSUED FOR INFORMATION             | 17.05.13 |
| 3   | ISSUED FOR INFORMATION             | 23.05.13 |
| 4   | ISSUED FOR INFORMATION             | 06.06.13 |
| A   | ISSUED FOR DEVELOPMENT APPLICATION | 24.06.13 |
| 5   | DS1 PLANNING FREEZE                | 01.07.13 |
| 6   | ISSUED FOR DS1                     | 11.07.13 |
| 7   | ISSUED FOR DS1                     | 24.07.13 |
| 8   | CURTAIN WALL AFT ISSUE             | 25.07.13 |
| 9   | ISSUED FOR INFORMATION             | 13.08.13 |
| 10  | ISSUED FOR INFORMATION             | 30.08.13 |
| 11  | ISSUED FOR INFORMATION             | 06.09.13 |
| 12  | ISSUED FOR INFORMATION             | 24.09.13 |
| 13  | ISSUED FOR INFORMATION             | 01.10.13 |
| 14  | ISSUED FOR INFORMATION             | 04.10.13 |
| 15  | ISSUED FOR INFORMATION             | 25.10.13 |
| 16  | ISSUED FOR REVIEW                  | 05.11.13 |
| 17  | ISSUED FOR INFORMATION             | 06.11.13 |
| 18  | ISSUED FOR SERVICES INFORMATION    | 11.11.13 |
| 19  | ISSUED FOR INFORMATION             | 12.11.13 |
| B   | ISSUED FOR SECTION 96 APPLICATION  | 04.12.13 |

ARCHITECT - PRINCIPAL DESIGN CONSULTANT  
**HASSELL+POPULOUS**  
HASSELL + POPULOUS PTY LTD ABN 3461979317  
LEVEL 2, PIER 8/9  
23 HICKSON ROAD  
SYDNEY NSW 2000 AUSTRALIA  
T +61 2 9101 2000 F +61 2 9101 2100

- CONSULTANTS
- Robert Bird Group** STRUCTURAL SERVICES  
LEVEL 5, 9 CASTLEREAGH ST, SYDNEY NSW 2000 (02) 8246 3000
  - AECOM** BUILDING / ENVIRONMENTAL SERVICES  
LEVEL 2, 420 GEORGE ST, SYDNEY NSW 2000 (02) 9334 0000
  - C.J. ARMES** HYDRAULIC SERVICES  
LEVEL 2, 9-24 HICKSON RD, MILLERS POINT NSW 2000 (02) 8036 8370
  - Hyder** CIVIL / TRAFFIC SERVICES  
51/41 WALKER ST, NORTH SYDNEY NSW 2000 (02) 8907 9000

CLIENT  
**Lend Lease**  
LEND LEASE BUILDING PTY LTD  
LEVEL 4, THE BOND, 20 HICKSON RD  
MILLERS POINT, NSW 2000 (02) 9236 6111

PROJECT  
**SICEEP\_DARLING HARBOUR**  
ICC

DRAWING TITLE  
**GA PLANS - THE GRAND BALLROOM**

**LEVEL 5**  
**RL 32**  
STATUS  
**SECTION 96**

| SCALE          | DRAWN          | CO.ORD | REVIEWED | APPROVED |
|----------------|----------------|--------|----------|----------|
| 1 : 250        | LM             | DH     | GS       | GS       |
| PROJECT NUMBER | DRAWING NUMBER | REV    |          |          |
| 003688         | CO_AR_D_208000 | B      |          |          |

FOR APPROVAL

C:\Users\pope\Documents\003688\_CO\_AR\_IBB.dwg 17/12/2013 4:39:21 PM