

NOTES

- PLEASE REFER TO DRAWING PP-CI-0150 FOR EXTENT OF CONSTRUCTION EXCAVATIONS WITHIN THE PPP SITE BOUNDARY.
- PLEASE REFER TO DRAWINGS PP-CI-0101 TO PP-CI-0112 FOR CONSTRUCTION STAGING PHASES FOR THE PPP DEVELOPMENT.
- THE CONTRACTOR AND ALL SUBCONTRACTORS TO ENSURE THAT ALL SEDIMENT & EROSION CONTROLS ARE TO BE IN ACCORDANCE WITH LANDCOM: MANAGING URBAN STORMWATER: SOILS AND CONSTRUCTION VOLUME 1: 4TH EDITION MARCH 2004, ALSO KNOWN AS "THE BLUE BOOK".
- SEDIMENT CONTROL FENCES AND BARRIERS TO BE INSTALLED AROUND CONSTRUCTION STAGING PERIMETERS IN ACCORDANCE WITH COUNCIL REQUIREMENTS.
- ALL SUBCONTRACTORS TO BE INFORMED OF THEIR RESPONSIBILITIES IN MINIMISING THE POTENTIAL FOR SOIL EROSION AND POLLUTION TO DOWNSLOPE AREAS.
- WHERE PRACTICABLE, THE SOIL EROSION HAZARD ON THE SITE WILL BE KEPT AS LOW AS POSSIBLE AND AS RECOMMENDED BY THE CONTRACTOR.
- EROSION AND SEDIMENT CONTROLS TO BE INSTALLED ON INLET PITS, IN ACCORDANCE WITH COUNCIL REQUIREMENTS E.G. MESH & GRAVEL FILTERS, GEOTEXTILE INLET FILTERS ETC.
- CONSTRUCT LOW FLOW EARTH BANKS WHERE REQUIRED, IN ACCORDANCE WITH COUNCIL REQUIREMENTS.
- CONSTRUCT STABILISED SITE ACCESSES WHERE NECESSARY, IN ACCORDANCE WITH COUNCIL REQUIREMENTS.
- ALL STOCKPILES TO BE LOCATED CLEAR OF ALL POSSIBLE AREAS OF CONCENTRATED WATER FLOW, AND TO BE CONTAINED WITHIN A SEDIMENT FENCE.
- STOCKPILES TO BE COVERED WHERE NECESSARY.
- ALL WHEEL AND EQUIPMENT WASHING FACILITIES TO BE CONTAINED TO SPECIFIC BUNDED WASH AREAS.
- ALL FUEL AND CHEMICALS TO BE SAFELY STORED TO PREVENT CONTAMINATION FROM SPILLAGES.

LEGEND

- EXTENT OF DARLING DRIVE CONSTRUCTION
- EXTENT OF BUILDINGS CONSTRUCTION
- EXTENT OF PUBLIC REALM CONSTRUCTION

DARLING HARBOUR LIVE

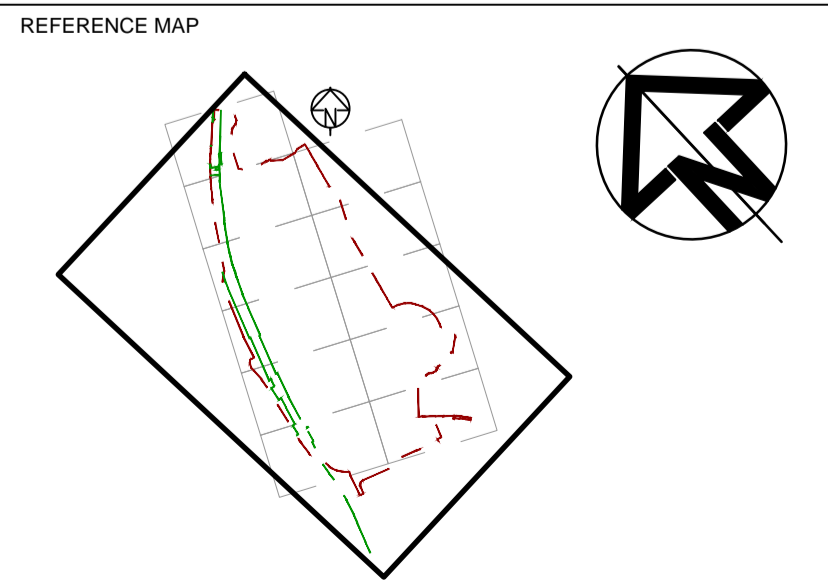

NOTES:

- DO NOT SCALE FROM DRAWINGS. WORK TO WRITTEN DIMENSIONS ONLY.
- ALL DIMENSIONS IN METRES UNLESS NOTED OTHERWISE.
- ALL COORDINATES TO MGA. ALL LEVELS TO AHD.
- ALL DIMENSIONS, COORDINATES AND LEVELS TO BE VERIFIED ON SITE BEFORE PROCEEDING WITH WORK. HYDER SHALL BE NOTIFIED IN WRITING OF ANY DISCREPANCIES.
- THIS DRAWING MUST BE READ IN CONJUNCTION WITH ALL RELEVANT CONTRACTS, SPECIFICATIONS AND DRAWINGS.
- PRECINCT BOUNDARIES ARE INDICATIVE ONLY AND ARE SUBJECT TO CHANGE.

0 20 40 60 80 100m
1 : 1000

REV	DESCRIPTION	DATE
A	ISSUE FOR DEVELOPMENT APPLICATION	14/03/2013

CLIENT
Lend Lease
 PROJECT MANAGEMENT & CONSTRUCTION
 LEVEL 4, THE BOND, 30 HICKSON RD
 MILLERS POINT, NSW 2000

CONSULTANTS
AECOM MECHANICAL / ELECTRICAL / FIRE SERVICES
 LEVEL 21, 420 GEORGE ST, SYDNEY
 NSW 2000

Robert Bird Group
 STRUCTURAL SERVICES
 LEVEL 5, 9 CASTLEREAGH ST, SYDNEY
 NSW 2000

HASSELL + POPULOUS ARCHITECT
 LEVEL 2, 88 CUMBERLAND STREET,
 SYDNEY NSW 2000

CIVIL / TRAFFIC / FACADES
HYDER CONSULTING PTY LTD
 ABN 76 104 485 289
 LEVEL 5, 141 WALKER ST,
 NORTH SYDNEY NSW 2060
 AUSTRALIA

Tel: +61 (0)2 8907 9000
 Fax: +61 (0)2 8907 9001
 www.hyderconsulting.com
 © Copyright reserved

Hyder

PROJECT
 SICEEP
 DARLING HARBOUR
 PRIVATE PUBLIC PARTNERSHIP (PPP)

DRAWING TITLE
**SEDIMENT AND EROSION CONTROL
 OVERALL PLAN**

STATUS
 DEVELOPMENT APPLICATION

SCALE @ A1	DRAWN	DESIGNED	REVIEWED	APPROVED
1 : 1000	LC	-	JH	GI
PROJECT NUMBER	DRAWING NUMBER		REV	
AA004399	PP-CI-0200		A	