

**NOTES:**

- THE EXISTING STORMWATER SHOWN ON THIS DRAWING HAS BEEN PLOTTED FROM INFORMATION SUPPLIED FROM CITY OF SYDNEY COUNCIL AND SYDNEY WATER REPORT "CITY AREA SWC 30 CAPACITY ASSESSMENT - JULY 1996". THE EXISTING STORMWATER INFORMATION HAS BEEN PREPARED ONLY TO SHOW THE APPROXIMATE POSITIONS OF ANY KNOWN STORMWATER AND MAY NOT BE AS CONSTRUCTED OR ACCURATE. HYDER CONSULTING CAN NOT GUARANTEE THAT THE STORMWATER INFORMATION SHOWN ON THIS DRAWING ACCURATELY INDICATES THE PRESENCE OR ABSENCE OF STORMWATER INFRASTRUCTURE OR THEIR LOCATION AND WILL ACCEPT NO LIABILITY FOR INACCURACIES IN THE STORMWATER INFORMATION SHOWN FROM ANY CAUSE WHATSOEVER.
- THE LOCATIONS OF UNDERGROUND SERVICES SHOWN ON THIS DRAWING HAS BEEN PLOTTED FROM "DIAL BEFORE YOU DIG" DRAWINGS RECEIVED ON THE 05/7/11. THE SERVICE INFORMATION HAS BEEN PREPARED ONLY TO SHOW THE APPROXIMATE POSITIONS OF ANY KNOWN SERVICES AND MAY NOT BE AS CONSTRUCTED OR ACCURATE. HYDER CONSULTING CAN NOT GUARANTEE THAT THE SERVICES INFORMATION SHOWN ON THIS DRAWING ACCURATELY INDICATES THE PRESENCE OR ABSENCE OF SERVICES OR THEIR LOCATION AND WILL ACCEPT NO LIABILITY FOR INACCURACIES IN THE SERVICES INFORMATION SHOWN FROM ANY CAUSE WHATSOEVER.

**LEGEND:**

s1	150-300 SEWER MAIN
s2	375-450 SEWER MAIN
s3	525-1000 SEWER MAIN
s4	812x1219, 1016x1270, 1016x1778, 1300x1750 SEWER MAIN
sr1	375 SEWER RISING MAIN
sr2	600 SEWER RISING MAIN
s	DISUSED SEWER MAIN
w1	100, 150 POTABLE WATER MAIN
w2	200, 225 POTABLE WATER MAIN
w3	250, 300 POTABLE WATER MAIN
w4	375, 500 POTABLE WATER MAIN
w5	600 POTABLE WATER MAIN
g1	SECONDARY MAIN 1050 kPa
g2	210 kPa
g3	7 kPa
g4	PROPOSED MAIN 2kPa
o1	OPTUS
o2	OPTUS IN OTHER UTILITY'S DUCT
1-4	1-4 CONDUITS
11	MAJOR SERVICE
12	AERIAL CABLE
v1	VERIZON DUCT
v2	TELSTRA DUCT (LIKELY FALSE)
a1	AAPT DUCT
a2	NON-AAPT DUCT
n1	NEXTGEN CABLE
n2	NEXTGEN THIRD PARTY CABLE
e1	1-5 CONDUITS
e2	6-12 CONDUITS
e3	13-20 CONDUITS
e4	RAILWAY CABLES
e5	TRANSMISSION CABLES
SW	STORMWATER PIPE/CULVERT

**DARLING HARBOUR LIVE**

FOR CONTINUATION REFER SHEET PP-CI-0022

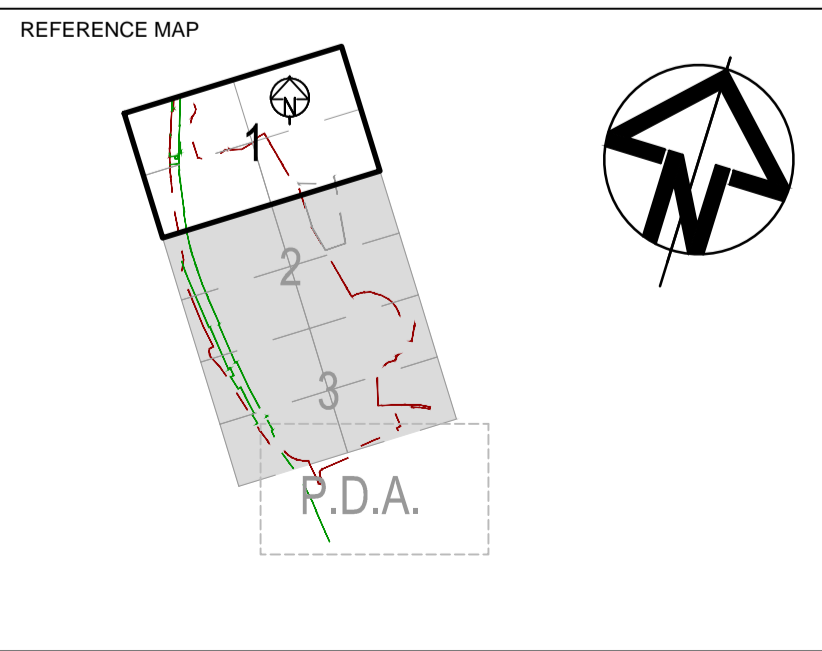

**NOTES:**

- DO NOT SCALE FROM DRAWINGS. WORK TO WRITTEN DIMENSIONS ONLY.
- ALL DIMENSIONS IN METRES UNLESS NOTED OTHERWISE.
- ALL COORDINATES TO MGA. ALL LEVELS TO AHD.
- ALL DIMENSIONS, COORDINATES AND LEVELS TO BE VERIFIED ON SITE BEFORE PROCEEDING WITH WORK. HYDER SHALL BE NOTIFIED IN WRITING OF ANY DISCREPANCIES.
- THIS DRAWING MUST BE READ IN CONJUNCTION WITH ALL RELEVANT CONTRACTS, SPECIFICATIONS AND DRAWINGS.
- PRECINCT BOUNDARIES ARE INDICATIVE ONLY AND ARE SUBJECT TO CHANGE.

REV	DESCRIPTION	DATE
A	ISSUE FOR DEVELOPMENT APPLICATION	14/03/2013

**CLIENT**  
**Lend Lease**  
 PROJECT MANAGEMENT & CONSTRUCTION  
 LEVEL 4, THE BOND, 30 HICKSON RD  
 MILLERS POINT, NSW 2000

**CONSULTANTS**  
**AECOM** MECHANICAL / ELECTRICAL / FIRE SERVICES  
 LEVEL 21, 420 GEORGE ST, SYDNEY  
 NSW 2000

**Robert Bird Group**  
 STRUCTURAL SERVICES  
 LEVEL 5, 9 CASTLEREAGH ST, SYDNEY  
 NSW 2000

**HASSELL + POPULOUS** ARCHITECT  
 LEVEL 2, 88 CUMBERLAND STREET,  
 SYDNEY NSW 2000

**CIVIL / TRAFFIC / FACADES**  
**HYDER CONSULTING PTY LTD**  
 ABN 76 104 485 289  
 LEVEL 5, 141 WALKER ST,  
 NORTH SYDNEY NSW 2060  
 AUSTRALIA

Tel: +61 (0)2 8907 9000  
 Fax: +61 (0)2 8907 9001  
 www.hyderconsulting.com  
 © Copyright reserved

**PROJECT**  
**SICEP**  
**DARLING HARBOUR**  
**PRIVATE PUBLIC PARTNERSHIP (PPP)**



DRAWING TITLE  
**SURVEY AND EXISTING SERVICES PLAN SHEET 1**

STATUS  
**DEVELOPMENT APPLICATION**

SCALE @ A1	DRAWN	DESIGNED	REVIEWED	APPROVED
1 : 500	RD	-	JH	GI

PROJECT NUMBER	DRAWING NUMBER	REV
AA004399	PP-CI-0021	A