

LEGEND

- BUILDING FOOTPRINT
- PROPOSED BUILDING ABOVE NOTED RL
- LINE OF EXISTING BUILDINGS
- EXISTING FIELD OF VIEW IMPACTED
- NEW FIELD OF VIEW

CONCLUSION
 WITHIN THE EAST ELEVATION OF THE HOTEL AT RL +36.450M, THE FIELD OF VIEW REDUCTION IN VIEW ANGLE DEVELOPMENT IS 17% AT THE EAST ELEVATION. A NEW FIELD OF VIEW IS 17%.

FOR APPROVAL

DRAWING TITLE
VIEW IMPACT ANALYSIS. NOVOTEL - MID LEVEL - EAST RL +36.450

STATUS
DEVELOPMENT APPLICATION

SCALE @ A1 | DRAWN | CO-ORD | REVIEWED | APPROVED
1:1000 DH GS GS GS GS

PROJECT NUMBER | DRAWING NUMBER | REV
3688 PP_AR_ID_900066 A

LANDSCAPE ARCHITECT - PRINCIPAL DESIGN CONSULTANT

HASSELL + POPULOUS
 88 COLLIER AND STREET
 SYDNEY NSW 2000 AUSTRALIA
 SYDNEY@HASSELLSTUDIO.COM
 T +61 2 9101 2000 F +61 2 9101 2100

HASSELL + POPULOUS

PROJECT
SICEEP_DARLING HARBOUR

PROJECT MANAGEMENT & CONSTRUCTION
 LEVEL 4, THE BOND, 30 HICKSON RD
 MILLERS POINT, NSW 2000
 (02) 9236 9111

BUILDING / ENVIRONMENTAL SERVICES
 LEVEL 21, 420 GEORGE STREET
 SYDNEY NSW 2000
 (02) 9854 0000

STRUCTURAL SERVICES
 LEVEL 6, 9 CASTLEREAGH STREET
 SYDNEY NSW 2000
 (02) 9348 3200

CIVIL / TRAFFIC SERVICES
 5/41 WALKER ST, NORTH SYDNEY
 NSW 2060
 (02) 9587 9000

CLIENT

Lend Lease

CONSULTANTS

AECOM

Robert Bird Group

Hyder

REV	DESCRIPTION	DATE
A	ISSUED FOR DEVELOPMENT APPLICATION	24/06/2013

THESE VIEW IMPACT ANALYSIS DRAWINGS ARE TO BE READ IN CONJUNCTION WITH THE ARCHITECTURAL DRAWINGS. THE FIELD OF VIEW DOES NOT TAKE INTO ACCOUNT ANY RLS OF TALLER BUILDINGS BEYOND THE SITE OR REFERENCE BUILDINGS. THE BUILDING ENVELOPE REPRESENTS THE MAXIMUM EXTERNAL ENVELOPE AS SUBMITTED IN THE PAVIMENT PLAN.

NOTES

- DO NOT SCALE DRAWINGS. WRITTEN DIMENSIONS GOVERN.
- ALL DIMENSIONS ARE IN MILLIMETRES UNLESS NOTED OTHERWISE.
- ALL DIMENSIONS SHALL BE VERIFIED ON SITE BEFORE PROCEEDING.
- ALL DIMENSIONS SHALL BE VERIFIED ON SITE BEFORE PROCEEDING. OF ANY DISCREPANCIES, HASSELL + POPULOUS SHALL BE NOTIFIED IN WRITING.
- THESE PLANS ARE TO BE READ IN CONJUNCTION WITH ARCHITECTURAL DRAWINGS AND DRAWINGS SECTION 5.7 MATERIALS SCHEDULE AND 5.7 OF ARCHITECTURAL DRAWINGS.
- ALL LEVELS ARE INDICATIVE ONLY BASED ON COMPOSITE SURVEY DATA PROVIDED BY LEND LEASE AND NOT TO BE RELIED UPON FOR COSTING OR CONSTRUCTION PURPOSES.

© COPYRIGHT OF THIS DRAWING IS VESTED IN HASSELL + POPULOUS, 2013 HASSELL + POPULOUS.

THIS DRAWING IS AN UNCONTROLLED COPY, UNLESS NOTED OTHERWISE.

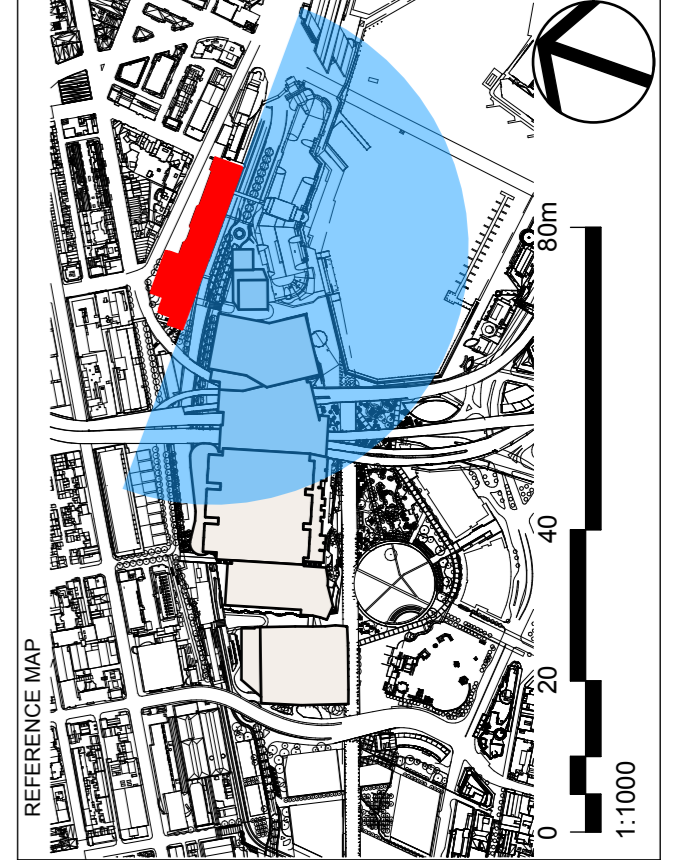

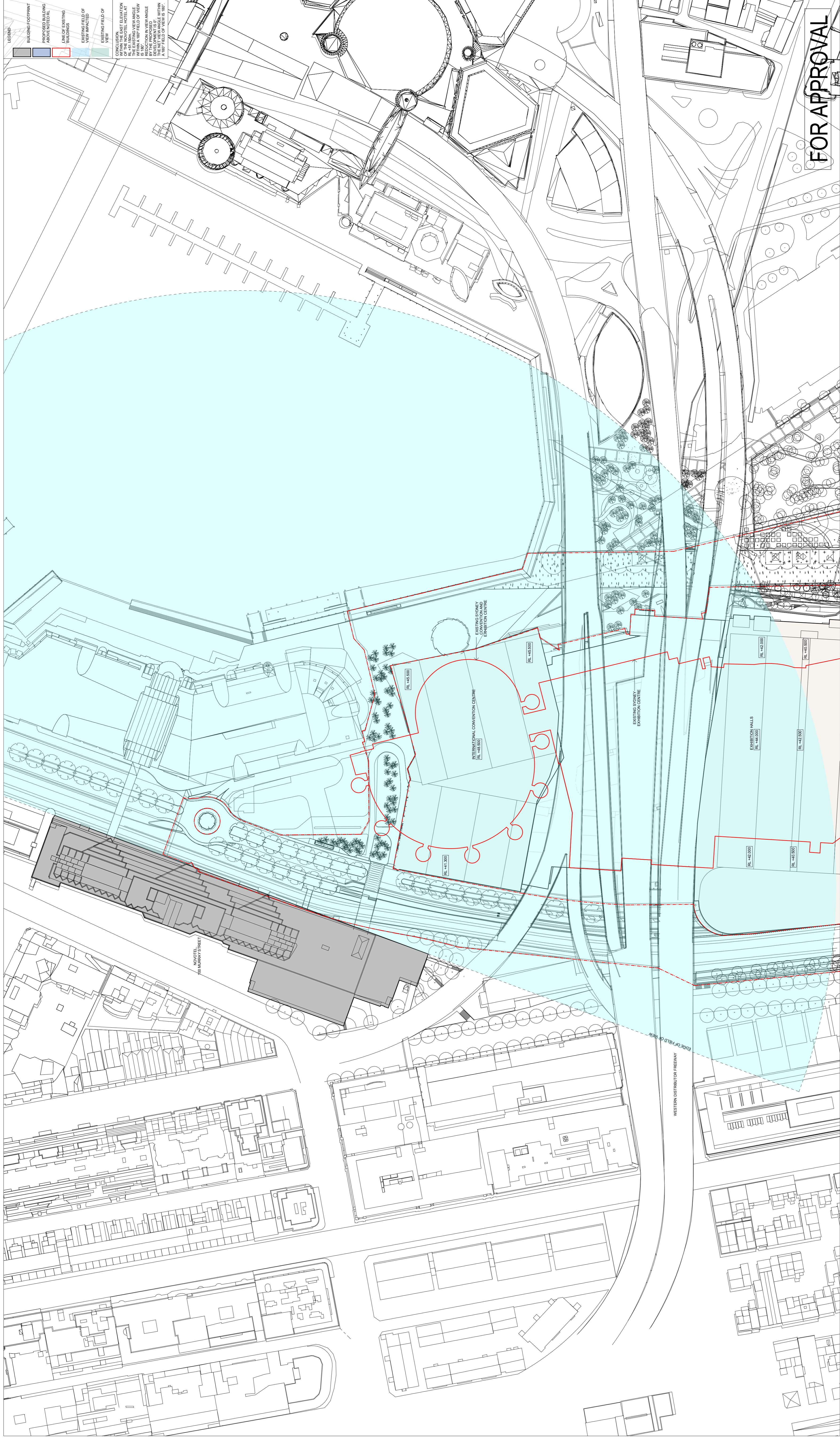

LEGEND

[Grey Box]	BUILDING FOOTPRINT
[Blue Box]	PROPOSED BUILDING ABOVE NOTED RL
[Red Box]	LINE OF EXISTING BUILDINGS
[Cyan Box]	EXISTING FIELD OF VIEW IMPACTED
[Green Box]	PROPOSED FIELD OF VIEW

CONCLUSION
 WITHIN THE EAST ELEVATION OF THE HOTEL AT RL +51.150M, THE PROPOSED BUILDING WILL CAUSE A REDUCTION IN VIEW ANGLE OF THE EXISTING BUILDINGS DEVELOPMENT TO THE WEST. THE VIEW ANGLE AT THE FIELD OF VIEW IS 100°.

FOR APPROVAL

DRAWING TITLE

**VIEW IMPACT ANALYSIS.
 NOVOTEL - HIGH LEVEL - EAST
 RL +51.150**

STATUS

DEVELOPMENT APPLICATION

SCALE @ A1 DRAWN CO-ORD REVIEWED APPROVED

1:1000 DH GS GS GS GS

PROJECT NUMBER DRAWING NUMBER REV

3688 PP_AR_D_900067 A

LANDSCAPE ARCHITECT - PRINCIPAL DESIGN CONSULTANT

HASSELL + POPULOUS
 88 COLLIER AND STREET
 SYDNEY NSW 2000 AUSTRALIA
 SYDNEY@HASSELLSTUDIO.COM
 T +61 2 9101 2000 F +61 2 9101 2100

HASSELL + POPULOUS

PROJECT

SICEEP_DARLING HARBOUR

PROJECT MANAGEMENT & CONSTRUCTION
 LEVEL 4, THE BOND, 30 HICKSON RD
 MILLERS POINT, NSW 2000
 (02) 9236 9111

BUILDING / ENVIRONMENTAL SERVICES
 LEVEL 21, 420 GEORGE STREET
 SYDNEY NSW 2000
 (02) 9354 0000

STRUCTURAL SERVICES
 LEVEL 6, 9 CASTLEREAGH STREET
 SYDNEY NSW 2000
 (02) 8348 3200

CIVIL / TRAFFIC SERVICES
 5/41 WALKER ST, NORTH SYDNEY
 NSW 2060
 (02) 9587 9000

CLIENT

Lend Lease

CONSULTANTS

AECOM

Robert Bird Group

Hyder

REV	DESCRIPTION	DATE
A	ISSUED FOR DEVELOPMENT APPLICATION	24/06/2013

THESE VIEW IMPACT ANALYSIS DRAWINGS ARE TO BE READ IN CONJUNCTION WITH THE ARCHITECTURAL DRAWINGS. THE FIELD OF VIEW DOES NOT TAKE INTO ACCOUNT ANY RLS OF TALLER BUILDINGS BEYOND THE SITE OR REFERENCE BUILDINGS. THE BUILDING ENVELOPE REPRESENTS THE MAXIMUM EXTERNAL ENVELOPE AS SUBMITTED IN THE PAVIMENT PLAN.

NOTES

- DO NOT SCALE DRAWINGS. WRITTEN DIMENSIONS GOVERN.
- ALL DIMENSIONS ARE IN MILLIMETRES UNLESS NOTED OTHERWISE.
- ALL DIMENSIONS SHALL BE VERIFIED ON SITE BEFORE PROCEEDING.
- ALL DIMENSIONS SHALL BE VERIFIED ON SITE BEFORE PROCEEDING.
- OF ANY DISCREPANCIES, HASSELL + POPULOUS SHALL BE NOTIFIED IN WRITING.
- THESE PLANS ARE TO BE READ IN CONJUNCTION WITH ARCHITECTURAL DRAWINGS AND DRAWINGS. SECTION 57 MATERIALS SCHEDULE AND 57 OF ENGINEERING DRAWINGS.
- ALL LEVELS ARE INDICATIVE ONLY BASED ON COMPOSITE SURVEY DATA PROVIDED BY LEND LEASE AND NOT TO BE RELIED UPON FOR COSTING OR CONSTRUCTION PURPOSES.

© COPYRIGHT OF THIS DRAWING IS VESTED IN HASSELL + POPULOUS, 2013 HASSELL + POPULOUS.

THIS DRAWING IS AN UNCONTROLLED COPY, UNLESS NOTED OTHERWISE.

