

stage 1 - prep to year 8								
projected student and staff numbers								
	existing	stage 1	stage 2	stage 3	stage 4	stage 5	stage 6	total
students	235	221						456
year 12 students (incl. in above)	nil	nil						nil
staff	20	10						30

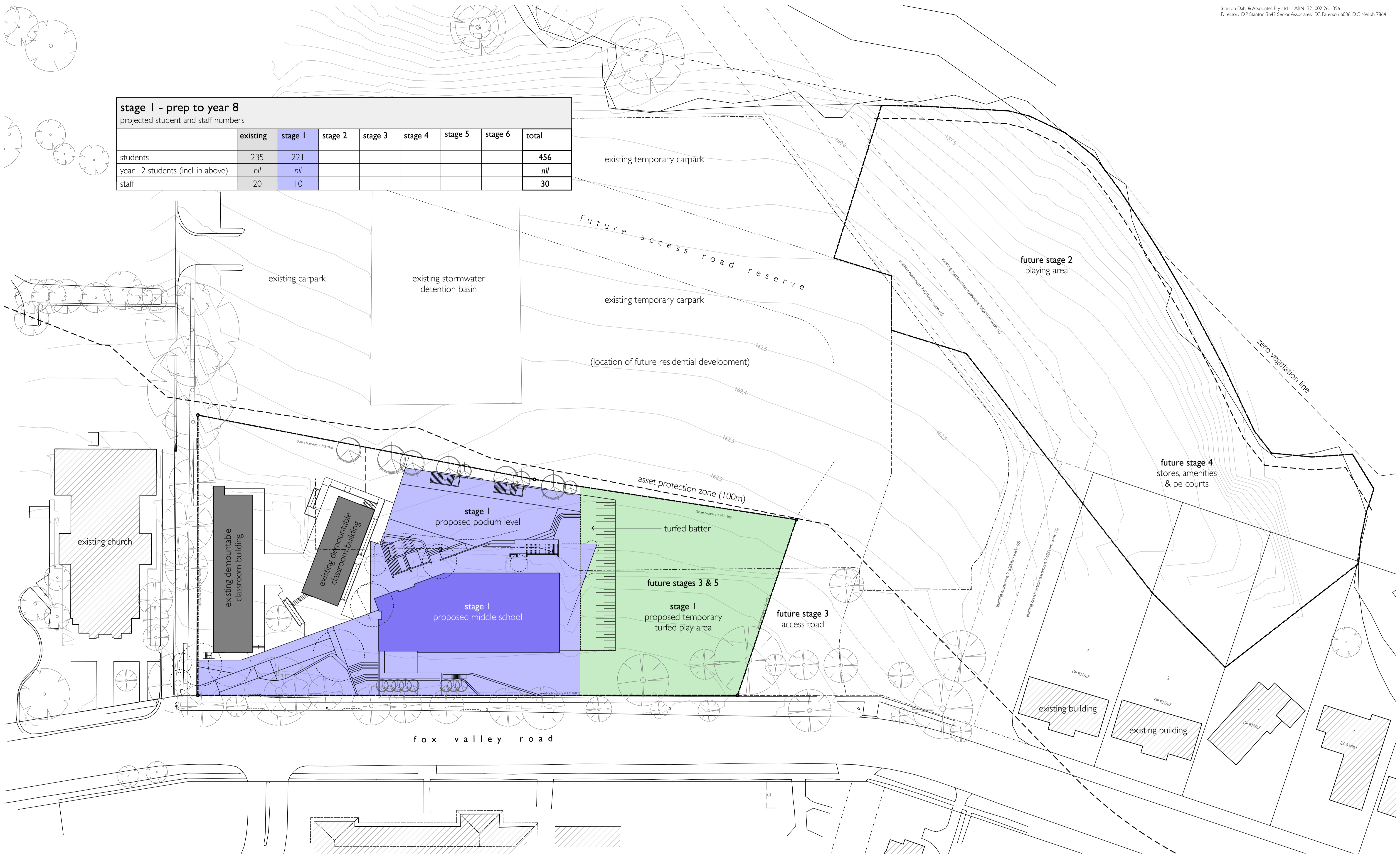

01 staging plan - stage 1
 1:400

3 - staging revised / re-issue for state significant development application	06/02/15
2 - re-issue for state significant development application	05/12/13
1 - issue for state significant development application	27/03/13
amendment	date
note: all dimensions are to be verified on site and any discrepancies referred to the architect for determination. figured dimensions are to take precedence over scaled dimensions.	

drawn	mc
checked	dmb
plot date	10/02/15
scale	1:400 @ A1

warrongga adventist school
 fox valley road, warrongga
 for seventh day adventist,
 greater sydney conference

staging plan - stage 1

job number 1318.10
 dwg. no. / issue & amendment DA03 / 3

stanton dahl architects

18 - 20 Oxford Street
 Epping NSW 2121
 Ph 61 2 8876 5300
 Fx 61 2 9868 2624
 design@stantondahl.com.au
 www.stantondahl.com.au
 copyright 2011 stanton dahl

