

legend

- builder's compound and construction parking
- construction access
- existing carpark
- existing temporary access road
- extent of stage 3 works

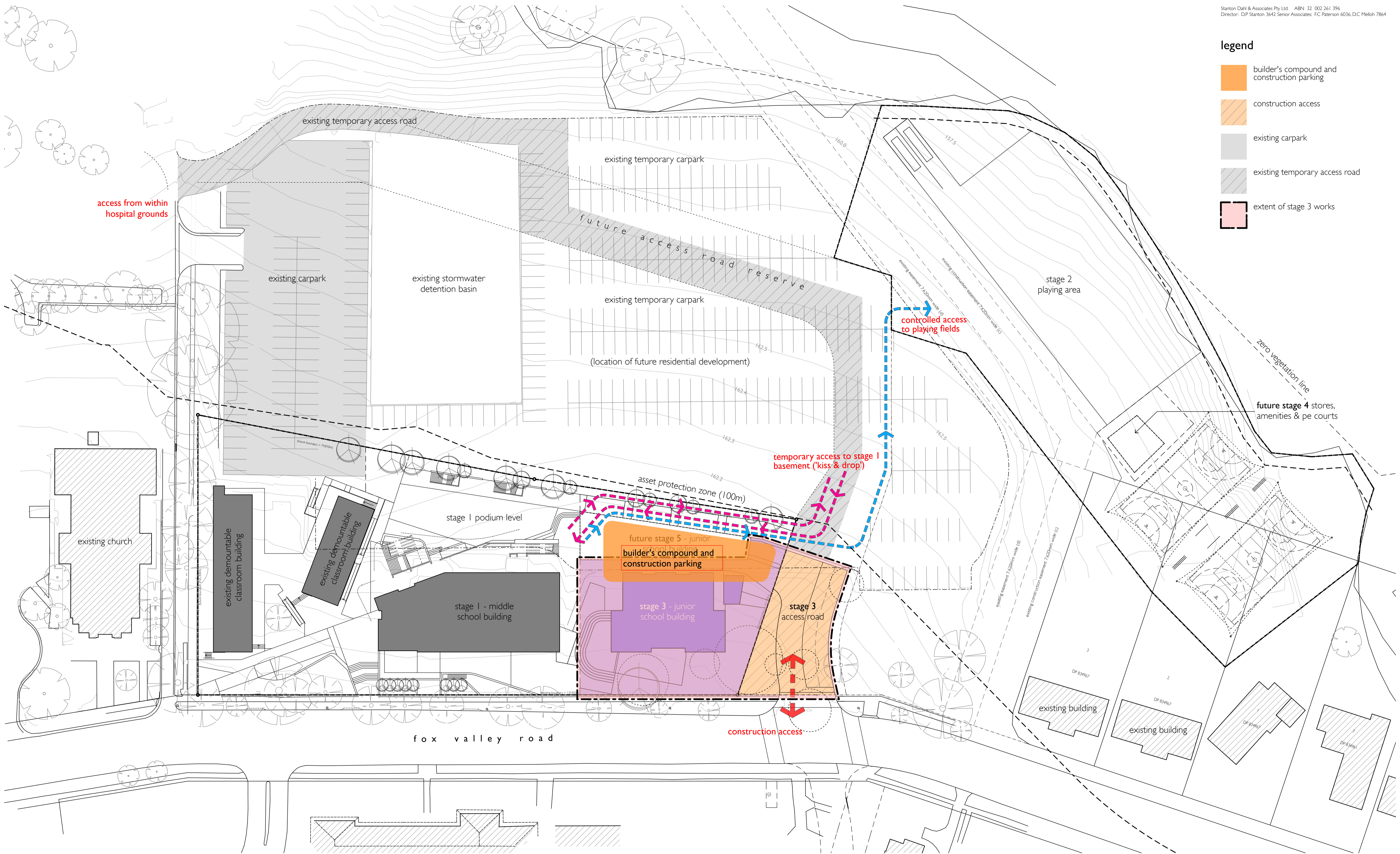

01 construction access & parking - stage 3
1:400

2 - staging revised / re-issue for state significant development application	06/02/15	
1 - re-issue for state significant development application	05/12/13	
amendment		date
note: all dimensions are to be verified on site and any discrepancies referred to the architect for determination. figured dimensions are to take precedence over scaled dimensions.		

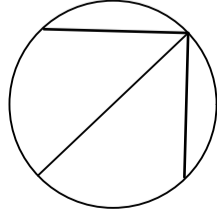

drawn s/dmb
checked dmb
plot date 10/02/15
scale 1:400 @ A1

wahroonga adventist school
fox valley road, wahroonga
for seventh day adventist,
greater sydney conference
construction access/parking - stage 3
job number 1318.10
dwg. no. / issue & amendment DA63/2

stanton dahl architects
18 - 20 Oxford Street
Epping NSW 2121
Ph 61 2 8876 5300
Fx 61 2 9868 2624
design@stantondahl.com.au
www.stantondahl.com.au
copyright 2011 stanton dahl

