

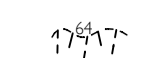





**legend:**

-  ex.contours & banking line
-  existing trees to be removed
-  existing trees to be retained
-  proposed trees - subject to landscape architects design
-  existing building(s)
-  proposed building(s)

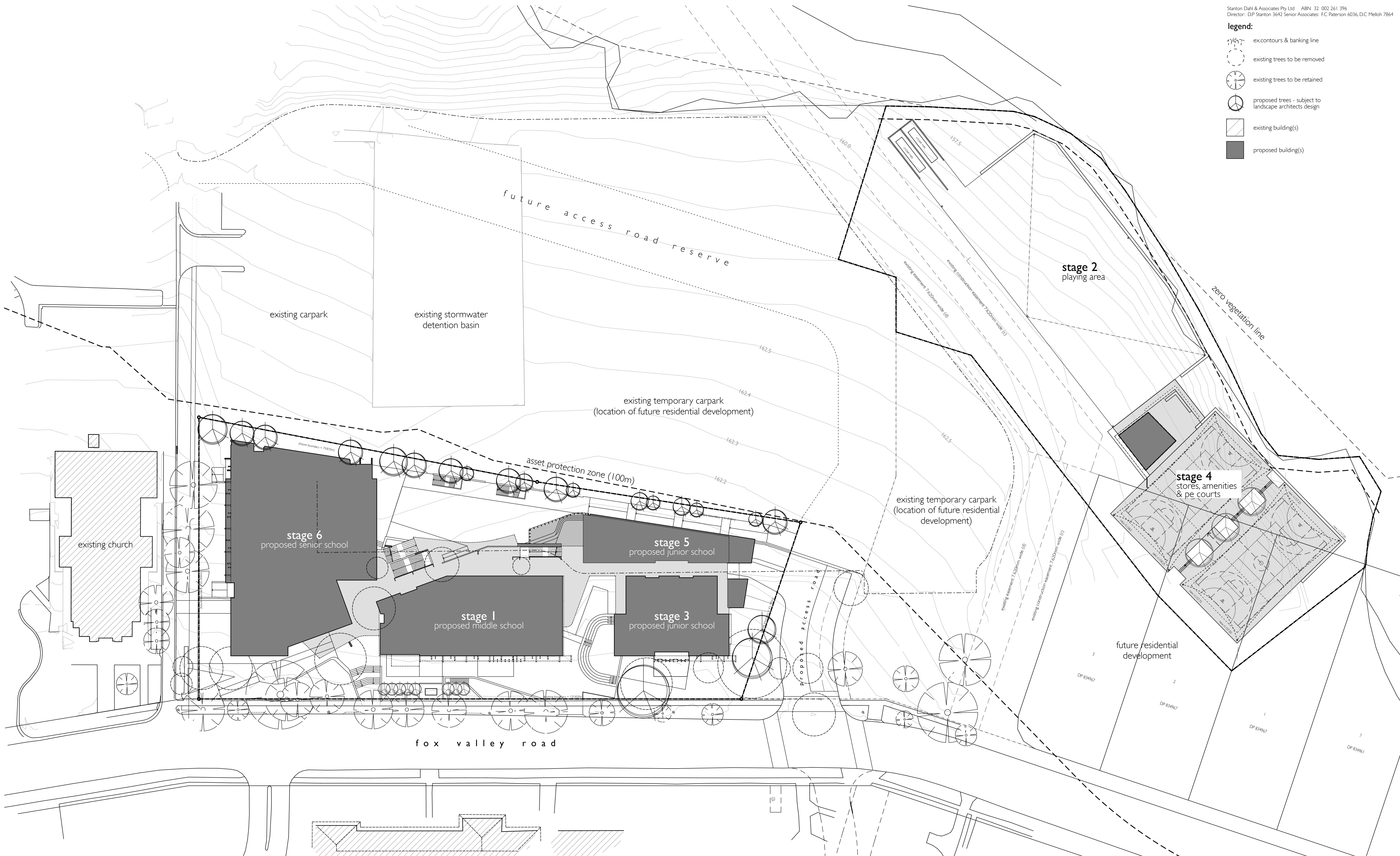

01 precinct plan  
1:400

amendment	date
3 - staging revised / re-issue for state significant development application	06/02/15
2 - re-issue for state significant development application	05/12/13
1 - issue for state significant development application	27/03/13

note: all dimensions are to be verified on site and any discrepancies referred to the architect for determination. figured dimensions are to take precedence over scaled dimensions.

drawn	jok
checked	dmb
plot date	10/02/15
scale	1:400 @ A1

**warringoona adventist school**  
 fox valley road, warringoona  
 for  
 seventh day adventist,  
 greater sydney conference

precinct plan  
 job number 1318.10 dwg. no. / issue & amendment DA02 / 3

stanton dahl architects

18 - 20 Oxford Street  
 Epping NSW 2121  
 Ph 61 2 8876 5300  
 Fx 61 2 9868 2624  
 design@stantondahl.com.au  
 www.stantondahl.com.au  
 copyright 2011 stanton dahl

