

LEGEND

- PROPOSED LEASE LINE
- SICEEP BOUNDARY
- DARLING QUARTER (approx 28,200m²)
- IMAX THEATRE FOOTPRINT
- ZONE OF INFLUENCE (approx 10,885m²)

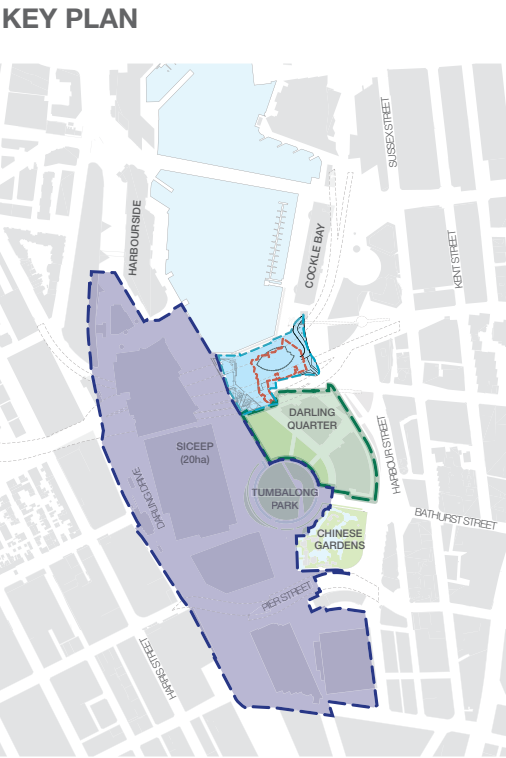

Public Domain Plan

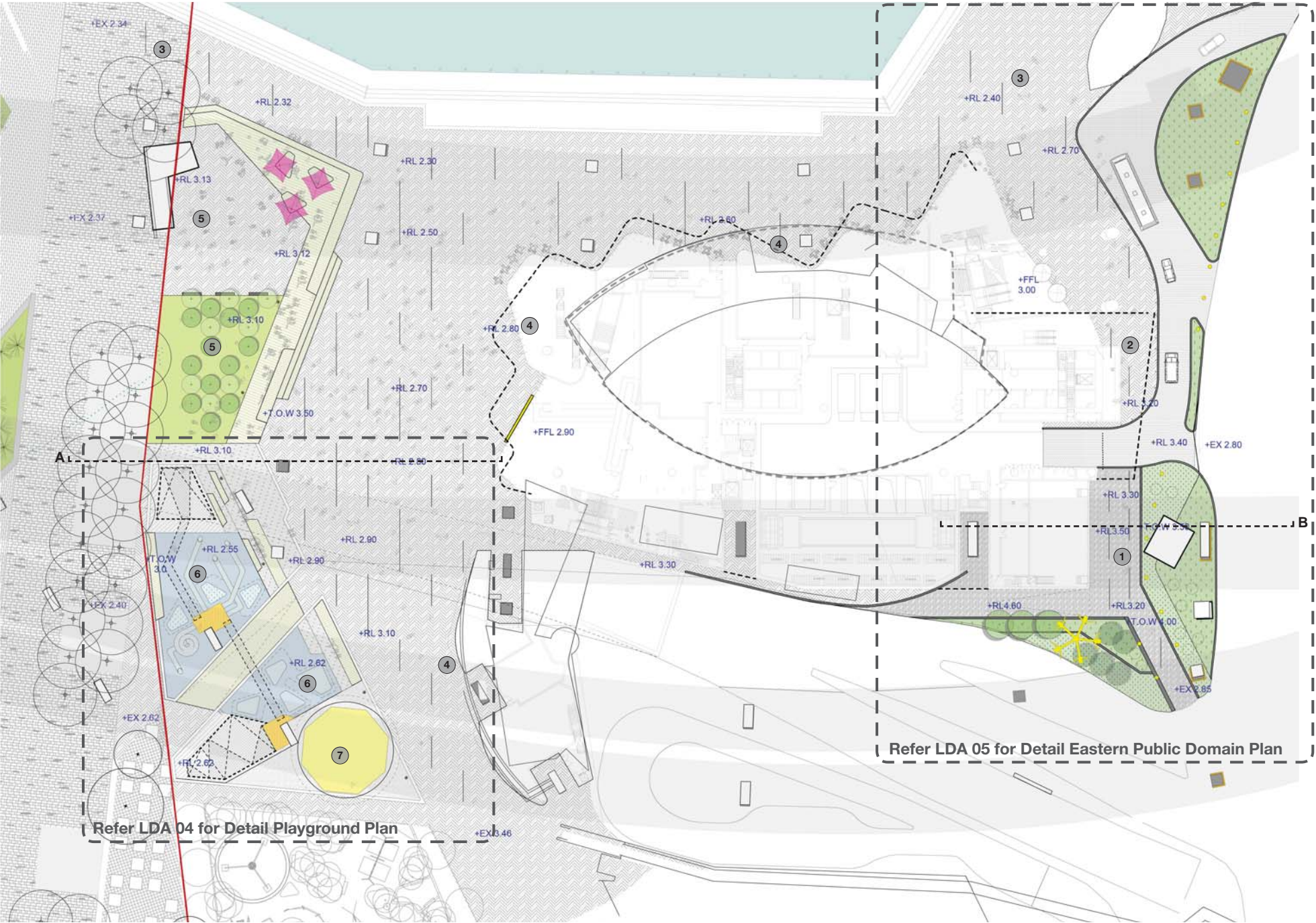

Key

- ## 1. Harbour Street pedestrian linking
- Paved footpath with pedestrian lighting and/ or opportunity for public art. The existing substation and freeway pylon will sit amongst a field of low rainforest planting. Along the western side of the path is a taller urban rainforest (with Kentia, Livistona palm and various fern species).
- ## 2. Harbour St/ Wheat Road drop off & building entries
- The drop off will be realigned and upgraded to create a new street address for the commercial and function lobbies. It has been designed to be a pedestrian oriented environment with unit paving on both the roadway and footpaths, flush kerbs along the drop off lane and bollards which demarcate the two.
- ## 3. Cockle Bay/ Darling Harbour public domain interface
- New high quality unit paving will be integrated with the existing Darling Harbour precinct paver in a harmonious way. The proposed new paving will feature a number of well crafted slotted drains to provide improved site drainage.
- ## 4. Ground floor retail interfaces
- The public domain will be activated along the building edge by new retail, IMAX lobby, and an outdoor 'city screen'. Outdoor seating areas will be provided adjacent the retail tenancies.
- ## 5. Palm grove revitalisation
- Features a new, large rationalised gathering space which pedestrians can easily move through. A large seating edge

has been provided to the west that provides numerous seating options for the public.

The existing palm grove (*Livistona australis*) has been relocated to an upper level turf area, which is designed for passive recreation.

The existing hardstand (containing the AV control building) has been retained, with upgraded paving and finishes. A large timber deck is provided to the east of the control building, with bespoke group seating opportunities located in a position which overlooks the harbour and city beyond. Existing *Phoenix canariensis* palms will be left as an important row of plants lining the valley floor of Darling Harbour.

6. Darling Quarter playground interface

A new playground is proposed, aligning with the existing Darling Quarter edge which further strengthens the existing playground and pedestrian boulevard. The overhead freeways and pylons provides an ideal framework for the location of a giant layered climbing net structure and integrated slide-scape. These items will extend the play opportunities currently provided at the Darling Quarter playground and provide an exciting destination for young adults.

7. Relocated existing carousel

The existing carousel has been relocated and is now in alignment with the existing Darling Quarter playground.

Design Diagrams

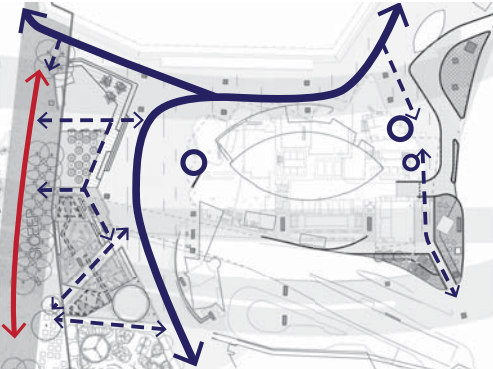

- Pedestrian Circulation**
- Main circulation path
 - - - Cross site connections
 - Main building entrances
 - SICEEP boulevard

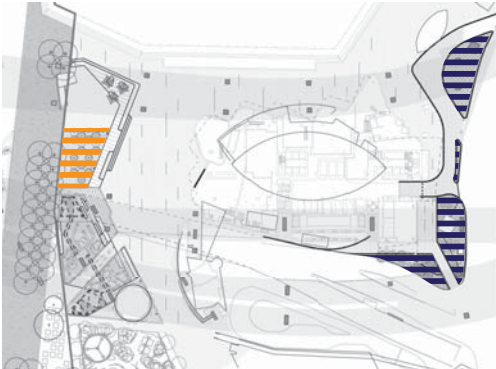



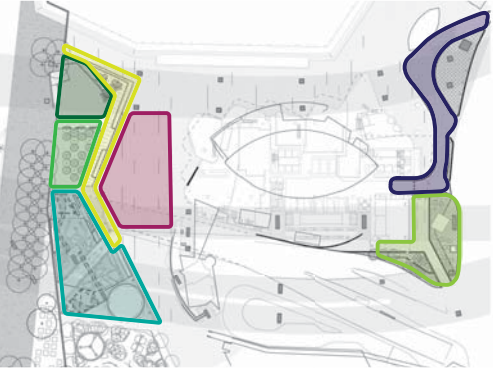



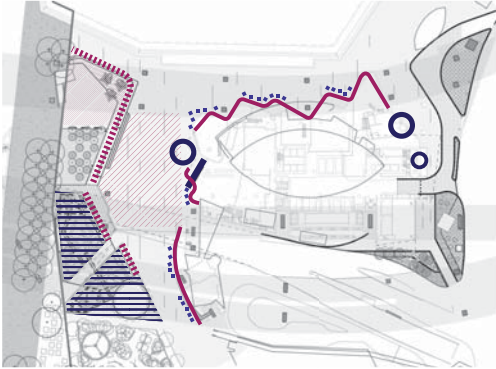

- ### Planting Habitats
- Solar access through freeway over - suitable for lawn
 -  Shaded habitat - suitable for rainforest species



- ### Spatial zoning
- Small event space
 - Relocated palm grove and lawn
 - Large event space
 - Terraced edge
 - Playground extension
 - Eastern pedestrian entry
 - Wheat Road drop off



- ### Activation
- | | | | |
|---|----------------------|---|-------------------------|
|  | Active Seating edge |  | Main building entrances |
|  | Outdoor dining |  | Large gathering space |
|  | Active Building Edge |  | Small gathering space |
|  | City screen | | |
|  | Playground | | |

Precedents

Waterfront Park



City beach umbrellas, Sugar Beach,
Montreal, Canada



Grove of *Livistona Australis*, Australia



Playful edges, Måløv, Denmark



Large play nets, Hasselt, Belgium



Large slides, Tate Modern, London,
UK



Shareway with high quality paving,
New Road, Brighton, UK



Post lighting/ totem installation

12023 - 31 Wheat Road | Darling Harbour, Sydney



Team:

HASELL pmd

**RUSSELL &
GEORGE**

Client:  Grocon

Drawn: **EC / TH**
Checked: **JM/SC**

Scale: **1:400 @A1**
Date: **February 2013**

Public Domain Plan



Dwg no. : **12023-LDA 02**
Rev: **D**

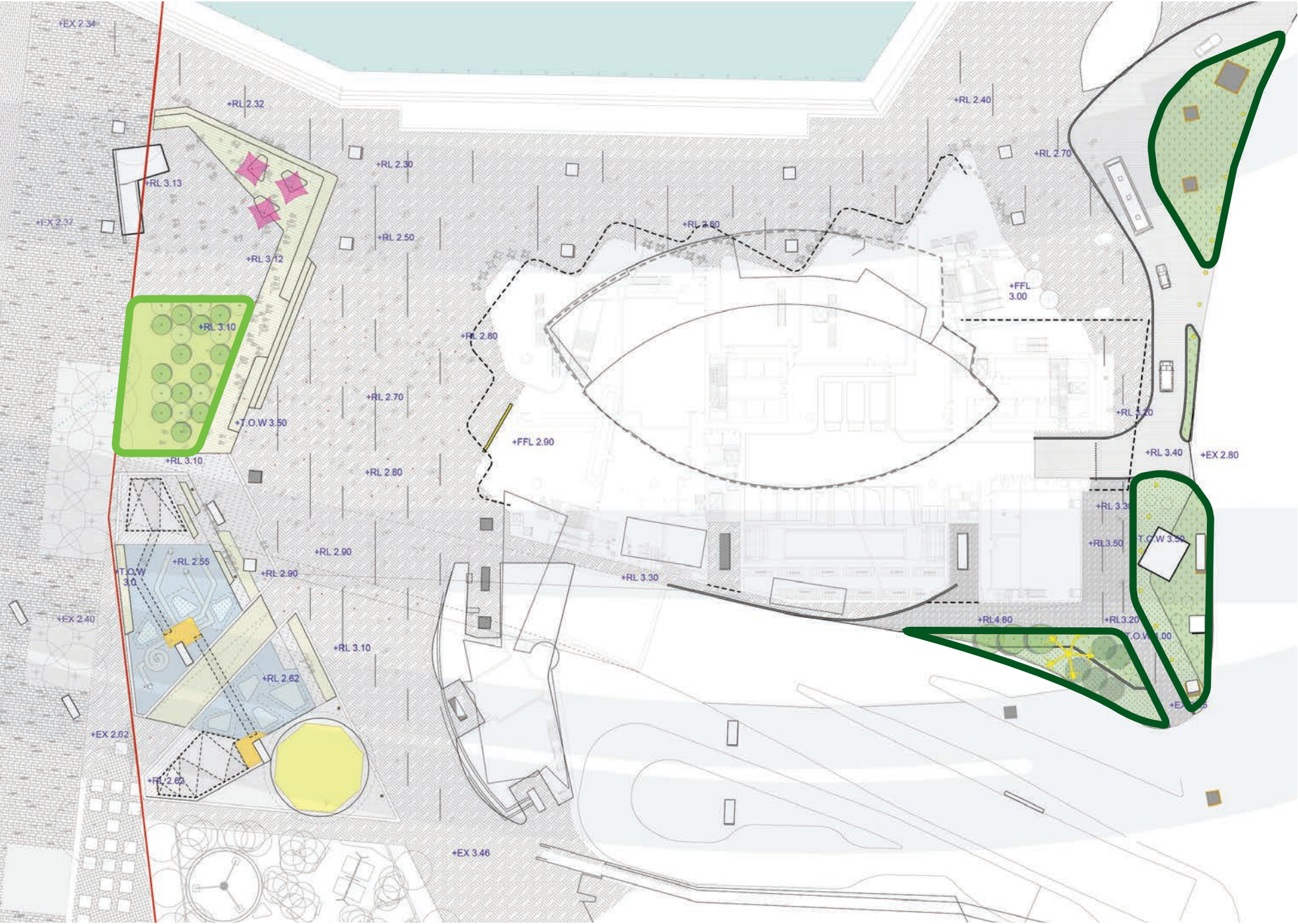

Planting Schedules

Lawn and (relocated) Palm Grove

Botanic Name	Common Name	Pot Size
Trees		
<i>Livistona australis</i>	Cabbage Tree Palm	Existing on site to be relocated
<i>Phoenix canariensis</i>	Phoenix Palm	Existing on site to be retained
<i>Howea forsteriana</i>	Kentia Palm	Forest salvaged, 6-12m
Turf		
<i>Stenotaphrum secundatum</i> 'King's Pride'	'King's Pride' Soft Leaf Buffalo	

Rainforest Entry Gardens

Botanic Name	Common Name	Pot Size
Trees and Ferns		
<i>Livistona australis</i>	Cabbage Tree Palm	Existing on site to be relocated
<i>Cyathea cooperi</i>	Coin Spot Tree Fern	2m high
<i>Dicksonia antarctica</i>	Soft Tree Fern	2m high
<i>Asplenium australasicum</i>	Birds Nest Fern	300mm
<i>Blechnum cartilagenum</i>	Gristle Fern	200mm
<i>Microsorium punctatum</i>	Fishtail Strap Fern	200mm
Groundcovers / Flowering Plants		
<i>Aspidistra eliator</i>	Cast Iron Plant	200mm
<i>Clivea miniata</i>	Clivea	200mm
<i>Liriope muscari</i> 'Evergreen Giant'	'Evergreen Giant' Lily Turf	200mm
<i>Philodendron</i> 'Xanadu'	'Xanadu' Philodendron	200mm
<i>Ajuga reptans</i> 'Giant Catlins'	Giant Catlins' Ajuga	150mm
<i>Anthropodium cirrhatum</i>	Renga Renga Lily	150mm
<i>Cycas revoluta</i>	Cycad	100L
<i>Ophiopogon japonica</i>	Mondo Grass	150mm
<i>Pachysandra terminalis</i>	Japanese Spurge	150mm
<i>Sansserveria trifasciata</i>	Monther In Law's Tongue	200mm
<i>Viola hederacea</i>	Native Violet	150mm

West. Lawn and Palm Grove



Existing Cabbage Palms (49) to be relocated within the site
Existing Phoenix palms to be retained along the western edge
Seating lawn, Darling Quarter, Sydney

East. Harbour St and Wheat Rd pedestrian link and median rainforest planting



Microsorium punctatum
Cyathea cooperi
Rainforest garden, Capita Centre, Sydney
Blechnum cartilagenum
Dicksonia antarctica and *Cycas revoluta*
Low mass planting, Darling Quarter